



WATEST  
WATEST 1  
C

**FIRST AMENDMENT TO DECLARATION OF  
COVENANTS, CONDITIONS, RESTRICTIONS AND EASEMENTS  
FOR WATERFORD LAKE**

The undersigned, constituting the "Declarant" under the Declaration of Covenants, Conditions, Restrictions and Easements for Waterford Lake dated January 28, 2008, and filed of record with the Lancaster County Register of Deeds as Instrument No. 2008005164 ("Declaration"), do hereby amend the Declaration as follows:

A. Exhibits "B", "C", "D", "F" and "H" attached to the Declaration are hereby deleted and replaced by Exhibits "B", "C", "D", "F" and "H", which are attached hereto and incorporated herein by this reference.

B. Paragraph 12 is hereby amended to also provide the NRD the right to enforce the Declaration.

C. The following language is added as a new paragraph 14:

14. NRD APPROVAL. Notwithstanding the foregoing provisions, any instrument amending, modifying, abrogating, or terminating this Declaration pertaining to the structure, existence or financing of the Association maintenance of the Lake Association Property, enforcement of this Declaration by the NRD and NRD approval of amendments to this Declaration must be approved by the NRD in writing and recorded with the Register of Deeds before it shall be effective. In addition, the NRD Agreements shall not be altered or amended without the express written approval of the NRD.

D. All other terms and conditions of the Declaration, except as amended herein, remain in full force and effect. In the event of a conflict between the terms of this First Amendment and the terms of the Declaration, the terms of this First Amendment shall control. Capitalized terms used herein and not defined herein have the same meaning as in the Declaration.

*Seacrest Kalkowski*

IN WITNESS WHEREOF, the Declarant has caused this First Amendment to be executed this 11 day of June, 2008.

**WATERFORD ESTATES, LLC**, a Nebraska limited liability company

By: **RIDGE DEVELOPMENT COMPANY**, a Nebraska corporation, Manager

By:   
Thomas E. White  
President of Development

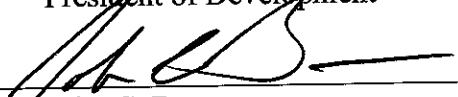
By:   
John C. Brager  
President of Construction

By: **SOUTHVIEW, INC.**, a Nebraska corporation, Manager

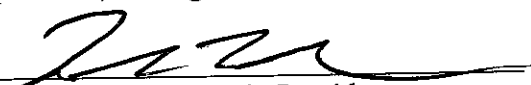
By:   
John F. Schleich, President

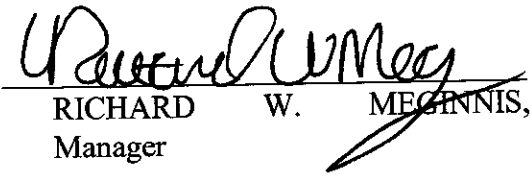
By:   
**RICHARD W. MEHNIS**,  
Manager

THE DECLARATION, AS AMENDED BY THIS FIRST AMENDMENT, IS APPROVED AS TO FORM FOR THE LIMITED PURPOSE OF TRANSFERRING MAINTENANCE OF THE LAKE ASSOCIATION PROPERTY TO THE ASSOCIATION:

**LOWER PLATTE SOUTH NATURAL RESOURCES DISTRICT**, a political subdivision of the State of Nebraska

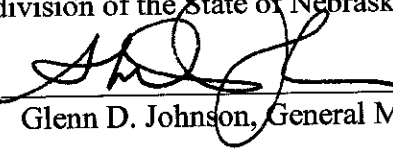
By:   
Glenn D. Johnson, General Manager

Date: June 10, 2008

STATE OF NEBRASKA )  
 ) ss.  
COUNTY OF LANCASTER )

The foregoing was acknowledged before me this 11 day of June, 2008, by Thomas E. White, President of Development of Ridge Development Company, a Nebraska corporation, Manager of **Waterford Estates, LLC**, a Nebraska limited liability company on behalf of the limited liability company.

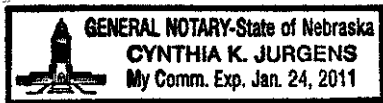

Cynthia K. Jurgens  
Notary Public

STATE OF NEBRASKA )  
 ) ss.  
COUNTY OF LANCASTER )

The foregoing was acknowledged before me this 11 day of June, 2008, by John C. Brager, President of Construction of Ridge Development Company, a Nebraska corporation, Manager of **Waterford Estates, LLC**, a Nebraska limited liability company on behalf of the limited liability company.

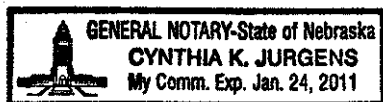

Cynthia K. Jurgens  
Notary Public

STATE OF NEBRASKA )  
 ) ss.  
COUNTY OF LANCASTER )

The foregoing was acknowledged before me this 5<sup>th</sup> day of June, 2008, by John F. Schleich, President of Southview, Inc., a Nebraska corporation, Manager of **Waterford Estates, LLC**, a Nebraska limited liability company on behalf of the limited liability company.

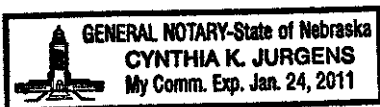

Cynthia K. Jurgens  
Notary Public

STATE OF NEBRASKA )  
 ) ss.  
COUNTY OF LANCASTER )

The foregoing was acknowledged before me this 5<sup>th</sup> day of June, 2008, by Richard W. Meginnis, Manager of **Waterford Estates, LLC**, a Nebraska limited liability company on behalf of the limited liability company.

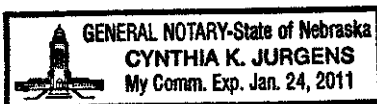

Cynthia K. Jurgens  
Notary Public

## EXHIBIT "B"

### COMMERCIAL PROPERTY LEGAL DESCRIPTION

#### EAST COMMERCIAL PROPERTY:

LOT 1, BLOCK 1 AND OUTLOT "H", WATERFORD ESTATES 1<sup>ST</sup> ADDITION, LINCOLN, LANCASTER COUNTY, NEBRASKA.

#### WEST COMMERCIAL PROPERTY:

A PORTION OF OUTLOT 'D', WATERFORD ESTATES ADDITION, LOCATED IN THE SOUTHEAST QUARTER OF SECTION 23, TOWNSHIP 10, RANGE 7 EAST OF THE 6TH P.M., CITY OF LINCOLN, LANCASTER COUNTY, NEBRASKA, AND MORE PARTICULARLY DESCRIBED AS FOLLOWS:

BEGINNING AT THE SOUTHEAST CORNER OF SAID OUTLOT 'D', SAID CORNER BEING ON THE NORTH RIGHT OF WAY LINE OF EAST 'O' STREET, SAID CORNER ALSO BEING ON THE WEST RIGHT OF WAY LINE OF NORTH 98<sup>TH</sup> STREET, THENCE WEST ALONG THE SOUTH LINE OF SAID OUTLOT 'D', SAID LINE ALSO BEING THE NORTH RIGHT OF WAY LINE OF EAST 'O' STREET, ON AN ASSUMED BEARING OF SOUTH 86 DEGREES 46 MINUTES 15 SECONDS WEST, A DISTANCE OF 337.32 FEET TO A SOUTH CORNER OF SAID OUTLOT 'D', SAID CORNER ALSO BEING A NORTH CORNER OF EAST 'O' STREET RIGHT OF WAY; THENCE NORTH 83 DEGREES 32 MINUTES 33 SECONDS WEST, ALONG THE SOUTH LINE OF SAID OUTLOT 'D', SAID LINE ALSO BEING THE NORTH RIGHT OF WAY LINE OF EAST 'O' STREET, A DISTANCE OF 351.85 FEET TO A SOUTH CORNER OF SAID OUTLOT 'D', SAID CORNER ALSO BEING A NORTH CORNER OF EAST 'O' STREET RIGHT OF WAY; THENCE SOUTH 85 DEGREES 06 MINUTES 05 SECONDS WEST, ALONG THE SOUTH LINE OF SAID OUTLOT 'D', SAID LINE ALSO BEING THE NORTH RIGHT OF WAY LINE OF EAST 'O' STREET, A DISTANCE OF 251.15 FEET TO A SOUTH CORNER OF SAID OUTLOT 'D', SAID CORNER ALSO BEING A NORTH CORNER OF EAST 'O' STREET RIGHT OF WAY; THENCE SOUTH 89 DEGREES 14 MINUTES 54 SECONDS WEST, ALONG THE SOUTH LINE OF SAID OUTLOT 'D', SAID LINE ALSO BEING THE NORTH RIGHT OF WAY LINE OF EAST 'O' STREET, A DISTANCE OF 300.08 FEET TO A SOUTH CORNER OF SAID OUTLOT 'D', SAID CORNER ALSO BEING A NORTH CORNER OF EAST 'O' STREET RIGHT OF WAY; THENCE NORTH 89 DEGREES 24 MINUTES 54 SECONDS WEST, ALONG THE SOUTH LINE OF SAID OUTLOT 'D', SAID LINE ALSO BEING THE NORTH RIGHT OF WAY LINE OF EAST 'O' STREET, A DISTANCE OF 145.00 FEET TO A SOUTH CORNER OF SAID OUTLOT 'D', SAID CORNER ALSO BEING A NORTH CORNER OF EAST 'O' STREET RIGHT OF WAY; THENCE SOUTH 00 DEGREES 35 MINUTES 26 SECONDS WEST, ALONG THE SOUTH LINE OF SAID OUTLOT 'D', SAID LINE ALSO BEING THE NORTH RIGHT OF WAY LINE OF EAST 'O' STREET, A DISTANCE OF 17.86 FEET TO A SOUTH CORNER OF SAID OUTLOT 'D', SAID CORNER ALSO BEING A NORTH CORNER OF EAST 'O' STREET RIGHT OF WAY; THENCE NORTH 89 DEGREES 24 MINUTES 34 SECONDS WEST, ALONG THE SOUTH LINE OF SAID OUTLOT 'D', SAID LINE ALSO BEING THE NORTH RIGHT OF WAY LINE OF EAST 'O' STREET, A DISTANCE OF 71.64 FEET TO A SOUTH CORNER OF SAID OUTLOT 'D', SAID CORNER ALSO BEING A NORTH CORNER OF EAST 'O' STREET RIGHT OF WAY; THENCE NORTH 00 DEGREES 50 MINUTES 30 SECONDS EAST, ALONG A WEST LINE OF SAID OUTLOT 'D', A DISTANCE OF 398.88 FEET TO A WEST CORNER OF SAID OUTLOT 'D'; THENCE NORTH 89 DEGREES 09 MINUTES 30 SECONDS WEST, ALONG A WEST LINE OF SAID OUTLOT 'D', A DISTANCE OF 69.91 FEET TO THE POINT OF CURVATURE OF A NON TANGENT CURVE; THENCE ALONG A CURVE TO THE LEFT HAVING A RADIUS OF 640.44 FEET, A DELTA ANGLE OF 41 DEGREES 08 MINUTES 48 SECONDS, AN ARC LENGTH OF 459.92 FEET, A CHORD BEARING OF NORTH 47 DEGREES 38 MINUTES 05 SECONDS WEST, ALONG A WEST LINE OF SAID OUTLOT 'D', AND A CHORD LENGTH OF 450.11 FEET TO A WEST CORNER OF SAID OUTLOT 'D'; THENCE NORTH 30 DEGREES 01 MINUTES 45 SECONDS WEST, ALONG A WEST LINE OF SAID OUTLOT 'D', A DISTANCE OF 71.22 FEET TO THE POINT OF CURVATURE OF A NON TANGENT CURVE; THENCE ALONG A CURVE TO THE LEFT HAVING A RADIUS OF 480.77 FEET, A DELTA ANGLE OF 34 DEGREES 09 MINUTES 30 SECONDS, AN ARC LENGTH OF 286.62 FEET, A CHORD BEARING OF NORTH 70 DEGREES 52 MINUTES 37 SECONDS WEST, ALONG A WEST LINE OF SAID OUTLOT 'D', AND A CHORD LENGTH OF 282.40 FEET TO A WEST CORNER OF SAID OUTLOT 'D'; THENCE NORTH 87 DEGREES 57 MINUTES 23 SECONDS WEST, ALONG A WEST LINE OF SAID OUTLOT 'D', A DISTANCE OF 262.74 FEET TO A WEST CORNER OF SAID OUTLOT 'D'; THENCE NORTH 43 DEGREES 29 MINUTES 54 SECONDS WEST, A DISTANCE OF 79.00 FEET TO A WEST CORNER OF SAID OUTLOT 'D'; THENCE NORTH 62 DEGREES 31 MINUTES 43 SECONDS WEST, ALONG A WEST LINE OF SAID OUTLOT 'D', A DISTANCE OF 61.30 FEET TO A WEST CORNER OF SAID OUTLOT 'D'; THENCE NORTH 19 DEGREES 43 MINUTES 36 SECONDS WEST, ALONG A WEST LINE OF SAID OUTLOT 'D', A DISTANCE OF 39.99 FEET TO A WEST CORNER OF SAID OUTLOT 'D'; THENCE NORTH 89 DEGREES 58 MINUTES 39 SECONDS WEST, ALONG A WEST LINE OF SAID OUTLOT 'D', A DISTANCE OF 44.33 FEET TO A WEST CORNER OF SAID OUTLOT 'D'; THENCE NORTH 00 DEGREES 01 MINUTES 21 SECONDS EAST, ALONG A WEST LINE OF SAID OUTLOT 'D', A DISTANCE OF 992.31 FEET TO A POINT; THENCE SOUTH 89 DEGREES 24 MINUTES 38 SECONDS EAST, A DISTANCE OF 729.79 FEET TO A POINT; THENCE SOUTH 00 DEGREES 00 MINUTES 53 SECONDS WEST, A DISTANCE OF 90.96 FEET TO A POINT; THENCE SOUTH 89 DEGREES 37 MINUTES 05 SECONDS EAST, A DISTANCE OF 547.18 FEET TO A POINT; THENCE SOUTH 87 DEGREES 19 MINUTES 39 SECONDS EAST, A DISTANCE OF 350.28 FEET TO A POINT; THENCE SOUTH 89 DEGREES 37 MINUTES 05 SECONDS EAST, A DISTANCE OF 264.49 FEET TO A WEST RIGHT OF WAY CORNER OF N. 98<sup>TH</sup> STREET; THENCE SOUTH 27 DEGREES 38 MINUTES 04 SECONDS EAST, ALONG AN EAST LINE OF SAID OUTLOT 'D', SAID LINE ALSO BEING A WEST RIGHT OF WAY LINE OF N. 98<sup>TH</sup> STREET, A DISTANCE OF 17.90 FEET TO AN EAST CORNER OF SAID OUTLOT 'D', SAID CORNER ALSO BEING A WEST RIGHT OF WAY CORNER OF N. 98<sup>TH</sup> STREET; THENCE SOUTH 10 DEGREES 37 MINUTES 15 SECONDS EAST, A DISTANCE OF 44.87 FEET TO THE POINT OF CURVATURE OF A NON TANGENT CURVE; THENCE ALONG A CURVE TO THE LEFT HAVING A RADIUS OF 1,560.00 FEET, A DELTA ANGLE OF 23 DEGREES 33 MINUTES 06 SECONDS, AN ARC LENGTH OF 641.24 FEET, A CHORD BEARING OF SOUTH 16 DEGREES 43 MINUTES 12 SECONDS EAST, ALONG AN EAST LINE OF SAID OUTLOT 'D', SAID LINE ALSO BEING A WEST RIGHT OF WAY LINE OF N. 98<sup>TH</sup> STREET, AND A CHORD LENGTH OF 636.74 FEET TO A POINT OF REVERSE CURVATURE; THENCE

ALONG A CURVE TO THE RIGHT HAVING A RADIUS OF 320.00 FEET, A DELTA ANGLE OF 08 DEGREES 16 MINUTES 09 SECONDS, AN ARC LENGTH OF 46.18 FEET, A CHORD BEARING OF SOUTH 24 DEGREES 21 MINUTES 40 SECONDS EAST, ALONG AN EAST LINE OF SAID OUTLOT 'D', SAID LINE ALSO BEING A WEST RIGHT OF WAY LINE OF N. 98<sup>TH</sup> STREET, AND A CHORD LENGTH OF 46.14 FEET TO A POINT OF REVERSE CURVATURE; THENCE ALONG A CURVE TO THE LEFT HAVING A RADIUS OF 318.00 FEET, A DELTA ANGLE OF 12 DEGREES 28 MINUTES 19 SECONDS, AN ARC LENGTH OF 69.22 FEET, A CHORD BEARING OF SOUTH 26 DEGREES 27 MINUTES 46 SECONDS EAST, ALONG AN EAST LINE OF SAID OUTLOT 'D', SAID LINE ALSO BEING A WEST RIGHT OF WAY LINE OF N. 98<sup>TH</sup> STREET, AND A CHORD LENGTH OF 69.09 FEET TO A POINT OF COMPOUND CURVATURE; THENCE ALONG A CURVE TO THE LEFT HAVING A RADIUS OF 1,570.00 FEET, A DELTA ANGLE OF 03 DEGREES 46 MINUTES 57 SECONDS, AN ARC LENGTH OF 103.64 FEET, A CHORD BEARING OF SOUTH 34 DEGREES 35 MINUTES 24 SECONDS EAST, ALONG AN EAST LINE OF SAID OUTLOT 'D', SAID LINE ALSO BEING A WEST RIGHT OF WAY LINE OF N. 98<sup>TH</sup> STREET, AND A CHORD LENGTH OF 103.63 FEET TO AN EAST CORNER OF SAID OUTLOT 'D', SAID CORNER ALSO BEING A WEST RIGHT OF WAY CORNER OF N. 98<sup>TH</sup> STREET; THENCE SOUTH 36 DEGREES 28 MINUTES 52 SECONDS EAST, ALONG AN EAST LINE OF SAID OUTLOT 'D', SAID LINE ALSO BEING A WEST RIGHT OF WAY LINE OF N. 98<sup>TH</sup> STREET, A DISTANCE OF 150.72 FEET TO AN EAST CORNER OF SAID OUTLOT 'D', SAID CORNER ALSO BEING A WEST RIGHT OF WAY CORNER OF N. 98<sup>TH</sup> STREET; THENCE SOUTH 11 DEGREES 16 MINUTES 18 SECONDS WEST, ALONG AN EAST LINE OF SAID OUTLOT 'D', SAID LINE ALSO BEING A WEST RIGHT OF WAY LINE OF N. 98<sup>TH</sup> STREET, A DISTANCE OF 15.00 FEET TO AN EAST CORNER OF SAID OUTLOT 'D', SAID CORNER ALSO BEING A WEST RIGHT OF WAY CORNER OF N. 98<sup>TH</sup> STREET; THENCE SOUTH 61 DEGREES 35 MINUTES 01 SECONDS WEST, ALONG AN EAST LINE OF SAID OUTLOT 'D', SAID LINE ALSO BEING A WEST RIGHT OF WAY LINE OF N. 98<sup>TH</sup> STREET, A DISTANCE OF 42.31 FEET TO THE POINT OF CURVATURE OF A NON TANGENT CURVE; THENCE ALONG A CURVE TO THE RIGHT HAVING A RADIUS OF 451.00 FEET, A DELTA ANGLE OF 01 DEGREES 01 MINUTES 52 SECONDS, AN ARC LENGTH OF 8.12 FEET, A CHORD BEARING OF SOUTH 73 DEGREES 10 MINUTES 37 SECONDS WEST, ALONG AN EAST LINE OF SAID OUTLOT 'D', SAID LINE ALSO BEING A WEST RIGHT OF WAY LINE OF N. 98<sup>TH</sup> STREET, AND A CHORD LENGTH OF 8.12 FEET TO AN EAST CORNER OF SAID OUTLOT 'D', SAID CORNER ALSO BEING A WEST RIGHT OF WAY CORNER OF N. 98<sup>TH</sup> STREET; THENCE SOUTH 16 DEGREES 18 MINUTES 27 SECONDS EAST, ALONG AN EAST LINE OF SAID OUTLOT 'D', SAID LINE ALSO BEING A WEST RIGHT OF WAY LINE OF N. 98<sup>TH</sup> STREET, A DISTANCE OF 98.00 FEET TO THE POINT OF CURVATURE OF A NON TANGENT CURVE; THENCE ALONG A CURVE TO THE LEFT HAVING A RADIUS OF 549.00 FEET, A DELTA ANGLE OF 08 DEGREES 21 MINUTES 54 SECONDS, AN ARC LENGTH OF 80.15 FEET, A CHORD BEARING OF NORTH 69 DEGREES 30 MINUTES 36 SECONDS EAST, ALONG AN EAST LINE OF SAID OUTLOT 'D', SAID LINE ALSO BEING A WEST RIGHT OF WAY LINE OF N. 98<sup>TH</sup> STREET, AND A CHORD LENGTH OF 80.08 FEET TO AN EAST CORNER OF SAID OUTLOT 'D', SAID CORNER ALSO BEING A WEST RIGHT OF WAY CORNER OF N. 98<sup>TH</sup> STREET; THENCE SOUTH 65 DEGREES 03 MINUTES 00 SECONDS EAST, ALONG AN EAST LINE OF SAID OUTLOT 'D', SAID LINE ALSO BEING A WEST RIGHT OF WAY LINE OF N. 98<sup>TH</sup> STREET, A DISTANCE OF 27.37 FEET TO AN EAST CORNER OF SAID OUTLOT 'D', SAID CORNER ALSO BEING A WEST RIGHT OF WAY CORNER OF N. 98<sup>TH</sup> STREET; THENCE SOUTH 38 DEGREES 34 MINUTES 11 SECONDS EAST, ALONG AN EAST LINE OF SAID OUTLOT 'D', SAID LINE ALSO BEING A WEST RIGHT OF WAY LINE OF N. 98<sup>TH</sup> STREET, A DISTANCE OF 41.11 FEET TO THE POINT OF CURVATURE OF A NON TANGENT CURVE; THENCE ALONG A CURVE TO THE RIGHT HAVING A RADIUS OF 1,434.00 FEET, A DELTA ANGLE OF 11 DEGREES 33 MINUTES 31 SECONDS, AN ARC LENGTH OF 289.29 FEET, A CHORD BEARING OF SOUTH 25 DEGREES 05 MINUTES 29 SECONDS EAST, ALONG AN EAST LINE OF SAID OUTLOT 'D', SAID LINE ALSO BEING A WEST RIGHT OF WAY LINE OF N. 98<sup>TH</sup> STREET, AND A CHORD LENGTH OF 288.80 FEET TO A POINT OF COMPOUND CURVATURE; THENCE ALONG A CURVE TO THE RIGHT HAVING A RADIUS OF 327.00 FEET, A DELTA ANGLE OF 16 DEGREES 04 MINUTES 15 SECONDS, AN ARC LENGTH OF 91.72 FEET, A CHORD BEARING OF SOUTH 11 DEGREES 16 MINUTES 35 SECONDS EAST, ALONG AN EAST LINE OF SAID OUTLOT 'D', SAID LINE ALSO BEING A WEST RIGHT OF WAY LINE OF N. 98<sup>TH</sup> STREET, AND A CHORD LENGTH OF 91.42 FEET TO A POINT OF REVERSE CURVATURE; THENCE ALONG A CURVE TO THE LEFT HAVING A RADIUS OF 318.00 FEET, A DELTA ANGLE OF 10 DEGREES 10 MINUTES 03 SECONDS, AN ARC LENGTH OF 56.43 FEET, A CHORD BEARING OF SOUTH 08 DEGREES 19 MINUTES 29 SECONDS EAST, ALONG AN EAST LINE OF SAID OUTLOT 'D', SAID LINE ALSO BEING A WEST RIGHT OF WAY LINE OF N. 98<sup>TH</sup> STREET, AND A CHORD LENGTH OF 56.36 FEET TO A POINT OF REVERSE CURVEATURE; THENCE ALONG A CURVE TO THE RIGHT HAVING A RADIUS OF 1,418.00 FEET, A DELTA ANGLE OF 12 DEGREES 33 MINUTES 00 SECONDS, AN ARC LENGTH OF 310.60 FEET, A CHORD BEARING OF SOUTH 07 DEGREES 08 MINUTES 00 SECONDS EAST, ALONG AN EAST LINE OF SAID OUTLOT 'D', SAID LINE ALSO BEING A WEST RIGHT OF WAY LINE OF N. 98<sup>TH</sup> STREET, AND A CHORD LENGTH OF 309.98 FEET TO THE POINT OF BEGINNING, EXCEPT FOR THAT PORTION OF OUTLOT 'D', WATERFORD ESTATES ADDITION, THAT IS DESCRIBED AS "LAKE (PARCEL C)" ON EXHIBIT "C" BELOW, FOR A TOTAL AREA OF 3,041,972.96 SQUARE FEET OR 69.84 ACRES MORE OR LESS.

**EXHIBIT "C"**

**LAKE ASSOCIATION PROPERTY  
LEGAL DESCRIPTION**

**LAKE (PARCEL A)**

OUTLOT "B", WATERFORD ESTATES 1<sup>ST</sup> ADDITION, LINCOLN, LANCASTER COUNTY, NEBRASKA.

**LAKE (PARCEL B)**

PORTIONS OF OUTLOT 'G', WATERFORD ESTATES 1<sup>ST</sup> ADDITION, LOCATED IN THE SOUTHWEST QUARTER OF SECTION 24, TOWNSHIP 10, RANGE 7 EAST OF THE 6TH P.M., CITY OF LINCOLN, LANCASTER COUNTY, NEBRASKA, MORE PARTICULARLY DESCRIBED AS FOLLOWS:

COMMENCING AT THE SOUTHEAST CORNER OF SAID SOUTHWEST QUARTER; THENCE NORTH ALONG THE EAST LINE OF SAID OUTLOT 'G' AND ALONG THE EAST LINE OF SAID SOUTHWEST QUARTER ON AN ASSUMED BEARING OF NORTH 00 DEGREES 10 MINUTES 10 SECONDS EAST A DISTANCE OF 562.31 FEET TO A POINT; THENCE NORTH 89 DEGREES 49 MINUTES 50 SECONDS WEST A DISTANCE OF 554.99 FEET TO THE POINT OF BEGINNING; THENCE NORTH 89 DEGREES 25 MINUTES 52 SECONDS WEST, A DISTANCE OF 12.68 FEET TO A POINT; THENCE NORTH 06 DEGREES 08 MINUTES 18 SECONDS WEST, A DISTANCE OF 41.58 FEET TO A POINT OF NON-TANGENT CURVATURE; THENCE ALONG A CURVE IN A COUNTER CLOCKWISE DIRECTION, HAVING A RADIUS OF 40.00 FEET, A DELTA ANGLE OF 45 DEGREES 05 MINUTES 40 SECONDS, AN ARC LENGTH OF 31.48 FEET, A CHORD BEARING OF NORTH 32 DEGREES 51 MINUTES 08 SECONDS WEST, AND A CHORD LENGTH OF 30.68 FEET TO A POINT; THENCE NORTH 59 DEGREES 43 MINUTES 17 SECONDS WEST, A DISTANCE OF 57.85 FEET TO A POINT; THENCE NORTH 00 DEGREES 30 MINUTES 23 SECONDS WEST, A DISTANCE OF 77.85 FEET TO A POINT; THENCE NORTH 06 DEGREES 19 MINUTES 35 SECONDS WEST, A DISTANCE OF 58.39 FEET TO A POINT; THENCE NORTH 00 DEGREES 06 MINUTES 09 SECONDS WEST, A DISTANCE OF 68.04 FEET TO A POINT; THENCE NORTH 76 DEGREES 54 MINUTES 05 SECONDS EAST, A DISTANCE OF 41.52 FEET TO A POINT; THENCE SOUTH 32 DEGREES 34 MINUTES 19 SECONDS EAST, A DISTANCE OF 70.33 FEET TO A POINT OF NON-TANGENT CURVATURE; THENCE ALONG A CURVE IN A CLOCKWISE DIRECTION, HAVING A RADIUS OF 50.00 FEET, A DELTA ANGLE OF 30 DEGREES 17 MINUTES 43 SECONDS, AN ARC LENGTH OF 26.44 FEET, A CHORD BEARING OF SOUTH 16 DEGREES 35 MINUTES 47 SECONDS EAST, AND A CHORD LENGTH OF 26.13 FEET TO A POINT; THENCE SOUTH 03 DEGREES 48 MINUTES 09 SECONDS EAST, A DISTANCE OF 99.97 FEET TO A POINT; THENCE SOUTH 00 DEGREES 39 MINUTES 08 SECONDS WEST, A DISTANCE OF 125.68 FEET TO THE POINT OF BEGINNING, SAID TRACT CONTAINS A CALCULATED AREA OF 19,239.70 SQUARE FEET OR 0.44 ACRES, MORE OR LESS; AND

COMMENCING AT THE SOUTHEAST CORNER OF SAID SOUTHWEST QUARTER; THENCE NORTH ALONG THE EAST LINE OF SAID OUTLOT 'G' AND ALONG THE EAST LINE OF SAID SOUTHWEST QUARTER ON AN ASSUMED BEARING OF NORTH 00 DEGREES 10 MINUTES 10 SECONDS EAST A DISTANCE OF 1098.82 FEET TO A POINT; THENCE NORTH 89 DEGREES 49 MINUTES 50 SECONDS WEST A DISTANCE OF 478.00 FEET TO THE POINT OF BEGINNING; THENCE SOUTH 56 DEGREES 03 MINUTES 04 SECONDS WEST, A DISTANCE OF 137.66 FEET TO A POINT; THENCE SOUTH 61 DEGREES 27 MINUTES 20 SECONDS WEST, A DISTANCE OF 36.17 FEET TO A POINT; THENCE SOUTH 73 DEGREES 53 MINUTES 37 SECONDS WEST, A DISTANCE OF 22.50 FEET TO A POINT; THENCE NORTH 58 DEGREES 21 MINUTES 04 SECONDS WEST, A DISTANCE OF 10.04 FEET TO A POINT; THENCE NORTH 07 DEGREES 47 MINUTES 14 SECONDS WEST, A DISTANCE OF 64.62 FEET TO A POINT; THENCE NORTH 00 DEGREES 24 MINUTES 43 SECONDS WEST, A DISTANCE OF 95.10 FEET TO A POINT; THENCE NORTH 06 DEGREES 54 MINUTES 53 SECONDS WEST, A DISTANCE OF 32.08 FEET TO A POINT; THENCE NORTH 12 DEGREES 36 MINUTES 13 SECONDS WEST, A DISTANCE OF 222.14 FEET TO A POINT; THENCE NORTH 16 DEGREES 36 MINUTES 20 SECONDS WEST, A DISTANCE OF 85.14 FEET TO A POINT; THENCE NORTH 12 DEGREES 14 MINUTES 17 SECONDS WEST, A DISTANCE OF 122.03 FEET TO A POINT; THENCE NORTH 28 DEGREES 12 MINUTES 37 SECONDS EAST, A DISTANCE OF 27.20 FEET TO A POINT; THENCE NORTH 77 DEGREES 17 MINUTES 14 SECONDS EAST, A DISTANCE OF 162.95 FEET TO A POINT; THENCE SOUTH 49 DEGREES 18 MINUTES 51 SECONDS WEST, A DISTANCE OF 26.38 FEET TO A POINT; THENCE SOUTH 22 DEGREES 00 MINUTES 50 SECONDS WEST, A DISTANCE OF 62.09 FEET TO A POINT; THENCE SOUTH 08 DEGREES 09 MINUTES 36 SECONDS WEST, A DISTANCE OF 39.51 FEET TO A POINT; THENCE SOUTH 03 DEGREES 08 MINUTES 32 SECONDS EAST, A DISTANCE OF 39.01 FEET TO A POINT; THENCE SOUTH 16 DEGREES 14 MINUTES 12 SECONDS EAST, A DISTANCE OF 34.89 FEET TO A POINT; THENCE SOUTH 32 DEGREES 43 MINUTES 36 SECONDS EAST, A DISTANCE OF 63.93 FEET TO A POINT OF NON-TANGENT CURVATURE; THENCE ALONG A CURVE IN A CLOCKWISE DIRECTION, HAVING A RADIUS OF 74.60 FEET, A DELTA ANGLE OF 32 DEGREES 43 MINUTES 09 SECONDS, AN ARC LENGTH OF 42.60 FEET, A CHORD BEARING OF SOUTH 18 DEGREES 25 MINUTES 30 SECONDS EAST, AND A CHORD LENGTH OF 42.02 FEET TO A POINT; THENCE SOUTH 00 DEGREES 18 MINUTES 55 SECONDS WEST, A DISTANCE OF 83.11 FEET TO A POINT; THENCE SOUTH 09 DEGREES 06 MINUTES 58 SECONDS EAST, A DISTANCE OF 44.53 FEET TO A POINT; THENCE SOUTH 24 DEGREES 18 MINUTES 03 SECONDS EAST, A DISTANCE OF 60.99 FEET TO A POINT; THENCE SOUTH 33 DEGREES 40 MINUTES 22 SECONDS EAST, A DISTANCE OF 132.98 FEET TO THE POINT OF BEGINNING, SAID TRACT CONTAINS A CALCULATED AREA OF 79,159.98 SQUARE FEET OR 1.82 ACRES, MORE OR LESS.

**LAKE (PARCEL C)**

A PORTION OF OUTLOT 'D', WATERFORD ESTATES ADDITION, LOCATED IN THE SOUTHEAST QUARTER OF SECTION 23, TOWNSHIP 10, RANGE 7 EAST OF THE 6TH P.M., CITY OF LINCOLN, LANCASTER COUNTY, NEBRASKA, AND MORE

PARTICULARLY DESCRIBED AS FOLLOWS:

COMMENCING AT THE SOUTHEAST CORNER OF SAID SOUTHEAST QUARTER, THENCE WEST ALONG THE SOUTH LINE OF SAID SOUTHEAST QUARTER ON AN ASSUMED BEARING OF NORTH 89 DEGREES 24 MINUTES 34 SECONDS WEST, A DISTANCE OF 672.22 FEET TO A POINT; THENCE NORTH 00 DEGREES 35 MINUTES 26 SECONDS EAST, A DISTANCE OF 150.69 FEET TO THE POINT OF BEGINNING; THENCE SOUTH 73 DEGREES 23 MINUTES 39 SECONDS WEST, A DISTANCE OF 39.27 FEET TO A POINT; THENCE SOUTH 85 DEGREES 06 MINUTES 05 SECONDS WEST, A DISTANCE OF 253.05 FEET TO A POINT; THENCE SOUTH 89 DEGREES 14 MINUTES 54 SECONDS WEST, A DISTANCE OF 298.65 FEET TO A POINT; THENCE NORTH 89 DEGREES 24 MINUTES 34 SECONDS WEST, A DISTANCE OF 57.69 FEET TO A POINT; THENCE NORTH 48 DEGREES 14 MINUTES 08 SECONDS WEST, A DISTANCE OF 29.27 FEET TO A POINT; THENCE NORTH 00 DEGREES 01 MINUTES 13 SECONDS EAST, A DISTANCE OF 11.74 FEET TO A POINT; THENCE NORTH 11 DEGREES 18 MINUTES 39 SECONDS WEST, A DISTANCE OF 30.54 FEET TO A POINT; THENCE NORTH 30 DEGREES 02 MINUTES 54 SECONDS WEST, A DISTANCE OF 11.98 FEET TO A POINT; THENCE NORTH 31 DEGREES 31 MINUTES 28 SECONDS EAST, A DISTANCE OF 48.75 FEET TO A POINT; THENCE NORTH 82 DEGREES 18 MINUTES 08 SECONDS EAST, A DISTANCE OF 64.23 FEET TO A POINT; THENCE SOUTH 87 DEGREES 59 MINUTES 09 SECONDS EAST, A DISTANCE OF 60.07 FEET TO A POINT; THENCE NORTH 65 DEGREES 17 MINUTES 13 SECONDS EAST, A DISTANCE OF 23.50 FEET TO A POINT; THENCE NORTH 53 DEGREES 09 MINUTES 29 SECONDS EAST, A DISTANCE OF 33.50 FEET TO A POINT; THENCE NORTH 50 DEGREES 40 MINUTES 53 SECONDS EAST, A DISTANCE OF 33.87 FEET TO A POINT; THENCE NORTH 26 DEGREES 25 MINUTES 28 SECONDS EAST, A DISTANCE OF 5.02 FEET TO A POINT; THENCE NORTH 58 DEGREES 13 MINUTES 15 SECONDS EAST, A DISTANCE OF 24.50 FEET TO A POINT; THENCE SOUTH 85 DEGREES 46 MINUTES 05 SECONDS EAST, A DISTANCE OF 4.08 FEET TO A POINT; THENCE SOUTH 80 DEGREES 40 MINUTES 27 SECONDS EAST, A DISTANCE OF 40.16 FEET TO A POINT; THENCE NORTH 76 DEGREES 31 MINUTES 03 SECONDS EAST, A DISTANCE OF 20.49 FEET TO A POINT; THENCE NORTH 52 DEGREES 09 MINUTES 12 SECONDS EAST, A DISTANCE OF 16.72 FEET TO A POINT; THENCE NORTH 43 DEGREES 42 MINUTES 33 SECONDS EAST, A DISTANCE OF 24.86 FEET TO A POINT; THENCE NORTH 51 DEGREES 10 MINUTES 42 SECONDS EAST, A DISTANCE OF 46.16 FEET TO A POINT; THENCE NORTH 43 DEGREES 42 MINUTES 33 SECONDS EAST, A DISTANCE OF 14.53 FEET TO A POINT; THENCE NORTH 01 DEGREES 57 MINUTES 20 SECONDS EAST, A DISTANCE OF 25.47 FEET TO A POINT; THENCE NORTH 36 DEGREES 55 MINUTES 24 SECONDS WEST, A DISTANCE OF 21.88 FEET TO A POINT; THENCE NORTH 52 DEGREES 06 MINUTES 43 SECONDS WEST, A DISTANCE OF 66.11 FEET TO A POINT; THENCE NORTH 39 DEGREES 43 MINUTES 23 SECONDS WEST, A DISTANCE OF 20.79 FEET TO A POINT; THENCE NORTH 72 DEGREES 31 MINUTES 58 SECONDS WEST, A DISTANCE OF 23.92 FEET TO A POINT; THENCE SOUTH 85 DEGREES 16 MINUTES 09 SECONDS WEST, A DISTANCE OF 20.99 FEET TO A POINT; THENCE NORTH 86 DEGREES 21 MINUTES 45 SECONDS WEST, A DISTANCE OF 48.47 FEET TO A POINT; THENCE NORTH 81 DEGREES 23 MINUTES 35 SECONDS WEST, A DISTANCE OF 35.15 FEET TO A POINT; THENCE SOUTH 79 DEGREES 48 MINUTES 22 SECONDS WEST, A DISTANCE OF 29.73 FEET TO A POINT; THENCE SOUTH 59 DEGREES 53 MINUTES 02 SECONDS WEST, A DISTANCE OF 21.63 FEET TO A POINT; THENCE SOUTH 46 DEGREES 10 MINUTES 30 SECONDS WEST, A DISTANCE OF 32.43 FEET TO A POINT; THENCE SOUTH 73 DEGREES 09 MINUTES 29 SECONDS WEST, A DISTANCE OF 62.36 FEET TO A POINT; THENCE SOUTH 82 DEGREES 00 MINUTES 55 SECONDS WEST, A DISTANCE OF 42.88 FEET TO A POINT; THENCE NORTH 50 DEGREES 27 MINUTES 17 SECONDS WEST, A DISTANCE OF 53.70 FEET TO A POINT; THENCE NORTH 24 DEGREES 02 MINUTES 08 SECONDS WEST, A DISTANCE OF 29.43 FEET TO A POINT; THENCE NORTH 36 DEGREES 53 MINUTES 31 SECONDS EAST, A DISTANCE OF 43.81 FEET TO A POINT; THENCE NORTH 81 DEGREES 39 MINUTES 52 SECONDS EAST, A DISTANCE OF 45.43 FEET TO A POINT; THENCE NORTH 71 DEGREES 00 MINUTES 07 SECONDS EAST, A DISTANCE OF 39.97 FEET TO A POINT; THENCE NORTH 34 DEGREES 23 MINUTES 29 SECONDS EAST, A DISTANCE OF 20.87 FEET TO A POINT; THENCE NORTH 46 DEGREES 41 MINUTES 51 SECONDS EAST, A DISTANCE OF 31.44 FEET TO A POINT; THENCE NORTH 69 DEGREES 09 MINUTES 54 SECONDS EAST, A DISTANCE OF 14.55 FEET TO A POINT; THENCE NORTH 86 DEGREES 07 MINUTES 03 SECONDS EAST, A DISTANCE OF 29.86 FEET TO A POINT; THENCE SOUTH 78 DEGREES 19 MINUTES 46 SECONDS EAST, A DISTANCE OF 28.74 FEET TO A POINT; THENCE SOUTH 78 DEGREES 38 MINUTES 49 SECONDS EAST, A DISTANCE OF 29.37 FEET TO A POINT; THENCE NORTH 89 DEGREES 35 MINUTES 09 SECONDS EAST, A DISTANCE OF 23.23 FEET TO A POINT; THENCE NORTH 79 DEGREES 18 MINUTES 20 SECONDS EAST, A DISTANCE OF 40.05 FEET TO A POINT; THENCE NORTH 70 DEGREES 41 MINUTES 20 SECONDS EAST, A DISTANCE OF 28.73 FEET TO A POINT; THENCE NORTH 65 DEGREES 50 MINUTES 15 SECONDS EAST, A DISTANCE OF 60.65 FEET TO A POINT; THENCE NORTH 60 DEGREES 09 MINUTES 37 SECONDS EAST, A DISTANCE OF 29.41 FEET TO A POINT; THENCE NORTH 54 DEGREES 39 MINUTES 54 SECONDS EAST, A DISTANCE OF 53.19 FEET TO A POINT; THENCE NORTH 46 DEGREES 32 MINUTES 07 SECONDS EAST, A DISTANCE OF 53.32 FEET TO A POINT; THENCE NORTH 33 DEGREES 56 MINUTES 42 SECONDS EAST, A DISTANCE OF 86.91 FEET TO A POINT; THENCE NORTH 44 DEGREES 29 MINUTES 33 SECONDS EAST, A DISTANCE OF 73.16 FEET TO A POINT; THENCE SOUTH 82 DEGREES 03 MINUTES 37 SECONDS EAST, A DISTANCE OF 156.03 FEET TO A POINT; THENCE SOUTH 77 DEGREES 34 MINUTES 07 SECONDS EAST, A DISTANCE OF 48.75 FEET TO A POINT; THENCE SOUTH 84 DEGREES 17 MINUTES 41 SECONDS EAST, A DISTANCE OF 12.08 FEET TO A POINT; THENCE SOUTH 57 DEGREES 45 MINUTES 51 SECONDS EAST, A DISTANCE OF 55.74 FEET TO A POINT; THENCE SOUTH 35 DEGREES 14 MINUTES 42 SECONDS EAST, A DISTANCE OF 13.69 FEET TO A POINT; THENCE SOUTH 28 DEGREES 38 MINUTES 06 SECONDS EAST, A DISTANCE OF 32.97 FEET TO A POINT; THENCE SOUTH 05 DEGREES 42 MINUTES 59 SECONDS EAST, A DISTANCE OF 13.22 FEET TO A POINT; THENCE SOUTH 12 DEGREES 37 MINUTES 51 SECONDS WEST, A DISTANCE OF 29.54 FEET TO A POINT; THENCE SOUTH 02 DEGREES 08 MINUTES 07 SECONDS WEST, A DISTANCE OF 58.78 FEET TO A POINT; THENCE SOUTH 07 DEGREES 55 MINUTES 32 SECONDS EAST, A DISTANCE OF 67.85 FEET TO A POINT; THENCE SOUTH 00 DEGREES 22 MINUTES 38 SECONDS WEST, A DISTANCE OF 26.62 FEET TO A POINT; THENCE SOUTH 05 DEGREES 57 MINUTES 13 SECONDS EAST, A DISTANCE OF 17.00 FEET TO A POINT; THENCE SOUTH 21 DEGREES 12 MINUTES 15 SECONDS WEST, A DISTANCE OF 210.31 FEET TO A POINT; THENCE SOUTH 40 DEGREES 05 MINUTES 57 SECONDS WEST, A DISTANCE OF 30.29 FEET TO A POINT; THENCE SOUTH 25 DEGREES 54 MINUTES 33 SECONDS WEST, A DISTANCE OF 148.06 FEET TO THE POINT OF BEGINNING. SAID TRACT CONTAINS A CALCULATED AREA OF 366,002.50 SQUARE FEET OR 8.40 ACRES, MORE OR LESS.

#### LAKE (PARCEL D)

A PORTION OF OUTLOT 'D', WATERFORD ESTATES ADDITION, LOCATED IN THE NORTHEAST QUARTER OF SECTION 23, TOWNSHIP 10, RANGE 7 EAST OF THE 6TH P.M., CITY OF LINCOLN, LANCASTER COUNTY, NEBRASKA, AND MORE PARTICULARLY DESCRIBED AS FOLLOWS:

COMMENCING AT A NORTHWEST CORNER OF SAID OUTLOT 'D', SAID CORNER ALSO BEING THE SOUTHEAST RIGHT OF WAY CORNER OF SUNNY SLOPE ROAD, THENCE NORTH ALONG A WEST LINE OF SAID OUTLOT 'D' ON AN ASSUMED BEARING OF NORTH 00 DEGREES 12 MINUTES 42 SECONDS EAST, A DISTANCE OF 504.87 FEET TO THE POINT OF BEGINNING; THENCE CONTINUING NORTH 00 DEGREES 12 MINUTES 42 SECONDS EAST, A DISTANCE OF 621.82 FEET TO A POINT; THENCE SOUTH 09 DEGREES 26 MINUTES 21 SECONDS EAST, A DISTANCE OF 30.10 FEET TO A POINT; THENCE SOUTH 25 DEGREES 39 MINUTES 05 SECONDS EAST, A DISTANCE OF 68.77 FEET TO A POINT; THENCE SOUTH 47 DEGREES 40 MINUTES 33 SECONDS EAST, A DISTANCE OF 68.77 FEET TO A POINT; THENCE SOUTH 69 DEGREES 42 MINUTES 00 SECONDS EAST, A DISTANCE OF 68.77 FEET TO A POINT; THENCE NORTH 88 DEGREES 16 MINUTES 32 SECONDS EAST, A DISTANCE OF 68.77 FEET TO A POINT; THENCE NORTH 68 DEGREES 43 MINUTES 04 SECONDS EAST, A DISTANCE OF 64.02 FEET TO A POINT; THENCE NORTH 90 DEGREES 00 MINUTES 00 SECONDS EAST, A DISTANCE OF 312.22 FEET TO A POINT; THENCE NORTH 83 DEGREES 57 MINUTES 39 SECONDS EAST, A DISTANCE OF 63.12 FEET TO A POINT; THENCE NORTH 70 DEGREES 15 MINUTES 59 SECONDS EAST, A DISTANCE OF 79.93 FEET TO A POINT; THENCE NORTH 54 DEGREES 57 MINUTES 21 SECONDS EAST, A DISTANCE OF 79.94 FEET TO A POINT ON THE SOUTH RIGHT OF WAY LINE OF NORTH 98<sup>TH</sup> STREET; THENCE SOUTH 58 DEGREES 38 MINUTES 19 SECONDS EAST, ALONG THE SOUTH RIGHT OF WAY LINE OF NORTH 98<sup>TH</sup> STREET, A DISTANCE OF 7.01 FEET TO A WESTERLY CORNER OF NORTH 98<sup>TH</sup> STREET; THENCE SOUTH 07 DEGREES 05 MINUTES 18 SECONDS WEST, ALONG A WESTERLY RIGHT OF WAY LINE OF NORTH 98<sup>TH</sup> STREET, A DISTANCE OF 19.99 FEET TO THE POINT OF CURVATURE OF A NON TANGENT CURVE; THENCE ALONG A CURVE TO THE LEFT, HAVING A RADIUS OF 1560.00 FEET, AN ARC LENGTH OF 340.03 FEET, A DELTA ANGLE OF 12 DEGREES 29 MINUTES 20 SECONDS, A CHORD BEARING OF SOUTH 23 DEGREES 14 MINUTES 07 SECONDS WEST, ALONG THE WEST RIGHT OF WAY LINE OF NORTH 98<sup>TH</sup> STREET, AND A CHORD LENGTH OF 339.36 FEET TO A POINT; THENCE NORTH 78 DEGREES 32 MINUTES 03 SECONDS WEST, A DISTANCE OF 178.36 FEET TO A POINT; THENCE NORTH 83 DEGREES 32 MINUTES 03 SECONDS WEST, A DISTANCE OF 164.47 FEET TO A POINT; THENCE NORTH 84 DEGREES 41 MINUTES 17 SECONDS WEST, A DISTANCE OF 11.88 FEET TO A POINT; THENCE SOUTH 85 DEGREES 02 MINUTES 51 SECONDS WEST, A DISTANCE OF 93.42 FEET TO A POINT; THENCE SOUTH 66 DEGREES 49 MINUTES 38 SECONDS WEST, A DISTANCE OF 93.42 FEET TO A POINT; THENCE SOUTH 48 DEGREES 36 MINUTES 25 SECONDS WEST, A DISTANCE OF 93.42 FEET TO A POINT; THENCE SOUTH 30 DEGREES 23 MINUTES 12 SECONDS WEST, A DISTANCE OF 93.42 FEET TO A POINT; THENCE SOUTH 11 DEGREES 38 MINUTES 47 SECONDS WEST, A DISTANCE OF 99.43 FEET TO THE POINT OF BEGINNING. SAID TRACT CONTAINS A CALCULATED AREA OF 178,894.05 SQUARE FEET OR 4.11 ACRES, MORE OR LESS.

#### LAKE (PARCEL E)

A PORTION OF OUTLOT 'E', WATERFORD ESTATES ADDITION, LOCATED IN THE NORTHEAST QUARTER, OF SECTION 23, TOWNSHIP 10, RANGE 7 EAST OF THE 6TH P.M., CITY OF LINCOLN, LANCASTER COUNTY, NEBRASKA, AND MORE PARTICULARLY DESCRIBED AS FOLLOWS:

BEGINNING AT THE SOUTHWEST CORNER OF SAID OUTLOT 'E', SAID POINT BEING THE NORTHWEST CORNER OF OUTLOT 'A', WATERFORD ESTATES ADDITION, SAID POINT BEING THE BEGINNING OF A CURVE TO THE RIGHT, HAVING A RADIUS OF 1440.00 FEET, A DELTA OF 10 DEGREES 07 MINUTES 31 SECONDS, AN ARC LENGTH OF 254.48 FEET, A CHORD BEARING OF NORTH 12 DEGREES 02 MINUTES 10 SECONDS EAST, ALONG THE WEST LINE OF SAID OUTLOT 'E' SAID LINE BEING THE EAST RIGHT OF WAY LINE OF NORTH 98<sup>TH</sup> STREET, AND A CHORD LENGTH OF 254.15 FEET TO A POINT OF COMPOUND CURVATURE; THENCE ALONG A CURVE TO THE RIGHT HAVING A RADIUS OF 320.00 FEET, A DELTA ANGLE OF 12 DEGREES 43 MINUTES 03 SECONDS, AN ARC LENGTH OF 71.03 FEET, A CHORD BEARING OF NORTH 23 DEGREES 27 MINUTES 27 SECONDS EAST, ALONG THE WEST LINE OF SAID OUTLOT 'E' SAID LINE BEING THE EAST RIGHT OF WAY LINE OF NORTH 98<sup>TH</sup> STREET, AND A CHORD LENGTH OF 70.88 FEET TO A POINT OF REVERSE CURVE; THENCE ALONG A CURVE TO THE LEFT HAVING A RADIUS OF 318.00 FEET, A DELTA ANGLE OF 08 DEGREES 06 MINUTES 32 SECONDS, AN ARC LENGTH OF 45.01 FEET, A CHORD BEARING OF NORTH 25 DEGREES 45 MINUTES 43 SECONDS EAST, ALONG THE WEST LINE OF SAID OUTLOT 'E' SAID LINE BEING THE EAST RIGHT OF WAY LINE OF NORTH 98<sup>TH</sup> STREET, AND A CHORD LENGTH OF 44.97 FEET TO A POINT OF REVERSE CURVATURE; THENCE ALONG A CURVE TO THE RIGHT HAVING A RADIUS OF 1,430.00 FEET, A DELTA ANGLE OF 03 DEGREES 07 MINUTES 21 SECONDS, AN ARC LENGTH OF 77.94 FEET, A CHORD BEARING OF NORTH 23 DEGREES 16 MINUTES 08 SECONDS EAST, ALONG THE WEST LINE OF SAID OUTLOT 'E' SAID LINE BEING THE EAST RIGHT OF WAY LINE OF NORTH 98<sup>TH</sup> STREET, AND A CHORD LENGTH OF 77.93 FEET TO A POINT; THENCE SOUTH 58 DEGREES 23 MINUTES 56 SECONDS EAST, A DISTANCE OF 107.73 FEET TO A POINT; THENCE SOUTH 51 DEGREES 49 MINUTES 08 SECONDS EAST, A DISTANCE OF 73.69 FEET TO A POINT; THENCE SOUTH 51 DEGREES 29 MINUTES 07 SECONDS EAST, A DISTANCE OF 221.04 FEET TO A POINT; THENCE SOUTH 38 DEGREES 30 MINUTES 53 SECONDS WEST, A DISTANCE OF 70.00 FEET TO A POINT; THENCE SOUTH 51 DEGREES 29 MINUTES 07 SECONDS EAST, A DISTANCE OF 120.00 FEET TO A POINT ON THE WEST RIGHT OF WAY LINE OF EXTENDED NORTH 100<sup>TH</sup> STREET; THENCE SOUTH 38 DEGREES 30 MINUTES 53 SECONDS WEST, ALONG THE WEST RIGHT OF WAY LINE OF NORTH 100<sup>TH</sup> STREET, AND ITS EXTENSION A DISTANCE OF 122.16 FEET TO A POINT OF CURVATURE; THENCE ALONG A CURVE TO THE LEFT HAVING A RADIUS OF 460.00 FEET, A DELTA ANGLE OF 01 DEGREES 40 MINUTES 08 SECONDS, AN ARC LENGTH OF 13.40 FEET, A CHORD BEARING OF SOUTH 37 DEGREES 40 MINUTES 49 SECONDS WEST, ALONG THE EAST LINE OF SAID OUTLOT 'E', SAID LINE BEING THE WEST RIGHT OF WAY LINE OF NORTH 100<sup>TH</sup> STREET, AND A CHORD LENGTH OF 13.40 FEET TO A POINT; THENCE NORTH 53 DEGREES 09 MINUTES 14 SECONDS WEST, A DISTANCE OF 78.84 FEET TO A POINT; THENCE NORTH 89 DEGREES 37 MINUTES 05 SECONDS WEST, A DISTANCE OF 357.13 FEET TO THE POINT OF BEGINNING. SAID TRACT CONTAINS A CALCULATED AREA OF 138,368.00 SQUARE FEET OR 3.18 ACRES, MORE OR LESS.



**LAKE (PARCEL F)**

A PORTION OF OUTLOT 'F', WATERFORD ESTATES ADDITION, LOCATED IN THE NORTHWEST QUARTER, OF SECTION 24, TOWNSHIP 10, RANGE 7 EAST OF THE 6TH P.M., CITY OF LINCOLN, LANCASTER COUNTY, NEBRASKA, AND MORE PARTICULARLY DESCRIBED AS FOLLOWS:

BEGINNING AT A SOUTH CORNER OF SAID OUTLOT 'F', SAID CORNER ALSO BEING A NORTH CORNER OF OUTLOT 'G', WATERFORD ESTATES ADDITION, THENCE NORTH ALONG A WEST LINE OF SAID OUTLOT 'F', ON AN ASSUMED BEARING OF NORTH 00 DEGREES 22 MINUTES 04 SECONDS EAST, A DISTANCE OF 200.02 FEET TO A POINT; THENCE SOUTH 88 DEGREES 45 MINUTES 34 SECONDS EAST, A DISTANCE OF 81.84 FEET TO A POINT; THENCE SOUTH 01 DEGREES 14 MINUTES 26 SECONDS WEST, A DISTANCE OF 120.00 FEET TO A POINT; THENCE SOUTH 88 DEGREES 45 MINUTES 34 SECONDS EAST, A DISTANCE OF 1,051.55 FEET TO A POINT; THENCE SOUTH 00 DEGREES 24 MINUTES 41 SECONDS WEST, A DISTANCE OF 200.41 FEET TO A POINT ON THE SOUTH LINE OF SAID OUTLOT 'F'; THENCE NORTH 89 DEGREES 37 MINUTES 56 SECONDS WEST, ALONG A SOUTH LINE OF SAID OUTLOT 'F', SAID LINE BEING THE NORTH LINE OF SAID OUTLOT 'G', A DISTANCE OF 251.54 FEET TO A POINT; THENCE NORTH 71 DEGREES 30 MINUTES 39 SECONDS WEST, ALONG A SOUTH LINE OF SAID OUTLOT 'F', SAID LINE BEING THE NORTH LINE OF SAID OUTLOT 'G', A DISTANCE OF 54.14 FEET TO A SOUTH CORNER OF SAID OUTLOT 'F'; THENCE NORTH 41 DEGREES 11 MINUTES 58 SECONDS WEST, ALONG A SOUTH LINE OF SAID OUTLOT 'F', SAID LINE BEING THE NORTH LINE OF SAID OUTLOT 'G', A DISTANCE OF 146.58 FEET TO A SOUTH CORNER OF SAID OUTLOT 'F'; THENCE NORTH 88 DEGREES 45 MINUTES 34 SECONDS WEST, ALONG A SOUTH LINE OF SAID OUTLOT 'F', SAID LINE BEING THE NORTH LINE OF SAID OUTLOT 'G', A DISTANCE OF 731.12 FEET TO THE POINT OF BEGINNING. SAID TRACT CONTAINS A CALCULATED AREA OF 142,248.23 SQUARE FEET OR 3.27 ACRES, MORE OR LESS.

**LAKE (PARCEL G)**

OUTLOT 'F', WATERFORD ESTATES 1<sup>ST</sup> ADDITION, LINCOLN, LANCASTER COUNTY, NEBRASKA.

## EXHIBIT "D"

### LAKE LOTS LEGAL DESCRIPTION

#### LAKE FRONT AREA 1

LOTS 1 THROUGH 5, BLOCK 2; LOTS 1 THROUGH 5, BLOCK 3; LOT 1, BLOCK 4; OUTLOT 'C' AND OUTLOT 'D', WATERFORD ESTATES 1<sup>ST</sup> ADDITION, LOCATED IN THE SOUTHWEST QUARTER OF SECTION 24, TOWNSHIP 10, RANGE 7 EAST OF THE 6TH P.M., CITY OF LINCOLN, LANCASTER COUNTY, NEBRASKA.

AND

A PORTION OF OUTLOT 'G', WATERFORD ESTATES 1<sup>ST</sup> ADDITION, LOCATED IN THE SOUTHWEST QUARTER AND IN THE NORTHWEST QUARTER OF SECTION 24, TOWNSHIP 10, RANGE 7 EAST OF THE 6TH P.M., CITY OF LINCOLN, LANCASTER COUNTY, NEBRASKA, AND MORE PARTICULARLY DESCRIBED AS FOLLOWS:

BEGINNING AT THE NORTHEAST CORNER OF SAID SOUTHWEST QUARTER, THENCE SOUTH ALONG THE EAST LINE OF SAID OUTLOT 'C', SAID LINE BEING THE EAST LINE OF SAID SOUTHWEST QUARTER ON AN ASSUMED BEARING OF SOUTH 00 DEGREES 10 MINUTES 10 SECONDS WEST, A DISTANCE OF 877.87 FEET TO A POINT; THENCE NORTH 89 DEGREES 49 MINUTES 50 SECONDS WEST, A DISTANCE OF 393.17 FEET TO A POINT OF CURVATURE OF A NON TANGENT CURVE; THENCE ALONG A CURVE TO THE LEFT HAVING A RADIUS OF 615.00 FEET, A DELTA ANGLE OF 12 DEGREES 42 SECONDS WEST, AN ARC LENGTH OF 138.28 FEET, A CHORD BEARING OF SOUTH 83 DEGREES 43 MINUTES 42 SECONDS WEST, AND A CHORD LENGTH OF 137.99 FEET TO A POINT; THENCE SOUTH 77 DEGREES 17 MINUTES 14 SECONDS WEST, A DISTANCE OF 417.75 FEET TO A POINT ON THE WEST LINE OF SAID OUTLOT 'G', SAID POINT BEING ON THE EAST RIGHT OF WAY LINE OF SHORE FRONT DRIVE; THENCE NORTH 12 DEGREES 42 MINUTES 46 SECONDS WEST, ALONG SAID WEST LINE AND ALONG SAID EAST RIGHT OF WAY LINE, A DISTANCE OF 30.00 FEET TO A WEST CORNER OF SAID OUTLOT 'G', SAID POINT BEING THE NORTHEAST RIGHT OF WAY CORNER OF SHORE FRONT DRIVE; THENCE SOUTH 77 DEGREES 17 MINUTES 14 SECONDS WEST, ALONG A SOUTH LINE OF SAID OUTLOT 'G' AND ALONG THE NORTH RIGHT OF WAY LINE OF SHORE FRONT DRIVE, A DISTANCE OF 10.00 FEET TO A WEST CORNER OF SAID OUTLOT 'G', SAID POINT BEING THE SOUTHEAST CORNER OF SAID LOT 1, BLOCK 4; THENCE NORTH 12 DEGREES 42 MINUTES 46 SECONDS WEST, ALONG A WEST LINE OF SAID OUTLOT 'G', SAID LINE BEING THE EAST LINE OF SAID LOT 1, BLOCK 4, A DISTANCE OF 110.00 FEET TO A WEST CORNER OF SAID OUTLOT 'G', SAID POINT BEING THE NORTHEAST CORNER OF SAID LOT 1, BLOCK 4; THENCE NORTH 60 DEGREES 08 MINUTES 02 SECONDS EAST, ALONG A LINE COMMON TO SAID OUTLOT 'G' AND OUTLOT 'B', WATERFORD ESTATES 1<sup>ST</sup> ADDITION, A DISTANCE OF 50.86 FEET TO A CORNER COMMON TO SAID OUTLOT 'G' AND SAID OUTLOT 'B'; THENCE NORTH 77 DEGREES 17 MINUTES 14 SECONDS EAST, ALONG SAID COMMON LINE, A DISTANCE OF 143.81 FEET TO A CORNER COMMON TO SAID OUTLOT 'G' AND SAID OUTLOT 'B'; THENCE SOUTH 12 DEGREES 31 MINUTES 36 SECONDS EAST, ALONG SAID COMMON LINE, A DISTANCE OF 125.00 FEET TO A CORNER COMMON TO SAID OUTLOT 'G' AND SAID OUTLOT 'B'; THENCE NORTH 77 DEGREES 17 MINUTES 14 SECONDS EAST, ALONG SAID COMMON LINE, A DISTANCE OF 62.51 FEET TO A CORNER COMMON TO SAID OUTLOT 'G' AND SAID OUTLOT 'B'; THENCE NORTH 12 DEGREES 42 MINUTES 46 SECONDS WEST, ALONG SAID COMMON LINE, A DISTANCE OF 125.00 FEET TO A CORNER COMMON TO SAID OUTLOT 'G' AND SAID OUTLOT 'B'; THENCE NORTH 77 DEGREES 17 MINUTES 14 SECONDS EAST, ALONG SAID COMMON LINE, A DISTANCE OF 50.00 FEET TO A CORNER COMMON TO SAID OUTLOT 'G' AND SAID OUTLOT 'B'; THENCE NORTH 88 DEGREES 35 MINUTES 50 SECONDS EAST, ALONG SAID COMMON LINE, A DISTANCE OF 50.99 FEET TO A CORNER COMMON TO SAID OUTLOT 'G' AND SAID OUTLOT 'B'; THENCE NORTH 34 DEGREES 10 MINUTES 26 SECONDS EAST, ALONG SAID COMMON LINE, A DISTANCE OF 21.59 FEET TO A CORNER COMMON TO SAID OUTLOT 'G' AND SAID OUTLOT 'B'; THENCE NORTH 15 DEGREES 28 MINUTES 26 SECONDS WEST, ALONG SAID COMMON LINE, A DISTANCE OF 52.16 FEET TO A CORNER COMMON TO SAID OUTLOT 'G' AND SAID OUTLOT 'B'; THENCE NORTH 09 DEGREES 54 MINUTES 23 SECONDS WEST, ALONG SAID COMMON LINE, A DISTANCE OF 351.82 FEET TO A CORNER COMMON TO SAID OUTLOT 'G' AND SAID OUTLOT 'B'; THENCE NORTH 16 DEGREES 15 MINUTES 18 SECONDS WEST, ALONG SAID COMMON LINE, A DISTANCE OF 74.86 FEET TO A CORNER COMMON TO SAID OUTLOT 'G' AND SAID OUTLOT 'B'; THENCE NORTH 27 DEGREES 56 MINUTES 12 SECONDS WEST, ALONG SAID COMMON LINE, A DISTANCE OF 86.21 FEET TO A CORNER COMMON TO SAID OUTLOT 'G' AND SAID OUTLOT 'B'; THENCE NORTH 02 DEGREES 34 MINUTES 26 SECONDS EAST, ALONG SAID COMMON LINE, A DISTANCE OF 87.25 FEET TO A CORNER COMMON TO SAID OUTLOT 'G' AND SAID OUTLOT 'B'; THENCE NORTH 29 DEGREES 51 MINUTES 13 SECONDS EAST, ALONG SAID COMMON LINE, A DISTANCE OF 87.25 FEET TO A CORNER COMMON TO SAID OUTLOT 'G' AND SAID OUTLOT 'B'; THENCE NORTH 57 DEGREES 07 MINUTES 59 SECONDS EAST, ALONG SAID COMMON LINE, A DISTANCE OF 87.25 FEET TO A CORNER COMMON TO SAID OUTLOT 'G' AND SAID OUTLOT 'B'; THENCE NORTH 84 DEGREES 24 MINUTES 46 SECONDS EAST, ALONG SAID COMMON LINE, A DISTANCE OF 87.25 FEET TO A CORNER COMMON TO SAID OUTLOT 'G' AND SAID OUTLOT 'B'; THENCE SOUTH 68 DEGREES 18 MINUTES 28 SECONDS EAST, ALONG SAID COMMON LINE, A DISTANCE OF 87.25 FEET TO A CORNER COMMON TO SAID OUTLOT 'G' AND SAID OUTLOT 'B'; THENCE SOUTH 41 DEGREES 01 MINUTES 41 SECONDS EAST, ALONG SAID COMMON LINE, A DISTANCE OF 87.25 FEET TO A CORNER COMMON TO SAID OUTLOT 'G' AND SAID OUTLOT 'B'; THENCE SOUTH 10 DEGREES 31 MINUTES 01 SECONDS EAST, ALONG SAID COMMON LINE, A DISTANCE OF 86.21 FEET TO A CORNER COMMON TO SAID OUTLOT 'G' AND SAID OUTLOT 'B'; THENCE SOUTH 00 DEGREES 58 MINUTES 58 SECONDS EAST, ALONG SAID COMMON LINE, A DISTANCE OF 176.47 FEET TO A CORNER COMMON TO SAID OUTLOT 'G' AND SAID OUTLOT 'B'; THENCE SOUTH 09 DEGREES 54 MINUTES 23 SECONDS EAST, ALONG SAID COMMON LINE, A DISTANCE OF 332.50 FEET TO A CORNER COMMON TO SAID OUTLOT 'G' AND SAID OUTLOT 'B'; THENCE SOUTH 00 DEGREES 20 MINUTES 47 SECONDS EAST, ALONG SAID COMMON LINE, A DISTANCE OF 48.17 FEET TO A CORNER COMMON TO SAID OUTLOT 'G' AND SAID OUTLOT 'B'; THENCE SOUTH 56 DEGREES 28 MINUTES 55 SECONDS EAST, ALONG SAID COMMON LINE, A DISTANCE OF 24.78 FEET TO A CORNER COMMON TO SAID OUTLOT 'G' AND SAID OUTLOT 'B'; THENCE NORTH 81 DEGREES 32 MINUTES 07 SECONDS EAST, ALONG SAID COMMON LINE, A DISTANCE OF 78.43 FEET TO A

CORNER COMMON TO SAID OUTLOT 'G' AND SAID OUTLOT 'B'; THENCE SOUTH 83 DEGREES 07 MINUTES 19 SECONDS EAST, ALONG SAID COMMON LINE, A DISTANCE OF 73.04 FEET TO A CORNER COMMON TO SAID OUTLOT 'G' AND SAID OUTLOT 'B'; THENCE NORTH 59 DEGREES 39 MINUTES 17 SECONDS EAST, ALONG SAID COMMON LINE, A DISTANCE OF 26.70 FEET TO A CORNER COMMON TO SAID OUTLOT 'G' AND SAID OUTLOT 'B'; THENCE NORTH 09 DEGREES 30 MINUTES 24 SECONDS WEST, ALONG SAID COMMON LINE, A DISTANCE OF 47.53 FEET TO A CORNER COMMON TO SAID OUTLOT 'G' AND SAID OUTLOT 'B'; THENCE NORTH 00 DEGREES 10 MINUTES 57 SECONDS EAST, ALONG SAID COMMON LINE, A DISTANCE OF 433.14 FEET TO A CORNER COMMON TO SAID OUTLOT 'G' AND SAID OUTLOT 'B'; THENCE NORTH 04 DEGREES 47 MINUTES 07 SECONDS EAST, ALONG SAID COMMON LINE, A DISTANCE OF 59.27 FEET TO A CORNER COMMON TO SAID OUTLOT 'G' AND SAID OUTLOT 'B'; THENCE NORTH 17 DEGREES 41 MINUTES 59 SECONDS EAST, ALONG SAID COMMON LINE, A DISTANCE OF 59.27 FEET TO A CORNER COMMON TO SAID OUTLOT 'G' AND SAID OUTLOT 'B'; THENCE NORTH 31 DEGREES 01 MINUTES 38 SECONDS EAST, ALONG SAID COMMON LINE, A DISTANCE OF 61.39 FEET TO A CORNER COMMON TO SAID OUTLOT 'G' AND SAID OUTLOT 'B'; THENCE NORTH 44 DEGREES 35 MINUTES 18 SECONDS EAST, ALONG SAID COMMON LINE, A DISTANCE OF 61.39 FEET TO A CORNER COMMON TO SAID OUTLOT 'G' AND SAID OUTLOT 'B'; THENCE NORTH 58 DEGREES 08 MINUTES 57 SECONDS EAST, ALONG SAID COMMON LINE, A DISTANCE OF 61.39 FEET TO A CORNER COMMON TO SAID OUTLOT 'G' AND SAID OUTLOT 'B'; THENCE NORTH 71 DEGREES 42 MINUTES 36 SECONDS EAST, ALONG SAID COMMON LINE, A DISTANCE OF 0.75 FEET TO A POINT ON THE EAST LINE OF SAID OUTLOT 'G', SAID LINE BEING THE EAST LINE OF SAID NORTHWEST QUARTER; THENCE SOUTH 00 DEGREES 09 MINUTES 34 SECONDS WEST, ALONG SAID EAST LINE A DISTANCE OF 7.10 FEET TO THE POINT OF BEGINNING. SAID TRACT CONTAINS A CALCULATED AREA OF 468,610.83 SQUARE FEET OR 10.76 ACRES, MORE OR LESS.

#### LAKE FRONT AREA 2

LOTS 1 THROUGH 3, BLOCK 1, LOTS 1 THROUGH 32 BLOCK 2 AND OUTLOT 'A', WATERFORD ESTATES ADDITION, LOCATED IN THE WEST ONE-HALF OF SECTION 24, AND THE EAST ONE-HALF OF SECTION 23, TOWNSHIP 10, RANGE 7 EAST OF THE 6TH P.M., CITY OF LINCOLN, LANCASTER COUNTY, NEBRASKA.

AND

A PORTION OF OUTLOT 'E', WATERFORD ESTATES ADDITION AND A PORTION OF OUTLOT 'E', WATERFORD ESTATES 1<sup>ST</sup> ADDITION, ALL LOCATED IN THE WEST ONE-HALF OF SECTION 24, AND THE EAST ONE-HALF OF SECTION 23, TOWNSHIP 10, RANGE 7 EAST OF THE 6TH P.M., CITY OF LINCOLN, LANCASTER COUNTY, NEBRASKA, AND MORE PARTICULARLY DESCRIBED AS FOLLOWS:

BEGINNING AT THE MOST NORTHERLY CORNER OF SAID OUTLOT 'E', WATERFORD ESTATES ADDITION, SAID POINT BEING A WEST CORNER OF OUTLOT 'F', WATERFORD ESTATES ADDITION; THENCE SOUTH 58 DEGREES 38 MINUTES 19 SECONDS EAST, ALONG A NORTHEAST LINE OF SAID OUTLOT 'E', A DISTANCE OF 20.66 FEET TO A NORTHEAST CORNER OF SAID OUTLOT 'E', SAID POINT BEING A POINT OF CURVATURE; THENCE ALONG A CURVE TO THE RIGHT HAVING A RADIUS OF 1,000.00 FEET, A DELTA ANGLE OF 07 DEGREES 09 MINUTES 12 SECONDS, AN ARC LENGTH OF 124.85 FEET, A CHORD BEARING OF SOUTH 55 DEGREES 03 MINUTES 43 SECONDS EAST, ALONG A NORTHEAST LINE OF SAID OUTLOT 'E', AND A CHORD LENGTH OF 124.77 FEET TO A NORTHEAST CORNER OF SAID OUTLOT 'E'; THENCE SOUTH 51 DEGREES 29 MINUTES 07 SECONDS EAST, ALONG A NORTHEAST LINE OF SAID OUTLOT 'E', A DISTANCE OF 263.76 FEET TO A POINT; THENCE SOUTH 38 DEGREES 30 MINUTES 53 SECONDS WEST, A DISTANCE OF 130.00 FEET TO A POINT; THENCE SOUTH 51 DEGREES 29 MINUTES 07 SECONDS EAST, A DISTANCE OF 150.00 FEET TO A POINT ON AN EAST LINE OF SAID OUTLOT 'E', SAID POINT BEING ON THE WEST LINE OF OUTLOT 'E', WATERFORD ESTATES 1<sup>ST</sup> ADDITION; THENCE NORTH 38 DEGREES 30 MINUTES 53 SECONDS EAST, ALONG A LINE COMMON TO SAID OUTLOT 'E', WATERFORD ESTATES ADDITION AND SAID OUTLOT 'E', WATERFORD ESTATES 1<sup>ST</sup> ADDITION, A DISTANCE OF 130.00 FEET TO A POINT ON THE NORTHEAST LINE OF SAID OUTLOT 'E', WATERFORD ESTATES 1<sup>ST</sup> ADDITION; THENCE SOUTH 51 DEGREES 29 MINUTES 07 SECONDS EAST, ALONG A LINE COMMON TO SAID OUTLOT 'E', WATERFORD ESTATES 1<sup>ST</sup> ADDITION AND OUTLOT 'F', WATERFORD ESTATES ADDITION, A DISTANCE OF 254.52 FEET TO A NORTHEAST CORNER OF SAID OUTLOT 'E', SAID POINT BEING A POINT OF CURVATURE; THENCE ALONG A CURVE TO THE LEFT HAVING A RADIUS OF 150.00 FEET, A DELTA ANGLE OF 79 DEGREES 40 MINUTES 18 SECONDS, AN ARC LENGTH OF 208.58 FEET, A CHORD BEARING OF NORTH 88 DEGREES 40 MINUTES 44 SECONDS EAST, ALONG SAID COMMON LINE, AND A CHORD LENGTH OF 192.18 FEET TO A NORTHWEST CORNER OF SAID OUTLOT 'E'; THENCE NORTH 48 DEGREES 50 MINUTES 35 SECONDS EAST, ALONG SAID COMMON LINE, A DISTANCE OF 162.00 FEET TO A NORTHWEST CORNER OF SAID OUTLOT 'E', SAID POINT BEING A POINT OF CURVATURE; THENCE ALONG A CURVE TO THE LEFT HAVING A RADIUS OF 285.00 FEET, A DELTA ANGLE OF 11 DEGREES 00 MINUTES 45 SECONDS, AN ARC LENGTH OF 54.78 FEET, A CHORD BEARING OF NORTH 43 DEGREES 20 MINUTES 13 SECONDS EAST, ALONG SAID COMMON LINE, AND A CHORD LENGTH OF 54.69 FEET TO A NORTHWEST CORNER OF SAID OUTLOT 'E', SAID POINT BEING A POINT OF COMPOUND CURVATURE; THENCE ALONG A CURVE TO THE LEFT HAVING A RADIUS OF 2,285.00 FEET, A DELTA ANGLE OF 13 DEGREES 03 MINUTES 27 SECONDS, AN ARC LENGTH OF 520.75 FEET, A CHORD BEARING OF NORTH 31 DEGREES 18 MINUTES 06 SECONDS EAST, ALONG SAID COMMON LINE, AND A CHORD LENGTH OF 519.62 FEET TO A NORTHWEST CORNER OF SAID OUTLOT 'E', SAID POINT BEING A POINT OF COMPOUND CURVATURE; THENCE ALONG A CURVE TO THE LEFT HAVING A RADIUS OF 1,000.00 FEET, A DELTA ANGLE OF 05 DEGREES 28 MINUTES 21 SECONDS, AN ARC LENGTH OF 95.51 FEET, A CHORD BEARING OF NORTH 22 DEGREES 02 MINUTES 12 SECONDS EAST, ALONG SAID COMMON LINE, AND A CHORD LENGTH OF 95.48 FEET TO A NORTHWEST CORNER OF SAID OUTLOT 'E'; THENCE NORTH 19 DEGREES 18 MINUTES 02 SECONDS EAST, ALONG SAID COMMON LINE, A DISTANCE OF 47.40 FEET TO A NORTH CORNER OF SAID OUTLOT 'E', SAID POINT BEING A POINT OF CURVATURE OF A NON TANGENT CURVE; THENCE ALONG A CURVE TO THE LEFT HAVING A RADIUS OF 500.00 FEET, A DELTA ANGLE OF 28 DEGREES 40 MINUTES 56 SECONDS, AN ARC LENGTH OF 250.30 FEET, A CHORD BEARING OF SOUTH 82 DEGREES 57 MINUTES 03 SECONDS EAST, ALONG SAID COMMON LINE, AND A CHORD LENGTH OF 247.70 FEET TO A POINT; THENCE SOUTH 07 DEGREES 17 MINUTES 32 SECONDS EAST, ALONG A LINE COMMON TO SAID OUTLOT 'E', WATERFORD ESTATES 1<sup>ST</sup> ADDITION AND OUTLOT 'B', WATERFORD ESTATES 1<sup>ST</sup> ADDITION, AND ITS EXTENSION, A DISTANCE OF 145.59 FEET TO A CORNER OF SAID OUTLOT 'E'; THENCE SOUTH 86 DEGREES 59 MINUTES 21 SECONDS WEST, ALONG SAID COMMON LINE, A DISTANCE OF 87.66 FEET TO A CORNER OF SAID OUTLOT 'E'; THENCE

NORTH 85 DEGREES 36 MINUTES 28 SECONDS WEST, ALONG SAID COMMON LINE, A DISTANCE OF 87.62 FEET TO A CORNER OF SAID OUTLOT 'E'; THENCE NORTH 76 DEGREES 31 MINUTES 19 SECONDS WEST, ALONG SAID COMMON LINE, A DISTANCE OF 116.72 FEET TO A CORNER OF SAID OUTLOT 'E', SAID POINT BEING A POINT OF CURVATURE OF A NON TANGENT CURVE; THENCE ALONG A CURVE TO THE RIGHT, HAVING A RADIUS OF 1,030.00 FEET, A DELTA ANGLE OF 00 DEGREES 01 MINUTES 08 SECONDS, AN ARC LENGTH OF 0.34 FEET, A CHORD BEARING OF SOUTH 24 DEGREES 45 MINUTES 49 SECONDS WEST, ALONG SAID COMMON LINE, AND A CHORD LENGTH OF 0.34 FEET TO A CORNER OF SAID OUTLOT 'E', SAID POINT BEING A POINT OF COMPOUND CURVATURE; THENCE ALONG A CURVE TO THE RIGHT, HAVING A RADIUS OF 2,315.00 FEET, A DELTA ANGLE OF 01 DEGREES 00 MINUTES 48 SECONDS, AN ARC LENGTH OF 40.95 FEET, A CHORD BEARING OF SOUTH 25 DEGREES 16 MINUTES 47 SECONDS WEST, ALONG SAID COMMON LINE, AND A CHORD LENGTH OF 40.94 FEET TO A CORNER OF SAID OUTLOT 'E'; THENCE SOUTH 64 DEGREES 12 MINUTES 49 SECONDS EAST, ALONG SAID COMMON LINE, A DISTANCE OF 125.00 FEET TO A CORNER OF SAID OUTLOT 'E'; THENCE SOUTH 26 DEGREES 43 MINUTES 37 SECONDS WEST, ALONG SAID COMMON LINE, A DISTANCE OF 80.10 FEET TO A CORNER OF SAID OUTLOT 'E'; THENCE SOUTH 28 DEGREES 36 MINUTES 29 SECONDS WEST, ALONG SAID COMMON LINE, A DISTANCE OF 119.44 FEET TO A CORNER OF SAID OUTLOT 'E'; THENCE SOUTH 50 DEGREES 31 MINUTES 10 SECONDS WEST, ALONG SAID COMMON LINE, A DISTANCE OF 48.06 FEET TO A CORNER OF SAID OUTLOT 'E'; THENCE SOUTH 11 DEGREES 40 MINUTES 48 SECONDS EAST, ALONG SAID COMMON LINE, A DISTANCE OF 28.55 FEET TO A CORNER OF SAID OUTLOT 'E'; THENCE SOUTH 73 DEGREES 27 MINUTES 21 SECONDS EAST, ALONG SAID COMMON LINE, A DISTANCE OF 50.50 FEET TO A CORNER OF SAID OUTLOT 'E'; THENCE SOUTH 56 DEGREES 10 MINUTES 01 SECONDS EAST, ALONG SAID COMMON LINE, A DISTANCE OF 131.22 FEET TO A CORNER OF SAID OUTLOT 'E'; THENCE SOUTH 65 DEGREES 51 MINUTES 59 SECONDS EAST, ALONG SAID COMMON LINE, A DISTANCE OF 177.88 FEET TO A CORNER OF SAID OUTLOT 'E'; THENCE SOUTH 40 DEGREES 07 MINUTES 19 SECONDS EAST, ALONG SAID COMMON LINE, A DISTANCE OF 95.76 FEET TO A CORNER OF SAID OUTLOT 'E'; THENCE SOUTH 10 DEGREES 07 MINUTES 19 SECONDS EAST, ALONG SAID COMMON LINE, A DISTANCE OF 95.76 FEET TO A CORNER OF SAID OUTLOT 'E'; THENCE SOUTH 19 DEGREES 21 MINUTES 20 SECONDS WEST, ALONG SAID COMMON LINE, A DISTANCE OF 92.50 FEET TO A CORNER OF SAID OUTLOT 'E'; THENCE SOUTH 48 DEGREES 18 MINUTES 38 SECONDS WEST, ALONG SAID COMMON LINE, A DISTANCE OF 92.50 FEET TO A CORNER OF SAID OUTLOT 'E'; THENCE SOUTH 77 DEGREES 47 MINUTES 18 SECONDS WEST, ALONG SAID COMMON LINE, A DISTANCE OF 95.76 FEET TO A CORNER OF SAID OUTLOT 'E'; THENCE NORTH 72 DEGREES 12 MINUTES 42 SECONDS WEST, ALONG SAID COMMON LINE, A DISTANCE OF 95.76 FEET TO A CORNER OF SAID OUTLOT 'E'; THENCE NORTH 46 DEGREES 39 MINUTES 35 SECONDS WEST, ALONG SAID COMMON LINE, A DISTANCE OF 181.45 FEET TO A CORNER OF SAID OUTLOT 'E'; THENCE NORTH 56 DEGREES 10 MINUTES 01 SECONDS WEST, ALONG SAID COMMON LINE, A DISTANCE OF 130.97 FEET TO A CORNER OF SAID OUTLOT 'E'; THENCE NORTH 37 DEGREES 46 MINUTES 16 SECONDS WEST, ALONG SAID COMMON LINE, A DISTANCE OF 47.62 FEET TO A CORNER OF SAID OUTLOT 'E'; THENCE SOUTH 87 DEGREES 13 MINUTES 01 SECONDS WEST, ALONG SAID COMMON LINE, A DISTANCE OF 38.69 FEET TO A CORNER OF SAID OUTLOT 'E'; THENCE SOUTH 22 DEGREES 19 MINUTES 48 SECONDS WEST, ALONG SAID COMMON LINE, A DISTANCE OF 56.00 FEET TO A CORNER OF SAID OUTLOT 'E'; THENCE SOUTH 48 DEGREES 50 MINUTES 35 SECONDS WEST, ALONG SAID COMMON LINE, A DISTANCE OF 164.58 FEET TO A CORNER OF SAID OUTLOT 'E'; THENCE SOUTH 04 DEGREES 25 MINUTES 14 SECONDS EAST, ALONG SAID COMMON LINE, A DISTANCE OF 30.16 FEET TO A CORNER OF SAID OUTLOT 'E'; THENCE SOUTH 18 DEGREES 10 MINUTES 45 SECONDS EAST, ALONG SAID COMMON LINE, A DISTANCE OF 72.68 FEET TO A CORNER OF SAID OUTLOT 'E'; THENCE SOUTH 53 DEGREES 11 MINUTES 55 SECONDS EAST, ALONG SAID COMMON LINE, A DISTANCE OF 80.19 FEET TO A CORNER OF SAID OUTLOT 'E'; THENCE SOUTH 40 DEGREES 38 MINUTES 36 SECONDS EAST, ALONG SAID COMMON LINE, A DISTANCE OF 95.76 FEET TO A CORNER OF SAID OUTLOT 'E'; THENCE SOUTH 10 DEGREES 38 MINUTES 36 SECONDS EAST, ALONG SAID COMMON LINE, A DISTANCE OF 95.76 FEET TO A CORNER OF SAID OUTLOT 'E'; THENCE SOUTH 20 DEGREES 27 MINUTES 56 SECONDS WEST, ALONG SAID COMMON LINE, A DISTANCE OF 102.66 FEET TO A CORNER OF SAID OUTLOT 'E'; THENCE SOUTH 52 DEGREES 41 MINUTES 01 SECONDS WEST, ALONG SAID COMMON LINE, A DISTANCE OF 102.66 FEET TO A CORNER OF SAID OUTLOT 'E'; THENCE SOUTH 83 DEGREES 30 MINUTES 38 SECONDS WEST, ALONG SAID COMMON LINE, A DISTANCE OF 94.00 FEET TO A CORNER OF SAID OUTLOT 'E'; THENCE NORTH 67 DEGREES 03 MINUTES 14 SECONDS WEST, ALONG SAID COMMON LINE, A DISTANCE OF 94.00 FEET TO A CORNER OF SAID OUTLOT 'E'; THENCE NORTH 40 DEGREES 58 MINUTES 01 SECONDS WEST, ALONG SAID COMMON LINE, A DISTANCE OF 72.94 FEET TO A CORNER OF SAID OUTLOT 'E'; THENCE NORTH 18 DEGREES 13 MINUTES 42 SECONDS WEST, ALONG SAID COMMON LINE, A DISTANCE OF 72.94 FEET TO A CORNER OF SAID OUTLOT 'E'; THENCE NORTH 37 DEGREES 10 MINUTES 35 SECONDS WEST, ALONG SAID COMMON LINE, A DISTANCE OF 84.37 FEET TO A CORNER OF SAID OUTLOT 'E'; THENCE NORTH 27 DEGREES 58 MINUTES 22 SECONDS WEST, ALONG SAID COMMON LINE, A DISTANCE OF 61.64 FEET TO A CORNER OF SAID OUTLOT 'E'; THENCE NORTH 20 DEGREES 12 MINUTES 20 SECONDS WEST, ALONG SAID COMMON LINE, A DISTANCE OF 61.64 FEET TO A CORNER OF SAID OUTLOT 'E'; THENCE NORTH 13 DEGREES 31 MINUTES 18 SECONDS WEST, ALONG SAID COMMON LINE, A DISTANCE OF 44.46 FEET TO A CORNER OF SAID OUTLOT 'E'; THENCE NORTH 07 DEGREES 55 MINUTES 16 SECONDS WEST, ALONG SAID COMMON LINE, A DISTANCE OF 44.46 FEET TO A CORNER OF SAID OUTLOT 'E'; THENCE NORTH 38 DEGREES 35 MINUTES 50 SECONDS WEST, ALONG SAID COMMON LINE, A DISTANCE OF 88.24 FEET TO A CORNER OF SAID OUTLOT 'E'; THENCE NORTH 51 DEGREES 29 MINUTES 07 SECONDS WEST, ALONG SAID COMMON LINE, A DISTANCE OF 50.00 FEET TO A CORNER OF SAID OUTLOT 'E'; THENCE NORTH 34 DEGREES 47 MINUTES 09 SECONDS WEST, ALONG SAID COMMON LINE, A DISTANCE OF 52.20 FEET TO A CORNER OF SAID OUTLOT 'E'; THENCE SOUTH 83 DEGREES 30 MINUTES 53 SECONDS WEST, ALONG SAID COMMON LINE, A DISTANCE OF 28.28 FEET TO A CORNER OF SAID OUTLOT 'E'; THENCE SOUTH 21 DEGREES 48 MINUTES 56 SECONDS WEST, ALONG SAID COMMON LINE, A DISTANCE OF 52.20 FEET TO A CORNER OF SAID OUTLOT 'E'; THENCE SOUTH 38 DEGREES 30 MINUTES 53 SECONDS WEST, ALONG SAID COMMON LINE, A DISTANCE OF 45.00 FEET TO A CORNER OF SAID OUTLOT 'E'; THENCE NORTH 51 DEGREES 29 MINUTES 07 SECONDS WEST, ALONG SAID COMMON LINE, A DISTANCE OF 125.00 FEET TO A POINT ON A WEST LINE OF SAID OUTLOT 'E'; THENCE NORTH 38 DEGREES 30 MINUTES 53 SECONDS EAST, ALONG A WEST LINE OF SAID OUTLOT 'E', SAID LINE BEING THE WEST RIGHT OF WAY LINE OF N. 100<sup>TH</sup> STREET, A DISTANCE OF 10.00 FEET TO A WEST CORNER OF SAID OUTLOT 'E', SAID POINT BEING A NORTHEAST RIGHT OF WAY CORNER OF N. 100<sup>TH</sup> STREET; THENCE NORTH 51 DEGREES 29 MINUTES 07 SECONDS WEST, ALONG THE NORTH RIGHT OF WAY LINE OF N. 100<sup>TH</sup> STREET, A DISTANCE OF 60.00 FEET TO A NORTHWEST RIGHT OF WAY CORNER OF N. 100<sup>TH</sup> STREET; THENCE NORTH 38 DEGREES 30 MINUTES 53 SECONDS EAST, ALONG THE EXTENSION OF THE WEST RIGHT OF WAY LINE OF N. 100<sup>TH</sup> STREET, A DISTANCE OF 15.00 FEET TO A POINT; THENCE NORTH 51 DEGREES 29 MINUTES 07 SECONDS WEST, A DISTANCE OF 120.00 FEET TO A POINT; THENCE NORTH 38 DEGREES 30 MINUTES 53 SECONDS EAST, A DISTANCE OF 70.00 FEET TO A POINT; THENCE NORTH 51 DEGREES 34 MINUTES 07 SECONDS

WEST, A DISTANCE OF 294.73 FEET TO A POINT; THENCE NORTH 58 DEGREES 23 MINUTES 56 SECONDS WEST, A DISTANCE OF 107.73 FEET TO A POINT ON THE WEST LINE OF OUTLOT 'E', WATERFORD ESTATE ADDITION, SAID POINT ALSO BEING ON THE EAST RIGHT OF WAY LINE OF N. 98<sup>TH</sup> STREET; THENCE ALONG A NON-TANGENT CURVE TO THE RIGHT HAVING A RADIUS OF 1,430.00 FEET, A DELTA ANGLE OF 05 DEGREES 12 MINUTES 32 SECONDS, AN ARC LENGTH OF 130.01 FEET, A CHORD BEARING OF NORTH 27 DEGREES 26 MINUTES 04 SECONDS EAST, ALONG THE WEST LINE OF SAID OUTLOT 'E', SAID LINE ALSO BEING THE EAST RIGHT OF WAY LINE OF N. 98<sup>TH</sup> STREET, AND A CHORD LENGTH OF 129.96 FEET TO A NORTHWEST CORNER OF SAID OUTLOT 'E'; THENCE SOUTH 58 DEGREES 38 MINUTES 19 SECONDS EAST, ALONG A NORTH LINE OF SAID OUTLOT 'E', A DISTANCE OF 22.24 FEET TO A NORTH CORNER OF SAID OUTLOT 'E'; THENCE NORTH 31 DEGREES 11 MINUTES 43 SECONDS EAST, ALONG A WEST LINE OF SAID OUTLOT 'E', A DISTANCE OF 33.00 FEET TO A NORTHWEST CORNER OF SAID OUTLOT 'E' TO THE POINT OF BEGINNING. SAID TRACT CONTAINS A CALCULATED AREA OF 660,537.68 SQUARE FEET OR 15.16 ACRES, MORE OR LESS.

## EXHIBIT "F"

### RESIDENTIAL PROPERTY LEGAL DESCRIPTION

#### RESIDENTIAL PARCEL A

A PORTION OF OUTLOT 'D', WATERFORD ESTATES ADDITION, LOCATED IN THE NORTHEAST QUARTER OF SECTION 23, TOWNSHIP 10, RANGE 7 EAST OF THE 6TH P.M., CITY OF LINCOLN, LANCASTER COUNTY, NEBRASKA, AND MORE PARTICULARLY DESCRIBED AS FOLLOWS:

BEGINNING AT THE NORTHWEST CORNER OF SAID OUTLOT 'D', THENCE EAST ALONG A NORTH LINE OF SAID OUTLOT 'D', SAID LINE ALSO BEING THE SOUTH RIGHT OF WAY LINE OF HOLDREGE STREET, ON AN ASSUMED BEARING OF SOUTH 89 DEGREES 15 MINUTES 58 SECONDS EAST, A DISTANCE OF 554.38 FEET TO A NORTH CORNER OF SAID OUTLOT 'D', SAID CORNER ALSO BEING A SOUTH RIGHT OF WAY CORNER OF HOLDREGE STREET; THENCE SOUTH 00 DEGREES 44 MINUTES 02 SECONDS WEST, ALONG AN EAST LINE OF SAID OUTLOT 'D', AND ALONG SAID SOUTH RIGHT OF WAY LINE, A DISTANCE OF 10.00 FEET TO A NORTH CORNER OF SAID OUTLOT 'D', SAID CORNER ALSO BEING A SOUTH RIGHT OF WAY CORNER OF HOLDREGE STREET; THENCE SOUTH 89 DEGREES 15 MINUTES 58 SECONDS EAST, ALONG A NORTH LINE OF SAID OUTLOT 'D', AND ALONG SAID SOUTH RIGHT OF WAY LINE OF HOLDREGE STREET, A DISTANCE OF 701.01 FEET TO A NORTHEAST CORNER OF SAID OUTLOT 'D', SAID CORNER ALSO BEING A SOUTH RIGHT OF WAY CORNER OF HOLDREGE STREET; THENCE SOUTH 00 DEGREES 22 MINUTES 04 SECONDS WEST, ALONG AN EAST LINE OF SAID OUTLOT 'D', SAID LINE ALSO BEING THE WEST RIGHT OF WAY LINE OF N. 98<sup>TH</sup> STREET, A DISTANCE OF 425.01 FEET TO AN EAST CORNER OF SAID OUTLOT 'D', SAID CORNER ALSO BEING A WEST RIGHT OF WAY CORNER OF N. 98<sup>TH</sup> STREET; THENCE SOUTH 12 DEGREES 38 MINUTES 56 SECONDS WEST, ALONG AN EAST LINE OF SAID OUTLOT 'D', SAID LINE ALSO BEING THE WEST RIGHT OF WAY LINE OF N. 98<sup>TH</sup> STREET, A DISTANCE OF 4.14 FEET TO AN EAST CORNER OF SAID OUTLOT 'D', SAID CORNER ALSO BEING A WEST RIGHT OF WAY CORNER OF N. 98<sup>TH</sup> STREET; THENCE NORTH 89 DEGREES 37 MINUTES 56 SECONDS WEST, ALONG AN EAST LINE OF SAID OUTLOT 'D', SAID LINE ALSO BEING THE WEST RIGHT OF WAY LINE OF N. 98<sup>TH</sup> STREET, A DISTANCE OF 31.20 FEET TO AN EAST CORNER OF SAID OUTLOT 'D', SAID CORNER ALSO BEING A WEST RIGHT OF WAY CORNER OF N. 98<sup>TH</sup> STREET; THENCE SOUTH 00 DEGREES 44 MINUTES 02 SECONDS WEST, ALONG AN EAST LINE OF SAID OUTLOT 'D', SAID LINE ALSO BEING THE WEST RIGHT OF WAY LINE OF N. 98<sup>TH</sup> STREET, A DISTANCE OF 60.00 FEET TO AN EAST CORNER OF SAID OUTLOT 'D', SAID CORNER ALSO BEING A WEST RIGHT OF WAY CORNER OF N. 98<sup>TH</sup> STREET; THENCE SOUTH 89 DEGREES 37 MINUTES 56 SECONDS EAST, ALONG AN EAST LINE OF SAID OUTLOT 'D', SAID LINE ALSO BEING THE WEST RIGHT OF WAY LINE OF N. 98<sup>TH</sup> STREET, A DISTANCE OF 28.35 FEET TO AN EAST CORNER OF SAID OUTLOT 'D', SAID CORNER ALSO BEING A WEST RIGHT OF WAY CORNER OF N. 98<sup>TH</sup> STREET; THENCE SOUTH 11 DEGREES 52 MINUTES 49 SECONDS EAST, ALONG AN EAST LINE OF SAID OUTLOT 'D', SAID LINE ALSO BEING THE WEST RIGHT OF WAY LINE OF N. 98<sup>TH</sup> STREET, A DISTANCE OF 19.42 FEET TO AN EAST CORNER OF SAID OUTLOT 'D', SAID CORNER ALSO BEING A WEST RIGHT OF WAY CORNER OF N. 98<sup>TH</sup> STREET; THENCE SOUTH 00 DEGREES 22 MINUTES 04 SECONDS WEST, ALONG AN EAST LINE OF SAID OUTLOT 'D', SAID LINE ALSO BEING THE WEST RIGHT OF WAY LINE OF N. 98<sup>TH</sup> STREET, A DISTANCE OF 74.58 FEET TO AN EAST CORNER OF SAID OUTLOT 'D', SAID CORNER ALSO BEING A WEST RIGHT OF WAY CORNER OF N. 98<sup>TH</sup> STREET, SAID POINT BEING A POINT OF CURVATURE; THENCE ALONG A CURVE TO THE RIGHT HAVING A RADIUS OF 940.00 FEET, A DELTA ANGLE OF 37 DEGREES 50 MINUTES 54 SECONDS, AN ARC LENGTH OF 620.94 FEET, A CHORD BEARING OF SOUTH 19 DEGREES 17 MINUTES 31 SECONDS WEST, ALONG AN EAST LINE OF SAID OUTLOT 'D', SAID LINE ALSO BEING THE WEST RIGHT OF WAY LINE OF N. 98<sup>TH</sup> STREET, AND A CHORD LENGTH OF 609.72 FEET TO AN EAST CORNER OF SAID OUTLOT 'D', SAID CORNER ALSO BEING A WEST RIGHT OF WAY CORNER OF N. 98<sup>TH</sup> STREET; THENCE SOUTH 38 DEGREES 12 MINUTES 58 SECONDS WEST, A DISTANCE OF 33.18 FEET TO AN EAST CORNER OF SAID OUTLOT 'D', SAID CORNER ALSO BEING A WEST RIGHT OF WAY CORNER OF N. 98<sup>TH</sup> STREET, SAID POINT BEING A POINT OF CURVATURE; THENCE ALONG A CURVE TO THE RIGHT HAVING A RADIUS OF 320.00 FEET, A DELTA ANGLE OF 10 DEGREES 09 MINUTES 28 SECONDS, AN ARC LENGTH OF 56.73 FEET, A CHORD BEARING OF SOUTH 43 DEGREES 17 MINUTES 42 SECONDS WEST, ALONG AN EAST LINE OF SAID OUTLOT 'D', SAID LINE ALSO BEING THE WEST RIGHT OF WAY LINE OF N. 98<sup>TH</sup> STREET, AND A CHORD LENGTH OF 56.66 FEET TO AN EAST CORNER OF SAID OUTLOT 'D', SAID CORNER ALSO BEING A WEST RIGHT OF WAY CORNER OF N. 98<sup>TH</sup> STREET, SAID POINT BEING A POINT OF REVERSE CURVATURE; THENCE ALONG A CURVE TO THE LEFT HAVING A RADIUS OF 318.00 FEET, A DELTA ANGLE OF 10 DEGREES 09 MINUTES 28 SECONDS, AN ARC LENGTH OF 56.38 FEET, A CHORD BEARING OF SOUTH 43 DEGREES 17 MINUTES 42 SECONDS WEST, ALONG AN EAST LINE OF SAID OUTLOT 'D', SAID LINE ALSO BEING THE WEST RIGHT OF WAY LINE OF N. 98<sup>TH</sup> STREET, AND A CHORD LENGTH OF 56.30 FEET TO AN EAST CORNER OF SAID OUTLOT 'D', SAID CORNER ALSO BEING A WEST RIGHT OF WAY CORNER OF N. 98<sup>TH</sup> STREET; THENCE SOUTH 38 DEGREES 12 MINUTES 58 SECONDS WEST, ALONG AN EAST LINE OF SAID OUTLOT 'D', SAID LINE ALSO BEING THE WEST RIGHT OF WAY LINE OF N. 98<sup>TH</sup> STREET, A DISTANCE OF 56.98 FEET TO AN EAST CORNER OF SAID OUTLOT 'D', SAID CORNER ALSO BEING A WEST RIGHT OF WAY CORNER OF N. 98<sup>TH</sup> STREET, SAID POINT BEING A POINT OF CURVATURE; THENCE ALONG A CURVE TO THE LEFT HAVING A RADIUS OF 1,570.00 FEET, A DELTA ANGLE OF 05 DEGREES 39 MINUTES 01 SECONDS, AN ARC LENGTH OF 154.83 FEET, A CHORD BEARING OF SOUTH 35 DEGREES 23 MINUTES 28 SECONDS WEST, ALONG AN EAST LINE OF SAID OUTLOT 'D', SAID LINE ALSO BEING THE WEST RIGHT OF WAY LINE OF N. 98<sup>TH</sup> STREET, AND A CHORD LENGTH OF 154.77 FEET TO AN EAST CORNER OF SAID OUTLOT 'D', SAID CORNER ALSO BEING A WEST RIGHT OF WAY CORNER OF N. 98<sup>TH</sup> STREET; THENCE NORTH 58 DEGREES 38 MINUTES 19 SECONDS WEST, ALONG AN EAST LINE OF SAID OUTLOT 'D', SAID LINE ALSO BEING THE WEST RIGHT OF WAY LINE OF N. 98<sup>TH</sup> STREET, A DISTANCE OF 10.31 FEET TO AN EAST CORNER OF SAID OUTLOT 'D', SAID CORNER ALSO BEING A WEST RIGHT OF WAY CORNER OF N. 98<sup>TH</sup> STREET, SAID POINT BEING A POINT OF CURVATURE; THENCE ALONG A CURVE TO THE RIGHT HAVING A RADIUS OF 417.00 FEET, A DELTA ANGLE OF 01 DEGREES 34 MINUTES 39 SECONDS, AN ARC LENGTH OF 11.48 FEET, A CHORD BEARING OF NORTH 57 DEGREES 51 MINUTES 00 SECONDS WEST, ALONG AN EAST LINE OF SAID OUTLOT 'D', SAID LINE ALSO BEING THE WEST RIGHT OF WAY LINE OF N. 98<sup>TH</sup> STREET, AND A CHORD LENGTH OF 11.48

FEET TO AN EAST CORNER OF SAID OUTLOT 'D', SAID CORNER ALSO BEING A WEST RIGHT OF WAY CORNER OF N. 98<sup>TH</sup> STREET; THENCE SOUTH 32 DEGREES 56 MINUTES 20 SECONDS WEST, ALONG AN EAST LINE OF SAID OUTLOT 'D', SAID LINE ALSO BEING THE WEST RIGHT OF WAY LINE OF N. 98<sup>TH</sup> STREET, A DISTANCE OF 66.00 FEET TO AN EAST CORNER OF SAID OUTLOT 'D', SAID CORNER BEING A WEST RIGHT OF WAY CORNER OF N. 98<sup>TH</sup> STREET, SAID POINT BEING THE POINT OF CURVATURE OF A NON TANGENT CURVE; THENCE ALONG A CURVE TO THE LEFT HAVING A RADIUS OF 483.00 FEET, A DELTA ANGLE OF 01 DEGREES 34 MINUTES 39 SECONDS, AN ARC LENGTH OF 13.30 FEET, A CHORD BEARING OF SOUTH 57 DEGREES 51 MINUTES 00 SECONDS EAST, ALONG AN EAST LINE OF SAID OUTLOT 'D', SAID LINE ALSO BEING THE WEST RIGHT OF WAY LINE OF N. 98<sup>TH</sup> STREET, AND A CHORD LENGTH OF 13.30 FEET TO AN EAST CORNER OF SAID OUTLOT 'D', SAID CORNER ALSO BEING A WEST RIGHT OF WAY CORNER OF N. 98<sup>TH</sup> STREET; THENCE SOUTH 58 DEGREES 38 MINUTES 19 SECONDS EAST, ALONG AN EAST LINE OF SAID OUTLOT 'D', SAID LINE ALSO BEING THE WEST RIGHT OF WAY LINE OF N. 98<sup>TH</sup> STREET, A DISTANCE OF 5.57 FEET TO A POINT; THENCE SOUTH 54 DEGREES 57 MINUTES 21 SECONDS WEST, A DISTANCE OF 79.94 FEET TO A POINT; THENCE SOUTH 70 DEGREES 15 MINUTES 59 SECONDS WEST, A DISTANCE OF 79.93 FEET TO A POINT; THENCE SOUTH 83 DEGREES 57 MINUTES 39 SECONDS WEST, A DISTANCE OF 63.12 FEET TO A POINT; THENCE NORTH 90 DEGREES 00 MINUTES 00 SECONDS WEST, A DISTANCE OF 312.22 FEET TO A POINT; THENCE SOUTH 68 DEGREES 43 MINUTES 04 SECONDS WEST, A DISTANCE OF 64.02 FEET TO A POINT; THENCE SOUTH 88 DEGREES 16 MINUTES 32 SECONDS WEST, A DISTANCE OF 68.77 FEET TO A POINT; THENCE NORTH 69 DEGREES 42 MINUTES 00 SECONDS WEST, A DISTANCE OF 68.77 FEET TO A POINT; THENCE NORTH 47 DEGREES 40 MINUTES 33 SECONDS WEST, A DISTANCE OF 68.77 FEET TO A POINT; THENCE NORTH 25 DEGREES 39 MINUTES 05 SECONDS WEST, A DISTANCE OF 68.77 FEET TO A POINT; THENCE NORTH 09 DEGREES 26 MINUTES 21 SECONDS WEST, A DISTANCE OF 30.10 FEET TO A POINT ON THE WEST LINE OF SAID OUTLOT 'D'; THENCE NORTH 00 DEGREES 12 MINUTES 42 SECONDS EAST, ALONG THE WEST LINE OF SAID OUTLOT 'D', A DISTANCE OF 1,460.27 FEET TO THE POINT OF BEGINNING. SAID TRACT CONTAINS A CALCULATED AREA OF 1,790,417.59 SQUARE FEET OR 41.10 ACRES, MORE OR LESS.

#### RESIDENTIAL PARCEL B

A PORTION OF OUTLOT 'E' AND A PORTION OF OUTLOT 'F', WATERFORD ESTATES ADDITION, AND A PORTION OF OUTLOT 'E', WATERFORD ESTATES 1<sup>ST</sup> ADDITION, ALL LOCATED IN THE NORTHWEST QUARTER OF SECTION 24, AND IN THE NORTHEAST QUARTER OF SECTION 23, TOWNSHIP 10, RANGE 7 EAST OF THE 6TH P.M., CITY OF LINCOLN, LANCASTER COUNTY, NEBRASKA, AND MORE PARTICULARLY DESCRIBED AS FOLLOWS:

BEGINNING AT THE NORTHWEST CORNER OF SAID OUTLOT 'F', WATERFORD ESTATES ADDITION; THENCE, EAST, ALONG THE NORTH LINE OF SAID OUTLOT 'F', SAID LINE ALSO BEING THE SOUTH RIGHT OF WAY LINE OF HOLDREGE STREET, ON AN ASSUMED BEARING OF SOUTH 88 DEGREES 45 MINUTES 34 SECONDS EAST, A DISTANCE OF 2,503.57 FEET TO THE NORTHEAST CORNER OF SAID OUTLOT 'F'; THENCE SOUTH 00 DEGREES 22 MINUTES 04 SECONDS WEST, ALONG A LINE COMMON TO SAID OUTLOT 'F', WATERFORD ESTATES ADDITION AND OUTLOT 'F', WATERFORD ESTATES 1<sup>ST</sup> ADDITION, A DISTANCE OF 502.12 FEET TO A POINT OF CURVATURE; THENCE ALONG A CURVE TO THE RIGHT HAVING A RADIUS OF 500.00 FEET, A DELTA ANGLE OF 23 DEGREES 49 MINUTES 19 SECONDS, AN ARC LENGTH OF 207.89 FEET, A CHORD BEARING OF SOUTH 12 DEGREES 16 MINUTES 44 SECONDS WEST, ALONG A LINE COMMON TO SAID OUTLOT 'F', WATERFORD ESTATES ADDITION AND OUTLOT 'F', WATERFORD ESTATES 1<sup>ST</sup> ADDITION, AND A CHORD LENGTH OF 206.39 FEET TO AN EAST CORNER OF SAID OUTLOT 'F', WATERFORD ESTATES ADDITION; THENCE SOUTH 24 DEGREES 11 MINUTES 24 SECONDS WEST, ALONG A LINE COMMON TO SAID OUTLOT 'F', WATERFORD ESTATES ADDITION AND OUTLOT 'F', WATERFORD ESTATES 1<sup>ST</sup> ADDITION, A DISTANCE OF 29.70 FEET TO A POINT OF CURVATURE; THENCE ALONG A CURVE TO THE LEFT HAVING A RADIUS OF 300.00 FEET, A DELTA ANGLE OF 32 DEGREES 35 MINUTES 00 SECONDS, AN ARC LENGTH OF 170.61 FEET, A CHORD BEARING OF SOUTH 07 DEGREES 53 MINUTES 53 SECONDS WEST, ALONG A LINE COMMON TO SAID OUTLOT 'F', WATERFORD ESTATES ADDITION AND OUTLOT 'F', WATERFORD ESTATES 1<sup>ST</sup> ADDITION, AND A CHORD LENGTH OF 168.32 FEET TO AN EAST CORNER OF SAID OUTLOT 'F', WATERFORD ESTATES ADDITION; THENCE SOUTH 08 DEGREES 23 MINUTES 37 SECONDS EAST, ALONG A LINE COMMON TO SAID OUTLOT 'F', WATERFORD ESTATES ADDITION AND OUTLOT 'F', WATERFORD ESTATES 1<sup>ST</sup> ADDITION, A DISTANCE OF 211.91 FEET TO A SOUTHEAST CORNER OF SAID OUTLOT 'F', WATERFORD ESTATES ADDITION; THENCE SOUTH 81 DEGREES 36 MINUTES 23 SECONDS WEST, ALONG A LINE COMMON TO SAID OUTLOT 'F', WATERFORD ESTATES ADDITION AND OUTLOT 'F', WATERFORD ESTATES 1<sup>ST</sup> ADDITION, A DISTANCE OF 135.00 FEET TO A SOUTH CORNER OF SAID OUTLOT 'F', WATERFORD ESTATES ADDITION; THENCE SOUTH 08 DEGREES 23 MINUTES 37 SECONDS EAST, ALONG A LINE COMMON TO SAID OUTLOT 'F', WATERFORD ESTATES 1<sup>ST</sup> ADDITION AND OUTLOT 'E', WATERFORD ESTATES 1<sup>ST</sup> ADDITION, A DISTANCE OF 144.27 FEET TO A SOUTH CORNER OF SAID OUTLOT 'F'; THENCE NORTH 81 DEGREES 36 MINUTES 23 SECONDS EAST, ALONG A LINE COMMON TO SAID OUTLOT 'F', WATERFORD ESTATES 1<sup>ST</sup> ADDITION AND OUTLOT 'E', WATERFORD ESTATES 1<sup>ST</sup> ADDITION, A DISTANCE OF 120.00 FEET TO A SOUTH CORNER OF SAID OUTLOT 'F'; THENCE SOUTH 08 DEGREES 23 MINUTES 37 SECONDS EAST, ALONG A LINE COMMON TO SAID OUTLOT 'F', WATERFORD ESTATES 1<sup>ST</sup> ADDITION AND OUTLOT 'E', WATERFORD ESTATES 1<sup>ST</sup> ADDITION, A DISTANCE OF 36.17 FEET TO A SOUTH CORNER OF SAID OUTLOT 'F'; THENCE SOUTH 89 DEGREES 50 MINUTES 26 SECONDS EAST, ALONG A LINE COMMON TO SAID OUTLOT 'F', WATERFORD ESTATES 1<sup>ST</sup> ADDITION AND OUTLOT 'E', WATERFORD ESTATES 1<sup>ST</sup> ADDITION, A DISTANCE OF 117.12 FEET TO A SOUTHEAST CORNER OF SAID OUTLOT 'F', SAID POINT BEING AN EAST CORNER OF SAID OUTLOT 'E', WATERFORD ESTATES 1<sup>ST</sup> ADDITION; THENCE SOUTH 00 DEGREES 09 MINUTES 34 SECONDS WEST, ALONG THE EAST LINE OF SAID OUTLOT 'E', A DISTANCE OF 982.88 FEET TO A SOUTHEAST CORNER OF SAID OUTLOT 'E'; THENCE NORTH 22 DEGREES 35 MINUTES 58 SECONDS WEST, ALONG A LINE COMMON TO SAID OUTLOT 'E', WATERFORD ESTATES 1<sup>ST</sup> ADDITION AND OUTLOT 'B', WATERFORD ESTATES 1<sup>ST</sup> ADDITION, A DISTANCE OF 245.30 FEET TO AN EAST CORNER OF SAID OUTLOT 'B'; THENCE NORTH 21 DEGREES 03 MINUTES 09 SECONDS WEST, ALONG A LINE COMMON TO SAID OUTLOT 'E', WATERFORD ESTATES 1<sup>ST</sup> ADDITION AND OUTLOT 'B', WATERFORD ESTATES 1<sup>ST</sup> ADDITION, A DISTANCE OF 80.68 FEET TO AN EAST CORNER OF SAID OUTLOT 'B'; THENCE NORTH 12 DEGREES 49 MINUTES 48 SECONDS WEST, ALONG A LINE COMMON TO SAID OUTLOT 'E', WATERFORD ESTATES 1<sup>ST</sup> ADDITION AND OUTLOT 'B', WATERFORD ESTATES 1<sup>ST</sup> ADDITION, A DISTANCE OF 89.53 FEET TO AN EAST CORNER OF SAID OUTLOT 'B'; THENCE NORTH 03 DEGREES 38 MINUTES 17 SECONDS WEST, ALONG A LINE COMMON TO SAID OUTLOT 'E', WATERFORD ESTATES 1<sup>ST</sup> ADDITION AND OUTLOT 'B', WATERFORD ESTATES 1<sup>ST</sup> ADDITION, A DISTANCE OF 87.41 FEET TO AN EAST CORNER OF SAID OUTLOT 'B'; THENCE NORTH 00 DEGREES 09 MINUTES



34 SECONDS EAST, ALONG A LINE COMMON TO SAID OUTLOT 'E', WATERFORD ESTATES 1<sup>ST</sup> ADDITION AND OUTLOT 'B', WATERFORD ESTATES 1<sup>ST</sup> ADDITION, A DISTANCE OF 196.26 FEET TO AN EAST CORNER OF SAID OUTLOT 'B'; THENCE NORTH 73 DEGREES 27 MINUTES 33 SECONDS WEST, ALONG A LINE COMMON TO SAID OUTLOT 'E', WATERFORD ESTATES 1<sup>ST</sup> ADDITION AND OUTLOT 'B', WATERFORD ESTATES 1<sup>ST</sup> ADDITION, A DISTANCE OF 118.71 FEET TO AN EAST CORNER OF SAID OUTLOT 'B'; THENCE NORTH 52 DEGREES 45 MINUTES 32 SECONDS WEST, ALONG A LINE COMMON TO SAID OUTLOT 'E', WATERFORD ESTATES 1<sup>ST</sup> ADDITION AND OUTLOT 'B', WATERFORD ESTATES 1<sup>ST</sup> ADDITION, A DISTANCE OF 101.18 FEET TO AN EAST CORNER OF SAID OUTLOT 'B'; THENCE NORTH 33 DEGREES 43 MINUTES 37 SECONDS WEST, ALONG A LINE COMMON TO SAID OUTLOT 'E', WATERFORD ESTATES 1<sup>ST</sup> ADDITION AND OUTLOT 'B', WATERFORD ESTATES 1<sup>ST</sup> ADDITION, A DISTANCE OF 101.18 FEET TO AN EAST CORNER OF SAID OUTLOT 'B'; THENCE NORTH 65 DEGREES 47 MINUTES 21 SECONDS EAST, ALONG A LINE COMMON TO SAID OUTLOT 'E', WATERFORD ESTATES 1<sup>ST</sup> ADDITION AND OUTLOT 'B', WATERFORD ESTATES 1<sup>ST</sup> ADDITION, A DISTANCE OF 120.00 FEET TO AN EAST CORNER OF SAID OUTLOT 'B', SAID POINT BEING A POINT OF NON TANGENT CURVATURE; THENCE ALONG A CURVE TO THE RIGHT HAVING A RADIUS OF 186.00 FEET, A DELTA ANGLE OF 15 DEGREES 49 MINUTES 03 SECONDS, AN ARC LENGTH OF 51.35 FEET, A CHORD BEARING OF NORTH 16 DEGREES 18 MINUTES 08 SECONDS WEST, ALONG A LINE COMMON TO SAID OUTLOT 'E', WATERFORD ESTATES 1<sup>ST</sup> ADDITION AND OUTLOT 'B', WATERFORD ESTATES 1<sup>ST</sup> ADDITION, AND A CHORD LENGTH OF 51.19 FEET TO AN EAST CORNER OF SAID OUTLOT 'B'; THENCE NORTH 08 DEGREES 23 MINUTES 37 SECONDS WEST, ALONG A LINE COMMON TO SAID OUTLOT 'E', WATERFORD ESTATES 1<sup>ST</sup> ADDITION AND OUTLOT 'B', WATERFORD ESTATES 1<sup>ST</sup> ADDITION, A DISTANCE OF 180.87 FEET TO AN EAST CORNER OF SAID OUTLOT 'B'; THENCE NORTH 41 DEGREES 00 MINUTES 11 SECONDS EAST, A DISTANCE OF 47.42 FEET TO A POINT ON A WEST LINE OF SAID OUTLOT 'F', WATERFORD ESTATES ADDITION, SAID POINT BEING A SOUTHEAST CORNER OF OUTLOT 'G', WATERFORD ESTATES ADDITION; THENCE NORTH 08 DEGREES 23 MINUTES 37 SECONDS WEST, ALONG A LINE COMMON TO SAID OUTLOT 'G', WATERFORD ESTATES ADDITION AND OUTLOT 'F', WATERFORD ESTATES ADDITION AND OUTLOT 'F', WATERFORD ESTATES ADDITION, A DISTANCE OF 240.29 FEET TO A POINT OF CURVATURE; THENCE ALONG A CURVE TO THE RIGHT HAVING A RADIUS OF 300.00 FEET, A DELTA ANGLE OF 39 DEGREES 54 MINUTES 06 SECONDS, AN ARC LENGTH OF 208.93 FEET, A CHORD BEARING OF NORTH 11 DEGREES 33 MINUTES 26 SECONDS EAST, ALONG A LINE COMMON TO SAID OUTLOT 'G', WATERFORD ESTATES ADDITION AND OUTLOT 'F', WATERFORD ESTATES ADDITION, AND A CHORD LENGTH OF 204.73 FEET TO A POINT OF REVERSE CURVATURE; THENCE ALONG A CURVE TO THE LEFT HAVING A RADIUS OF 300.00 FEET, A DELTA ANGLE OF 31 DEGREES 08 MINUTES 25 SECONDS, AN ARC LENGTH OF 163.05 FEET, A CHORD BEARING OF NORTH 15 DEGREES 56 MINUTES 17 SECONDS EAST, ALONG A LINE COMMON TO SAID OUTLOT 'G', WATERFORD ESTATES ADDITION AND OUTLOT 'F', WATERFORD ESTATES ADDITION, AND A CHORD LENGTH OF 161.05 FEET TO A POINT; THENCE NORTH 00 DEGREES 22 MINUTES 04 SECONDS EAST, ALONG A LINE COMMON TO SAID OUTLOT 'G', WATERFORD ESTATES ADDITION AND OUTLOT 'F', WATERFORD ESTATES ADDITION, A DISTANCE OF 17.02 FEET TO A NORTHEAST CORNER OF SAID OUTLOT 'G'; THENCE NORTH 89 DEGREES 37 MINUTES 56 SECONDS WEST, ALONG A LINE COMMON TO SAID OUTLOT 'G', WATERFORD ESTATES ADDITION AND OUTLOT 'F', WATERFORD ESTATES ADDITION, A DISTANCE OF 36.00 FEET TO A POINT; THENCE NORTH 00 DEGREES 24 MINUTES 41 SECONDS EAST, A DISTANCE OF 200.41 FEET TO A POINT; THENCE NORTH 88 DEGREES 45 MINUTES 34 SECONDS WEST, A DISTANCE OF 1,051.55 FEET TO A POINT; THENCE NORTH 88 DEGREES 01 MINUTES 14 SECONDS WEST, A DISTANCE OF 120.00 FEET TO A POINT; THENCE NORTH 88 DEGREES 45 MINUTES 34 SECONDS WEST, A DISTANCE OF 81.84 FEET TO A POINT; THENCE SOUTH 00 DEGREES 22 MINUTES 04 SECONDS WEST, A DISTANCE OF 165.00 FEET TO A SOUTH CORNER OF SAID OUTLOT 'F', WATERFORD ESTATES ADDITION; THENCE NORTH 89 DEGREES 37 MINUTES 56 SECONDS WEST, ALONG A LINE COMMON TO SAID OUTLOT 'G', WATERFORD ESTATES ADDITION AND OUTLOT 'F', WATERFORD ESTATES ADDITION, A DISTANCE OF 150.00 FEET TO A SOUTHEAST CORNER OF SAID OUTLOT 'F', WATERFORD ESTATES ADDITION, SAID CORNER ALSO BEING A NORTHWEST CORNER OF SAID OUTLOT 'G', WATERFORD ESTATES ADDITION; THENCE SOUTH 00 DEGREES 22 MINUTES 04 SECONDS WEST, ALONG A LINE COMMON TO SAID OUTLOT 'G', WATERFORD ESTATES ADDITION AND OUTLOT 'F', WATERFORD ESTATES ADDITION, A DISTANCE OF 359.77 FEET TO A CORNER COMMON TO SAID OUTLOT 'G' AND SAID OUTLOT 'F', SAID POINT BEING A POINT OF CURVATURE; THENCE ALONG A CURVE TO THE RIGHT HAVING A RADIUS OF 500.00 FEET, A DELTA ANGLE OF 06 DEGREES 52 MINUTES 09 SECONDS, AN ARC LENGTH OF 59.95 FEET, A CHORD BEARING OF SOUTH 03 DEGREES 48 MINUTES 09 SECONDS WEST, ALONG A LINE COMMON TO SAID OUTLOT 'G', WATERFORD ESTATES ADDITION AND OUTLOT 'F', WATERFORD ESTATES ADDITION, AND A CHORD LENGTH OF 59.91 FEET TO A CORNER COMMON TO SAID OUTLOT 'G' AND SAID OUTLOT 'F'; THENCE SOUTH 07 DEGREES 14 MINUTES 13 SECONDS WEST, ALONG A LINE COMMON TO SAID OUTLOT 'G', WATERFORD ESTATES ADDITION AND OUTLOT 'F', WATERFORD ESTATES ADDITION, A DISTANCE OF 225.02 FEET TO A CORNER COMMON TO SAID OUTLOT 'G' AND SAID OUTLOT 'F', SAID POINT BEING A POINT OF CURVATURE; THENCE ALONG A CURVE TO THE RIGHT HAVING A RADIUS OF 500.00 FEET, A DELTA ANGLE OF 12 DEGREES 03 MINUTES 48 SECONDS, AN ARC LENGTH OF 105.27 FEET, A CHORD BEARING OF SOUTH 13 DEGREES 16 MINUTES 08 SECONDS WEST, ALONG A LINE COMMON TO SAID OUTLOT 'G', WATERFORD ESTATES ADDITION AND OUTLOT 'F', WATERFORD ESTATES ADDITION, AND A CHORD LENGTH OF 105.08 FEET TO A CORNER COMMON TO SAID OUTLOT 'G', AND SAID OUTLOT 'F'; THENCE SOUTH 19 DEGREES 18 MINUTES 02 SECONDS WEST, ALONG A LINE COMMON TO SAID OUTLOT 'G', WATERFORD ESTATES ADDITION AND OUTLOT 'F', WATERFORD ESTATES ADDITION, A DISTANCE OF 81.34 FEET TO AN CORNER COMMON TO SAID OUTLOT 'G' AND SAID OUTLOT 'F'; THENCE SOUTH 80 DEGREES 00 MINUTES 48 SECONDS EAST, ALONG A LINE COMMON TO SAID OUTLOT 'G', WATERFORD ESTATES ADDITION AND OUTLOT 'F', WATERFORD ESTATES ADDITION, A DISTANCE OF 120.40 FEET TO A CORNER COMMON TO SAID OUTLOT 'G' AND SAID OUTLOT 'F'; THENCE NORTH 87 DEGREES 40 MINUTES 57 SECONDS EAST, ALONG A LINE COMMON TO SAID OUTLOT 'G', WATERFORD ESTATES ADDITION AND OUTLOT 'F', WATERFORD ESTATES ADDITION, A DISTANCE OF 60.00 FEET TO A CORNER COMMON TO SAID OUTLOT 'G', AND SAID OUTLOT 'F'; THENCE NORTH 80 DEGREES 32 MINUTES 28 SECONDS EAST, ALONG A LINE COMMON TO SAID OUTLOT 'G', WATERFORD ESTATES ADDITION AND OUTLOT 'F', WATERFORD ESTATES ADDITION, A DISTANCE OF 66.74 FEET TO A CORNER COMMON TO SAID OUTLOT 'G', AND SAID OUTLOT 'F'; THENCE NORTH 80 DEGREES 15 MINUTES 07 SECONDS EAST, ALONG A LINE COMMON TO SAID OUTLOT 'G', WATERFORD ESTATES ADDITION AND OUTLOT 'F', WATERFORD ESTATES ADDITION, A DISTANCE OF 434.14 FEET TO A CORNER COMMON TO SAID OUTLOT 'G', AND SAID OUTLOT 'F'; THENCE SOUTH 09 DEGREES 44 MINUTES 53 SECONDS EAST, ALONG A LINE COMMON TO SAID OUTLOT 'G', WATERFORD ESTATES ADDITION AND OUTLOT 'F', WATERFORD ESTATES ADDITION, A DISTANCE OF 150.00 FEET TO A CORNER COMMON TO SAID OUTLOT 'G' AND SAID OUTLOT 'F', SAID POINT ALSO BEING ON A NORTH LINE OF OUTLOT 'E', WATERFORD ESTATES 1<sup>ST</sup> ADDITION; THENCE NORTH 80 DEGREES 15 MINUTES 07 SECONDS EAST, ALONG A LINE COMMON TO SAID OUTLOT 'G', WATERFORD ESTATES ADDITION AND OUTLOT



'E', WATERFORD ESTATES 1<sup>ST</sup> ADDITION, A DISTANCE OF 451.76 FEET TO A POINT; THENCE SOUTH 09 DEGREES 44 MINUTES 53 SECONDS EAST, A DISTANCE OF 150.00 FEET TO A CORNER COMMON TO SAID OUTLOT 'E', WATERFORD ESTATES 1<sup>ST</sup> ADDITION AND SAID OUTLOT 'B', WATERFORD ESTATES 1<sup>ST</sup> ADDITION; THENCE SOUTH 80 DEGREES 15 MINUTES 07 SECONDS WEST, ALONG A LINE COMMON TO SAID OUTLOT 'E', WATERFORD ESTATES 1<sup>ST</sup> ADDITION AND OUTLOT 'B', WATERFORD ESTATES 1<sup>ST</sup> ADDITION, A DISTANCE OF 804.00 FEET TO A CORNER COMMON TO SAID OUTLOT 'E' AND SAID OUTLOT 'B', WATERFORD ESTATES 1<sup>ST</sup> ADDITION; THENCE NORTH 54 DEGREES 44 MINUTES 53 SECONDS WEST, ALONG A LINE COMMON TO SAID OUTLOT 'E', WATERFORD ESTATES 1<sup>ST</sup> ADDITION AND OUTLOT 'B', WATERFORD ESTATES 1<sup>ST</sup> ADDITION, A DISTANCE OF 14.14 TO A CORNER COMMON TO SAID OUTLOT 'E' AND SAID OUTLOT 'B', WATERFORD ESTATES 1<sup>ST</sup> ADDITION; THENCE NORTH 09 DEGREES 44 MINUTES 53 SECONDS WEST, ALONG A LINE COMMON TO SAID OUTLOT 'E', WATERFORD ESTATES 1<sup>ST</sup> ADDITION AND OUTLOT 'B', WATERFORD ESTATES 1<sup>ST</sup> ADDITION, A DISTANCE OF 110.00 FEET TO A CORNER COMMON TO SAID OUTLOT 'E' AND SAID OUTLOT 'B', WATERFORD ESTATES 1<sup>ST</sup> ADDITION; THENCE SOUTH 80 DEGREES 15 MINUTES 07 SECONDS WEST, ALONG A LINE COMMON TO SAID OUTLOT 'E', WATERFORD ESTATES 1<sup>ST</sup> ADDITION AND OUTLOT 'B', WATERFORD ESTATES 1<sup>ST</sup> ADDITION, A DISTANCE OF 123.29 FEET TO A CORNER COMMON TO SAID OUTLOT 'E' AND SAID OUTLOT 'B', WATERFORD ESTATES 1<sup>ST</sup> ADDITION, SAID POINT BEING A POINT OF CURVATURE; THENCE ALONG A CURVE TO THE RIGHT HAVING A RADIUS OF 530.00 FEET, A DELTA ANGLE OF 02 DEGREES 27 MINUTES 21 SECONDS, AN ARC LENGTH OF 22.72 FEET, A CHORD BEARING OF SOUTH 81 DEGREES 28 MINUTES 48 SECONDS WEST, ALONG A LINE COMMON TO SAID OUTLOT 'E', WATERFORD ESTATES 1<sup>ST</sup> ADDITION AND OUTLOT 'B', WATERFORD ESTATES 1<sup>ST</sup> ADDITION, AND A CHORD LENGTH OF 22.72 FEET TO A CORNER COMMON TO SAID OUTLOT 'E' AND SAID OUTLOT 'B', WATERFORD ESTATES 1<sup>ST</sup> ADDITION; THENCE NORTH 07 DEGREES 17 MINUTES 32 SECONDS WEST A DISTANCE OF 30.00 FEET TO A POINT ON A NORTH LINE OF SAID OUTLOT 'E', WATERFORD ESTATES 1<sup>ST</sup> ADDITION, SAID POINT ALSO BEING ON A SOUTH LINE OF SAID OUTLOT 'F', WATERFORD ESTATES ADDITION, SAID POINT BEING A POINT OF NON-TANGENT CURVATURE; THENCE ALONG A CURVE TO THE RIGHT HAVING A RADIUS OF 500.00 FEET, A DELTA ANGLE OF 28 DEGREES 40 MINUTES 56 SECONDS, AN ARC LENGTH OF 250.30 FEET, A CHORD BEARING OF NORTH 82 DEGREES 57 MINUTES 03 SECONDS WEST, ALONG A LINE COMMON TO SAID OUTLOT 'E', WATERFORD ESTATES 1<sup>ST</sup> ADDITION AND OUTLOT 'F', WATERFORD ESTATES ADDITION, AND A CHORD LENGTH OF 247.70 FEET TO A CORNER COMMON TO SAID OUTLOT 'E', WATERFORD ESTATES 1<sup>ST</sup> ADDITION AND OUTLOT 'F', WATERFORD ESTATES ADDITION; THENCE SOUTH 19 DEGREES 18 MINUTES 02 SECONDS WEST, ALONG A LINE COMMON TO SAID OUTLOT 'E', WATERFORD ESTATES 1<sup>ST</sup> ADDITION AND OUTLOT 'F', WATERFORD ESTATES ADDITION, A DISTANCE OF 47.40 FEET TO A CORNER COMMON TO SAID OUTLOT 'E', WATERFORD ESTATES 1<sup>ST</sup> ADDITION AND OUTLOT 'F', WATERFORD ESTATES ADDITION, SAID POINT BEING A POINT OF CURVATURE; THENCE ALONG A CURVE TO THE RIGHT HAVING A RADIUS OF 1,000.00 FEET, A DELTA ANGLE OF 05 DEGREES 28 MINUTES 21 SECONDS, AN ARC LENGTH OF 95.51 FEET, A CHORD BEARING OF SOUTH 22 DEGREES 02 MINUTES 13 SECONDS WEST, ALONG A LINE COMMON TO SAID OUTLOT 'E', WATERFORD ESTATES 1<sup>ST</sup> ADDITION AND OUTLOT 'F', WATERFORD ESTATES ADDITION, AND A CHORD LENGTH OF 95.48 FEET TO A CORNER COMMON TO SAID OUTLOT 'E', WATERFORD ESTATES 1<sup>ST</sup> ADDITION AND OUTLOT 'F', WATERFORD ESTATES ADDITION, SAID POINT BEING A POINT OF COMPOUND CURVATURE; THENCE ALONG A CURVE TO THE RIGHT HAVING A RADIUS OF 2,285.00 FEET, A DELTA ANGLE OF 13 DEGREES 03 MINUTES 27 SECONDS, AN ARC LENGTH OF 520.75 FEET, A CHORD BEARING OF SOUTH 31 DEGREES 18 MINUTES 06 SECONDS WEST, ALONG A LINE COMMON TO SAID OUTLOT 'E', WATERFORD ESTATES 1<sup>ST</sup> ADDITION AND OUTLOT 'F', WATERFORD ESTATES ADDITION, AND A CHORD LENGTH OF 519.62 FEET TO A CORNER COMMON TO SAID OUTLOT 'E', WATERFORD ESTATES 1<sup>ST</sup> ADDITION AND OUTLOT 'F', WATERFORD ESTATES ADDITION, SAID POINT BEING A POINT OF COMPOUND CURVATURE; THENCE ALONG A CURVE TO THE RIGHT HAVING A RADIUS OF 285.00 FEET, A DELTA ANGLE OF 11 DEGREES 00 MINUTES 45 SECONDS, AN ARC LENGTH OF 54.78 FEET, A CHORD BEARING OF SOUTH 43 DEGREES 20 MINUTES 13 SECONDS WEST, ALONG A LINE COMMON TO SAID OUTLOT 'E', WATERFORD ESTATES 1<sup>ST</sup> ADDITION AND OUTLOT 'F', WATERFORD ESTATES ADDITION, AND A CHORD LENGTH OF 54.69 FEET TO A CORNER COMMON TO SAID OUTLOT 'E', WATERFORD ESTATES 1<sup>ST</sup> ADDITION AND OUTLOT 'F', WATERFORD ESTATES ADDITION; THENCE SOUTH 48 DEGREES 50 MINUTES 35 SECONDS WEST, ALONG A LINE COMMON TO SAID OUTLOT 'E', WATERFORD ESTATES 1<sup>ST</sup> ADDITION AND OUTLOT 'F', WATERFORD ESTATES ADDITION, A DISTANCE OF 162.00 FEET TO A CORNER COMMON TO SAID OUTLOT 'E', WATERFORD ESTATES 1<sup>ST</sup> ADDITION AND OUTLOT 'F', WATERFORD ESTATES ADDITION, SAID POINT BEING A POINT OF CURVATURE; THENCE ALONG A CURVE TO THE RIGHT HAVING A RADIUS OF 150.00 FEET, A DELTA ANGLE OF 79 DEGREES 40 MINUTES 18 SECONDS, AN ARC LENGTH OF 208.58 FEET, A CHORD BEARING OF SOUTH 88 DEGREES 40 MINUTES 44 SECONDS WEST, ALONG A LINE COMMON TO SAID OUTLOT 'E', WATERFORD ESTATES 1<sup>ST</sup> ADDITION AND OUTLOT 'F', WATERFORD ESTATES ADDITION, AND A CHORD LENGTH OF 192.18 FEET TO A CORNER COMMON TO SAID OUTLOT 'E', WATERFORD ESTATES 1<sup>ST</sup> ADDITION AND OUTLOT 'F', WATERFORD ESTATES ADDITION; THENCE NORTH 51 DEGREES 29 MINUTES 07 SECONDS WEST, ALONG A LINE COMMON TO SAID OUTLOT 'E', WATERFORD ESTATES 1<sup>ST</sup> ADDITION AND OUTLOT 'F', WATERFORD ESTATES ADDITION, A DISTANCE OF 254.52 FEET TO A CORNER COMMON TO OUTLOT 'E', WATERFORD ESTATES 1<sup>ST</sup> ADDITION AND OUTLOT 'E', WATERFORD ESTATES ADDITION; THENCE SOUTH 38 DEGREES 30 MINUTES 53 SECONDS WEST, ALONG A LINE COMMON TO SAID OUTLOT 'E', WATERFORD ESTATES 1<sup>ST</sup> ADDITION AND OUTLOT 'E', WATERFORD ESTATES ADDITION, A DISTANCE OF 130.00 FEET TO A POINT; THENCE NORTH 51 DEGREES 29 MINUTES 07 SECONDS WEST, A DISTANCE OF 150.00 FEET TO A POINT; THENCE NORTH 38 DEGREES 30 MINUTES 53 SECONDS EAST, A DISTANCE OF 130.00 FEET TO A POINT ON A LINE COMMON TO SAID OUTLOT 'E', WATERFORD ESTATES ADDITION AND OUTLOT 'F', WATERFORD ESTATES ADDITION; THENCE NORTH 51 DEGREES 29 MINUTES 07 SECONDS WEST, ALONG A LINE COMMON TO SAID OUTLOT 'E', WATERFORD ESTATES ADDITION AND OUTLOT 'F', WATERFORD ESTATES ADDITION, A DISTANCE OF 263.76 FEET TO A CORNER COMMON TO SAID OUTLOT 'E' AND SAID OUTLOT 'F', WATERFORD ESTATES ADDITION, SAID POINT BEING A POINT OF CURVATURE; THENCE ALONG A CURVE TO THE LEFT HAVING A RADIUS OF 1,000.00 FEET, A DELTA ANGLE OF 07 DEGREES 09 MINUTES 12 SECONDS, AN ARC LENGTH OF 124.85 FEET, A CHORD BEARING OF NORTH 55 DEGREES 03 MINUTES 43 SECONDS WEST, ALONG A LINE COMMON TO SAID OUTLOT 'E', WATERFORD ESTATES ADDITION AND OUTLOT 'F', WATERFORD ESTATES ADDITION, AND A CHORD LENGTH OF 124.77 FEET TO A CORNER COMMON TO SAID OUTLOT 'E' AND SAID OUTLOT 'F', WATERFORD ESTATES ADDITION; THENCE NORTH 58 DEGREES 38 MINUTES 19 SECONDS WEST, ALONG A LINE COMMON TO SAID OUTLOT 'E', WATERFORD ESTATES ADDITION AND OUTLOT 'F', WATERFORD ESTATES ADDITION, A DISTANCE OF 20.66 FEET TO A CORNER COMMON TO SAID OUTLOT 'E' AND SAID OUTLOT 'F', WATERFORD ESTATES ADDITION, SAID POINT BEING LOCATED ON THE EAST RITHG OF WAY LINE OF N. 98<sup>TH</sup> STREET; THENCE NORTH 31 DEGREES 11 MINUTES 43 SECONDS EAST, ALONG A WEST LINE OF SAID OUTLOT 'F', SAID LINE ALSO BEING THE EAST

RIGHT OF WAY LINE OF N. 98<sup>TH</sup> STREET, A DISTANCE OF 33.00 FEET TO A WEST CORNER OF SAID OUTLOT 'F', SAID POINT ALSO BEING AN EAST RIGHT OF WAY CORNER OF N. 98<sup>TH</sup> STREET; THENCE NORTH 58 DEGREES 38 MINUTES 19 SECONDS WEST, ALONG A WEST LINE OF SAID OUTLOT 'F', SAID LINE ALSO BEING THE EAST RIGHT OF WAY LINE OF N. 98<sup>TH</sup> STREET, A DISTANCE OF 24.06 FEET TO A WEST CORNER OF SAID OUTLOT 'F', SAID POINT ALSO BEING AN EAST RIGHT OF WAY CORNER OF N. 98<sup>TH</sup> STREET; THENCE NORTH 09 DEGREES 34 MINUTES 47 SECONDS EAST, ALONG A WEST LINE OF SAID OUTLOT 'F', SAID LINE ALSO BEING THE EAST RIGHT OF WAY LINE OF N. 98<sup>TH</sup> STREET, A DISTANCE OF 20.08 FEET TO A WEST CORNER OF SAID OUTLOT 'F', SAID POINT BEING AN EAST RIGHT OF WAY CORNER OF N. 98<sup>TH</sup> STREET, SAID POINT BEING THE POINT OF CURVATURE OF A NON TANGENT CURVE; THENCE ALONG A CURVE TO THE RIGHT HAVING A RADIUS OF 1,440.00 FEET, A DELTA ANGLE OF 04 DEGREES 47 MINUTES 58 SECONDS, AN ARC LENGTH OF 120.62 FEET, A CHORD BEARING OF NORTH 35 DEGREES 48 MINUTES 59 SECONDS EAST, ALONG A WEST LINE OF SAID OUTLOT 'F', SAID LINE ALSO BEING THE EAST RIGHT OF WAY LINE OF N. 98<sup>TH</sup> STREET, AND A CHORD LENGTH OF 120.59 FEET TO A WEST CORNER OF SAID OUTLOT 'F', SAID POINT ALSO BEING AN EAST RIGHT OF WAY CORNER OF N. 98<sup>TH</sup> STREET; THENCE NORTH 38 DEGREES 12 MINUTES 58 SECONDS EAST, ALONG A WEST LINE OF SAID OUTLOT 'F', SAID LINE ALSO BEING THE EAST RIGHT OF WAY LINE OF N. 98<sup>TH</sup> STREET, A DISTANCE OF 202.67 FEET TO A WEST CORNER OF SAID OUTLOT 'F', SAID POINT BEING AN EAST RIGHT OF WAY CORNER OF N. 98<sup>TH</sup> STREET, SAID POINT BEING A POINT OF CURVATURE; THENCE ALONG A CURVE TO THE LEFT HAVING A RADIUS OF 1,060.00 FEET, A DELTA ANGLE OF 30 DEGREES 56 MINUTES 20 SECONDS, AN ARC LENGTH OF 572.39 FEET, A CHORD BEARING OF NORTH 22 DEGREES 44 MINUTES 48 SECONDS EAST, ALONG A WEST LINE OF SAID OUTLOT 'F', SAID LINE ALSO BEING THE EAST RIGHT OF WAY LINE OF N. 98<sup>TH</sup> STREET, AND A CHORD LENGTH OF 565.46 FEET TO A WEST CORNER OF SAID OUTLOT 'F', SAID POINT ALSO BEING AN EAST RIGHT OF WAY CORNER OF N. 98<sup>TH</sup> STREET; THENCE NORTH 18 DEGREES 22 MINUTES 02 SECONDS EAST, ALONG A WEST LINE OF SAID OUTLOT 'F', SAID LINE ALSO BEING THE EAST RIGHT OF WAY LINE OF N. 98<sup>TH</sup> STREET, A DISTANCE OF 4.62 FEET TO A WEST CORNER OF SAID OUTLOT 'F', SAID POINT ALSO BEING AN EAST RIGHT OF WAY CORNER OF N. 98<sup>TH</sup> STREET; THENCE SOUTH 84 DEGREES 35 MINUTES 17 SECONDS EAST, ALONG A WEST LINE OF SAID OUTLOT 'F', SAID LINE ALSO BEING THE EAST RIGHT OF WAY LINE OF N. 98<sup>TH</sup> STREET, A DISTANCE OF 30.65 FEET TO A WEST CORNER OF SAID OUTLOT 'F', SAID POINT ALSO BEING AN EAST RIGHT OF WAY CORNER OF N. 98<sup>TH</sup> STREET; THENCE NORTH 05 DEGREES 24 MINUTES 43 SECONDS EAST, ALONG A WEST LINE OF SAID OUTLOT 'F', SAID LINE ALSO BEING THE EAST RIGHT OF WAY LINE OF N. 98<sup>TH</sup> STREET, A DISTANCE OF 60.00 FEET TO A WEST CORNER OF SAID OUTLOT 'F', SAID POINT ALSO BEING AN EAST RIGHT OF WAY CORNER OF N. 98<sup>TH</sup> STREET; THENCE NORTH 84 DEGREES 35 MINUTES 17 SECONDS WEST, ALONG A WEST LINE OF SAID OUTLOT 'F', SAID LINE ALSO BEING THE EAST RIGHT OF WAY LINE OF N. 98<sup>TH</sup> STREET, A DISTANCE OF 27.95 FEET TO A WEST CORNER OF SAID OUTLOT 'F', SAID POINT ALSO BEING AN EAST RIGHT OF WAY CORNER OF N. 98<sup>TH</sup> STREET; THENCE NORTH 08 DEGREES 12 MINUTES 39 SECONDS WEST, ALONG A WEST LINE OF SAID OUTLOT 'F', SAID LINE ALSO BEING THE EAST RIGHT OF WAY LINE OF N. 98<sup>TH</sup> STREET, A DISTANCE OF 18.02 FEET TO A WEST CORNER OF SAID OUTLOT 'F', SAID POINT BEING AN EAST RIGHT OF WAY CORNER OF N. 98<sup>TH</sup> STREET, SAID POINT ALSO BEING THE POINT OF CURVATURE OF A NON TANGENT CURVE; THENCE ALONG A CURVE TO THE LEFT HAVING A RADIUS OF 1,060.00 FEET, A DELTA ANGLE OF 02 DEGREES 28 MINUTES 31 SECONDS, AN ARC LENGTH OF 45.79 FEET, A CHORD BEARING OF NORTH 01 DEGREES 36 MINUTES 20 SECONDS EAST, ALONG A WEST LINE OF SAID OUTLOT 'F', SAID LINE ALSO BEING THE EAST RIGHT OF WAY LINE OF N. 98<sup>TH</sup> STREET, AND A CHORD LENGTH OF 45.79 FEET TO A WEST CORNER OF SAID OUTLOT 'F', SAID POINT ALSO BEING AN EAST RIGHT OF WAY CORNER OF N. 98<sup>TH</sup> STREET; THENCE NORTH 00 DEGREES 22 MINUTES 04 SECONDS EAST, ALONG A WEST LINE OF SAID OUTLOT 'F', SAID LINE ALSO BEING THE EAST RIGHT OF WAY LINE OF N. 98<sup>TH</sup> STREET, A DISTANCE OF 223.67 FEET TO A WEST CORNER OF SAID OUTLOT 'F', SAID POINT BEING AN EAST RIGHT OF WAY CORNER OF N. 98<sup>TH</sup> STREET, SAID POINT BEING A POINT OF CURVATURE; THENCE ALONG A CURVE TO THE RIGHT HAVING A RADIUS OF 320.00 FEET, A DELTA ANGLE OF 10 DEGREES 09 MINUTES 28 SECONDS, AN ARC LENGTH OF 56.73 FEET, A CHORD BEARING OF NORTH 05 DEGREES 26 MINUTES 48 SECONDS EAST, ALONG A WEST LINE OF SAID OUTLOT 'F', SAID LINE ALSO BEING THE EAST RIGHT OF WAY LINE OF N. 98<sup>TH</sup> STREET, AND A CHORD LENGTH OF 56.66 FEET TO A WEST CORNER OF SAID OUTLOT 'F', SAID POINT BEING AN EAST RIGHT OF WAY CORNER OF N. 98<sup>TH</sup> STREET, SAID POINT BEING A POINT OF REVERSE CURVATURE; THENCE ALONG A CURVE TO THE LEFT HAVING A RADIUS OF 318.00 FEET, A DELTA ANGLE OF 10 DEGREES 09 MINUTES 28 SECONDS, AN ARC LENGTH OF 56.38 FEET, A CHORD BEARING OF NORTH 05 DEGREES 26 MINUTES 48 SECONDS EAST, ALONG A WEST LINE OF SAID OUTLOT 'F', SAID LINE ALSO BEING THE EAST RIGHT OF WAY LINE OF N. 98<sup>TH</sup> STREET, AND A CHORD LENGTH OF 56.30 FEET TO A WEST CORNER OF SAID OUTLOT 'F', SAID POINT ALSO BEING AN EAST RIGHT OF WAY CORNER OF N. 98<sup>TH</sup> STREET; THENCE NORTH 00 DEGREES 22 MINUTES 04 SECONDS EAST, ALONG A WEST LINE OF SAID OUTLOT 'F', SAID LINE ALSO BEING THE EAST RIGHT OF WAY LINE OF N. 98<sup>TH</sup> STREET, A DISTANCE OF 254.96 FEET TO THE POINT OF BEGINNING. SAID TRACT CONTAINS A CALCULATED AREA OF 3,068,436.44 SQUARE FEET OR 70.44 ACRES, MORE OR LESS.

#### RESIDENTIAL PARCEL C

LOTS 1 THROUGH 51, BLOCK 5 AND OUTLOT 'A', WATERFORD ESTATES 1<sup>ST</sup> ADDITION, LOCATED IN THE SOUTHWEST QUARTER OF SECTION 24, TOWNSHIP 10, RANGE 7 EAST OF THE 6TH P.M., CITY OF LINCOLN, LANCASTER COUNTY, NEBRASKA;

AND

A PORTION OF OUTLOT 'G', WATERFORD ESTATES 1<sup>ST</sup> ADDITION, LOCATED IN THE SOUTHWEST QUARTER OF SECTION 24, TOWNSHIP 10, RANGE 7 EAST OF THE 6TH P.M., CITY OF LINCOLN, LANCASTER COUNTY, NEBRASKA, AND MORE PARTICULARLY DESCRIBED AS FOLLOWS:

BEGINNING AT THE SOUTHEAST CORNER OF SAID OUTLOT 'G', THENCE WEST ALONG THE SOUTH LINE OF SAID OUTLOT 'G', SAID LINE ALSO BEING THE NORTH RIGHT OF WAY LINE OF 'O' STREET, ON AN ASSUMED BEARING OF NORTH 89 DEGREES 21 MINUTES 18 SECONDS WEST, A DISTANCE OF 550.00 FEET TO A SOUTH CORNER OF SAID OUTLOT 'G', SAID POINT ALSO BEING A NORTH RIGHT OF WAY CORNER OF 'O' STREET; THENCE NORTH 88 DEGREES 57 MINUTES 48 SECONDS WEST, ALONG A SOUTH LINE OF SAID OUTLOT 'G', SAID LINE ALSO BEING A NORTH RIGHT OF WAY LINE OF 'O' STREET, A DISTANCE OF 259.85 FEET TO A SOUTHWEST CORNER OF SAID OUTLOT 'G', SAID POINT BEING THE SOUTHEAST

CORNER OF LOT 10 I.T., SAID POINT BEING A NORTH RIGHT OF WAY CORNER OF 'O' STREET; THENCE NORTH 00 DEGREES 13 MINUTES 22 SECONDS EAST, ALONG A WEST LINE OF SAID OUTLOT 'G', SAID LINE ALSO BEING THE EAST LINE OF SAID LOT 10 I.T., A DISTANCE OF 494.92 FEET TO A WEST CORNER OF SAID OUTLOT 'G', SAID CORNER ALSO BEING THE NORTHEAST CORNER OF SAID LOT 10 I.T.; THENCE NORTH 88 DEGREES 57 MINUTES 49 SECONDS WEST, ALONG A SOUTH LINE OF SAID OUTLOT 'G', SAID LINE ALSO BEING THE NORTH LINE OF SAID LOT 10 I.T, A DISTANCE OF 100.29 FEET TO A POINT; THENCE NORTH 00 DEGREES 48 MINUTES 28 SECONDS WEST, ALONG A WEST LINE OF SAID OUTLOT 'G', SAID LINE BEING THE EAST LINE OF OUTLOT 'H' AND THE EAST LINE OF OUTLOT 'A', WATERFORD ESTATES 1<sup>ST</sup> ADDITION, A DISTANCE OF 925.71 FEET TO A WEST CORNER OF SAID OUTLOT 'G'; THENCE NORTH 12 DEGREES 42 MINUTES 46 SECONDS WEST, ALONG THE WEST LINE OF SAID OUTLOT 'G', SAID LINE BEING THE EAST LINE OF SAID OUTLOT 'A', A DISTANCE OF 127.15 FEET TO A WEST CORNER OF SAID OUTLOT 'G', SAID POINT BEING ON THE SOUTH RIGHT-OF-WAY LINE OF SHORE FRONT DRIVE; THENCE NORTH 77 DEGREES 17 MINUTES 14 SECONDS EAST, ALONG SAID SOUTH RIGHT OF WAY LINE, A DISTANCE OF 23.50 FEET TO A WEST CORNER OF SAID OUTLOT 'G', SAID POINT BEING A SOUTHEAST RIGHT OF WAY CORNER OF SHORE FRONT DRIVE; THENCE NORTH 12 DEGREES 42 MINUTES 46 SECONDS WEST, ALONG A WEST LINE OF SAID OUTLOT 'G' AND ALONG THE EAST RIGHT OF WAY LINE OF SAID SHORE LINE DRIVE, A DISTANCE OF 30.00 FEET TO A POINT; THENCE NORTH 77 DEGREES 17 MINUTES 14 SECONDS EAST, A DISTANCE OF 417.76 FEET TO A POINT OF CURVATURE; THENCE ALONG A CURVE TO THE RIGHT HAVING A RADIUS OF 615.00 FEET, A DELTA ANGLE OF 12 DEGREES 52 MINUTES 57 SECONDS, AN ARC LENGTH OF 138.28 FEET, A CHORD BEARING OF NORTH 83 DEGREES 43 MINUTES 42 SECONDS EAST, AND A CHORD LENGTH OF 137.99 FEET TO A POINT; THENCE SOUTH 89 DEGREES 49 MINUTES 50 SECONDS EAST, A DISTANCE OF 393.17 FEET TO A POINT ON THE EAST LINE OF SAID OUTLOT 'G'; THENCE SOUTH 00 DEGREES 10 MINUTES 10 SECONDS WEST, ALONG THE EAST LINE OF SAID OUTLOT 'G', SAID LINE BEING THE EAST LINE OF SAID SOUTHWEST QUARTER, A DISTANCE OF 1,697.56 FEET TO THE POINT OF BEGINNING, EXCEPT FOR THAT PORTION THAT IS DESCRIBED AS "LAKE (PARCEL B)" ON EXHIBIT "C" ABOVE.

#### RESIDENTIAL PARCEL D

LOTS 33 THRU 43, BLOCK 2, LOTS 1 THRU 17, BLOCK 3, AND OUTLOT 'B', WATERFORD ESTATES ADDITION, LINCOLN, LANCASTER COUNTY, NEBRASKA.

#### RESIDENTIAL PARCEL E

A PORTION OF OUTLOT 'D', WATERFORD ESTATES ADDITION, LOCATED IN THE EAST ONE-HALF OF SECTION 23, TOWNSHIP 10, RANGE 7 EAST OF THE 6TH P.M., CITY OF LINCOLN, LANCASTER COUNTY, NEBRASKA, AND MORE PARTICULARLY DESCRIBED AS FOLLOWS:

BEGINNING AT A NORTHWEST CORNER OF SAID OUTLOT 'D', SAID POINT ALSO BEING THE NORTHWEST CORNER OF THE SOUTHEAST QUARTER OF SAID SECTION 23; THENCE EAST ALONG A NORTH LINE OF SAID OUTLOT 'D', SAID LINE ALSO BEING THE NORTH LINE OF SAID SOUTHEAST QUARTER, ON AN ASSUMED BEARING OF SOUTH 89 DEGREES 25 MINUTES 50 SECONDS EAST, A DISTANCE OF 1,308.26 FEET TO A NORTH CORNER OF SAID OUTLOT 'D'; THENCE NORTH 00 DEGREES 10 MINUTES 15 SECONDS EAST, ALONG A WEST LINE OF SAID OUTLOT 'D', A DISTANCE OF 504.87 FEET TO A POINT; THENCE NORTH 11 DEGREES 38 MINUTES 47 SECONDS EAST, A DISTANCE OF 99.43 FEET TO A POINT; THENCE NORTH 30 DEGREES 23 MINUTES 12 SECONDS EAST, A DISTANCE OF 93.42 FEET TO A POINT; THENCE NORTH 48 DEGREES 36 MINUTES 25 SECONDS EAST, A DISTANCE OF 93.42 FEET TO A POINT; THENCE NORTH 66 DEGREES 49 MINUTES 38 SECONDS EAST, A DISTANCE OF 93.42 FEET TO A POINT; THENCE NORTH 85 DEGREES 02 MINUTES 51 SECONDS EAST, A DISTANCE OF 93.42 FEET TO A POINT; THENCE SOUTH 84 DEGREES 41 MINUTES 17 SECONDS EAST, A DISTANCE OF 11.88 FEET TO A POINT; THENCE SOUTH 83 DEGREES 32 MINUTES 03 SECONDS EAST, A DISTANCE OF 164.47 FEET TO A POINT; THENCE SOUTH 78 DEGREES 32 MINUTES 03 SECONDS EAST, A DISTANCE OF 178.36 FEET TO A POINT ON AN EAST LINE OF SAID OUTLOT 'D', SAID POINT ALSO BEING ON A WEST RIGHT OF WAY LINE OF N. 98<sup>TH</sup> STREET, SAID POINT BEING A POINT OF CURVATURE OF A NON TANGENT CURVE; THENCE ALONG A CURVE TO THE LEFT HAVING A RADIUS OF 1,560.00 FEET, A DELTA ANGLE OF 04 DEGREES 03 MINUTES 36 SECONDS, AN ARC LENGTH OF 110.54 FEET, A CHORD BEARING OF SOUTH 14 DEGREES 57 MINUTES 39 SECONDS WEST, ALONG AN EAST LINE OF SAID OUTLOT 'D', SAID LINE ALSO BEING A WEST RIGHT OF WAY LINE OF N. 98<sup>TH</sup> STREET, AND A CHORD LENGTH OF 110.52 FEET TO AN EAST CORNER OF SAID OUTLOT 'D', SAID POINT ALSO BEING A WEST RIGHT OF WAY CORNER OF N. 98<sup>TH</sup> STREET; THENCE SOUTH 24 DEGREES 22 MINUTES 39 SECONDS WEST, ALONG AN EAST LINE OF SAID OUTLOT 'D', SAID LINE ALSO BEING A WEST RIGHT OF WAY LINE OF N. 98<sup>TH</sup> STREET, A DISTANCE OF 4.81 FEET TO A POINT; THENCE NORTH 78 DEGREES 32 MINUTES 03 SECONDS WEST, ALONG AN EAST LINE OF SAID OUTLOT 'D', SAID LINE ALSO BEING A WEST RIGHT OF WAY LINE OF N. 98<sup>TH</sup> STREET, A DISTANCE OF 30.69 FEET TO AN EAST CORNER OF SAID OUTLOT 'D', SAID POINT ALSO BEING A WEST RIGHT OF WAY CORNER OF N. 98<sup>TH</sup> STREET; THENCE SOUTH 11 DEGREES 27 MINUTES 57 SECONDS WEST, ALONG AN EAST LINE OF SAID OUTLOT 'D', SAID LINE ALSO BEING A WEST RIGHT OF WAY LINE OF N. 98<sup>TH</sup> STREET, A DISTANCE OF 60.00 FEET TO AN EAST CORNER OF SAID OUTLOT 'D', SAID POINT ALSO BEING A WEST RIGHT OF WAY CORNER OF N. 98<sup>TH</sup> STREET; THENCE SOUTH 78 DEGREES 32 MINUTES 03 SECONDS EAST, ALONG AN EAST LINE OF SAID OUTLOT 'D', SAID LINE ALSO BEING A WEST RIGHT OF WAY LINE OF N. 98<sup>TH</sup> STREET; THENCE SOUTH 01 DEGREES 32 MINUTES 27 SECONDS EAST, ALONG AN EAST LINE OF SAID OUTLOT 'D', SAID LINE ALSO BEING A WEST RIGHT OF WAY LINE OF N. 98<sup>TH</sup> STREET, A DISTANCE OF 18.14 FEET TO THE POINT OF CURVATURE OF A NON TANGENT CURVE; THENCE ALONG A CURVE TO THE LEFT HAVING A RADIUS OF 1,560.00 FEET, A DELTA ANGLE OF 09 DEGREES 31 MINUTES 25 SECONDS, AN ARC LENGTH OF 259.30 FEET, A CHORD BEARING OF SOUTH 05 DEGREES 08 MINUTES 38 SECONDS WEST, ALONG AN EAST LINE OF SAID OUTLOT 'D', SAID LINE ALSO BEING A WEST RIGHT OF WAY LINE OF N. 98<sup>TH</sup> STREET, AND A CHORD LENGTH OF 259.00 FEET TO AN EAST CORNER OF SAID OUTLOT 'D', SAID POINT ALSO BEING A WEST RIGHT OF WAY CORNER OF N. 98<sup>TH</sup> STREET; THENCE SOUTH 00 DEGREES 22 MINUTES 55 SECONDS WEST, ALONG AN EAST LINE OF SAID OUTLOT 'D', SAID LINE ALSO BEING A WEST RIGHT OF WAY LINE OF N. 98<sup>TH</sup> STREET, A DISTANCE OF 585.93 FEET TO A POINT OF CURVATURE; THENCE ALONG A CURVE TO THE RIGHT HAVING A RADIUS OF 320.00 FEET, A DELTA ANGLE OF 10 DEGREES 09 MINUTES 28 SECONDS, AN ARC LENGTH OF 56.73 FEET, A CHORD BEARING OF SOUTH 05 DEGREES 27 MINUTES 39 SECONDS WEST, ALONG AN EAST LINE

OF SAID OUTLOT 'D', SAID LINE ALSO BEING A WEST RIGHT OF WAY LINE OF N. 98<sup>TH</sup> STREET, AND A CHORD LENGTH OF 56.66 FEET TO A POINT OF REVERSE CURVATURE; THENCE ALONG A CURVE TO THE LEFT HAVING A RADIUS OF 318.00 FEET, A DELTA ANGLE OF 10 DEGREES 09 MINUTES 28 SECONDS, AN ARC LENGTH OF 56.38 FEET, A CHORD BEARING OF SOUTH 05 DEGREES 27 MINUTES 39 SECONDS WEST, ALONG AN EAST LINE OF SAID OUTLOT 'D', SAID LINE ALSO BEING A WEST RIGHT OF WAY LINE OF N. 98<sup>TH</sup> STREET, AND A CHORD LENGTH OF 56.30 FEET TO AN EAST CORNER OF SAID OUTLOT 'D', SAID POINT ALSO BEING A WEST RIGHT OF WAY CORNER OF N. 98<sup>TH</sup> STREET; THENCE SOUTH 00 DEGREES 22 MINUTES 55 SECONDS WEST, ALONG AN EAST LINE OF SAID OUTLOT 'D', SAID LINE ALSO BEING A WEST RIGHT OF WAY LINE OF N. 98<sup>TH</sup> STREET, A DISTANCE OF 208.33 FEET TO AN EAST CORNER OF SAID OUTLOT 'D', SAID POINT ALSO BEING A WEST RIGHT OF WAY CORNER OF N. 98<sup>TH</sup> STREET; THENCE SOUTH 37 DEGREES 38 MINUTES 42 SECONDS WEST, ALONG AN EAST LINE OF SAID OUTLOT 'D', SAID LINE ALSO BEING A WEST RIGHT OF WAY LINE OF N. 98<sup>TH</sup> STREET, A DISTANCE OF 4.57 FEET TO AN EAST CORNER OF SAID OUTLOT 'D', SAID POINT ALSO BEING A WEST RIGHT OF WAY CORNER OF N. 98<sup>TH</sup> STREET; THENCE SOUTH 83 DEGREES 21 MINUTES 13 SECONDS WEST, ALONG AN EAST LINE OF SAID OUTLOT 'D', SAID LINE ALSO BEING A WEST RIGHT OF WAY LINE OF N. 98<sup>TH</sup> STREET, A DISTANCE OF 47.53 FEET TO AN EAST CORNER OF SAID OUTLOT 'D', SAID POINT ALSO BEING A WEST RIGHT OF WAY CORNER OF N. 98<sup>TH</sup> STREET; THENCE NORTH 89 DEGREES 37 MINUTES 05 SECONDS WEST, ALONG AN EAST LINE OF SAID OUTLOT 'D', SAID LINE ALSO BEING A WEST RIGHT OF WAY LINE OF N. 98<sup>TH</sup> STREET, A DISTANCE OF 32.07 FEET TO AN EAST CORNER OF SAID OUTLOT 'D', SAID POINT ALSO BEING A WEST RIGHT OF WAY CORNER OF N. 98<sup>TH</sup> STREET; THENCE SOUTH 00 DEGREES 22 MINUTES 55 SECONDS WEST, ALONG AN EAST LINE OF SAID OUTLOT 'D', SAID LINE ALSO BEING A WEST RIGHT OF WAY LINE OF N. 98<sup>TH</sup> STREET, A DISTANCE OF 100.00 FEET TO A POINT; THENCE NORTH 89 DEGREES 37 MINUTES 05 SECONDS WEST, A DISTANCE OF 182.72 FEET TO A POINT; THENCE NORTH 87 DEGREES 19 MINUTES 39 SECONDS WEST, A DISTANCE OF 350.28 FEET TO A POINT; THENCE NORTH 89 DEGREES 37 MINUTES 05 SECONDS WEST, A DISTANCE OF 547.18 FEET TO A POINT; THENCE NORTH 00 DEGREES 00 MINUTES 53 SECONDS EAST, A DISTANCE OF 90.96 FEET TO A POINT; THENCE NORTH 89 DEGREES 24 MINUTES 38 SECONDS WEST, A DISTANCE OF 729.79 FEET TO A POINT; THENCE NORTH 00 DEGREES 01 MINUTES 21 SECONDS EAST, A DISTANCE OF 620.03 FEET TO THE POINT OF BEGINNING. SAID TRACT CONTAINS A CALCULATED AREA OF 1,738,033.40 SQUARE FEET OR 39.90 ACRES, MORE OR LESS.

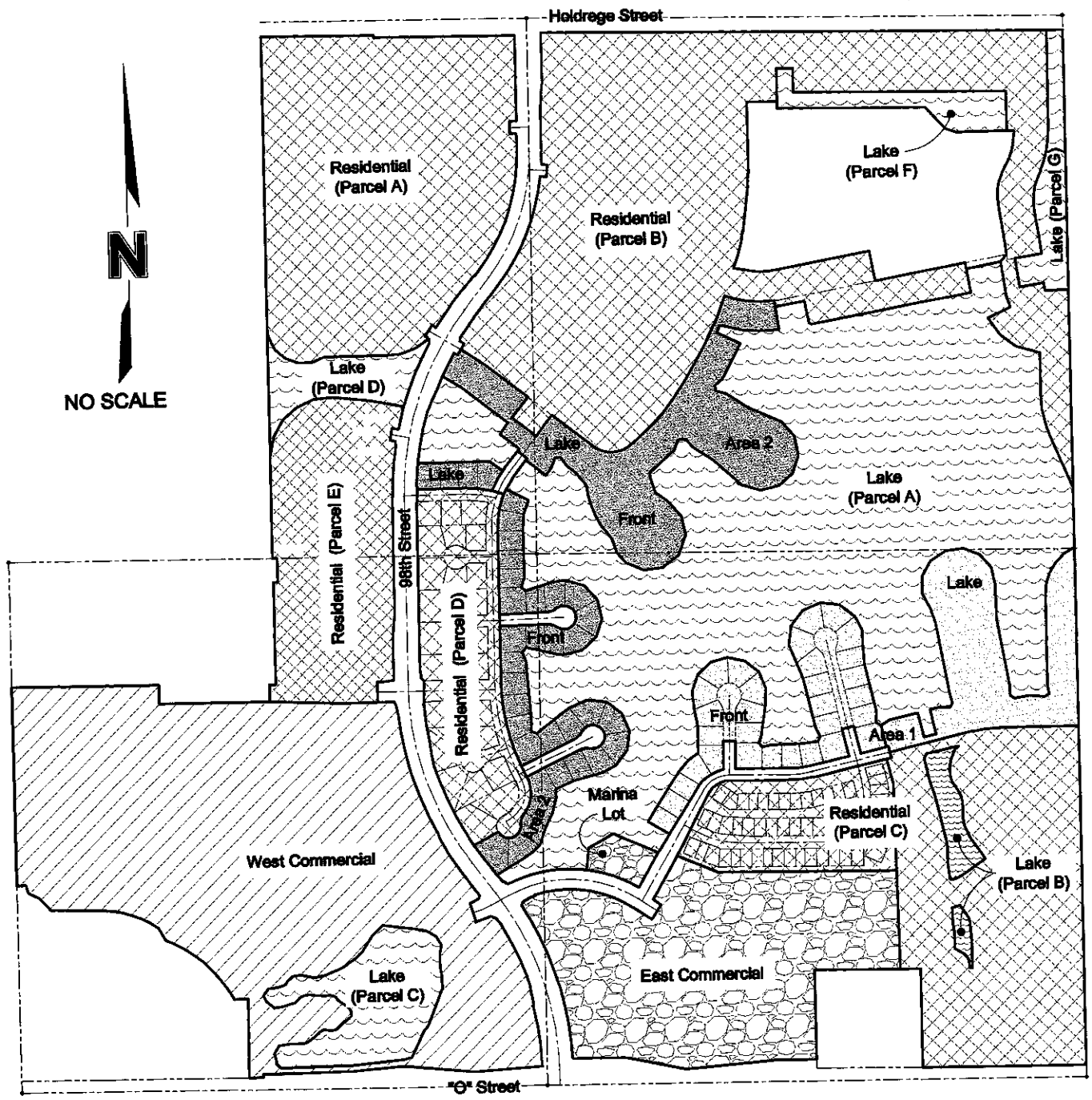

DATE: 06.03.06  
 PROJECT NO: 2008-1408  
 DRAWN BY: dst  
 DSD, 09/05/08  
 0877, 09/05/08  
 0877, 09/05/08  
 0877, 09/05/08

**PROJECT NO:** 2008-1408  
**DRAWN BY:** dst  
**DATE:** 06.03.06

**Parcel Exhibit**



1111 Lincoln Mall, Suite 111  
 P.O. Box 84608  
 Lincoln, NE 68501-4608  
 TEL 402.474.6311  
 FAX 402.474.5160

**Exhibit**  
 "F"