

with a copy to:

Seacrest & Kalkowski, PC, LLO
1111 Lincoln Mall, Suite 350
Lincoln, NE 68508

D. **Binding Effect.** The Annexation Agreement runs with the land and is binding upon and inures to the benefit and burden of the successors and assigns of the respective parties.

E. **Copy of Annexation Agreement.** A copy of the Annexation Agreement is on file with the City Clerk.

F. **Recordation.** This Memorandum shall be filed of record with the Lancaster County Register of Deeds against the Property legally described on Exhibit "B".

"CITY"

CITY OF LINCOLN, NEBRASKA,
a municipal corporation

ATTEST:

Jean E. R...
City Clerk

By: Chris Beutler
Chris Beutler, Mayor

STATE OF NEBRASKA)
) ss.
COUNTY OF LANCASTER)

The foregoing instrument was acknowledged before me this 9th day of November, 2011, by Chris Beutler, Mayor of the **City of Lincoln, Nebraska**, a municipal corporation.

Teresa J. Meier
Notary Public



"DEVELOPER"

RINGNECK DEVELOPMENT, LLC,
a Nebraska limited liability company

By: Midwest First Financial, Inc.,
a Nebraska corporation, Manager

By: William B. Preston
William B. Preston, President

STATE OF NEBRASKA)
) ss.
COUNTY OF DOUGLAS)

The foregoing was acknowledged before me this 15 day of November, 2011, by William B. Preston, President of Midwest First Financial, Inc, a Nebraska corporation, Manager of **Ringneck Development, LLC**, a Nebraska limited liability company, on behalf of the limited liability company.



Aaron Whaley
Notary Public

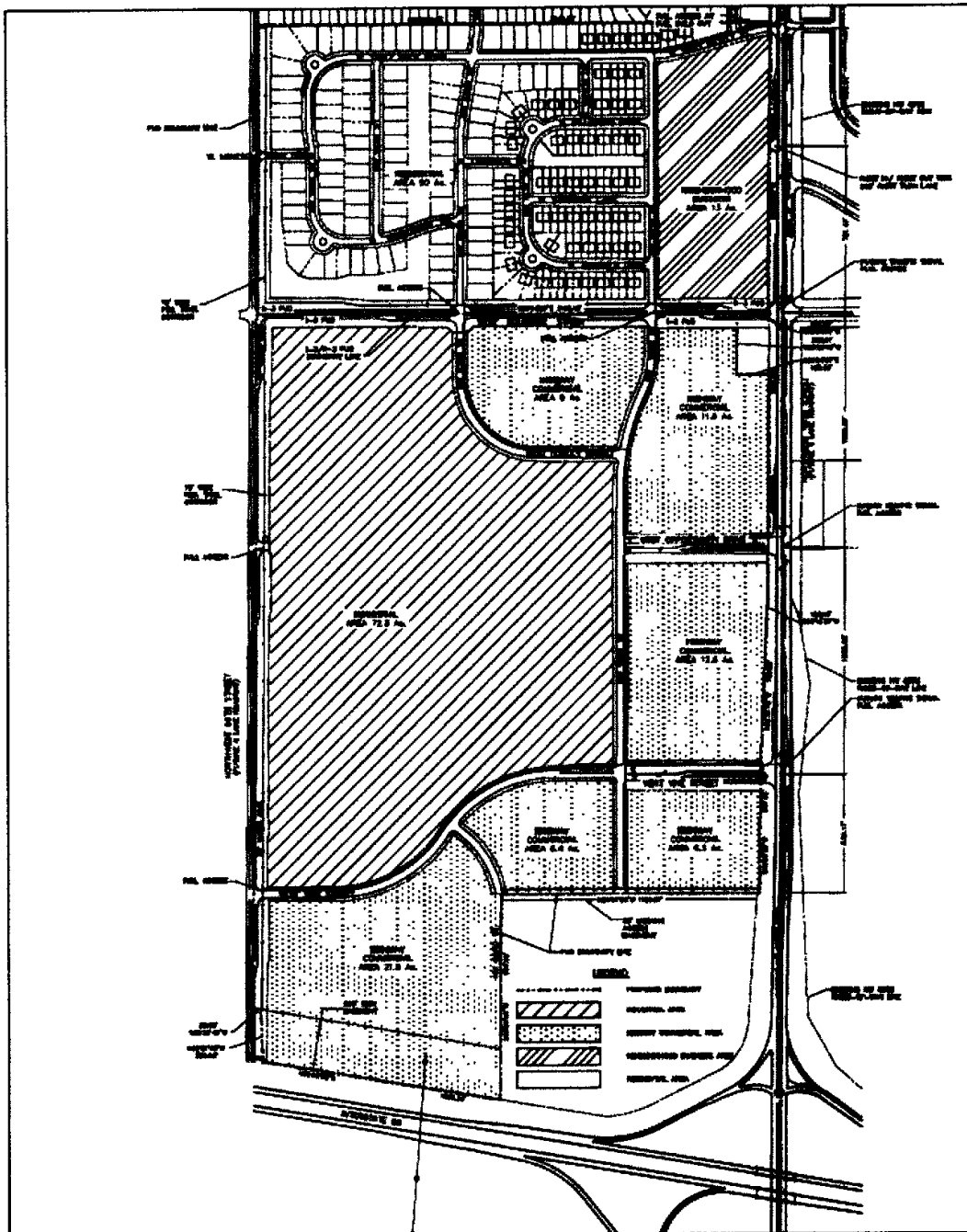

PROJECT NO: 006-2085
 DRAWN BY: NKS
 DATE: 06.26.11 - City Version

**I-80 WEST LINCOLN
 BUSINESS CENTER**



1111 Lincoln Mall Suite 111
 P.O. Box 8408
 Lincoln, NE 68501-4808
 TEL 402-474-0311
 FAX 402-474-5190

EXHIBIT
A

PROPERTY LEGAL DESCRIPTION

A LEGAL DESCRIPTION FOR A TRACT OF LAND COMPOSED OF LOT 8 I.T., AND THE SOUTHWEST QUARTER OF THE SOUTHWEST QUARTER, ALL LOCATED SOUTHWEST QUARTER OF SECTION 18, TOWNSHIP 10 NORTH, RANGE 8 EAST, LOTS 23 I.T., 31 I.T., AND 33 I.T., AND THE WEST HALF OF THE NORTHWEST QUARTER OF SECTION 19, TOWNSHIP 10 NORTH, RANGE 8 EAST, ALL OF THE 6TH P.M., CITY OF LINCOLN, LANCASTER COUNTY, NEBRASKA, AND MORE PARTICULARLY DESCRIBED AS FOLLOWS:

COMMENCING AT THE SOUTHWEST CORNER OF THE SOUTHWEST QUARTER OF THE SOUTHWEST QUARTER OF SAID SECTION 18, SAID POINT BEING THE POINT OF BEGINNING; THENCE NORTHERLY ALONG THE WEST LINE OF THE SOUTHWEST QUARTER OF THE SOUTHWEST QUARTER OF SAID SECTION 18 ON AN ASSUMED BEARING OF NORTH 00 DEGREES 28 MINUTES 53 SECONDS EAST, A DISTANCE OF 1,320.26 FEET TO THE NORTHWEST CORNER OF THE SOUTHWEST QUARTER OF THE SOUTHWEST QUARTER OF SAID SECTION 18, THENCE NORTH 89 DEGREES 59 MINUTES 01 SECONDS EAST ALONG THE NORTH LINE OF SAID SOUTHWEST QUARTER OF THE SOUTHWEST QUARTER OF SAID SECTION 18, AND THE NORTH LINE OF LOT 8 I.T., A DISTANCE OF 2,345.82 FEET TO THE NORTHEAST CORNER OF SAID LOT 8 I.T., SAID POINT BEING ON THE WEST LINE OF NORTH WEST 48TH STREET RIGHT-OF-WAY, THENCE SOUTH 00 DEGREES 36 MINUTES 52 SECONDS WEST ALONG THE WEST LINE OF SAID LOT 8 I.T., SAID LINE BEING A WEST LINE OF SAID RIGHT-OF-WAY, A DISTANCE OF 1,324.40 FEET TO THE SOUTHEAST CORNER OF SAID LOT 8 I.T., THENCE NORTH 89 DEGREES 54 MINUTES 57 SECONDS WEST ALONG THE SOUTH LINE OF SAID LOT 8 I.T., SAID LINE BEING THE NORTH LINE OF THE NORTHWEST QUARTER OF SECTION 19, A DISTANCE OF 145.04 FEET TO THE NORTHEAST CORNER OF LOT 31 I.T., THENCE SOUTH 00 DEGREES 23 MINUTES 49 SECONDS WEST ALONG A EAST LINE OF SAID LOT 31 I.T., A DISTANCE OF 283.01 FEET TO NORTH CORNER OF SAID LOT 31 I.T., THENCE SOUTH 89 DEGREES 54 MINUTES 57 SECONDS EAST ALONG A NORTH LINE OF SAID LOT 31 I.T., A DISTANCE OF 150.00 FEET TO A NORTHEAST CORNER OF SAID LOT 31 I.T., SAID POINT BEING ON THE WEST LINE OF NORTH WEST 48TH STREET RIGHT-OF-WAY, THENCE SOUTH 00 DEGREES 31 MINUTES 35 SECONDS WEST ALONG A EAST LINE OF SAID LOT 31 I.T., SAID LINE BEING A WEST LINE OF SAID RIGHT-OF-WAY, A DISTANCE OF 1,009.85 FEET TO A POINT OF DEFLECTION, THENCE SOUTH 03 DEGREES 14 MINUTES 27 SECONDS WEST ALONG A EAST LINE OF SAID LOT 31 I.T., AND A EAST LINE OF LOT 33 I.T., A DISTANCE OF 100.10 FEET TO A POINT OF DEFLECTION, THENCE SOUTH 02 DEGREES 38 MINUTES 45 SECONDS WEST ALONG A EAST LINE OF SAID LOT 33 I.T., SAID LINE BEING A WEST LINE OF SAID RIGHT-OF-WAY, A DISTANCE OF 700.96 FEET TO A POINT OF DEFLECTION, THENCE SOUTH 00 DEGREES 22 MINUTES 27 SECONDS WEST ALONG A EAST LINE OF SAID LOT 33 I.T., SAID LINE BEING A WEST LINE OF SAID RIGHT-OF-WAY, A DISTANCE OF 547.84 FEET TO THE SOUTHEAST CORNER OF SAID LOT 33 I.T., THENCE NORTH 89 DEGREES 57 MINUTES 53 SECONDS WEST THE SOUTH LINE OF SAID LOT 33 I.T., A DISTANCE OF 1,185.57 FEET TO THE NORTHEAST CORNER OF LOT 23 I.T., THENCE SOUTH 89 DEGREES 26 MINUTES 06 SECONDS WEST ALONG THE EAST LINE OF SAID LOT 23 I.T., A DISTANCE OF 937.88 FEET TO THE SOUTHEAST CORNER OF SAID LOT 23 I.T., SAID POINT BEING ON THE NORTH LINE OF INTERSTATE 80 RIGHT-OF-WAY, THENCE NORTH 80 DEGREES 36 MINUTES 00 SECONDS WEST ALONG A SOUTH LINE OF SAID LOT 23 I.T., SAID LINE BEING A NORTH LINE OF SAID RIGHT-OF-WAY, A DISTANCE OF 1,095.24 FEET TO THE SOUTHWEST CORNER OF SAID LOT 23 I.T., SAID POINT BEING ON THE EAST LINE OF NORTH WEST 56TH STREET RIGHT-OF-WAY, THENCE NORTH 02 DEGREES 31 MINUTES 40 SECONDS WEST ALONG A WEST LINE OF SAID LOT 23 I.T., SAID LINE BEING A EAST LINE OF SAID RIGHT-OF-WAY, A DISTANCE OF 230.50 FEET TO A SOUTH CORNER OF SAID LOT 23 I.T., THENCE NORTH 89 DEGREES 32 MINUTES 40 SECONDS WEST ALONG A SOUTH LINE OF SAID LOT 23 I.T., SAID LINE BEING A NORTH LINE OF SAID RIGHT-OF-WAY, A DISTANCE OF 33.00 FEET TO A SOUTHWEST CORNER OF SAID LOT 23 I.T., SAID POINT BEING ON THE WEST LINE OF THE SOUTHWEST QUARTER OF SAID SECTION 19, THENCE NORTH 00 DEGREES 27 MINUTES 20 SECONDS EAST ALONG THE WEST LINE OF SAID LOT 23 I.T., SAID LINE BEING THE WEST LINE OF SAID SOUTHWEST QUARTER, A DISTANCE OF 526.76 FEET TO THE NORTHWEST CORNER OF SAID LOT 23 I.T., SAID POINT BEING THE SOUTHWEST CORNER OF THE NORTHWEST QUARTER OF SAID SECTION 19, THENCE NORTH 00 DEGREES 27 MINUTES 38 SECONDS EAST ALONG THE WEST LINE OF SAID NORTHWEST QUARTER, A DISTANCE OF 2,642.46 FEET TO THE NORTHWEST CORNER OF SAID NORTHWEST QUARTER, SAID POINT BEING THE SOUTHWEST CORNER OF THE SOUTHWEST QUARTER OF SECTION 18, THENCE NORTH 00 DEGREES 28 MINUTES 53 SECONDS EAST ALONG THE WEST LINE OF SAID SOUTHWEST QUARTER, A DISTANCE OF 1,320.26 FEET TO THE POINT OF BEGINNING. SAID TRACT CONTAINS A CALCULATED AREA OF 10,185,284.23 SQUARE FEET OR 233.36 ACRES, MORE OR LESS.

PROJECT NO: 009-3085
 DRAWN BY: MKB
 DATE: 08.25.11

**PROPERTY LEGAL
 DESCRIPTION**

MOLSSON
 ASSOCIATES

1511 Lincoln Mall, Suite 111
 P.O. Box 94999
 Lincoln, NE 68509-0499
 TEL: 402.494.2011
 FAX: 402.476.5180

EXHIBIT

B



N.W. 56TH STREET

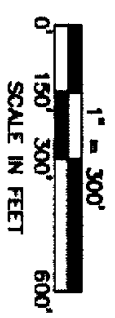

WEST HOLDRIDGE STREET

ANNEXED
PROPERTY

N.W. 56TH STREET

N.W. 56TH STREET

PROJECT NO.: 008-2005
DRAWN BY: NMB
DATE: 08.28.11

ANNEXED PROPERTY

WOLSSON
ASSOCIATES

7111 Elizabeth Ave., Suite 111
Cedar Rapids, IA 52401-4408
TEL: 563.741.8111
FAX: 563.741.8100

EXHIBIT
C

EXHIBIT "C"

**LEGAL DESCRIPTION
ANNEXATION**

A LEGAL DESCRIPTION FOR A TRACT OF LAND COMPOSED OF A PORTION OF LOT 8 I.T. LOCATED IN THE SOUTHEAST QUARTER OF THE SOUTHWEST QUARTER OF SECTION 18, TOWNSHIP 10 NORTH, RANGE 6 EAST OF THE 6TH P.M., LANCASTER COUNTY, NEBRASKA, AND MORE PARTICULARLY DESCRIBED AS FOLLOWS:

COMMENCING AT THE SOUTHEAST CORNER OF SAID SOUTHEAST QUARTER OF THE SOUTHWEST QUARTER; THENCE WESTERLY ALONG THE SOUTH LINE OF SAID SOUTHWEST QUARTER ON AN ASSUMED BEARING OF N89°54'57"W, A DISTANCE OF 107.11' TO A POINT; THENCE N00°06'03"E, A DISTANCE OF 33.00' TO THE SOUTHEAST CORNER OF SAID LOT 8 I.T., SAID POINT BEING ON THE NORTH RIGHT-OF-WAY LINE OF WEST HOLDREGE STREET AND A WEST RIGHT-OF-WAY LINE OF NORTHWEST 48TH STREET, SAID POINT ALSO BEING 107.20' WEST OF THE EAST LINE OF SAID SOUTHWEST QUARTER; THENCE N00°23'02"E ALONG A EAST LINE OF SAID LOT 8 I.T., SAID LINE ALSO BEING A WEST RIGHT-OF-WAY LINE OF SAID RIGHT-OF-WAY, A DISTANCE OF 805.80' TO A POINT, SAID POINT BEING 105.70' WEST OF THE EAST LINE OF SAID SOUTHWEST QUARTER; THENCE N00°32'18"E ALONG A EAST LINE OF SAID LOT 8 I.T., SAID LINE ALSO BEING THE WEST LINE OF SAID RIGHT-OF-WAY, A DISTANCE OF 95.81' TO THE TRUE POINT OF BEGINNING; THENCE N89°54'57"W, A DISTANCE OF 567.75' TO A POINT; THENCE N00°05'03"E, A DISTANCE OF 589.13' TO A POINT OF INTERSECTION WITH THE NORTH LINE OF SAID LOT 8 I.T., SAID LINE ALSO BEING THE NORTH LINE OF SAID SOUTHWEST QUARTER; THENCE N89°59'01"E ALONG THE NORTH LINE OF SAID LOT 8 I.T., SAID LINE ALSO BEING THE NORTH LINE OF SAID SOUTHWEST QUARTER, A DISTANCE OF 572.42' TO THE NORTHEAST CORNER OF SAID LOT 8 I.T., SAID POINT BEING ON A WEST RIGHT-OF-WAY LINE OF NORTHWEST 48TH STREET, SAID POINT ALSO BEING 102.15' WEST OF THE EAST LINE OF SAID SOUTHWEST QUARTER; THENCE S00°32'18"W ALONG A EAST LINE OF SAID LOT 8 I.T., SAID LINE ALSO BEING A WEST LINE OF SAID RIGHT-OF-WAY, A DISTANCE OF 590.15' TO THE POINT OF BEGINNING, SAID TRACT CONTAINS A CALCULATED AREA OF 336,138.52 SQUARE FEET OR 7.72 ACRES, MORE OR LESS.

PROJECT NO: 008-2006
DRAWN BY: NMS
DATE: 08/25/11

CHANGE OF ZONE

OLSSON
ASSOCIATES
1711 Lincoln Hill, Suite 111
P.O. Box 6088
Lubbock, TX 79401-4088
TEL: 806/793-8100
FAX: 806/793-8100

EXHIBIT
D

