

FILED SARPY CO. NE.
 INSTRUMENT NUMBER
 2003-64026
 2003 OCT 31 A 8:39

COUNTER C.E.
 VERIFY D.E.
 PROOF
 FEES \$ 127.00
 CHECK#
 CHG. EACG CASH
 REFUND CREDIT
 SHORT NCR

Glenn J. Dowling
 REGISTER OF DEEDS

18	300.00'	112.76'	57.05'	21°32'10"
19	300.00'	114.05'	57.72'	21°46'52"
20	585.92'	149.19'	75.00'	14°35'19"
21	1089.70'	145.92'	73.07'	7°40'21"
22	300.00'	114.05'	57.72'	21°46'52"
23	150.00'	56.38'	28.53'	21°32'10"
24	470.71'	176.93'	89.52'	21°32'10"
25	300.00'	114.05'	57.72'	21°46'52"
26	12426.66'	178.38'	89.19'	0°49'21"
27	100.00'	31.22'	15.74'	17°53'06"
42	300.00'	139.40'	70.98'	26°37'23"
43	120.81' 300.00'	120.81'	61.24'	23°04'26"



AFFIDAVIT OF CORRECTION

To correct certain dimensions of Center-Line Curve Table, Val Vista (Lots 1 thru 240 inclusive and Outlots "A", "B", "C", & "D"), a subdivision located in the SW 1/4 of Section 16, Township 14 North, Range 12 East of the 6th P.M., Sarpy County, Nebraska.

The Radius of Curve 43 to read 300.00 feet instead of 120.81 feet.

AFFIDAVIT

Correction to Val Vista (Lots 1 thru 240 inclusive and Outlots "A", "B", "C", & "D"), a subdivision located in the SW 1/4 of Section 16, Township 14 North, Range 12 East of the 6th P.M., Sarpy County, Nebraska.

I Robert Clark, do hereby submit the above drawing in order to correct the error in dimensions of Center-Line Curve Table, Val Vista (Lots 1 thru 240 inclusive and Outlots "A", "B", "C", & "D"), a subdivision located in Sarpy County, Nebraska as recorded in Instrument No. 2001-14254, in the Register of Deeds office, Sarpy County, Nebraska.

I certify that I am the same identical person whose name appears in the Surveyor's Certificate of said Val Vista (Lots 1 thru 240 inclusive and Outlots "A", "B", "C" & "D"), Sarpy County, Nebraska.

Robert Clark
 Robert Clark

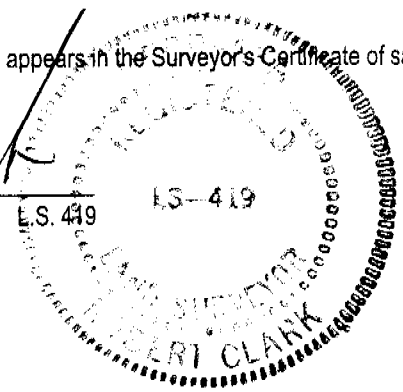

STATE OF NEBRASKA
) SS
 COUNTY OF DOUGLAS

On the 20TH day of OCT, 2003, before me a Notary Public, qualified and commissioned in and for said County, personally appeared Robert Clark, who is personally known to me to be the same identical person whose name is affixed to the above Affidavit, and he acknowledged the signing thereof to be his voluntary act and deed.

Witness my hand and official seal at Omaha, Nebraska, on this date last aforesaid.

Commission Expires:
4-30-07 *Homer R. Hunt*
 NOTARY PUBLIC



E&A CONSULTING GROUP, INC.
 ENGINEERS • PLANNERS • SURVEYORS
 12001 Q STREET OMAHA, NE 68137 PHONE: (402) 895-4700

Drawn by: JNT Chkd by: *WAC* Date: 10-17-03 Chkd by: Date:

Job No.: 99175 Date: 7/07/03 Book No.:

AFFIDAVIT OF CORRECTION
 CENTER-LINE CURVE TABLE, VAL VISTA
 (LOTS 1 THRU 240 INCLUSIVE & OUTLOTS "A", "B", "C" & "D")
 SARPY COUNTY, NEBRASKA