

FILED SARPY CO. NE.
INSTRUMENT NUMBER
2000-000674

2000 JA 11 AM 8:01

Lloyd J. Dowding
REGISTER OF DEEDS

Counter SS
Verify AK
D.E. M
Proof D
Fee \$ 34.00
Ck Cash Chg *COB.*



**THIS PAGE ADDED
FOR RECORDING
INFORMATION.**

**DOCUMENT STARTS ON
NEXT PAGE.**

LLOYD J. DOWDING
SARPY COUNTY REGISTER OF DEEDS
1210 GOLDEN GATE DRIVE, #1109
PAPILLION, NE 68046-2895
402-593-5773

2000-000674A

ORDINANCE RECORD

No. 728-REDFIELD & COMPANY INC., OMAHA

ORDINANCE NO. 3065

AN ORDINANCE TO ANNEX TO THE CITY OF BELLEVUE, SARPY COUNTY, NEBRASKA, CERTAIN LANDS, LOTS AND REAL ESTATE LYING WITHIN THE BOUNDARIES DESCRIBED WITHIN THE ORDINANCE, TO THE CITY OF BELLEVUE, SARPY COUNTY, NEBRASKA, DESIGNATING AN EFFECTIVE DATE, AND PUBLISHING IN PAMPHLET FORM.

WHEREAS, ALL OF THE LOTS, LANDS, AND REAL ESTATE LYING WITHIN THE BOUNDARIES DESCRIBED AS FOLLOWS, TO WIT:

Lots 13A, 13B, 14 through 20, 23 and 25, Lots 32 through 40, 41A, 41B, 43, 44, 45, Lots 47 48, 49, north one-half Lot 52, north one-half Lot 53, south one-half of Lot 52, south one-half Lot 53, Lot 54B, 56 and 57 of Childs Estate Acres; Lots 1 through 8, Swaney's Addition; Lots 1 through 3 Overland Park Addition, Lots 1 and 2 Childs Estate Acres Replat 2, Lots 1 and 2, Paxson Addition; Lots 1 and 2 Childs Estate Acres Replat 3, Lots 1 through 8, Replat of Childs Estate Acres, Lots 1 and 2 Kulhanek Subdivision; Lots 1 through 5 Kreb's First Addition Lots 1 through 3 Rejda Addition, all located in the Northeast Quarter, Section 22, Township 14 North, Range 13 East of the 6th P.M., Sarpy County, Nebraska; and including all county roads adjacent thereto.

Lots 4 through 11, inclusive, Lots 12A, 12B, 12C, 21A, 21B, south one-half Lot 21, Lots 22 and 24 of Childs Estate Acres, all located in Section 23, Township 14 North, Range 13 East of the 6th P.M., Sarpy County, Nebraska; and including all county roads adjacent thereto.

More particularly described as starting at a point, said point being the southeast corner of Lot 6, Childs Estate Acres, thence westerly along the south property lines of Lots 6, 5, and 4 of Childs Estates Acres to a point, said point being the southwest corner of Lot 4, Childs Estate Acres; thence southerly along the west property lines of Lots 3, 2, and 1, Childs Estate Acres; thence southerly along an extended line across Cary Street right of way to an intersection point on Cary Street's southern right of way, said point being the northwest corner of Lot 9, Bellevue Business Park; thence westerly along the irregular south right of way of Cary Street to a point, said point being the intersection of extended 17th Street west right of way and Cary Street south right of way; thence northerly across Cary Street right of way to a point, said point being the southeast corner of Lot 62, Childs Estate Acres; thence northerly along the east property lines of Lots 62 and 61, Childs Estate Acres to a point, said point being the northeast corner of Lot 61, Childs Estate Acres; thence northerly across Virginia Street right of way to a point, said point being the southeast corner of Lot 60, Childs Estate Acres; thence northerly along the east property lines of Lots 60 and 59, Childs Estate Acres to a point, said point being the northeast corner of Lot 59, Childs Estate Acres; thence northerly across Childs Road to a point, said point being the 17th Street extended western right of way to the Childs Road north right of way; thence easterly along the south property line of Lot 51, Southwoods to a point, said point being the southeast corner of Lot 51, Southwoods; thence easterly across the Colorado Street right of way to a point; said point being the southwest corner of Lot 50, Southwoods; thence easterly along the south property line of Lot 50, and combined Lots 22 and 23, Southwoods; thence easterly across Denver Street right of way to a point, said point being the southwest corner Lot 1, Southwoods II; thence easterly along the south property lines of Lots 1, 15, 14, and 13, Southwoods II to a point, said point being the southeast corner of Lot 13, Southwoods II; thence easterly across Kauai Street right of way to a point; said point being the southwest corner of Lot 21, Southwoods; thence easterly along the south property lines of Lots 21 and 9, Southwoods to a point, said point being the southeast corner of Lot 9, Southwoods; thence easterly across Nebraska Drive right of way to a point, said point being the southwest corner of Lot 8, Southwoods; thence easterly along the south property lines of Lot 8, Southwoods and Lot 2, Metz-Pendleton Subdivision to a point, said point being the southeast corner of Lot 2, Metz-Pendleton Subdivision; thence southerly along the west right of way line of Union Pacific Railroad to point of beginning.

SUCH LANDS ARE CONTIGUOUS TO AND ADJACENT TO THE CITY OF BELLEVUE, NEBRASKA, AND ARE URBAN OR SUBURBAN IN CHARACTER, AND

WHEREAS, SAID REAL ESTATE WILL RECEIVE MATERIAL BENEFITS AND ADVANTAGES FROM ANNEXATION TO THE SAID CITY.

NOW, THEREFORE, BE IT ORDAINED BY THE MAYOR AND THE CITY COUNCIL OF THE CITY OF BELLEVUE, NEBRASKA:

Section 1: All of the real estate lying within the area heretofore described as and the same hereby is included within the boundaries and territory of the City of Bellevue, Nebraska, and said lands and the persons residing thereon shall hereafter be subjected to all of the rules, regulations, ordinances, taxes, and other burdens and benefits of other persons and territory included within the City of Bellevue, Nebraska.

Section 2: This Ordinance shall take effect and be in full force and effect on and after December 31, 1999, upon its passage, approval and publication according to law.

Passed and approved this 7th day of December, 1999

Beverly Hardy
City Clerk

Mayor

Jerry Ayers

First Reading: November 8, 1999
Second Reading: November 22, 1999
Third Reading: December 7, 1999

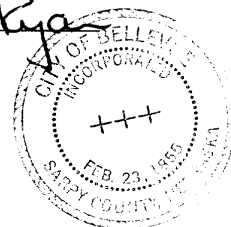

000674

2000-000674 B

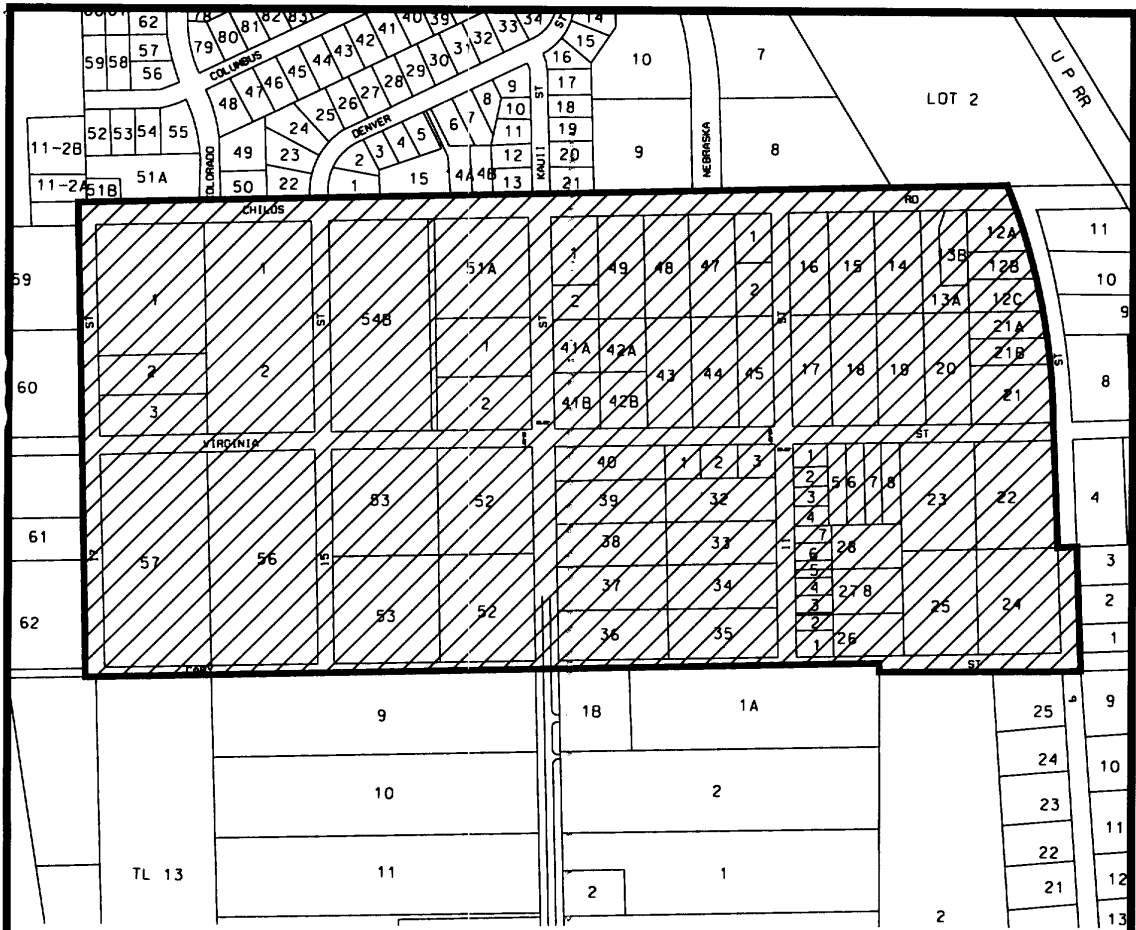

UA #11

NE 1/4 SEC 22 T14N-R13E

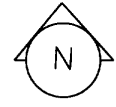

1"=400'

LT 13-20, 23 & 25 CHILDS ESTATE ACRES; LT 1-8 SWANEY'S ADD.; LT 1-3 OVERLAND PARK ADD.;
 LT 1 & 2 CHILDS ESTATE ACRES REPLAT 3; LT 1-8 REPLAT OF CHILDS ESTATE ACRES; LT 1 & 2
 KULHANEK SUB.; LT 1-5 KREB'S FIRST ADD.; LT 1-3 REJDA ADD.

2000-000674C



UA #11
SEC 23



1"=300'

LT 4-11, 12A, 12B, 12C, 21A, 21B, S. 1/2 21, 22 & 24 CHILD'S ESTATE ACRES