

SE 1/4 35-14-13

Scale: 1"=200'

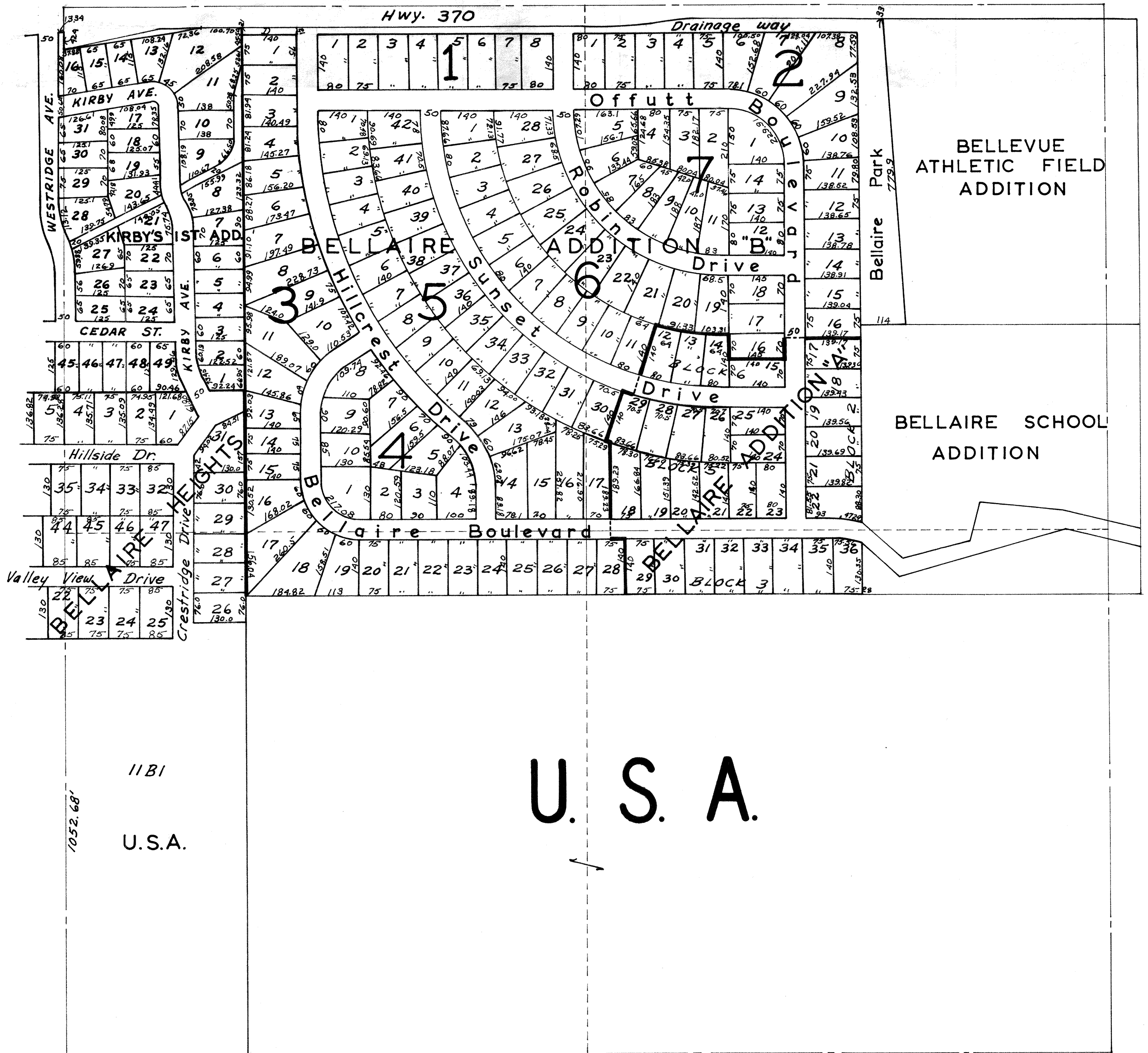

11B1
U.S.A.

U.S.A.

Note: Lot dimensions omitted here due to lack of space.
See original plats of subdivisions.

OFFICIAL PLAT
SARPY COUNTY SURVEYOR'S OFFICE
February, 1961
F.I.W.-N.P.W.