

This map constitutes a representation based on information provided to the Sarpy County Surveyors Office by other individuals and organizations. Therefore no representations regarding the accuracy of the size, dimensions, measurements, condition, platting or location of the within described area are made. Should such information be required for construction, zoning or other purposes, the services of a private surveyor and/or title search should be secured.

NW1/4 SEC. 17 T14N-R13E

SCALE 1" = 200'

1028



* NOTE: 8B is not a part of OLSON'S SUBDIVISION

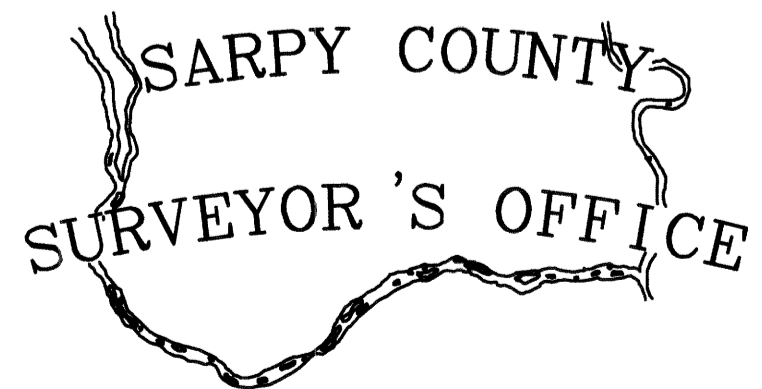

REVISED

- 6-18-69
- 9-05-71
- 1-20-72
- 3-27-73
- 7-11-73
- 6-28-82
- 9-20-83
- 8-06-85
- 12-30-85
- 1-13-87
- 6-17-87
- 10-17-90
- 5-31-91
- 7-02-91
- 3-08-93
- 11-28-95-PLAT
- 02-01-99-ROW
- 04-14-99-ROW
- 09-03-99-PLAT
- 12-13-01-PLAT