

This map constitutes a representation based on information provided to the Sary County Surveyors Office by other individuals and organizations. Therefore no representations regarding the accuracy of the size, dimensions,

the within described area are made. Should such information be required for construction, zoning or other purposes, the services of a private surveyor and/or title search should be secured.

NW 1/4 SEC. 25-14-12
SCALE 1" = 200'

1012

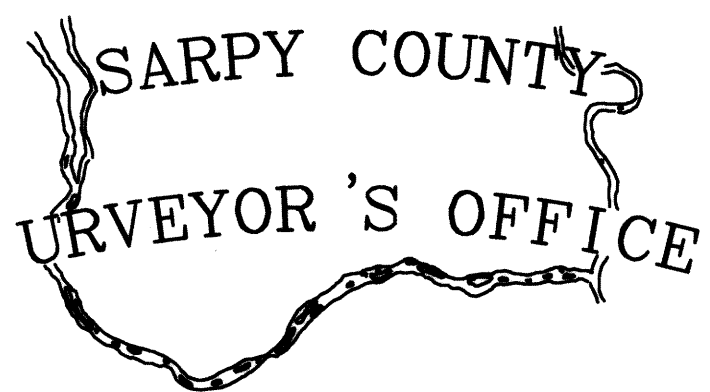

REVISIONS

- 07-26-93
- 08-25-93
- 01-11-94
- 12-15-94
- 07-18-95-PLAT
- 08-28-96-PLAT
- 08-28-98-12761
- 09-15-98-PLAT