

Correction to Raven Oaks, (Lot 29 through 53, inclusive, Block 2; Lots 13 through 25, inclusive, Block 3; Lots 15 through 60, inclusive, Block 7; Lots 15 through 19, inclusive, Block 8; Lots 1 through 23, inclusive, Block 9; Lots 1 through 38, inclusive, Block 10; Lots 1 through 9, inclusive, Block 11; Lot 1, Block 12; Lot 1, Block 13), a subdivision in part of Section 19 and part of the West one half of Section 20, all in T16N, R13E, of the 6th P.M., Douglas County, Nebraska.

I, the undersigned Registered Land Surveyor, do hereby submit this document in order to correct certain errors in the Surveyor's Certificate of said Raven Oaks, as recorded in Book 1278, Page 727, of the records in the Register of Deeds Office, Douglas County, Nebraska.

I hereby certify that I am the identical person whose name appears on the Surveyor's Certificate of said Raven Oaks.

William P. Dorner  
Registered Land Surveyor

L.S. 217  
Registration Number

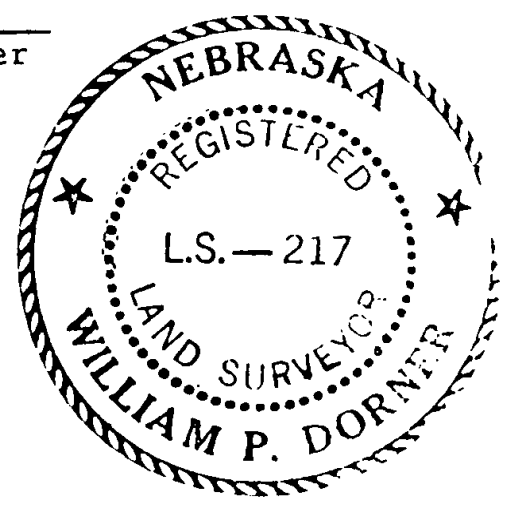

State of Nebraska)  
County of Douglas)

On this 7<sup>TH</sup> day of March, 1973 before me, a notary public, duly commissioned and qualified in and for said county, appeared William P. Dorner who is personally known by me to be the identical person whose name is affixed above.

Witness my hand and official seal, in Omaha, Nebraska, the date last aforesaid.

My Commission expires on Feb. 14, 1974.

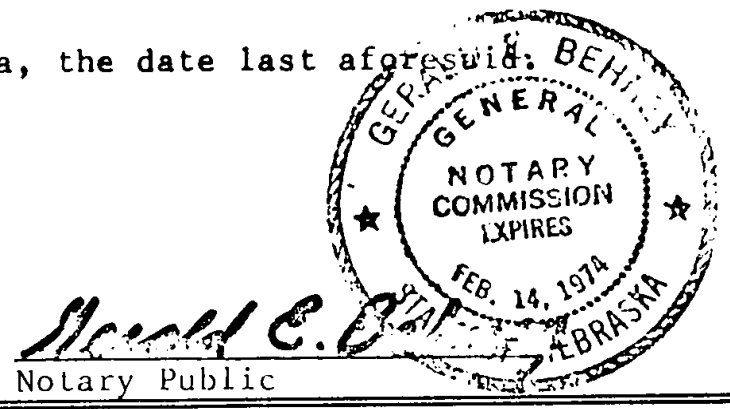

Surveyor's Certificate As It Reads Now

(Line 21).....SW $\frac{1}{2}$  of Section 19; thence N 89° 57' 30" E along the said North line of Section 19, a distance of 1315.35 feet; thence N 0° 08' 50" W, a distance of 331.36 feet;.....

Surveyor's Certificate As It Should Read

(Line 21).....SW $\frac{1}{2}$  of Section 19; thence N 89° 57' 30" E along the North line of said SW $\frac{1}{2}$ , of Section 19, a distance of 1315.35 feet; thence N 0° 08' 50" W, a distance of 331.36 feet;.....

19. 7 DAY OF March 1973 AT 11:57A M. C. HAROLD OSTLER, REGISTER OF DEEDS 43-25 ✓

ENTERED IN NUMERICAL INDEX AND RECORDED IN THE REGISTER OF DEEDS OFFICE IN DOUGLAS COUNTY, NEBRASKA