

Recorded  \_\_\_\_\_  
General  \_\_\_\_\_  
Numerical \_\_\_\_\_  
Photostat \_\_\_\_\_

60

STATE OF NEBRASKA COUNTY OF WASHINGTON) SS 1347  
ENTERED IN NUMERICAL INDEX AND FILED FOR RECORD  
THIS 16 DAY OF MAY A.D. 1986  
AT 10:13 O'CLOCK A.M. AND RECORDED IN BOOK  
158 AT PAGE 60-64  
COUNTY CLERK Sherrill Bloch  
DEPUTY Sherrill Bloch

DEDICATION AND EASEMENT

This DEDICATION AND EASEMENT is executed this 10<sup>th</sup> day of March, 1986, by the hereaftersigned landowners of certain real property situated in the Village of Arlington, Washington County, Nebraska.

WHEREAS, said landowners are owners of certain real property in Arlington, Washington County, Nebraska, with certain sewer or drain lines or pipes as well as the manhole cleanouts servicing same (hereinafter collectively referred to as "sewer lines") running on and below the surface of said real property; and

WHEREAS, said landowners wish to dedicate said sewer lines to the Village of Arlington and further grant said Village an easement upon their respective tracts or lots of real property hereinafter described for the purposes of maintaining same;

NOW, THEREFORE, and in consideration of the mutual covenants expressed herein, the hereaftersigned landowners do hereby convey, dedicate, grant, remise and otherwise quitclaim unto the Village of Arlington, Washington County, Nebraska, a municipal corporation, all of their and each of their right, title and interest in and to the sewer lines described on the attached Exhibit "A", said Exhibit "A" being specifically incorporated herein by this reference.

Said landowners do also, and BY THESE PRESENTS, hereby grant, sell, convey, remise, quitclaim and otherwise extend to the said Village of Arlington a permanent and perpetual easement of sufficient and reasonable width and length over and upon their respective tracts or lots of real property described on the said attached Exhibit "A" and such that said easement will include the full right, power and authority of said Village to maintain, repair, replace, install, alter or otherwise operate said sewer lines from time to time as said Village (or its assigns), and in its discretion, deems necessary and reasonable for the continued or continuing operation of said sewer lines, provided, however, that in the event said Village (or any of its employees, contractors, agents or representatives) should exercise its rights of easement hereto and otherwise come upon all or any portion of the real property described herein in furtherance of the exercise of its rights of easement, that Village shall restore, and to its prior condition, any property of the undersigned signatories (or their successors or assigns) altered by Village (or any of its employees, contractors, agents or representatives) in furtherance of or pursuant to Village's rights of easement and maintenance hereunder.

DATED AND EXECUTED this 10<sup>th</sup> day of March, 1986.

Herbert F. Biel  
Herbert F. Biel

Nell E. Biel  
Nell E. Biel

Dean M. Bloch  
Dean M. Bloch

Sherrill Bloch  
Sherrill Bloch

Gene W. Kay  
Gene W. Kay

Nona Kay  
Nona Kay

GENERAL NOTARY STATE OF NEBRASKA  
MARY ANN FLUKE  
My Comm. Exp. April 14, 1988

FILED  
MAY 16 1986  
COUNTY CLERK  
WASHINGTON COUNTY

Colley M. Fuchs

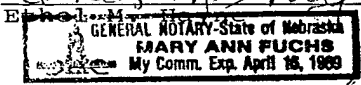

Alvin W. Katt

Alvin Katt

Hazel Katt  
Hazel Katt

Eugene A. Gnuse  
Eugene A. Gnuse

Becky Gnuse  
Becky Gnuse

Ted F. Walkenhorst  
Ted F. Walkenhorst

Patsy J. Walkenhorst  
Patsy J. Walkenhorst

Charles E. Hansen  
Charles E. Hansen

Arlene M. Hansen  
Arlene M. Hansen

Dennis E. Koley  
Dennis E. Koley

Darlene C. Koley  
Darlene C. Koley

Bill W. Stafford  
Bill W. Stafford

Phyllis A. Stafford  
Phyllis A. Stafford

Gottsch Feeding Corporation,  
A Nebraska Corporation,

Jay E. Thomsen  
Jay E. Thomsen

By: F. J. ...  
One of its duly authorized and  
acting officers

Linda D. Thomsen  
Linda D. Thomsen

STATE OF NEBRASKA )  
 ) ss.  
COUNTY OF DOUGLAS )

The above and foregoing DEDICATION AND EASEMENT was  
acknowledged before me, a Notary Public, on the 19th day of  
March, 1986, by Herbert F. Biel and Nell E. Biel, husband  
and wife.

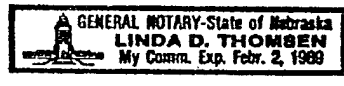

Linda D. Thomsen  
Notary Public  
My commission expires: 2/2/89

STATE OF NEBRASKA )  
 ) ss.  
COUNTY OF WASHINGTON )

The above and foregoing DEDICATION AND EASEMENT was  
acknowledged before me, a Notary Public, on the 10th day of  
March, 1986, by Dean M. Bloch and Sherrill Bloch, husband  
and wife.

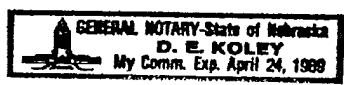

D. E. Koley  
Notary Public  
My commission expires: \_\_\_\_\_

STATE OF NEBRASKA )  
 ) ss.  
COUNTY OF WASHINGTON )

The above and foregoing DEDICATION AND EASEMENT was  
acknowledged before me, a Notary Public, on the 27 day of  
March, 1986, by Gene W. Kay and Nona Kay, husband and  
wife.



Mary Ann Fuchs  
Notary Public  
My commission expires: 4-16-89

STATE OF NEBRASKA )  
 )ss.  
COUNTY OF WASHINGTON)

The above and foregoing DEDICATION AND EASEMENT was acknowledged before me, a Notary Public, on the 21 day of March, 1986, by Ethel M. Hayne, an unmarried widow.



Mary Ann Fuchs  
Notary Public  
My commission expires: 4-16-89

STATE OF NEBRASKA )  
 )ss.  
COUNTY OF WASHINGTON)

The above and foregoing DEDICATION AND EASEMENT was acknowledged before me, a Notary Public, on the 21 day of March, 1986, by Alvin W. Katt and Hazel Katt, husband and wife.



Mary Ann Fuchs  
Notary Public  
My commission expires: 4-16-89

STATE OF NEBRASKA )  
 )ss.  
COUNTY OF WASHINGTON)

The above and foregoing DEDICATION AND EASEMENT was acknowledged before me, a Notary Public, on the 14 day of April, 1986, by Eugene A. Gnuse and Becky Gnuse, husband and wife.



Mary Ann Fuchs  
Notary Public  
My commission expires: 4-16-89

STATE OF NEBRASKA )  
 )ss.  
COUNTY OF WASHINGTON)

The above and foregoing DEDICATION AND EASEMENT was acknowledged before me, a Notary Public, on the 9 day of April, 1986, by Ted F. Walkenhorst and Patsy J. Walkenhorst, husband and wife.



Mary Ann Fuchs  
Notary Public  
My commission expires: 4-16-89

STATE OF NEBRASKA )  
 )ss.  
COUNTY OF WASHINGTON)

The above and foregoing DEDICATION AND EASEMENT was acknowledged before me, a Notary Public, on the 26 day of March, 1986, by Charles E. Hansen and Arlene M. Hansen, husband and wife.



Mary Ann Fuchs  
Notary Public  
My commission expires: 4-16-89

STATE OF NEBRASKA )  
 )ss.  
COUNTY OF WASHINGTON)

The above and foregoing DEDICATION AND EASEMENT was acknowledged before me, a Notary Public, on the 11<sup>th</sup> day of March, 1986, by Dennis E. Koley and Darlene C. Koley, husband and wife.

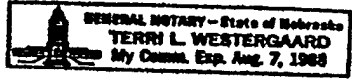

Terri L. Westergaard  
Notary Public  
My commission expires: \_\_\_\_\_

STATE OF NEBRASKA )  
 )ss.  
COUNTY OF WASHINGTON)

The above and foregoing DEDICATION AND EASEMENT was acknowledged before me, a Notary Public, on the 1st day of Sept, 1986, by Bill W. Stafford and Phyllis A. Stafford, husband and wife.



Mary Ann Fuchs  
Notary Public  
My commission expires: 4-18-89

STATE OF NEBRASKA )  
 )ss.  
COUNTY OF Douglas)

The above and foregoing DEDICATION AND EASEMENT was acknowledged before me, a Notary Public, on the 2nd day of May, 1986, by Robert J. Ballack, a duly authorized and acting officer of Gottsch Feeding Corporation, A Nebraska Corporation, on behalf of said corporation.



Shirley A. Heldt  
Notary Public  
My commission expires: Sept 17, 1987

STATE OF NEBRASKA )  
 )ss.  
COUNTY OF WASHINGTON)

The above and foregoing DEDICATION AND EASEMENT was acknowledged before me, a Notary Public, on the 13<sup>th</sup> day of May, 1986, by Jay E. Thomsen and Linda D. Thomsen, husband and wife.

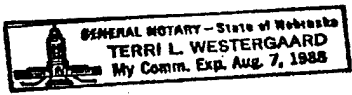

Terri L. Westergaard  
Notary Public  
My commission expires: \_\_\_\_\_

## Exhibit "A"

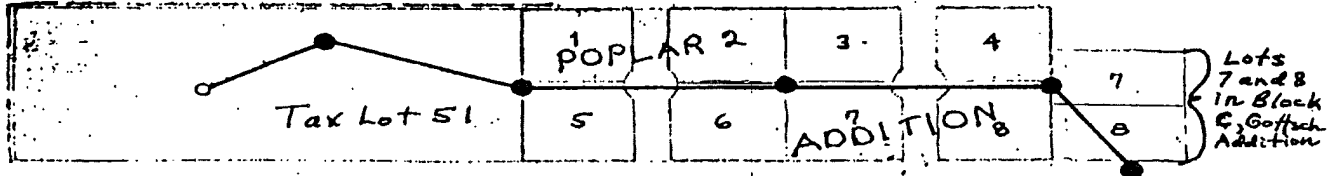

Note - The darkened line above and circled portions connected thereto denote the sewer or drain lines or pipes as well as the manhole cleanout servicing same which are collectively referred to as "sewer lines" in said DEDICATION AND EASEMENT.

The below-listed parties/individuals represent the owners thereof:

Tract or Lot of Real Property Affected:

Owner(s) Thereof:

Tax Lot 119 (part of the former Tax Lot 51) in Section 12, Township 17 North, Range 9, East of the 6th P.M., Washington County (Village of Arlington) Nebraska.

Nell E. Biel  
Linda D. Thomsen

Tax Lot 120 (remaining portion of Tax Lot 51).

Sherrill Bloch

Lot 1, Poplar Addition, Village of Arlington, Washington County, Nebraska.

Ethel M. Hayne

Lot 2, Poplar Addition, Village of Arlington, Washington County, Nebraska.

Eugene A. Gnuse &  
Becky Gnuse, H & W\*

Lot 3, Poplar Addition, Village of Arlington, Washington County, Nebraska.

Charles E. Hansen &  
Arlene M. Hansen, H & W\*

Lot 4, Poplar Addition, Village of Arlington, Washington County, Nebraska.

Bill W. Stafford &  
Phyllis A. Stafford, H&W\*

Lot 5, Poplar Addition, Village of Arlington, Washington County, Nebraska.

Gene W. Kay & Nona Kay,  
H & W\*

Lot 6, Poplar Addition, Village of Arlington, Washington County, Nebraska.

Alvin W. Katt & Hazel  
Katt, H & W\*

Lot 7, Poplar Addition, Village of Arlington, Washington County, Nebraska.

Ted F. Walkenhorst &  
Patsy J. Walkenhorst,  
H & W\*

Lot 8, Poplar Addition, Village of Arlington, Washington County, Nebraska.

Dennis E. Koley &  
Darlene C. Koley, H & W\*

Lots 7 & 8, in Block C, Gottsch Addition to the Village of Arlington, Washington County, Nebraska.

Gottsch Feeding Corp-  
oration, a Nebraska  
Corporation

\* H & W refers to Husband and Wife