

LEAWOOD OAKS III

Lots 1 Thru 169, Inclusive

Being a Platting of Part of the South One Half of the NE 1/4 of Section 9-T14N-R16E of the 6th P.M., Sarpy County, Nebraska.



Centerline Curve Data

1) Δ. 17°00'00" D. 1678.676 T. 100.00 L. 171.01 R. 170.64	2) Δ. 27°00'00" D. 1832.513 T. 100.00 L. 188.94 R. 189.05	3) Δ. 15°18'33" D. 1343.713 T. 100.00 L. 108.86 R. 109.17
4) Δ. 10°10'03" D. 508.759 T. 100.00 L. 108.90 R. 108.10	5) Δ. 25°00'40" D. 1070.840 T. 100.00 L. 108.00 R. 108.00	6) Δ. 29°03'58" D. 1078.255 T. 100.00 L. 107.72 R. 108.99
7) Δ. 6°59'41" D. 508.844 T. 100.00 L. 108.90 R. 108.05	8) Δ. 10°00'00" D. 1078.676 T. 100.00 L. 108.94 R. 109.06	9) Δ. 16°18'41" D. 1228.445 T. 100.00 L. 108.94 R. 109.25
10) Δ. 14°11'00" D. 838.745 T. 100.00 L. 108.18 R. 108.10	11) Δ. 18°04'18" D. 920.380 T. 100.00 L. 108.26 R. 108.75	12) Δ. 14°12'35" D. 1228.445 T. 100.00 L. 108.94 R. 109.25
13) Δ. 7°00'00" D. 1008.766 T. 100.00 L. 108.00 R. 107.99	14) Δ. 30°11'41" D. 818.713 T. 100.00 L. 108.61 R. 108.61	15) Δ. 13°16'15" D. 1418.913 T. 100.00 L. 107.85 R. 108.00

Notes
 1) Dimensions Shown On Curves Are Arc Dimensions Not Chord Dimensions
 2) Non-Radius Lot Lines Are Identified By The Letters N/A

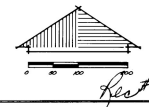

SURVEYOR'S CERTIFICATE
 I, THE UNDERSIGNED REGISTERED LAND SURVEYOR IN THE STATE OF NEBRASKA, DO HEREBY CERTIFY THAT I HAVE MADE A BOUNDARY SURVEY OF THE SUBDIVISION HEREIN, AND THAT PERMANENT MARKERS HAVE BEEN PLACED ON THE BOUNDARY AND THAT IRON PIPES WILL BE PLACED AT ALL CORNERS OF ALL LOTS, STREETS, WHEEL POINTS, AND ENDS OF ALL CURVES IN LEAWOOD OAKS III, LOTS 1 THRU 169, INCLUSIVE, BEING A PLATTING OF THAT PART OF THE S 1/2 OF THE NE 1/4 OF SECTION 9, T14N, R16E OF THE 6TH P.M., SARPY COUNTY, NEBRASKA, DESCRIBED AS FOLLOWS: BEGINNING AT THE NW CORNER OF THE S 1/2 OF SAID NE 1/4 THENCE S 89° 20' 00" W (ASSUMED BEARING) ON THE NORTH LINE OF THE S 1/2 OF SAID NE 1/4, 124.43 FEET TO THE NW CORNER OF THE S 1/2 OF SAID NE 1/4 THENCE S 89° 20' 00" W (ASSUMED BEARING) ON THE WEST LINE OF SAID NE 1/4, 124.43 FEET, THENCE S 00° 12' 00" W ON A LINE 109.11 FEET EAST OF AND PARALLEL TO THE WEST LINE OF THE S 1/2 OF SAID NE 1/4, 124.06 FEET, THENCE S 89° 20' 00" W, 124.09 FEET, THENCE S 00° 12' 00" W, 100.00 FEET TO A POINT ON THE SOUTH LINE OF THE S 1/2 OF SAID NE 1/4, THENCE S 89° 20' 00" E ON THE SOUTH LINE OF THE S 1/2 OF SAID NE 1/4, 110.00 FEET TO THE SE CORNER OF THE S 1/2 OF SAID NE 1/4 THENCE N 00° 02' 00" E ON THE EAST LINE OF THE S 1/2 OF SAID NE 1/4, 110.43 FEET TO THE POINT OF BEGINNING.

DATE: September 7, 1977
 James J. Hagan
 REGISTERED LAND SURVEYOR

DEDICATION
 KNOW ALL MEN BY THESE PRESENTS: THAT WE, BELLEVUE SOUTHWEST CORP., URBAN CORNER AND ROSALLE CORNER, NEBRASKA AND VEVE (VENOR), SCHOOL DISTRICT OF THE CITY OF BELLEVUE (LAND CONTRACT PURCHASER) BEING THE DONORS AND COMMERCIAL SAVINGS AND LOAN ASSOCIATION BEING THE MORTGAGEE HOLDERS OF THE LAND DESCRIBED WITHIN THE SURVEYOR'S CERTIFICATE AND INCORPORATED WITHIN THIS PLAT, HAVE CAUSED SAID LAND TO BE SUBDIVIDED INTO LOTS AND STREETS, TO BE BOUNDARY AND NAMED AS SHOWN, SAID SUBDIVISION TO BE BOUNDARY AND NAMED AS SHOWN ON THIS PLAT, AND WE DO HEREBY DEDICATE TO THE PUBLIC, FOR PUBLIC USE, THE STREETS AND EASEMENTS AS SHOWN ON THIS PLAT, AND WE DO FURTHER GRANT A PERPETUAL EASEMENT TO THE OMAHA PUBLIC POWER DISTRICT, AND NORTHWESTERN BELL TELEPHONE COMPANY, THEIR SUCCESSORS AND ASSIGNS, TO INSTALL, OPERATE, MAINTAIN, REPAIR AND REMOVE WIRES, CABLES, CROSSINGS, JUNK CANS AND ARCHES, CABLES, CONDUITS AND OTHER RELATED FACILITIES, AND TO EXTEND THEREON WIRES OR CABLES FOR THE CARRYING AND TRANSMISSION OF ELECTRIC CURRENT FOR LIGHT, HEAT, AND POWER FOR THE TRANSMISSION OF SIGNALS AND SOUNDS OF ALL KINDS AND THE RECEIVING THEREOF, ON, OVER, THROUGH, UNDER AND ACROSS A FIVE (5') FOOT WIDE STRIP OF LAND ADJOINING ALL FRONT AND SIDE BOUNDARY LOT LINES; AN EIGHT (8') FOOT WIDE STRIP OF LAND ADJOINING THE REAR BOUNDARY LINES OF ALL INTERIOR LOTS; AND A SIXTEEN (16') FOOT WIDE STRIP OF LAND ADJOINING THE REAR BOUNDARY LINES OF ALL EXTERIOR LOTS. THE TEN EXTERIOR LOTS IS HEREBY OFFERED AS THESE LOTS FORMING THE NORTH PART OF THE ABOVE DESCRIBED ADDITION. SAID SIXTEEN (16') FOOT WIDE EASEMENT WILL BE REDUCED TO AN EIGHT (8') FOOT WIDE STRIP WITH THE ADJACENT LAND IS SURVEYED, PLATTED AND RECORDED IF SAID SIXTEEN (16') FOOT EASEMENT IS NOT OCCUPIED BY UTILITY FACILITIES AND IF REQUESTED BY THE OWNER. NO PERMANENT BUILDINGS, TREES, RETAINING WALLS OR LOOSE ROCK WALLS SHALL BE PLACED IN THE SAID EASEMENT YARDS, BUT THE SAME MAY BE USED FOR GARDENS, SHRUBS, LANDSCAPING AND OTHER PURPOSES THAT DO NOT TRIP OR LATCH INTERFERE WITH THE APPLICABLE USES OR RIGHTS HEREIN GRANTED.

BELLEVUE SOUTHWEST CORP.
 Donald A. Harrison Pres.
 Donald C. Mangum Secy.
 COMMERCIAL FEDERAL SAVINGS AND LOAN ASSOCIATION
 James J. Hagan, Secy. Pres.
 Bruce A. Hagan, Cashier

SCHOOL DISTRICT OF THE CITY OF BELLEVUE
 James C. McCaskey

ACKNOWLEDGMENT OF NOTARY
 STATE OF NEBRASKA: SS
 COUNTY OF DOUGLASS: SS
 APPEARED Donald A. Harrison and Donald C. Mangum on this 7th day of September, 1977, before me, a Notary Public, duly commissioned and qualified in and for said county, and they did acknowledge their execution of the foregoing dedication to be their voluntary act and deed, and the voluntary act and deed of said corporation.
 MY COMMISSION EXPIRES July 23, 1979
 NOTARY PUBLIC: James C. McCaskey

ACKNOWLEDGMENT OF NOTARY
 STATE OF NEBRASKA: SS
 COUNTY OF DOUGLASS: SS
 APPEARED James J. Hagan and Bruce A. Hagan on this 7th day of September, 1977, before me, a Notary Public, duly commissioned and qualified in and for said county, and they did acknowledge their execution of the foregoing dedication to be their voluntary act and deed, and the voluntary act and deed of said corporation.
 MY COMMISSION EXPIRES March 1, 1978
 NOTARY PUBLIC: James C. McCaskey

ACKNOWLEDGMENT OF NOTARY
 STATE OF NEBRASKA: SS
 COUNTY OF DOUGLASS: SS
 APPEARED James J. Hagan and Bruce A. Hagan on this 7th day of September, 1977, before me, a Notary Public, duly commissioned and qualified in and for said county, and they did acknowledge their execution of the foregoing dedication to be their voluntary act and deed, and the voluntary act and deed of said commercial federal savings and loan association.
 MY COMMISSION EXPIRES March 1, 1978
 NOTARY PUBLIC: M. Ann W. Hildebrand

ACKNOWLEDGMENT OF NOTARY
 STATE OF NEBRASKA: SS
 COUNTY OF DOUGLASS: SS
 APPEARED James J. Hagan and Bruce A. Hagan on this 7th day of September, 1977, before me, a Notary Public, duly commissioned and qualified in and for said county, and they did acknowledge their execution of the foregoing dedication to be their voluntary act and deed.
 MY COMMISSION EXPIRES 2-3-81
 NOTARY PUBLIC: James C. McCaskey

SARPY COUNTY TREASURER'S CERTIFICATE
 I HEREBY CERTIFY THAT THE RECORDS OF MY OFFICE SHOW NO TAXES DUE OR DELINQUENT UPON THE LAND DESCRIBED IN THE SURVEYOR'S CERTIFICATE AS APPEARS ON THIS PLAT AS OF THE 7th DAY OF September, 1977.

APPROVAL OF SARPY COUNTY SURVEYOR
 THIS PLAT OF LEAWOOD OAKS III WAS APPROVED BY THE SARPY COUNTY SURVEYOR THIS 7th DAY OF September, 1977.
 SARPY COUNTY SURVEYOR: Thomas M. Whitney

APPROVAL OF BELLEVUE CITY PLANNING DEPARTMENT
 THIS PLAT OF LEAWOOD OAKS III WAS APPROVED BY THE BELLEVUE CITY PLANNING DEPARTMENT THIS 26th DAY OF October, 1977.
 CHAIRMAN: Ernest R. Penney

APPROVAL OF BELLEVUE CITY COUNCIL
 THIS PLAT OF LEAWOOD OAKS III WAS APPROVED BY THE BELLEVUE CITY COUNCIL THIS 7th DAY OF October, 1977.
 MAYOR: Robert W. Howard
 PRESIDENT: James C. McCaskey
 CITY CLERK: James C. McCaskey

Leawood Oaks III

THOMPSON DRESSER & DORNER
 Consulting Engineers & Land Surveyors
 1770 PACIFIC ST., OMAHA, NEBRASKA 68111
 TELEPHONE 387-7664 AREA CODE 402

Scale: 1" = 100'
 Date: 9-28-77

Project No.:

58