

Corrections Change

Lat 7	88.46	65.5'
Lat 8	88.46	65.5'
Lat 9	88.46	65.5'
Lat 10	88.46	65.5'
Lat 11	88.46	65.5'
Lat 12	88.46	65.5'
Lat 13	88.46	65.5'
Lat 14	88.46	65.5'
Lat 15	88.46	65.5'
Lat 16	88.46	65.5'
Lat 17	88.46	65.5'
Lat 18	88.46	65.5'
Lat 19	88.46	65.5'
Lat 20	88.46	65.5'
Lat 21	88.46	65.5'
Lat 22	88.46	65.5'
Lat 23	88.46	65.5'
Lat 24	88.46	65.5'
Lat 25	88.46	65.5'
Lat 26	88.46	65.5'
Lat 27	88.46	65.5'
Lat 28	88.46	65.5'
Lat 29	88.46	65.5'
Lat 30	88.46	65.5'
Lat 31	88.46	65.5'
Lat 32	88.46	65.5'
Lat 33	88.46	65.5'
Lat 34	88.46	65.5'
Lat 35	88.46	65.5'

O.R.D. BY J.P. CLARK
SEPT 3, 1955

SURVEYORS CERTIFICATE
This is to certify that I have accurately surveyed and staked the above described plat of land in the North Range 18 East of the 6th P.M. corner of the Bellevue Addition to the City of Bellevue and a tract of land and plat of land known as the Lawre Addition No. 1 in the City of Bellevue, Nebraska, as shown on the plat hereunto filed in the office of the Surveyor General for the State of Nebraska, and do hereby state that the above subdivision of the property is in accordance with the subdivision of the property described in the Surveyors Certificate as appears on this plat. I witness my hand and official seal at Bellevue, Nebraska, this 18th day of July, 1955.
Notary Public
J. Edgar E. Rice, Notary Public
My Commission expires on the 6th day of Jan. AD 1956.

DEDICATION
I know all men by these presents, that we, LAWRE, INC., Surveyors Certificate and embraced in this plat have caused said tract of land to be platted as shown and to be hereinafter known as the Lawre Addition No. 1, and do hereby dedicate to the public, for public use, the above subdivision of the property and do hereby state that the above subdivision of the property described in the Surveyors Certificate as appears on this plat is in accordance with the desire of the undersigned owners and proprietors of the same.

STATE OF NEBRASKA
County of Sarpy
On the 18th day of July, 1955, before me, a Notary Public duly commissioned and qualified in and for said county personally came the above named LAWRE, INC., who is personally known to me to be the identical person whose name is affixed to the above described Surveyors Certificate, and he has acknowledged to me in said county, the date last aforesaid.
Witness my hand and official seal at Bellevue, Nebraska, this 18th day of July, 1955.
J. Edgar E. Rice, Notary Public
My Commission expires on the 6th day of Jan. AD 1956.

COUNTY TREASURERS CERTIFICATE
I hereby certify that the records of my office show no taxes due on the property described in the plat, as of July 1, 1955.
J. Edgar E. Rice, Notary Public
My Commission expires on the 6th day of Jan. AD 1956.
J. Edgar E. Rice, Notary Public
My Commission expires on the 6th day of Jan. AD 1956.

ACCEPTANCE BY THE CITY COUNCIL OF BELLEVUE, NEBR.
This plat of LAWRE ADDITION NO. 1, as approved and accepted by the City Council of the City of Bellevue, Sarpy County, Nebraska, this 18th day of July, 1955 AD.
Attest: *Mary Stewart*
City Clerk.

LAWRE ADDITION NO. 1
CITY OF BELLEVUE, NEBR.
Sec 36 Twp 14N, R 18E, 6th
Sarpy County, Nebraska
KIRKPATRICK, SCHEIDT & ASSOCIATES
CORPORATE ENGINEERS
OMAHA, NEBRASKA

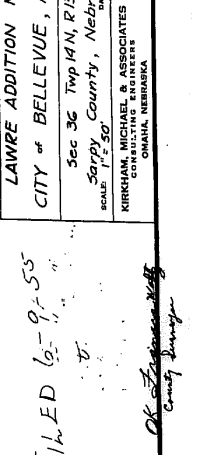

FILED 6-9-55

City Engineer

KNOW ALL MEN BY THESE PRESENTS:

THAT LAWRE, INC., BEING THE THEN OWNER AND PROPRIETOR OF ALL THE PROPERTY DESCRIBED IN THE SURVEYOR'S CERTIFICATE WHICH WAS ATTACHED TO THE PLAT OF LAWRE ADDITION No. 1, AS ORIGINALLY FILED AND RECORDED, DOES HEREBY STATE THAT IT WAS THE INTENTION OF THE OWNER AT THE TIME OF SAID DEDICATION AND PLATTING OF LAWRE ADDITION No. 1, TO DESIGNATE ALL THAT PART OF LAWRE ADDITION No. 1, EXCEPT:

- (1) LOTS ONE (1) TO THIRTY-FOUR (34), BOTH INCLUSIVE;
- (2) ALL STREETS, AVENUES AND ROADWAYS,

AS LOT TWO C (2C) OF LAWRE ADDITION No. 1, AND THAT THE SAID LAWRE, INC. DOES AT THIS TIME RATIFY AND CONFIRM THE DESIGNATION OF ALL THAT PART OF LAWRE ADDITION No. 1, EXCEPT

- (1) LOTS ONE (1) TO THIRTY-FOUR (34), BOTH INCLUSIVE;
- (2) ALL STREETS, AVENUES AND ROADWAYS,

AS LOT TWO C (2C) OF LAWRE ADDITION No. 1, AND DOES HEREBY AUTHORIZE SUCH DESIGNATION TO BE WRITTEN ON THE PLAT BY THE APPROPRIATE OFFICER OF THE COUNTY OF SARPY, STATE OF NEBRASKA.

LAWRE, INC.,

By *[Signature]*
PRESIDENT

ATTEST: *C. M. Lawrence*
SECRETARY

STATE OF NEBRASKA)
COUNTY OF DOUGLAS) ^{SS}

ON THIS 28 DAY OF March, 1962, BEFORE ME THE UNDERSIGNED, A NOTARY PUBLIC IN AND FOR SAID COUNTY, PERSONALLY CAME THE ABOVE NAMED *C. M. Lawrence*, PRESIDENT OF LAWRE, INC., WHO IS PERSONALLY KNOWN TO ME TO BE THE IDENTICAL PERSON WHOSE NAME IS AFFIXED TO THE FOREGOING DEDICATION, AND HE DID ACKNOWLEDGE THE SIGNING OF SAID DEDICATION TO BE HIS VOLUNTARY ACT AND DEED, AND THE VOLUNTARY ACT AND DEED OF SAID CORPORATION.

Mary Genet Taylor
NOTARY PUBLIC

My Commission Expires: Sept 26-1965