

ORDINANCE RECORD

No. 728-REDFIELD & COMPANY INC., OMAHA

ORDINANCE NO. 1006

AN ORDINANCE DECLARING THE NECESSITY, EXPEDIENCY AND PROPRIETY OF VACATING LOIS AVENUE IN THE CITY OF BELLEVUE, SARPY COUNTY, NEBRASKA, FROM THE INTERSECTION OF LOIS AVENUE AND BELLEVUE BOULEVARD NORTHWESTERLY TO A POINT WHERE LOIS AVENUE TERMINATES AT THE NORTHWESTERLY CORNER OF LOT 29 IN JEWELL PLACE, IN THE CITY OF BELLEVUE, NOT HERETOFORE VACATED; REPEALING ALL ORDINANCES AND ALL PARTS OF ORDINANCES IN CONFLICT HERewith AND DESIGNATING EFFECTIVE DATE.

WHEREAS, the City Council of the City of Bellevue, Nebraska, has determined that no damages will accrue to any citizens of the City of Bellevue, nor to any owners of property herein by reason of the proposed vacation.

NOW, THEREFORE,

BE IT ORDAINED BY THE MAYOR AND COUNCIL OF THE CITY OF BELLEVUE, NEBRASKA:

Section 1. It is hereby necessary, expedient and proper to vacate all of Lois Avenue in the City of Bellevue, Sarpy County, Nebraska, from the intersection of Lois Avenue and Bellevue Boulevard, Northwesterly to a point where Lois Avenue terminates at the Northwesterly corner of Lot 29 in Jewell Place, in the City of Bellevue, not heretofore vacated, and the same be and hereby is vacated.

Section 2. All ordinances and parts of ordinances in conflict herewith are hereby repealed.

Section 3. This ordinance shall become effective after its passage, approval and publication according to law.

Passed and approved this 12th day of April, 1971.

Robert M. Hawth
Mayor

Attest:

Mary Ann Clark
City Clerk

FILED SARPY CO. NE.
INSTRUMENT NUMBER
91-09360

91 JUL -8 PM 12:34

Carol J. Davis
REGISTER OF DEEDS

First Reading: April 12, 1971

Second Reading: April 13, 1971

Third Reading: April 12, 1971

Proof	<u>m</u>
D.E.	<u>✓</u>
Verify	<u>✓</u>
Filmed	<u>✓</u>
Checked	<u>✓</u>
Fee \$	<u>11.50</u>

09960

409460A-16

14A2B
15B1A4

BIB3
BIB2

PT. OF
15B1A2

HARVEL

BELLEVUE

15B1A3

18B 59A1A

18C

61A

RS 84

61B

61C

60D

60C 60B

ROAD

LOGAN AVENUE

LOUISIANA DRIVE

NORMANDY

LEWIS AVENUE

RS 84

29A

28A

FREEMAN DR.

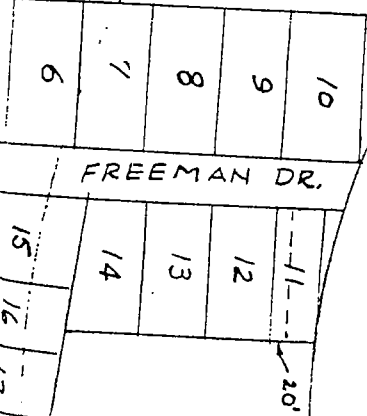

28B

RS 84

PARK AVENUE

27A

22F

23

RS 120

JEWELL PARK

21B

21A

20

19

18B

18A

36D

35C

33B

33A

33D

32C

32A

32D

32B

1

2

3

4

5

6

7

8

9

10

11

12

13

14

15

16

60C

60D

61A

61B

61C

62A

62B

62C

62D

62E

62F

62G

62H

62I

62J

62K

59A1A

59A1B

59A1C

59A1D

59A1E

59A1F

59A1G

59A1H

59A1I

59A1J

59A1K

59A1L

59A1M

59A1N

59A1O

59A1P

18B

18C

18D

18E

18F

18G

18H

18I

18J

18K

18L

18M

18N

18O

18P

18Q

15B1A3

15B1A4

15B1A5

15B1A6

15B1A7

15B1A8

15B1A9

15B1A10

15B1A11

15B1A12

15B1A13

15B1A14

15B1A15

15B1A16

15B1A17

15B1A18

14A2B

14A2C

14A2D

14A2E

14A2F

14A2G

14A2H

14A2I

14A2J

14A2K

14A2L

14A2M

14A2N

14A2O

14A2P

14A2Q

LIS REGIER, A.I.A.
REGISTERED PROFESSIONAL ARCHITECT