

HABITAT FOR HUMANITY ADDITION II

BEING A REPLAT OF TAX LOT B3A1, LOCATED IN PART OF THE
 NORTHEAST ONE-QUARTER OF SECTION 16, TOWNSHIP 14 NORTH,
 RANGE 13 EAST OF THE 6TH P.M., SARPY COUNTY, NEBRASKA.

LOTS 1 THRU 6

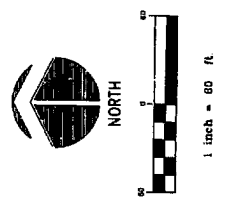
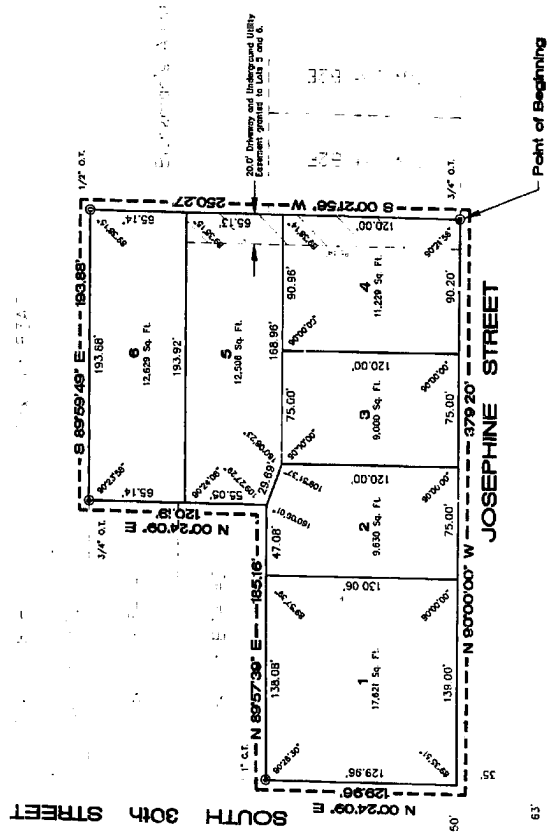

• = CORNERS FOUND
 O.T. = OPEN TOP PIPE



Plan No. 3-391-0-552M
 44-006172
 Royd L. Unwinng, Engineer at Large, Sarpy Co., NE

SURVEYOR'S CERTIFICATE
 I, THE UNDERSIGNED REGISTERED LAND SURVEYOR, DO HEREBY CERTIFY THAT THE CORNERS, BEARINGS AND DISTANCES SHOWN ON ALL LOTS AND STREETS IN "HABITAT FOR HUMANITY ADDITION II", BEING ALL LOTS B3A1, LOCATED IN PART OF THE NORTHEAST ONE-QUARTER OF SECTION 16, TOWNSHIP 14 NORTH, RANGE 13 EAST OF THE 6TH P.M., SARPY COUNTY, NEBRASKA, BEING MORE PARTICULARLY DESCRIBED AS FOLLOWS: BEING THE NORTHWEST 1/4 OF LOT B3A1, THENCE N 80°00'00" W (ASSUMED BEARING) 379.20 FEET ALONG THE NORTH-TO-SOUTH LINE OF JOSEPHINE STREET TO THE INTERSECTION WITH THE EAST RIGHT-OF-WAY LINE OF JOSEPHINE STREET; N 89°57'30" E 138.08 FEET ALONG SAID EAST RIGHT-OF-WAY LINE; THENCE N 89°57'30" E 181.16 FEET TO THE POINT OF BEGINNING; S 89°54'07" E 183.89 FEET TO THE NORTHEAST CORNER OF SAID TAX LOT B3A1; THENCE S 00°21'18" W 250.27 FEET TO THE POINT OF BEGINNING. DESCRIBED TRACT CONTAINS 1.87 ACRES, MORE OR LESS.

DATE February 29 1999
 MICHAEL R. SHARP R.L.S., REG. NO. 515

DEDICATION
 KNOW ALL MEN BY THESE PRESENTS THAT I, KAREN FENRIDGE, BEING THE OWNERS OF THE PROPERTY TO BE HEREINAFTER DESCRIBED, DO HEREBY DEDICATE TO THE PUBLIC THE RIGHT OF WAY AND EASEMENTS SHOWN ON THIS PLAT, TO BE HEREINAFTER REFERRED TO AS "THE DEDICATED PROPERTY". AS SHOWN ON THIS PLAT, I DO NOT INTEND TO RESERVE ANY RIGHTS OR INTERESTS IN SAID DEDICATED PROPERTY. THE DEDICATION OF SAID PROPERTY IS MADE FOR THE USE AND BENEFIT OF THE PUBLIC AND SHALL BE SUBJECT TO ANY AND ALL LAWS, ORDINANCES, REGULATIONS, RULES AND ORDERS OF THE BOARD OF PUBLIC UTILITIES AND OTHER AGENCIES HAVING JURISDICTION THEREIN. I, THE DEDICATOR, HEREBY CERTIFY THAT SAID DEDICATION IS MADE VOLUNTARILY AND WITHOUT RESERVATION OF ANY RIGHTS OR INTERESTS IN SAID PROPERTY. I, THE DEDICATOR, HEREBY CERTIFY THAT SAID DEDICATION IS MADE FOR THE USE AND BENEFIT OF THE PUBLIC AND SHALL BE SUBJECT TO ANY AND ALL LAWS, ORDINANCES, REGULATIONS, RULES AND ORDERS OF THE BOARD OF PUBLIC UTILITIES AND OTHER AGENCIES HAVING JURISDICTION THEREIN. I, THE DEDICATOR, HEREBY CERTIFY THAT SAID DEDICATION IS MADE VOLUNTARILY AND WITHOUT RESERVATION OF ANY RIGHTS OR INTERESTS IN SAID PROPERTY. I, THE DEDICATOR, HEREBY CERTIFY THAT SAID DEDICATION IS MADE FOR THE USE AND BENEFIT OF THE PUBLIC AND SHALL BE SUBJECT TO ANY AND ALL LAWS, ORDINANCES, REGULATIONS, RULES AND ORDERS OF THE BOARD OF PUBLIC UTILITIES AND OTHER AGENCIES HAVING JURISDICTION THEREIN.

DATE February 29 1999
 KAREN FENRIDGE, PERSONAL REPRESENTATIVE

ACKNOWLEDGEMENT OF NOTARY
 I, John E. Brien, Notary Public for the State of Nebraska, County of Sarpy, do hereby certify that the foregoing was read and acknowledged by the person whose name appears on the dedication on this plat and said acknowledgment was made for the purpose herein stated and in full view of me and my witnesses.

APPROVAL OF BELLEVUE PLANNING DIRECTOR
 THIS PLAT OF "HABITAT FOR HUMANITY ADDITION II" WAS APPROVED BY THE BELLEVUE PLANNING DIRECTOR THIS 28 DAY OF February, 1999.

APPROVAL OF BELLEVUE PUBLIC WORKS DIRECTOR
 THIS PLAT OF "HABITAT FOR HUMANITY ADDITION II" WAS APPROVED BY THE BELLEVUE PUBLIC WORKS DIRECTOR THIS 28 DAY OF February, 1999.

APPROVAL OF BELLEVUE CITY ENGINEER
 THIS PLAT OF "HABITAT FOR HUMANITY ADDITION II" WAS APPROVED BY THE BELLEVUE CITY ENGINEER THIS 28 DAY OF February, 1999.

COUNTY TREASURER CERTIFICATE
 THIS IS TO CERTIFY THAT THESE ARE THE TAXES DUE ON DEDICATED PROPERTY AS SHOWN ON THE RECORDS OF THIS OFFICE.
 DATE: 2-23-99

REVIEW OF SARPY COUNTY SURVEYOR
 I HAVE REVIEWED THIS PLAT OF "HABITAT FOR HUMANITY ADDITION II" THIS 23 DAY OF February, 1999.
 DATE: 2-23-99

NE1/4 SEC 16 T14N R13E

1 inch = 200 feet

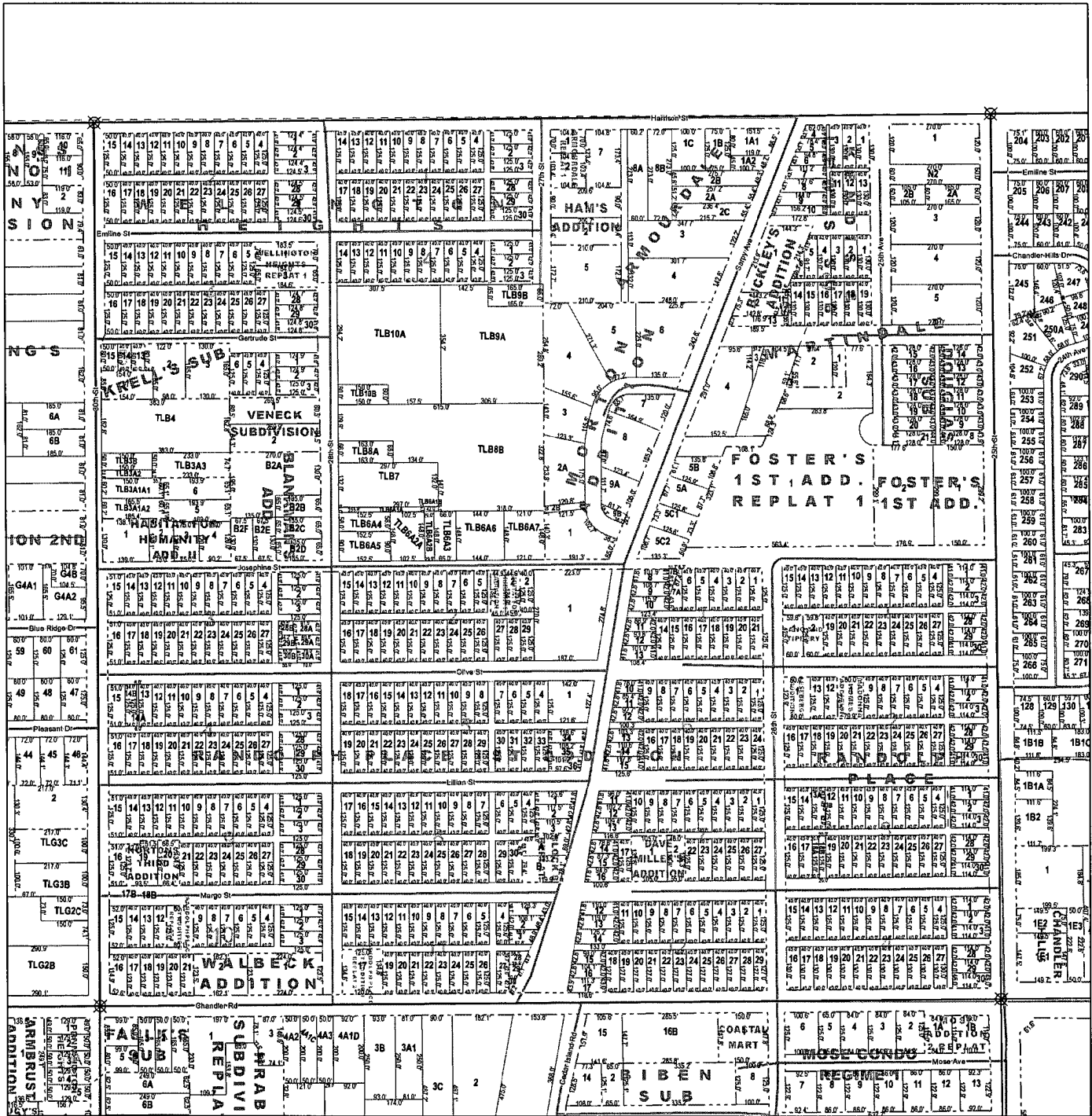

SARPY COUNTY
SURVEYOR'S OFFICE

sarpy county
GIS

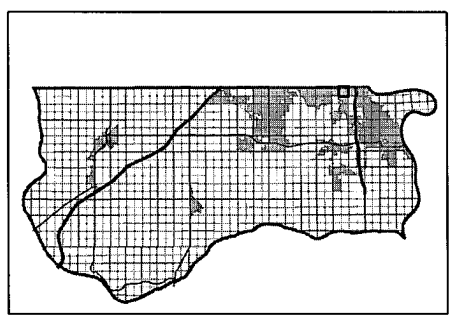

Legend

- Corners
- Quarter Sections
- Subdivisions
- Rights of Way
- Lots
- Blocks
- Railroads
- Street Centerline

NOTICE

This map constitutes a representation based on information provided to the Sarpy County Surveyors Office by other individuals and organizations. Therefore no representations regarding the accuracy of the size, dimensions, measurements, condition, platting, or location of the within described area are made. Should such information be required for construction, zoning, or other purposes, the services of a private surveyor and/or title search should be secured.

This Map Was Printed On:
6/23/2009

99-006170

FILED SARPY CO. NE.
INSTRUMENT NUMBER
99-006170

99 MAR -3 PM 2:53

Lloyd J. Dowding
REGISTER OF DEEDS

Counter MSD
Verify MSD
D.E. MSD
Proof MSD
Fee \$ 15.50
Ck Cash Chg



**THIS PAGE ADDED
FOR RECORDING
INFORMATION.**

**DOCUMENT STARTS ON
NEXT PAGE.**

LLOYD J. DOWDING
SARPY COUNTY REGISTER OF DEEDS
1210 GOLDEN GATE DRIVE, #1109
PAPILLION, NE 68046-2895
402-593-5773

99-006170A

PLAT AND DEDICATION FOR STREET WIDENING

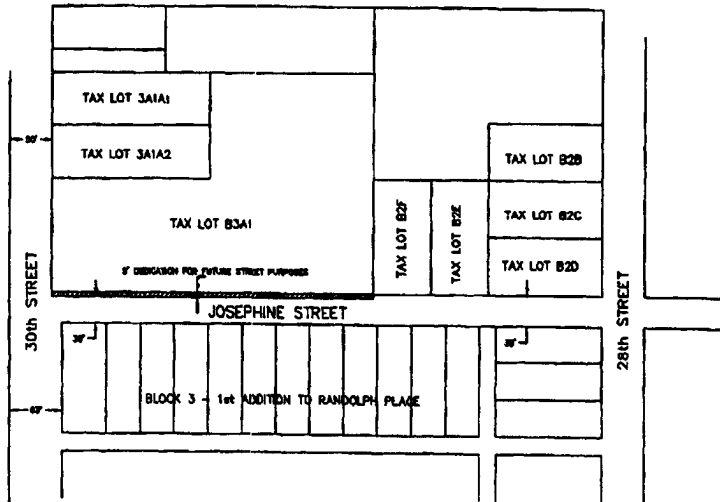

DEDICATION: KNOW ALL PERSONS BY THESE PRESENTS: That (we)(I) the undersigned Karen Pendrock, sole owners of the five foot strip of land described below and embraced within the above plat and shown as additional right of way for Josephine St. hereby dedicate(s) to the public for public use the said five foot strip for street purposes to be hereafter known as Josephine St.

LEGAL DESCRIPTION: (attach additional sheets if needed)

The South 5.00 feet of Tax Lot B3A1, located in the Northeast $\frac{1}{4}$ of Section 16, T14N, R13E of the 6th P.M., Sarpy County, Nebraska.

Acknowledgement by Individual

State of Nebraska)
) s.s.
 County of Sarpy)

Karen Pendrock

Owner's Signature

KAREN PENDROCK

(Print or Type Name of Owner)

The foregoing Dedication was acknowledged before me this 3 day of March, 19 99, by

Karen Pendrock

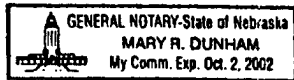

Mary R. Dunham
 Notary Public

006170

99-006170 B

MORTGAGE RELEASE: That _____ Mortgage(s) under Mortgage dated ____ day of _____, 19__, recorded at _____ Book No. ____, Page No. ____, Mortgage Records, Sarpy County, Nebraska covering _____ foot of land above described hereby consent to and approve of plat and dedication and release from said mortgage the _____ foot strip dedicated for street purposes without prejudice to the lien of mortgage on the remaining real estate.

State of Nebraska)
) s.s.
 County of Sarpy)

 Mortgagee

The foregoing Mortgage Release was acknowledged before me this ____ day of _____, 19__, by _____ of _____, on behalf of _____.

 Notary Public

Acknowledgement of Corporation

State of Nebraska)
) s.s.
 County of Sarpy)

The foregoing Dedication was acknowledged before me this ____ day of _____, 19__ by _____ of _____, a corporation, on behalf of said corporation.

 Notary Public

Acknowledgement of Corporation

State of Nebraska)
) s.s.
 County of Sarpy)

The foregoing Dedication was acknowledged before me this ____ day of _____, 19__ by _____ of _____, a corporation, on behalf of said corporation.

 Notary Public

APPROVALS: Above plat and dedication recommended for approval by:

City Engineer	<u><i>Darryl D. Bergstrom</i></u>	Date: <u>2/5/99</u>
Planning Director	<u><i>Tom E. [unclear]</i></u>	Date: <u>2/5/99</u>
Public Works Director	<u><i>Don [unclear]</i></u>	Date: <u>2/5/99</u>

This plat and dedication approved and accepted by the City Council of BELLEVUE this 25th day of January, 1999.

ATTEST *Beverly J. Kelly*
 City Clerk

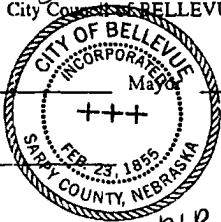

[Signature]
 Greater Bellevue Habitat for Humanity Inc.
 P.O. Box 1664
 Bellevue, NE 68005

President, City Council _____

RTR

FILED SARPY CO. NE.
INSTRUMENT NUMBER
99-006171
99 MAR -3 PM 2: 53

Glenn J. Dowling
REGISTER OF DEEDS

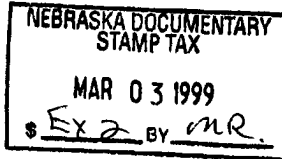

Counter MD
Verify S
D.E. A
Proof R
Fee \$ 5.50
Ck Cash Chg

WARRANTY DEED

KAREN PENDROCK, Personal Representative, Grantor, in consideration of One Dollar (\$1.00) and other valuable consideration received from THE CITY OF BELLEVUE, NEBRASKA, a municipal corporation, GRANTEE, conveys and grants to GRANTEE, the following described real estate (as defined in Neb. Rev. Stat. 76-201):

THE SOUTH 5.00 FEET OF TAX LOT B3A1, LOCATED IN THE NORTHEAST ¼ OF SECTION 16, TOWNSHIP 14 NORTH, RANGE 13 EAST OF THE 6th P.M., SARPY COUNTY, NEBRASKA.

GRANTOR covenants with GRANTEE that GRANTOR:

- (1) Is lawfully seized of such real estate and that it free from encumbrance;
- (2) Has legal power and lawful authority to convey the same; and
- (3) Warrants and will defend title to the real estate against the lawful claims of all persons.

GRANTOR

Karen Pendrock PR

Karen Pendrock,
Personal Representative

STATE OF NEBRASKA)
) SS.
COUNTY OF SARPY)

The undersigned, a Notary Public in and for said County, does hereby certify that Karen Pendrock, whose name if signed to the foregoing instrument and who is known to me, acknowledged before me on this day and is executed and delivered said instrument as her voluntary act and deed.

WITNESS my hand and notarial seal this 3 day of March 1999

My Commission Expires _____

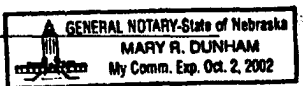

Mary R. Dunham
Notary Public

006171

KNOW ALL MEN BY THESE PRESENTS, That

James Mayer & Marie A. Mayer (Husband & Wife)

in consideration of One Dollar and other Valuable Considerations (\$1.00) - DOLLARS in hand paid, do hereby grant, bargain, sell, convey and confirm unto

John C. Bower & Dorothy M. Bower (Husband & Wife)

as JOINT TENANTS, and not as tenants in common; the following described real estate, situated in the County of Sarpy, and State of Nebraska, to-wit:

Starting at a point 1320 feet south of the North-West corner of the North-East quarter of Section 16, Township 14 north, range 13 east of the 6th. Principle Meridian, thence east 17 feet to the point of beginning; thence east 375 feet, thence north 255 feet, thence west 194 feet, thence south 120 feet, thence west 125 feet, thence south 135 feet to point of beginning as is surveyed, platted and recorded in Sarpy County, Nebraska. Known as that portion of Tax Lot B3A1 according to the surveyor's certificate as of May 13th, 1954. Also known as 7217 South 30th. Street, Omaha, Nebr.



together with all the tenements, hereditaments and appurtenances to the same belonging, and all the estate; title, dower, right of homestead, claim or demand whatsoever of the said grantor s , of, in or to the same, or any part thereof; subject to 1954 taxes due in 1955 and subsequent taxes.

IT BEING THE INTENTION OF ALL PARTIES HERETO, THAT IN THE EVENT OF THE DEATH OF EITHER OF SAID GRANTEEES, THE ENTIRE FEE SIMPLE TITLE TO THE REAL ESTATE DESCRIBED HEREIN SHALL VEST IN THE SURVIVING GRANTEE.

TO HAVE AND TO HOLD the above described premises, with the appurtenances, unto the said grantees as JOINT TENANTS, and not as tenants in common, and to their assigns, or to the heirs and assigns of the survivor of them, forever, and they the grantor s named herein for themselves and their heirs, executors, and administrators, do covenant with the grantees named herein and with their assigns and with the heirs and assigns of the survivor of them, that they are lawfully seized of said premises; that they are free from incumbrance except as stated herein, and that they the said grantor s have good right and lawful authority to sell the same, and that they will and their heirs, executors and administrators shall warrant and defend the same unto the grantees named herein and unto their assigns and unto the heirs and assigns of the survivor of them, forever, against the lawful claims of all persons whomsoever, excluding the exceptions named herein.

IN WITNESS WHEREOF We have hereunto set our hands this 19th. day of

1954. In presence of Lawrence H. Leap James Mayer Marie A. Mayer

Entered in Numerical Index and Recorded in the Register of Deeds office in Sarpy County, Nebraska 20 day May 19 54 at 10:00 AM, Geo. F. Nicholson, County Clerk 513 & 02.

FILED SARPY CO. NE.
 INSTRUMENT NUMBER
 98-000256
 98 JAN -6 AM10:04
 REGISTER OF DEEDS

98-000256
 Counter
 Verify: *[initials]*
 D.E.
 Proof: *[initials]*
 Fee: 5.50
 Ck
 Cash
 Charge

WHEN THIS COPY CARRIES THE RAISED SEAL OF THE NEBRASKA HEALTH AND HUMAN SERVICES SYSTEM, IT CERTIFIES THE BELOW TO BE A TRUE COPY OF THE ORIGINAL RECORD ON FILE WITH THE NEBRASKA HEALTH AND HUMAN SERVICES SYSTEM, VITAL STATISTICS SECTION, WHICH IS THE LEGAL DEPOSITORY FOR VITAL RECORDS.

DATE OF ISSUANCE
 JAN 8 1998
 LINCOLN, NEBRASKA

Stanley S. Cooper
 STANLEY S. COOPER
 ASSISTANT STATE REGISTRAR
 HEALTH AND HUMAN SERVICES SYSTEM

SEAL

STATE OF NEBRASKA — DEPARTMENT OF HEALTH
 BUREAU OF VITAL STATISTICS
 CERTIFICATE OF DEATH

96-04008

1. DECEASED - NAME FIRST MIDDLE LAST Dorothy M. Bowen		2. SEX Female	3. DATE OF DEATH March 27, 1996
4. CITY AND STATE OF BIRTH Belvidere, Nebraska		5a. AGE - Last birthday (Yrs) 79	5b. DATE OF BIRTH April 20, 1916
7. BOOK, SECURITY NUMBER 505-62-8949		8. PLACE OF BIRTH Huntington Park Care Center	
9. CITY, TOWN OR LOCATION OF BIRTH Papillion		10. COUNTY OF BIRTH Sarpy	
11. RACE - (See instructions) White		12. NAME OF SPOUSE John C. Bowen	
13. USUAL OCCUPATION Elementary Teacher		14. EDUCATION 11th grade	
15. FATHER - NAME William N. Morehouse		16. MOTHER - NAME Mary G. Arnold	
17. HOME ADDRESS 7217 South 30th Street, Bellevue, Nebraska 68147		18. PLACE OF INTERMENT St. John's Cemetery	
19. FUNERAL HOME Kahler-Dolce Mortuary		20. CITY OR TOWN OF INTERMENT Bellevue, Nebraska	
21. RESIDENTIAL ADDRESS 441 N. Washington Street, Papillion, Nebraska 68046-2231		22. CAUSE OF DEATH Cardiopulmonary Arrest	
23. OTHER SIGNIFICANT CONDITIONS Alzheimer's Disease		24. THIS CASE REFERRED TO MEDICAL EXAMINER OR CORONER? Yes	
25. DATE OF DEATH 3-27-96		26. TIME OF DEATH 8:25 A.	
27. DATE BORN 4-1-96		28. THIS CASE REFERRED TO MEDICAL EXAMINER OR CORONER? Yes	
29. SIGNATURE OF REGISTRAR <i>Eugene J. Barone</i>		30. DATE FILED APR 5 1998	

Tax Lot B3A1B 16-14-13 (1.79 ac.) Tax Lots to Bellevue, as surveyed, platted and recorded in Sarpy County, Nebraska.

WHEN RECORDED RETURN TO:
 Thomas J. Wik
 13831 Millard Ave.
 Omaha, NE 68137

000256

99-006530

FILED SARPY CO. NE.
INSTRUMENT NUMBER
99-006530

99 MAR -8 AM 9: 52

Glenn J. Dowling
REGISTER OF DEEDS

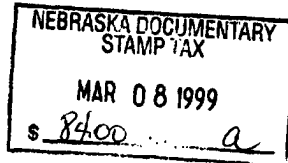

Counter ay
Verify S
D.E. a
Proof nk
Fee \$ 7.50
Chk Cash Chg

DEED OF DISTRIBUTION BY PERSONAL REPRESENTATIVE

Karen Pendrock, Personal Representative of the Estate of John C. Bowen, Deceased, pursuant to appointment by the County Court of Sarpy County, Nebraska, GRANTOR, conveys and releases to Greater Bellevue Habitat for Humanity, GRANTEE, the following described real estate (as defined in Neb. Rev. Stat. § 76-201):

Lots 2, 3, 4, 5 and 6, Habitat for Humanity Addition II as platted, surveyed and recorded in Sarpy County, Nebraska.

subject to easements and restrictions of record.

GRANTOR covenants with GRANTEE that GRANTOR has legal power and lawful authority to convey and release the same.

Executed the 5 day of March, 1999.

Karen Pendrock, Personal Representative
Karen Pendrock, Personal Representative of the Estate of John C. Bowen, Deceased

STATE OF NEBRASKA)
COUNTY OF Sarpy) SS

The foregoing instrument was acknowledged before me on the 5 day of March, 1999, by Karen Pendrock, Personal Representative of the Estate of John C. Bowen, Deceased.

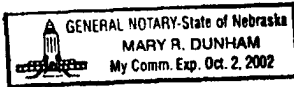

Mary R Dunham
Notary Public

STATE OF NEBRASKA, County of Sarpy. Filed for record and entered in Numerical Index on _____, 19____, at _____: ____ .m. and recorded in Deed Record _____ at Page _____.



FILED SARPY CO. NE.
INSTRUMENT NUMBER
99-026173

99 AUG 18 AM 10:54

Glenn J. Downing
REGISTER OF DEEDS

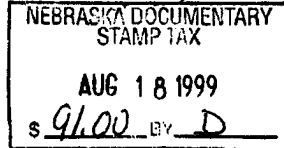

99-26173
Counter DW
Verify M
D.E. AK
Proof a
Fee \$ 5.50
Ok Cash Eng

DEED OF DISTRIBUTION BY PERSONAL REPRESENTATIVE

Karen Pendrock, Personal Representative of the Estate of John C. Bowen, Deceased, pursuant to appointment by the County Court of Sarpy County, Nebraska, GRANTOR, conveys and releases to Donna J. Grove, a single person, GRANTEE, the following described real estate (as defined in Neb. Rev. Stat. § 76-201):

Lot 1 in Habitat for Humanity Addition II, a Subdivision in Sarpy County Nebraska.

subject to easements and restrictions of record.
GRANTOR covenants with GRANTEE that GRANTOR has legal power and lawful authority to convey and release the same.

Executed the 11th day of August, 1999.

Karen Pendrock
Karen Pendrock, Personal
Representative of the Estate of
John C. Bowen, Deceased

STATE OF NEBRASKA)
) SS
COUNTY OF DOUGLAS)

11th The foregoing instrument was acknowledged before me on the 11th day of August, 1999, by Karen Pendrock, Personal Representative of the Estate of John C. Bowen, Deceased.



Catherine A. Woells
Notary Public

STATE OF NEBRASKA, County of Sarpy. Filed for record and entered in Numerical Index on _____, 19____, at _____: _____m. and recorded in Deed Record _____ at Page _____.



NE1/4NE1/4
NW1/4NE1/4
SW1/4NE1/4
SE1/4NE1/4

NE1/4NW1/4
NW1/4NW1/4
SW1/4NW1/4
SE1/4NW1/4

NE1/4SW1/4
NW1/4SW1/4
SW1/4SW1/4
SE1/4SW1/4

NE1/4SE1/4
NW1/4SE1/4
SW1/4SE1/4
SE1/4SE1/4

DATE	GRANTOR	GRANTEE	KIND OF INSTRUMENT	RECORD BOOK PAGE	QUARTERS				ACRES	REMARKS
					N.E. QUARTER	N.W. QUARTER	S.W. QUARTER	S.E. QUARTER		
	Walter J. McCoy, of	Emma Loan & Bldg. Assn	mtg	2 549	2				1/2 Sec 22	Com 28-618
	Jane Johnson, et al	William C. Johnson	GC.D.	42 80	2				15	
	Frank C. Johnson, of	William C. Johnson	GC.D.	42 127	2				35	
	Joseph H. Kopytz, Casp. Co.	Joseph Holcar	Lein	8 50					5	Ad. 2 Com. Map
	Mary Leigen	Antonia Leigen	W.D.	43 203	2				1	Lot 2 E
	Fred Lovers	Jessie Horn	W.D.	43 214	2				1/2	Lot 2 L.
	John R. Holliday, of	James J. Jaks	W.D.	43 346	2				1/2	Lot 2 in Wellington Heights
	Charles W. Martin, of	Harbert K. Martin	GC.D.	44 89					15	D 2
	Harry J. Fenner, of	Harbert K. Martin	mtg	49 48					3 3/4	Com. 30-443
	Harbert K. Martin	Harry J. Fenner	W.D.	42 365					3 3/4	D 7 B
	Harbert K. Martin	Charles W. Martin	GC.D.	44 90					5	D 9
	James W. Adams, of	Jesse L. Thompson	W.D.	43 271	2					Lot 8 7
	Etzel Johnson, Trust	Em. Loan & Bldg. Assn	mtg	28 28					10	Lot 2 Com. 34
	Antonia Leigen, of	John Sterba, of	W.D.	43 418	2				1	Lot 2 E
	John Sterba, of	Em. Loan & Bldg. Assn	mtg	28 22					1	Com 27-633
	Bessie L. Ingersoll, Trust	Vac Jaros, of	W.D.	43 558					10	Lot 2 E
	Edward Winkler	James F. Kettering, Belushi	mtg	27 188					10	Lot 2 E Com 30-369
	Julia A. Kopytz	Nebraska Distilling	Comer.	41 21					5	
	Joseph Coufal, of	Joseph Coufal, of	W.D.	45 81	2				2 1/2	8 9
	Ernest D. Smiley, of	Henric K. Whittlesey	mtg	27 198					2	Com 32-223
	Joseph Bruntonad, of	Emilia Johanna Abogman	W.D.	46 19					1/2	Lot 28 Pleasant Hill
	Emilia Johanna Abogman	Joseph Bruntonad, of	mtg	27 274					1/2	Lot 35 Pleasant Hill
	Jessie Horn	Com. Dev. & Loan Association	mtg	28 282						Com 34-344
	Edward S. Christie, of	Harry M. Christie, et al	GC.D.	46 69						Lot 2 E
	Harry M. Christie, et al	Fred Lovers	GC.D.	46 70						Lot 2 E
	Samuel J. Gaker, Jr, of	Fred Lovers	GC.D.	46 71						Lot 2 E
	Fred Lovers	Jessie Horn	W.D.	45 243						Lot 2 E
	Jessie L. Adams, et al	Paul K. Martin	W.D.	46 76						7th Lot 7
	Paul K. Martin	Jessie L. Adams	W.D.	45 274						19th 7th Lot 7
	Walter J. McCoy, of	May Sewer Mose	mtg	27 222	2					Lot 2 E Com 36-69
	Chris Jacobson	William J. May, Comer.	off.	44 284	2					
	James L. Jacobson, of	William C. Jacobson	W.D.	45 329	2					8 6
	William C. Jacobson, of	Charles W. Jaks, of	W.D.	46 285	2					Com 28-243
	Emilia Johanna Abogman	M. D. Cameron	mtg	30 49						Lot 28 Pleasant Hill
	Emilia Johanna Abogman	Carl B. Olson, of	W.D.	45 353						Com 32-449
	James Saada, of	Ornithos, of Bldg. Assn	mtg	28 72	2					Lot 28-419
	Forest M. Oakes, of	Kasens Bookman	mtg	30 201						Lot 28-570
	William A. Daehler, of	Etta A. Weiss	W.D.	45 421						1 1/2
	Kasens Bookman, et al	Forest M. Oakes	W.D.	48 1						1/2 7th-5th
	Forest M. Oakes, of	Loath Omaha Sav. Bank	mtg	27 282						Com 34-453
	John Sterba, of	Eda M. Dutz	W.D.	48 49						Com 34-452
	Edna M. Dutz, et al	Em. Loan & Bldg. Assn	mtg	32 37						8 5
	Lebbe L. Smiley, et al	Jay L. Smiley	W.D.	48 104						Com 34-115
	Jay L. Smiley, of	Commercial Dev. & Loan Assn	mtg	32 96						D 6
	Bessie L. Ingersoll, et al	Ernest D. Smiley, et al	W.D.	47 274						Lot 192' D 50
	Bessie L. Ingersoll, et al	Warriett A. Smiley	W.D.	47 275						77.144' D 50

Please see next page

1/2 of Sec 12 & 13 of Twp 14 Rng 13

LOT NOS. NE 1/4 NW 1/4 SW 1/4 SE 1/4 NE 1/4 SW 1/4 SE 1/4 NW 1/4 SE 1/4 NE 1/4 SW 1/4 SE 1/4 NW 1/4 SE 1/4

SEC. 16 TWP. 14 RNG. 13

SARPY COUNTY, NEBRASKA

GRANTOR	GRANTEE	KIND OF INSTRUMENT	RECORD		QUARTERS				ACRES	REMARKS	DATE
			BOOK	PAGE	N.E. QUARTER	N.W. QUARTER	S.W. QUARTER	S.E. QUARTER			
William J. Kicht & w/f	Com. Adv. Loan Assn	Mtg	51	193							Com 34-474
Cassie Cohen & h	Harry J. Lerner & w/f	Mtg	51	108							D 7 th Com 34-262
Cassie Cohen & h	Joseph Giles	Mtg	51	107							D 7 th Com 34-118
Byron S. Amiley & w/f	Harrist A. Amiley	W.D.	48	168							D 7 th Com 34-118
Harry J. Lerner & w/f	Cassie Cohen & h	W.D.	47	304							D 7 th
Joseph Coufal & w/f	Omaha Loan & Bldg Assn	Mtg	52	229							B ⁹ Com 34-476
Cassie Cohen & h	Joseph Giles	Mtg	51	118							Com 34-260
Naclaw Jasso & w/f	Joseph Grand	W.D.	48	251							D 7 th D 7 th
Joseph Grand	Naclaw Jasso & w/f	Mtg	52	317							B ⁹
Omaha Loan & Bldg Assn	Joseph Coufal & h	Rel	52	223							B ⁹
Harrist A. Amiley & h	Byron S. Amiley & w/f	W.D.	48	352							B ⁹
Omaha Loan & Building Assn	James Bragda & w/f	Rel	52	449							3 A ²
James Bragda & w/f	John Bragda & w/f	W.D.	48	376							B ⁹
John Bragda & w/f	Omaha Loan & Building Assn	Mtg	52	450							Com 34-198
Nellie S. Hutchinson	Baptist Home of Monroe County	Grant	52	476							1 ² Permit Hill
Joseph Coufal & w/f	Omaha Loan & Building Assn	Mtg	52	538							2 ⁵⁰ B ⁹ Com 34-476
Otto A. Weiss	Eleanor Maslowsky & w/f	Rel	52	550							Permit Hill 1 ²
Emma M. Doty & h	Joseph Kupomach & w/f	W.D.	48	631							1 B ⁹
Robert K. Martens	Whom it may Concern	Off	48	568							4
Robert K. Martens	Whom it may Concern	Off	48	370							4
Forest M. Baker & w/f	First Omaha Savings Bank	Mtg	51	269							20 Com 42-122
John Dehaack & w/f	Andrew Schaller	W.D.	48	685							10 D ²
J. H. Koppitz	Whom it may Concern	Off	47	403							10 D ²
Omaha Loan & Bldg Assn	Ethel Schell, et al	Rel	51	36							10
Joseph Grand & w/f	Naclaw Jasso, et al	Mtg	51	384							10
Fred Scheller & w/f	George Scheller	W.D.	50	1							10
Ida Scheller Shear	George Scheller	Q.C.D.	49	102							Com 34-669
Frank Hancock & w/f	Walter J. McCoy	Mtg	51	386							2.04 Lot B ²
Walter J. McCoy & w/f	Frank J. Hancock	W.D.	50	6							2.04 Lot B ²
H. R. Martens	Whom it may Concern	Off	47	424							Lot B ²
Wagner & Moore	Walter J. McCoy & w/f	Rel	51	69							Lot B ²
Omaha Loan & Bldg Assn	Edna M. Doty & w/f	Rel	51	115							
Joseph Giles	Cassie Cohen & h	Rel	51	118							
Byron S. Amiley & w/f	Byron S. Amiley	W.D.	50	116							
Ben F. Broyles & w/f	A. C. Gibson	W.D.	49	223							7.54 Lot D
Jay B. Amiley & w/f	Ben F. Broyles	W.D.	50	143							
William J. Kicht & w/f	Ben Stratgard	W.D.	50	148							
Joseph Giles	Cassie Cohen & h	Rel	51	260							7.31-118
Harry J. Lerner & w/f	Cassie Cohen & h	Release	51	262							7.31-108
Cassie Cohen & h	Joseph Berger & w/f	W.D.	50	167							D 7 th
Joseph Berger & w/f	Cassie Cohen & h	Mtg	51	419							Com 34-25
A. C. Gibson	Jay B. Amiley	W.D.	49	280							
Jay B. Amiley	William A. Johnson	W.D.	49	280							
Wm. Conner, Sec. of Loan Assn	Susan Horn	Rel	51	314							7.54 Lot D & 7
Franklin S. Palmer & w/f	Farmers Service Co	W.D.	49	301							
Susan Horn	Fred Foy	W.D.	50	240							
Farmers Service Co	Jease W. Jones	W.D.	49	330							7.54 Lot D & 7

Record of Grantor

Original of Copyboard

LOT NOS.

LOT NOS.

SEC 16 TWP 14 RING 13

SARPY COUNTY, NEBRASKA

28

TIMES-VARIATION-NOTABLE

DATE	GRANTOR	GRANTEE	KIND OF INSTRUMENT	RECORD		QUARTERS				ACRES	REMARKS
				BOOK	PAGE	N.E. QUARTER	N.W. QUARTER	S.W. QUARTER	S.E. QUARTER		
	Forest M. Oakes & wif	Carrie A. Hendrickson	W.D.	50	315					20	
	East Omaha School	Forest M. Oakes & wif	Gift	34	452						See H.
	Louisa Cobb	F. P. Daniell	Gift	34	474					5	
	Emma J. Spivey & Spivey	William J. Kicht & wif	Release	34	474					5	Nov 35-46
	Don Faustgarten & wif	Louisa Cobb	Mtg.	34	464					5	Aug 34-474
	Omaha Loan & Bldg. Assoc	Joseph Conyale	Mtg.	34	476					2 1/2	Nov 12-17-20
	Joseph Conyale & wif	Omaha Loan & Bldg. Assoc	Mtg.	34	475					2 1/2	Nov 11-20
	East Omaha School	Forest M. Oakes & wif	Rel.	34	453						See H.
	Dixson D. Spivey, et al	Dixson Bros. & Co.	Mtg.	2	444		2				Can 24-
	Emma J. Thompson	H. Schlekner	W.D.	149	435					10	
	Dixson Bros. & Company	Dixson D. Spivey & wif	Rel.	34	570						
	Don Faustgarten	Mike Dukmanovich & wif	Cont.	5	110						
	Forest M. Oakes & wif	Winnie K. Whitlacy	Mtg.	34	607						Page 11-476
	William A. Hartman, et al	William A. Hartman	W.D.	50	552						See next page
	William A. Hartman & wif	Charles W. Martin, et al	Mtg.	34	480						Can 38-511
	Walter G. McCoy	Frank J. Danick & wif	Rel.	34	669						Correct 12-17-20
	Frank J. Danick & wif	Anna Little	W.D.	50	563						B 2
	Melo F. Little & wif	Om. Loan & Bldg. Assoc	Mtg.	34	669						Can 12-262
	Henry D. Hoffmann	Clara J. Hoffmann	W.D.	50	565						
	W. C. Robinson	Wm. J. May Concern	Gift	5	297						Nov 11-17-20
	Joseph L. Small & wif	Nicholas Jasso, et al	Mtg.	2	509						Released 23-369
	Clara J. Hoffmann & wif	A. M. Larkins	W.D.	50	685						
	James A. Thompson & wif	Joseph Machacek	W.D.	52	127						Rel. 12-2
	Agnes Machacek & wif	Om. Loan & Bldg. Assoc	Mtg.	35	302						Can 35-382
	Joseph L. Small & wif	Anna Mayhew	W.D.	52	151					4	T.L. B 5
	Om. Loan & Bldg. Assoc	Agnes Machacek, et al	Rel.	35	302						
	F. P. Daniell	Don Faustgarten & wif	Rel.	35	406						
	Don Faustgarten & wif, et al	Emma J. Spivey & wif	Mtg.	35	467						Can 38-502
	George Schellert & wif	John H. Beckitt	Mtg.	2	545						Can 35-
	Nicholas Jasso & wif	Joseph L. Small & wif	Rel.	33	347						J. 509
	Joseph L. Small & wif	Nicholas Jasso & wif	Mtg.	35	486						Can 38-464
	John H. Beckitt	George Schellert & wif	Rel.	35	619						Rel. 12-2
	George Schellert & wif	James W. Jones	W.D.	52	291						Rel. 12-2
	Carrie A. Hendrickson	William Hendrickson	W.D.	51	326						See H.
	Omaha Loan & Bldg. Assoc	Franklin M. Larkins & wif	Rel.	37	6						Rel 38-484
	Fred E. Kern & wif	A. M. Larkins	Mtg.	2	572					5	Rel 38-223
	A. M. Larkins & wif	Fred E. Kern	W.D.	52	320						
	Franklin M. Larkins & wif	E. Schlegel, Jr	Mtg.	33	447					5	
	Louisa Cobb, et al	Joseph L. Small & wif	Rel.	37	25						
	Richard E. Larkins	Anna Johnson	W.D.	52	373						Rel. 12-2
	Omaha Loan & Bldg. Assoc	John Prager & wif	Rel.	37	128						Rel. 12-2
	Don Faustgarten & wif	Louisa Zimmerman	W.D.	52	416						Rel. 12-2
	Mike Dukmanovich & wif	Louisa Zimmerman	Rel.	51	492						" "
	Ed Campbell	Ed Campbell & wif	Cont.	6	5						Rel. 12-2
	Anna E. Jones & wif	Dora Ward	Mtg.	37	447						See next page (Error)
	Anna Mayhew	Henry Hencke & wif	W.D.	51	657						Rel. 12-2
	Henry Hencke & wif	Omaha Loan & Bldg. Assoc	Mtg.	33	578						Can 12-206

See next page

DATE	GRANTOR	GRANTEE	KIND OF INSTRUMENT	RECORD		N.E. QUARTER	N.W. QUARTER	S.W. QUARTER	S.E. QUARTER	ACRES	REMARKS
				BOOK	PAGE						
	Anna Coufal	Sella Criswell	WB	54	287						Order in Subd.
	Byron H. Smiley & wif.	Erosa R. Leigh	WB	54	274						N.W. 1/4 N.W. 1/4 E 1/2 Sec. 16
	Erosa R. Leigh & wif.	Byron H. Smiley, et al	WB	58	156						Order in Subd. N.W. 1/4 N.W. 1/4 E 1/2 Sec. 16
	James F. Aull & wif.	Five Stock Nat'l Bank	Mtg	41	461						N.W. 1/4 N.W. 1/4 E 1/2 Sec. 16
	Harriet L. Counselor & Leonard	Five Stock Nat'l Bank	Mtg	41	461						Can 42-251
	Mo. Omaha Savings Bank	Forest M. Lake & wif.	Rel	42	122						
	William Hendrickson	James J. Corcoran	Mtg	40	170						20 08 31-269
	Therocia Jaros	Joseph France & wif.	Rel	42	129						Can 42-354
	H. Shoo Lmb. & Wrecking Co.	Mrs. C. A. Ulio	Rel	C	316						of 40-43
	Anna Ulio	Shopen & Company, Trustee	Mtg	40	177						Can 42-324
	Shopen & Co. Trustee	Anna Ulio	Rel	42	147						Can 42-324
	Shopen & Co. Trustee	W. B. Smith	Rel	42	172						Can 42-324
	James F. Aull & wif.	Five Stock Nat'l Bank	Mtg	42	185						of 40-81
	H. Shoo Lmb. & Wrecking Co.	Mrs. C. A. Ulio	Rel	C	324						TLB-6 of 40-177
	Edgar D. Day, et al	Edward Winkler & William	WB	54	429						Rel 42-476
5/31/72	Clement A. Waldron & wif.	Emma B. Nielsen	WB	55	343						of C-316
	Temple McFayden Lbr. & Coal	Emma B. Nielsen	WB	55	344						10 PART
	Clerk of District Court	Whom it May Concern	WB	55	344						15 PART
	Clerk of District Court	Whom it May Concern	WB	55	344						of 40-43
	Omaha Loan & Bldg. Asdr.	Henry Venick & wif.	Rel	42	204						of 41-180
	Charles W. Martin, et al	William A. Lehner	Rel	42	206						" " of 41-196
	Five Stock Nat'l Bank	James F. Aull & wif.	Rel	42	251						of 33-578
	Omaha Loan & Bldg. Asdr.	Milo F. Fitto & wif.	Rel	42	262						of 41-661
	William Hendrickson	James J. Corcoran	Mtg	40	457						Tax lot 28
	H. A. Alderog, Sheriff	Clement A. Waldron	Rel	55	433						of 34-669
	James J. Corcoran	William Hendrickson	Rel	42	354						Can 42-355
	James J. Corcoran	William Hendrickson	Rel	42	355						of 40-170
	William Hendrickson	James J. Corcoran	Mtg	40	464						of 40-457
	Metropolitan Utilities District	Joseph & Frances Verga	WB	7	400						Can 42-567
	Metropolitan Utilities District	Stefania Wozniak	WB	7	448						PT of TL D
	Five Stock National Bank	James F. Aull & Lucile B. Aull	Rel	42	416						of 42-185
	On the Matter of Application	Lucile B. Aull, Guardian	Rel	55	585						
	Thomas A. Still & wif.	Five Stock Nat'l Bank	Mtg	42	477						Can 45-539

Please Turn Page

LOT NOS. *prop read*

LOT NOS.

LOT NOS.

LOT NOS.

SEC. 16 TWP. 14 RNG. 13

NE 1/4 NE 1/4
NW 1/4 NE 1/4
SW 1/4 NE 1/4
SE 1/4 NE 1/4

NE 1/4 NW 1/4
NW 1/4 NW 1/4
SW 1/4 NW 1/4
SE 1/4 NW 1/4

NE 1/4 SW 1/4
NW 1/4 SW 1/4
SW 1/4 SW 1/4
SE 1/4 SW 1/4

NE 1/4 SE 1/4
NW 1/4 SE 1/4
SW 1/4 SE 1/4
SE 1/4 SE 1/4

SARPY COUNTY
NEBRASKA

GRANTOR	GRANTEE	KIND OF INSTRUMENT	RECORD		N.E. QUARTER		N.W. QUARTER		S.W. QUARTER		S.E. QUARTER		ACRES	REMARKS	DATE
			BOOK	PAGE	N.E.	N.W.	S.W.	S.E.	N.E.	N.W.	S.W.	S.E.			
Andrew & Emma B. Nielsen	Harry Robinson	deed	55	608									15	533'0" x 2.10'0" T.L. 9-T.	
Emma B. Nielsen, Adm.	Harry Robinson	deed	55	609									15	533'0" T.L. 9-T.	
Emma B. Nielsen, Adm.	Harry Robinson	deed	55	609									15	T.L. 9-T.	
James Benak & wif.	E. H. Langer, Inc.	Mtg	43	533										533'0" T.L. 9-T.	
Fred Rover	Henry J. Staeger	Rel	42	562										Can 45-517	
John H. Staeger, et al	William H. C. Schuett	WB	55	678									4	of 39-38	
Joseph Slovick	To Whom it May Concern	Aff.	7	160										T.L. 142	
In Matter of Estate of Thos. J. Sheehan Jr.	Henry J. Staeger	deed	40	153									4	Tax Lots 142	
James G. Corcoran	William Hendrickson	Rel	48	567									4	Tax Lots 142	
William Hendrickson	James G. Corcoran	Mtg	40	572										of 40-464	
William H. C. Schuett	Martha M. Kaynor, et al	deed	3	179										Can 43-581	
William H. Schuett	Lena Schuett	Mtg	40	527									4	Tax Lot 142	
Harry Robinson	Charlie Stibilisco & wif.	WB	56	108										Rel 49-498	
Charlie Stibilisco & wif.	Harry Robinson	Mtg.	40	534										Tax Lot 142	
William Hendrickson	John T. Scanlan	WB	54	679									20	Tax Lot 142	
Harding Fuel & Oil Co.	Charlie Stibilisco	deed	C	415										of 40-534	
Harry Robinson	Union Pacific Assurance	Assoc	43	91										Can 46-370	
Henry Veneak & wif.	Anton Novotny	Mtg	40	584										of 40-534	
Harry Robinson	Union Pacific Assurance	Assoc	43	100										Tax Lot 67-2	
Harriett Council Kearney	Clara T. Clancy	WB	57	26									5	of 40-534	
Union Pacific Assurance Co	Service Life Ins. Co.	Assoc	43	218										Canon Margin	
James Spavat	Charles Kotek, et al	deed	C	441										of C-441	
James Spavat	Charles Kotek, et al	deed	C	441										wd's T.L.F.	
In Matter of Estate of E. R. Bell	Mary E. Martin, de'd.	deed	3	493										Tax Lot F.	
Fannie Slavik & hus	James M. Martin, de'd.	deed	3	493											
Clara T. Clancy	To Whom it May Concern	Aff.	3	498											
John Grayda	Sarpy County	JCD	56	387									.064		
	Sarpy County	JCD	56	389									.027		
	Sarpy County	JCD	56	388									.125		

Next Page
Please

DATE	GRANTOR	GRANTEE	KIND OF INSTRUMENT	RECORD		QUARTERS				ACRES	REMARKS
				BOOK	PAGE	N.E. QUARTER	N.W. QUARTER	S.W. QUARTER	S.E. QUARTER		
	J. Bragda	Sarpy County	2CD	56	389		X			.11	
	Mary M Martin	Sarpy County	2CD	56	404						
	William A. Lehman & wy.	Byron & Smiley et al	Spec	8	201		S				
	James D. Concoran	William Hendricksen	Rel	43	581						of 40-510
	John T. Scanlan	Clarence & Mabel Allyn	WD	56	567						Can 46-537
	Clarence H. Allyn & wy.	John T. Scanlan	mtg.	40	604						T.L. 68-58A
	Byron & Smiley & wy.	Nanna Bergstrand	WD	57	96						Can 43-662
	Nanna Bergstrand & Hs.	Byron & Smiley, et al	mtg.	40	626						
	Metropolitan Utilities Dist	Nanna Bergstrand	Agreement	8	658						
	Charlie Sibilisco	Antonia Sibilisco	WD	57	105						
	Byron & Smiley, et al	Nanna Bergstrand & Hs.	Rel	43	662						of 40-626
	Charlie Sibilisco	Antonia Sibilisco	WD	57	123						
	Harding Fuel & Sup. Co.	Charlie Sibilisco	Rel	C	415						of C-415
	Vaclav Bragda & wy.	John Bragda & wy.	WD	56	593						B 3 L
	Antonia Sibilisco & wy.	Stone Owners Loan Corp.	mtg.	45	93						Can 54-333
	William F. Patrick	Whom it May Concern	App.	9	24						Est 47-515
	Service Life Insurance Co.	Charlie Sibilisco & wy.	Rel	45	103						of 40-534
	Charat F. Adamo & Hs.	Joe Francl	WD	57	162						Tax Lot F
	Joseph Francl & wy.	Mary E. West	mtg.	39	233						Can 52-182
	Pete Slavits, Sr.	Marie Pavlik	WD	57	161						T.L. 03-248 & F
	Northern Natural Gas Co	Chase Natl Bank	mtg.	44	165						
	In Matter of Estate of	Fannie Slavits, Decd.	Decree	9	216						
	George M Hansen & wy.	Metta Hansen	2CD	58	106						1C Martins Sub
	Helen H. Kuehl & Hs.	Metta Hansen	2CD	58	105						1C Martins Sub
	E. H. Longee, Inc.	James Benek & wy.	Rel	45	517						of 42-533
	Marie Pavlik & Hs.	First Fed. Sav & Loan	mtg.	45	519						Can 54-392
	In Matter of Estate of	Sherman A. Hansen, Decd.	Decree	9	239						Rel 48-139
	Anna Coufal	Bella Criswell, et al	Partners	9	240						1C Martins Sub
	Thomas A. Hill & wy.	Com'l. Sav. & Loan Assn.	mtg.	45	535						T.L. A-2
	Thomas A. Hill & wy.	Com'l. Sav. & Loan Assn.	mtg.	9	244						Can 54-322
	Live Stock Natl Bank	Thomas A. & Laura M. Hill	Rel	45	539						of 42-477
	James Benek & wy.	Robert E. Hurley & wy.	WD	58	170						T.L. 03B - error
	James Benek & wy.	J. H. Kopietz	WD	57	222						T.L. 6-4 error
	J. H. Kopietz	James Benek & wy.	WD	58	171						" " error

Please Turn Page

33

proceed

NE 1/4 NE 1/4	NE 1/4 NW 1/4	NE 1/4 SW 1/4	NE 1/4 SE 1/4
NW 1/4 NE 1/4	NW 1/4 NW 1/4	NW 1/4 SW 1/4	NW 1/4 SE 1/4
SW 1/4 NE 1/4	SW 1/4 NW 1/4	SW 1/4 SW 1/4	SW 1/4 SE 1/4
SE 1/4 NE 1/4	SE 1/4 NW 1/4	SE 1/4 SW 1/4	SE 1/4 SE 1/4

SEC. 16 TWP. 14 RNG. 13

SARPY COUNTY NEBRASKA

GRANTOR	GRANTEE	KIND OF INSTRUMENT	RECORD		N.E. QUARTER		N.W. QUARTER		S.W. QUARTER		S.E. QUARTER		ACRES	REMARKS	DATE
			BOOK	PAGE	N.	E.	N.	W.	S.	W.	S.	E.			
Anna Ulio & ho.	Oscar Wedner & wf	WD	58	204											
W. B. Smith	Anna Ulio	Rel	45	710											
Carl A. Bergstrand	W. F. Bawinger	Mtg	46	177											
James Riha	Mary Riha	WD	57	310											
Carl A. Bergstrand & wf	W. F. Bawinger	Mtg.	46	220											
Herbert W. Bawins & wf	Richard E. Bawins, et al	JCD	58	447											
Henry Vereck & wf.	Anton & Mary Novotny	Mtg	46	369											
Anton Novotny	Henry Vereck & wf.	Rel	46	370											
On Matter of Estate of	Charles W. Martin, Decd	W.D. & M.D.	9	571											
J. J. Walling	William H. C. Schuett	Rel	46	505											
Mrs. Anna G. Ferguson	Clarence H. Allyn, et al	Rel	46	537											
Herbert R. Martin	Nelle M. Martin	WD	57	392											
Clarence H. Allyn & wf.	Omaha Loan & Bldg. Assn.	Mtg	46	645											
Clarence H. Allyn & wf.	Omaha Loan Bldg. Assn.	Mtg	46	671											
Anna Fille	First Fed. Savings & Loan	Mtg	46	671											
Metropolitan Utilities Dist	Oscar Wedner, et al	Agreement	10	74											
Annie Silson	Anton G. Krbek & wf.	WD	59	122											
Antonia Krbek & ho.	Stephen Petersen	Mtg	47	201											
J. J. Walling	William H. C. Schuett	Rel	46	548											
William H. C. Schuett	Lucile Severese	Mtg	39	260											
Clarence H. Allyn & wf.	The Byron Reed Co	WD	57	530											
Bessie Ingersoll et al	Chris & Emily Petersen	WD	59	220											
Antonia Kibilisco & ho	Home Owners Loan Corp.	Agreement	47	515											
Chris & Emily A. Petersen	Metropolitan Util. Dist	Agreement	10	232											
Mary Riha & ho.	Omaha Loan & Bldg. Assn.	Mtg	47	555											
Mary Riha & ho.	Omaha Loan & Bldg. Assn.	Mtg	47	555											
Chris Petersen & wf.	Douglas County Bank	Mtg.	47	607											
Antonia Kibilisco & ho	William A. Corley & wf	WD	59	311											

Next Page Please

DATE	GRANTOR	GRANTEE	KIND OF INSTRUMENT	RECORD		N.E. QUARTER				N.W. QUARTER				S.W. QUARTER				S.E. QUARTER				ACRES	REMARKS
				BOOK	PAGE	N.E.	N.W.	S.E.	S.W.	N.E.	N.W.	S.E.	S.W.	N.E.	N.W.	S.E.	S.W.	N.E.	N.W.	S.E.	S.W.		
	Adolph H. Voss	Kapt. Zimmerman et al	W.D.	18	443																		
	Marie Poulak et al	Francis Kohlbak	W.D.	59	463																See also 220		
	Charles Harlik et al	Francis Kohlbak	W.D.	59	484																220 1/2 1/2 1/2 1/2		
	William Harlik et al	Francis Kohlbak	W.D.	59	485																" "		
	Peter Harlik & wf	Francis Kohlbak	W.D.	59	486																" "		
	Marie Poulak & wf	Francis Kohlbak	W.D.	59	487																" "		
	Marie Poulak & wf	First Federal Sav. & Loan Assn	Mtg	48	139																Rel 18-392		
	Allen Zimmerman et al	Adolph H. Voss	W.D.	57	608																		
	George Dorch	Mrs. Rebecca Zimmerman	Mtg	39	70																of 39-70		
	John Potter Webster & wf	Anton Yablonski et al	W.D.	59	607																		
	Anton Yablonski & wf	John Potter Webster	Mtg	48	227																Can 56-169		
	First Federal Savings & Loan Assn	Marie Poulak & wf	Rel	48	392																45-579		
	Anton Novotny et al	Henry Venesek & wf	Rel	48	415																of 46-369		
	Lena Schmitt	William H. Schmitt	Rel	48	498																of 40-527		
	County of Sarpy vs Douglas Co. Bank of Omaha	August Zimmermann et al	W.D.	11	269																		
	Mary M. Martin	Christ Peterson et al	Rel	50	10																of 47-607		
	Harry Mundell, Sheriff	Charles Kolek et al	W.D.	62	52																T.L. 0°		
	W. F. Bawinger	Sarpy County	Rel	62	333																Box Lot E		
	W. F. Bawinger	C. A. Bergstrand et al	Rel	50	259																of 46-177		
	George W. Woodland & wf	Carl R. Bergstrand et al	Rel	50	260																of 46-290		
	Kanna Bergstrand & wf	Kanna Bergstrand	Mtg	50	260																212-77-275, 276, 277		
	James Kevak	George W. Woodland	W.D.	62	425																72 D 5 A - 08		
	Adolph H. Voss & wf	Lillian Benank	W.D.	62	424																		
	Lelia M. Corby & wf	Lelia M. Corby et al	W.D.	62	271																		
	Byron Reed Company	S. C. Nelson	Mtg	50	650																Rel 52-495		
	Mary M. Martin	Thomas H. Lindley	W.D.	61	258																		
	Com'l Sav & Loan Assn	Clara S. Clancy	W.D.	61	264																TL Daa, G, C		
	Mary C. West	Thomas S. Hill & wf	Rel	52	123																of 45-535		
	Lucile Demerece	Joseph French & wf	Rel	52	182																of 39-233		
	County of Sarpy vs William H.C. Schmitt	William H.C. Schmitt	Rel	52	189																of 39-260		
	Marie Bragda	Lucile Demerece	Mtg	39	280																		
	Dr. C. Beadler, Oct. Co.	Harry H. Bennett et al	Mtg	12	333																Foot Lot D 2 B		
	In Matter of Estate of S. C. Nelson	John Bragda, Jr. & wf	W.D.	61	593																		
	Omaha Loan & Bldg Assn of Omaha	W. Hon St. Mary Concern	Mtg	12	579																		
	First Federal Savings & Loan Assn	James Bragda, Dec'd	Mtg	12	628																		
	Mary Rika	Lelia M. Corby & wf	Rel	52	495																of 50-650		
	Anna Fille	Mary Rika & wf	Rel	52	501																of 47-555		
	Frank C. Blankman & wf	Anna Fille	Rel	52	600																of 46-671		
	In Matter of Estate of Frank C. Blankman & wf	Louis P. Rika & wf	W.D.	65	208																TL 2 B		
		Frank C. Blankman & wf	W.D.	65	241																TL B 2		
		Anna Fille	Mtg	53	95																Rel 63-385		
		Marie Bragda, Dec'd	Mtg	13	39																TL B 301		

35

Handwritten note

LOT NOS. _____ LOT NOS. _____ LOT NOS. _____ LOT NOS. _____ SEC. 16 TWP. 14 RANG. 13
 NE1/4NE1/4 _____ NW1/4NE1/4 _____ SW1/4NE1/4 _____ SE1/4NE1/4 _____
 NE1/4NW1/4 _____ NW1/4NW1/4 _____ SW1/4NW1/4 _____ SE1/4NW1/4 _____
 NE1/4SE1/4 _____ NW1/4SE1/4 _____ SW1/4SE1/4 _____ SE1/4SE1/4 _____
 SARY COUNTY
 NEBRASKA

GRANTOR	GRANTEE	KIND OF INSTRUMENT	RECORD		N.E. QUARTER				N.W. QUARTER				S.W. QUARTER				S.E. QUARTER				ACRES	REMARKS	DATE
			BOOK	PAGE	N.E.	N.W.	S.E.	S.W.	N.E.	N.W.	S.E.	S.W.	N.E.	N.W.	S.E.	S.W.	N.E.	N.W.	S.E.	S.W.			
Clara S. Conroy	John Starginaki et al	W.D.	65	430																			
John Bragda et wf	Minnie Pavlik	W.D.	64	303																			
Marg Bragda	W Thom St May Concern	off	15	107																			
Stanley Slovick et wf	Thomas H. Lindell et wf	mtg	53	114																			
J. E. Kopsity	W Thom St May Concern	off	13	122																			
Bella Orswell	William K. Lotting et al	W.D.	65	519																			
William K. Lotting et wf	Omaha Loan & Bldg. Assn	mtg	54	375																			
William K. Lotting et wf	Omaha Loan & Bldg. Assn	Receipt	13	128																			
Emma Bragda et al	James Mayer et wf	W.D.	64	219																			
Marie Pavlik et al	James Mayer et wf	W.D.	69	220																			
Conrad Saviniga et son	Thomas S. Hill et wf	Rel	54	322																			
Thomas S. Hill et wf	Clyde C. Copper et wf	W.D.	64	230																			
Clyde C. Copper et wf	Conrad Saviniga et son	mtg	54	322																			
Homa Owens et son	Antonio Schillico et wf	Rel	54	323																			
Clyde C. Copper et wf	Thomas S. Hill et wf	mtg	54	337																			
John Hostak	Robert C. Hunley et wf	W.D.	65	633																			
Joseph Varga et wf	John J. Varga et wf	W.D.	65	681																			
William E. Corby et wf	Aldrich Nisan et wf	W.D.	66	71																			
In Matter of Estate	Peter Havelk, Dec'd	dec	13	266																			
In Matter of Estate	John Bragda, Dec'd	Receipt	13	292																			
Marg Bragda	Frederick O. Beck	W.D.	65	138																			
Frederick O. Beck	Marg Bragda et al	W.D.	66	169																			
In Matter of Estate	Heber M. Martin, Dec'd	Receipt	13	359																			
John Peter Webster	Anton Jablonaki et wf	Rel	56	169																			
Anton Jablonaki	Paul Johnson et wf	W.D.	66	369																			
Joseph Slovick et wf	State of Nebraska	W.D.	64	554																			
Jessie M. Birnie et wf	State of Nebraska	W.D.	64	554																			
George Schellen et wf	State of Nebraska	W.D.	64	556																			
Aldrich Nisan et wf	Minnie Nisan	W.D.	66	388																			
In Matter of Estate	Beadie Ingersoll, Dec'd	Receipt	13	512																			
In Matter of Estate	Herbert V. Ingersoll, Dec'd	Receipt	13	513																			
Victor H. Schmidt, Ref	Louis Rikas et wf	Receipt	64	587																			
Louis P. Rikas et wf	Omaha Loan & Bldg. Assn	mtg	56	262																			
James Mayer et wf	James Mayer et wf	W.D.	66	569																			
Certificate of Death	Anna Marie Mayer, Dec'd	Receipt	13	534																			
Victor H. Schmidt, Refere	Carl Svendsen et al	Receipt	64	614																			
Aldrich Nisan et wf	State of Nebraska	W.D.	64	641																			
Robert C. Hunley et wf	Lloyd C. Elder et wf	W.D.	64	668																			
In Matter of Estate	William A. Lehman, Dec'd	Receipt	13	581																			
Emma C. Lehman	Theodore J. Lehman	W.D.	66	419																			
Theodore J. Lehman et wf	First State National Bank	mtg	56	399																			
Edel Schnell et wf	The State of Nebraska	W.D.	67	32																			

Handwritten note: *Hand*

DATE	GRANTOR	GRANTEE	KIND OF INSTRUMENT	RECORD		N.E. QUARTER				N.W. QUARTER				S.W. QUARTER				S.E. QUARTER				ACRES	REMARKS
				BOOK	PAGE	N.E.	N.W.	S.W.	S.E.	N.E.	N.W.	S.W.	S.E.	N.E.	N.W.	S.W.	S.E.	N.E.	N.W.	S.W.	S.E.		
	Theodore J. Lehman - of	Lloyd H. Lehman	Rel	58	21																Can 61-16		
	William K. Lottling et al	Metropolitan Utilities District	W.D.	19	26																T 2 B-9		
	Oscar Weckner - of	Helena M. Rhode - of	W.D.	66	489																T 2 B-6		
	Joseph Franal - of	State of Nebraska	W.D.	67	224																W.P. of T 2 D 3		
	Stephen Patara	Antonina Habel - of	Rel	59	507																of 49-201		
	Theodore J. Lehman - of	W. Albert Rice et al	W.D.	68	283																T 2 D 6 + D 10		
	Lloyd H. Lehman	Theodore J. Lehman - of	Rel	61	56																of 58-21		
	Lincoln Stock Nat'l Bank	Spaulding J. Lehman - of	Rel	61	57																of 56-899		
	J. Ward Rice et al	Lincoln Stock Nat'l Bank	W.D.	61	92																Rel 70-183		
	Thomas S. Hill - of	Clyde C. Copper - of	Rel	61	462																T 2 D 6 + D 18		
	Com'l Savings & Loan Ass'n	Clyde C. Copper - of	Rel	61	463																of 54-327		
	Clyde C. Copper - of	Ellen R. Morton - of	W.D.	69	12																of 54-322		
	Ellen R. Morton - of	Com'l Savings & Loan Ass'n	W.D.	61	463																R 2		
	Thomas H. Lindley - of	Stanley Shovich - of	W.D.	69	34																Rel 71-111		
	Ellen R. Morton - of	Thomas S. Hill - of	W.D.	61	500																Rel 71-120		
	In Matter of Estate	Herbert R. Martin, Dec'd	W.D.	14	381																T 2 D 10 + D 11		
	J. Ward Rice et al	Morris P. Day	W.D.	67	611																and 75-24		
	Eugene R. Ingorsall - of	Morris P. Day et al	W.D.	68	696																T 2 D 18, T 2 D 6		
	Cedeh Schnell	Edward Warren - of	W.D.	67	665																T 2 D 7 A + D 10		
	Edward Warren - of	Cedeh Schnell	W.D.	63	17																Rel 63-134		
	Oscar Weckner - of	Allen M. Rhode - of	W.D.	65	723																		
	Maria Cook - of	Garry E. Jansen	W.D.	69	254																		
	Garry E. Jansen	Commercial Savings & Loan Ass'n	W.D.	63	58																Rel 124-11		
	Cedeh Schnell	Edward Warren - of	W.D.	63	134																of 63-17		
	Wm. K. Lottling - of	Omaha Sav. & Bldg. Ass'n	W.D.	63	318																Rel 88-288		
	Omaha Sav. & Bldg. Ass'n	Wm. K. Lottling - of	W.D.	63	317																and 13-123		
	Marion H. Mansfield - of	J. Ward Rice	W.D.	70	160																of 54-275		
	Cedeh Schnell	State of Nebraska	W.D.	70	167																'5 Stat		
	Anna Little	Frank C. Blankman	Rel	63	335																Part of T 2 I		
	J. Ward Rice et al	Blodgett - Krajicek	W.D.	70	202																T 2 B 2		
	Jack T. Blodgett et al	Metropolitan Utilities District	W.D.	15	61																of 53-85		
	Blodgett - Krajicek	Commercial Savings & Loan Ass'n	W.D.	63	502																T 2 D 7 A		
	J. Ward Rice et al	Blodgett - Krajicek	W.D.	70	239																T 2 D 7 A - Rel 74-109		
	Joe Franal - of	State of Nebraska	W.D.	70	243																Remainder of 70-202		
	Blodgett - Krajicek	Blodgett - Krajicek Bldg. Co.	W.D.	70	256																.61		
	Albush Mason - of	Minnie Straydon	W.D.	69	735																annote 66-380		
	J. Ward Rice - of	Morris P. Day et al	W.D.	70	325																T 2 D 18 + D 6		
	Macklin Home Imp. Co.	Joe & Mary Slank	W.D.	71	190																Rel D-205		
	Certificate of Death of	Emma Mayer	W.D.	15	238																T 2 B 3 A 1		
	James Mayer	Whom It May Concern	W.D.	71	228																T 2 B 3 A 1		
	James Mayer - of	James Mayer - of	W.D.	71	112																T 2 B 3 A 1		
	Macklin Home Imp. Co.	Joe & Mary Slank	Rel	71	205																of D-190		

37

John Road

LOT NOS. LOT NOS. LOT NOS. LOT NOS. SEC. 16 TWP. 14 RANG. 13

NE 1/4 NW 1/4 NE 1/4 NW 1/4 NE 1/4 SW 1/4 NE 1/4 SE 1/4

NW 1/4 NE 1/4 NW 1/4 NW 1/4 NW 1/4 SW 1/4 NW 1/4 SE 1/4

SW 1/4 NE 1/4 SW 1/4 NW 1/4 SW 1/4 SW 1/4 SW 1/4 SE 1/4

SE 1/4 NE 1/4 SE 1/4 NW 1/4 SE 1/4 SW 1/4 SE 1/4 SE 1/4

SARPY COUNTY
NEBRASKA

GRANTOR	GRANTEE	KIND OF INSTRUMENT	RECORD		N.E. QUARTER				N.W. QUARTER				S.W. QUARTER				S.E. QUARTER				ACRES	REMARKS	DATE
			BOOK	PAGE	N.E.	N.W.	S.E.	S.W.	N.E.	N.W.	S.E.	S.W.	N.E.	N.W.	S.E.	S.W.	N.E.	N.W.	S.E.	S.W.			
Joseph Blank & w/f	William H C. Schmitt	W.D.	71	210																	T.L.K		
Frank C. Blankman, et al.	To the Public	Flat	70	376																	P.L. 1342		
James P. Rika, et al.	Metropolitan Utilities Dist	Con. Agn.	15	362																	T.L. D 111		
Edora H. Seidel & w/f	Commercial Savg & Loan Assn	W.D.	66	187																	Rel 80-175 (CPN)		
Minnie Stragdas & w/f	Charles Miskau & w/f	W.D.	76	339																	Notarized 5-11-56		
Mary Rika (Widow)	Frank J. Wischita & w/f	W.D.	73	7																	T.L.R.		
Frank J. Wischita & w/f	Omaha Loan & Bldg. Assoc	W.D.	68	15																	T.L.BSA		
Blodgett & Krajacic Bldg. Conts	John F. Daly	W.D.	68	59																	Rel 78-518		
Omaha Loan & Bldg. Assoc.	James Rika & w/f	W.D.	68	176																	T.L. D 111 of 50-202		
Joseph Blank & w/f	William C. Schmitt	W.D.	73	165																	P.L. T.L.K		
James Rika & w/f	Charles A. Krajacic & w/f	W.D.	68	377																	Rel 78-254		
Stanley Blank & w/f	State of Nebraska	W.D.	73	318																			
L.R. Morton	To Whom It May Concern	W.D.	73	131																	Unnotar		
in Matter of Estate of	Joseph Mischak	W.D.	77	107																	4-8-54 (NPN)		
(Ignace Mischak, Widow)	William Bartak & w/f	W.D.	77	108																	T.L.B7		
Mary Skrzynski	Bernada Ann Skrzynski	W.D.	74	50																	T.L.G2		
James Mayer & w/f	John C. Bowen & w/f	W.D.	74	73																	T.L.B3A1		
John C. Bowen & w/f	Com'l Savng & Loan Assoc	W.D.	69	344																	Rel 143-699		
John C. Bowen & w/f	James Mayer & w/f	W.D.	70	1																	T.L.B3A1, 72		
Live Stock Mart, Bank, Omaha	J. Ward Rice et al	W.D.	70	183																	5-1-54 017		
James Mayer & w/f	Harman J. Long & w/f	W.D.	74	36																	T.L.B3A1		
Com'l Savng. Loan Assoc	Ellen R. Morton & w/f	W.D.	71	119																	61-463		
Thomas J. Hill & w/f	Ellen R. Morton & w/f	W.D.	71	120																	61-500		
L.R. Morton & w/f	Com'l Savng. Loan Assoc	W.D.	71	121																			
Mary Skrzynski (Widow)	John Petersen et al	W.D.	75	102																			
John Petersen et al	John Petersen & w/f	W.D.	75	103																			
John Petersen & w/f	Metropolitan Util. Dist.	W.D.	75	105																			
Anton J. Habel & w/f	Herbert Rubin & w/f	W.D.	75	5																			
Herbert Rubin & w/f	Commercial Savng & Loan Assoc	W.D.	75	295																			
Arthur M. Deack & w/f	Metropolitan Utilities Dist	W.D.	72	54																	Rel 114-153		
Omaha Loan & Bldg. Assoc	Frank J. Wischita & w/f	W.D.	72	396																	Rel 114-153		
Frank J. Wischita & w/f	Omaha Loan & Bldg. Assoc	W.D.	72	397																	Rel 114-153		
Bernada A. Skrzynski et al	George L. Skrzynski	W.D.	76	51																	T.L.G2		
Metropolitan Utilities Dist	To Whom It May Concern	W.D.	76	179																	0 78-079		
Metropolitan Utilities Dist	George L. Skrzynski & w/f	W.D.	76	209																	0 57-06-08		
John F. Daly	Blodgett & Krajacic	W.D.	73	235																	P.L. T.L.G2		
Metropolitan Utilities Dist	Herbert Rubin & w/f	W.D.	73	277																	of 68-39		
Blodgett & Krajacic	First Federal Savings & Loan Assn	W.D.	73	420																	Rel 84-307		
Blodgett & Krajacic	First Federal Savings & Loan Assn	W.D.	73	423																	T.L. B7A-D10		
John F. Daly	Blodgett & Krajacic	W.D.	73	513																	Rel 84-307		
Commercial Savng & Loan	Blodgett & Krajacic	W.D.	74	104																	Rel 84-307		

proof read

DATE	GRANTOR	GRANTEE	KIND OF INSTRUMENT	RECORD		N.E. QUARTER		N.W. QUARTER		S.W. QUARTER		S.E. QUARTER		ACRES	REMARKS
				BOOK	PAGE	N.	E.	N.	W.	S.	W.	S.	E.		
	Bertha E. Martin	Miriam H. Weiss	W.D.	77	171										
	George L. Skirwin et al	John Peterson et al	W.D.	77	167										
	Helen M. Rhode + wif	Miriam C. Cunningham + wif	W.D.	77	265										
	Ellen R. Weston + wif	Conrad Loveing + Loan Assoc	W.D.	75	92										
	Metropolitan Util. Dist.	Whom St May Concern	Notice	19	111										
	George W. Goodland + wif	Stock Yards Nat'l Bank of Omaha	W.D.	75	333										
	Allian Bank	Whom St May Concern	W.D.	3	37										
	John Peterson + wif	Bankers Nat'l Bank Omaha	W.D.	76	409										
	Bankers Nat'l Bank	John Peterson + wif	Rel	77	62										
	John Peterson + wif	Bankers National Bank	W.D.	77	63										
	Charles L. Krajacic + wif	Louis Rika + wif	Rel	78	254										
	Metropolitan Utilites Dist.	Whom St May Concern	Notice	70	60										
	Metropolitan Utilites Dist.	Whom St May Concern	Notice	70	60										
	Metropolitan Utilites Dist.	Whom St May Concern	Notice	70	81										
	Aldrich Nixon + wif	Warren P. Cox + wif	W.D.	79	319										
	Louis Rika + wif	Morris P. Soy et al	W.D.	79	445										
	Minnie Stroud + wif	Aldrich Nixon + wif	W.D.	79	445										
	Aldrich Nixon + wif	Carl R. Schwartzlander + wif	W.D.	139	139										
	Aldrich Nixon + wif	Abe M. Kaylowaky	W.D.	79	186										
	Louis Rika + wif	Morris P. Soy et al	W.D.	79	445										
	Anna Ulip	Charles Ulip + wif	W.D.	80	84										
	Anna Ulip	Emma Yast + wif	W.D.	80	82										
	Arthur M. Debeck + wif	Commercial Saving + Loan Assoc	W.D.	19	300										
	Anna Ulip	Charles Ulip + wif	W.D.	80	84										
	Anna Ulip	Emma Yast + wif	W.D.	80	82										
	Commercial Sav. Loan Assoc.	Eldre H. Seibel + wif	Rel	80	175										
	Richard C. Binns, et al	Richard L. Binns + wif	W.D.	50	373										
	Micklin Home Imp. Co vs	Frank M. Stuelman + wif	W.D.	440	440										
	J. Ward Rice, et al	Omaha National Bank	W.D.	82	370										
	Metropolitan Utilites Dist.	Herbert Rubin + wif	Rel	21	125										
	J. Ward Rice, et al	Omaha National Bank	W.D.	83	50										
	Blodgett + Krajacic et al	Stanley Sabedy	W.D.	83	97										
	First Federal Saving + Loan	Blodgett + Krajacic	Rel	84	307										
	Stanley J. Sabedy + wif	Russell Arthur Runyan + wif	W.D.	83	168										
	Metropolitan Utilites Dist.	Whom St May Concern	Notice	21	357										
	Frances Varga	Standard Oil Co.	W.D.	83	471										
	Anton J. Hbek + wif	John J. Hbek + wif	W.D.	85	148										
	M. U. D.	Whom St May Concern	Notice	22	349										
	Antonina Hbek	Whom St May Concern	Off	22	431										
	John J. Hbek + wif	Katolicky Delnick	W.D.	88	125										
	Omaha Loan + Bldg. Assoc	William K. Lobbing + wif	Rel	88	288										
	M. U. D.	Whom St May Concern	Notice	23	93										

6.77
 Ad. L.
 T.L. 82-395
 T.L. 85-7-7-8-8
 T.L. 82, 89, 5 (810)
 T.L. 6-3 RE 77-62
 of 76-409
 T.L. 112-302
 of 68-347
 T.L. 85, 8, 8-8-84
 T.L. 61-64
 T.L. 63
 T.L. 2 - T.L. T
 12 of T.L. DIRI
 T.L. R.
 T.L. 2 + J + 204 + 208
 T.L. 2 + J
 12 of T.L. DIRI
 No. 15 of T.L. 86
 No. 90 of T.L. 86
 T.L. 136 102
 14 T.L. 63
 of 66-134
 T.L. J
 assigned - 426 RE
 of 202
 T.L. DIRI RE 97-20
 T.L. 016, T.L. 016
 of 188 of 81-202 of DIRI
 T.L. 06 RE 97-20
 T.L. 016, T.L. 016
 T.L. DIRI - 010
 of 93-420
 T.L. DIRI, T.L. 010
 T.L. DIRI - T.L. 010
 of 85-135 of 81-202 of DIRI
 of 85-135 of 81-202 of DIRI
 of 85-135 of 81-202 of DIRI
 T.L. 0761
 T.L. T.L. 044
 T.L. T.L. 89
 RE 189-2214
 T.L. T.L. 040
 of 63-318
 T.L. 63

Blond Wood

LOT NOS. _____ NE 1/4 NW 1/4 _____ NW 1/4 NW 1/4 _____ SW 1/4 NW 1/4 _____ SE 1/4 NW 1/4 _____
 LOT NOS. _____ NE 1/4 SW 1/4 _____ NW 1/4 SW 1/4 _____ SW 1/4 SW 1/4 _____ SE 1/4 SW 1/4 _____
 LOT NOS. _____ NE 1/4 SE 1/4 _____ NW 1/4 SE 1/4 _____ SW 1/4 SE 1/4 _____ SE 1/4 SE 1/4 _____
 SEC. 16 TWP. 14 RNG. 13
 SARRY COUNTY
 NEBRASKA

GRANTOR	GRANTEE	KIND OF INSTRUMENT	RECORD		N.E. QUARTER				N.W. QUARTER				S.W. QUARTER				S.E. QUARTER				ACRES	REMARKS	DATE
			BOOK	PAGE	N.	E.	S.	E.	N.	E.	S.	E.	N.	E.	S.	E.	N.	E.	S.	E.			
M. U. D.	Whom St May Concern	Notice	23	96																6.77	T.L. 049		
Ellen R. Morton & wf	Northwestern Metal Co.	Mtg	90	380																Rel 115-463			
Ellen R. Morton & wf	Comm'l Saving & Loan Assoc.	Mtg	90	309																26 122-520			
Comm'l Saving & Loan Assoc	Ellen R. Morton & wf	Rel	90	7																28 71-121-25-92			
Northwestern Metal Co.	Comm'l Savings & Loan Assoc	Agreement	23	327																			
Joseph Franck & wf	Bellevue Const Co.	W.D.	88	122																T.L. 5-03, 1704			
Marvin C. Cunningham & wf	Donald D. White & wf	W.D.	88	282																E. 100' T.L. 86			
Carl A. Bergstrand	George W. Woodland & wf	Rel	91	446																T.L. D 54			
Bellevue Construction Co.	Whom St May Concern	Part	3	90																Chandler Heights			
M. U. D.	Whom St May Concern	Notice	23	135																N. 54' T.L. 2			
M. U. D.	Whom St May Concern	Notice	23	136																1.132' of N. 645' 2'			
Omaha Bldg & Loan Assoc.	Frank J. Wischita & wf	Rel	92	296																4 72-397			
Frank J. Wischita & wf	Omaha Bldg & Loan Assoc.	Mtg	92	293																Rel 154-051			
Oscar E. Wodner & wf	Carl O. Wodner & wf	W.D.	89	44																27 T.L. 834			
Sarry County	Bellevue Const Co.	2C D	89	123																			
George W. Woodland & wf	Stock Yds Nat'l. Bk.	Mtg	92	396																T.L.E			
Stock Yds Nat'l. Bank	George W. Woodland & wf	Rel	92	295																26 Rel 96-455			
Herman J. Long & wf	Clair N. Ripley & wf	W.D.	89	249																T.L. D 54-08 Rel 97-458			
Cross J. Orr	Benton R. Ellison & wf	W.D.	91	92																4 75-333			
Stock Yds Nat'l Bank	George W. Woodland & wf	W.D.	91	143																T.L. 8341			
George W. Woodland & wf	Metropolitan Util Dist.	W.D.	91	143																IF			
Morris P. Day & et al	Bellevue Construction Co.	W.D.	91	185																Part T.L. 54 of 92-396			
Omaha National Bank	J. Ward Rice & et al	Rel	97	20																T.L. D 191, D 18+06			
Ragnhild Bergstrand & wf	George W. Woodland & wf	Rel	97	277																26 72-350			
Sydney X. Bergstrand	George W. Woodland & wf	Rel	97	276																4 73-50			
Carl G. Bergstrand	George W. Woodland & wf	Rel	97	276																4 50-260			
Clair Bergstrand & wf	George W. Woodland & wf	Rel	97	275																4 50-260			
D. M. Murphy Jr.	Whom St May Concern	Off	97	278																4 50-260			
Frances Varga	Joseph Varga & wf	W.D.	91	400																T.L. 54 + T.L. D 8			
George W. Woodland & wf	Bertie H. Roberts & wf	W.D.	91	439																4 T.L. D 7 B			
Bertie H. Roberts & wf	First Federal Sav. & Loan Assn	Mtg	97	392																Part of T.L. D 8 + D 54			
Bertie H. Roberts & wf	First Federal Sav. & Loan Assn	Mtg	97	394																Rel 144-97			
Stock Yds. Nat'l Bank of Mo	George W. Woodland & wf	Rel	97	458																Part of T.L. D 8 - D 54			
Anton F. Frank & wf	Benton R. Ellison & wf	2C B	92	35																Rel 144-97			
Clara Paul Frank & wf	Benton R. Ellison & wf	2C B	92	33																Rel 144-97			
Edward F. Mahacek, et al	Port Carly & wf	2C D	92	133																Part of T.L. D 8 - D 54			
Edward F. Mahacek, et al	Port Carly & wf	2C D	92	489																Part of T.L. D 8 - D 54			
Aldrich Mixan & wf	Carl Schwartzlander & wf	W.D.	92	455																4 92-396			
Carl Schwartzlander & wf	Carl Permentier & wf	W.D.	92	457																T.L. 87			
Louise G. McFarling, et al	Industrial Loan & Somethe	Mtg	99	108																T.L. 87			
Mary Skozinski	Louise G. McFarling et al	W.D.	92	498																Part of T.L. R			

DATE	GRANTOR	GRANTEE	KIND OF INSTRUMENT	RECORD		QUARTERS				ACRES	REMARKS
				BOOK	PAGE	N.E. QUARTER	N.W. QUARTER	S.W. QUARTER	S.E. QUARTER		
	George W. Woodland & w/f	Metropolitan Utilities Dist.	W.D.	93	111		2				21' of T1-D5-D
	Joseph Branch & w/f	Belleme Construction Co.	W.D.	93	264		3			1.00 ac	21' of T1-D5-D
	Joseph Varga & w/f	Commercial Building & Construction	W.D.	101	451		2				21' of T1-D5-D
	James G. W. Farling et al	Whom it May Concern	W.D.	103	273		2				21' of T1-D5-D
	Alcar Wedner & w/f	Carl C. Wedner & w/f	W.D.	94	278		2				21' of T1-D5-D
	Carl Parson (in) & w/f	Lincoln City School Dist. No. 1	W.D.	103	484		3				21' of T1-D5-D
	Adriech T. Wilson & w/f	Vernon L. Lund & w/f	W.D.	95	281		3				21' of T1-D5-D
	Industrial Bonds Investment Co.	Louis A. W. Farling et al	W.D.	104	359		2				21' of T1-D5-D
	George Scheller & w/f	Lloyd J. Barnhart & w/f	W.D.	95	449		3				21' of T1-D5-D
	Lloyd J. Barnhart & w/f	Commercial Building & Construction	W.D.	105	31		3				21' of T1-D5-D
	Industrial Bonds Investment Co.	Louis A. W. Farling, et al	W.D.	115	351		2				21' of T1-D5-D
	Belleme Construction Co.	Wallace W. Diller	P.C.D.	96	285		2				21' of T1-D5-D
	Belleme Construction Co.	Howard B. Westering	P.C.D.	96	283		2				21' of T1-D5-D
	Belleme Construction Co.	Anna S. Schwartz	P.C.D.	96	284		2				21' of T1-D5-D
	Belleme Construction Co.	Howard M. Diller	P.C.D.	96	343		2				21' of T1-D5-D
	Belleme Construction Co.	C. B. Farber	P.C.D.	96	241		2				21' of T1-D5-D
	Robert A. Masters & w/f	Louis A. W. Farling & w/f	W.D.	96	319		2				21' of T1-D5-D
	Belleme Construction Co.	Whom it May Concern	W.D.	95	490		2				21' of T1-D5-D
	Belleme Construction Co.	Whom it May Concern	W.D.	93	282		2				21' of T1-D5-D
	Carl C. Wedner & w/f	Frank H. Goch Jr & w/f	W.D.	96	438		2				21' of T1-D5-D
	Belleme Construction Co.	Whom it May Concern	W.D.	96	28		2				21' of T1-D5-D
	Arthur J. Darnstrom, Const.	Charles Anderson Construction	W.D.	97	360		2				21' of T1-D5-D
	C. E. Hannum	Belleme Construction Co.	W.D.	97	371		2				21' of T1-D5-D
	Belleme Construction Co.	Buildings Investment Co.	P.C.D.	97	538		2				21' of T1-D5-D
	Edward E. Ripley & w/f	Henry J. Palmon & w/f	W.D.	97	406		2				21' of T1-D5-D
	Henry J. Palmon & w/f	Omaha Loan & Bldg. Assn.	W.D.	108	33		2				21' of T1-D5-D
	Metropolitan Utilities Dist.	Whom it May Concern	W.D.	108	33		2				21' of T1-D5-D
	Construction Service Equipment	Belleme Construction Co.	W.D.	97	398		2				21' of T1-D5-D
	Belleme Construction Co.	Whom it May Concern	W.D.	97	423		2				21' of T1-D5-D
	Howard B. Westering & w/f	Belleme Construction Co.	P.C.D.	97	539		2				21' of T1-D5-D
	C. B. Farber & w/f	Belleme Construction Co.	P.C.D.	97	574		2				21' of T1-D5-D
	Howard M. Diller & w/f	Belleme Construction Co.	P.C.D.	97	573		2				21' of T1-D5-D
	Anna S. Schwartz & w/f	Belleme Construction Co.	P.C.D.	97	572		2				21' of T1-D5-D
	Wallace W. Diller & w/f	Belleme Construction Co.	P.C.D.	97	537		2				21' of T1-D5-D

NE 1/4 NE 1/4 LOT NOS. NW 1/4 NE 1/4 LOT NOS. SE 1/4 NE 1/4 LOT NOS. SW 1/4 NE 1/4 LOT NOS. *Proof read Original in Copybook*
 NE 1/4 NW 1/4 LOT NOS. NW 1/4 NW 1/4 LOT NOS. SE 1/4 NW 1/4 LOT NOS. SW 1/4 NW 1/4 LOT NOS.

SEC. 16 TWP. 14 R. 13
 SARPY COUNTY, NEBRASKA
 42

DATE	GRANTOR	GRANTEE	KIND OF INSTRUMENT	RECORD				ACRES	REMARKS
				BOOK	PAGE	N.E. QUARTER	N.W. QUARTER		
	<i>Branch Co.</i> Bellevue Construction Co.	William V. G. Schuck et al	Rel.	125			2		J. F. 360
	Bellevue Construction Co.	Phillips Petroleum Co.	W.D.	103	576		5		20' extension - 20' 20' 1/2' 1/2' 1/2' 1/2'
	Wear Hedner & w/f	Carl O. Hedner & w/f	P.C.D.	104	274		2		Corrected deed
	Carl O. Hedner & w/f	Alice D. Eich	W.D.	104	277		2		
	Bellevue Construction Co.	City of Omaha - Utility Improvement	Exec.	28	284		3		Rel. 30 - 100
	Metropolitan Utilities Dist.	Lloyd Barnhart & w/f	W.D.	28	331		3		1/4 of 5122' of 72' 0"
	Carl Sanderson & w/f	A. Robert Lohle & w/f	W.D.	104	456		2		1.0530 1/4 of 72' 27' 20" 27' 20"
	Commercial Savings & Loan	John L. Merton & w/f	Rel.	122	570		1		of 81 - 329
	Alfred R. Merton & w/f	Commercial Savings & Loan	W.D.	122	521		1		1.0720 Rel. 175 - 320
	Bellevue Construction Co.	George Lattimer & w/f	P.C.D.	104	278		3		Rel. 1021 Chandle
	Bellevue Construction Co.	Robert W. Salvo & w/f	P.C.D.	104	611		3		Rel. 1021 Chandle
	Bellevue Construction Co.	Ann E. Lubich & w/f	P.C.D.	104	603		3		Rel. 1021 Chandle
	Bellevue Construction Co.	Eddy J. Bowers & w/f	P.C.D.	102	600		3		Rel. 1021 Chandle
	Bellevue Construction Co.	Jordan Z. Lawson & w/f	P.C.D.	102	604		3		Rel. 1021 Chandle
	Bellevue Construction Co.	Bernard H. Hough & w/f	P.C.D.	102	605		3		Rel. 1021 Chandle
	Jordan Z. Lawson & w/f	Bellevue Construction	P.C.D.	103	644		3		Rel. 1021 Chandle
	Russell A. Runyon & w/f	Dorothy K. Runyon	W.D.	115	120		3		71.0770, 1.10.10
	Bellevue Construction Co.	Vincent J. Harey & w/f	P.C.D.	105	203		3		Rel. 1021 Chandle
	Commercial Savings & Loan	Jerry J. Jarvis & w/f	Rel.	124	41		2		of 63 - 58
	Alice D. Eich	Eugene F. Hoss & w/f	W.D.	105	238		3		1/4 of 71.86
	Nebraska Light & Power	Carl Parmentier & w/f	Rel.	124	408		3		of 103 - 451
	Carl Parmentier & w/f	Jackie L. O'Quinn & w/f	W.D.	105	378		3		6.146 of 50.100' 72'
	Jackie L. O'Quinn & w/f	City of Omaha - Steam	W.D.	120	406		3		Rel. 204 - 575
	Bellevue Construction Co.	Eugene Walthall Jr. & w/f	P.C.D.	105	339		3		Rel. 1021 Chandle
	Bellevue Construction Co.	Paul R. Boubel & w/f	P.C.D.	105	587		3		Rel. 1021 Chandle
	Jerry J. Jarvis & w/f	Omaha Loan & Bldg. Co.	W.D.	125	369		2		Rel. 157 - 82
	J. E. Chapetz	William H. May Concern	W.D.	129	577		2		
	C. E. Thompson	William H. May Concern	W.D.	129	469		2		of F 371
	A. Robert Lohle & w/f	William H. May Concern	W.D.	129	110		2		71.1.122
	A. Robert Lohle & w/f	First Federal Savings & Loan	W.D.	125	654		2		71.290 Rel. 17 - 112
	A. Robert Lohle & w/f	First Federal Sav. & Loan	W.D.	125	652		2		71.290 Rel. 17 - 112

43

GRANTOR	GRANTEE	KIND OF INSTRUMENT	RECORD		N.E. QUARTER		N.W. QUARTER		S.W. QUARTER		S.E. QUARTER		ACRES	REMARKS	DATE
			BOOK	PAGE	N.E.N.W.S.E.	N.E.N.W.S.E.	N.W.N.W.S.E.	N.W.N.W.S.E.	S.W.N.W.S.E.	S.W.N.W.S.E.	S.E.N.W.S.E.	S.E.N.W.S.E.			
John Petersen, Jr. et al	Paul L. Rhoten	W.D.	106	169										173' x 110' of E 1/2 of T. 14. R. 13	
Bellman Construction Co.	William J. Roth et al	P.C.D.	106	334										1/2 of 1/2 of 29' Charles Ave	
William Lumber Co.	James D. Smith	Gen. L.	107	203										1/2 of 1/2 of 29' Charles Ave	
Francis Varga	John J. Varga	W.D.	107	203										1/2 of 1/2 of 29' Charles Ave	
Francis Varga	John J. Varga	W.D.	107	203										1/2 of 1/2 of 29' Charles Ave	
Bellman Const. Co.	Jack W. Reed et al	P.C.D.	107	203										1/2 of 1/2 of 29' Charles Ave	
Arthur J. Huber et al	Hubert Huber et al	W.D.	107	203										1/2 of 1/2 of 29' Charles Ave	
Bellman Construction Co.	Marian J. Emerson et al	P.C.D.	108	102										1/2 of 1/2 of 29' Charles Ave	
Central Construction Co.	Edward A. Warren et al	P.C.D.	108	457										1/2 of 1/2 of 29' Charles Ave	
Chester A. Holcomb et al	County of Sarpy	P.C.D.	108	461										1/2 of 1/2 of 29' Charles Ave	
Floyd E. Elder et al	County of Sarpy	P.C.D.	108	457										1/2 of 1/2 of 29' Charles Ave	
George Scheller et al	William W. May Concern	Off.	30	132										1/2 of 1/2 of 29' Charles Ave	
William Bartak et al	Omaha Loan & Bldg. Co.	Mtg.	132	131										1/2 of 1/2 of 29' Charles Ave	
Metropolitan Utilities Dist.	William W. May Concern	Mtg.	30	214										1/2 of 1/2 of 29' Charles Ave	
George L. Scheller, Jr.	William W. May Concern	Off.	30	202										1/2 of 1/2 of 29' Charles Ave	
George L. Scheller, Jr. et al	William W. May Concern	W.D.	118	676										1/2 of 1/2 of 29' Charles Ave	
William W. C. Schmitt	Atchafalaya National Bank	Mtg.	132	223										1/2 of 1/2 of 29' Charles Ave	
William W. C. Schmitt	Atchafalaya National Bank	Mtg.	132	224										1/2 of 1/2 of 29' Charles Ave	
William K. Leasing et al	Stanley M. Brooks et al	W.D.	109	85										1/2 of 1/2 of 29' Charles Ave	
Stanley M. Brooks et al	Catholic Workmen	Mtg.	132	305										1/2 of 1/2 of 29' Charles Ave	
Frank Jensen, et al	William W. C. Schmitt	P.C.D.	109	250										1/2 of 1/2 of 29' Charles Ave	
Commercial Savings & Loan	Floyd J. Barnhart et al	Part. Mtg.	133	20										1/2 of 1/2 of 29' Charles Ave	
Commercial Savings & Loan	Floyd J. Barnhart et al	Part. Mtg.	132	319										1/2 of 1/2 of 29' Charles Ave	
Commercial Savings & Loan	Floyd J. Barnhart et al	Part. Mtg.	132	487										1/2 of 1/2 of 29' Charles Ave	
Commercial Savings & Loan	Floyd J. Barnhart et al	Mtg.	132	488										1/2 of 1/2 of 29' Charles Ave	
Floyd J. Barnhart et al	Richard L. Barnhart et al	W.D.	109	679										1/2 of 1/2 of 29' Charles Ave	
Richard L. Barnhart et al	Commercial Savings & Loan	Mtg.	132	609										1/2 of 1/2 of 29' Charles Ave	
Metropolitan Utilities Dist.	Floyd Barnhart et al	Part. Mtg.	132	400										1/2 of 1/2 of 29' Charles Ave	
Edward Warren et al	Metropolitan Utilities Dist.	Part. Mtg.	132	405										1/2 of 1/2 of 29' Charles Ave	
Arthur W. Roscoe et al	Commercial Savings & Loan	Mtg.	136	52										1/2 of 1/2 of 29' Charles Ave	
Commercial Savings & Loan	Arthur W. Roscoe et al	Mtg.	136	102										1/2 of 1/2 of 29' Charles Ave	
Paul L. Rhoten et al	Paul L. Rhoten et al	W.D.	111	373										1/2 of 1/2 of 29' Charles Ave	

Wagon

DATE	GRANTOR	GRANTEE	KIND OF INSTRUMENT	RECORD		N.E. QUARTER	N.W. QUARTER	S.W. QUARTER	S.E. QUARTER	ACRES	REMARKS
				BOOK	PAGE						
	Francis Varga	Joseph Varga Jr.	WD	111	521						11-11-10, 07A-2
	A Robert 1st & wf	Metropolitan Utilities Dist.	signed	91	159						11-11-10, 07B
	Metropolitan Utilities Dist.	Whom it May Concern	Notice	34	203						11-11-10, 07C
	Joseph Varga Jr. & wf	Joseph Varga Jr. & wf	WD	112	516						11-11-10, 07D
	Stena R. Maxson & wf	Whom it May Concern	Platt	83	525						11-11-10, 07E
	Metropolitan Utilities Dist.	Whom it May Concern	Notice	31	974						11-11-10, 07F
	Jerry Wilson & wf	The Center Bank	mtg	134	205						11-11-10, 07G
	Eugene T. Kireo & wf	Commercial Sav. & Loan	mtg	139	474						11-11-10, 07H
	Marie Pavlik	Marie Pavlik & Husband	WD	113	226						11-11-10, 07I
	William Bartak & wf	Commercial Sav. & Loan	mtg	139	606						11-11-10, 07J
	Omaha Loan & Bldg. Assoc.	William Bartak & wf	Rel	140	110						11-11-10, 07K
	Metropolitan Utilities Dist.	Whom it May Concern	Notice	32	85						11-11-10, 07L
	Floyd J. Barnhart & wf	Robert F. Barnhart & wf	WD	114	630						11-11-10, 07M
	Carolyne Blankman	Carolyne Blankman, et al	WD	115	176						11-11-10, 07N
	Barnhart, Robert F. & wf	Ciliver, George W. & wf	WD	115	381						11-11-10, 07O
	Watkins Lumber Inc.	Speth James D.	rel	116	299						11-11-10, 07P
	Bower, John C. & wf	Comm. Sav. & Loan Assoc.	mtg	143	620						11-11-10, 07Q
	Wodner, Oscar & wf & on	Bro. Eugene T. & wf	2CD	115	574						11-11-10, 07R
	Com. Sav. & Loan Assoc.	Bower, John C. & wf	Rel	143	699						11-11-10, 07S
	First Fed. Sav. & Loan	Werts, Bertie H. & wf	Rel	141	97						11-11-10, 07T
	Ciliver, George W. & wf	Nick. City Fed. Sav. & Loan	mtg	144	49						11-11-10, 07U
	Spinel, Eldon H. & wf	School Dist of Omaha	WD	116	227						11-11-10, 07V
	Rayton, Mary M. & wf	Cool Dist of Omaha	WD	116	466						11-11-10, 07W
	Phillips Petroleum Co.	Phillips Petroleum Co.	WD	117	214						11-11-10, 07X
	Reproco, Inc.	Dankers Trust Co.	mtg	146	346						11-11-10, 07Y
	Reproco, Inc. & Phillips	Dankers Trust Co.	mtg	133	254						11-11-10, 07Z
	Neb. City Federal Sav. & Loan	Oliver, George W. & wf	Rel	146	668						11-11-10, 08A
	Oliver, George W. & wf	Schnell, Charles & wf	WD	117	462						11-11-10, 08B
	Schnell, Charles & wf	Nick. City Federal Sav. & Loan	mtg	146	711						11-11-10, 08C
	Com. Sav. & Loan Assoc.	Beck, Arthur W. & wf	Rel	148	37						11-11-10, 08D
	Svendson, Carl & wf	Svendson, Robert & wf	WD	119	488						11-11-10, 08E
	Svendson, Robert & wf	Neb. Sav. & Loan Assoc.	mtg	150	362						11-11-10, 08F
	Stock Yards National Bank	Schnett, William H. C.	Rel	151	525						11-11-10, 08G
	Schnett, William H. C. & wf	Stock Yards National	mtg	151	526						11-11-10, 08H
11-2-64	Schnett, William H. C. & wf	Stock Yards National	mtg	151	527						11-11-10, 08I
11-24-64	Com. Sav. & Loan Assoc.	Barnhart, Floyd J. & wf	Rel	152	193						11-11-10, 08J
11-24-64	Barnhart, Floyd J. & wf	Leppan, Joseph L. Jr. & wf	WD	120	448						11-11-10, 08K
12-2-64	Blankman, Carolyne, et al	Leppan, Joseph L. Jr. & wf	WD	120	557						11-11-10, 08L
12-9-64	Leppan, Joseph P. Jr. & wf	Com. Sav. & Loan Assoc.	mtg	152	437						11-11-10, 08M
12-15-64	Burns, Richard L. & wf	Schnett, William H. C.	WD	120	591						11-11-10, 08N
12-22-64	Burns, Richard L. & wf	Schnett, William H. C.	WD	120	646						11-11-10, 08O
3-5-65	In Matter of Estate of	Roberts, Bertie Deceased	Deed	35	15						11-11-10, 08P
3-5-65	Silbhus Construction Company	Baker, Abe	WD	121	461						11-11-10, 08Q
7-26-65	Omaha Loan & Bldg. Assoc.	Wichita, Frank J. & wf	Rel	154	651						11-11-10, 08R
5-18-65	Baker, Abe & wf	Baker's Super Market Inc	WD	122	234						11-11-10, 08S

Please Turn Page

45

LOT NOS. LOT NOS. LOT NOS. LOT NOS.

SEC. 16 TWP. 14 R. 13

NE1/4NW1/4 NW1/4NW1/4 SW1/4NW1/4 SE1/4NW1/4 NW1/4SW1/4 NW1/4SE1/4 SW1/4SE1/4 SE1/4SW1/4

SARPY COUNTY, NEBRASKA

GRANTOR	GRANTEE	KIND OF INSTRUMENT	RECORD		QUARTERS				ACRES	REMARKS	DATE
			BOOK	PAGE	N.E. Q.	N.W. Q.	S.W. Q.	S.E. Q.			
Lib. court, Kenneth J. & Wf.	Lib. court, Kenneth J. & Wf.	WD	122	254					7.1 B. 311A1	5-14-65	
Lib. court, Kenneth J. & Wf.	Messinger, Larry E. & Wf.	WD	122	265					T. L. B. 311A1	5-20-65	
Messinger, Larry E. & Wf.	Mortgage Associates, Inc.	Mtg	155	502					Assign 197-188	5-28-65	
Wichter, Frank J. & Wf.	Bank, Vincent J. & Wf.	WD	122	367					T. L. B. 311A1	5-28-65	
Various Employer Credit	Docourt, Kenneth J. & Wf.	Rel	155	655					7.1 B. 311A1	6-19-65	
Omaha Loan & Bldg. Assn.	Jara, Jerry J. & Wf.	Rel	157	82					7.1 B. 311A1	7-28-65	
Jara, Jerry J. & Wf.	Omaha Loan & Bldg. Assn.	Mtg	157	101					7.1 B. 311A1	7-28-65	
Mortgage Associates, Inc.	Bankers Trust Company	Mtg	158	182					7.1 B. 311A1	8-31-65	
In the Matter of Estate of Varga, Frances	Peterson, Chris & Wf.	WD	39	637					7.1 D. 781	9-14-65	
Metropolitan Utilities Dist	Spradner, Carl F. & Wf.	WD	124	285					7.1 D. 112	9-29-65	
Carl F. Robert & Wf.	Schwarzlander, Carl	WD	H	612					7.1 D. 9C	10-2-65	
Starr, Rockwell & Co.	Commercial Sav & Loan Assn.	Mtg	161	281					Rel. 595	11-9-65	
Varga, Joseph & Wf. (Jr.)	Varga, John J. & Dorothy	Rel	H	656					Rel. 54, 568	12-3-65	
National Home Supply Co. Inc.	Wright, Charles W. & Wf.	WD	125	467					7.1 D. 785-0766	11-4-66	
Saffron, Joseph Paul Jr. & Wf.	First National Bk of Omaha	Mtg	162	283					Assign 163 121	1-21-66	
Scindale, Charles & Wf.	Commercial Sav & Loan Assn.	Rel	163	326					152-4-79	1-28-66	
First National Sav & Loan Assn.	Bank, Lillian et al	WD	126	176					160 283	3-7-66	
Bank, Lillian	Kuparowicz, Ube M.	Mtg	164	121					7.1 D. 10	3-22-66	
Mixar, Aldrich & Wf. Bank	Schmitt, William H. & Wf.	WD	127	572					114-1584	4-29-66	
Omaha Stock Lds Natl	Macder, Erwin H. & Wf.	WD	127	572					51-527	6-6-66	
Knack, Charles H. & Wf.	Jara, Jerry J. & Wf.	Rel	168	472					104-546	7-19-66	
Omaha Loan & Bldg. Assn.	Wron, Edward	Mtg	168	471					140-24	1-5-67	
Jara, Jerry J. & Wf.	Sautter, Eugene A. & Wf.	WD	130	467					30-405	1-23-67	
Metropolitan Utilities Dist	Local Loan Company	Mtg	170	5					7.1 D. 378	3-21-67	
Varga, Joseph Jr. & Wf.	Widner, Carl O. & Wf.	WD	131	386					121-1584	3-31-67	
Jara, Jerry J. & Wf.	Widner, Marie	Mtg	171	107					121-1584	5-26-67	
Widner, Marie (Mabel)	M. A. Beer, Walter A. & Wf.	WD	131	691					121-1584	6-27-67	
Widner, Carl O. & Wf.	M. A. Beer, Walter A. & Wf.	WD	132	59					121-1584	7-5-67	
Sparzinski, Mary	Warren, Jerry L. & Wf.	WD	133	447					121-1584	10-5-67	
Sparzinski, Mary	Warren, Jerry L. & Wf.	WD	133	449					121-1584	10-5-67	
Warren, Edward & Wf.	Messinger, Larry E. & Wf.	Mtg	174	76					121-1584	10-6-67	
Warren, Edward & Wf.	Nelva Bank & Loan Assn.	Mtg	174	145					121-1584	10-11-67	
Bankers Trust Company	Morton, Glen R. & Wf.	Rel	175	320					122 521	11-28-67	
Warren, Jerry L. & Wf.	Messinger, Larry E. & Wf.	Rel	175	451					155 522	12-8-67	
Commercial Sav & Loan Assn.	Moser, John F. & Wf.	WD	134	456					7.1 B. 311A1	12-8-67	
Bankers Trust Company	Moser, John F. & Wf.	Rel	135	648					7.1 B. 311A1	3-18-68	
Messinger, Larry E. & Wf.	Fed. National Mtg. Assn.	Mtg	177	375					191-1517	5-20-68	
Moser, John F. & Wf.	Mixar, James F. & Wf.	WD	136	577					191-1517	5-20-68	
Moser, John F. & Wf.	Commercial Sav & Loan Assn.	Mtg	178	524					191-1517	5-24-68	
Ulbricht, Al. & Wf.	Schwarzlander, Carl	WD	T	489					191-1517	5-24-68	
Ulbricht, Al. & Wf.	Schwarzlander, Carl	WD	T	491					191-1517	5-24-68	
Mixar, James F. & Wf.	Mixar, James F. & Wf.	WD	137	172					191-1517	6-12-68	
Mixar, James F. & Wf.	Commercial Sav & Loan Assn.	Mtg	179	124					191-1517	6-12-68	

Next Page Please

LOT NOS. LOT NOS. LOT NOS. LOT NOS.

NE1/4NE1/4 NW1/4NE1/4 SW1/4NE1/4 SE1/4NE1/4
 NE1/4NW1/4 NW1/4NW1/4 SW1/4NW1/4 SE1/4NW1/4
 NE1/4SW1/4 NW1/4SW1/4 SW1/4SW1/4 SE1/4SW1/4
 NE1/4SE1/4 NW1/4SE1/4 SW1/4SE1/4 SE1/4SE1/4

SEC. 16 TWP. 14 R. 13
 SARDY COUNTY, NEBRASKA
 46

DATE FILED	GRANTOR	GRANTEE	KIND OF INSTRUMENT	RECORD		N.E. QUARTER		N.W. QUARTER		S.W. QUARTER		S.E. QUARTER		ACRES	REMARKS
				BOOK	PAGE	N.E.	N.W.	S.W.	S.E.	N.E.	N.W.	S.W.	S.E.		
9-4-68	Catholic Workman	Brabeau Stanley M. + w/f	Rel.	180	460										g 132-325
9-9-68	Catholic Workman	Rebin, Herbert + w/f	Rel.	180	527										g 111-300
4-21-69	Leann, Robbink + Co.	Schwartzlander, Carl R.	W.D.	141	575										g 71-612
4-21-69	Mijan, Aldrich A. + w/f	Schwartzlander, Carl R. + w/f	W.D.	141	571										g 147-4-321, 147-5-11, 147-6-11, 147-7-11, 147-8-11, 147-9-11, 147-10-11, 147-11-11, 147-12-11
4-21-69	Mijan, Aldrich A. + w/f	Schwartzlander, Carl R. + w/f	W.D.	141	571										at 72 DPA + PPA
5-1-69	Hysok, Anton J. + w/f	Hysok, John J. + w/f	W.D.	141	120										FL D 781
5-8-69	Sautter, Eugene A. + w/f	Safeway Stores, Inc.	W.D.	141	122										D781-0782, 0783, 0784, 0785, 0786, 0787, 0788, 0789, 0790, 0791, 0792, 0793, 0794, 0795, 0796, 0797, 0798, 0799, 0800
5-8-69	Varga, John G. + w/f	Safeway Stores, Inc.	W.D.	141	126										FLS-0785, 0783
5-8-69	Varga, Joseph J. + w/f	Safeway Stores, Inc.	W.D.	141	188										FLS-0787, 0784-D70
5-9-69	Reynolds, Loretta K. + w/f	Safeway Stores, Inc.	W.D.	141	190										FL D 781
5-9-69	Commercial Dev. + Loan Assn.	Varga, Joseph + w/f	Rel.	184	568										g 161-251
5-14-69	Commercial Dev. + Loan Assn.	Varga, Joseph + w/f	Rel.	184	643										g 101-451
5-19-69	Varga, Joseph Jr. + w/f	Safeway Stores, Inc.	W.D.	141	223										FL D782, 0784, D10
5-22-69	Mt & Blair, Walter A. + w/f	Dee, Robert W. + w/f	W.D.	141	324										170's E105, 116, 117, 118, 119, 120, 121, 122, 123, 124, 125, 126, 127, 128, 129, 130, 131, 132, 133, 134, 135, 136, 137, 138, 139, 140, 141, 142, 143, 144, 145, 146, 147, 148, 149, 150, 151, 152, 153, 154, 155, 156, 157, 158, 159, 160, 161, 162, 163, 164, 165, 166, 167, 168, 169, 170, 171, 172, 173, 174, 175, 176, 177, 178, 179, 180, 181, 182, 183, 184, 185, 186, 187, 188, 189, 190, 191, 192, 193, 194, 195, 196, 197, 198, 199, 200
5-22-69	Dee, Robert W. + w/f	Comm. Dev. + Loan Assn.	Mtg.	185	31										Rel. 182-807
MICROFILMED				JUL 28 1969											
10-21-69	Schlafke, Charles B. + w/f	Vicario, Dante A. + w/f	W.D.	143	228										N89.40 T.L.O. + N88.75' of T.L.P. 11/11/69
1-5-70	Commercial Dev. + Loan Assn.	Stevens, Paul W. + w/f	W.D.	145	12										at 12 F m 11/11/69
1-5-70	Commercial Dev. + Loan Assn.	Commercial Dev. + Loan Assn.	Mtg.	181	11										Rel. 183-281
4-7-70	Mijan, Aldrich + w/f	Kaglowsky, Abe M.	Mtg.	189	513										Rel. 149-539, 149-540, 149-541, 149-542, 149-543, 149-544, 149-545, 149-546, 149-547, 149-548, 149-549, 149-550, 149-551, 149-552, 149-553, 149-554, 149-555, 149-556, 149-557, 149-558, 149-559, 149-560, 149-561, 149-562, 149-563, 149-564, 149-565, 149-566, 149-567, 149-568, 149-569, 149-570, 149-571, 149-572, 149-573, 149-574, 149-575, 149-576, 149-577, 149-578, 149-579, 149-580, 149-581, 149-582, 149-583, 149-584, 149-585, 149-586, 149-587, 149-588, 149-589, 149-590, 149-591, 149-592, 149-593, 149-594, 149-595, 149-596, 149-597, 149-598, 149-599, 149-600
4-13-70	Varga, Joseph J. + w/f	Local Loan Co.	Mtg.	189	718										Rel. 183-281
6-11-70	Safeway Stores, Inc.	Omaha Public Power Dist.	Lease	43	341										Rel. 149-539, 149-540, 149-541, 149-542, 149-543, 149-544, 149-545, 149-546, 149-547, 149-548, 149-549, 149-550, 149-551, 149-552, 149-553, 149-554, 149-555, 149-556, 149-557, 149-558, 149-559, 149-560, 149-561, 149-562, 149-563, 149-564, 149-565, 149-566, 149-567, 149-568, 149-569, 149-570, 149-571, 149-572, 149-573, 149-574, 149-575, 149-576, 149-577, 149-578, 149-579, 149-580, 149-581, 149-582, 149-583, 149-584, 149-585, 149-586, 149-587, 149-588, 149-589, 149-590, 149-591, 149-592, 149-593, 149-594, 149-595, 149-596, 149-597, 149-598, 149-599, 149-600
7-23-70	Ericsson Develop. Co. Inc.	T.G. & G. Stores Co.	Lease	43	244										Rel. 149-539, 149-540, 149-541, 149-542, 149-543, 149-544, 149-545, 149-546, 149-547, 149-548, 149-549, 149-550, 149-551, 149-552, 149-553, 149-554, 149-555, 149-556, 149-557, 149-558, 149-559, 149-560, 149-561, 149-562, 149-563, 149-564, 149-565, 149-566, 149-567, 149-568, 149-569, 149-570, 149-571, 149-572, 149-573, 149-574, 149-575, 149-576, 149-577, 149-578, 149-579, 149-580, 149-581, 149-582, 149-583, 149-584, 149-585, 149-586, 149-587, 149-588, 149-589, 149-590, 149-591, 149-592, 149-593, 149-594, 149-595, 149-596, 149-597, 149-598, 149-599, 149-600
7-23-70	Schwartz, William H. + w/f	Goldblatt, Harold D.	Lease	43	302										5.94' S. 25.2' E. of T.L.N. 11/11/69
12-1-70	Catholic Workman (Rel.)	Hysok, John J. + w/f	Rel.	189	2214										g 88-125
12-23-70	Safeway Stores, Inc.	Ericsson Develop. Co. Inc.	W.D.	145	2285										Leashtite 10 5220
12-23-70	Ericsson Develop. Co. Inc.	Safeway Stores, Inc.	Lease	43	431										149-539, 149-540, 149-541, 149-542, 149-543, 149-544, 149-545, 149-546, 149-547, 149-548, 149-549, 149-550, 149-551, 149-552, 149-553, 149-554, 149-555, 149-556, 149-557, 149-558, 149-559, 149-560, 149-561, 149-562, 149-563, 149-564, 149-565, 149-566, 149-567, 149-568, 149-569, 149-570, 149-571, 149-572, 149-573, 149-574, 149-575, 149-576, 149-577, 149-578, 149-579, 149-580, 149-581, 149-582, 149-583, 149-584, 149-585, 149-586, 149-587, 149-588, 149-589, 149-590, 149-591, 149-592, 149-593, 149-594, 149-595, 149-596, 149-597, 149-598, 149-599, 149-600
12-23-70	Ericsson Develop. Co. Inc.	Down Securities Co.	Mtg.	189	2362										Rel. 149-539, 149-540, 149-541, 149-542, 149-543, 149-544, 149-545, 149-546, 149-547, 149-548, 149-549, 149-550, 149-551, 149-552, 149-553, 149-554, 149-555, 149-556, 149-557, 149-558, 149-559, 149-560, 149-561, 149-562, 149-563, 149-564, 149-565, 149-566, 149-567, 149-568, 149-569, 149-570, 149-571, 149-572, 149-573, 149-574, 149-575, 149-576, 149-577, 149-578, 149-579, 149-580, 149-581, 149-582, 149-583, 149-584, 149-585, 149-586, 149-587, 149-588, 149-589, 149-590, 149-591, 149-592, 149-593, 149-594, 149-595, 149-596, 149-597, 149-598, 149-599, 149-600
12-23-70	Ericsson Develop. Co. Inc.	U.S. Natl. Bank of Omaha	Lease	43	2374										Rel. 149-539, 149-540, 149-541, 149-542, 149-543, 149-544, 149-545, 149-546, 149-547, 149-548, 149-549, 149-550, 149-551, 149-552, 149-553, 149-554, 149-555, 149-556, 149-557, 149-558, 149-559, 149-560, 149-561, 149-562, 149-563, 149-564, 149-565, 149-566, 149-567, 149-568, 149-569, 149-570, 149-571, 149-572, 149-573, 149-574, 149-575, 149-576, 149-577, 149-578, 149-579, 149-580, 149-581, 149-582, 149-583, 149-584, 149-585, 149-586, 149-587, 149-588, 149-589, 149-590, 149-591, 149-592, 149-593, 149-594, 149-595, 149-596, 149-597, 149-598, 149-599, 149-600
12-23-70	Ericsson Develop. Co. Inc.	U.S. Natl. Bank of Omaha	Lease	43	2374										Rel. 149-539, 149-540, 149-541, 149-542, 149-543, 149-544, 149-545, 149-546, 149-547, 149-548, 149-549, 149-550, 149-551, 149-552, 149-553, 149-554, 149-555, 149-556, 149-557, 149-558, 149-559, 149-560, 149-561, 149-562, 149-563, 149-564, 149-565, 149-566, 149-567, 149-568, 149-569, 149-570, 149-571, 149-572, 149-573, 149-574, 149-575, 149-576, 149-577, 149-578, 149-579, 149-580, 149-581, 149-582, 149-583, 149-584, 149-585, 149-586, 149-587, 149-588, 149-589, 149-590, 149-591, 149-592, 149-593, 149-594, 149-595, 149-596, 149-597, 149-598, 149-599, 149-600
12-23-70	Ericsson Develop. Co. Inc.	U.S. Natl. Bank of Omaha	Lease	43	2374										Rel. 149-539, 149-540, 149-541, 149-542, 149-543, 149-544, 149-545, 149-546, 149-547, 149-548, 149-549, 149-550, 149-551, 149-552, 149-553, 149-554, 149-555, 149-556, 149-557, 149-558, 149-559, 149-560, 149-561, 149-562, 149-563, 149-564, 149-565, 149-566, 149-567, 149-568, 149-569, 149-570, 149-571, 149-572, 149-573, 149-574, 149-575, 149-576, 149-577, 149-578, 149-579, 149-580, 149-581, 149-582, 149-583, 149-584, 149-585, 149-586, 149-587, 149-588, 149-589, 149-590, 149-591, 149-592, 149-593, 149-594, 149-595, 149-596, 149-597, 149-598, 149-599, 149-600
12-23-70	Ericsson Develop. Co. Inc.	U.S. Natl. Bank of Omaha	Lease	43	2374										Rel. 149-539, 149-540, 149-541, 149-542, 149-543, 149-544, 149-545, 149-546, 149-547, 149-548, 149-549, 149-550, 149-551, 149-552, 149-553, 149-554, 149-555, 149-556, 149-557, 149-558, 149-559, 149-560, 149-561, 149-562, 149-563, 149-564, 149-565, 149-566, 149-567, 149-568, 149-569, 149-570, 149-571, 149-572, 149-573, 149-574, 149-575, 149-576, 149-577, 149-578, 149-579, 149-580, 149-581, 149-582, 149-583, 149-584, 149-585, 149-586, 149-587, 149-588, 149-589, 149-590, 149-591, 149-592, 149-593, 149-594, 149-595, 149-596, 149-597, 149-598, 149-599, 149-600
12-23-70	Ericsson Develop. Co. Inc.	U.S. Natl. Bank of Omaha	Lease	43	2374										Rel. 149-539, 149-540, 149-541, 149-542, 149-543, 149-544, 149-545, 149-546, 149-547, 149-548, 149-549, 149-550, 149-551, 149-552, 149-553, 149-554, 149-555, 149-556, 149-557, 149-558, 149-559, 149-560, 149-561, 149-562, 149-563, 149-564, 149-565, 149-566, 149-567, 149-568, 149-569, 149-570, 149-571, 149-572, 149-573, 149-574, 149-575, 149-576, 149-577, 149-578, 149-579, 149-580, 149-581, 149-582, 149-583, 149-584, 149-585, 149-586, 149-587, 149-588, 149-589, 149-590, 149-591, 149-592, 149-593, 149-594, 149-595, 149-596, 149-597, 149-598, 149-599, 149-600
12-23-70	Ericsson Develop. Co. Inc.	U.S. Natl. Bank of Omaha	Lease	43	2374										Rel. 149-539, 149-540, 149-541, 149-542, 149-543, 149-544, 149-545, 149-546, 149-547, 149-548, 149-549, 149-550, 149-551, 149-552, 149-553, 149-554, 149-555, 149-556, 149-557, 149-558, 149-559, 149-560, 149-561, 149-562, 149-563, 149-564, 149-565, 149-566, 149-567, 149-568, 149-569, 149-570, 149-571, 149-572, 149-573, 149-574, 149-575, 149-576, 149-577, 149-578, 149-579, 149-580, 149-581, 149-582, 149-583, 149-584, 149-585, 149-586, 149-587, 149-588, 149-589, 149-590, 149-591, 149-592, 149-593, 149-594, 149-595, 149-596, 149-597, 149-598, 149-599, 149-600
12-23-70	Ericsson Develop. Co. Inc.	U.S. Natl. Bank of Omaha	Lease	43	2374										Rel. 149-539, 149-540, 149-541, 149-542, 149-543, 149-544, 149-545, 149-546, 149-547, 149-548, 149-549, 149-550, 149-551, 149-552, 149-553, 149-554, 149-555, 149-556, 149-557, 149-558, 149-559, 149-560, 149-561, 149-562, 149-563, 149-564, 149-565, 149-566, 149-567, 149-568, 149-569, 149-570, 149-571, 149-572, 149-573, 149-574, 149-575, 149-576, 149-577, 149-578, 149-579, 149-580, 149-581, 149-582, 149-583, 149-584, 149-585, 149-586, 149-587, 149-588, 149-589, 149-590, 149-591, 149-592, 149-593, 149-594, 149-595, 149-596, 149-597, 149-598, 149-599, 149-600
1															

LOT NOS. LOT NOS. LOT NOS. LOT NOS.

NE1/4NW1/4 NW1/4NE1/4 SW1/4NE1/4 SE1/4NE1/4 NE1/4NW1/4 NW1/4NW1/4 SW1/4NW1/4 SE1/4NW1/4 NE1/4SW1/4 NW1/4SW1/4 SW1/4SW1/4 SE1/4SW1/4 NE1/4SE1/4 NW1/4SE1/4 SW1/4SE1/4 SE1/4SE1/4

SEC 16 TWP 14 RANG 13

SARPY COUNTY, NEBRASKA 48

DATE	GRANTOR	GRANTEE	KIND OF INSTRUMENT	RECORD		QUARTERS				ACRES	REMARKS
				BOOK	PAGE	N.E. QUARTER	N.W. QUARTER	S.W. QUARTER	S.E. QUARTER		
6-12-73	Conit Fed. Sav. Loan Assn	Sarnhart, Richard L. & wf	Rel.	192	2218			3		of 123-608	02758
6-22-73	Swendson, Carl & wf	Swendson, Robert L. & wf	W.D.	148	1509		2			of 123-607	02766
8-18-73	Warren, Jerry Lee	Warren, Sally Ann	Q.C.D.	148	2114			2			02828
8-23-73	Kelly, Charles E. & wf	Goak, Lawrence E. Jr. & wf	W.D.	148	2111		3			of 123-608	02828
8-23-73	Goak, Lawrence E. Jr. & wf	Conit Fed. Sav. Loan Assn	Mtg.	192	3610						02997
8-27-73	Conit Fed. Sav. Loan Assn	Bowen, John C. & wf	Rel.	192	3648					of 123-602	03047
9-17-73	Epison Develop. Co., Inc.	AMFAC Mortgage Co.	Rel.	192	3789			2			03069
9-17-73	Epison, Orvin R.	AMFAC Mortgage Co.	Rel.	192	3788			2			03069
10-10-73	Commissioner, Sarpy County	Whorn & May Concern	Rel.	192	68					of 123-608	03151
10-10-73	Conit Fed. Sav. Loan Assn	Wagner, Carl & wf	Rel.	192	4355					of 123-608	03185
10-26-73	San Matter of Estate	Wagner, Carl O. & wf	W.D.	148	2025						03207
11-5-73	Wedner, Marie	Wagner, Carl O. & wf	W.D.	148	2025						03207
11-13-73	Wedner, Carl O. & wf	Wagner, Carl O. & wf	W.D.	148	2025						03207
12-20-73	Hargenski, Mary	Wagner, Carl O. & wf	W.D.	148	2025						03207
12-21-73	San Matter of Estate	Wagner, Carl O. & wf	W.D.	148	2025						03207
1-10-74	Swendson, Robert L. & wf	Con. Fed. Sav. Loan Assn	Mtg.	192	96						03345
3-25-74	Sarpy County	Shanley, George	W.D.	149	589						03502
5-14-74	Yast, Richard & wf	Ulep, Charles & wf	W.D.	149	1050						03651
6-11-74	Ulep, Charles & wf	Ulep, Charles & wf	W.D.	149	1050						03746
6-18-74	Yast, Richard & wf	Ulep, Charles & wf	W.D.	149	1050						03746
6-18-74	Ulep, Charles & wf	Ulep, Charles & wf	W.D.	149	1050						03746
7-3-74	Chicago, R.I. and Pacific R.R. Co.	Western Securities Co.	Mtg.	193	2177						03746
7-8-74	Ulep, Charles & wf	Ulep, Charles & wf	W.D.	149	1050						03746
8-7-74	Ulep, Charles & wf	Ulep, Charles & wf	W.D.	149	1050						03746
8-12-74	Western Securities Co.	Ulep, Charles & wf	W.D.	149	1050						03746
8-19-74	Conit Fed. Sav. Loan Assn	Ulep, Charles & wf	W.D.	149	1050						03746
9-12-74	C & L Company, Inc.	Ulep, Charles & wf	W.D.	149	1050						03746
9-30-74	Ciech, Joseph & Dorothy	Ulep, Charles & wf	W.D.	149	1050						03746
6-19-75	Ulep, Charles & wf	Ulep, Charles & wf	W.D.	149	1050						03746
6-19-75	Ulep, Charles & wf	Ulep, Charles & wf	W.D.	149	1050						03746
6-19-75	Ulep, Charles & wf	Ulep, Charles & wf	W.D.	149	1050						03746
9-4-75	Ulep, Charles & wf	Ulep, Charles & wf	W.D.	149	1050						03746
10-23-75	Ulep, Charles & wf	Ulep, Charles & wf	W.D.	149	1050						03746
3-9-76	Ulep, Charles & wf	Ulep, Charles & wf	W.D.	149	1050						03746
3-9-76	Ulep, Charles & wf	Ulep, Charles & wf	W.D.	149	1050						03746
3-18-76	Ulep, Charles & wf	Ulep, Charles & wf	W.D.	149	1050						03746
5-18-76	Ulep, Charles & wf	Ulep, Charles & wf	W.D.	149	1050						03746
5-18-76	Ulep, Charles & wf	Ulep, Charles & wf	W.D.	149	1050						03746
6-24-76	Ulep, Charles & wf	Ulep, Charles & wf	W.D.	149	1050						03746
6-24-76	Ulep, Charles & wf	Ulep, Charles & wf	W.D.	149	1050						03746
6-24-76	Ulep, Charles & wf	Ulep, Charles & wf	W.D.	149	1050						03746
6-24-76	Ulep, Charles & wf	Ulep, Charles & wf	W.D.	149	1050						03746
8-16-76	Ulep, Charles & wf	Ulep, Charles & wf	W.D.	149	1050						03746
8-24-76	Ulep, Charles & wf	Ulep, Charles & wf	W.D.	149	1050						03746
10-4-76	Ulep, Charles & wf	Ulep, Charles & wf	W.D.	149	1050						03746

DATE	GRANTOR	GRANTEE	KIND OF INSTRUMENT	RECORD		QUARTERS				ACRES	REMARKS
				BOOK	PAGE	N.E. QUARTER	N.W. QUARTER	S.W. QUARTER	S.E. QUARTER		
3-28-83	Clerk Dist. Court, Sarpy County	Helm, Charles E.	Ord. of Sale	202	1499						of 197-5356 182nd
4-21-83	Pickens, John W.	Pavolko, Donald M.	l. r.	158	926						Remo 13 1844 327
5-20-83	Svendson, Robert H. et al	Shell Fuel Credit Union	Mtg	202	204						Rel. 201-10036 04553
5-20-83	Shell Fuel Credit Union	Svendson, Robert H. et al	Rel.	202	203						of 197-3443 04552
6-6-83	In Matter of Estate of	Kramer, Robert D.	Special	56	344						52777
6-30-83	Svendson, Robert H. et al	Whom it May Concern	Plat	8	23						Svendson, Robert H. et al 6223
7-5-83	Summa, Yunick	Griest, Halby R. Jr. et al	W.D.	158	170						Rel. 205-12724 01386
7-5-83	Episto, Paul Roy R. Jr. et al	Reulbarn, Dale	Mtg	202	373						of 197-5269 7407
7-27-83	Peckers Natl. Bank of Minn.	Mojam, James P. et al	Mtg	202	428						8078
8-9-83	In Matter of Estate of	W. H. B. Bond (N.M.)	Ord. of Sale	56	304						930
9-6-83	Wagner, Raymond A. et al	Leg. Development Services	Mtg	202	538						1016
9-23-83	Rubini, Herbert et al Co-Trustee	Rubini, Herbert et al	W.D.	158	175						T.L. D143
10-13-83	Berry, John S. et al	First Natl. Bank of Belle	Plat	202	632						Rel. 204-8325 14580
10-14-83	Johnson, Curtis P.	Johnson, Judith Kay et al	Ord. of Sale	158	204						71 203 16925
10-27-83	Wate, Billy D. et al	Kenny, Patricia Ann et al	Ord. of Sale	158	357						T.L. S (232) 1575
10-27-83	Denney, Charles R. et al	Relator Bank	Mtg	202	608						Rel. 206-10006 11513
10-27-83	Denney, Charles R. et al	Relator Bank	Mtg	202	609						Rel. 206-10006 11514
1-18-84	Warren, James W. et al	Commercial State Natl. Bank of Chicago	Mtg	203	317						of 198-2035 579
3-19-84	Vilim, Harry A. et al	Am. Charter Fed. Sav. & Inv.	Mtg	203	443						of 198-2035 579
5-21-84	U. S. Supply Company	Merwald, William J.	W.D.	159	243						of 198-2035 579
6-1-84	Dist. Court, Sarpy County	Whom it May Concern	Ord. of Sale	57	368						5578
6-1-84	First Natl. Bank Chicago	Chicago R. I. & Pacific R. Co.	Rel.	203	376						See Chart 5579
6-1-84	Dubois, William M. et al	Chicago Pacific Corp.	Deed	159	1366						5579
7-18-84	Nernandez, Sr. Anthony M.	Cont. Hk. Sav. & Inv. Assn.	Mtg	203	423						Rel. 89-04527 748
8-31-84	Peterson, Roseann	Packers Natl. Bank of Minn.	Mtg	203	524						Rel. 90-01019 09477
9-13-84	Relator Bank	Jackson, Michael L.	Rel.	203	531						of 200-4256 86
9-17-84	U. S. Savings & Loan Assn.	Security Pacific Finance Corp.	Rel.	57	719						of 201-4256 86
9-17-84	U. S. Savings & Loan Assn. et al	Security Pacific Finance Corp.	Rel.	57	719						of 201-4256 86
10-31-84	Amoco Oil Company	Rever, Joseph P. et al	W.D.	159	394						(44.55) 1766
10-31-84	Rever, Joseph P. et al	Rever, Kenneth A.	W.D.	159	397						(32.00) 1147
10-31-84	Rever, Kenneth A.	Rever, Joseph P. et al	Mtg	203	694						1148
11-5-84	Priddy, Sharon L. et al	Omaha Public Power Plant	Exec.	57	447						12214
11-9-84	Metropolitan Utilities Dist.	Whom it May Concern	Notice	57	447						12434
1-8-85	Deed of Conveyance et al	Bredline, Stephen P. et al	Rel.	204	107						of 198-2555 257
1-8-85	Bredline, Stephen P. et al	Deed of Conveyance et al	Rel.	160	67						P.T.L. 14 259
1-8-85	Deed of Conveyance et al	Deed of Conveyance et al	Rel.	204	108						1357
4-24-85	Chicago Pacific Corp.	US Telecom, Inc.	Exec.	58	711						6162
6-13-85	Chicago Pacific Corp.	Sarpy R & R Co.	Ord. of Sale	160	467						(37.00) 9252
8-16-85	Jackson, Michael L.	Jankovich, William J.	W.D.	160	210						939
8-16-85	Jankovich, William J.	Crestline Financing, Inc.	Rel.	58	170						of 204-5745 979
8-16-85	Jankovich, William J.	Johnson, R. C. Trustee	Rel.	204	545						of 198-5744 1812
8-16-85	Crestline Financing, Inc.	Natl. Invest. Finance Auth.	Rel.	204	546						11818
9-5-85	Am. Charter Fed. Sav. & Inv.	Jackson, Michael L.	Rel.	204	597						
9-25-85	Jankovich, William J.	Johnson, R. C. Trustee	Rel.	204	604						

Numerical Land Index, Sarpy County, Nebraska

55

LOT NOS.	LOT NOS.	LOT NOS.	LOT NOS.
NE 1/4 NE 1/4	NE 1/4 NW 1/4	NE 1/4 SW 1/4	NE 1/4 SE 1/4
NW 1/4 NE 1/4	NW 1/4 NW 1/4	NW 1/4 SW 1/4	NW 1/4 SE 1/4
SW 1/4 NE 1/4	SW 1/4 NW 1/4	SW 1/4 SW 1/4	SW 1/4 SE 1/4
SE 1/4 NE 1/4	SE 1/4 NW 1/4	SE 1/4 SW 1/4	SE 1/4 SE 1/4

SEC. 16 TWP. 14 N. R. 13 E.

SARPY COUNTY
NEBRASKA

DATE	GRANTOR	GRANTEE	KIND OF INSTRUMENT	RECORD INSTRUMENT NUMBER	QUARTERS				ACRES	REMARKS
					N.E. QUARTER	N.W. QUARTER	S.W. QUARTER	S.E. QUARTER		
3-9-88	Brabee, Helen M.	Brabee, Helen M., et al.	W.D.	88-02668						of 1.60 898
3-24-88	Wetmy National Bank	Benson Co Services, Inc.	Rel	88-03576						of 196-6574
4-14-88	Potter Creek Farm Ltd.	Bank of the Midlands	Trust	88-04385						
6-6-88	Slesack, Arthur M. et al.	Metropolitan National Bank	Deed	88-07423						
6-6-88	Slenny, Charles R. et al.	Bank of Papillion	Deed	88-07446						
6-6-88	Slenny, Charles R. & wf.	Bank of Papillion	Deed	88-07447						
7-12-88	Rubenstein Development Co.	Heller Financial, Inc.	Deed	88-09474						
7-12-88	Rubenstein Development Co.	Heller Financial, Inc.	Deed	88-09475						
7-12-88	W. H. F. Inc.	Rubenstein Dev. Co.	UCC	88-09476						
7-13-88	Leach, Arthur M. et al.	Whom it may concern	Rel	88-09561						of 15-5
7-15-88	Jackson, Judy K.	Anderson, Carl F. et al.	W.D.	88-09611						Deed & Rel. E & S TL 098
7-26-88	Campbell, James L. et al.	First Nat. Bank of Omaha	Deed	88-10193						
7-26-88	Campbell, James L. & wf.	First Nat. Bank of Omaha	Deed	88-10194						deed of record 89-01957
7-26-88	Campbell, James L. & wf.	First Nat. Bank of Omaha	Deed	88-10195						
8-10-88	Heller Financial, Inc.	Fredrick, Keith L. Esq.	Deed	88-10557						no. 201-4855
8-10-88	Rubenstein Dev. Co.	Rubenstein Development Co.	UCC	88-10558						of 201-4855
8-10-88	Rubenstein Dev. Co.	Heller Financial, Inc.	U.C.C.	88-10559						JTL
8-11-88	Hilley, Violet L.	Anderson, Carl F. & Lisa M.	U.C.C.	88-11108						JTL
8-11-88	Leach, Carl A. & wf.	Heritage S&L Savings Bank	Rel	88-11109						JTL
8-15-88	Conit, Ed. & wf.	Prichy, Charles L. & wf.	Rel	88-11559						of 195-4481
8-29-88	Northwest Bank, N.A.	Prichy, Sharon L.	Rel	88-11929						of 201-4031
9-12-88	Dorton, Donald Ray & wf.	Anderson, Virgil D.	W.D.	88-12526						(8250) T.L. 'H'
9-12-88	Northwest Bank, N.A.	Dorton, Donald Ray & wf.	UCC	88-12527						of 204-7479
9-12-88	Anderson, Virgil D.	Dorton, Donald R. & wf.	Deed	88-12528						
9-12-88	Anderson, Virgil D.	Dorton, Donald R. & wf.	Deed	88-12529						
9-19-88	Fisher Mfg. Co.	Leach, Carl A. & wf.	Assign	88-12889						of 205-12006
10-7-88	St. Schyler State Bank	Countywide Land Corp.	Assign	88-14616						of 206-6664
10-19-88	Heim, Charles G.	Southwest Bank & Trust Co.	Deed	88-15078						
10-19-88	Heim, Charles G.	Southwest Bank & Trust Co.	Deed	88-15099						Deed of Record 89-12337
11-1-88	Heritage S&L Savings Bank	Creative Financing, Inc.	Assign	88-15888						of 88-11109
2-17-89	First Nat. Bank of Omaha	Campbell, James L. & wf.	Deed	89-01959						of 88-10194
4-7-89	Northwest Bank, N.A.	Bank of the Midlands	Deed	89-04674						
4-19-89	Conit, Ed. & wf.	Hernandez, Myrtha	Rel	89-04520						of 203-4330
6-14-89	Creative Financing, Inc.	Lidell, J. & wf.	Assign	89-07223						of 88-11109
7-26-89	Swaggell, Kenneth G. et al.	Packers Bank & Trust Co.	Deed	89-09460						TL 810B
7-26-89	Swaggell, Kenneth G. et al.	Packers Bank & Trust Co.	Deed	89-09461						TL 810B
9-13-89	Heim, Charles G.	Omaha Fed. Credit Union	Deed	89-12335						
9-13-89	Heim, Charles G.	Omaha Fed. Credit Union	Deed	89-12336						
9-13-89	Southwest Bank & Trust Co.	Heim, Charles G.	UCC	89-12337						of 88-15099
9-13-89	Southwest Bank & Trust Co.	Heim, Charles G.	UCC	89-12338						of 206-11600
9-22-89	Slenny, Charles L. et al.	Bank of Papillion	UCC	89-12840						TLS
9-22-89	Slenny, Charles L. & wf.	Bank of Papillion	Deed	89-12841						
9-28-89	Jay-Jak, Inc.	First Nat. Bank of Omaha	U.C.C.	89-13209						
10-11-89	Campbell, James L. & wf.	First Nat. Bank of Omaha	Deed	89-14000						
10-11-89	Campbell, James L. & wf.	First Nat. Bank of Omaha	Deed	89-14001						
10-16-89	Knapp, Bernard R. & wf.	Packers Bank & Trust Co.	Rel	89-14216						
10-16-89	Knapp, Bernard R. & wf.	Packers Bank & Trust Co.	Rel	89-14217						
12-5-89	Rubenstein Dev. Co.	Knapp, Bernard R. & wf.	UCC	89-16856						of 205-8775

User = OMATITLE

Search Type Lands # Records Found 229

Search Criteria =Sec 16 Tns 14 Rng 13 NW Quarter - Quarter of the NE Quarter
Images maybe DELAYED for viewing.

If the Image button says YES, but you get no image try again in a few hours.

Book Image Available

YES

Note: Loading may take a while because of file size.

NE NW SW SE

Instr #	Image?	Type	Filed Date	NE	NW	SW	SE	NE	NW	SW	SE	NE	NW	SW	SE	NE	NW	SW	SE	Lots	Remarks	
199208459	<input type="checkbox"/> YES	ACK	1992-05-01	*	P	*	*	*	*	*	*	*	*	*	*	*	*	*	*	*	B8A	
Grantor :VILIM LARRY A ETAL				Grantee :COMMERCIAL FED MTG CORP																		
199208460	<input type="checkbox"/> YES	DOT	1992-05-01	*	P	*	*	*	*	*	*	*	*	*	*	*	*	*	*	*	B8A	
Grantor :VILIM LARRY A & RIKKI R				Grantee :COMMERCIAL FED MTG CORP ETAL																		
199209528	<input type="checkbox"/> YES	REL	1992-05-15	*	P	*	*	*	*	*	*	*	*	*	*	*	*	*	*	*	B8A	OF 203-1743
Grantor :AMERICAN CHARTER FED S/L ASSN				Grantee :VILIM LARRY A ETAL																		
199214013	<input type="checkbox"/> YES	REL	1992-07-09	*	P	*	*	*	*	*	*	*	*	*	*	*	*	*	*	*	B8A	OF 194-2992
Grantor :AMERICAN CHARTER FED S/L ASSN				Grantee :VILIM LARRY A ETAL																		
199216168	<input type="checkbox"/> YES	WD	1992-08-10	*	P	*	*	*	*	*	*	*	*	*	*	*	*	*	*	*	B3A1A1	
Grantor :MITCHELL KENNETH E ETAL				Grantee :DIVER CARL W ETAL																		
199220114	<input type="checkbox"/> YES	LP	1992-09-22	*	P	*	*	*	*	*	*	*	*	*	*	*	*	*	*	*		<i>Bl</i> RE 204-6638
Grantor :INDIANA MTG CORP AUTHORITY				Grantee :BOKELMAN GORDON L																		
199228629	<input type="checkbox"/> YES	REPLY	1992-12-23	*	P	*	*	*	*	*	*	*	*	*	*	*	*	*	*	*		TAX LOTS B6A2B & B6A3
Grantor :METROPOLITAN UTILITIES DIST				Grantee :WHOM IT MAY CONCERN																		
199302429	<input type="checkbox"/> YES	WD	1993-02-05	*	P	*	*	*	*	*	*	*	*	*	*	*	*	*	*	*		TAX LOTS B6A1B, B6A2B, & B6A3
Grantor :BOKELMAN GORDON L				Grantee :ANDCO DESIGN BUILD INC																		

User = OMATITLE

Search Type Lands # Records Found 229

Search Criteria =Sec 16 Tns 14 Rng 13 NW Quarter - Quarter of the NE Quarter
Images maybe DELAYED for viewing.

If the Image button says YES, but you get no image try again in a few hours.

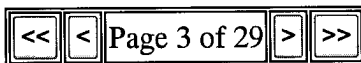

Book Image Available YES Note: Loading may take a while because of file size.

Instr #	Image?	Type	Filed Date	NE				NW				SW				SE				Lots	Remarks
				NE	NW	SW	SE	NE	NW	SW	SE	NE	NW	SW	SE	NE	NW	SW	SE		
<input type="checkbox"/> 199503290	<input type="checkbox"/> YES	NOS	1995-03-16	*	P	*	*	*	*	*	*	*	*	*	*	*	*	*	*	RE 204-6638	
Grantor :STERLING BANK & TRUST				Grantee :ANDCO DESIGN BUILD INC ETAL																	
<input type="checkbox"/> 199512042	<input type="checkbox"/> YES	CL	1995-07-31	*	P	*	*	*	*	*	*	*	*	*	*	*	*	*	*		
Grantor :EVERHART PAUL E				Grantee :ANDCO DESIGN ETAL																	
<input type="checkbox"/> 199602386	<input type="checkbox"/> YES	NOS	1996-02-09	*	P	*	*	*	*	*	*	*	*	*	*	*	*	*	*	RE 204-6638 B6A2B B6A1B B6A3	
Grantor :STERLING BANK & TRUST				Grantee :ANDCO DESIGN BUILD INC ETAL																	
<input type="checkbox"/> 199602836	<input type="checkbox"/> YES	DOT	1996-02-29	*	P	*	*	*	*	*	*	*	*	*	*	*	*	*	*	B6A5	
Grantor :WAGNER RAYMOND L ETAL				Grantee :EQUICREDIT CORP OF NE ETAL																	
<input type="checkbox"/> 199604105	<input type="checkbox"/> YES	REL	1996-03-05	*	P	*	*	*	*	*	*	*	*	*	*	*	*	*	*	TL OF 202-B6A5 5338	
Grantor :PACESETTER CORP				Grantee :WAGNER RAYMOND L ETAL																	
<input type="checkbox"/> 199605737	<input type="checkbox"/> YES	REL	1996-03-29	*	P	*	*	*	*	*	*	*	*	*	*	*	*	*	*	B6A5 OF 198-5086	
Grantor :COMMERCIAL FED BANK				Grantee :WHITAKER JERRY																	
<input type="checkbox"/> 199605911	<input type="checkbox"/> YES	WD	1996-04-01	*	P	*	*	*	*	*	*	*	*	*	*	*	*	*	*	PT TL B6A5	
Grantor :WAGNER RAYMOND L ETAL				Grantee :ARCHULETTA MICKAEL A ETAL																	
<input type="checkbox"/> 199605912	<input type="checkbox"/> YES	DOT	1996-04-01	*	P	*	*	*	*	*	*	*	*	*	*	*	*	*	*	PT B6A5	
Grantor :ARCHULETTA MICKAEL A ETAL				Grantee :FIRST MTG CORP ETAL																	

User = OMATITLE

Search Type Lands # Records Found 229

Search Criteria =Sec 16 Tns 14 Rng 13 NW Quarter - Quarter of the NE Quarter
Images maybe DELAYED for viewing.

If the Image button says YES, but you get no image try again in a few hours.

Book Image Available

YES

Note: Loading may take a while because of file size.

NE NW SW SE

Instr #	Image?	Type	Filed Date	NE	NW	SW	SE	NE	NW	SW	SE	NE	NW	SW	SE	Lots	Remarks
199606188	<input type="checkbox"/> YES	AM	1996-04-04	*	P	*	*	*	*	*	*	*	*	*	*	PT TLB6A5	OF 96-05912
Grantor :FIRST MTG CORP				Grantee :COMMERCIAL FED BANK													
199607856	<input type="checkbox"/> YES	DOR	1996-04-26	*	P	*	*	*	*	*	*	*	*	*	*	TL B10B	OF 94-12322
Grantor :NORWEST BANK TR				Grantee :SVAJGL KENNETH J JR ETAL													
199607859	<input type="checkbox"/> YES	DOT	1996-04-29	*	P	*	*	*	*	*	*	*	*	*	*	TL B10B	
Grantor :SVAJGL KENNETH ETAL				Grantee :NORWEST BANK ETAL													
199618958	<input type="checkbox"/> YES	DOR	1996-09-18	*	P	*	*	*	*	*	*	*	*	*	*	TLB6A5	OF 96-03836
Grantor :KIVETT MICHAEL E TR				Grantee :WAGNER RAYMOND L & CINDY L													
199624775	<input type="checkbox"/> YES	NOS	1996-12-09	*	P	*	*	*	*	*	*	*	*	*	*		RE 204-6638
Grantor :STERLING BANK & TRUST				Grantee :ANDCO DESIGN BUILD INC ETAL													
199711341	<input type="checkbox"/> YES	TD	1997-06-06	*	P	*	*	*	*	*	*	*	*	*	*		
Grantor :ANDCO DESIGN BUILD INC				Grantee :CHASE VERL A ETAL													
199712566	<input type="checkbox"/> YES	DOT	1997-06-20	*	P	*	*	*	*	*	*	*	*	*	*		B8A
Grantor :VILIM LARRY A ETAL				Grantee :FIRST NATL BANK OF OMAHA ETAL													
199722390	<input type="checkbox"/> YES	ST	1997-10-07	*	P	*	*	*	*	*	*	*	*	*	*		RE 97-11341 & 97-11342 EXC NO 5'
Grantor :CHASE VERL A ETAL				Grantee :JUNGERS DEAN J TR													

User = OMATITLE
 Search Type Lands # Records Found 229
 Search Criteria =Sec 16 Tns 14 Rng 13 NW Quarter - Quarter of the NE Quarter
 Images maybe DELAYED for viewing.
 If the Image button says YES, but you get no image try again in a few hours.

Book Image Available YES Note: Loading may take a while because of file size.
 NE NW SW SE

Instr #	Image?	Type	Filed Date	NE	NW	SW	SE	NE	NW	SW	SE	NE	NW	SW	SE	Lots	Remarks
<input type="checkbox"/> 199722392	<input type="checkbox"/> YES	NOD	1997-10-07	*	P	*	*	*	*	*	*	*	*	*	*	*	RE 97-11341 B6A2B B6A1B & B6A3
Grantor :JUNGERS DEAN J TR Grantee :WHOM IT MAY CONCERN ETAL																	
<input type="checkbox"/> 199727861	<input type="checkbox"/> YES	COD	1997-12-09	*	P	*	*	*	*	*	*	*	*	*	*	*	B6A6
Grantor :IN MATTER OF ESTATE Grantee :KOHLSCHEN PAMELA M																	
<input type="checkbox"/> 199729261	<input type="checkbox"/> YES	WD	1997-12-29	*	P	*	*	*	*	*	*	*	*	*	*	*	ESTATE OF JERRY J JAROS CO GUARDIANS
Grantor :FIELDS DELORES M ETAL Grantee :VANSCOY SHARON ETAL																	
<input type="checkbox"/> 199729262	<input type="checkbox"/> YES	COD	1997-12-29	*	P	*	*	*	*	*	*	*	*	*	*	*	TLB3B B3A2 B3A3
Grantor :IN MATTER OF ESTATE Grantee :JAROS HELENE																	
<input type="checkbox"/> 199729263	<input type="checkbox"/> YES	WD	1997-12-29	*	P	*	*	*	*	*	*	*	*	*	*	*	TLB3B B3A2 B3A3
Grantor :VANSCOY SHARON ETAL Grantee :KIRSCHNER STEVE P ETAL																	
<input type="checkbox"/> 199729264	<input type="checkbox"/> YES	DOT	1997-12-29	*	P	*	*	*	*	*	*	*	*	*	*	*	TL B3B B3A2 B3A3
Grantor :KIRSCHNER STEVEN P ETAL Grantee :VANSCOY SHARON ETAL																	
<input type="checkbox"/> 199800256	<input type="checkbox"/> YES	COD	1998-01-06	*	P	*	*	*	*	*	*	*	*	*	*	*	
Grantor :IN MATTER OF ESTATE Grantee :BOWEN DOROTHY M																	
<input type="checkbox"/> 199803129	<input type="checkbox"/> YES	SD	1998-02-12	*	P	*	*	*	*	*	*	*	*	*	*	*	TAX LOTS B6A2B B6A1B B6A3
Grantor :SHERIFF SARPY CTY Grantee :CISAR DAVID																	

User = OMATITLE

Search Type Lands # Records Found 229

Search Criteria =Sec 16 Tns 14 Rng 13 NW Quarter - Quarter of the NE Quarter
Images maybe DELAYED for viewing.

If the Image button says YES, but you get no image try again in a few hours.

Book Image Available

YES

Note: Loading may take a while because of file size.

NE NW SW SE

Instr #	Image?	Type	Filed Date	NE	NW	SW	SE	NE	NW	SW	SE	NE	NW	SW	SE	Lots	Remarks
199805955	<input type="checkbox"/> YES	DOR	1998-03-16	*	P	*	*	*	*	*	*	*	*	*	*	TL B8A	OF 97-12566
Grantor :FIRST NATL BANK OF OMAHA TR Grantee :VILIM LARRY A & RIKKI R																	
199808685	<input type="checkbox"/> YES	DOT	1998-04-09	*	P	*	*	*	*	*	*	*	*	*	*	TXLT B9B	
Grantor :LEWIS JAMES C ETAL Grantee :NORWEST BANK ETAL																	
199811563	<input type="checkbox"/> YES	WD	1998-05-07	*	P	*	*	*	*	*	*	*	*	*	*		B6
Grantor :CISAB DAVID Grantee :MILLEDGE GARY L ETAL																	
199811564	<input type="checkbox"/> YES	DOT	1998-05-07	*	P	*	*	*	*	*	*	*	*	*	*		
Grantor :MILLEDGE GARY L ETAL Grantee :CENTEX HOME EQUITY CORP ETAL																	
199811565	<input type="checkbox"/> YES	DOT	1998-05-07	*	P	*	*	*	*	*	*	*	*	*	*		
Grantor :MILLEDGE GARY L ETAL Grantee :MID AMERICA FINANCIAL INVEST CORP ETAL																	
199823030	<input type="checkbox"/> YES	WD	1998-08-19	*	P	*	*	*	*	*	*	*	*	*	*		UNDIVIDED 1/3 INTEREST
Grantor :PAVLIK DUANE M ETAL Grantee :LEE DANIEL C JR ETAL																	
199823031	<input type="checkbox"/> YES	WD	1998-08-19	*	P	*	*	*	*	*	*	*	*	*	*		ESTATE OF DONALD M PAVLIK UNDIVIDED 2/3 INTEREST
Grantor :PAVLIK DUANE M PER REP Grantee :LEE DANIEL C JR ETAL																	
199823032	<input type="checkbox"/> YES	DOT	1998-08-19	*	P	*	*	*	*	*	*	*	*	*	*		AKA DANIEL C LEE JR
Grantor :LEE DANIEL C ETAL Grantee :U S BANK NATL ASSN ETAL																	

User = OMATITLE

Search Type Lands # Records Found 229

Search Criteria =Sec 16 Tns 14 Rng 13 NW Quarter - Quarter of the NE Quarter
Images maybe DELAYED for viewing.

If the Image button says YES, but you get no image try again in a few hours.

Book Image Available YES Note: Loading may take a while because of file size.

Instr #	Image?	Type	Filed Date	NE				NW				SW				SE				Lots	Remarks
				NE	NW	SW	SE	NE	NW	SW	SE	NE	NW	SW	SE	NE	NW	SW	SE		
<input type="checkbox"/> 199827243	<input type="checkbox"/> YES	MTG	1998-09-28	*	P	*	*	*	*	*	*	*	*	*	*	*	*	*	TXLT B8A		
Grantor :VILIM LARRY A ETAL Grantee :COMMERCIAL FED BANK																					
<input type="checkbox"/> 199828143	<input type="checkbox"/> YES	DOT	1998-10-05	*	P	*	*	*	*	*	*	*	*	*	*	*	*	*	B4		
Grantor :LEE DANIEL C ETAL Grantee :U S BANK NATL ASSN ETAL																					
<input type="checkbox"/> 199832059	<input type="checkbox"/> YES	DOR	1998-11-19	*	P	*	*	*	*	*	*	*	*	*	*	*	*	*	B10B OF 89-09461		
Grantor :NORWEST BANK TR Grantee :SVAJGL KENNETH J ETAL																					
<input type="checkbox"/> 199900385	<input type="checkbox"/> YES	DOT	1999-01-06	*	P	*	*	*	*	*	*	*	*	*	*	*	*	*	B10B		
Grantor :SVAJGL KENNETH J JR ETAL Grantee :COMMERCIAL CREDIT CORP ETAL																					
<input type="checkbox"/> 199904573	<input type="checkbox"/> YES	DOT	1999-02-16	*	P	*	*	*	*	*	*	*	*	*	*	*	*	*	TXLTS B3B B3A2 & B3A3		
Grantor :KIRSCHNER STEVE P ETAL Grantee :COMMONWEALTH UNITED MTG CO ETAL																					
<input type="checkbox"/> 199905024	<input type="checkbox"/> YES	DOT	1999-02-19	*	P	*	*	*	*	*	*	*	*	*	*	*	*	*	TL B8A		
Grantor :VILIM LARRY A ETAL Grantee :COMMERCIAL FED MTG CORP ETAL																					
<input type="checkbox"/> 199906170	<input type="checkbox"/> YES	DED	1999-03-03	*	P	*	*	*	*	*	*	*	*	*	*	*	*	*	CORR SW TO NW IN NE 1/4 3-4-99 LAL		
Grantor :PENDROCK KAREN Grantee :WHOM IT MAY CONCERN																					
<input type="checkbox"/> 199906171	<input type="checkbox"/> YES	WD	1999-03-03	*	P	*	*	*	*	*	*	*	*	*	*	*	*	*	CORR FROM SW TO NW OF NE 1/4 3-4-99 LAL		
Grantor :PENDROCK KAREN PER REP Grantee :BELLEVUE CITY OF																					

User = OMATITLE

Search Type Lands # Records Found 229

Search Criteria =Sec 16 Tns 14 Rng 13 NW Quarter - Quarter of the NE Quarter
Images maybe DELAYED for viewing.

If the Image button says YES, but you get no image try again in a few hours.

Book Image Available YES Note: Loading may take a while because of file size.

Instr #	Image?	Type	Filed Date	NE				NW				SW				SE				Lots	Remarks
				NE	NW	SW	SE	NE	NW	SW	SE	NE	NW	SW	SE	NE	NW	SW	SE		
<input type="text" value="199906172"/>	<input type="checkbox"/> YES	PLAT	1999-03-03	*	P	*	*	*	*	*	*	*	*	*	*	*	*	*		PT NE 1/4 16-14-13 NKA HAFOHUADII LTS 1-6	
Grantor :PENDROCK KAREN PER REP Grantee :WHOM IT MAY CONCERN																					
<input type="text" value="199912316"/>	<input type="checkbox"/> YES	DOR	1999-04-26	*	P	*	*	*	*	*	*	*	*	*	*	*	*	*	TL B8A	OF 92-08460	
Grantor :COMMERCIAL FED BANK TR Grantee :VILIM LARRY A ETAL																					
<input type="text" value="199916868"/>	<input type="checkbox"/> YES	DOT	1999-05-28	*	P	*	*	*	*	*	*	*	*	*	*	*	*	*	TL B4		
Grantor :LEE DANIEL C JR ETAL Grantee :AMERICAS WHOLESALE LENDER ETAL																					
<input type="text" value="199919123"/>	<input type="checkbox"/> YES	DOR	1999-06-17	*	P	*	*	*	*	*	*	*	*	*	*	*	*	*		OF 98-23032	
Grantor :U S BANK NATL ASSN TR Grantee :LEE DANIEL C ETAL																					
<input type="text" value="199919754"/>	<input type="checkbox"/> YES	DOR	1999-06-22	*	P	*	*	*	*	*	*	*	*	*	*	*	*	*	B10B	OF 99-00385	
Grantor :KIVETT MICHAEL F TR Grantee :SVAJGL KENNETH J JR ETAL																					
<input type="text" value="199919821"/>	<input type="checkbox"/> YES	DOT	1999-06-22	*	P	*	*	*	*	*	*	*	*	*	*	*	*	*	B10B		
Grantor :SVAJGL KENNETH J JR ETAL Grantee :COMMERCIAL CREDIT CORP ETAL																					
<input type="text" value="199920748"/>	<input type="checkbox"/> YES	DOR	1999-06-30	*	P	*	*	*	*	*	*	*	*	*	*	*	*	*	B9B	OF 98-08685	
Grantor :NORWEST BANK TR Grantee :LEWIS JAMES C ETAL																					
<input type="text" value="199920752"/>	<input type="checkbox"/> YES	DOT	1999-06-30	*	P	*	*	*	*	*	*	*	*	*	*	*	*	*	B9B		
Grantor :LEWIS JAMES C ETAL Grantee :NORWEST BANK ETAL																					