

94-01010

ORDINANCE RECORD

No. 728-REDFIELD & COMPANY INC., OMAHA

ORDINANCE NO. 2263

AN ORDINANCE TO ANNEX TO THE CITY OF BELLEVUE, SARPY COUNTY, NEBRASKA, CERTAIN LANDS, LOTS, AND REAL ESTATE LYING WITHIN THE BELOW DESCRIBED BOUNDARIES, TO THE CITY OF BELLEVUE, SARPY COUNTY, NEBRASKA, AND DESIGNATING AN EFFECTIVE DATE.

WHEREAS, ALL OF THE LOTS, LANDS, AND REAL ESTATE LYING WITHIN THE BOUNDARIES DESCRIBED AS FOLLOWS, TO WIT:

GRANADA, SID #83

A tract of land located in the northwest Quarter of Section 4, Township 13 North, Range 13 East of the sixth P.M., Sarpy County, Nebraska, and being more particularly described as follows:

Beginning at a point on the North line of Section 4, Township 13 North, Range 13 East, said point also being on the East right-of-way line of 36th Street. Thence, Easterly along the North line of said Section 4, 1441.19 feet, more or less, to the Northwest corner of Tax Lot 12. Thence Southerly along the West line of Tax Lot 12, 1327.61 feet to the Southwest corner of Tax Lot 12, said point also being on the South line of the North half of the Northwest Quarter of said Section 4. Thence Westerly along the South line of the North half of the Northwest Quarter of said Section 4 to the East right-of-way line of 36th Street. Thence, Northerly along the East right-of-way line of 36th Street, 1327.61 feet to the point of beginning.

ARE CONTIGUOUS AND ADJACENT TO THE CITY OF BELLEVUE, NEBRASKA, AND ARE URBAN OR SUBURBAN IN CHARACTER, AND

WHEREAS, SAID REAL ESTATE WILL RECEIVE MATERIAL BENEFITS AND ADVANTAGES FROM ANNEXATION TO THE SAID CITY.

NOW, THEREFORE, BE IT ORDAINED BY THE MAYOR AND CITY COUNCIL OF THE CITY OF BELLEVUE, NEBRASKA:

Section 1. All of the real estate lying within the area heretofore described be and the same hereby is included within the boundaries and territory of the City of Bellevue, Nebraska, and said lands and the persons residing thereon shall hereafter be subject to all of the rules, regulations, ordinances, taxes, and all other burdens and benefits of other persons and territory included within the City of

ch4
Cob
C07672

94 01012A

ORDINANCE RECORD

No. 728-REDFIELD & COMPANY INC., OMAHA

Bellevue, Nebraska.

Section 2. This Ordinance shall take effect and be in full force and effect on and after August 30, 1983, and after its passage, approval and publication according to law.

Passed and approved this 25th day of July, 1983.

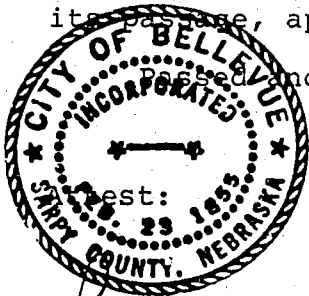

Joseph H. Baldwin
Mayor

Dewey Hardy
City Clerk

First reading: June 27, 1983
Second reading: July 11, 1983
Third reading: July 25, 1983

Proof	<u>C & M</u>
D.E.	<u>S</u>
Verify	<u>S</u>
Filmed	<u> </u>
Checked	<u> </u>
Fee \$	<u>39.00</u>

INSTRUMENT NUMBER
94-607672

94 APR -5 PM 3:03

Carol A. Glavin
REGISTER OF DEEDS



GLAS A. CLARK, R.S.
Environmental Health Scientist
DIVISION OF HOUSING AND
ENVIRONMENTAL HEALTH

402 471-2541
301 Centennial Mall South
P.O. Box 95007
Lincoln, Nebraska 68509

94-07672B

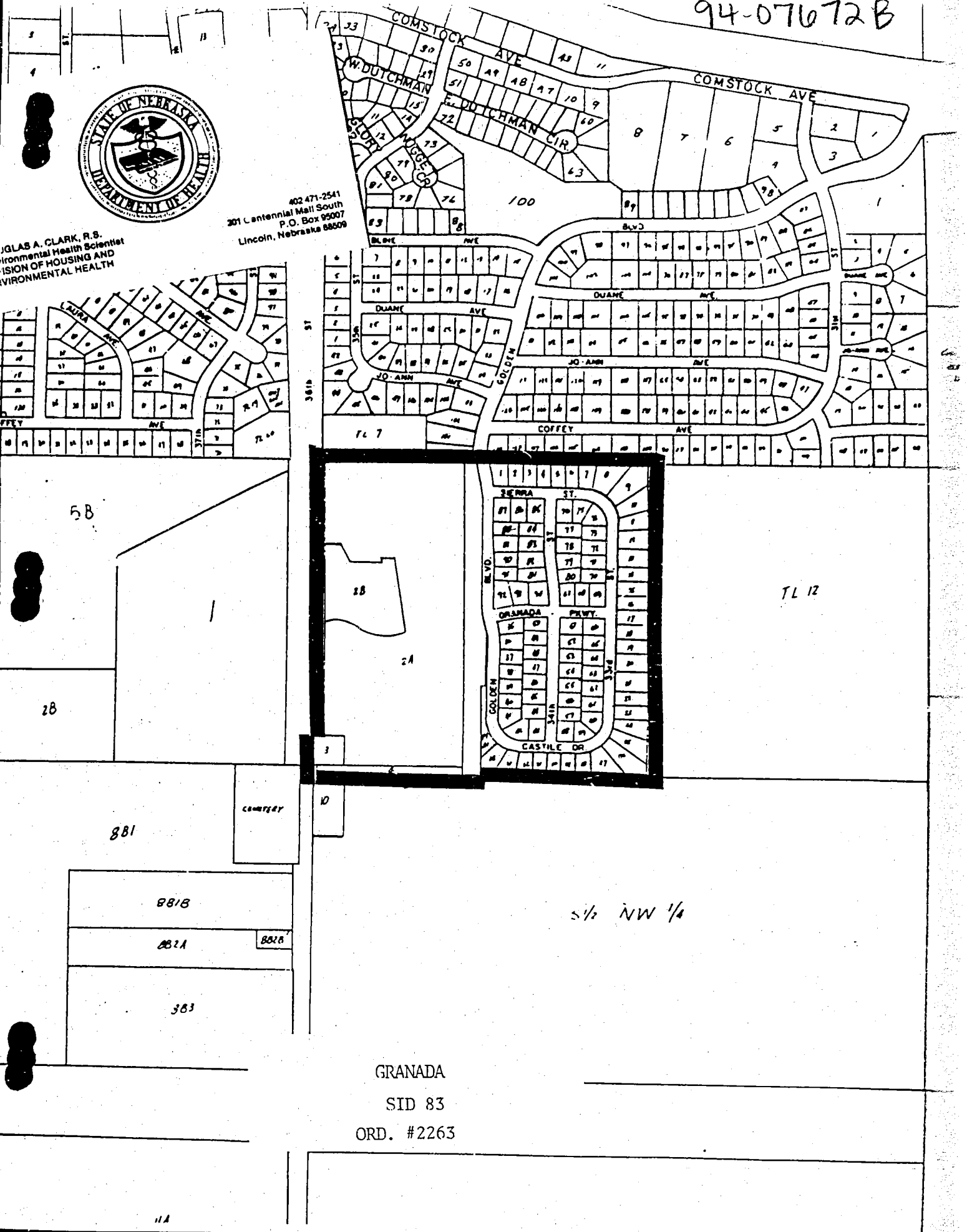

GRANADA
SID 83
ORD. #2263