

check your lot
show see pages 116. of Doc. 109, 110 +

BEFORE THE COUNTY JUDGE OF DOUGLAS COUNTY, NEBRASKA

939 PAGE 99

STATE OF NEBRASKA
DEPARTMENT OF ROADS,

Condemner,

v.

FATHER FLANAGAN'S BOYS' HOME, A
Nebraska Corporation, Owner;

Condemnees.

Docket C6 Page 53 Case _____

RETURN OF
APPRAISERS

TO THE COUNTY JUDGE OF DOUGLAS COUNTY, NEBRASKA.

We, the undersigned appraisers, do hereby certify that under and by virtue of an "Appointment of Appraisers" duly served upon us by R. Newsum, Sheriff or Deputy Sheriff of Douglas County, Nebraska, on the 23rd day of July, 1990, and after having taken and filed the "Oath of Appraisers" that we did carefully inspect and view the property described herein, sought to be appropriated by the State of Nebraska, Department of Roads, and also other property of the condemnees alleged damaged thereby and did hear all parties interested therein in reference to the amount of damages sustained while we were so inspecting and viewing the property herein described and thereafter did assess the damages that the condemnees have sustained or will sustain by such appropriation of the property herein described for State highway purposes and also damage to such other property of the condemnees as in our opinion, was damaged by the appropriation of the property herein described:

23-15-1117
BK 939 N 24-15-1117 90 FEB 156 50
99-729 N 13-15-1117 DEL VK MC
24 Misc COMP Q F/B 616600

RECEIVED
SEP 25 8 53 AM '90
REGISTER OF DEEDS
DOUGLAS COUNTY, NE

miss 17672

PROJECT: E-QF-6-7 (134) C.N.: 21212 DOUGLAS COUNTY TRACT 15
(PAGE 1)
OF 13

CONDEMNATION

BOOK 939 PAGE 100

OWNER: FATHER FLANAGAN'S BOYS' HOME, A NEBRASKA CORPORATION

FEE SIMPLE TITLE TO A TRACT OF LAND AND ALL IMPROVEMENTS THEREON, IF ANY, FOR HIGHWAY RIGHT OF WAY PURPOSES LOCATED IN THE NORTHEAST QUARTER OF SECTION 23, TOWNSHIP 15 NORTH, RANGE 11 EAST OF THE SIXTH PRINCIPAL MERIDIAN, DOUGLAS COUNTY, NEBRASKA, AS ILLUSTRATED ON THE ATTACHED PLAT AND BEING MORE PARTICULARLY DESCRIBED AS FOLLOWS:

BEGINNING AT THE NORTHEAST CORNER OF SAID QUARTER SECTION; THENCE WESTERLY A DISTANCE OF 2652.55 FEET TO THE NORTHWEST CORNER OF SAID QUARTER SECTION; THENCE SOUTHERLY DEFLECTING 090 DEGREES, 05 MINUTES, 12 SECONDS LEFT, A DISTANCE OF 545.00 FEET ALONG THE WEST LINE OF SAID QUARTER SECTION; THENCE NORTHEASTERLY DEFLECTING 124 DEGREES, 00 MINUTES, 35 SECONDS LEFT, A DISTANCE OF 713.54 FEET; THENCE EASTERLY DEFLECTING 027 DEGREES, 34 MINUTES, 36 SECONDS RIGHT, A DISTANCE OF 352.28 FEET; THENCE EASTERLY DEFLECTING 006 DEGREES, 31 MINUTES, 11 SECONDS RIGHT, A DISTANCE OF 400.00 FEET; THENCE EASTERLY DEFLECTING 005 DEGREES, 42 MINUTES, 38 SECONDS RIGHT, A DISTANCE OF 1004.99 FEET; THENCE SOUTHEASTERLY DEFLECTING 020 DEGREES, 51 MINUTES, 16 SECONDS RIGHT, A DISTANCE OF 212.43 FEET; THENCE SOUTHEASTERLY DEFLECTING 030 DEGREES, 09 MINUTES, 26 SECONDS RIGHT, A DISTANCE OF 83.75 FEET; THENCE SOUTHERLY DEFLECTING 033 DEGREES, 15 MINUTES, 40 SECONDS RIGHT, A DISTANCE OF 780.00 FEET; THENCE SOUTHERLY DEFLECTING 009 DEGREES, 27 MINUTES, 44 SECONDS RIGHT, A DISTANCE OF 91.24 FEET; THENCE SOUTHERLY DEFLECTING 008 DEGREES, 50 MINUTES, 22 SECONDS LEFT, A DISTANCE OF 460.03 FEET; THENCE SOUTHERLY DEFLECTING 010 DEGREES, 40 MINUTES, 05 SECONDS LEFT, A DISTANCE OF 355.45 FEET TO A POINT ON THE WESTERLY 144TH STREET RIGHT OF WAY LINE; THENCE EASTERLY DEFLECTING 079 DEGREES, 57 MINUTES, 17 SECONDS LEFT, A DISTANCE OF 33.00 FEET TO A POINT ON THE EAST LINE OF SAID QUARTER SECTION; THENCE NORTHERLY DEFLECTING 090 DEGREES, 00 MINUTES, 00 SECONDS LEFT, A DISTANCE OF 2050.00 FEET ALONG SAID LINE TO THE POINT OF BEGINNING CONTAINING 15.31 ACRES, MORE OR LESS, WHICH INCLUDES 5.16 ACRES, MORE OR LESS PREVIOUSLY OCCUPIED AS PUBLIC HIGHWAY.

THERE WILL BE NO INGRESS OR EGRESS OVER THE FOLLOWING DESCRIBED CONTROLLED ACCESS LINE LOCATED IN THE NORTHEAST QUARTER OF SECTION 23, TOWNSHIP 15 NORTH, RANGE 11 EAST OF THE SIXTH PRINCIPAL MERIDIAN, DOUGLAS COUNTY, NEBRASKA:

REFERRING TO THE NORTHEAST CORNER OF SAID QUARTER SECTION; THENCE WESTERLY A DISTANCE OF 2652.53 FEET TO THE NORTHWEST CORNER OF SAID QUARTER SECTION; THENCE SOUTHERLY DEFLECTING 090 DEGREES, 05 MINUTES, 12 SECONDS LEFT, A DISTANCE OF 545.00 FEET ALONG THE WEST LINE OF SAID QUARTER SECTION TO THE POINT OF BEGINNING; THENCE NORTHEASTERLY DEFLECTING 124 DEGREES, 00 MINUTES, 35 SECONDS LEFT, A DISTANCE OF 713.54 FEET; THENCE EASTERLY DEFLECTING 027 DEGREES, 34 MINUTES, 36 SECONDS RIGHT, A DISTANCE OF 352.28 FEET; THENCE EASTERLY DEFLECTING 006 DEGREES, 31 MINUTES, 11 SECONDS RIGHT, A DISTANCE OF 400.00 FEET; THENCE EASTERLY DEFLECTING 005 DEGREES, 42 MINUTES, 38 SECONDS RIGHT, A DISTANCE OF 1004.99 FEET; THENCE SOUTHEASTERLY DEFLECTING 020 DEGREES, 51 MINUTES, 16 SECONDS RIGHT, A DISTANCE OF 212.43 FEET; THENCE SOUTHEASTERLY DEFLECTING 030 DEGREES, 09 MINUTES, 26 SECONDS RIGHT, A DISTANCE OF 83.75 FEET; THENCE SOUTHERLY DEFLECTING 033 DEGREES, 15 MINUTES, 40 SECONDS RIGHT, A DISTANCE OF 780.00 FEET; THENCE SOUTHERLY DEFLECTING 009 DEGREES, 27 MINUTES, 44 SECONDS RIGHT, A DISTANCE OF 91.24 FEET; THENCE SOUTHERLY DEFLECTING 008 DEGREES, 50 MINUTES, 22 SECONDS LEFT, A DISTANCE OF 60.00 FEET TO THE POINT OF TERMINATION; EXCEPT OVER ONE UNRESTRICTED ACCESS NOT TO EXCEED 40 FEET IN WIDTH, LOCATED ON A EXTENDED LINE OF THE CENTERLINE OF RELOCATED 150TH STREET FOR INGRESS OR EGRESS TO 150TH STREET AND WYCLIFFE DRIVE EXCEPT, OVER ONE UNRESTRICTED ACCESS(ES) NOT TO EXCEED 40 FEET IN WIDTH, THE CENTERLINE(S) OF WHICH (IS, ARE) LOCATED 465.00 FEET FROM THE NORTH LINE OF QUARTER SECTION AS MEASURED ALONG THE CENTERLINE OF 144TH STREET. EXCEPT, OVER ONE RESTRICTED ACCESS(ES). SUCH ACCESS IS TO BE PERMITTED ONLY IF IT DOES NOT EXCEED 40 FEET IN WIDTH, AND ONLY SO LONG AS TRAFFIC UPON SUCH ACCESS(ES) DOES NOT EXCEED 10 VEHICLE MOVEMENTS PER HOUR AS DETERMINED BY THE DEPARTMENT OF ROADS IN ACCORDANCE WITH THE PROCEDURES INDICATED BELOW. THE CENTERLINE(S) OF THE ACCESS(ES) (IS, ARE) LOCATED 1027.00 FEET FROM THE NORTH LINE OF SAID QUARTER SECTION AS MEASURED ALONG THE CENTERLINE OF 144TH STREET.

FOR THE PURPOSE OF THIS INSTRUMENT, THE 10 VEHICLE MOVEMENTS PER HOUR WILL BE MEASURED AND DETERMINED BY THE FOLLOWING PROCEDURE: UPON ITS OWN DETERMINATION OR WHENEVER TRAFFIC CONGESTION OCCURS AT A RESTRICTED ACCESS, THE DEPARTMENT MAY MAKE A TRAFFIC COUNT, SUCH COUNT TO BE FOR A MINIMUM 8-HOUR PERIOD DURING THE HOURS OF 7 AM TO 9 AM, 10 AM TO 1 PM, 3 PM TO 6 PM, AND, IN ADDITION, FOR ANY OTHER PEAK HOURS PECULIAR TO THE HIGHWAY. THE AVERAGE HOURLY TRAFFIC WILL BE DETERMINED BY DIVIDING THE TOTAL NUMBER OF VEHICLE MOVEMENTS RECORDED DURING THE TIME PERIODS BY THE LENGTH OF THE TIME PERIODS IN HOURS. IN THE EVENT ANY OF THE PEAK HOUR VEHICLE COUNTS EXCEEDS THE AVERAGE BY A FACTOR OF 1.5, THE HIGHER FIGURE MAY BE USED TO DETERMINE THE NUMBER OF VEHICLE MOVEMENTS FOR THE ACCESS POINT.

PROVIDED THAT SHOULD THE CONDEMNEE(S) OR HIS SUCCESSORS IN TITLE FAIL AND REFUSE TO KEEP OR PERFORM THE PROVISIONS LIMITING TRAFFIC IN SUCH ACCESS TO 10 VEHICLE MOVEMENTS PER HOUR, BY EXCEEDING THIS AMOUNT ON FIVE OR MORE SEPARATE OCCASIONS WITHIN A CONTINUOUS 90 DAY PERIOD, HE, OR HIS SUCCESSORS IN TITLE, WILL BE CONSIDERED IN VIOLATION OF THE TERMS OF THIS INSTRUMENT AND SUBJECT TO APPROPRIATE PROCEEDINGS AT LAW

OR IN EQUITY FOR ITS ENFORCEMENT.

ALL RIGHTS TO OIL AND GAS MINERALS IN OR ON THE ABOVE DESCRIBED REAL PROPERTY, SHALL BE RETAINED AND RESERVED TO THE CONDEMNEE AND TO ITS SUCCESSORS AND ASSIGNS. SAID CONDEMNEE AND/OR ITS SUCCESSORS AND ASSIGNS SHALL HAVE NO RIGHT TO ENTER OR USE THE SURFACE OF SAID REAL PROPERTY FOR ANY PURPOSE CONCERNING SAID OIL AND GAS MINERAL RIGHTS, NOR SHALL THE CONDEMNEE AND/OR ITS SUCCESSORS AND ASSIGNS IN EXTRACTING SAID OIL AND GAS MINERALS FROM SAID REAL PROPERTY, DAMAGE OR IN ANY WAY IMPAIR THE USE OF SAID REAL PROPERTY.

AND ALSO, TEMPORARY EASEMENT TO A TRACT OF LAND AND ALL IMPROVEMENTS THEREON, IF ANY, FOR BUILDING REMOVAL PURPOSES, LOCATED IN THE NORTHEAST QUARTER OF SECTION 23, TOWNSHIP 15 NORTH, RANGE 11 EAST OF THE SIXTH PRINCIPAL MERIDIAN, DOUGLAS COUNTY, NEBRASKA, AS ILLUSTRATED ON THE ATTACHED PLAT AND BEING MORE PARTICULARLY DESCRIBED AS FOLLOWS:

REFERRING TO THE NORTHEAST CORNER OF SAID QUARTER SECTION; THENCE SOUTHERLY A DISTANCE OF 880.00 FEET ALONG THE EAST LINE OF SAID QUARTER SECTION; THENCE WESTERLY DEFLECTING 090 DEGREES, 00 MINUTES, 00 SECONDS RIGHT, A DISTANCE OF 75.00 FEET TO THE POINT OF BEGINNING; THENCE WESTERLY DEFLECTING 000 DEGREES, 00 MINUTES, 00 SECONDS A DISTANCE OF 80.00 FEET; THENCE SOUTHERLY DEFLECTING 090 DEGREES, 00 MINUTES, 00 SECONDS LEFT, A DISTANCE OF 90.00 FEET; THENCE EASTERLY DEFLECTING 090 DEGREES, 00 MINUTES, 00 SECONDS LEFT, A DISTANCE OF 80.00 FEET; THENCE NORTHERLY DEFLECTING 090 DEGREES, 00 MINUTES, 00 SECONDS LEFT, A DISTANCE OF 90.00 FEET TO THE POINT OF BEGINNING CONTAINING 0.17 ACRES, MORE OR LESS.

AND ALSO, TEMPORARY EASEMENT TO A TRACT OF LAND AND ALL IMPROVEMENTS THEREON, IF ANY, FOR DRIVE PURPOSES, LOCATED IN THE NORTHEAST QUARTER OF SECTION 23, TOWNSHIP 15 NORTH, RANGE 11 EAST OF THE SIXTH PRINCIPAL MERIDIAN, DOUGLAS COUNTY, NEBRASKA, AS ILLUSTRATED ON THE ATTACHED PLAT AND BEING MORE PARTICULARLY DESCRIBED AS FOLLOWS:

REFERRING TO THE NORTHEAST CORNER OF SAID QUARTER SECTION; THENCE SOUTHERLY A DISTANCE OF 1300.00 FEET ALONG THE EAST LINE OF SAID QUARTER SECTION; THENCE WESTERLY DEFLECTING 090 DEGREES, 00 MINUTES, 00 SECONDS RIGHT, A DISTANCE OF 90.65 FEET TO THE POINT OF BEGINNING; THENCE WESTERLY DEFLECTING 000 DEGREES, 00 MINUTES, 00 SECONDS A DISTANCE OF 109.35 FEET; THENCE SOUTHERLY DEFLECTING 090 DEGREES, 00 MINUTES, 00 SECONDS LEFT, A DISTANCE OF 100.00 FEET; THENCE EASTERLY DEFLECTING 090 DEGREES, 00 MINUTES, 00 SECONDS LEFT, A DISTANCE OF 108.26 FEET; THENCE NORTHERLY DEFLECTING 089 DEGREES, 22 MINUTES, 38 SECONDS LEFT, A DISTANCE OF 100.01 FEET TO THE POINT OF BEGINNING CONTAINING 0.25 ACRES, MORE OR LESS.

AND ALSO, TEMPORARY EASEMENT TO A TRACT OF LAND AND ALL IMPROVEMENTS THEREON, IF ANY, FOR SHAPING PURPOSES, LOCATED IN THE NORTHEAST QUARTER OF SECTION 23, TOWNSHIP 15 NORTH, RANGE 11 EAST OF THE SIXTH

BOOK 939 PAGE 103

PRINCIPAL MERIDIAN, DOUGLAS COUNTY, NEBRASKA, AS ILLUSTRATED ON THE ATTACHED PLAT AND BEING MORE PARTICULARLY DESCRIBED AS FOLLOWS:

REFERRING TO THE NORTHEAST CORNER OF SAID QUARTER SECTION; THENCE SOUTHERLY A DISTANCE OF 2100.00 FEET ALONG THE EAST LINE OF SAID QUARTER SECTION; THENCE WESTERLY DEFLECTING 090 DEGREES, 00 MINUTES, 00 SECONDS RIGHT, A DISTANCE OF 33.00 FEET TO THE POINT OF BEGINNING; THENCE WESTERLY DEFLECTING 000 DEGREES, 00 MINUTES, 00 SECONDS A DISTANCE OF 12.00 FEET; THENCE NORTHERLY DEFLECTING 080 DEGREES, 32 MINUTES, 16 SECONDS RIGHT, A DISTANCE OF 304.14 FEET; THENCE NORTHERLY DEFLECTING 009 DEGREES, 27 MINUTES, 44 SECONDS RIGHT, A DISTANCE OF 100.00 FEET; THENCE SOUTHERLY DEFLECTING 169 DEGREES, 57 MINUTES, 17 SECONDS RIGHT, A DISTANCE OF 355.45 FEET; THENCE SOUTHERLY DEFLECTING 010 DEGREES, 02 MINUTES, 43 SECONDS RIGHT, A DISTANCE OF 50.00 FEET TO THE POINT OF BEGINNING CONTAINING 0.15 ACRES, MORE OR LESS.

THE EASEMENT AREA(S) MAY BE USED FOR THE TEMPORARY RELOCATION OF UTILITIES DURING THE CONSTRUCTION OF THE PROJECT. UPON COMPLETION AND ACCEPTANCE OF PROJECT F-6-7 (1029), ALL RIGHTS, INTEREST AND USE OF THE ABOVE DESCRIBED TEMPORARY EASEMENT AREA(S) SHALL BE RETURNED TO THE CONDEMNEE(S) AND TO HIS, HER OR THEIR HEIRS, SUCCESSORS AND ASSIGNS WITH THE AFORESAID CHANGES COMPLETED.

AND ALSO;

FEE SIMPLE TITLE TO A TRACT OF LAND AND ALL IMPROVEMENTS THEREON, IF ANY, FOR HIGHWAY RIGHT OF WAY PURPOSES LOCATED IN THE NORTHWEST QUARTER OF SECTION 24, TOWNSHIP 15 NORTH, RANGE 11 EAST OF THE SIXTH PRINCIPAL MERIDIAN, DOUGLAS COUNTY, NEBRASKA, AS ILLUSTRATED ON THE ATTACHED PLAT AND BEING MORE PARTICULARLY DESCRIBED AS FOLLOWS:

BEGINNING AT THE NORTHWEST CORNER OF SAID QUARTER SECTION; THENCE EASTERLY A DISTANCE OF 2634.67 FEET TO THE NORTHEAST CORNER OF SAID QUARTER SECTION; THENCE SOUTHERLY DEFLECTING 089 DEGREES, 47 MINUTES, 07 SECONDS RIGHT, A DISTANCE OF 120.00 FEET ALONG THE EAST LINE OF SAID QUARTER SECTION; THENCE WESTERLY DEFLECTING 093 DEGREES, 48 MINUTES, 29 SECONDS RIGHT, A DISTANCE OF 797.81 FEET; THENCE WESTERLY DEFLECTING 003 DEGREES, 35 MINUTES, 35 SECONDS LEFT, A DISTANCE OF 250.00 FEET; THENCE WESTERLY DEFLECTING 006 DEGREES, 18 MINUTES, 22 SECONDS LEFT, A DISTANCE OF 601.50 FEET; THENCE WESTERLY DEFLECTING 008 DEGREES, 46 MINUTES, 48 SECONDS RIGHT, A DISTANCE OF 346.54 FEET; THENCE SOUTHWESTERLY DEFLECTING 027 DEGREES, 58 MINUTES, 34 SECONDS LEFT, A DISTANCE OF 391.23 FEET; THENCE WESTERLY DEFLECTING 005 DEGREES, 09 MINUTES, 06 SECONDS RIGHT, A DISTANCE OF 186.29 FEET; THENCE SOUTHERLY DEFLECTING 061 DEGREES, 13 MINUTES, 48 SECONDS LEFT, A DISTANCE OF 197.29 FEET; THENCE SOUTHERLY DEFLECTING 005 DEGREES, 57 MINUTES, 12 SECONDS LEFT, A DISTANCE OF 410.49 FEET; THENCE SOUTHERLY DEFLECTING 002 DEGREES, 18 MINUTES, 55 SECONDS LEFT, A DISTANCE OF 240.01 FEET; THENCE SOUTHERLY DEFLECTING 000 DEGREES, 28 MINUTES, 39

SECONDS LEFT, A DISTANCE OF 200.00 FEET; THENCE SOUTHERLY DEFLECTING 004 DEGREES, 53 MINUTES, 57 SECONDS RIGHT, A DISTANCE OF 351.28 FEET TO A POINT ON THE EASTERLY 144TH STREET RIGHT OF WAY LINE; THENCE WESTERLY DEFLECTING 085 DEGREES, 06 MINUTES, 03 SECONDS RIGHT, A DISTANCE OF 33.00 FEET TO A POINT ON THE WEST LINE OF SAID QUARTER SECTION; THENCE NORTHERLY DEFLECTING 090 DEGREES, 00 MINUTES, 00 SECONDS RIGHT, A DISTANCE OF 1750.00 FEET ALONG SAID LINE TO THE POINT OF BEGINNING CONTAINING 10.65 ACRES, MORE OR LESS, WHICH INCLUDES 4.90 ACRES, MORE OR LESS PREVIOUSLY OCCUPIED AS PUBLIC HIGHWAY.

THERE WILL BE NO INGRESS OR EGRESS OVER THE FOLLOWING DESCRIBED CONTROLLED ACCESS LINE LOCATED IN THE NORTHWEST QUARTER OF SECTION 24, TOWNSHIP 15 NORTH, RANGE 11 EAST OF THE SIXTH PRINCIPAL MERIDIAN, DOUGLAS COUNTY, NEBRASKA:

REFERRING TO THE NORTHWEST CORNER OF SAID QUARTER SECTION; THENCE EASTERLY A DISTANCE OF 2674.67 FEET TO THE NORTHEAST CORNER OF SAID QUARTER SECTION; THENCE SOUTHERLY DEFLECTING 089 DEGREES, 47 MINUTES, 07 SECONDS RIGHT, A DISTANCE OF 240.00 FEET ALONG THE EAST LINE OF SAID QUARTER SECTION TO THE POINT OF BEGINNING; THENCE SOUTHWESTERLY DEFLECTING 058 DEGREES, 08 MINUTES, 20 SECONDS RIGHT, A DISTANCE OF 131.82 FEET TO THE POINT OF TERMINATION; THENCE WESTERLY DEFLECTING 032 DEGREES, 04 MINUTES, 33 SECONDS RIGHT, A DISTANCE OF 75.00 FEET TO THE POINT OF RESUMPTION; THENCE WESTERLY DEFLECTING 015 DEGREES, 26 MINUTES, 47 SECONDS RIGHT, A DISTANCE OF 788.48 FEET; THENCE WESTERLY DEFLECTING 017 DEGREES, 04 MINUTES, 24 SECONDS LEFT, A DISTANCE OF 500.20 FEET; THENCE WESTERLY DEFLECTING 004 DEGREES, 40 MINUTES, 44 SECONDS LEFT, A DISTANCE OF 199.07 FEET; THENCE WESTERLY DEFLECTING 008 DEGREES, 46 MINUTES, 48 SECONDS RIGHT, A DISTANCE OF 346.54 FEET; THENCE SOUTHWESTERLY DEFLECTING 027 DEGREES, 58 MINUTES, 34 SECONDS LEFT, A DISTANCE OF 391.23 FEET; THENCE WESTERLY DEFLECTING 005 DEGREES, 09 MINUTES, 06 SECONDS RIGHT, A DISTANCE OF 186.29 FEET; THENCE SOUTHERLY DEFLECTING 061 DEGREES, 13 MINUTES, 48 SECONDS LEFT, A DISTANCE OF 197.29 FEET; THENCE SOUTHERLY DEFLECTING 005 DEGREES, 57 MINUTES, 12 SECONDS LEFT, A DISTANCE OF 410.49 FEET; THENCE SOUTHERLY DEFLECTING 002 DEGREES, 18 MINUTES, 55 SECONDS LEFT, A DISTANCE OF 240.01 FEET; THENCE SOUTHERLY DEFLECTING 000 DEGREES, 28 MINUTES, 39 SECONDS LEFT, A DISTANCE OF 100.00 FEET TO THE POINT OF TERMINATION; EXCEPT, OVER ONE UNRESTRICTED ACCESS(ES) NOT TO EXCEED 40 FEET IN WIDTH, THE CENTERLINE(S) OF WHICH (IS, ARE) LOCATED 465.00 FEET FROM THE NORTH LINE OF QUARTER SECTION AS MEASURED ALONG THE CENTERLINE OF 144TH STREET.

ALL RIGHTS TO OIL AND GAS MINERALS IN OR ON THE ABOVE DESCRIBED REAL PROPERTY, SHALL BE RETAINED AND RESERVED TO THE CONDEMNEE AND TO ITS SUCCESSORS AND ASSIGNS. SAID CONDEMNEE AND/OR ITS SUCCESSORS AND ASSIGNS SHALL HAVE NO RIGHT TO ENTER OR USE THE SURFACE OF SAID REAL PROPERTY FOR ANY PURPOSE CONCERNING SAID OIL AND GAS MINERAL RIGHTS, NOR SHALL THE CONDEMNEE AND/OR ITS SUCCESSORS AND ASSIGNS IN EXTRACTING SAID OIL AND GAS MINERALS FROM SAID REAL PROPERTY, DAMAGE OR IN ANY WAY IMPAIR THE USE OF SAID REAL PROPERTY.

PROJECT: I

AND ALSO,
THEREON,
QUARTER OF
PRINCIPAL
ATTACHED PL

REFERRING
SOUTHERLY
QUARTER SE
00 SECONDS
144TH STRE
EASTERLY I
30.00 FEET
SECONDS LE
175 DEGREE
THENCE SOU
A DISTANCE
ACRES, MORE

AND ALSO,
THEREON, I
OF SECTION
MERIDIAN,
PLAT AND BE

REFERRING
SOUTHERLY
QUARTER SE
00 SECONDS
144TH STRE
EASTERLY D
47.00 FEET
SECONDS RI
090 DEGREE
THENCE NORT
A DISTANCE
ACRES, MORE

AND ALSO,
THEREON, I
QUARTER OF
PRINCIPAL
ATTACHED PL

REFERRING
SOUTHERLY
QUARTER SE
00 SECONDS
THENCE SOUTH

A DISTANCE OF 410.00 FEET; THENCE WESTERLY DEFLECTING 090 DEGREES, 00 MINUTES, 00 SECONDS RIGHT, A DISTANCE OF 20.00 FEET; THENCE NORTHERLY DEFLECTING 092 DEGREES, 47 MINUTES, 34 SECONDS RIGHT, A DISTANCE OF 410.49 FEET TO THE POINT OF BEGINNING CONTAINING 0.09 ACRES, MORE OR LESS.

THE EASEMENT AREA(S) MAY BE USED FOR THE TEMPORARY RELOCATION OF UTILITIES DURING THE CONSTRUCTION OF THE PROJECT. UPON COMPLETION AND ACCEPTANCE OF PROJECT F-6-7 (1029), ALL RIGHTS, INTEREST AND USE OF THE ABOVE DESCRIBED TEMPORARY EASEMENT AREA(S) SHALL BE RETURNED TO THE CONDEMNEE AND TO ITS SUCCESSORS AND ASSIGNS WITH THE AFORESAID CHANGES COMPLETED.

AND ALSO;

FEE SIMPLE TITLE TO A TRACT OF LAND AND ALL IMPROVEMENTS THEREON, IF ANY, FOR HIGHWAY RIGHT OF WAY PURPOSES LOCATED IN THE NORTHEAST QUARTER OF SECTION 24, TOWNSHIP 15 NORTH, RANGE 11 EAST OF THE SIXTH PRINCIPAL MERIDIAN, DOUGLAS COUNTY, NEBRASKA, AS ILLUSTRATED ON THE ATTACHED PLAT AND BEING MORE PARTICULARLY DESCRIBED AS FOLLOWS:

BEGINNING AT THE NORTHEAST CORNER OF SAID QUARTER SECTION; THENCE WESTERLY A DISTANCE OF 2637.62 FEET TO THE NORTHWEST CORNER OF SAID QUARTER SECTION; THENCE SOUTHERLY DEFLECTING 090 DEGREES, 13 MINUTES, 19 SECONDS LEFT, A DISTANCE OF 120.00 FEET ALONG THE WEST LINE OF SAID QUARTER SECTION; THENCE EASTERLY DEFLECTING 095 DEGREES, 27 MINUTES, 13 SECONDS LEFT, A DISTANCE OF 606.71 FEET TO A POINT ON THE SOUTHERLY EXISTING WEST DODGE STREET RIGHT OF WAY LINE; THENCE EASTERLY DEFLECTING 005 DEGREES, 40 MINUTES, 31 SECONDS RIGHT, A DISTANCE OF 248.91 FEET ALONG SAID RIGHT OF WAY LINE; THENCE EASTERLY DEFLECTING 006 DEGREES, 22 MINUTES, 27 SECONDS RIGHT, A DISTANCE OF 179.35 FEET; THENCE EASTERLY DEFLECTING 005 DEGREES, 09 MINUTES, 32 SECONDS RIGHT, A DISTANCE OF 120.57 FEET; THENCE EASTERLY DEFLECTING 012 DEGREES, 40 MINUTES, 20 SECONDS LEFT, A DISTANCE OF 705.13 FEET; THENCE EASTERLY DEFLECTING 014 DEGREES, 16 MINUTES, 24 SECONDS RIGHT, A DISTANCE OF 308.06 FEET; THENCE SOUTHEASTERLY DEFLECTING 022 DEGREES, 14 MINUTES, 46 SECONDS RIGHT, A DISTANCE OF 423.14 FEET; THENCE SOUTHERLY DEFLECTING 052 DEGREES, 46 MINUTES, 18 SECONDS RIGHT, A DISTANCE OF 395.15 FEET; THENCE SOUTHERLY DEFLECTING 004 DEGREES, 24 MINUTES, 05 SECONDS LEFT, A DISTANCE OF 503.02 FEET; THENCE SOUTHERLY DEFLECTING 006 DEGREES, 16 MINUTES, 38 SECONDS RIGHT, A DISTANCE OF 400.00 FEET; THENCE SOUTHERLY DEFLECTING 001 DEGREES, 25 MINUTES, 56 SECONDS LEFT, A DISTANCE OF 600.19 FEET; THENCE SOUTHERLY DEFLECTING 010 DEGREES, 58 MINUTES, 31 SECONDS LEFT, A DISTANCE OF 102.39 FEET TO A POINT ON THE WESTERLY 132ND STREET RIGHT OF WAY LINE; THENCE EASTERLY DEFLECTING 077 DEGREES, 35 MINUTES, 34 SECONDS LEFT, A DISTANCE OF 33.00 FEET TO A POINT ON THE EAST LINE OF SAID QUARTER SECTION; THENCE NORTHERLY DEFLECTING 090 DEGREES, 00 MINUTES, 00 SECONDS LEFT, A DISTANCE OF 2400.00 FEET ALONG SAID LINE TO THE POINT OF BEGINNING CONTAINING

PROJE

11.99
PREVIC

THERE
CONTRC
TOWNSH
DOUGL

REFERE
WESTER
QUART
19 SEC
QUART
106 DE
A POIN
THENCE
A DIS
EASTER
DISTAN
MINUTE
DEFLEC
705.13
SECON
DEFLEC
423.14
SECON
004 I
THE PO

ALL I
PROPEI
SUCCE
ASSIGN
PROPEI
NOR
EXTRAC
OR IN

AND /
THEREC
QUART
PRINCI
ATTACH

REFERE
WESTER
QUART
19 SEC
QUART
13 SEC
EXISTI

11.99 ACRES, MORE OR LESS, WHICH INCLUDES 5.48 ACRES, MORE OR LESS PREVIOUSLY OCCUPIED AS PUBLIC HIGHWAY.

THERE WILL BE NO INGRESS OR EGRESS OVER THE FOLLOWING DESCRIBED CONTROLLED ACCESS LINE LOCATED IN THE NORTHEAST QUARTER OF SECTION 24, TOWNSHIP 15 NORTH, RANGE 11 EAST OF THE SIXTH PRINCIPAL MERIDIAN, DOUGLAS COUNTY, NEBRASKA:

REFERRING TO THE NORTHEAST CORNER OF SAID QUARTER SECTION; THENCE WESTERLY A DISTANCE OF 2637.62 FEET TO THE NORTHWEST CORNER OF SAID QUARTER SECTION; THENCE SOUTHERLY DEFLECTING 090 DEGREES, 13 MINUTES, 19 SECONDS LEFT, A DISTANCE OF 240.00 FEET ALONG THE WEST LINE OF SAID QUARTER SECTION TO THE POINT OF BEGINNING; THENCE EASTERLY DEFLECTING 106 DEGREES, 23 MINUTES, 30 SECONDS LEFT, A DISTANCE OF 629.56 FEET TO A POINT ON THE SOUTHERLY EXISTING WEST DODGE STREET RIGHT OF WAY LINE; THENCE EASTERLY DEFLECTING 016 DEGREES, 36 MINUTES, 49 SECONDS RIGHT, A DISTANCE OF 248.91 FEET ALONG SAID RIGHT OF WAY LINE; THENCE EASTERLY DEFLECTING 006 DEGREES, 22 MINUTES, 27 SECONDS RIGHT, A DISTANCE OF 179.35 FEET; THENCE EASTERLY DEFLECTING 005 DEGREES, 09 MINUTES, 32 SECONDS RIGHT, A DISTANCE OF 120.57 FEET; THENCE EASTERLY DEFLECTING 012 DEGREES, 40 MINUTES, 20 SECONDS LEFT, A DISTANCE OF 705.13 FEET; THENCE EASTERLY DEFLECTING 014 DEGREES, 16 MINUTES, 24 SECONDS RIGHT, A DISTANCE OF 308.06 FEET; THENCE SOUTHEASTERLY DEFLECTING 022 DEGREES, 14 MINUTES, 46 SECONDS RIGHT, A DISTANCE OF 423.14 FEET; THENCE SOUTHERLY DEFLECTING 052 DEGREES, 46 MINUTES, 18 SECONDS RIGHT, A DISTANCE OF 395.15 FEET; THENCE SOUTHERLY DEFLECTING 004 DEGREES, 24 MINUTES, 05 SECONDS LEFT, A DISTANCE OF 94.57 FEET TO THE POINT OF TERMINATION;

ALL RIGHTS TO OIL AND GAS MINERALS IN OR ON THE ABOVE DESCRIBED REAL PROPERTY, SHALL BE RETAINED AND RESERVED TO THE CONDEMNEE AND TO ITS SUCCESSORS AND ASSIGNS. SAID CONDEMNEE AND/OR ITS SUCCESSORS AND ASSIGNS SHALL HAVE NO RIGHT TO ENTER OR USE THE SURFACE OF SAID REAL PROPERTY FOR ANY PURPOSE CONCERNING SAID OIL AND GAS MINERAL RIGHTS, NOR SHALL THE CONDEMNEE AND/OR ITS SUCCESSORS AND ASSIGNS IN EXTRACTING SAID OIL AND GAS MINERALS FROM SAID REAL PROPERTY, DAMAGE OR IN ANY WAY IMPAIR THE USE OF SAID REAL PROPERTY.

AND ALSO, TEMPORARY EASEMENT TO A TRACT OF LAND AND ALL IMPROVEMENTS THEREON, IF ANY, FOR SHAPING PURPOSES, LOCATED IN THE NORTHEAST QUARTER OF SECTION 24, TOWNSHIP 15 NORTH, RANGE 11 EAST OF THE SIXTH PRINCIPAL MERIDIAN, DOUGLAS COUNTY, NEBRASKA, AS ILLUSTRATED ON THE ATTACHED PLAT AND BEING MORE PARTICULARLY DESCRIBED AS FOLLOWS:

REFERRING TO THE NORTHEAST CORNER OF SAID QUARTER SECTION; THENCE WESTERLY A DISTANCE OF 2637.62 FEET TO THE NORTHWEST CORNER OF SAID QUARTER SECTION; THENCE SOUTHERLY DEFLECTING 090 DEGREES, 13 MINUTES, 19 SECONDS LEFT, A DISTANCE OF 120.00 FEET ALONG THE WEST LINE OF SAID QUARTER SECTION; THENCE EASTERLY DEFLECTING 095 DEGREES, 27 MINUTES, 13 SECONDS LEFT, A DISTANCE OF 606.71 FEET TO A POINT ON THE SOUTHERLY EXISTING WEST DODGE RIGHT OF WAY LINE TO THE POINT OF BEGINNING;

PROJECT: F-QF-6-7 (134) C.N.: 21212 DOUGLAS COUNTY
(PAGE 9)
OF 13

TRACT 15

PROJ

BOOK 939 PAGE 108

THENCE EASTERLY DEFLECTING 005 DEGREES, 40 MINUTES, 31 SECONDS RIGHT, A DISTANCE OF 248.91 FEET ALONG SAID RIGHT OF WAY LINE; THENCE EASTERLY DEFLECTING 006 DEGREES, 22 MINUTES, 27 SECONDS RIGHT, A DISTANCE OF 179.35 FEET; THENCE WESTERLY DEFLECTING 174 DEGREES, 51 MINUTES, 38 SECONDS RIGHT, A DISTANCE OF 178.51 FEET; THENCE WESTERLY DEFLECTING 001 DEGREES, 57 MINUTES, 11 SECONDS RIGHT, A DISTANCE OF 199.00 FEET; THENCE WESTERLY DEFLECTING 010 DEGREES, 29 MINUTES, 31 SECONDS LEFT, A DISTANCE OF 117.98 FEET; THENCE EASTERLY DEFLECTING 170 DEGREES, 41 MINUTES, 26 SECONDS RIGHT, A DISTANCE OF 69.95 FEET TO THE POINT OF BEGINNING CONTAINING 0.10 ACRES, MORE OR LESS.

ACRES

THERE
CONTR
TOWNS
DOUGL

REFER
EASTE
QUART
14 SE
QUART
DEFLE
142.0
039

THE
02 M
WESTE
DISTA
MINUT
DEFLE
1005.
18 S
DEFLE
266.3
SECON

THE EASEMENT AREA(S) MAY BE USED FOR THE TEMPORARY RELOCATION OF UTILITIES DURING THE CONSTRUCTION OF THE PROJECT. UPON COMPLETION AND ACCEPTANCE OF PROJECT F-6-7 (1027), ALL RIGHTS, INTEREST AND USE OF THE ABOVE DESCRIBED TEMPORARY EASEMENT AREA(S) SHALL BE RETURNED TO THE CONDEEMNEE AND TO ITS SUCCESSORS AND ASSIGNS WITH THE AFORESAID CHANGES COMPLETED.

AND ALSO;

FEE SIMPLE TITLE TO A TRACT OF LAND AND ALL IMPROVEMENTS THEREON, IF ANY, FOR HIGHWAY RIGHT OF WAY PURPOSES LOCATED IN THE SOUTHWEST QUARTER OF SECTION 13, TOWNSHIP 15 NORTH, RANGE 11 EAST OF THE SIXTH PRINCIPAL MERIDIAN, DOUGLAS COUNTY, NEBRASKA, AS ILLUSTRATED ON THE ATTACHED PLAT AND BEING MORE PARTICULARLY DESCRIBED AS FOLLOWS:

BEGINNING AT THE SOUTHWEST CORNER OF SAID QUARTER SECTION; THENCE EASTERLY A DISTANCE OF 2634.67 FEET TO THE SOUTHEAST CORNER OF SAID QUARTER SECTION; THENCE NORTHERLY DEFLECTING 090 DEGREES, 07 MINUTES, 14 SECONDS LEFT, A DISTANCE OF 195.00 FEET ALONG THE EAST LINE OF SAID QUARTER SECTION; THENCE WESTERLY DEFLECTING 094 DEGREES, 31 MINUTES, 40 SECONDS LEFT, A DISTANCE OF 1048.83 FEET; THENCE WESTERLY DEFLECTING 007 DEGREES, 57 MINUTES, 32 SECONDS RIGHT, A DISTANCE OF 1106.05 FEET; THENCE NORTHWESTERLY DEFLECTING 023 DEGREES, 02 MINUTES, 18 SECONDS RIGHT, A DISTANCE OF 385.58 FEET; THENCE NORTHERLY DEFLECTING 047 DEGREES, 03 MINUTES, 13 SECONDS RIGHT, A DISTANCE OF 266.30 FEET; THENCE NORTHERLY DEFLECTING 018 DEGREES, 48 MINUTES, 02 SECONDS RIGHT, A DISTANCE OF 360.31 FEET; THENCE NORTHEASTERLY DEFLECTING 024 DEGREES, 10 MINUTES, 45 SECONDS RIGHT, A DISTANCE OF 111.80 FEET; THENCE NORTHERLY DEFLECTING 038 DEGREES, 11 MINUTES, 55 SECONDS LEFT, A DISTANCE OF 347.13 FEET; THENCE NORTHERLY DEFLECTING 011 DEGREES, 38 MINUTES, 01 SECONDS RIGHT, A DISTANCE OF 400.00 FEET; THENCE NORTHERLY DEFLECTING 015 DEGREES, 06 MINUTES, 34 SECONDS LEFT, A DISTANCE OF 103.58 FEET TO A POINT ON THE EASTERLY 144TH STREET; RIGHT OF WAY LINE; THENCE WESTERLY DEFLECTING 074 DEGREES, 53 MINUTES, 26 SECONDS LEFT, A DISTANCE OF 33.00 FEET TO A POINT ON THE WEST LINE OF SAID QUARTER SECTION; THENCE SOUTHERLY DEFLECTING 090 DEGREES, 00 MINUTES, 00 SECONDS LEFT, A DISTANCE OF 1900.00 FEET TO THE POINT OF BEGINNING CONTAINING 13.26 ACRES, MORE OR LESS, WHICH INCLUDES 5.03

ALL
PROPE
SUCCE
ASSIG
PROPE
NOR
EXTRA
OR IN

AND
THERE
OF SE
MERID
PLAT

REFER
NORTH
QUART
00 SI
144TH
DEGRE
THENCE
A DIST
MINUTE

PROJECT: F-QF-6-7 (134) C.N.: 21212 DOUGLAS COUNTY
(PAGE 10)

TRACT 15

OF 13

BOOK 939 PAGE 109

ACRES, MORE OR LESS PREVIOUSLY OCCUPIED AS PUBLIC HIGHWAY.

THERE WILL BE NO INGRESS OR EGRESS OVER THE FOLLOWING DESCRIBED CONTROLLED ACCESS LINE LOCATED IN THE SOUTHWEST QUARTER OF SECTION 13, TOWNSHIP 15 NORTH, RANGE 11 EAST OF THE SIXTH PRINCIPAL MERIDIAN, DOUGLAS COUNTY, NEBRASKA:

REFERRING TO THE SOUTHWEST CORNER OF SAID QUARTER SECTION; THENCE EASTERLY A DISTANCE OF 2634.67 FEET TO THE SOUTHEAST CORNER OF SAID QUARTER SECTION; THENCE NORTHERLY DEFLECTING 090 DEGREES, 07 MINUTES, 14 SECONDS LEFT, A DISTANCE OF 400.00 FEET ALONG THE EAST LINE OF SAID QUARTER SECTION TO THE POINT OF BEGINNING; THENCE NORTHWESTERLY DEFLECTING 050 DEGREES, 34 MINUTES, 40 SECONDS LEFT, A DISTANCE OF 142.09 FEET TO THE POINT OF TERMINATION; THENCE WESTERLY DEFLECTING 039 DEGREES, 18 MINUTES, 06 SECONDS LEFT, A DISTANCE OF 75.00 FEET TO THE POINT OF RESUMPTION; THENCE SOUTHWESTERLY DEFLECTING 059 DEGREES, 02 MINUTES, 10 SECONDS LEFT, A DISTANCE OF 116.62 FEET; THENCE WESTERLY DEFLECTING 043 DEGREES, 55 MINUTES, 36 SECONDS RIGHT, A DISTANCE OF 517.90 FEET; THENCE WESTERLY DEFLECTING 004 DEGREES, 04 MINUTES, 49 SECONDS LEFT, A DISTANCE OF 423.53 FEET; THENCE WESTERLY DEFLECTING 022 DEGREES, 30 MINUTES, 01 SECONDS RIGHT, A DISTANCE OF 1005.88 FEET; THENCE NORTHWESTERLY DEFLECTING 023 DEGREES, 02 MINUTES, 18 SECONDS RIGHT, A DISTANCE OF 385.58 FEET; THENCE NORTHERLY DEFLECTING 047 DEGREES, 03 MINUTES, 13 SECONDS RIGHT, A DISTANCE OF 266.30 FEET; THENCE NORTHERLY DEFLECTING 018 DEGREES, 48 MINUTES, 02 SECONDS RIGHT, A DISTANCE OF 220.19 FEET TO THE POINT OF TERMINATION;

ALL RIGHTS TO OIL AND GAS MINERALS IN OR ON THE ABOVE DESCRIBED REAL PROPERTY, SHALL BE RETAINED AND RESERVED TO THE CONDEMNEE AND TO ITS SUCCESSORS AND ASSIGNS. SAID CONDEMNEE AND/OR ITS SUCCESSORS AND ASSIGNS SHALL HAVE NO RIGHT TO ENTER OR USE THE SURFACE OF SAID REAL PROPERTY FOR ANY PURPOSE CONCERNING SAID OIL AND GAS MINERAL RIGHTS, NOR SHALL THE CONDEMNEE AND/OR ITS SUCCESSORS AND ASSIGNS IN EXTRACTING SAID OIL AND GAS MINERALS FROM SAID REAL PROPERTY, DAMAGE OR IN ANY WAY IMPAIR THE USE OF SAID REAL PROPERTY.

AND ALSO, TEMPORARY EASEMENT TO A TRACT OF LAND AND ALL IMPROVEMENTS THEREON, IF ANY, FOR DRIVE PURPOSES, LOCATED IN THE SOUTHWEST QUARTER OF SECTION 13, TOWNSHIP 15 NORTH, RANGE 11 EAST OF THE SIXTH PRINCIPAL MERIDIAN, DOUGLAS COUNTY, NEBRASKA, AS ILLUSTRATED ON THE ATTACHED PLAT AND BEING MORE PARTICULARLY DESCRIBED AS FOLLOWS:

REFERRING TO THE SOUTHWEST CORNER OF SAID QUARTER SECTION; THENCE NORTHERLY A DISTANCE OF 1900.00 FEET ALONG THE WEST LINE OF SAID QUARTER SECTION; THENCE EASTERLY DEFLECTING 090 DEGREES, 00 MINUTES, 00 SECONDS RIGHT, A DISTANCE OF 33.00 FEET TO A POINT ON THE EASTERLY 144TH STREET RIGHT OF WAY LINE; THENCE SOUTHERLY DEFLECTING 074 DEGREES, 53 MINUTES, 26 SECONDS RIGHT, A DISTANCE OF 103.58 FEET; THENCE SOUTHERLY DEFLECTING 015 DEGREES, 06 MINUTES, 34 SECONDS RIGHT, A DISTANCE OF 400.00 FEET; THENCE SOUTHERLY DEFLECTING 011 DEGREES, 38 MINUTES, 01 SECONDS LEFT, A DISTANCE OF 347.13 FEET; THENCE

Affects
Lots 1+2
FNBP
Rep 13
FNBP
AL 2

Lot 6
FNBP

Lots 1+2
FNBP
Rep 2
see
Diagram
Pg. 116

BOOK 939 PAGE 110

SOUTHWESTERLY DEFLECTING 038 DEGREES, 11 MINUTES, 55 SECONDS RIGHT, A DISTANCE OF 16.77 FEET TO THE POINT OF BEGINNING; THENCE SOUTHWESTERLY DEFLECTING 000 DEGREES, 00 MINUTES, 00 SECONDS A DISTANCE OF 95.03 FEET; THENCE SOUTHERLY DEFLECTING 024 DEGREES, 10 MINUTES, 45 SECONDS LEFT, A DISTANCE OF 140.12 FEET; THENCE NORTHEASTERLY DEFLECTING 128 DEGREES, 52 MINUTES, 38 SECONDS LEFT, A DISTANCE OF 75.67 FEET; THENCE NORTHEASTERLY DEFLECTING 029 DEGREES, 03 MINUTES, 53 SECONDS LEFT, A DISTANCE OF 120.83 FEET; THENCE NORTHWESTERLY DEFLECTING 066 DEGREES, 12 MINUTES, 15 SECONDS LEFT, A DISTANCE OF 93.84 FEET TO THE POINT OF BEGINNING CONTAINING 0.31 ACRES, MORE OR LESS.

THE EASEMENT AREA(S) MAY BE USED FOR THE TEMPORARY RELOCATION OF UTILITIES DURING THE CONSTRUCTION OF THE PROJECT. UPON COMPLETION AND ACCEPTANCE OF PROJECT F-6-7 (1027), ALL RIGHTS, INTEREST AND USE OF THE ABOVE DESCRIBED TEMPORARY EASEMENT AREA(S) SHALL BE RETURNED TO THE CONDEMNEE AND TO ITS SUCCESSORS AND ASSIGNS WITH THE AFORESAID CHANGES COMPLETED.

AND ALSO;

FEE SIMPLE TITLE TO A TRACT OF LAND AND ALL IMPROVEMENTS THEREON, IF ANY, FOR HIGHWAY RIGHT OF WAY PURPOSES LOCATED IN THE SOUTHEAST QUARTER OF SECTION 13, TOWNSHIP 15 NORTH, RANGE 11 EAST OF THE SIXTH PRINCIPAL MERIDIAN, DOUGLAS COUNTY, NEBRASKA, AS ILLUSTRATED ON THE ATTACHED PLAT AND BEING MORE PARTICULARLY DESCRIBED AS FOLLOWS:

107
25
BEGINNING AT THE SOUTHEAST CORNER OF SAID QUARTER SECTION; THENCE WESTERLY A DISTANCE OF 2637.62 FEET TO THE SOUTHWEST CORNER OF SAID QUARTER SECTION; THENCE NORTHERLY DEFLECTING 089 DEGREES, 52 MINUTES, 21 SECONDS RIGHT, A DISTANCE OF 195.00 FEET ALONG THE WEST LINE OF SAID QUARTER SECTION; THENCE EASTERLY DEFLECTING 092 DEGREES, 22 MINUTES, 35 SECONDS RIGHT, A DISTANCE OF 254.83 FEET; THENCE EASTERLY DEFLECTING 011 DEGREES, 34 MINUTES, 47 SECONDS RIGHT, A DISTANCE OF 334.70 FEET; THENCE EASTERLY DEFLECTING 025 DEGREES, 20 MINUTES, 08 SECONDS LEFT, A DISTANCE OF 287.81 FEET; THENCE EASTERLY DEFLECTING 014 DEGREES, 40 MINUTES, 55 SECONDS RIGHT, A DISTANCE OF 96.24 FEET; THENCE EASTERLY DEFLECTING 006 DEGREES, 30 MINUTES, 45 SECONDS RIGHT, A DISTANCE OF 405.20 FEET; THENCE EASTERLY DEFLECTING 012 DEGREES, 47 MINUTES, 00 SECONDS LEFT, A DISTANCE OF 298.18 FEET; THENCE EASTERLY DEFLECTING 008 DEGREES, 12 MINUTES, 51 SECONDS LEFT, A DISTANCE OF 203.96 FEET; THENCE EASTERLY DEFLECTING 005 DEGREES, 35 MINUTES, 58 SECONDS RIGHT, A DISTANCE OF 301.50 FEET; THENCE EASTERLY DEFLECTING 012 DEGREES, 43 MINUTES, 28 SECONDS LEFT, A DISTANCE OF 316.23 FEET; THENCE NORTHEASTERLY DEFLECTING 039 DEGREES, 47 MINUTES, 11 SECONDS LEFT, A DISTANCE OF 146.78 FEET; THENCE NORTHERLY DEFLECTING 031 DEGREES, 53 MINUTES, 51 SECONDS LEFT, A DISTANCE OF 120.00 FEET; THENCE NORTHERLY DEFLECTING 010 DEGREES, 39 MINUTES, 35 SECONDS RIGHT, A DISTANCE OF 183.16 FEET TO A POINT ON THE WESTERLY 132ND STREET RIGHT OF WAY LINE; THENCE EASTERLY DEFLECTING 079 DEGREES, 27 MINUTES,

P
J3
OE
MI
TC
IN
HI
TF
CC
TC
DC
RE
WI
QU
2
SI
DI
2
2
DI
4
S
O
T
D
M
D
3
1
D
1
S
1
D
T
A
T
A
E
S
A
E
N
E
C
P
T
S

110

BOOK 939 PAGE 111

I, A
ERLY
5.03
ONDS
128
ENCE
I, A
ES,
OF

33 SECONDS RIGHT, A DISTANCE OF 71.12 FEET TO A POINT ON THE EAST LINE
OF SAID QUARTER SECTION; THENCE SOUTHERLY DEFLECTING 089 DEGREES, 52
MINUTES, 52 SECONDS RIGHT, A DISTANCE OF 699.85 FEET ALONG SAID LINE
TO THE POINT OF BEGINNING CONTAINING 10.65 ACRES, MORE OR LESS, WHICH
INCLUDES 4.68 ACRES, MORE OR LESS PREVIOUSLY OCCUPIED AS PUBLIC
HIGHWAY.

OF
AND
OF
TO
AID

THERE WILL BE NO INGRESS OR EGRESS OVER THE FOLLOWING DESCRIBED
CONTROLLED ACCESS LINE LOCATED IN THE SOUTHEAST QUARTER OF SECTION 13,
TOWNSHIP 15 NORTH, RANGE 11 EAST OF THE SIXTH PRINCIPAL MERIDIAN,
DOUGLAS COUNTY, NEBRASKA:

IF
AST
KTH
THE

REFERRING TO THE SOUTHEAST CORNER OF SAID QUARTER SECTION; THENCE
WESTERLY A DISTANCE OF 2637.62 FEET TO THE SOUTHWEST CORNER OF SAID
QUARTER SECTION; THENCE NORTHERLY DEFLECTING 089 DEGREES, 52 MINUTES,
21 SECONDS RIGHT, A DISTANCE OF 400.00 FEET ALONG THE WEST LINE OF
SAID QUARTER SECTION TO THE POINT OF BEGINNING; THENCE EASTERLY
DEFLECTING 101 DEGREES, 13 MINUTES, 02 SECONDS RIGHT, A DISTANCE OF
259.95 FEET; THENCE SOUTHEASTERLY DEFLECTING 019 DEGREES, 17 MINUTES,
22 SECONDS RIGHT, A DISTANCE OF 336.15 FEET; THENCE EASTERLY
DEFLECTING 027 DEGREES, 12 MINUTES, 15 SECONDS LEFT, A DISTANCE OF
413.75 FEET; THENCE EASTERLY DEFLECTING 006 DEGREES, 30 MINUTES, 45
SECONDS RIGHT, A DISTANCE OF 405.20 FEET; THENCE EASTERLY DEFLECTING
012 DEGREES, 47 MINUTES, 00 SECONDS LEFT, A DISTANCE OF 298.18 FEET;
THENCE EASTERLY DEFLECTING 008 DEGREES, 12 MINUTES, 51 SECONDS LEFT, A
DISTANCE OF 203.96 FEET; THENCE EASTERLY DEFLECTING 005 DEGREES, 35
MINUTES, 58 SECONDS RIGHT, A DISTANCE OF 301.50 FEET; THENCE EASTERLY
DEFLECTING 012 DEGREES, 43 MINUTES, 28 SECONDS LEFT, A DISTANCE OF
316.23 FEET; THENCE NORTHEASTERLY DEFLECTING 039 DEGREES, 47 MINUTES,
11 SECONDS LEFT, A DISTANCE OF 146.78 FEET; THENCE NORTHERLY
DEFLECTING 031 DEGREES, 53 MINUTES, 51 SECONDS LEFT, A DISTANCE OF
120.00 FEET; THENCE NORTHERLY DEFLECTING 010 DEGREES, 39 MINUTES, 35
SECONDS RIGHT, A DISTANCE OF 183.16 FEET TO A POINT ON THE WESTERLY
132ND STREET RIGHT OF WAY LINE; THENCE NORTHERLY DEFLECTING 009
DEGREES, 42 MINUTES, 19 SECONDS LEFT, A DISTANCE OF 256.21 FEET;
THENCE NORTHERLY DEFLECTING 000 DEGREES, 57 MINUTES, 17 SECONDS RIGHT,
A DISTANCE OF 43.85 FEET ALONG SAID RIGHT OF WAY LINE TO THE POINT OF
TERMINATION;

NCE
AID
ES,
OF
22
LY
OF
08
NG
T;
IT,
47
LY
OF
58
NG
T;
DS
31
T;
T,
ET
S,

ALL RIGHTS TO OIL AND GAS MINERALS IN OR ON THE ABOVE DESCRIBED REAL
PROPERTY, SHALL BE RETAINED AND RESERVED TO THE CONDEMNEE AND TO ITS
SUCCESSORS AND ASSIGNS. SAID CONDEMNEE AND/OR ITS SUCCESSORS AND
ASSIGNS SHALL HAVE NO RIGHT TO ENTER OR USE THE SURFACE OF SAID REAL
PROPERTY FOR ANY PURPOSE CONCERNING SAID OIL AND GAS MINERAL RIGHTS,
NOR SHALL THE CONDEMNEE AND/OR ITS SUCCESSORS AND ASSIGNS IN
EXTRACTING SAID OIL AND GAS MINERALS FROM SAID REAL PROPERTY, DAMAGE
OR IN ANY WAY IMPAIR THE USE OF SAID REAL PROPERTY.

AND ALSO, TEMPORARY EASEMENT TO A TRACT OF LAND AND ALL IMPROVEMENTS
THEREON, IF ANY, FOR BORROW AND DRIVE PURPOSES, LOCATED IN THE
SOUTHEAST QUARTER OF SECTION 13, TOWNSHIP 15 NORTH, RANGE 11 EAST OF

PROJECT: F-QF-6-7 (134) C.N.: 21212 DOUGLAS COUNTY TRACT 15
(PAGE 13)
OF 13

BOOK 939 PAGE 112

THE SIXTH PRINCIPAL MERIDIAN, DOUGLAS COUNTY, NEBRASKA, AS ILLUSTRATED ON THE ATTACHED PLAT AND BEING MORE PARTICULARLY DESCRIBED AS FOLLOWS:

REFERRING TO THE SOUTHEAST CORNER OF SAID QUARTER SECTION; THENCE NORTHERLY A DISTANCE OF 699.85 FEET TO A POINT ON THE EAST LINE OF SAID QUARTER SECTION; THENCE WESTERLY DEFLECTING 089 DEGREES, 52 MINUTES, 52 SECONDS LEFT, A DISTANCE OF 71.12 FEET TO THE POINT OF BEGINNING; THENCE WESTERLY DEFLECTING 000 DEGREES, 07 MINUTES, 07 SECONDS LEFT, A DISTANCE OF 828.88 FEET; THENCE NORTHERLY DEFLECTING 089 DEGREES, 59 MINUTES, 59 SECONDS RIGHT, A DISTANCE OF 400.00 FEET; THENCE NORTHEASTERLY DEFLECTING 039 DEGREES, 48 MINUTES, 20 SECONDS RIGHT, A DISTANCE OF 781.02 FEET; THENCE EASTERLY DEFLECTING 050 DEGREES, 11 MINUTES, 40 SECONDS RIGHT, A DISTANCE OF 349.88 FEET TO A POINT ON THE WESTERLY 132ND STREET RIGHT OF WAY LINE; THENCE SOUTHERLY DEFLECTING 090 DEGREES, 00 MINUTES, 00 SECONDS RIGHT, A DISTANCE OF 115.42 FEET; THENCE SOUTHERLY DEFLECTING 000 DEGREES, 57 MINUTES, 16 SECONDS RIGHT, A DISTANCE OF 252.88 FEET; THENCE SOUTHERLY DEFLECTING 000 DEGREES, 57 MINUTES, 17 SECONDS RIGHT, A DISTANCE OF 375.77 FEET; THENCE SOUTHERLY DEFLECTING 000 DEGREES, 57 MINUTES, 17 SECONDS LEFT, A DISTANCE OF 256.21 FEET ALONG SAID RIGHT OF WAY LINE TO THE POINT OF BEGINNING CONTAINING 15.85 ACRES, MORE OR LESS.

THE EASEMENT AREA(S) MAY BE USED FOR THE TEMPORARY RELOCATION OF UTILITIES DURING THE CONSTRUCTION OF THE PROJECT. UPON COMPLETION AND ACCEPTANCE OF PROJECT F-6-7 (1027), ALL RIGHTS, INTEREST AND USE OF THE ABOVE DESCRIBED TEMPORARY EASEMENT AREA(S) SHALL BE RETURNED TO THE CONDEMNEE AND TO ITS SUCCESSORS AND ASSIGNS WITH THE AFORESAID CHANGES COMPLETED.

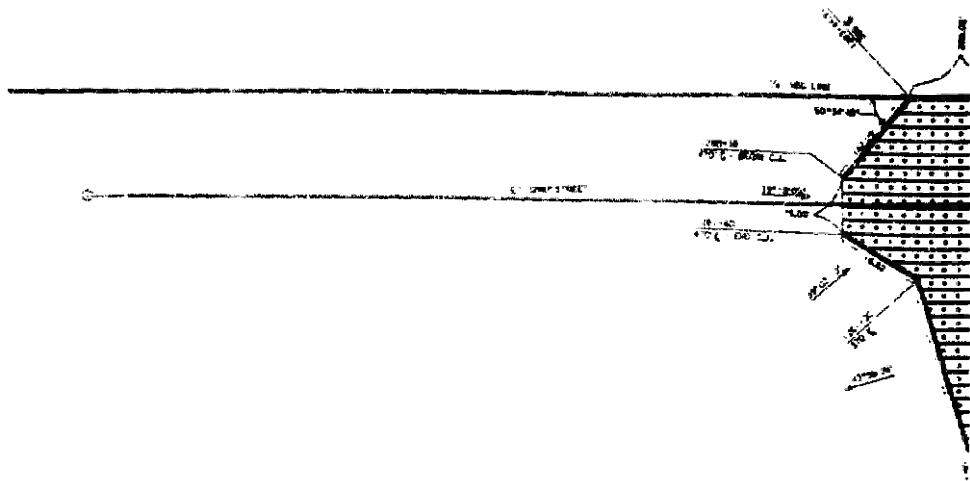

SW 1/4 SEC. 13 T. 15N. R. 11E.
 1/4 AC. 100' x 100'
 1/4 AC. 100' x 100'
 1/4 AC. 100' x 100'
 1/4 AC. 100' x 100'
 1/4 AC. 100' x 100'
 1/4 AC. 100' x 100'
 1/4 AC. 100' x 100'
 1/4 AC. 100' x 100'

100' x 100'
 100' x 100'

SW 1/4 SEC. 13 T. 15N. R. 11E.

100' x 100'
 100' x 100'

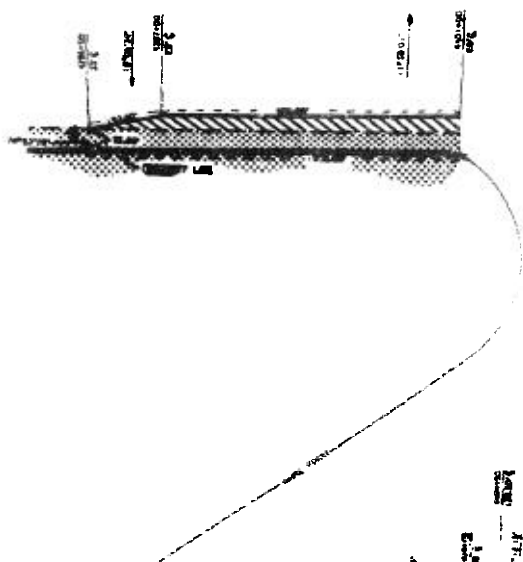

SW 1/4 SEC. 13 T. 15N. R. 11E.
 1/4 AC. 100' x 100'
 1/4 AC. 100' x 100'
 1/4 AC. 100' x 100'
 1/4 AC. 100' x 100'
 1/4 AC. 100' x 100'
 1/4 AC. 100' x 100'
 1/4 AC. 100' x 100'

100' x 100'
 100' x 100'

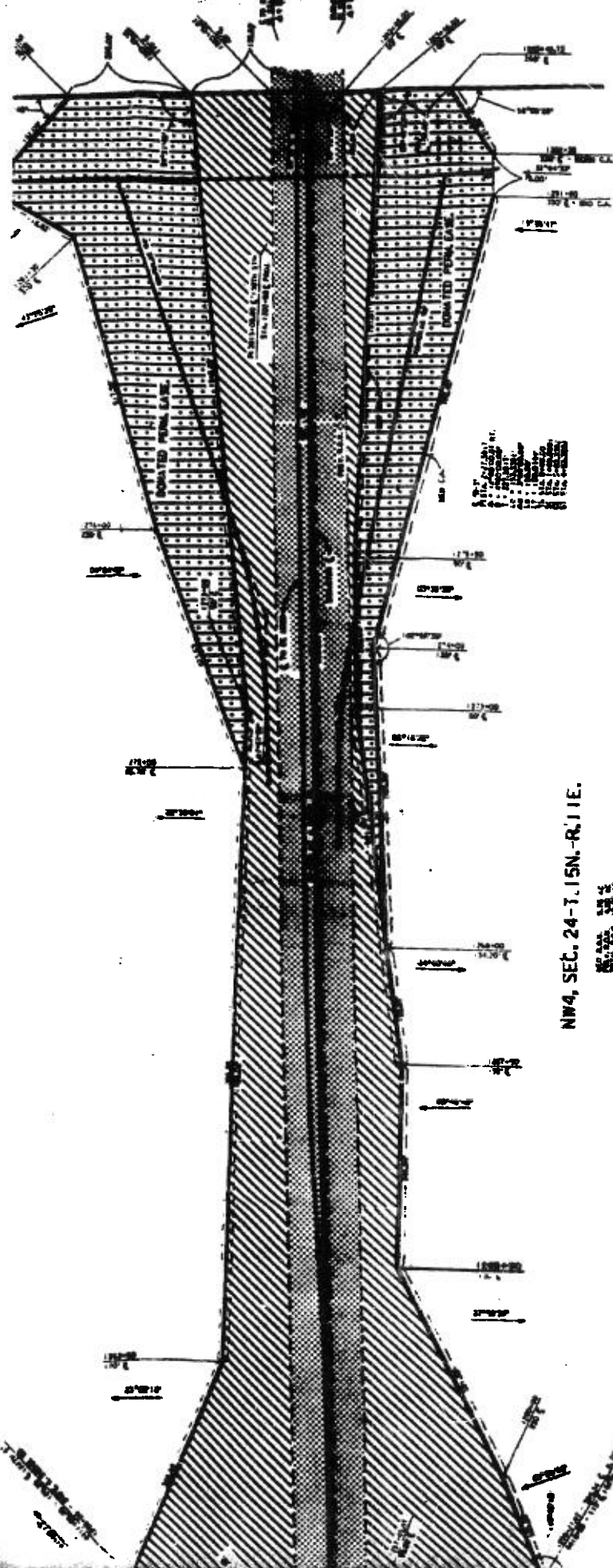

1994年12月

सर्वोच्च न्यायालय

11. **11.000000**

THE UNIVERSITY OF CHICAGO

Abstract

10-10-2010

23

THE

BOOK 939 PAGE 116

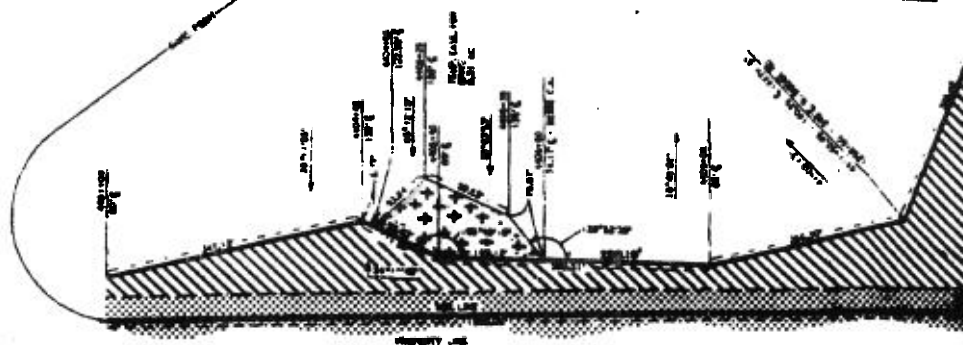

19 25 2003
18 25 2003
17 25 2003
16 25 2003
15 25 2003
14 25 2003
13 25 2003
12 25 2003
11 25 2003
10 25 2003
09 25 2003
08 25 2003
07 25 2003
06 25 2003
05 25 2003
04 25 2003
03 25 2003
02 25 2003
01 25 2003
31 12 2002
30 12 2002
29 12 2002
28 12 2002
27 12 2002
26 12 2002
25 12 2002
24 12 2002
23 12 2002
22 12 2002
21 12 2002
20 12 2002
19 12 2002
18 12 2002
17 12 2002
16 12 2002
15 12 2002
14 12 2002
13 12 2002
12 12 2002
11 12 2002
10 12 2002
09 12 2002
08 12 2002
07 12 2002
06 12 2002
05 12 2002
04 12 2002
03 12 2002
02 12 2002
01 12 2002
31 11 2002
30 11 2002
29 11 2002
28 11 2002
27 11 2002
26 11 2002
25 11 2002
24 11 2002
23 11 2002
22 11 2002
21 11 2002
20 11 2002
19 11 2002
18 11 2002
17 11 2002
16 11 2002
15 11 2002
14 11 2002
13 11 2002
12 11 2002
11 11 2002
10 11 2002
09 11 2002
08 11 2002
07 11 2002
06 11 2002
05 11 2002
04 11 2002
03 11 2002
02 11 2002
01 11 2002
31 10 2002
30 10 2002
29 10 2002
28 10 2002
27 10 2002
26 10 2002
25 10 2002
24 10 2002
23 10 2002
22 10 2002
21 10 2002
20 10 2002
19 10 2002
18 10 2002
17 10 2002
16 10 2002
15 10 2002
14 10 2002
13 10 2002
12 10 2002
11 10 2002
10 10 2002
09 10 2002
08 10 2002
07 10 2002
06 10 2002
05 10 2002
04 10 2002
03 10 2002
02 10 2002
01 10 2002
31 09 2002
30 09 2002
29 09 2002
28 09 2002
27 09 2002
26 09 2002
25 09 2002
24 09 2002
23 09 2002
22 09 2002
21 09 2002
20 09 2002
19 09 2002
18 09 2002
17 09 2002
16 09 2002
15 09 2002
14 09 2002
13 09 2002
12 09 2002
11 09 2002
10 09 2002
09 09 2002
08 09 2002
07 09 2002
06 09 2002
05 09 2002
04 09 2002
03 09 2002
02 09 2002
01 09 2002
31 08 2002
30 08 2002
29 08 2002
28 08 2002
27 08 2002
26 08 2002
25 08 2002
24 08 2002
23 08 2002
22 08 2002
21 08 2002
20 08 2002
19 08 2002
18 08 2002
17 08 2002
16 08 2002
15 08 2002
14 08 2002
13 08 2002
12 08 2002
11 08 2002
10 08 2002
09 08 2002
08 08 2002
07 08 2002
06 08 2002
05 08 2002
04 08 2002
03 08 2002
02 08 2002
01 08 2002
31 07 2002
30 07 2002
29 07 2002
28 07 2002
27 07 2002
26 07 2002
25 07 2002
24 07 2002
23 07 2002
22 07 2002
21 07 2002
20 07 2002
19 07 2002
18 07 2002
17 07 2002
16 07 2002
15 07 2002
14 07 2002
13 07 2002
12 07 2002
11 07 2002
10 07 2002
09 07 2002
08 07 2002
07 07 2002
06 07 2002
05 07 2002
04 07 2002
03 07 2002
02 07 2002
01 07 2002
31 06 2002
30 06 2002
29 06 2002
28 06 2002
27 06 2002
26 06 2002
25 06 2002
24 06 2002
23 06 2002
22 06 2002
21 06 2002
20 06 2002
19 06 2002
18 06 2002
17 06 2002
16 06 2002
15 06 2002
14 06 2002
13 06 2002
12 06 2002
11 06 2002
10 06 2002
09 06 2002
08 06 2002
07 06 2002
06 06 2002
05 06 2002
04 06 2002
03 06 2002
02 06 2002
01 06 2002
31 05 2002
30 05 2002
29 05 2002
28 05 2002
27 05 2002
26 05 2002
25 05 2002
24 05 2002
23 05 2002
22 05 2002
21 05 2002
20 05 2002
19 05 2002
18 05 2002
17 05 2002
16 05 2002
15 05 2002
14 05 2002
13 05 2002
12 05 2002
11 05 2002
10 05 2002
09 05 2002
08 05 2002
07 05 2002
06 05 2002
05 05 2002
04 05 2002
03 05 2002
02 05 2002
01 05 2002
31 04 2002
30 04 2002
29 04 2002
28 04 2002
27 04 2002
26 04 2002
25 04 2002
24 04 2002
23 04 2002
22 04 2002
21 04 2002
20 04 2002
19 04 2002
18 04 2002
17 04 2002
16 04 2002
15 04 2002
14 04 2002
13 04 2002
12 04 2002
11 04 2002
10 04 2002
09 04 2002
08 04 2002
07 04 2002
06 04 2002
05 04 2002
04 04 2002
03 04 2002
02 04 2002
01 04 2002
31 03 2002
30 03 2002
29 03 2002
28 03 2002
27 03 2002
26 03 2002
25 03 2002
24 03 2002
23 03 2002
22 03 2002
21 03 2002
20 03 2002
19 03 2002
18 03 2002
17 03 2002
16 03 2002
15 03 2002
14 03 2002
13 03 2002
12 03 2002
11 03 2002
10 03 2002
09 03 2002
08 03 2002
07 03 2002
06 03 2002
05 03 2002
04 03 2002
03 03 2002
02 03 2002
01 03 2002
31 02 2002
30 02 2002
29 02 2002
28 02 2002
27 02 2002
26 02 2002
25 02 2002
24 02 2002
23 02 2002
22 02 2002
21 02 2002
20 02 2002
19

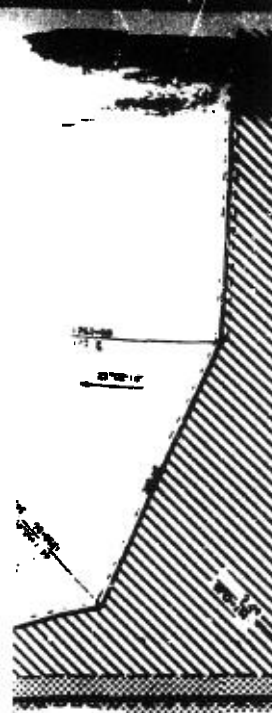

THE UNIVERSITY OF CHICAGO

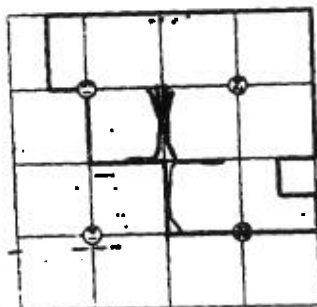
22 ~~SECRET~~

THE UNIVERSITY OF CHICAGO PRESS

BOOK 939 PAGE 117

NE 4, SEC. 23-T. 15N.-R. 11E.

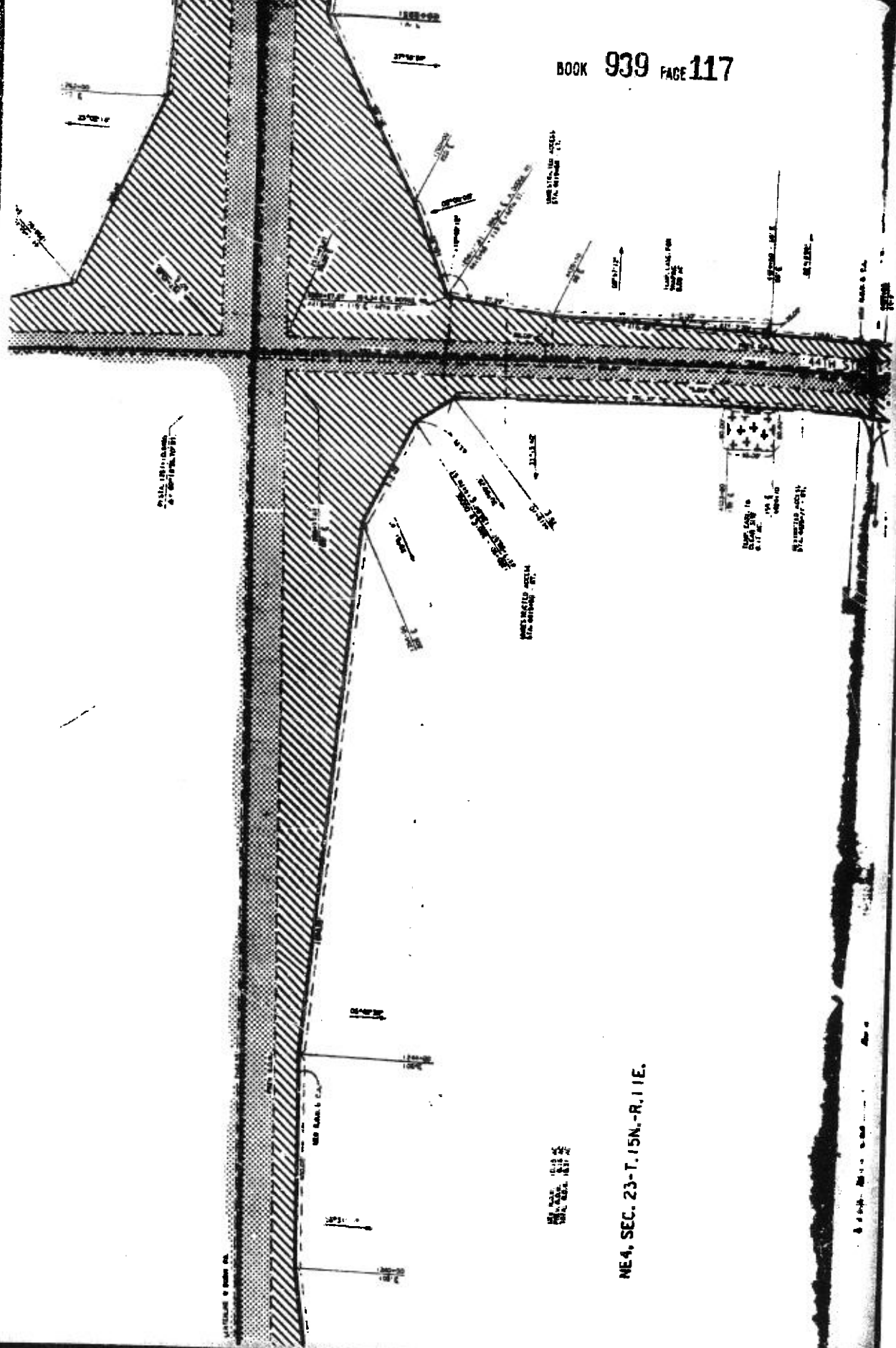

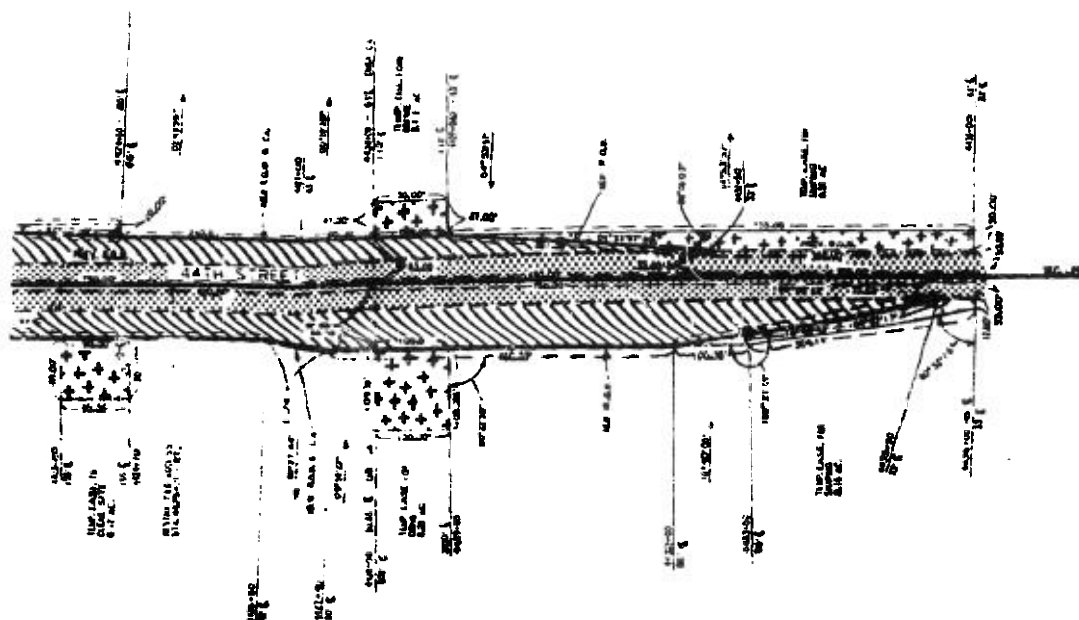

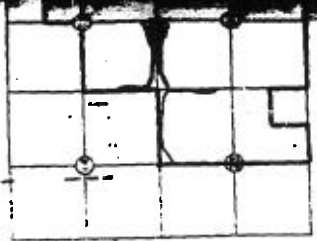





BOOK 939 PAGE 119

PLAT SHOWING
RIGHT OF WAY
TO BE ACQUIRED FROM LAND OWNED BY
FATHER FLANAGAN'S BOYS' HOME, A NEBRASKA CORPORATION

STATE OF NEBRASKA
DEPARTMENT OF ROADS
RIGHT OF WAY DIVISION
LINCOLN, NEBRASKA

TRACT NO. 15
LOCATION 26TH to 162ND W. DODGE RD.
PROJECT NO. F-6-7(134)
CONTROL NO. 21212

SCALE 1" = 200'

PREV. R.O.V. 
NEW R.O.V. 
TEMP. EASE. 
PERM. EASE. 
CONTROLLED ACCESS 

36.61 AC
17.39 AC

DRAWN BY B.G. 06/19/90
CHECKED BY R.B. 06/19/90
COMPUTED BY
WRITTEN BY
CHECKED BY

BOOK 939 PAGE 120

NE 1/4, SEC. 23-T, 15N.-R. 11E.

NE 1/4, SEC. 23-T, 15N.-R. 11E.

23.155 AC.
FUTURE UNRESTRICTED ACCESS

200'

30
3/90

S

BOOK 939 PAGE 121

SHEET 1 OF 2

S[

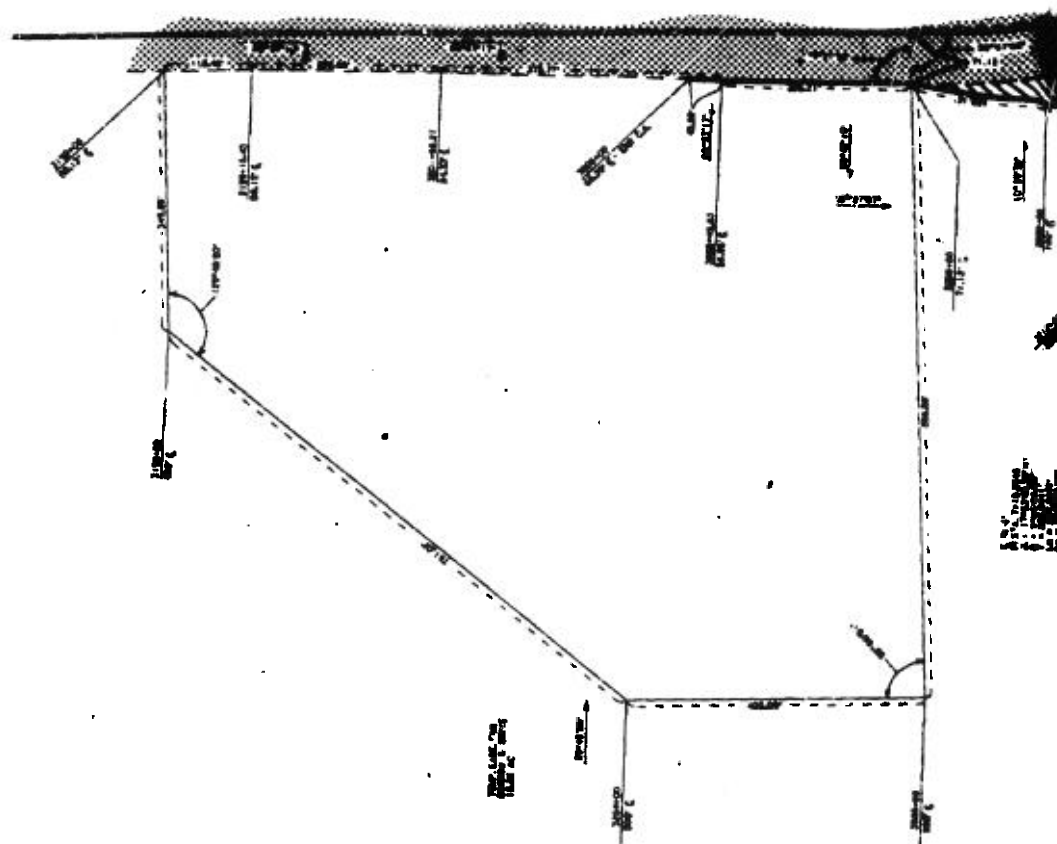

N

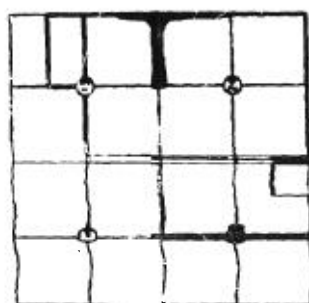

SECTION 13-T-15N-R-11E

SECTION 13-T-15N-R-11E

SECTION 13-T-15N-R-11E



SECTION 13-T-15N-R-11E

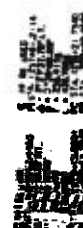

SE4, SEC. 13-T.15N.-R.11E.

NE4, SEC. 24-T.15N.-R.11E.

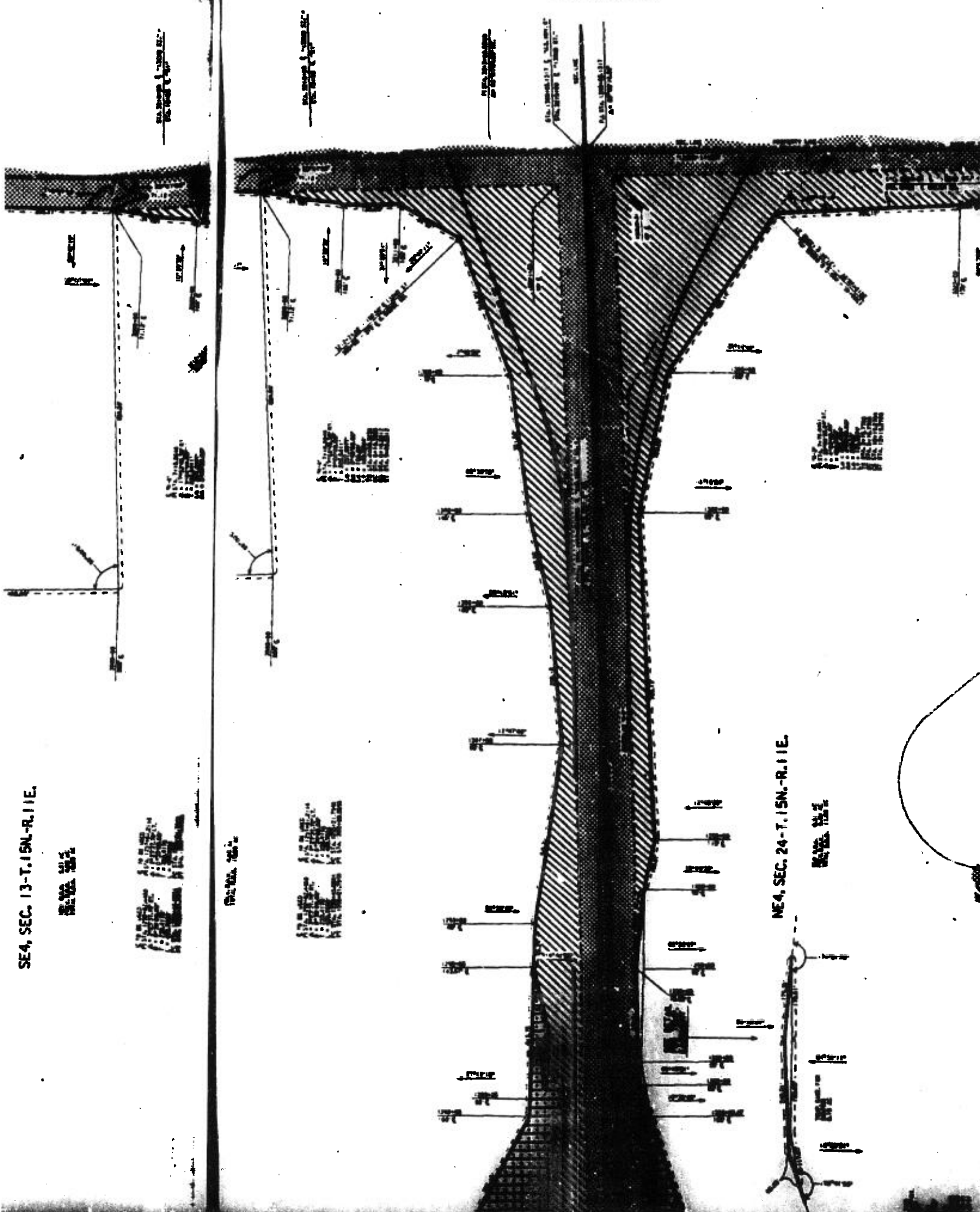

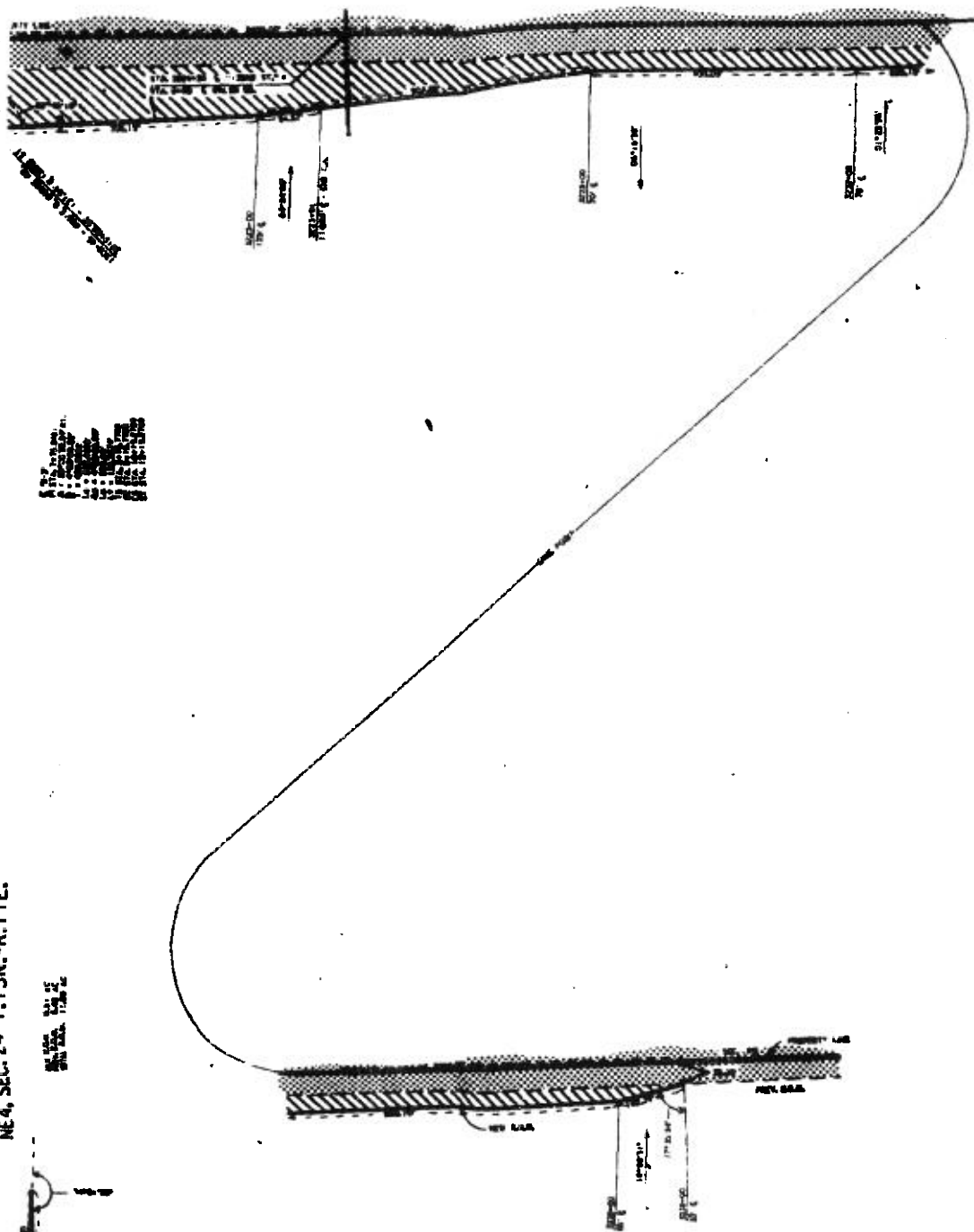

NE 4, SEC. 24-1, 10N-10E

110.00
110.00
110.00

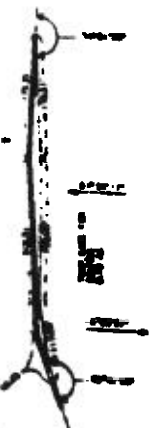

ZZ

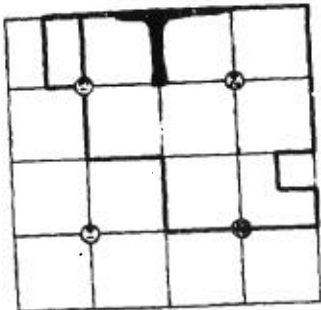

SE 4, SEC. 13-T.15N.-R.11E.

SE 4, SEC. 13-T.15N.-R.11E.

SE 4, SEC. 13-T.15N.-R.11E.

SE 4, SEC. 13-T.15N.-R.11E.

BOOK 939 PAGE 125

SE 4, SEC. 13-T.15N.-R.11E.

PLAN SHOWING
RIGHT OF WAY
TO BE ACQUIRED FROM LAND OWNED BY
FATHER FLANAGAN'S BOYS' HOME, A NEBRASKA CORPORATION

STATE OF NEBRASKA
DEPARTMENT OF ROADS
RIGHT OF WAY DIVISION
LINCOLN, NEBRASKA

TRACT NO.
LOCATION
PROJECT NO.
CONTROL NO.

15
126TH to 162ND W. DODGE RD.
F-6-7(134)
21212

SCALE 1" = 200'

PREV. R.O.W.
NEW R.O.W. 36.61 AC
TEMP. EASE. 17.38 AC
PERM. EASE.
CONTROLLED ACCESS

DRAWN BY B.G. 06/19/90
CHECKED BY R.B. 06/19/90
COMPUTED BY J.B.M. 7/10
WRITTEN BY J.B.M. 7/10
CHECKED BY J.B.M. 7/10

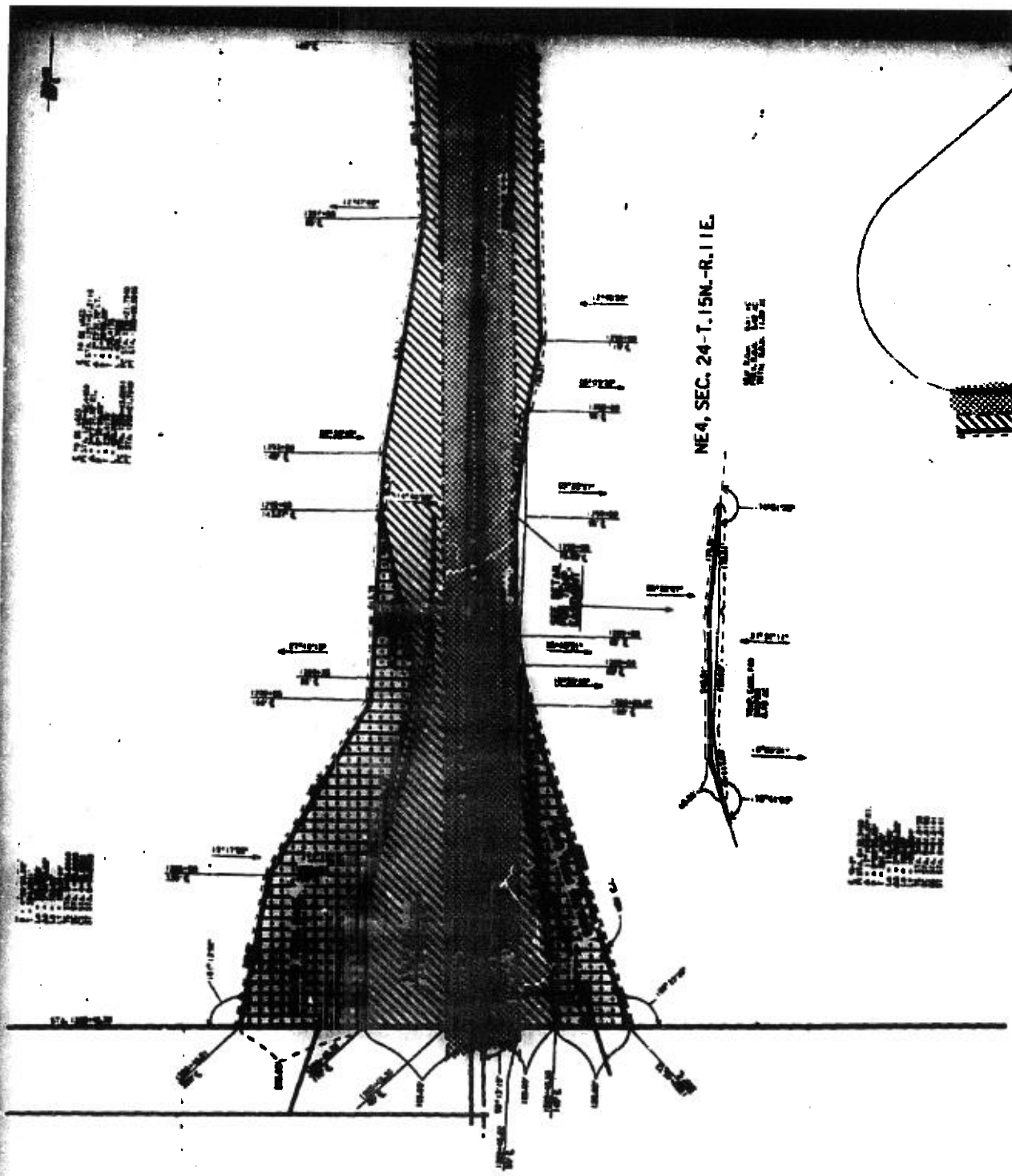

NE 4, SEC. 24-T. 15N.-R. 11E.

BOOK 939 PAGE 126

1" = 200'
RD.

19/90
6/19/90
7/10
1/10

SHEE

NE4, SEC. 24-T.15N.-R.11E.

NE4, SEC. 24-T.15N.-R.11E.

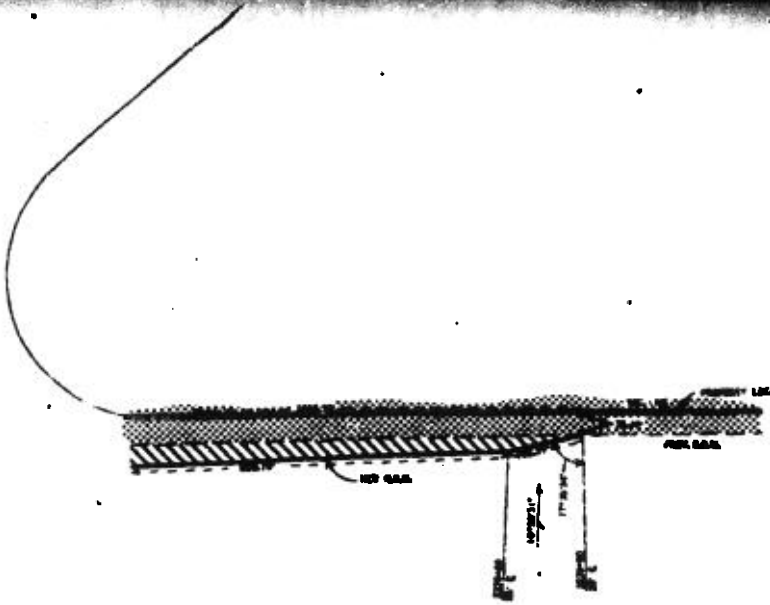

BOOK 939 PAGE 127

Et.

SHEET 2 OF 2

E

Now, therefore, we as appraisers aforesaid, do hereby find and appraise the damages that will be suffered by reason of the appropriation of title to the said property or any interest therein described for State highway purposes by the State of Nebraska, Department of Roads, in the amount of:

TOTAL AMOUNT AWARDED FOR ACQUISITION OF TRACT 15 \$2,847,270.⁰⁰

Award to be distributed as follows:

To: Father Flanagan's Boys' Home, \$2,847,270.⁰⁰
A Nebraska Corporation, Owner;

All of which is hereby respectfully submitted.

Dated this 21st day of September, A.D. 1990.

Robert E. Wilson
Thomas M. Whiston
and [Signature]
Appraisers

Filed this _____ day of _____, A.D. 1990.
(SEAL)

County Judge

FILED
COUNTY COURT
PROBATE DIVISION
SEP 27 1990
DOUGLAS COUNTY, NEBRASKA

STATE OF

PL 22 (S)

STA

COU

Cou

entri

Matt

DAT

(See

STATE OF NEBRASKA

PR 33 (8/88)

CERTIFICATE

Doc. C6

Page 53

Douglas County Court, Probate Division
17th & Farnam Streets, 3-West, Omaha, NE 68163 (402) 444-7182

STATE OF NEBRASKA
COUNTY OF DOUGLAS

SS.

BOOK 939 PAGE 129

I, Janet Langle

Registrar

Deputy Clerk of the Douglas

County Court, certify that the attached documents are full, true and complete copies of the original records of entries identified as follows: "REPORT OF APPRAISERS, in re:

STATE OF NEBRASKA, DEPARTMENT OF ROADS, Condemner, vs.

FATHER FLANAGAN'S BOYS' HOME, Condemnees

on file and of record in the Douglas County Court, entitled: in the
Matter of Condemnation Docket C6 Page 53

IN TESTIMONY WHEREOF, I have placed my signature and the seal of said Court.

DATE: 9/24/90

BY THE COURT:

Registrar

Deputy Clerk

(Seal)

