

25-145
1

89-232

Introduce: 8-28-89

ORDINANCE NO. 15295

01 AN ORDINANCE creating Sidewalk Improvement District No. 85,
02 defining the limits thereof, providing for the construction, reconstruction,
03 replacement, or repair of public sidewalks therein, providing for the payment
04 of the cost thereof, designating the property to be benefited, providing for
05 the acquisition of easements and additional right-of-way, if necessary, and
06 repealing all ordinances or parts of ordinances in conflict herewith.

07 BE IT ORDAINED by the City Council of the City of Lincoln, Nebraska:

08 Section 1. That Sidewalk Improvement District No. 85, of the City of
09 Lincoln, Nebraska, be and the same is hereby created, that said Sidewalk
10 Improvement District shall include that area bounded on the north by Holdrege
11 Street; on the east by 70th Street; on the south by "A" Street; and on the
12 west by 48th Street; with construction, reconstruction, replacement or repair
13 of sidewalks as approved by the Director of Public Works for the following
14 described real estate benefited to-wit: All those properties legally described
15 in the attached "Exhibit A" which is hereby incorporated herein.

16 The cost of constructing, reconstructing, replacing or repairing the
17 sidewalks in said District, including the cost of grading the sidewalk space
18 and public street between the curb line and the property line and all
19 expenses incidental to all of this improvement shall be assessed against the
20 property benefited in said District in proportion to the benefits not
21 exceeding the cost thereof. In the event that easements or additional
22 right-of-way must be acquired for the completion of this district, such
23 property rights may be acquired by negotiation and purchase or by
24 condemnation, if necessary, as provided by law.

2

01 : 2. That all ordinances and parts of ordinances in conflict herewith be
02 and the same hereby are repealed.

03 3. This ordinance shall take effect and be in force from and after its
04 passage and publication according to law, but construction shall not be
05 commenced until ordered by resolution by the City Council.

Introduced by

Kenneth W. Haar

Approved as to Form:

Donna W. Poyer
City Attorney

AYES: Gutschell, Haar, Hempel,
Johanns, Seng, Wilson;
NAYS: None.
ABSENT: Minnick.

Approved as to Description:

Ruth Robinson
City Engineer

Staff Review Completed:

[Signature]
Administrative Assistant

Preliminary Cost Estimate:

KKH1077

APPROVED

SEP 19, 1989

Bill Harris
MAYOR

FASSEL

SEP 11 1989

CITY COUNCIL

3

C E R T I F I C A T E

I, Paul A. Malzer, City Clerk of the City of Lincoln, Nebraska, do certify that the above and foregoing is a true and correct copy of Ordinance No. 15295 - Creating Sidewalk Improvement District No. 85

as passed and approved by the City Council of the City of Lincoln, Nebraska, at its meeting held September 11, 1989 as the original appears of record in my office, and is now in my charge remaining as City Clerk aforesaid.

IN WITNESS WHEREOF, I have hereunto set my hand officially and affixed the seal of the City of Lincoln, Nebraska, this 13th day of September, 1989.

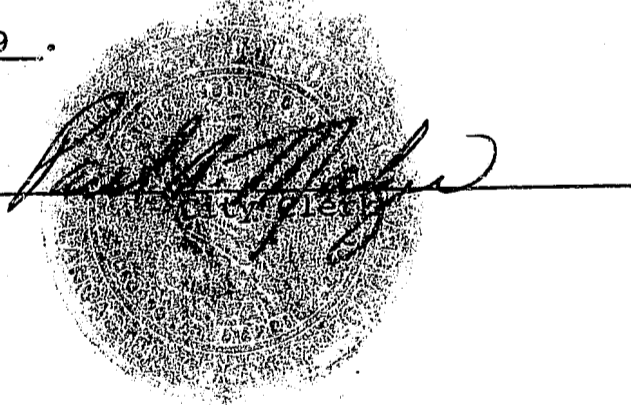
A handwritten signature in cursive, appearing to read "Paul A. Malzer", is written over a circular official seal. The seal is embossed and contains text that is mostly illegible due to the quality of the scan, but it appears to be the official seal of the City of Lincoln, Nebraska.

4

2

TAX # 1055849
INSPTR 6930 L ST, SUITE A
DC LINCOLN, NE 68510

LEGAL YORK'S SUB
LOT 4 BLK 1

York X

SECTION 1-2

Block 38

SEQUENCE 3 LOCATION 06930 L ST

1055822 H R B & H A PARTNERSHIP
INSPTR % GMAC MORTGAGE CORP
DC 8360 OLD YORK RD
ELKINS PARK, PA 19117

LEGAL YORK'S SUB
LOTS 1 & 2 BLK 1

York X

SECTION 1-2

Block 1

SEQUENCE 5 LOCATION 00301 SO 70 ST
FC

0725111 ANDERSON, SHIRLEY
INSPTR 430 WEDGEWOOD
DC LINCOLN, NE 68510

LEGAL IRREGULAR TRACT LOT 72 NE
28-10-7

X

SECTION 1-2

SEQUENCE 7 LOCATION 00245 SO 70 ST

0725137 WEIGEL, ROBERT A & JOANNE M
INSPTR 339 NO COTNER #3
DC LINCOLN, NE 68505

LEGAL IRREG TRACT
LOT 55 NE & S30' N85'
W40.2'
E635.3' NE 28-10-7

X

SECTION 1-2

SEQUENCE 8 LOCATION 06811 D
ST/HY-VEE/SIZZLER/LONG JOHN

1389020 RIERDEN, J MICHAEL TRUSTEE
INSPTR %SHOPKO STORES INC
DC ATTN:TAX DEPT PO BOX
19060GREENBAY, WI 54307

LEGAL IRREGULAR TRACT LOT 74 NE
EX E30' & LOT 75 NE EX W PT
FOR ROAD & THAT PT OF
TAYLOR PARK ADJ LYING N OF
TAYLOR PARK DR 28-10-7

X

SECTION 1-2

SEQUENCE 11 LOCATION 06801 D ST

1232759 CRAIG, PAUL E
INSPTR 1034 ROCKHURST DR
DC LINCOLN, NE 68510

LEGAL TAYLOR MEADOWS 3RD ADD LOT
16

TAME 3 X

No Block

SECTION 1-2

SEQUENCE 14 LOCATION 01034 ROCKHURST DR

6

5

3

TAX # 0952141
NAME AND ADDRESS WALLY, JAMES J & JANE E
INSPTR 6309 RAINIER CT
DC LINCOLN, NE 68510

LEGAL TAYLOR MEADOWS BLOCK 1 LOT
8 EX PT ADJ TO LOT 9 & W35
LOT 7

Block 1

TAME
3

SECTION 1-2

SEQUENCE 15 LOCATION 06305 RAINIER DR.

TAX # 0521612
NAME AND ADDRESS CONROY, JAMES F & GRACE N
INSPTR 320 PIAZZA TERRACE
DC LINCOLN, NE 68510

LEGAL CASINO HEIGHTS BLOCK 1 LOT
13

CASHE

SECTION 1-2

SEQUENCE 21 LOCATION 00230 PIAZZA TER

TAX # 0521621
NAME AND ADDRESS ENGEL, MICHAEL L & BONNIE
INSPTR 238 PIAZZA TERRACE
DC LINCOLN, NEBR. 68510

LEGAL CASINO HEIGHTS BLOCK 1 LOT
14

CASHE

SECTION 1-2

SEQUENCE 22 LOCATION 00238 PIAZZA TER

TAX # 0521639
NAME AND ADDRESS PARKENING, RALPH L & RUTH E
INSPTR 5508 M
DC LINCOLN, NE 68510

LEGAL CASINO HEIGHTS BLOCK 1 LOT
15

CASHE

SECTION 1-2

SEQUENCE 23 LOCATION 05508 M ST

TAX # 0521647
NAME AND ADDRESS ROESLER, LAWRENCE & FRANCES
INSPTR 5540 M ST
DC LINCOLN, NEBR. 68510

LEGAL CASINO HEIGHTS BLOCK 1 LOT
16

CASHE

SECTION 1-2

SEQUENCE 24 LOCATION 05540 M ST

TAX # 0521523
NAME AND ADDRESS COMMERCIAL FEDERAL SAVINGS &
INSPTR LOAN ATTN: ACCTS PAYABLE
DC 13TH FLOOR TOWER 2120 SO 72ND
ST. OMAHA, NE 68124

LEGAL CASINO HEIGHTS BLK 1 LOT 1
EX 79.3 SQ FT &
ALL LOTS 2 & 3

CASHE

SECTION 1-2

SEQUENCE 25 LOCATION 05533 O ST

6

6

4

TAX # NAME AND ADDRESS
 1442729 PONSIGA, GIUSEPPE
 INSPTR %JEFF JOHNSON
 DC 5401 O ST
 LINCOLN, NE 68505

LEGAL
 CASINO HEIGHTS BLOCK 1 LOTS
 8 & 9 EX NW PT LOT 9 FOR
 STREET

CRSHE

SECTION 1-2

SEQUENCE 27

LOCATION 5401 "O" STREET

0521834 NORDEN, ALVIN J & DOROTHY J
 INSPTR 245 PIAZZA TERRACE
 DC LINCOLN, NEBR. 68510

CASINO HEIGHTS BLOCK 2 LOT
 19

CRSHE

SECTION 1-2

SEQUENCE 28

LOCATION 00245 PIAZZA TER

0521876 BOETTCHER, ALLEN L
 INSPTR 5434 M ST
 DC LINCOLN, NEBR. 68510

CASINO HEIGHTS BLOCK 2 LOT
 18

CRSHE

SECTION 1-2

SEQUENCE 29

LOCATION 05434 M ST

0521850 BENNER, OTTO R & KATHERINE
 INSPTR 5412 M
 DC LINCOLN, NE 68510

CASINO HEIGHTS BLOCK 2 LOT
 16

CRSHE

SECTION 1-2

SEQUENCE 30

LOCATION 05412 M ST

0521833 SIERADZKI, BARBARA L
 INSPTR 5340 M ST
 DC LINCOLN, NE 68510

CASINO HEIGHTS BLOCK 2 LOT
 14

CRSHE

SECTION 1-2

SEQUENCE 31

LOCATION 05340 M ST

0521825 EISENTRAGER, JAMES A & ELVERA
 INSPTR 5114 M
 DC LINCOLN, NE 68510

CASINO HEIGHTS BLOCK 2 LOT
 13

CRSHE

SECTION 1-2

SEQUENCE 32

LOCATION 05334 M ST

6

7

5

TAX # NAME AND ADDRESS
0521817 SMITH, DONALD K & CRYSTAL
INSPTR 5324 M
DC LINCOLN, NE 68510

LEGAL
CASINO HEIGHTS BLOCK 2 LOT
12

Handwritten notes:
0521817 ✓
23

SECTION 1-2

SEQUENCE 33 LOCATION 05324 M ST

0521809 FRANSON, BRUCE R & BRIDGET M
INSPTR 5316 M
DC LINCOLN, NE 68510

CASINO HEIGHTS BLOCK 2 LOT
11

Handwritten notes:
0521809 ✓

SECTION 1-2

SEQUENCE 34 LOCATION 05316 M ST

0852741 MAPES, CHERYL
INSPTR 100 ND 12
DC LINCOLN, NE 68508

PIEDMONT SUB BLOCK 10 LOT 8

Handwritten notes:
0852741 ✓

SECTION 1-2

SEQUENCE 41 LOCATION 01256 FALL CREEK RD

0852724 PATZEL, STANLEY L & MARY LOU
INSPTR 1313 PIEDMONT RD
DC LINCOLN, NE 68510

PIEDMONT SUB BLOCK 10 LOT 6

Handwritten notes:
0852724 ✓

SECTION 1-2

SEQUENCE 43 LOCATION 01313 PIEDMONT RD

0852333 KNOX, ELLIS G & JANE FOSTER
INSPTR 1040 PIEDMONT RD
DC LINCOLN, NE 68510

PIEDMONT SUB BLOCK 6 LOT 4

Handwritten notes:
0852333 ✓

SECTION 1-2

SEQUENCE 44 LOCATION 01040 PIEDMONT RD

0852341 ODE, ARTHUR H JR & JOAN F
INSPTR 1010 PIEDMONT
DC LINCOLN, NE 68510

PIEDMONT SUB BLOCK 6 LOT 5

Handwritten notes:
0852341 ✓

SECTION 1-2

SEQUENCE 45 LOCATION 01010 PIEDMONT RD

6

8

6

TAX # NAME AND ADDRESS
0852309 DZERK, VIRGINIA M
INSPTR 5445 VALLEY RD
DC LINCOLN, NEBR. 68510

LEGAL
PIEDMONT SUB BLOCK 6 LOT 1

Piedmont

SECTION 1-2

SEQUENCE 46 LOCATION 05344 VALLEY RD

0852376 EDWARDS, JANE B
INSPTR 1111 PIEDMONT RD
DC LINCOLN, NEBR. 68510

LEGAL
PIEDMONT SUB BLOCK 7 LOT 3

Piedmont

SECTION 1-2

SEQUENCE 48 LOCATION 01111 PIEDMONT RD

0852368 REINHARDT, ALEX & AMELIA
INSPTR % WEYENETH, ERNEST & DEE ANNE
DC (CONT) 1045 PIEDMONT RD
LINCOLN, NE 68510

LEGAL
PIEDMONT SUB BLOCK 7 LOT 2

Piedmont

SECTION 1-2

SEQUENCE 49 LOCATION 01045 PIEDMONT RD

0852350 BETTMAN, PRENTISS & EVELYN
INSPTR 1001 PIEDMONT
DC LINCOLN, NEBR. 68510

LEGAL
PIEDMONT SUB BLOCK 7 LOT 1

Piedmont

SECTION 1-2

SEQUENCE 50 LOCATION 01301 PIEDMONT RD

0852384 BAUER, WILLIAM B & SHIRLEY
INSPTR 1117 PIEDMONT ROAD
DC LINCOLN, NEBR. 68510

LEGAL
PIEDMONT SUB BLOCK 7 LOT 4

Piedmont

SECTION 1-2

SEQUENCE 52 LOCATION 01125 SD CORNER BLV

0768481 MELSON, ETHEL A.
INSPTR 900 S 48
DC LINCOLN, NEBR. 68510

LEGAL
LINWOOD ADD BLOCK 2 LOT 12

Linwood

SECTION 1-2

SEQUENCE 59 LOCATION 00900 SD 48 ST

6

9

7

TAX # NAME AND ADDRESS
0768497 HORNBY, FRANCIS W & VIVIAN D
INSPTR 1121 COTTONWOOD DR
DC LINCOLN, NE 68510

LEGAL
LINWOOD ADD BLOCK 2 LOT 13

Linwood X

SECTION 1-2

SEQUENCE 59 LOCATION 00910 SD 48 ST

0768502 YETTER, WALTER A
INSPTR 920 SD 48
DC LINCOLN, NE 68510

LINWOOD ADD BLOCK 2 ALL LOT
14 & N HALF LOT 15

Linwood X

SECTION 1-2

SEQUENCE 60 LOCATION 00920 SD 48 ST

0768545 FOGHT, ESTELLA H
INSPTR 4848 VALLEY RD
DC LINCOLN, NE 68510

LINWOOD ADD BLOCK 2 LOT 19
S77 OF E61&17NTS
LOT 20 S77

Linwood X

SECTION 1-2

SEQUENCE 63 LOCATION 04845 VALLEY RD

0768308 PALMER, MADELYN M
INSPTR 964 S 49
DC LINCOLN, NE 68510

LINWOOD ADD BLOCK 1 S76'
LOTS 16 & 17

Linwood

SECTION 1-2

SEQUENCE 64 LOCATION 00954 SD 49 ST

0768316 MARSH, DONALD F & HELEN T
INSPTR 4920 VALLEY RD
DC LINCOLN, NE 68510

LINWOOD ADD BLOCK 1 LOT 18
& W10' LOT 10

Linwood

SECTION 1-2

SEQUENCE 65 LOCATION 04920 VALLEY RD

0768324 PLACE, GEORGE E & ELIZABETH A
INSPTR 4940 VALLEY RD
DC LINCOLN, NEBR. 68510

LINWOOD ADD BLOCK 1 ALL LOT
20 EX W10' L19

*66 19 pt 50
Linwood*

SECTION 1-2

SEQUENCE 66 LOCATION 04940 VALLEY RD

7

10

8

TAX # NAME AND ADDRESS LEGAL
 1025460 TOBISKA, KENNETH A. & FLORINE W WITTS SUB LOT 3
 INSPTR 5000 VALLEY RD
 DC LINCOLN, NE 68510

WITTS
23

SECTION 1-2

SEQUENCE 67 LOCATION 05000 VALLEY RD

1025478 WITKOWICZ, PETRO & JOSEPHINE WITTS SUB LOT 4
 INSPTR 934 SD 50
 DC LINCOLN, NE 68510

WITTS

SECTION 1-2

SEQUENCE 68 LOCATION 00934 SD 50 ST

0679208 MILLER, JAMES H & HIGHLAND HOME 29-10-7 LOT 2
 INSPTR MILLER, JAMES A & PATRICIA E EX N351' &
 DC 850 SD 50 EX E165' BLOCK 1
 LINCOLN, NE 68510

HIGHLAND

SECTION 1-2

SEQUENCE 73 LOCATION 00850 SD 50 ST

0679186 JUENSEL, RAYMOND L & EVETTE S HIGHLAND HOME 29-10-7 560'
 INSPTR 830 SOUTH 50 N291' EX E165'
 DC LINCOLN, NEBR. 68510 LOT 2 BLOCK 1

HIGHLAND

SECTION 1-2

SEQUENCE 74 LOCATION 00830 SD 50 ST

0768171 DAY, VICTOR W & CYNTHIA S LINWOOD ADD BLOCK 1 LOT 4
 INSPTR 1701 PLEASANT HILL RD N70&STINTS OF W50
 DC LINCOLN, NE 68523 LOT 5 N70&STINTS

LINWOOD

SECTION 1-2

SEQUENCE 75 LOCATION 00800 SD 49 ST

0679180 TEMPLE BAPTIST CHURCH HIGHLAND HOME N171' EX ST
 INSPTR 4940 RANDOLPH L2 B1 25-10-7
 DC LINCOLN, NE 68510

HIGHLAND

SECTION 1-2

SEQUENCE 76 LOCATION 00820 SD 50 ST

6

11

9

TAX # 0937525
NAME AND ADDRESS STONER, ROY C & SHERRY L
INSPTR 5105 RANDOLPH
DC LINCOLN, NE 68510

LEGAL
STASTNEYS SUB W50' LOTS 16,
17 & 18

STASTNEYS ✓

SECTION 1-2

NO 3100

SEQUENCE 80 LOCATION 05105 RANDOLPH ST

TAX # 0937541
NAME AND ADDRESS WATKINS, SUZANNE
INSPTR 5121 RANDOLPH
DC LINCOLN, NEBR. 68510

LEGAL
STASTNEYS SUB LOTS 16 TO 18
E50' W100'

STASTNEYS ✓

SECTION 1-2

NO 3100

SEQUENCE 81 LOCATION 05121 RANDOLPH ST

TAX # 0937452
NAME AND ADDRESS MATHESON, MICHAEL D
INSPTR 5149 RANDOLPH
DC LINCOLN, NE 68510

LEGAL
STASTNEYS SUB (EX W59') DR
E70' LOTS 1 TO 3
& W1/2 VAC 52ND ST ADJ

STASTNEYS

SECTION 1-2

NO 3100

SEQUENCE 83 LOCATION 05149 RANDOLPH ST

TAX # 1025451
NAME AND ADDRESS WITT, KARL A.
INSPTR 5032 VALLEY RD
DC LINCOLN, NE 68510

LEGAL
WITTS SUB LOT 2 S110

WITTS ✓

SECTION 1-2

SEQUENCE 84 LOCATION 05032 VALLEY RD

TAX # 0852040
NAME AND ADDRESS TULLIS, PATRICIA A
INSPTR RT 1 - BOX 106
DC EAGLE, NE 68437

LEGAL
PIEDMONT SUB BLOCK 1 LOT 8

PIEDMONT ✓

SECTION 1-2

SEQUENCE 85 LOCATION 00800 FALL CREEK RD

TAX # 0851973
NAME AND ADDRESS HINKLEY, LLOYD D & DONNA J
INSPTR 5440 FAIRDALE RD
DC LINCOLN, NEBR. 68510

LEGAL
PIEDMONT SUB BLOCK 1 LOT 1

PIEDMONT ✓

SECTION 1-2

SEQUENCE 88 LOCATION 05440 FAIRDALE RD

8

12

10

TAX #	NAME AND ADDRESS	LEGAL
0852031	STELLING, MORTON A & MARLENE L	PIEDMONT SUB BLOCK 1 LOT 7
INSPTR	5300 FAIRDALE	<i>Piedmont</i>
DC	LINCOLN, NE 68510	<i>10-</i>

SECTION 1-2

SEQUENCE	91	LOCATION	08300 FAIRDALE	RD
----------	----	----------	----------------	----

0852121	JOHNSON, JESSIE B	PIEDMONT SUB BLOCK 3 LOT 3
INSPTR	925 PIEDMONT RD	<i>Piedmont</i>
DC	LINCOLN, NEBR. 68510	

SECTION 1-2

SEQUENCE	92	LOCATION	00925 PIEDMONT	RD
----------	----	----------	----------------	----

0852198	MISLE, JULIUS & MIRIAM	PIEDMONT SUB BLOCK 4 LOT 2
INSPTR	919 SD COTNER	<i>Piedmont</i>
DC	LINCOLN, NE 68510	

SECTION 1-2

SEQUENCE	93	LOCATION	00919 SD COTNER	BLV
----------	----	----------	-----------------	-----

0852210	KIMBALL, WM T & BEVERLY W	PIEDMONT SUB BLOCK 4 LOT 4
INSPTR	800 SD 13 ST	<i>Piedmont</i>
DC	LINCOLN, NEBR. 68508	

SECTION 1-2

SEQUENCE	100	LOCATION	00969 SD COTNER	BLV
----------	-----	----------	-----------------	-----

0852225	SNOWDEN, JAMES A & NANCY J	PIEDMONT SUB BLOCK 4 LOT 5
INSPTR	940 PIEDMONT RD	<i>Piedmont</i>
DC	LINCOLN, NE 68510	

SECTION 1-2

SEQUENCE	101	LOCATION	00940 PIEDMONT	RD
----------	-----	----------	----------------	----

0852295	BREGORY, HILDA R	PIEDMONT SUB BLOCK 5 LOT 4
INSPTR	960 SD COTNER	<i>Piedmont</i>
DC	LINCOLN, NEBR. 68510	

SECTION 1-2

SEQUENCE	105	LOCATION	00960 SD COTNER	BLV
----------	-----	----------	-----------------	-----

6

13

11

TAX # 0852996
NAME AND ADDRESS MCCracken, DALE J & JOYCE M
INSPTR 5525 ELLENDALE RD
DC LINCOLN, NEBR. 68510

LEGAL
PIEDMONT SUB BLOCK 13 LOT 2

Piedmont

SECTION 1-2

SEQUENCE 114 LOCATION 05525 ELLENDALE RD

0852856 MITCHELL, GEORGE C & LAPRELE
INSPTR 1330 PIEDMONT
DC LINCOLN, NE 68510

LEGAL
PIEDMONT SUB BLOCK 11 LOT 8

Piedmont

SECTION 1-2

SEQUENCE 122 LOCATION 01330 PIEDMONT RD

0852864 GLENN, ROBERT W & MARY
INSPTR 1300 PIEDMONT
DC LINCOLN, NEBR. 68510

LEGAL
PIEDMONT SUB BLOCK 11 LOT 9

Piedmont

SECTION 1-2

SEQUENCE 123 LOCATION 01300 PIEDMONT RD

0852783 WRIGHT, THOMAS T. & MARY
INSPTR 1105 CRESTDALE
DC LINCOLN, NE 68510

LEGAL
PIEDMONT SUB BLOCK 11 LOT 1

Piedmont

SECTION 1-2

SEQUENCE 125 LOCATION 01105 CRESTDALE RD

0584866 RECHT, WILLIS R & THELMA L
INSPTR % BANGSUND,
DC KATHERINE (CONTRACT 400 LYNDEREST
LINCOLN, NEBR. 68510

LEGAL
EASTRIDGE ADD BLOCK 02 LOT 1

27/57 57 000

SECTION 1-2

SEQUENCE 132 LOCATION 00400 LYNDEREST DR

1247993 LINCOLN, CITY OF
INSPTR PARKS & RECREATION DEPT.
DC 2740 A STREET
LINCOLN, NE 68505

LEGAL
IRREGULAR TRACT LOT 28 NE
(TAYLOR PARK) EX TRACT N OF
TAYLORPARK DR. 28-10-7

SECTION 1-2

SEQUENCE 134 LOCATION PARKVALE SIDE/TAYLOR PARK

6

14

12

TAX # NAME AND ADDRESS
0955108 FAWL, CLIFFORD L & BARBARA L
INSPTR 651 HAVERFORD CR
DC LINCOLN, NEBR. 68510

LEGAL
TAYLOR PARK EAST BLOCK 1
LOT 17

TAPAC
29

SECTION 1-2

SEQUENCE 135 LOCATION 00651 HAVERFORD CIR

0955086 BURNS, JEFFREY J & LORI A
INSPTR 631 HAVERFORD CIR
DC LINCOLN, NE 68510

TAYLOR PARK EAST BLOCK 1
LOT 15

TAPAC
29

SECTION 1-2

SEQUENCE 136 LOCATION 00631 HAVERFORD CIR

0954624 WEST, VIRGIL A
INSPTR 220 TAYLOR PARK
DC LINCOLN, NE 68510

TAYLOR PARK ADD BLOCK 02
LOT 8

TAPAC
27

SECTION 1-2

SEQUENCE 138 LOCATION 00220 TAYLOR PARK DR

0869104 J HARTNETT FARMS INC
INSPTR 1735 SD 57
DC LINCOLN, NE 68505

RANDOLPH ACRES E140.4'
W165.4' LOT 23

F.A.C.
7.1 AC

SECTION 1-2

SEQUENCE 155 LOCATION 00420 SD 54 ST

0867236 PARK, YOUNG MIN & KYUNG
INSPTR 500 SD 54
DC LINCOLN, NE 68510

RANDOLPH ACRES LOT 27 EX W
25 W 1/2

F.A.C.
11B-

SECTION 1-2

SEQUENCE 159 LOCATION 00500 SD 54 ST

0869821 COLE, DIANE L & KOLUCH, KORIN
INSPTR 5315 L ST
DC LINCOLN, NE 68510

RANDOLPH ACRES
LOT 62 N1/2 E196.4' EX
E130' &
LOT 63 E196.4' EX E130'

F.A.C.

SECTION 1-2

SEQUENCE 161 LOCATION 05315 L ST

NO Bldg

6

15

13

TAX # NAME AND ADDRESS
0869082 LONDON, DAMON M & ANGELA M
INSPTR 5411 L ST
DC LINCOLN, NE 68510

LEGAL
RANDOLPH ACRES LOT 21 & 22
E50 OF W130

No Block

RHAC X

SECTION 1-2

SEQUENCE 162

LOCATION 05411 L ST

0869040 FONTAINE, EDWARD A & LEONA H
INSPTR 5417 L STREET
DC LINCOLN, NE 68510

RANDOLPH ACRES LOT 21&22
E50 OF W185

No Block

RHAC X

SECTION 1-2

SEQUENCE 163

LOCATION 05417 L ST

0615013 MEIER, GILBERT C & ANNA M
INSPTR 336 SD 55
DC LINCOLN, NEBR. 68510

FIENES REPLT PT LOT 8
LEMINGS:BLK 1 LOT 15

SECTION 1-2

SEQUENCE 165

LOCATION 00336 SD 55 ST

0615005 SCHUBERT, WILLIAM D
INSPTR 346 SD 55
DC LINCOLN, NEBR. 68510

FIENES REPLT PT LOT 8
LEMINGS:BLK 1 LOT 14

FIENES

SECTION 1-2

SEQUENCE 166

LOCATION 00348 SD 55 ST

0868612 BUTLER, MARY K
INSPTR 401 SD 56
DC LINCOLN, NE 68510

RANDOLPH ACRES N70.1' LOT 1

RHAC X
11B-

SECTION 1-2

SEQUENCE 168

LOCATION 09401 SD 56 ST

0615072 FARMER, DOUGLAS R & SHIRLEY L
INSPTR 5400 L
DC LINCOLN, NE 68510

FIENES REPLT PT LOT 8
LEMINGS:BLK 2 LOT 6

FIENES

SECTION 1-2

SEQUENCE 170

LOCATION 05400 L ST

6

16

14

TAX # 0521868
NAME AND ADDRESS ZOUCHA, GARY R. & PAULINE
INSPTR 5424 M
DC LINCOLN, NE 68510

LEGAL
CASINO HEIGHTS BLOCK 2 LOT
17

X

SECTION 1-2

SEQUENCE 180 LOCATION 05424 H ST.

0869449 KILLEEN, DONALD & LAURIE
INSPTR 735 SD 55
DC LINCOLN, NEBR. 68510

RANDOLPH ACRES LOT 39 582

NO BLOCK
RHAC

SECTION 1-2

SEQUENCE 182 LOCATION 00735 SD 55 ST

0868795 WENDT, BERNARD F & KATHERINE E
INSPTR 735 S 56
DC LINCOLN, NE 68510

RANDOLPH ACRES LOT 10

RHAC

SECTION 1-2

SEQUENCE 184 LOCATION 735 SOUTH 56 STREET

0869651 POTTER, ROBERT A &
INSPTR TABOREK, LINDA S
DC 524 SD 53
LINCOLN, NE 68510

RANDOLPH ACRES N30.3' LOT
55 EX E165.5' & S45.3' LOT
56 EX E165.5'

RHAC

SECTION 1-2

SEQUENCE 191 LOCATION 00524 SD 53 ST

0869686 SMITH, HAROLD W JR & LINDA S
INSPTR 510 SD 53
DC LINCOLN, NE 68510

RANDOLPH ACRES N15' LOT 56
EX E165.5 & W1/2 LOT 57

RHAC

SECTION 1-2

SEQUENCE 192 LOCATION 00510 SD 53 ST

0968927 SULLIVAN, JOHN & DEBRA ET AL
INSPTR 355 SD 54 STREET
DC LINCOLN, NEBR. 68510

TROENDLYS SUB LT 10 E HLF

TROENDLYS
NO BLOCK
18

SECTION 1-2

SEQUENCE 195 LOCATION 00355 SD 54 ST

0

17

15

TAX # NAME AND ADDRESS
0869813 DEONOR, RAYMOND C JR & CONNIE
INSPTR 410 SD 53
DC LINCOLN, NE 68510

LEGAL
RANDOLPH ACRES
LOT 62 N1/2 EX E196.4' & X
LOT 63
EX E 196.4'

SECTION 1-2

10500 AHAC

SEQUENCE 197 LOCATION 00410 SD 53 ST

0725188 TAYLOR INVESTMENT CO
INSPTR 244 SD COTNER
DC LINCOLN, NE 68510

IRREG TRACT L49 NW 28-10-7

SECTION 1-2

SEQUENCE 198 LOCATION 05645 D ST
F

0580261 TAYLOR FAMILY PARTNERSHIP
INSPTR 5830 M ST
DC LINCOLN, NE 68510

EASTMONT ADD EX STREET L 1
& 2 & L3 BLK 4 X

EASTMONT

SECTION 1-2

20

SEQUENCE 199 LOCATION 05701 D ST
F

0580694 TAYLOR INVESTMENT CO
INSPTR 244 SD COTNER BLVD
DC LINCOLN, NEBR. 68510

EASTMONT ADD BLOCK 12 X

EASTMONT

SECTION 1-2

SEQUENCE 200 LOCATION 05630 N ST

0580627 TAYLOR, MAX W & REBECCA C
INSPTR 244 SD. COTNER
DC LINCOLN, NEBR. 68510

EASTMONT ADD BLOCK 11 LOTS X
1 THRU 6

EASTMONT

SECTION 1-2

SEQUENCE 201 LOCATION 05633 N ST

0580571 WILSON, DARRELL A & JANELLE
INSPTR 5600 LENOX
DC LINCOLN, NE 68510

EASTMONT ADD BLOCK 10 LOT 7 X

EASTMONT

SECTION 1-2

SEQUENCE 202 LOCATION 05600 LENOX ST

6

18

16

TAX # NAME AND ADDRESS
0580597 HERMAN, VERA
INSPTR 5628 LENOX
DC LINCOLN, NEBR. 68510

LEGAL
EASTMONT ADD BLOCK 10 LOT 9
EASTMONT

SECTION 1-2

SEQUENCE 204 LOCATION 05628 LENOX ST

0580601 HANSEN, DONALD H & RUTH M
INSPTR 5638 LENOX
DC LINCOLN, NE 68510

EASTMONT ADD BLOCK 10 LOT 10
EASTMONT

SECTION 1-2

SEQUENCE 205 LOCATION 05638 LENOX ST

0580341 WARD, BETTY J
INSPTR 387 S COTNER
DC LINCOLN, NE 68510

EASTMONT ADD BLOCK 06 LOT 4
EASTMONT

SECTION 1-2

SEQUENCE 208 LOCATION 00387 SD COTNER BLV

0580621 WILLIAMS, MARVIN F & VIOLA H
INSPTR 445 SD COTNER BLVD
DC LINCOLN, NE 68510

EASTMONT ADD BLOCK 14 LOT 6
EASTMONT

SECTION 1-2

SEQUENCE 213 LOCATION 00445 SD COTNER BLV

0582023 ROSS, JERRY L & VICKI L
INSPTR 350 EASTRIDGE
DC LINCOLN, NE 68510

EASTMONT SECOND TRI NW PT
L11 18' ON FR 0
ON RR & ALL 12 BLK 7
EASTMONT

SECTION 1-2

SEQUENCE 218 LOCATION 00350 EASTRIDGE DR

0582107 LONGACRE, WHITCOMB G & BEVERLY
INSPTR 340 EASTRIDGE DR.
DC LINCOLN, NEBR. 68510

EASTMONT SECOND ADD BLOCK 07 LOT 13
EASTMONT 2

SECTION 1-2

SEQUENCE 219 LOCATION 00340 EASTRIDGE DR

6

19

17

TAX # NAME AND ADDRESS
 0581984 JELINEK, DON L & JANE E
 INSPTR 311 DALE DR
 DC LINCOLN, NEBR. 68510

LEGAL
 EASTMONT SECOND ADD BLOCK
 07 LOT 1

EASTMONT 2

SECTION 1-2

SEQUENCE 220

LOCATION 00311 DALE DR

0581801 BARRETT, WILLIAM J & ANN K
 INSPTR 8532 SNOWVILLE DR
 DC SANDY, UT 84092

EASTMONT SECOND ADD
 BLOCK 05 LOT 4

EASTMONT 2

SECTION 1-2

SEQUENCE 227

LOCATION 00325 LYNCREST DR

0581810 FIRST EVANGELICAL COVENANT
 INSPTR CHURCH
 DC 6024 L ST.
 LINCOLN, NE 68510

EASTMONT SECOND ADD LOTS
 5-12 BLK 5 EXEMPT

EASTMONT 2

SECTION 1-2

SEQUENCE 228

LOCATION 06024 L ST

0581828 BRINKMAN, WOODROW & ELIZABETH
 INSPTR 334 DALE
 DC LINCOLN, NE 68510

EASTMONT SECOND ADD BLOCK
 05 LOT 13

EASTMONT 2

SECTION 1-2

SEQUENCE 229

LOCATION 00334 DALE DR

0581844 JONES, JOHN D & JUDY A
 INSPTR 310 DALE DR
 DC LINCOLN, NE 68510

EASTMONT SECOND ADD BLOCK
 05 LOT 15

EASTMONT 2

SECTION 1-2

SEQUENCE 230

LOCATION 00310 DALE DR

0581852 BUSBODD, ARNOLD E. & MARIE K.
 INSPTR 310 EASTRIDGE DRIVE
 DC LINCOLN, NEBR. 68510

EASTMONT SECOND ADD BLOCK
 05 LOT 16

EASTMONT 2

SECTION 1-2

SEQUENCE 231

LOCATION 00310 EASTRIDGE DR

6

20

18

TAX # NAME AND ADDRESS
0581440 SOMMER, EVERETT L & MARJORIE A
INSPTR 220 EASTRIDGE DR
DC LINCOLN, NE 68510

LEGAL
EASTMONT SECOND ADD BLOCK
03 LOT 27

EASTMONT 2 X

SECTION 1-2

SEQUENCE 232 LOCATION 00220 EASTRIDGE DR

0581470 STOUT, MAURICE JR & MAXINE Y
INSPTR 341 CARDLYN
DC LINCOLN, NE 68510

EASTMONT SECOND ADD BLOCK
03 LOT 9

EASTMONT 2 X

SECTION 1-2

SEQUENCE 235 LOCATION 00341 CARDLYN CT

0581500 BARTEL, EDNA M
INSPTR 385 BRUCE DR
DC LINCOLN, NEBR 68510

EASTMONT SECOND ADD BLOCK
03 LOT 12

EASTMONT 2 X

SECTION 1-2

SEQUENCE 237 LOCATION 00385 BRUCE DR

0581518 GROSSERODE, STEVE H & PATRICIA
INSPTR 6220 L ST
DC LINCOLN, NE 68510

EASTMONT SECOND ADD BLOCK 3
LOT 13 & E10' LOT 14

EASTMONT 2 X

SECTION 1-2

SEQUENCE 238 LOCATION 06220 L ST

0581526 ROEDER, ROSCOE W & NORMA R
INSPTR 6200 L STREET
DC LINCOLN, NEBR. 68510

EASTMONT SECOND ADD BLOCK 3
LOT 14 EX E10'

EASTMONT 2 X

SECTION 1-2

SEQUENCE 239 LOCATION 06200 L ST

0581534 HOFMANN, RICHARD L & BEULAH M
INSPTR 6140 L
DC LINCOLN, NE 68510

EASTMONT SECOND ADD BLOCK
03 LOT 15

EASTMONT 2 X

SECTION 1-2

SEQUENCE 240 LOCATION 06140 L ST

6

21

19

TAX # 0581551
NAME AND ADDRESS KEISTER, CARL H & H KATHERINE
INSPTR 6120 L
DC LINCOLN, NE 68510

LEGAL EASTMONT SECOND ADD BLOCK 3
LOT 17 EX E5' *EASTMONT 2*

SECTION 1-2

SEQUENCE 241 LOCATION 06120 L ST

0581364 LEACH, HERBERT D & JACQUELYN
INSPTR 220 CAROLYN CT
DC LINCOLN, NE 68510

EASTMONT SECOND BLOCK 2 LOT
16 EX S 16&6
TENTHS LOT 17 S 15

SECTION 1-2

SEQUENCE 246 LOCATION 00220 CAROLYN CT

0581356 FRICKE, CARL C & BARBARA A
INSPTR 230 CAROLYN
DC LINCOLN, NE 68510

EASTMONT SECOND BLOCK 2 LOT
15 EX S 13
LOT 16 S 16 & 6 TENTS

SECTION 1-2

SEQUENCE 247 LOCATION 00230 CAROLYN CT

0581348 ZIER, JACOB & EMMA
INSPTR 240 CAROLYN CT
DC LINCOLN, NEBR. 68510

EASTMONT 2ND BLOCK 2 LOT 14
LT 15 S13 *EASTMONT 2*

SECTION 1-2

SEQUENCE 248 LOCATION 00240 CAROLYN CT

0581305 BEEZLEY, D ROBERT H & NELL M
INSPTR 310 CAROLYN CT
DC LINCOLN, NE 68510

EASTMONT SECOND WITTS
REPLAT LOTS B
12 B-2; LOT 2 EX SE 5 FT

SECTION 1-2

SEQUENCE 249 LOCATION 00310 CAROLYN CT

0581313 EWERTH, MARVIN W & VELMA K
INSPTR 330 CAROLYN CT
DC LINCOLN, NE 68510

EASTMONT SECOND BLK 2 WITTS
REPLAT
LOTS B & 12 B-2; LOT 2 SE 5
LOT 3

SECTION 1-2

SEQUENCE 250 LOCATION 00330 CAROLYN CT

6

22

20

TAX #	NAME AND ADDRESS	LEGAL
0581291	VANHAN, LEE R & LAUREL B	EASTMONT SECOND ADD
INSPTR	335 BRUCE DR.	WITTS REPLAT OF LOTS 8, 12
DC	LINCOLN, NE 68510	2-2:LOT 1

SECTION 1-2

SEQUENCE	251	LOCATION	00335	BRUCE	DR
----------	-----	----------	-------	-------	----

0581089	6211 PARTNERSHIP	EASTMONT SECOND ADD BLOCK 1
INSPTR	% LARSEN, SCHRÖEDER & ASSOC	LOT 2 EX ST
DC	6211 D	
	LINCOLN, NE 68510	

SECTION 1-2

SEQUENCE	253	LOCATION	06211	D	ST
			FC		

0954934	CHRISTIAN RETIREMENT HOMES INC	TAYLOR PARK OUTLOT A W 898
INSPTR	6315 D ST	FT
DC	LINCOLN, NE 68510	

SECTION 1-2

SEQUENCE	255	LOCATION	06315	D	ST
----------	-----	----------	-------	---	----

0954543	BOMBERBER, CLIFFORD & VIVIAN	TAYLOR PARK ADD BLOCK 01
INSPTR	2838 JACKSON DR	LOT 20
DC	LINCOLN, NE 68502	

SECTION 1-2

SEQUENCE	256	LOCATION	06530	TAYLOR PARK	DR
----------	-----	----------	-------	-------------	----

0954535	LAIRD, RICHARD L & ELEANOR	TAYLOR PARK ADD BLOCK 01
INSPTR	6520 TAYLOR PARK DR	LOT 19
DC	LINCOLN, NEBR. 68510	

SECTION 1-2

SEQUENCE	257	LOCATION	06520	TAYLOR PARK	DR
----------	-----	----------	-------	-------------	----

0954519	ELROD, GORDON & ALICE L	TAYLOR PARK ADD BLOCK 01
INSPTR	6500 TAYLOR PARK DR	LOT 17
DC	LINCOLN, NEBR. 68510	

SECTION 1-2

SEQUENCE	258	LOCATION	06500	TAYLOR PARK	DR
----------	-----	----------	-------	-------------	----

23

21

TAX #	NAME AND ADDRESS	LEGAL
0954501	FATRICK, RUTH F	TAYLOR PARK ADD BLOCK 01
INSPTR	6430 TAYLOR PARK DR	LOT 16
DC	LINCOLN, NE 68510	

TAPA
27

SECTION 1-2

SEQUENCE	259	LOCATION	06430	TAYLOR PARK	DR
----------	-----	----------	-------	-------------	----

0954497	SCHAFFERT, JAMES W & KAREN	TAYLOR PARK BLOCK 1 LOT 15
INSPTR	6420 TAYLOR PARK	E 70 FT
DC	LINCOLN, NEBR. 68510	

TAPA

SECTION 1-2

SEQUENCE	260	LOCATION	06420	TAYLOR PARK	DR
----------	-----	----------	-------	-------------	----

0954446	KAY, FRANCES M	TAYLOR PARK ADD BLOCK 01
INSPTR	215 TAYLOR PARK DR	LOT 10
DC	LINCOLN, NE 68510	

TAPA

SECTION 1-2

SEQUENCE	261	LOCATION	00215	TAYLOR PARK	DR
----------	-----	----------	-------	-------------	----

0954365	DIETZE, KEITH & DIANE	TAYLOR PARK ADD BLOCK 01
INSPTR	327 TAYLOR PARK DR	LOT 2
DC	LINCOLN, NE 68510	

TAPA

SECTION 1-2

SEQUENCE	263	LOCATION	00327	TAYLOR PARK	DR
----------	-----	----------	-------	-------------	----

0586129	ROBEL, JOHN H JR & MARY JO	EASTRIDGE ADD BLOCK 08 LOT 7
INSPTR	521 EASTRIDGE	
DC	LINCOLN, NE 68510	

EASTRIDGE

SECTION 1-2

SEQUENCE	265	LOCATION	00521	EASTRIDGE	DR
----------	-----	----------	-------	-----------	----

0586111	LYON, MELVIN E & ROSEMARY	EASTRIDGE ADD BLK 8 LOT 6
INSPTR	511 EASTRIDGE	
DC	LINCOLN, NEBR. 68510	

EASTRIDGE

SECTION 1-2

SEQUENCE	266	LOCATION	00511	EASTRIDGE	DR
----------	-----	----------	-------	-----------	----

24

22

TAX # 0586102 NAME AND ADDRESS MASTALIR, HOWARD W & MARJORIE
INSPTR 501 EASTRIDGE
DC LINCOLN, NEBR. 68510

LEGAL EASTRIDGE ADD TRI. SW 3
1/2' LOT 4 & EX TRI
NE CORNER LOT 5 BLK B

SECTION 1-2

SEQUENCE 267

LOCATION 00501 EASTRIDGE DR

0586099 MARTIN, ROBERT E & JOLEEN R
INSPTR 435 EASTRIDGE
DC LINCOLN, NE 68510

EASTRIDGE AD-BLK B EX TRI
SW 31 1/2' LOT 4
LOT 5 TRI IN NE

SECTION 1-2

SEQUENCE 268

LOCATION 00435 EASTRIDGE DR

0586081 MANNING, RAYMOND C & EDNA L
INSPTR 425 EASTRIDGE
DC LINCOLN, NEBR 68510

EASTRIDGE ADD BLOCK 08 LOT
3

SECTION 1-2

SEQUENCE 269

LOCATION 00425 EASTRIDGE DR

0580708 CRADDUCK, WARREN J & CHERYL L
INSPTR 400 S COTNER
DC LINCOLN, NE 68510

EASTMONT ADD BLOCK 13 LOT
1&2

SECTION 1-2

SEQUENCE 271

LOCATION 00400 S COTNER BLV

0580724 BROGAN, WILLIAM L & DYKEEN L
INSPTR 444 S COTNER
DC LINCOLN, NEBR. 68510

EASTMONT ADD BLOCK 13 LOT 4

SECTION 1-2

SEQUENCE 272

LOCATION 00444 S COTNER BLV

0530759 FRANKS, TED R
INSPTR 540 S COTNER
DC LINCOLN, NEBR. 68510

EASTMONT ADD BLOCK 13 LOT 7

SECTION 1-2

SEQUENCE 274

LOCATION 00540 S COTNER BLV

25

23

TAX # NAME AND ADDRESS
0586161 SUTTON, OPAL M
INSPTR 5735 J
DC LINCOLN, NEBR. 68510

LEGAL
EASTRIDGE ADD BLOCK 09 LOT
2 LT 3 E99

EASTRIDGE

SECTION 1-2

SEQUENCE 275 LOCATION 05735 J ST

0586153 GRIESS, OTTO B & THEODORA
INSPTR 5725 J
DC LINCOLN, NEBR. 68510

EASTRIDGE ADD BLOCK 09 LOT
1 LT 3 EX E99

EASTRIDGE

SECTION 1-2

SEQUENCE 276 LOCATION 05725 J ST

0581020 EMBRY, FRANCIS D
INSPTR 700 SD COTNER
DC LINCOLN, NEBR. 68510

EASTMONT BLOCK 16 LOT 5 &
OUTLOT A OF
EASTRIDGE ADJ TO L5 B16

EASTMONT

SECTION 1-2

SEQUENCE 277 LOCATION 00700 SD COTNER BLV

0581038 DOUGLAS, PAUL L
INSPTR 720 S COTNER
DC LINCOLN, NEBR. 68510

EASTMONT ADD BLOCK 16 LOT 6
OUTLOT A OF
EASTRIDGE ADD ADJ

EASTMONT

SECTION 1-2

SEQUENCE 278 LOCATION 00720 SD COTNER BLV

0586251 BARTAK, DENNIS F & KATHRYN L
INSPTR 5630 RANDOLPH
DC LINCOLN, NEBR. 68510

EASTRIDGE ADD BLOCK 09 LOT
12

EASTRIDGE

SECTION 1-2

SEQUENCE 282 LOCATION 05630 RANDOLPH ST

0586226 BECKENHAUER, JON R. & ANN E.
INSPTR 8410 PHOENIX AVE
DC UNIVERSAL CITY, TX 78148

EASTRIDGE ADD BLOCK 09 LOT
9

EASTRIDGE

SECTION 1-2

SEQUENCE 284 LOCATION 00727 EASTRIDGE DR

11

26

27

TAX # NAME AND ADDRESS
0586218 BISHOP, DAVID M & BARBARA D
INSPTR 717 EASTRIDGE DR
DC LINCOLN, NE 68510

LEGAL
EASTRIDGE ADD BLOCK 09 LOT
8

EASTRIDGE ✓

SECTION 1-2

SEQUENCE 285 LOCATION 00717 EASTRIDGE DR

0586200 ROSELLE, ROBERT E & MARGARET M
INSPTR 701 EASTRIDGE DR
DC LINCOLN, NE 68510

EASTRIDGE ADD BLOCK 09 LOT
7

EASTRIDGE ✓

SECTION 1-2

SEQUENCE 286 LOCATION 00701 EASTRIDGE DR

0586196 OLSON, EMANUEL A. & DOROTHY
INSPTR 925 SD 52
DC LINCOLN, NE 68510

EASTRIDGE ADD BLOCK 09 LOT
6

EASTRIDGE ✓

SECTION 1-2

SEQUENCE 287 LOCATION 00643 EASTRIDGE DR

0586188 LINTEL, JAMES E & MARIA L.P.
INSPTR 633 EASTRIDGE DR
DC LINCOLN, NE 68510

EASTRIDGE ADD BLOCK 09 LOT
5

EASTRIDGE ✓

SECTION 1-2

SEQUENCE 288 LOCATION 00633 EASTRIDGE DR

0586170 BOWERS, JOHN E & JEANNE M
INSPTR 623 EASTRIDGE DR
DC LINCOLN, NEBR. 68510

EASTRIDGE ADD BLOCK 09 LOT
4

EASTRIDGE ✓

SECTION 1-2

SEQUENCE 289 LOCATION 00623 EASTRIDGE DR

0585947 WOLFORD, JAMES C & JOAN R
INSPTR 5801 J
DC LINCOLN, NEBR. 68510

EASTRIDGE ADD BLOCK 07 LOT
1

EASTRIDGE ✓

SECTION 1-2

SEQUENCE 290 LOCATION 05801 J ST

6

27

25

TAX # 0586048
INSPTR SUITER, CHARLES J & MILDRED K
DC 700 EASTRIDGE DR
LINCOLN, NE 68510

LEGAL
EASTRIDGE ADD
LOTS 11 & 12 BLK 7

EASTRIDGE
25

SECTION 1-2

SEQUENCE 292 LOCATION 00700 EASTRIDGE DR

0586005 HARA, DONNA R
INSPTR 5810 RANDOLPH
DC LINCOLN, NE 68510

EASTRIDGE ADD BLOCK 07 LOT 7

EASTRIDGE

SECTION 1-2

SEQUENCE 294 LOCATION 05810 RANDOLPH ST

0585978 ROBERTS, GEORGE V & MAXINE
INSPTR 5820 RANDOLPH
DC LINCOLN, NEBR. 68510

EASTRIDGE ADD BLOCK 07 LOT 6

EASTRIDGE

SECTION 1-2

SEQUENCE 295 LOCATION 05820 RANDOLPH ST

0585980 PANARELLI, JOSEPH E & MADELEINE
INSPTR 5830 RANDOLPH ST
DC LINCOLN, NE 68510

EASTRIDGE ADD BLOCK 07 LOT 5

EASTRIDGE

SECTION 1-2

SEQUENCE 296 LOCATION 05830 RANDOLPH ST

0585564 HARRIS, GROVER C & RUBY
INSPTR 431 MULDER
DC LINCOLN, NEBR 68510

EASTRIDGE ADD BLOCK 5 LOT 3

EASTRIDGE

SECTION 1-2

SEQUENCE 297 LOCATION 00431 MULDER DR

0585572 LYBERIS, CHRIS & GEORGETTA
INSPTR 441 MULDER DR
DC LINCOLN, NE 68510

EASTRIDGE ADD BLOCK 5 LOT 4

EASTRIDGE

SECTION 1-2

SEQUENCE 298 LOCATION 00441 MULDER DR

6

28

26

TAX # NAME AND ADDRESS
0585531 GRAVES, BELLE L
INSPTR 501 MULDER DR
DC LINCOLN, NEBR. 68510

LEGAL
EASTRIDGE ADD BLOCK 05 LOT
5

EASTRIDGE

SECTION 1-2

SEQUENCE 299 LOCATION 00501 MULDER DR

0585611 STEINEGGER, DONALD H & SUSAN
INSPTR 601 MULDER DR
DC LINCOLN, NE 68510

EASTRIDGE ADD BLOCK 05 LOT
8

EASTRIDGE

SECTION 1-2

SEQUENCE 301 LOCATION 00601 MULDER DR

0585653 KENNEY, VINCENT V & MARIE K
INSPTR 715 MULDER DR
DC LINCOLN, NEBR. 68510

EASTRIDGE ADD BLOCK 05 LOT
12

EASTRIDGE

SECTION 1-2

SEQUENCE 303 LOCATION 00713 MULDER DR

0585661 WALZ, DEBRA L
INSPTR 735 MULDER DR
DC LINCOLN, NE 68510

EASTRIDGE ADD BLOCK 5 LOT
13

EASTRIDGE

SECTION 1-2

SEQUENCE 304 LOCATION 00735 MULDER DR

0585670 NILAN, MARTIN E & PATRICIA A
INSPTR 5920 RANDOLPH
DC LINCOLN, NE 68510

EASTRIDGE ADD BLOCK 05 LOT
14

EASTRIDGE

SECTION 1-2

SEQUENCE 305 LOCATION 05920 RANDOLPH ST

0585680 HAYES, BEVERLY J
INSPTR 728 ELDON DR
DC LINCOLN, NE 68510

EASTRIDGE ADD BLOCK 5 LOT
15

EASTRIDGE

SECTION 1-2

SEQUENCE 306 LOCATION 00728 ELDON DR

6

29

27

TAX #	NAME AND ADDRESS	LEGAL
0585742	LOUNSBURY, KRISTI L & LOREN K	EASTRIDGE ADD BLOCK 05 LOT /
INSPTR	540 ELDON DR	21
DC	LINCOLN, NE 68510	<i>EASTRIDGE</i>

SECTION 1-2

SEQUENCE	310	LOCATION	00540	ELDON	DR
----------	-----	----------	-------	-------	----

0585751	EVANS, MARVIN A & LORA O	EASTRIDGE ADD BLOCK 05 LOT
INSPTR	530 ELDON	22
DC	LINCOLN, NEBR. 68510	<i>EASTRIDGE</i>

SECTION 1-2

SEQUENCE	311	LOCATION	00530	ELDON	DR
----------	-----	----------	-------	-------	----

0585793	KOCH, RANDAL M & NANCY B	EASTRIDGE ADD BLOCK 06 LOT /
INSPTR	521 ELDON DR	2
DC	LINCOLN, NE 68510	<i>EASTRIDGE</i>

SECTION 1-2

SEQUENCE	312	LOCATION	00521	ELDON	DR
----------	-----	----------	-------	-------	----

0585815	ANTOINE, MAX-JAQUES & FRANCOISE	EASTRIDGE ADD BLOCK 06 LOT /
INSPTR	615 ELDON DR	4
DC	LINCOLN, NE 68510	<i>EASTRIDGE</i>

SECTION 1-2

SEQUENCE	313	LOCATION	00615	ELDON	DR
----------	-----	----------	-------	-------	----

0585831	ANDERSEN, PETER L & JOYCE A	EASTRIDGE ADD BLOCK 06 LOT /
INSPTR	701 ELDON DR	6
DC	LINCOLN, NEBR. 68510	<i>EASTRIDGE</i>

SECTION 1-2

SEQUENCE	315	LOCATION	00701	ELDON	DR
----------	-----	----------	-------	-------	----

0585866	TINGGAARD, OPAL N	EASTRIDGE ADD BLOCK 06 LOT /
INSPTR	5848 RANDOLPH	9
DC	LINCOLN, NEBR. 68510	<i>EASTRIDGE</i>

SECTION 1-2

SEQUENCE	316	LOCATION	05848	RANDOLPH	ST
----------	-----	----------	-------	----------	----

6

30

28

TAX #	NAME AND ADDRESS	LEGAL	
0585874	HARRIS, FORD E & EVELANE E	EASTRIDGE ADD	BLOCK 06 LOT
INSPTR	5844 J	10	
DC	LINCOLN, NE 68510		

SECTION 1-2

SEQUENCE	317	LOCATION	05844	J	ST
----------	-----	----------	-------	---	----

0585904	SKEAHAM, DIXIE RAE	EASTRIDGE ADD	BLOCK 06 LOT
INSPTR	5618 J STREET	13	
DC	LINCOLN, NEBR. 68510		

SECTION 1-2

SEQUENCE	318	LOCATION	05818	J	ST
----------	-----	----------	-------	---	----

0585921	HAASE, MARVIN L. & MARIANNE H	EASTRIDGE ADD	BLOCK 06 LOT
INSPTR	5800 J	15	
DC	LINCOLN, NE 68510		

SECTION 1-2

SEQUENCE	319	LOCATION	05800	J	ST
----------	-----	----------	-------	---	----

0585360	NILSON, LAVORE D.	EASTRIDGE ADD	BLOCK 04 LOT
INSPTR	717 DALE DRIVE	14	
DC	LINCOLN, NEBR. 68510		

SECTION 1-2

SEQUENCE	320	LOCATION	00717	DALE	DR
----------	-----	----------	-------	------	----

0585467	KROLIKOWSKI, RONALD J & DIANNE	EASTRIDGE ADD	BLOCK 04 LOT
INSPTR	524 MULDER DR	26	
DC	LINCOLN, NEBR. 68510		

SECTION 1-2

SEQUENCE	322	LOCATION	00524	MULDER	DR
----------	-----	----------	-------	--------	----

0585483	NEWHOUSE, K N & BETTY J	EASTRIDGE ADD	BLOCK 04 LOT
INSPTR	500 MULDER DR	28	
DC	LINCOLN, NEBR. 68510		

SECTION 1-2

SEQUENCE	323	LOCATION	00500	MULDER	DR
----------	-----	----------	-------	--------	----

6

31

29

TAX # NAME AND ADDRESS LEGAL
 0565084 SIMPSON, THOMAS E & DOROTHY J EASTRIDGE ADD BLOCK 03 LOT ✓
 INSPTR 633 LYNCREST 11
 DC LINCOLN, NE 68510

SECTION 1-2

SEQUENCE 335 LOCATION 00633 LYNCREST DR.

0871305 YANDICK, GEORGE & NORMA J RANDOLPH ACRES LOT 158 N ✓
 INSPTR 540 SD 48 HALF
 DC LINCOLN, NE 68510

SECTION 1-2

SEQUENCE 336 LOCATION 00530 SD 48 ST

0871354 MILLER, DELMER H & MARGARET F RANDOLPH ACRES LOT 147 ✓
 INSPTR 4828 J STREET
 DC LINCOLN, NE 68510

SECTION 1-2

SEQUENCE 337 LOCATION 04828 J ST

0871338 SEBEK, PAMELA A & RANDOLPH ACRES LOT 145 ✓
 INSPTR VAJERT, RANDALL L.
 DC 4844 J ST
 LINCOLN, NE 68510

SECTION 1-2

SEQUENCE 338 LOCATION 04844 J ST

0871117 BUSBECOM, SANDRA KAY RANDOLPH ACRES LOT 132 E50 ✓
 INSPTR 4930 J ST OF W100
 DC LINCOLN, NE 68510

SECTION 1-2

SEQUENCE 341 LOCATION 04930 J ST

0522104 ZLUMKE, DOROTHY R CASINO HEIGHTS BLOCK 4 LOT ✓
 INSPTR 220 SD 52 6
 DC LINCOLN, NE 68510

SECTION 1-2

SEQUENCE 345 LOCATION 00220 SD 52 ST

6

32

30

TAX # NAME AND ADDRESS
0522040 FEERHUSEN, LLOYD & JEAN
INSPTR 300 E. HILLCREST DR.
DC LINCOLN, NE 68520

LEGAL
CASINO HEIGHTS BLK 4 LOT 2
EX N125'

CASH
23

SECTION 1-2

SEQUENCE 347 LOCATION 00120 SD 52 ST

0522015 ABEL FOUNDATION, THE
INSPTR 1815 Y
DC LINCOLN, NEBR 68508

CASINO HEIGHTS BLOCK 4 LOT
1 N 125'
EX 66.2 SD FT IN NE CORNER

CASH

SECTION 1-2

SEQUENCE 348 LOCATION 5221 D ST

0522058 WITTMANN BROTHERS LTD.
INSPTR XBURGER KING CORP #1490
DC PO BOX 520783 MS1245
MIAMI, FL 33125

CASINO HEIGHTS BLK 4 LOT 2
N125' EX TR FOR
STR

CASH

SECTION 1-2

SEQUENCE 349 LOCATION 05221 D ST

0522031 HIEN, LESTER L & JOANNE C
INSPTR 5145 D ST, SUITE 202
DC LINCOLN, NE 68510

CASINO HEIGHTS B4 L1 EX
N125'

CASH

SECTION 1-2

SEQUENCE 350 LOCATION 00119 SD 53 ST

0522190 HIEN, LESTER L. & JOANNE
INSPTR 5145 D ST, SUITE 202
DC LINCOLN, NEBR. 68510

CASINO HEIGHTS BLOCK 4 LOT
14

CASH

SECTION 1-2

SEQUENCE 351 LOCATION 00135 SD 53 ST

0522171 FAYMAN, DIANE J
INSPTR 145 SD 53
DC LINCOLN, NE 68510

CASINO HEIGHTS BLOCK 4 LOT
13

CASH

SECTION 1-2

SEQUENCE 352 LOCATION 00145 SD 53 ST

6

33

31

TAX # NAME AND ADDRESS
0522155 SACKETT, DALE L & JANETTE C
INSPTR 221 50 53
DC LINCOLN, NE 68510

LEGAL
CASINO HEIGHTS BLOCK 4 LOT
11

SECTION 1-2

SEQUENCE 354 LOCATION 00221 50 53 ST

0522147 MASHEK, MAURICE JR & ANGIE M
INSPTR 231 50 53 ST
DC LINCOLN, NE. 68510

CASINO HEIGHTS BLOCK 4 LOT
10

SECTION 1-2

SEQUENCE 355 LOCATION 00231 50 53 ST

0442291 KATT, RICHARD L. & SHARON
INSPTR 4900 ALLES CIRCLE
DC LINCOLN, NEBR. 68510

ALLES REPLAT, EX. TRI TRAC
LOT 4

SECTION 1-2

SEQUENCE 357 LOCATION 04900 ALLES CIR

0941425 LOCKARD, ELWYN K & MARILYN A
INSPTR 5031 M ST
DC LINCOLN NEBR 68510

STUHR'S PARK VIEW BLOCK 5
LOT 1

SECTION 1-2

SEQUENCE 359 LOCATION 05031 M ST

0941557 CITY OF LINCOLN
INSPTR PARKS & RECREATION DEPARTMENT
DC 2740 "A" STREET
LINCOLN, NE 68502

STUHR'S PARK VIEW BETW 50 &
52 ST & BETW
L & M ST.

SECTION 1-2

SEQUENCE 360 LOCATION STUHR'S PARK

0941255 FILBERT, DANIEL H & CINDY L
INSPTR 5101 M ST
DC LINCOLN, NE 68510

STUHR'S PARK VIEW BLOCK 2
LOT 9

SECTION 1-2

SEQUENCE 361 LOCATION 05101 M ST

*Park
Center in 110*

PH 11

34

32

TAX # NAME AND ADDRESS
0941212 OZAKI, RONALD H & MILDRED Y
INSPTR 5136 LENOX
DC LINCOLN, NE 68510

LEGAL
STUHRS PARK VIEW BLOCK 2
LOT 5
LOT 6 E 1 DF 5 63

SECTION 1-2

SEQUENCE 365 LOCATION 05136 LENOX AVE

0941522 JOHNSON, STEPHEN H & MARILEE S
INSPTR 240 SD 50 ST
DC LINCOLN NEBR 68510

STUHRS PARK VIEW BLOCK 6
LOT 4

SECTION 1-2

SEQUENCE 376 LOCATION 00240 SD 50 ST

0941531 AXBERG, ELMER N & EDITH N
INSPTR 200 SD 50 ST
DC LINCOLN, NE 68510

STUHRS PARK VIEW BLOCK 6
LOT 5

SECTION 1-2

SEQUENCE 377 LOCATION 00200 SD 50 ST

0941158 ALBRANDT, JACOB & ARLENE A
INSPTR 5117 N ST
DC LINCOLN, NE 68510

STUHRS PARK VIEW BLOCK 1
LOT 11

SECTION 1-2

SEQUENCE 378 LOCATION 05117 N ST

0941081 NOVICOFF, ROSE & GEORGE
INSPTR 5135 N ST
DC LINCOLN, NE 68510

STUHRS PARK VIEW BLOCK 1
LOT 1 EX 52

SECTION 1-2

SEQUENCE 379 LOCATION 05135 N ST

0941085 BLOHM, CHARLENE
INSPTR 5134 M ST
DC LINCOLN, NE 68510

STUHRS PARK VIEW BLOCK 1
LOT 3 S 3 LOT 4

SECTION 1-2

SEQUENCE 382 LOCATION 5134 M ST

6

25

33

TAX # NAME AND ADDRESS
0941093 CAMERON, STANLEY E & NANCY
INSPTR 5124 N ST
DC LINCOLN, NEBR. 68510

LEGAL
STUHR'S PARK VIEW BLOCK 1
LOT 5

STUHR'S

SECTION 1-2

SEQUENCE 383

LOCATION 05124 M ST

0941107 EISENTRAGER, JAMES & E DORENE
INSPTR 5114 M
DC LINCOLN, NEBR. 68520

LEGAL
STUHR'S PARK VIEW BLOCK 1
LOT 6

STUHR'S

SECTION 1-2

SEQUENCE 384

LOCATION 05114 M ST

0941115 RANDOJA, ENDEL H
INSPTR 5108 M ST
DC LINCOLN, NE 68510

LEGAL
STUHR'S PARK VIEW BLOCK 1
LOT 7

STUHR'S

SECTION 1-2

SEQUENCE 385

LOCATION 05108 M ST

0941506 PORTSCHE, STANLEY L & GRACE A
INSPTR 5020 M ST
DC LINCOLN, NEBR. 68510

LEGAL
STUHR'S PARK VIEW BLOCK 6
LOT 2

STUHR'S

SECTION 1-2

SEQUENCE 386

LOCATION 05020 M ST

0941514 BANTZ, ARTHUR C & AILEEN S
INSPTR 5010 M ST
DC LINCOLN, NE 68510

LEGAL
STUHR'S PARK VIEW BLOCK 6
LOT 3

STUHR'S

SECTION 1-2

SEQUENCE 387

LOCATION 05010 M ST

0751090 BHM CORPORATION
INSPTR 4949 D ST
DC LINCOLN, NE 68510

LEGAL
LEMING'S SUB LOT 3 EX ST
5129.2' W240'
EX W30' N 1/2

LEMING'S
No 8104

SECTION 1-2

SEQUENCE 388

LOCATION 05040 M ST

28

6

36

34

TAX # 0751103
 NAME AND ADDRESS KINNEY SHOE CORPORATION #5127
 INSPTR ATTN: TAX DEPARTMENT
 DC PO BOX 2663
 HARRISBURG, PA 17105
 SECTION 1-2

LEGAL
 LEMINGS SUB LOT 3 N156'
 W240' EX W30'
 N 1/2 & EX N6'

LEMINGS

SEQUENCE 389 LOCATION 05001 0 ST
 FC

0751227 BHM CORPORATION
 INSPTR 4949 D ST
 DC LINCOLN, NE 68510

LEMINGS SUB N25.3' S310.3'
 W105' E135' &
 E255' EX E30' N300' & EX
 1416 SQ FT FOR ST
 LOT 4

LEMINGS

SECTION 1-2
 SEQUENCE 390 LOCATION 04949 0 ST

0751120 BHM CORPORATION
 INSPTR 4949 D ST
 DC LINCOLN, NE 68510

LEMINGS SUB LT 4 W60 N 100
 IN NW COR EX STR

LEMINGS

SECTION 1-2
 SEQUENCE 391 LOCATION 04801 0 ST

0751154 BHM CORPORATION
 INSPTR 4949 D ST
 DC LINCOLN, NE 68510

LEMINGS SUB LOT 4 N320' EX
 E225' N300'
 EX W60' N100' & EX S57'
 N200' W150'
 EX W135' S118' N320'

LEMINGS

SECTION 1-2
 SEQUENCE 392 LOCATION 04815 0 ST

0751138 BHM CORPORATION
 INSPTR 4949 D ST
 DC LINCOLN, NE 68510

LEMINGS SUB LOT 4 EX W10'
 S57' N207' W150'

LEMINGS

SECTION 1-2
 SEQUENCE 393 LOCATION 00136 50 48 ST

0751235 COX, JOHN C & IMOGENE R
 INSPTR % SHIELDS, JESSE & NORMA-CONT
 DC BOX 5002 STATION C
 LINCOLN, NE 68505

LEMINGS SUB LOT 4 S170 OF
 N377 W135
 EX 1622 SQ FT FOR ST

LEMINGS

SECTION 1-2
 SEQUENCE 394 LOCATION 00140 50 48 ST

6

37

35

TAX # NAME AND ADDRESS
0751201 COX, JOHN C & INOGENE R
INSPTR % SHIELDS, JESSE & NORMA-CONT
DC BDX 5002 STATION C
LINCOLN, NE 68505

LEGAL
LEMINGS SUB PT L4 EX RD
N60' S253' W135' L4

LEMINGS

SECTION 1-2

SEQUENCE 395

LOCATION 00200 SD 48

ST

0869911 RIED, JULIUS H & BETTY L
INSPTR 501 SD 53
DC LINCOLN, NE 68510

RANDOLPH ACRES LOT 67 N61&1
HALF

NO BLOCK

RAND

SECTION 1-2

SEQUENCE 399

LOCATION 00501 SD 53

ST

0869897 EICHELBERGER, JAMES R &
INSPTR MILLER-EICHELBERGER, RENEE D
DC 453 SD 53
LINCOLN, NE 68510

RANDOLPH ACRES SUB S1/2 LOT
66 EX E5'

RAND

SECTION 1-2

SEQUENCE 400

LOCATION 00453 SD 53

ST

0870188 HURST, WH D & DONA Y
INSPTR 450 S 52
DC LINCOLN, NEBR. 68510

RANDOLPH ACRES LOT 81 SOUTH
HALF

RAND

SECTION 1-2

SEQUENCE 402

LOCATION 00450 SD 52

ST

0769095 CLEMENT, MARY KAYE
INSPTR 309 SD 53
DC LINCOLN, NE 68510

TRENDLYS SUB LOT 21 E136'

TRENDLYS

SECTION 1-2

SEQUENCE 405

LOCATION 00309 SD 53

ST

0766960 HOLT, DALE C & DYNTHIA B
INSPTR 350 SD 52
DC LINCOLN, NE 68510

TRENDLYS SUB LT 13

TRENDLYS

SECTION 1-2

SEQUENCE 414

LOCATION 00350 SD 52

ST

NO BLOCK

6

38

36

TAX # 0941441 NAME AND ADDRESS STOLZ, PAUL M & VIRGINIA N
INSPTR 310 SO 50TH STREET
DC LINCOLN, NEBR. 68510

LEGAL STUHRS PARK VIEW BLOCK 5
LOT 3

STUHRS
21

SECTION 1-2

SEQUENCE 419

LOCATION 00310 SO 50

ST

0941433 DALMAR INVESTMENTS INC
INSPTR % WATKINS, B.
DC 1115 K ST SUITE 104
LINCOLN, NE 68508

LEGAL STUHRS PARK VIEW BLOCK 5
LOT 2

STUHRS

SECTION 1-2

SEQUENCE 420

LOCATION 00300 SO 50

ST

0870943 NAVRATIL, KENNETH J & SUSAN R
INSPTR 416 SO 50
DC LINCOLN, NE 68510

LEGAL RANDOLPH ACRES LOT 122

RAND

SECTION 1-2

SEQUENCE 422

LOCATION 00416 SO 50

ST

0870919 LEUFOLD, WILBUR
INSPTR BOX 2792
DC LINCOLN, NE 68502

LEGAL RANDOLPH ACRES LOT 119

RAND

SECTION 1-2

SEQUENCE 424

LOCATION 00450 SO 50

ST

0870251 RIDOLFI, TIMOTHY A & MIRIAM S
INSPTR 5121 L ST
DC LINCOLN, NE 68510

LEGAL RANDOLPH ACRES LOT 94 & LOT
85 E 75 OF W152

RAND

SECTION 1-2

SEQUENCE 427

LOCATION 05121 L

ST

0871486 PASCO MARKETING INC.
INSPTR % SINCLAIR MARKETING
DC PO BOX 30825
SALT LAKE CITY, UT 84130

LEGAL RANDOLPH ACRES LOT 153 S68
OF W106&2TNTS &
E30' S82'

RAND

SECTION 1-2

SEQUENCE 445

LOCATION 00740 SO 48

ST

39

37

TAX # NAME AND ADDRESS LEGAL
 0871451 MINER, MARY RANDOLPH ACRES LOT 152 W42
 INSPTR 4828 RANDOLPH OF E80
 DC LINCOLN, NE 68510

SECTION 1-2 *NO BLDG*
 SEQUENCE 446 LOCATION 04828 RANDOLPH ST

0871443 FRENZEL, JON A & CYNTHIA K RANDOLPH ACRES LOT 152 E38
 INSPTR 4838 RANDOLPH
 DC LINCOLN, NE 68510

SECTION 1-2 *NO BLDG*
 SEQUENCE 447 LOCATION 04838 RANDOLPH ST

0871222 TEMPLE BAPTIST CHURCH RANDOLPH ACRES LOT 138 W40
 INSPTR 4940 RANDOLPH
 DC LINCOLN, NE 68510

SECTION 1-2 *NO BLDG*
 SEQUENCE 448 LOCATION 04900 RANDOLPH ST

0870391 KREJCI, KAREN A & RANDOLPH ACRES SUB N61' LOT
 INSPTR SALMONS, MITCHELL J 93
 DC 619 SD 52
 LINCOLN, NE 68510

SECTION 1-2 *NO BLDG*
 SEQUENCE 454 LOCATION 00619 SD 52 ST

0870579 BLISS, FREDRICK & SANDRA J RANDOLPH ACRES LOT 101 S41
 INSPTR 610 SD 51
 DC LINCOLN, NE 68510

SECTION 1-2 *NO BLDG*
 SEQUENCE 455 LOCATION 00610 SD 51 ST

0870862 WURM, KENNETH J & JANET K RANDOLPH ACRES LOT 116 W80
 INSPTR 600 SD 50 OF N60&57 HNDG
 DC LINCOLN, NE 68510

SECTION 1-2 *NO BLDG*
 SEQUENCE 457 LOCATION 00600 SD 50 ST

40

38

TAX #	NAME AND ADDRESS	LEGAL
0870854	HOBLE, GEORGE A & EVA B & INSPTR BRINTON, ROBERT J & LOIS B DC 410 SD 50 LINCOLN, NE 68510	RANDOLPH ACRES 860.57' W80' LOT 116 no Bldg <i>RAC</i>
SECTION 1-2		LOCATION 00610 SD 50 ST
SEQUENCE 458		
0870820	OLSEN, JOHN H & HELEN L INSPTR 620 SD 50 DC LINCOLN, NE 68510	RANDOLPH ACRES LOT 115 N55 <i>RAC</i>
SECTION 1-2		LOCATION 00620 SD 50 ST
SEQUENCE 459		
0869945	BARNETT, JERRY E. & CONNIE INSPTR 5245 J ST DC LINCOLN, NE 68510	RANDOLPH ACRES LOT 69 E80.3' <i>RAC</i>
SECTION 1-2		LOCATION 05245 J ST
SEQUENCE 461		
0869929	DAVIDSON, WILLIAM R & KATHLEEN A INSPTR 5244 J DC LINCOLN, NE 68510	RANDOLPH ACRES SUB EX W66 LOT 68 <i>RAC</i>
SECTION 1-2		LOCATION 05244 J ST
SEQUENCE 464		
0870048	BUSH, DONALD L JR & MARGARET A INSPTR 5200 RANDOLPH DC LINCOLN, NE 68510	RANDOLPH ACRES LOT 74 W90 <i>RAC</i>
SECTION 1-2		LOCATION 05200 RANDOLPH ST
SEQUENCE 467		
0870081	MARLETTE, RALPH R & MARJORIE M INSPTR 640 SD 52 DC LINCOLN, NEBR. 68510	RANDOLPH ACRES LOT 76 EX N1' & EX S10' <i>RAC</i>
SECTION 1-2		LOCATION 00640 SD 52 ST
SEQUENCE 469		

6

41

39

TAX # NAME AND ADDRESS
0870099 BERNER, STEVE
INSPTR 620 SO 52 ST
DC LINCOLN, NEBR. 68510

LEGAL
RANDOLPH ACRES LOT 77 N61

RAND

SECTION 1-2

15 Block

SEQUENCE 470

LOCATION 00620 SO 52 ST

0870111 BERGMAN, PAUL & ADELINE
INSPTR 610 SO 52 ST
DC LINCOLN, NEBR. 68510

RANDOLPH ACRES LOT 78 EX
N70'

RAND

SECTION 1-2

15 Block

SEQUENCE 471

LOCATION 00610 SO 52 ST

0521914 HUTCHISON REAL ESTATE LTD
INSPTR 530 SO 13 ST
DC LINCOLN, NE 68508

VOID: REPLATTED CASINO
HEIGHTS 1ST ADD FOR 1989.
SEE NEW KEYS 1664446,
1664454 & 1664462.
CASINO HEIGHTS BLOCK 3
N100' LOT 1 & N100' E55' LD

*PT
1-2
Casht*

SECTION 1-2

LOCATION

SEQUENCE 472

0521931 HUTCHISON REAL ESTATE LTD
INSPTR 530 SOUTH 13
DC LINCOLN, NE 68508

VOID: REPLATTED CASINO
HEIGHTS 1ST ADD FOR 1989.
SEE NEW KEYS 1664446,
1664454 & 1664462.
CASINO HEIGHTS BLOCK 3 W10'
LOT 2 & LOTS 3, 4 & 5

*PT
1-3
Casht*

SECTION 1-2

LOCATION 05305 D ST

SEQUENCE 473

0580210 TAYLOR, MAX W & REBECCA C
INSPTR 244 S COTNER
DC LINCOLN, NEBR. 68510

EASTMONT ADD BLOCK 2 LOT 4
EX ST

EASTMONT

SECTION 1-2

LOCATION 00244 SO COTNER BLV

SEQUENCE 478

0580180 SIMS, TERRY L
INSPTR 200 SO COTNER
DC LINCOLN, NE 68510

EASTMONT ADD BLOCK 2 LOT 1
EX ST

EASTMONT

SECTION 1-2

LOCATION 00200 SO COTNER BLV

SEQUENCE 479

6

42

40

TAX # NAME AND ADDRESS
0580155 TAYLOR ENTERPRISES, INC.
INSPTR 244 S COTNER
DC LINCOLN, NEBR. 68510

LEGAL
EASTMONT ADD BLOCK 1 LOT 1
& LOT 2 EX ST.

EASTMONT

SECTION 1-2

SEQUENCE 480

LOCATION 00100 SO COTNER BLV
"IOLL" DA # 1465028

0581666 FIRST COMMERCE SAVINGS INC
INSPTR PO BOX 80036
DC LINCOLN, NE 68501

EASTMONT SECOND ADD EX
210.4 SQ FT & EX
W 181.25' LOT 1, BLK 4

EASTMONT

SECTION 2-2

SEQUENCE 481

LOCATION 00121 EASTRIDGE DR

0581674 SMITH, LUTHER D
INSPTR X ROBERT D RASH #362-27-206 P
DC J BOX 1600
ROWLETT, TEXAS 75088

EASTMONT 2ND ADD. W 181.25'
LOT 1 BLK 4

EASTMONT

SECTION 1-2

SEQUENCE 482

LOCATION 06145 D ST

0580350 YOUNG, JULIUS D. & MYRTLE
INSPTR 300 SO COTNER
DC LINCOLN, NEBR. 68510

EASTMONT ADD BLOCK 07 LOT 1

EASTMONT

SECTION 1-2

SEQUENCE 486

LOCATION 00300 SO COTNER BLV

1449561 YOUNG, DANIEL & CAROLYN S
INSPTR 731 DANVILLE CIR
DC LINCOLN, NE 68510

TAYLOR MEADOWS 8TH ADD LOT
5

TAYLOR

SECTION 1-2

SEQUENCE 498

LOCATION 00731 DANVILLE CIR

1449537 MEYER, CHARLES A & SHERRY R
INSPTR 821 DANVILLE CIR
DC LINCOLN, NE 68510

TAYLOR MEADOWS 8TH ADD LOT
5

TAYLOR

SECTION 1-2

SEQUENCE 497

LOCATION 00821 DANVILLE CIR
R300

R300

43

41

TAX # NAME AND ADDRESS
0955699 BULLERMAN, LLOYD B & KATHLEEN
INSPTR 6710 AMHURST DR
DC LINCOLN, NE 68510

LEGAL
TAYLOR PARK EAST BLOCK 4
LOT 6

SECTION 1-2

SEQUENCE 500 LOCATION 06701 AMHURST DR

0955591 NEALY, WM R & INEZ M
INSPTR 524 ROCKHURST DR
DC LINCOLN, NEBR. 68510

TAYLOR PARK EAST BLOCK 3
LOT 24

SECTION 1-2

SEQUENCE 503 LOCATION 00524 ROCKHURST DR

0955604 CHENG, PETER P C & NELLY C Y
INSPTR 516 ROCKHURST DR
DC LINCOLN, NEBR. 68510

TAYLOR PARK EAST BLOCK 3
LOT 25

SECTION 1-2

SEQUENCE 504 LOCATION 00518 ROCKHURST DR

0952168 RUDERSDORF, SUZANNE K
INSPTR 6300 RAINIER CT
DC LINCOLN, NE 68510

TAYLOR MEADOWS
LOT 10 BLK 1

SECTION 1-2

SEQUENCE 511 LOCATION 06300 RAINIER DR

0952265 CHEN, KUNG HONG & MEI HUI WEI
INSPTR 6310 YELLOWSTONE
DC LINCOLN, NE 68510

TAYLOR MEADOWS
LOT 21 BLK 1

SECTION 1-2

SEQUENCE 512 LOCATION 06310 YELLOWSTONE CIR

0952281 RANDALWOOD INC & LANCASTER CO
INSPTR % ALBERT W & JEAN BEYER
DC 1231 TWINRIDGE RD
LINCOLN, NE 68510

TAYLOR MEADOWS
ALL LOT 23 & 515' LOT 24
BLK 1

SECTION 1-2

SEQUENCE 513 LOCATION 01231 TWIN RIDGE RD

6

44

42

TAX # NAME AND ADDRESS
0952290 ELLINSSON, RICHARD A & JANICE
INSPTR 1217 TWINRIDGE RD
DC LINCOLN, NE 68510

LEGAL
TAYLOR MEADOWS
LOT 24 EX 915' & LOT 25 EX
NW20'
BLK 1

SECTION 1-2

SEQUENCE 514

LOCATION 01217 TWIN RIDGE RD

0952303 DUDLEY, DIANE Z & JOHN P
INSPTR 1201 TWIN RIDGE RD
DC LINCOLN, NE 68506

TAYLOR MEADOWS
NW 20' LOT 25 & ALL LOT 26
BLK 1

SECTION 1-2

SEQUENCE 515

LOCATION 01201 TWIN RIDGE RD

0952460 HUDSON, THOMAS
INSPTR 1001 TWIN RIDGE RD
DC LINCOLN, NE 68510

TAYLOR MEADOWS
LOT 13 BLK 2

SECTION 1-2

SEQUENCE 517

LOCATION 01001 TWIN RIDGE RD

1311250 GAPP, THOMAS A & LINDA K
INSPTR 1007 TWINRIDGE RD
DC LINCOLN, NE 68510

TAYLOR MEADOWS BLOCK 2
N37.5' LOT 11 & ALL LOT 12

SECTION 1-2

SEQUENCE 518

LOCATION 01007 TWINRIDGE RD

0954021 LEACH, RUSSELL
INSPTR ZSHAW, MARILYN
DC 1101 ROCKHURST DR
LINCOLN, NE 68510

TAYLOR MEADOWS 1ST ADD
S FT LOT 18 BLK 7

SECTION 1-2

SEQUENCE 519

LOCATION 1101 ROCKHURST DR

1315254 SINNER, JAMES E & PATRICIA L
INSPTR 6505 TETON DRIVE
DC LINCOLN, NE 68510

TAYLOR MEADOWS 7TH ADD
BLOCK 2 LOT 21

SECTION 1-2

SEQUENCE 520

LOCATION 06505 TETON DR

6

45

43

TAX # NAME AND ADDRESS
0953849 FRY, WILLIAM J.
INSPTR 6541 SHENANDOAH DR
DC LINCOLN, NE 68510

LEGAL
TAYLOR MEADOWS 1ST ADD
N PT LOT 20 BLK 6

TAYLOR
31

SECTION 1-2

SEQUENCE 522 LOCATION 06541 SHENANDOAH DR

0952516 SUTTON, DENNIS A & JOYCE T
INSPTR 901 TWINRIDGE RD
DC LINCOLN, NE 68508

TAYLOR MEADOWS LOT 5 BLK 3

TAYLOR
37

SECTION 1-2

SEQUENCE 524 LOCATION 00901 TWIN RIDGE RD

1232783 EVERS, HERBERT A & MABLE B
INSPTR 1110 ROCKHURST
DC LINCOLN, NE 68510

TAYLOR MEADOWS 3RD ADD LOT
19

TAYLOR
40

SECTION 1-2

SEQUENCE 525 LOCATION 01110 ROCKHURST DR

1232520 CARLSON, DONALD R
INSPTR 1000 ROCKHURST DRIVE
DC LINCOLN, NE 68510

TAYLOR MEADOWS 3RD ADD LOT
9

TAYLOR
39

SECTION 1-2

SEQUENCE 529 LOCATION 01000 ROCKHURST DR

0955353 CITY OF LINCOLN HOUSING AUTHORITY
INSPTR P.O. BOX 5327
DC LINCOLN, NEBR. 68505

TAYLOR PARK EAST BLOCK 2
LOT 25

TAYLOR
29

SECTION 1-2

SEQUENCE 543 LOCATION 06721 L ST

0955141 HOLZHEY, C. STEVEN & JOYCE
INSPTR 430 HAVERFORD DR
DC LINCOLN, NEBR. 68510

TAYLOR PARK EAST BLOCK 2
LOT 4

TAYLOR

SECTION 1-2

SEQUENCE 548 LOCATION 00430 HAVERFORD DR

6

46

44

TAX # NAME AND ADDRESS
0955124 LEE, WILLIE S
INSPTR 410 HAVERFORD
DC LINCOLN, NE 68510

LEGAL
TAYLOR PARK EAST BLOCK 2
LOT 2

7/28/11
29

SECTION 1-2

SEQUENCE 549 LOCATION 00410 HAVERFORD DR,

0955116 POWELL, ROGER H & ANGELA M
INSPTR 6701 L STREET
DC LINCOLN, NEBR. 68510

TAYLOR PARK EAST BLOCK 2
LOT 1

7/28/11

SECTION 1-2

SEQUENCE 550 LOCATION 06701 L ST

0766780 LANGE, RICHARD F & MARY S
INSPTR 1200 SD 48
DC LINCOLN, NE 68510

LINDALE BLOCK 2 LOT 1
W135.75'

LINDALE
23

SECTION 1-2

SEQUENCE 557 LOCATION 01200 SD 48 ST

0852627 CITY OF LINCOLN FIRE DEPARTMENT
INSPTR 1345 SD COTNER
DC STATION NO 7
LINCOLN, NE 68510

PIEDMONT SUB LOT 9 BLK 9
EXEMPT

PIEDMONT
18

SECTION 1-2

SEQUENCE 559 LOCATION 1345 SD COTNER

0852546 MISLE, HENRY & ESTHER
INSPTR 1201 FALL CREEK RD
DC LINCOLN, NE 68510

PIEDMONT SUB BLOCK 9 LOT 1

PIEDMONT

SECTION 1-2

SEQUENCE 564 LOCATION 01201 FALL CREEK RD

0852601 MADFIELD, LARRY D & JANICE M
INSPTR 1350 ALDRICH RD
DC LINCOLN, NE 68510

PIEDMONT SUB BLOCK 9 LOT 7

PIEDMONT

SECTION 1-2

SEQUENCE 567 LOCATION 01350 ALDRICH RD

6

47

45

TAX # NAME AND ADDRESS
0852431 JONES, ROBERT K & PATRICIA M
INSPTR 1001 FALL CREEK RD
DC LINCOLN, NE 68510

LEGAL
PIEDMONT SUB BLOCK 8 LOT 1

PIEDMONT
18

SECTION 1-2

SEQUENCE 571 LOCATION 01001 FALL CREEK RD

0852473 STRAUB, WILLIAM F
INSPTR 7200 OLD POST ROAD UNIT 12
DC LINCOLN, NE 68506

LEGAL
PIEDMONT SUB BLOCK 8 LOT 5

PIEDMONT

SECTION 1-2

SEQUENCE 572 LOCATION 01145 FALL CREEK RD

0679356 CITY OF LINCOLN
INSPTR PARKS & RECREATION DEPARTMENT
DC 2740 "A" STREET
LINCOLN, NE 68502

LEGAL
HIGHLAND HOME 29-10-7 PT.
BLOCK 3

H/H/O
137

SECTION 1-2

SEQUENCE 574 LOCATION PIEDMONT PARK

0667188 LATIMER, BILLY E & DORIS A
INSPTR 1322 SD 48
DC LINCOLN, NE 68510

LEGAL
HAWKINS PARK SUB L 3&4 BL 6
HIGHLAND HOME
SE 1/4 29-10-7; BLK 2 ALL LT
13< 14 826'

HAWKINS
20
ST

SECTION 1-2

SEQUENCE 586 LOCATION 01322 SD 48

0667196 WEST, NORMAN F & LOLA H
INSPTR 1318 SD 48
DC LINCOLN, NE 68510

LEGAL
HAWKINS PARK SUB L 3&4 BL 6
HIGHLAND HOME SE 29-10-7;
BLOCK 2 LOT 14 EX 826' &
ALL LOT 18

HAWKINS

SECTION 1-2

SEQUENCE 587 LOCATION 01318 SD 48 ST

0614974 SCHUMACHER, RALPH E
INSPTR 5545 M ST
DC LINCOLN, NE 68510

LEGAL
FIENES REFLT PT LOT 8
LEMINGS; BLOCK 1 LT 1

FIENES

SECTION 1-2

SEQUENCE 589 LOCATION 05545 M ST

6

48

46

TAX # NAME AND ADDRESS
0614904 FRALEY, CHARLES E & HARRIETT P
INSPTR 319 SO 56
DC LINCOLN, NE 68510

LEGAL
FIENES REPLT PT LOT 8
LEMINGS: BLK 1 LOT 4

23-753
FRALEY
20-

SECTION 1-2

SEQUENCE 590 LOCATION 00319 SO 56 ST

0614921 GEIS, HARVEY & LOUISE
INSPTR 341 S 56
DC LINCOLN, NEBR. 68510

LEGAL
FIENES REPLT PT LOT 8
LEMINGS: BLK 1 LOT 6

FIEVES

SECTION 1-2

SEQUENCE 592 LOCATION 00341 SO 56 ST

0586668 SMILEY, WM W & ELLEN W
INSPTR 919 EASTRIDGE DR
DC LINCOLN, NEBR. 68510

LEGAL
EASTRIDGE FIRST BLOCK 02
LOT 4

EASTRIDGE
23

SECTION 1-2

SEQUENCE 597 LOCATION 00919 EASTRIDGE DR

0587117 PARDY, ROSEVELT L & ANN
INSPTR 1101 EASTRIDGE
DC LINCOLN, NE 68510

LEGAL
EASTRIDGE FIRST BLOCK 06
LOT 4

EASTRIDGE

SECTION 1-2

SEQUENCE 599 LOCATION 01101 EASTRIDGE DR

0588806 LIVINGSTON, DALE W & LORAIN C
INSPTR (PARAPLEGIC)
DC 5600 A
LINCOLN, NEBR. 68510

LEGAL
EASTRIDGE THIRD BLK 4 LOT
13

EASTRIDGE
23

SECTION 1-2

SEQUENCE 610 LOCATION 05600 A ST

0588989 BOWEN, WM H & BEVERLY B
INSPTR 5851 MARGO DRIVE
DC LINCOLN, NEBR. 68510

LEGAL
EASTRIDGE FOURTH BLOCK 02
LOT 13

274712689
24-

SECTION 1-2

SEQUENCE 623 LOCATION 05851 MARGO DR

6

49

47

TAX # NAME AND ADDRESS
0588971 SCHUMACHER, E H & JANE K
INSPTR 5901 MARGO DR
DC LINCOLN, NEBR. 68510

LEGAL
EASTRIDGE FOURTH BLOCK 02
LOT 12

EASTRIDGE 4
24

SECTION 1-2

SEQUENCE 624

LOCATION 05901 MARGO DR

0588962 AMEN, HARRY
INSPTR 1132 MULDER DR
DC LINCOLN, NE 68510

EASTRIDGE FOURTH BLOCK 02
LOT 11

EASTRIDGE 4

SECTION 1-2

SEQUENCE 625

LOCATION 05911 MARGO DR

0588938 VANBOSKIRK, LELAND D & RUTH B
INSPTR 5941 MARGO DR
DC LINCOLN, NEBR. 68510

EASTRIDGE FOURTH BLOCK 02
LOT 8

EASTRIDGE

SECTION 1-2

SEQUENCE 628

LOCATION 05941 MARGO DR

0588957 DUNBAR, HENRY S & JEAN C
INSPTR 5941 SUNRISE ROAD
DC LINCOLN, NEBR. 68510

EASTRIDGE FOURTH BLOCK 02
LOT 1 EX 550'

EASTRIDGE 4

SECTION 1-2

SEQUENCE 630

LOCATION 05941 SUNRISE RD

0588990 TRAUDT, THOMAS H & BEVERLY A
INSPTR 6041 MEADOWBROOK LA
DC LINCOLN, NE 68510

EASTRIDGE FOURTH BLOCK 02
LOT 4

EASTRIDGE 4

SECTION 1-2

SEQUENCE 631

LOCATION 06041 MEADOWBROOK LN

0589705 UNITED PRESBYTERIAN WELFARE
INSPTR 1313 ELDON DR
DC LINCOLN, NE 68510

EASTRIDGE FIFTH ADD ALL BLK
4 EXEMPT

EASTRIDGE 5

SECTION 1-2

SEQUENCE 632

LOCATION 01313 ELDON DR

25

50

48

TAX # 0725072 NAME AND ADDRESS PIUS X HIGH SCHOOL CORPORATION
INSPTR 6000 A
DC LINCOLN, NE 68510

LEGAL IRREG TR PT L41 28-10-7

SW

SECTION 1-2

SEQUENCE 633 LOCATION 06000 A ST

0589098 MCCABE, ROBERT J
INSPTR 5821 SUNRISE RD
DC LINCOLN, NEBR. 68510

EASTRIDGE FOURTH BLOCK 03
LOT 7

EASTRIDGE 24

SECTION 1-2

SEQUENCE 638 LOCATION 05821 SUNRISE RD

0588474 SWEPSTON, W.W. & DORIS L
INSPTR 5801 SUNRISE RD
DC LINCOLN, NEBR. 68510

EASTRIDGE THIRD BLOCK 01
LOT 1 LT 2 N5

EASTRIDGE 23

SECTION 1-2

SEQUENCE 639 LOCATION 05801 SUNRISE RD

0588482 STANGE, WADE W & HEIDI J
INSPTR 1110 EASTRIDGE DR
DC LINCOLN, NE 68510

EASTRIDGE THIRD BLOCK 01
LOT 2 EX N5

EASTRIDGE 23

SECTION 1-2

SEQUENCE 640 LOCATION 01110 EASTRIDGE DR

0588471 FOWLER, MABEL E
INSPTR 1120 EASTRIDGE DR
DC LINCOLN, NE 68510

EASTRIDGE THIRD BLOCK 01
LOT 3

EASTRIDGE 23

SECTION 1-2

SEQUENCE 641 LOCATION 01120 EASTRIDGE DR

0588440 HEERMAN, CHARLOTTE M.
INSPTR 5910 SUNRISE
DC LINCOLN, NEBR. 68510

EASTRIDGE SECOND BLOCK 11
LOT 18

EASTRIDGE 23

SECTION 1-2

SEQUENCE 650 LOCATION 05910 SUNRISE RD

51

49

TAX # NAME AND ADDRESS
0588423 KATZ, ROBERT
INSPTR 5850 SUNRISE RD
DC LINCOLN, NEBR. 68510

LEGAL
EASTRIDGE SECOND BLOCK 11
LOT 15 E36
LOT 16 W64

EASTRIDGE 2

23

SECTION 1-2

SEQUENCE 651 LOCATION 05850 SUNRISE RD,

0588407 MARTI, DONALD L & CAROLYN J
INSPTR 5830 SUNRISE RD.
DC LINCOLN, NEBR. 68510

EASTRIDGE SECOND BLOCK 11
LOT 13 LT 14 W25'

EASTRIDGE 2

SECTION 1-2

SEQUENCE 652 LOCATION 05830 SUNRISE RD

0588385 MADDOX, SHIRLEY R
INSPTR 5820 SUNRISE RD
DC LINCOLN, NE 68510

EASTRIDGE SECOND BLOCK 11
LOT 11

EASTRIDGE 2

SECTION 1-2

SEQUENCE 653 LOCATION 05820 SUNRISE RD

0587265 MCLAUGHLIN, MAURICE M
INSPTR 6230 SUNRISE
DC LINCOLN, NE 68510

EASTRIDGE SECOND BLOCK 04
LOT 4

EASTRIDGE 2

SECTION 1-2

SEQUENCE 654 LOCATION 06230 SUNRISE RD

0587257 BROWN, BARRY R
INSPTR 6238 SUNRISE RD
DC LINCOLN, NE 68510

EASTRIDGE SECOND BLOCK 04
LOT 3

EASTRIDGE 2

SECTION 1-2

SEQUENCE 655 LOCATION 06238 SUNRISE RD

0587249 STANGE, DREW D
INSPTR 6246 SUNRISE RD
DC LINCOLN, NE 68510

EASTRIDGE SECOND BLOCK 04
LOT 2

EASTRIDGE 2

SECTION 1-2

SEQUENCE 656 LOCATION 06246 SUNRISE RD

6

52

50

TAX # NAME AND ADDRESS
0586510 HOLROYD, MICHAEL RAY & SANDRA
INSPTR 801 SUNRISE
DC LINCOLN, NE 68510

LEGAL
EASTRIDGE ADD BLOCK 16 LOT
3

EASTRIDGE

SECTION 1-2

SEQUENCE 658 LOCATION 00801 SUNRISE RD

0587311 WEBSTER, PHILIP N & SYLVIA V.
INSPTR 912 DALE DR
DC LINCOLN, NEBR. 68510

EASTRIDGE SECOND BLOCK 04
LOT 9

EASTRIDGE 2

SECTION 1-2

SEQUENCE 661 LOCATION 00912 DALE DR

0587389 ASHMAN, MICHAEL D & MARY JANE
INSPTR 811 LYNCREST
DC LINCOLN, NEBR. 68510

EASTRIDGE SECOND BLOCK 05
LOT 1

EASTRIDGE 2

SECTION 1-2

SEQUENCE 662 LOCATION 00811 LYNCREST DR

0586480 ROSS, LE ROY & DOROTHY
INSPTR 801 LYNCREST
DC LINCOLN, NEBR. 68510

EASTRIDGE ADD BLOCK 15 LOT
3

EASTRIDGE

SECTION 1-2

SEQUENCE 663 LOCATION 00801 LYNCREST DR

0586463 MILLS, ROBERT W & ANNA S
INSPTR 621 LAKEWOOD DR
DC LINCOLN, NE 68510

EASTRIDGE ADD BLOCK 15 LOT
1

EASTRIDGE

SECTION 1-2

SEQUENCE 665 LOCATION 00800 DALE DR

0587451 HULBERT, MAX T & ADALINE W
INSPTR 814 DALE DR
DC LINCOLN, NE 68510

EASTRIDGE SECOND BLOCK 05
LOT 8

EASTRIDGE 2

SECTION 1-2

SEQUENCE 666 LOCATION 00814 DALE DR

6

53

51

TAX # 0587443
NAME AND ADDRESS CODA, PETER J & CAROL E
INSPTR 822 DALE DR
DC LINCOLN, NE 68510

LEGAL
EASTRIDGE SECOND BLOCK 05
LOT 7

EASTRIDGE

SECTION 1-2

SEQUENCE 667 LOCATION 00822 DALE DR

0587435 BRUNZELL, PAUL F & MAXINE
INSPTR 830 DALE DR
DC LINCOLN, NEBR. 68510

EASTRIDGE SECOND BLOCK 05
LOT 6

EASTRIDGE

SECTION 1-2

SEQUENCE 668 LOCATION 00830 DALE DR

0589489 REEDER, ROBERT E & MARGARET D
INSPTR 1200 ELDON DRIVE
DC LINCOLN, NEBR. 68510

EASTRIDGE FIFTH ADD BLOCK
2 LOT 21

EASTRIDGE

SECTION 1-2

SEQUENCE 674 LOCATION 01200 ELDON DR

0589462 WEINBERG, JON B & JAN K
INSPTR 1220 ELDON DR
DC LINCOLN, NE 68510

EASTRIDGE FIFTH ADD BLOCK
2 LOT 19

EASTRIDGE

SECTION 1-2

SEQUENCE 675 LOCATION 01220 ELDON DR

0589454 TUDER, DONALD E & IRIS M
INSPTR 1230 ELDON DR
DC LINCOLN, NEBR. 68510

EASTRIDGE FIFTH ADD BLOCK
2 LOT 18

EASTRIDGE

SECTION 1-2

SEQUENCE 676 LOCATION 01230 ELDON DR

0589446 SCHATZ, DEARLE C & HELEN C
INSPTR 1240 ELDON DR
DC LINCOLN, NE 68510

EASTRIDGE FIFTH ADD BLOCK
2 LOT 17

EASTRIDGE

SECTION 1-2

SEQUENCE 677 LOCATION 01240 ELDON DR

6

54

52

TAX # 0589209 NAME AND ADDRESS LEMBRICH, DERALD L & VERNA H
INSPTR 1010 MULDER DRIVE
DC LINCOLN, NEBR. 68510

LEGAL
EASTRIDGE FIFTH ADD BLOCK
1 LOT 2

SECTION 1-2

SEQUENCE 690 LOCATION 01010 MULDER DR,

0589781 SAISER, DONALD R & MARJORIE L
INSPTR 1256 MULDER DR
DC LINCOLN, NE 68510

EASTRIDGE FIFTH ADD BLOCK
5 LOT 8

SECTION 1-2

SEQUENCE 699 LOCATION 01256 MULDER DR

0725081 UNITARIAN CHURCH OF LINCOLN
INSPTR 6300 A ST
DC LINCOLN, NE 68510

IRREG TR LT 42 SW 28-10-7

SECTION 1-2

SEQUENCE 700 LOCATION 06300 A ST

0587150 WILSON, TWILA A
INSPTR 6211 SUNRISE RD
DC LINCOLN, NE 68510

EASTRIDGE SECOND BLOCK 02
LOT 3

SECTION 1-2

SEQUENCE 702 LOCATION 06211 SUNRISE RD

0587141 GREESER, DAVID H JR & SONYA
INSPTR ALASKA PACIFIC UNIVERSITY
DC 6217 SUNRISE
LINCOLN, NE 68510

EASTRIDGE SECOND BLOCK 02
LOT 2

SECTION 1-2

SEQUENCE 703 LOCATION 06217 SUNRISE RD

0587133 HEALEY, PATRICK & MARSHALL HEA
INSPTR MARSHALL, NANCY L
DC 6225 SUNRISE RD
LINCOLN, NE 68510

EASTRIDGE SECOND BLOCK 02
LOT 1

SECTION 1-2

SEQUENCE 704 LOCATION 06225 SUNRISE RD

EASTRIDGE 2

25

EASTRIDGE 5

EASTRIDGE 2

23

EASTRIDGE 2

EASTRIDGE 2

6

55

53

TAX # NAME AND ADDRESS
0586528 STERNS, FLOYD A & FRISCILLA
INSPTR 6301 RANDOLPH
DC LINCOLN, NE 68510

LEGAL
EASTRIDGE ADD BLOCK 17 LOT
1 LOT 2 N 3

EASTRIDGE

SECTION 1-2

SEQUENCE 707 LOCATION 06301 RANDOLPH ST

0585106 OCHSNER, FREDERICK D & CAROL G
INSPTR 731 LYNCREST
DC LINCOLN, NEBR. 68510

EASTRIDGE ADD BLOCK 03 LOT
13

EASTRIDGE

SECTION 1-2

SEQUENCE 708 LOCATION 00731 LYNCREST DR

0587061 WINTER, THOMAS N & JOANNA F
INSPTR 1010 EASTRIDGE
DC LINCOLN, NEBR. 68510

EASTRIDGE FIRST BLOCK 05
LOT 4

EASTRIDGE 1

SECTION 1-2

SEQUENCE 710 LOCATION 01010 EASTRIDGE DR

0587052 NYQUIST, MERWYN A & LOIS
INSPTR 5815 MEADOWBROOK
DC LINCOLN, NEBR. 68510

EASTRIDGE FIRST BLOCK 05
LOT 3 EX E3

EASTRIDGE 1

SECTION 1-2

SEQUENCE 711 LOCATION 05815 MEADOWBROOK LN

0587036 GARDNER, CHARLES O & WANDA M
INSPTR 5835 MEADOWBROOK
DC LINCOLN, NE 68510

EASTRIDGE FIRST BLOCK 05
LOT 1

EASTRIDGE 1

SECTION 1-2

SEQUENCE 712 LOCATION 05835 MEADOWBROOK LN

0588351 CULWELL, GEORGE H & VIRGINIA L
INSPTR 5847 MEADOWBROOK LA
DC LINCOLN, NE 68510

EASTRIDGE SECOND BLOCK 11
LOT 8

EASTRIDGE 2

SECTION 1-2

SEQUENCE 714 LOCATION 05847 MEADOWBROOK LN

6

56

54

TAX # NAME AND ADDRESS
0588342 HULL, JOHN D. & ELAINE
INSPTR 5851 MEADOWBROOK LA
DC LINCOLN, NEBR. 68510

LEGAL
EASTRIDGE SECOND BLOCK 11
LOT 7

EASTRIDGE 2

SECTION 1-2

SEQUENCE 715

LOCATION 05851 MEADOWBROOK LN

0588334 LARSON, CHERE LEE
INSPTR 5901 MEADOWBROOK LA
DC LINCOLN, NEBR. 68510

EASTRIDGE SECOND BLOCK 11
LOT 6

SECTION 1-2

SEQUENCE 716

LOCATION 05901 MEADOWBROOK LN

0588326 BARTELS, JEAN K &
INSPTR MITCHELL, PHILLIP M
DC 5911 MEADOWBROOK LN
LINCOLN, NE 68510

EASTRIDGE SECOND BLOCK 11
LOT 5

SECTION 1-2

SEQUENCE 717

LOCATION 05911 MEADOWBROOK LN

0588318 KNODDLE, JACK M & MILDRED M
INSPTR 5917 MEADOWBROOK LA
DC LINCOLN, NE 68510

EASTRIDGE SECOND BLOCK 11
LOT 4

SECTION 1-2

SEQUENCE 718

LOCATION 05917 MEADOWBROOK LN

0588300 GRAHAM, DONALD E & YVONNE D
INSPTR NOEL S DEKALB (CONTRACT)
DC 5925 MEADOWBROOK LANE
LINCOLN, NE 68510

EASTRIDGE SECOND BLOCK 11
LOT 3

SECTION 1-2

SEQUENCE 719

LOCATION 05925 MEADOWBROOK LN

0588288 HAYDEN, F G & THERESA M
INSPTR 5945 MEADOWBROOK LANE
DC LINCOLN, NEBR. 68510

EASTRIDGE SECOND (TR OF S
OF LOT 2 5' ON
FRONT) & ALL LOT 1 BLK 11

SECTION 1-2

SEQUENCE 720

LOCATION 05945 MEADOWBROOK LN

6

57

55

TAX # NAME AND ADDRESS LEGAL
0588148 BAUER, ALYCE L EASTRIDGE SECOND BLOCK 09
INSPTR 5940 SUNRISE LOT 15
DC LINCOLN, NEBRASKA 68510

23 ✓

SECTION 1-2

SEQUENCE 721 LOCATION 05940 SUNRISE RD

0588130 KELLY, ROBERT L & KATHY L
INSPTR 5950 SUNRISE RD
DC LINCOLN, NE 68510

EASTRIDGE SECOND BLOCK 09
LOT 14

SECTION 1-2

SEQUENCE 722 LOCATION 05950 SUNRISE RD

0588121 HATTING, GARY
INSPTR 1035 ELDON DR
DC LINCOLN, NE 68510

EASTRIDGE SECOND BLOCK 09
LOT 13

SECTION 1-2

SEQUENCE 723 LOCATION 01035 ELDON DR

0588113 THIERSTEIN, WILLIAM R &
INSPTR MARVEEN
DC 1025 ELDON DR
LINCOLN, NEBR. 68510

EASTRIDGE SECOND BLOCK 09
LOT 12

SECTION 1-2

SEQUENCE 724 LOCATION 01025 ELDON DR

0588105 BIERHAUS, ROBERT & EVELYN
INSPTR 1015 ELDON DRIVE
DC LINCOLN, NEBR. 68510

EASTRIDGE SECOND BLOCK 09
LOT 11

SECTION 1-2

SEQUENCE 725 LOCATION 01015 ELDON DR

0588091 MAZURAK, ANDREW P & MABEL L
INSPTR 1001 ELDON DR
DC LINCOLN, NE 68510

EASTRIDGE SECOND BLOCK 09
LOT 10

SECTION 1-2

SEQUENCE 726 LOCATION 01001 ELDON DR

6

58

56

TAX # 0588075
NAME AND ADDRESS BURROW, PAUL D. & MARY G.
INSPTR 929 ELDON DRIVE
DC LINCOLN, NEBR. 68510

LEGAL
EASTRIDGE SECOND BLOCK 09
LOT 8

Same
23

SECTION 1-2

SEQUENCE 727 LOCATION 00929 ELDON DR

0588059 FRENCH, JAMES L & PATRICIA A
INSPTR 911 ELDON DR
DC LINCOLN, NE 68510

EASTRIDGE SECOND BLOCK 09
LOT 6 EX
NORTHERLY 8'

Same

SECTION 1-2

SEQUENCE 728 LOCATION 00911 ELDON DR

0588008 LUSINS, ELMARS J & INTA
INSPTR 901 ELDON DR
DC LINCOLN, NE 68510

EASTRIDGE SECOND BLOCK 09
LDT 1 & NORTHERLY 8' LOT 6

Same

SECTION 1-2

SEQUENCE 729 LOCATION 00901 ELDON DR

0588041 PARKER, WESLEY W & RUTH
INSPTR 5900 MEADOWBROOK LANE
DC LINCOLN, NEBR. 68510

EASTRIDGE SECOND BLOCK 09
LOT 5

Same

SECTION 1-2

SEQUENCE 733 LOCATION 05900 MEADOWBROOK LN

0588202 KIRBY, ROGER D & SUZANNE R
INSPTR 5910 MEADOWBROOK LANE
DC LINCOLN, NEBR 68510

EASTRIDGE SECOND BLOCK 09
LOT 21

Same

SECTION 1-2

SEQUENCE 734 LOCATION 05910 MEADOWBROOK LN

0588199 KUEBLER, CAROL & LONG, ELYSE
INSPTR HARPER ET AL
DC 5918 MEADOWBROOK LA
LINCOLN, NEBR. 68510

EASTRIDGE SECOND BLOCK 09
LOT 20

Same

SECTION 1-2

SEQUENCE 735 LOCATION 05918 MEADOWBROOK LN

Same

59

57

TAX # NAME AND ADDRESS
0588181 SCHNEBERGER, LEON W & JANNETT
INSPTR 5924 MEADOWBROOK LANE
DC LINCOLN, NEBR. 68510

LEGAL
EASTRIDGE SECOND BLOCK 09
LOT 19

87

SECTION 1-2

SEQUENCE 736 LOCATION 05924 MEADOWBROOK LN

0588172 BENNETT, DARRELL & HARRIET
INSPTR 5930 MEADOWBROOK LANE
DC LINCOLN, NE 68510

EASTRIDGE SECOND BLOCK 09
LOT 18

Same

SECTION 1-2

SEQUENCE 737 LOCATION 05930 MEADOWBROOK LN

0588164 BROWN, IRVIN J
INSPTR 5938 MEADOWBROOK LANE
DC LINCOLN, NE 68510

EASTRIDGE SECOND BLOCK 09
LOT 17

Same

SECTION 1-2

SEQUENCE 738 LOCATION 05938 MEADOWBROOK LN

0589560 WAY, LESTER & HARRIETT
INSPTR 6021 SUNRISE ROAD
DC LINCOLN, NEBR. 68510

EASTRIDGE FIFTH ADD BLOCK
3 LOT 1

EASTRIDGE 5

SECTION 1-2

SEQUENCE 739 LOCATION 06021 SUNRISE RD

0589594 BORLAND, CYRUS J & ROSE M
INSPTR 1131 ELDON DR
DC LINCOLN, NEBR. 68510

EASTRIDGE FIFTH ADD BLOCK
3 LOT 4

Same

SECTION 1-2

SEQUENCE 742 LOCATION 01131 ELDON DR

0589608 KWAN, SHIU KWAN
INSPTR 1141 ELDON DR
DC LINCOLN, NE 68510

EASTRIDGE FIFTH ADD BLOCK 3
LOT 5

Same

SECTION 1-2

SEQUENCE 743 LOCATION 01141 ELDON DR

61

59

TAX #	NAME AND ADDRESS	LEGAL
0589683	FRUHWIRTH, WILLIAM M & SANDRA	EASTRIDGE FIFTH ADD BLOCK
INSPTR	6044 MEADOWBROOK LANE	3 LOT 13
DC	LINCOLN, NE 68510	

EASTRIDGE 5

SECTION 1-2

SEQUENCE	750	LOCATION	06044	MEADOWBROOK	LN
----------	-----	----------	-------	-------------	----

0589691	LEE, KELLY JO & WAGNER, TRAVIS	EASTRIDGE FIFTH ADD BLOCK
INSPTR	6036 MEADOWBROOK	3 LOT 14
DC	LINCOLN, NE 68510	

EASTRIDGE 5

SECTION 1-2

SEQUENCE	751	LOCATION	06036	MEADOWBROOK	LN
----------	-----	----------	-------	-------------	----

0588849	KRHOUNEK, ELWYN J & ANN	EASTRIDGE FOURTH BLOCK 01
INSPTR	6030 MEADOWBROOK LANE	LOT 4
DC	LINCOLN, NE 68510	

EASTRIDGE 4

SECTION 1-2

SEQUENCE	752	LOCATION	06030	MEADOWBROOK	LN
----------	-----	----------	-------	-------------	----

0587923	HEIMAN, RALPH L & CATHERINE M	EASTRIDGE SECOND BLOCK 08
INSPTR	1040 ELDON DR	LOT 13
DC	LINCOLN, NEBR. 68510	

EASTRIDGE 2

SECTION 1-2

SEQUENCE	754	LOCATION	01040	ELDON	DR
----------	-----	----------	-------	-------	----

0587931	STALL, LLOYD E & MARY E	EASTRIDGE SECOND BLOCK 08
INSPTR	1024 ELDON DR	LOT 14
DC	LINCOLN, NEBR. 68510	

EASTRIDGE 2

SECTION 1-2

SEQUENCE	755	LOCATION	01024	ELDON	DR
----------	-----	----------	-------	-------	----

0587966	FILBECK, ROBERT W & SHIRLEY A	EASTRIDGE SECOND BLOCK 08
INSPTR	940 ELDON DR	LOT 17
DC	LINCOLN, NE 68510	

EASTRIDGE 2

SECTION 1-2

SEQUENCE	756	LOCATION	00940	ELDON	DR
----------	-----	----------	-------	-------	----

62

60

TAX # NAME AND ADDRESS
0587974 CARROLL, BILL & DIAN
INSPTR 930 ELDON
DC LINCOLN, NE 68510

LEGAL
EASTRIDGE SECOND BLOCK 8
LOT 18

SECTION 1-2

SEQUENCE 757 LOCATION 00930 ELDON DR

0587982 POHL, GREGORY J & CHERYL A
INSPTR 920 ELDON DR
DC LINCOLN, NE 68510

EASTRIDGE SECOND BLOCK 08
LOT 19

SECTION 1-2

SEQUENCE 758 LOCATION 00920 ELDON DR

0587869 HARRDUN, STANLEY M & JANICE L
INSPTR 931 MULDER DR
DC LINCOLN, NE 68510

EASTRIDGE SECOND BLOCK 8
LOT 7

SECTION 1-2

SEQUENCE 764 LOCATION 00931 MULDER DR

0587877 PAAKE, LESLEY E. & CAROLYN R.
INSPTR 937 MULDER DRIVE
DC LINCOLN, NEBR. 68510

EASTRIDGE SECOND BLOCK 08
LOT 8

SECTION 1-2

SEQUENCE 765 LOCATION 00937 MULDER DR

0587805 GREGORY, THERESA YVONNE
INSPTR 943 MULDER DR
DC LINCOLN, NE 68510

EASTRIDGE SECOND BLOCK 08
LOT 9

SECTION 1-2

SEQUENCE 766 LOCATION 00943 MULDER DR

0587893 WENZ, MICHAEL C & JEANNE A
INSPTR 944 MULDER
DC LINCOLN, NE 68510

EASTRIDGE SECOND BLOCK 08
LOT 10

SECTION 1-2

SEQUENCE 767 LOCATION 00949 MULDER DR

63

61

TAX #	NAME AND ADDRESS	LEGAL
0587915	SMITH, JUDSON M & MARY S	EASTRIDGE SECOND BLOCK 08
INSPTR	6010 SUNRISE RD	LOT 12
DC	LINCOLN, NEBR. 68510	<i>EASTRIDGE 2</i>

SECTION 1-2

SEQUENCE	768	LOCATION	06010	SUNRISE	RD
----------	-----	----------	-------	---------	----

0586404	COLE, FRANCES E	EASTRIDGE ADD BLOCK 13 LOT
INSPTR	800 ELDON DR	1
DC	LINCOLN, NE 68510	<i>EASTRIDGE</i>

SECTION 1-2

SEQUENCE	769	LOCATION	00800	ELDON	DR
----------	-----	----------	-------	-------	----

0586412	JOHNSON, CARROLL D & CAROLYN P	EASTRIDGE ADD BLOCK 13 LOT
INSPTR	5919 RANDOLPH	2
DC	LINCOLN, NEBR. 68510	<i>EASTRIDGE</i>

SECTION 1-2

SEQUENCE	770	LOCATION	05919	RANDOLPH	ST
----------	-----	----------	-------	----------	----

0586421	BROOKS, RONALD L & SHARON K	EASTRIDGE ADD BLOCK 13 LOT
INSPTR	801 MULDER DR	3
DC	LINCOLN, NE 68510	<i>EASTRIDGE</i>

SECTION 1-2

SEQUENCE	771	LOCATION	00801	MULDER	DR
----------	-----	----------	-------	--------	----

0587702	KULAWIK, JAMES R & SHIRLEY J	EASTRIDGE SECOND BLOCK 07
INSPTR	811 MULDER DR	LOT 1
DC	LINCOLN, NE 68510	<i>EASTRIDGE 2</i>

SECTION 1-2

SEQUENCE	772	LOCATION	00811	MULDER	DR
----------	-----	----------	-------	--------	----

0587711	STUDNICKA, CHARLES & PATRICIA	EASTRIDGE SECOND BLOCK 07
INSPTR	821 MULDER DR	LOT 2
DC	LINCOLN, NE 68510	<i>EASTRIDGE 2</i>

SECTION 1-2

SEQUENCE	773	LOCATION	00821	MULDER	DR
----------	-----	----------	-------	--------	----

6

64

62

TAX # NAME AND ADDRESS
0587729 RETZLAFF, SANDRA S
INSPTR 829 MULDER DR
DC LINCOLN, NEBR. 68510

LEGAL
EASTRIDGE SECOND BLOCK 07
LOT 3

EASTRIDGE 2

SECTION 1-2

SEQUENCE 774

LOCATION 00829 MULDER DR

0587737 SKEAHAN, DIXIE R
INSPTR 839 MULDER DR
DC LINCOLN, NE 68510

EASTRIDGE SECOND BLOCK 07
LOT 4

EASTRIDGE 2

SECTION 1-2

SEQUENCE 775

LOCATION 00839 MULDER DR

0587745 BURNS, ILA M
INSPTR 647 FERNDAL RD
DC LINCOLN, NE 68510

EASTRIDGE SECOND BLOCK 07
LOT 5

EASTRIDGE 2

SECTION 1-2

SEQUENCE 776

LOCATION 00847 FERNDAL RD

0586371 MARTIN-PRICE, LISA D &
INSPTR PRICE, RONALD A
DC 5847 RANDOLPH
LINCOLN, NE 68510

EASTRIDGE ADD BLOCK 12 LOT
9

EASTRIDGE

SECTION 1-2

SEQUENCE 778

LOCATION 05849 RANDOLPH ST

0586382 WAGNER, KATHARINE
INSPTR 5843 RANDOLPH
DC LINCOLN, NE 68510

EASTRIDGE ADD BLOCK 12 LOT
8

EASTRIDGE

SECTION 1-2

SEQUENCE 779

LOCATION 05843 RANDOLPH ST

0586374 PAUL, MARILYN
INSPTR 5837 RANDOLPH
DC LINCOLN, NE 68510

EASTRIDGE ADD BLOCK 12 LOT
7

EASTRIDGE

SECTION 1-2

SEQUENCE 780

LOCATION 05837 RANDOLPH ST

6

65

63

TAX #	NAME AND ADDRESS	LEGAL
0586358	DIDRICHSONS, ILMARS	EASTRIDGE ADD BLOCK 12 LOT
INSPTR	925 ROBERT RD	5
DC	LINCOLN, NE 68510	

EASTRIDGE /
13

SECTION 1-2

SEQUENCE	782	LOCATION	05825	RANDOLPH	ST
----------	-----	----------	-------	----------	----

0586331	DUGGAN, MARK & JACKLYNE	EASTRIDGE ADD BLOCK 12 LOT
INSPTR	5813 RANDOLPH	3
DC	LINCOLN, NE 68510	

EASTRIDGE /

SECTION 1-2

SEQUENCE	783	LOCATION	05813	RANDOLPH	ST
----------	-----	----------	-------	----------	----

0586323	BARRETT, LAURENCE D & DELORIS	EASTRIDGE ADD BLOCK 12 LOT
INSPTR	5807 RANDOLPH	2
DC	LINCOLN, NE 68510	

EASTRIDGE /

SECTION 1-2

SEQUENCE	784	LOCATION	05807	RANDOLPH	ST
----------	-----	----------	-------	----------	----

0586315	WOLF, DAVID A & JULIE A	EASTRIDGE ADD BLOCK 12 LOT
INSPTR	800 EASTRIDGE	1
DC	LINCOLN, NE 68510	

EASTRIDGE /

SECTION 1-2

SEQUENCE	785	LOCATION	00800	EASTRIDGE	DR
----------	-----	----------	-------	-----------	----

0586927	ARNOLD, WILLIAM J & MARY M	EASTRIDGE FIRST BLOCK 03
INSPTR	900 EASTRIDGE	LOT 14
DC	LINCOLN, NEBR. 68510	

EASTRIDGE /

SECTION 1-2

SEQUENCE	786	LOCATION	00900	EASTRIDGE	DR
----------	-----	----------	-------	-----------	----

0586901	BOSLAUGH, LESLIE & ELIZABETH M	EASTRIDGE FIRST BLOCK 03
INSPTR	938 EASTRIDGE	LOT 12
DC	LINCOLN, NE 68510	

EASTRIDGE /

SECTION 1-2

SEQUENCE	787	LOCATION	00938	EASTRIDGE	DR
----------	-----	----------	-------	-----------	----

66

64

TAX #	NAME AND ADDRESS	LEGAL
0586871	K & M INDUSTRIES	EASTRIDGE FIRST BLOCK 03
INSPTR	VERSAW, MILDRED M TRUSTEE	LOT 9
DC	923 MORaine	<i>EASTRIDGE 1</i>
	LINCOLN, NE 68510	
SECTION 1-2		
SEQUENCE	788	LOCATION 00923 MORaine DR
0586854	BROWN, ALBERT L & MARGARET S	EASTRIDGE FIRST BLOCK 03
INSPTR	859 MORaine DR	LOT 7
DC	LINCOLN, NE 68510	<i>EASTRIDGE 1</i>
SECTION 1-2		
SEQUENCE	789	LOCATION 00859 MORaine DR
0586838	ORTON, KENNETH D & ANITA D	EASTRIDGE FIRST BLOCK 03
INSPTR	843 MORaine DR	LOT 5
DC	LINCOLN, NE 68510	<i>EASTRIDGE 1</i>
SECTION 1-2		
SEQUENCE	791	LOCATION 00843 MORaine DR
0586803	NEEMAN, HARLAND H & JANICE O	EASTRIDGE FIRST BLOCK 03
INSPTR	821 MORaine DR	LOT 2
DC	LINCOLN, NEBR. 68510	<i>EASTRIDGE 1</i>
SECTION 1-2		
SEQUENCE	792	LOCATION 00821 MORaine DR
0586790	SCHLEGEL, RONALD E & BARBARA	EASTRIDGE FIRST BLOCK 03
INSPTR	815 ELDON	LOT 1
DC	LINCOLN, NE 68510	<i>EASTRIDGE 1</i>
SECTION 1-2		
SEQUENCE	793	LOCATION 00815 ELDON DR
0586951	DORT, EILEEN M & KIRKLAND,	EASTRIDGE FIRST BLOCK 04
INSPTR	SUZANNE M	LOT 1
DC	826 MORaine DR	<i>EASTRIDGE 1</i>
	LINCOLN, NE 68510	
SECTION 1-2		
SEQUENCE	794	LOCATION 00826 MORaine DR

67

65

TAX # 0586960
INSPTR 838 MORAINIAN BLVD
DC LINCOLN, NE 68510

LEGAL
EASTRIDGE FIRST BLOCK 04
LOT 2

EASTRIDGE 1

SECTION 1-2

23

SEQUENCE 795

LOCATION 00838 MORAINIE DR

0586978
INSPTR 846 MORAINIE DR
DC LINCOLN, NE 68510

LEGAL
EASTRIDGE FIRST BLOCK 04
LOT 3

24

SECTION 1-2

SEQUENCE 796

LOCATION 00848 MORAINIE DR

0586994
INSPTR 900 MORAINIE DR
DC LINCOLN, NE 68510

LEGAL
EASTRIDGE FIRST BLOCK 04
LOT 5

25

SECTION 1-2

SEQUENCE 797

LOCATION 00900 MORAINIE DR

0587001
INSPTR 924 MORAINIE DR
DC LINCOLN, NEBR. 68510

LEGAL
EASTRIDGE FIRST BLOCK 04
LOT 6

26

SECTION 1-2

SEQUENCE 798

LOCATION 00924 MORAINIE DR

0587028
INSPTR 944 MORAINIE DR
DC LINCOLN, NE 68510

LEGAL
EASTRIDGE FIRST BLOCK 04
LOT 8

27

SECTION 1-2

SEQUENCE 799

LOCATION 00944 MORAINIE DR

0588270
INSPTR 5840 MEADOWBROOK LA
DC LINCOLN, NEBR. 68510

LEGAL
EASTRIDGE SECOND BLOCK 10
LOT 7

EASTRIDGE 2

SECTION 1-2

SEQUENCE 800

LOCATION 05840 MEADOWBROOK LN

28

4

65

66

TAX # NAME AND ADDRESS
0588261 KOENIG, JOHN D & MALISSA ANN
INSPTR 735 FERNDALE RD
DC LINCOLN, NEBR 68510

LEGAL
EASTRIDGE SECOND BLOCK 10
LOT 6

SECTION 1-2

SEQUENCE 801 LOCATION 00935 FERNDALE RD

0588253 FRANKLIN, LESLIE W & BRENDA K
INSPTR 925 FERNDALE ROAD
DC LINCOLN, NEBR. 68510

EASTRIDGE SECOND BLOCK 10
LOT 5

SECTION 1-2

SEQUENCE 802 LOCATION 00925 FERNDALE RD

0588229 LEBSACK, EDWIN A & DONNA R
INSPTR 901 FERNDALE RD
DC LINCOLN, NE 68510

EASTRIDGE SECOND BLOCK 10
LOT 2

SECTION 1-2

SEQUENCE 805 LOCATION 00901 FERNDALE RD

0588211 KALNINS, PETERIS
INSPTR 835 ELDON DR
DC LINCOLN, NEBR. 68510

EASTRIDGE SECOND BLOCK 10
LOT 1

SECTION 1-2

SEQUENCE 806 LOCATION 00835 ELDON DR

0586439 ZASTRO, THOMAS E & KATHRYN
INSPTR 800 MULDER DR
DC LINCOLN, NE 68510

EASTRIDGE ADD BLOCK 14 LOT
1

SECTION 1-2

SEQUENCE 807 LOCATION 00800 MULDER DR

0587697 MCCREIGHT, FRANCES H & KEITH R
INSPTR 814 MULDER DR
DC LINCOLN, NE 68510

EASTRIDGE SECOND BLOCK 06
LOT 24

SECTION 1-2

SEQUENCE 808 LOCATION 00814 MULDER DR

69

67

TAX # NAME AND ADDRESS
0587681 MARCUS, MORDECAI & ERIN J
INSPTR 822 MULDER DR
DC LINCOLN, NEBR. 68510

LEGAL
EASTRIDGE SECOND BLOCK 06
LOT 23

EASTRIDGE 2
23

SECTION 1-2

SEQUENCE 809

LOCATION 00822 MULDER DR

0587672 COWEN, JAMES D. & JEAN M.
INSPTR 830 MULDER DR
DC LINCOLN, NEBR. 68510

EASTRIDGE SECOND BLOCK 06
LOT 22

EASTRIDGE 2

SECTION 1-2

SEQUENCE 810

LOCATION 00830 MULDER DR

0587630 OLSEN, DUANE A & CAROLYN F
INSPTR 910 MULDER DR
DC LINCOLN, NEBR. 68510

EASTRIDGE SECOND BLOCK 06
LOT 18

EASTRIDGE 2

SECTION 1-2

SEQUENCE 814

LOCATION 00910 MULDER DR

0587583 WILSON, ROBERT R & ANNETTE E
INSPTR 944 MULDER DR
DC LINCOLN, NE 68510

EASTRIDGE SECOND BLOCK 06
LOT 13

EASTRIDGE 2

SECTION 1-2

SEQUENCE 819

LOCATION 00944 MULDER DR

0586455 MENARD, JAMES L & VELDA R
INSPTR 801 DALE DR
DC LINCOLN, NE 68510

EASTRIDGE ADD BLOCK 14 LOT
3

EASTRIDGE

23

SECTION 1-2

SEQUENCE 824

LOCATION 00801 DALE DR

0587303 KOVANDA, SHIRLEY B
INSPTR 930 DALE DR
DC LINCOLN, NEBR. 68510

EASTRIDGE SECOND BLOCK 04
LOT 8

EASTRIDGE 2

SECTION 1-2

SEQUENCE 825

LOCATION 00930 DALE DR

23

6

70

65

TAX # NAME AND ADDRESS
0587290 STARR, THOMAS L JR & CHRISTINE
INSPTR 6210 SUNRISE
DC LINCOLN, NE 68510

LEGAL
EASTRIDGE SECOND BLOCK 04
LOT 7

EASTRIDGE 2

SECTION 1-2

SEQUENCE 826 LOCATION 06210 SUNRISE RD

0587281 GRANDGENETT, DWIGHT P & D JANE
INSPTR 6216 SUNRISE RD
DC LINCOLN, NE 68510

EASTRIDGE SECOND BLOCK 04
LOT 6

EASTRIDGE 2

SECTION 1-2

SEQUENCE 827 LOCATION 06216 SUNRISE RD

0587273 MORRIS, ROLLO B & VELMA J
INSPTR 6222 SUNRISE RD
DC LINCOLN, NEBR. 68510

EASTRIDGE SECOND BLOCK 04
LOT 5

EASTRIDGE 2

SECTION 1-2

SEQUENCE 828 LOCATION 06222 SUNRISE RD

~~0579831 MARTIN, GARRY L. & REBECCA J.
INSPTR 335 SD. 29TH ST.
DC LINCOLN, NEBR. 68510~~

~~EASTLINCOLN BLOCK 9 LOT 6~~

*Not to be included in
this district!*

~~SECTION 1-2~~

~~SEQUENCE 829 LOCATION 03335 SD 29 ST~~

0581330 ECKLUND, STANLEY G. & JEANETTE
INSPTR 300 CAROLYN CT
DC LINCOLN, NEBR. 68510

EASTMONT SECOND ADD BLOCK
02 LOT 13

EASTMONT 2

SECTION 1-2

SEQUENCE 830 LOCATION 00300 CAROLYN CT

0586731 BERANEK, EMIL L & MARGARET L
INSPTR 1000 ROBERT RD
DC LINCOLN, NEBR. 68510

EASTRIDGE FIRST BLOCK 02
LOT 11

EASTRIDGE 1

SECTION 1-2

SEQUENCE 832 LOCATION 01000 ROBERT RD

71

69

TAX # NAME AND ADDRESS
0584714 HARDING, MARGARET S
INSPTR 5700 SUNRISE
DC LINCOLN, NEBR. 68510

LEGAL
EASTRIDGE FIRST BLOCK 02
LOT 9

EASTRIDGE 1

SECTION 1-2

SEQUENCE 836 LOCATION 05700 SUNRISE RD

1232384 LEY, JONATHAN H
INSPTR 924 ROCKHURST DR
DC LINCOLN, NE 68510

TAYLOR MEADOWS 3RD ADD LOT
4

TAYLOR

SECTION 1-2

No Block 40-

SEQUENCE 837 LOCATION 00924 ROCKHURST DR

0033054 MII-PIEDMONT LIMITED PARTNER-
INSPTR SHIP
DC 11236 DAVENPORT ST
OMAHA, NE 68154

PIEDMONT SUB ALL BLOCK 14

No
Loss

PIEDMONT

SECTION 1-2

18

SEQUENCE 841 LOCATION 01255 SO CORNER BLV
FC THE PIEDMONT SHOPS

0749346 HAHN, MARK & CYNTHIA S
INSPTR 340 SO 53
DC LINCOLN, NE 68510

TROENDLYS SUB LT 5 W HLF

TROENDLYS

SECTION 1-2

No Block 18

SEQUENCE 843 LOCATION 00340 SO 53 ST

1546966 GRANDMOTHER'S INC
INSPTR 8420 W DODGE RD #100
DC OMAHA, NE 68114

IRREG TRACT LOT 02 SE EX
THAT PART LYING
IN THE WEST 23-10-7
(EXCEPTION DESCRIBED IN
INST #97-5826)

SECTION 1-2

SEQUENCE 857 LOCATION 06930 A ST

0603279 SELECTION RESEARCH INC
INSPTR 302 SO 53 ST PLACE
DC LINCOLN, NE 68510

EXECUTIVE CENTER
LOT 2

EXECUTIVE

SECTION 1-2

No Block 39-

SEQUENCE 863 LOCATION 00301 SO 68 ST

6

72

70

TAX # NAME AND ADDRESS
1578183 MOORE, CARLTON H
INSPTR 3141 RANDOLPH
DC LINCOLN, NE 68510

LEGAL
STASTNEYS SUB W59' LOTS 1,
2 & 3 &
E29' LOTS 16, 17, & 18 &
VAC N-S ALLEY ADJ

No blk
STASTNEYS
13A

SECTION 1-2

SEQUENCE 866

LOCATION 05141 RANDOLPH ST

1542383 BAUER, RALPH R JR & JUDITH
INSPTR 5620 RANDOLPH
DC LINCOLN, NE 68510

EASTRIDGE ADD THAT PART OF
OUTLOT A LYING S OF THE N
LINE OF LT 7 BLK 16 EASTMONT
ADD EXTENDED EASTERLY; AND
EASTMONT ADDBLOCK 16 CITY
LOT 7 & VAC RANDOLPH ST ADJ

SECTION 1-2

SEQUENCE 883

LOCATION 05620 RANDOLPH ST

No blk EASTMONT
16E

0871044 BLISS, HARRY R & BETTY ET AL
INSPTR 435 SD 50
DC LINCOLN, NE 68510

RANDOLPH ACRES LOT 127

SECTION 1-2

SEQUENCE 684

LOCATION 00425 SD 50 ST

No Block
11B

0869724 HOUSING AUTHORITY
INSPTR P.O, BOX 5327
DC LINCOLN, NE 68505

RANDOLPH ACRES LOT 59 W
153'

SECTION 1-2

SEQUENCE 193

LOCATION 440 SD 53

RARE

0965846 HAHN, MARK & CYNTHIA
INSPTR 5712 CULWELLS RD
DC LINCOLN, NE 68516

TROENDLYS SUB LOT 6 W HLF

SECTION 1-2

SEQUENCE 174

LOCATION 340 SD 53

TROENDLYS

No Block
1B

0941085 BLOHM, CHARLENE
INSPTR 5134 M ST
DC LINCOLN, NE 68510

STUHR'S PARK VIEW BLOCK 1
LOT 3
LOT 4

SECTION 1-2

SEQUENCE 381

LOCATION 5134 M ST

BLK 1
STUHR'S
22

8

73

71

TAX #	NAME AND ADDRESS	LEGAL
0870520	FRANSON, JAMES P & DIANNA K	RANDOLPH ACRES LOT 100 N 61
INSPTR	616 SO 51 ST	
DC	LINCOLN, NE 68510	

RAAC
No Block *118*

SECTION 1-2
SEQUENCE 456 LOCATION 616 SO 51 ST

0870072	BEIS, DAVID A & JULIA A	RANDOLPH ACRES LOT 75 N 61
INSPTR	700 SO 52 ST	LOT 76 S 10
DC	LINCOLN, NE 68510	

RAAC
No Block

SECTION 1-2
SEQUENCE 468 LOCATION 700 SO 52 ST

0588814	DEWEY, BARBARA L	EASTRIDGE FOURTH BLK 1 LOT
INSPTR	6001 SUNDRISE RD	1
DC	LINCOLN, NE 68510	

RAAC
No Block
24

SECTION 1-2
SEQUENCE 753 LOCATION 6001 SUNDRISE RD

0587613	MESSERLI, CARLOS & SUSAN	EASTRIDGE SECOND BLK 6 LOT
INSPTR	924 MULDER DR	16
DC	LINCOLN, NE 68510	

EASTRIDGE
22

SECTION 1-2
SEQUENCE 816 LOCATION 924 MULDER DR

0587001	MALLON, JAMES M & ALICE M	EASTRIDGE FIRST BLK 4 LOT 6
INSPTR	924 MORaine DR	
DC	LINCOLN, NE 68510	

EASTRIDGE
23

SECTION 1-2
SEQUENCE 848 LOCATION 00924 MORaine DR

0587028	MCUNT, ELAINE	EASTRIDGE FIRST BLK 4 LOT 8
INSPTR	944 MORaine DR	
DC	LINCOLN, NE 68510	

EASTRIDGE

SECTION 1-2
SEQUENCE 849 LOCATION 00944 MORaine DR

6

XL4

72

TAX # 1589002
NAME AND ADDRESS IRWIN, JACK
INSPTR 3440 FROST DR
OF LINCOLN, NE 68510

LEGAL
EASTMONT 2ND ADD BLK 4 LOTS
11 & 12

EASTMONT 2

SECTION 1-2

24

SEQUENCE 885

LOCATION 209 EASTRIDGE DR

0870765 HERRINGTON, JOHN C & ANGELA
INSPTR 5016 RANDOLPH
DC LINCOLN, NE 68510

RANDOLPH ACRES E65' LOT 112
EX N29'

RAAC
11B No Block

SECTION 1-2

SEQUENCE 450

LOCATION 05016 RANDOLPH ST

0587559 JANIKE, WM S & NANCY C
INSPTR 5627 SUNRISE RD
DC LINCOLN, NEBR. 68510

EASTRIDGE SECOND BLOCK 06
LOT 10

EASTRIDGE 2

SECTION 1-2

23

SEQUENCE 822

LOCATION 00937 DALE DR

0869481 RAWATE, ARUN K & CLARA R
INSPTR 5340 RANDOLPH
DC LINCOLN, NE 68510

RANDOLPH ACRES LOT 43

RAAC

SECTION 1-2

11B No Block

SEQUENCE 875

LOCATION 05340 RANDOLPH ST

4

75

73

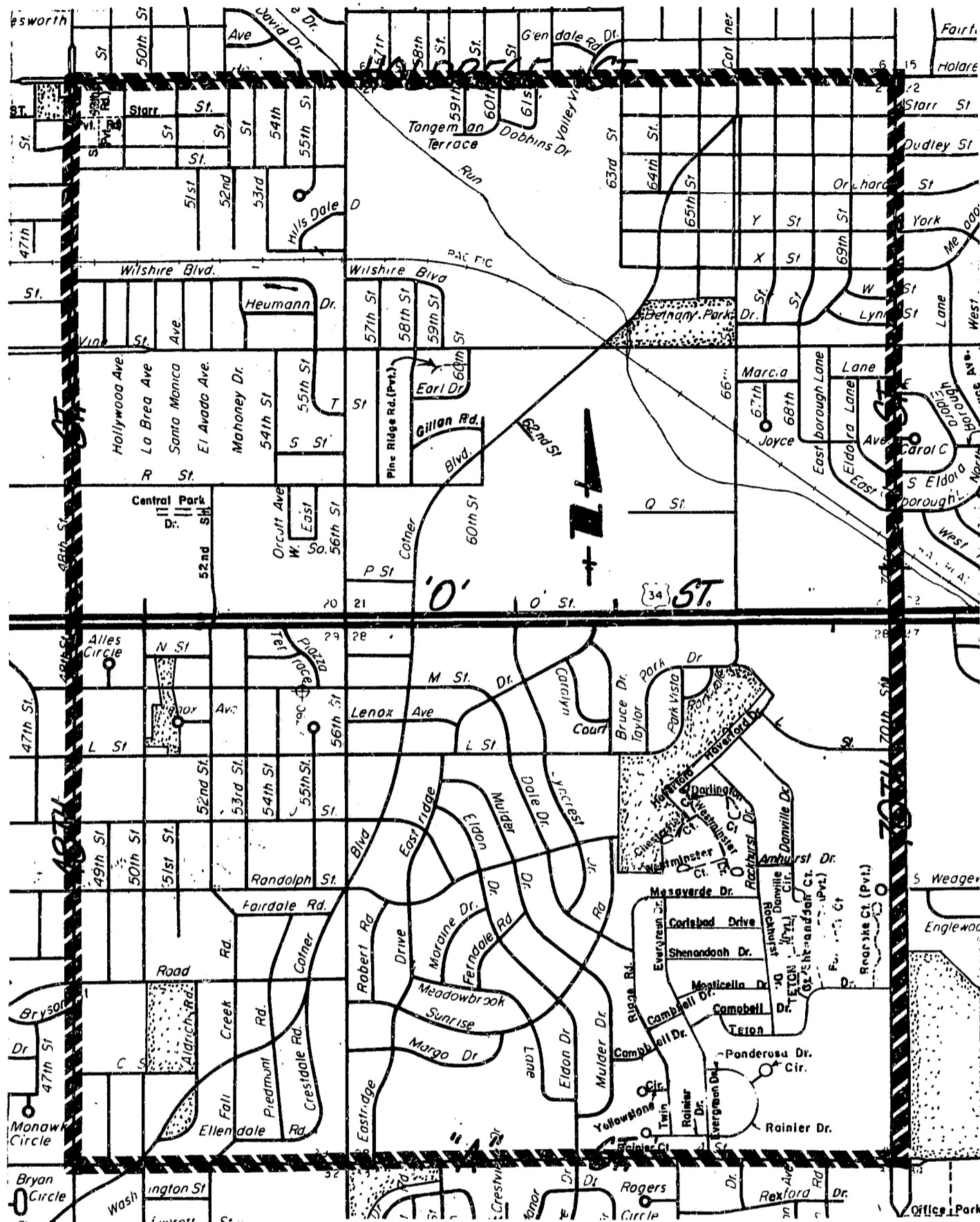

SIDEWALK DISTRICT NO. 85

REGISTERED LIGHT BLOCK

Dan Jello

REGISTERED BLOCKS

90 AUG 16 AM 9:45

ENTERED ON
NUMERICAL INDEX
FILED FOR RECORD AS

INST. NO. 90-25145

\$574.50

*Hill
City Club
ATTN
Joan*

SEARCHED
INDEXED
SERIALIZED
FILED