

Map of
BEHRENS ADDITION
No. 10.

BLAIR
WASHINGTON COUNTY

NEBRASKA

Cont. of
Sec. 10.
Township 18 N. Range 11 E. 64th P.M. Nebraska.
Acres 100 feet a 1 inch.

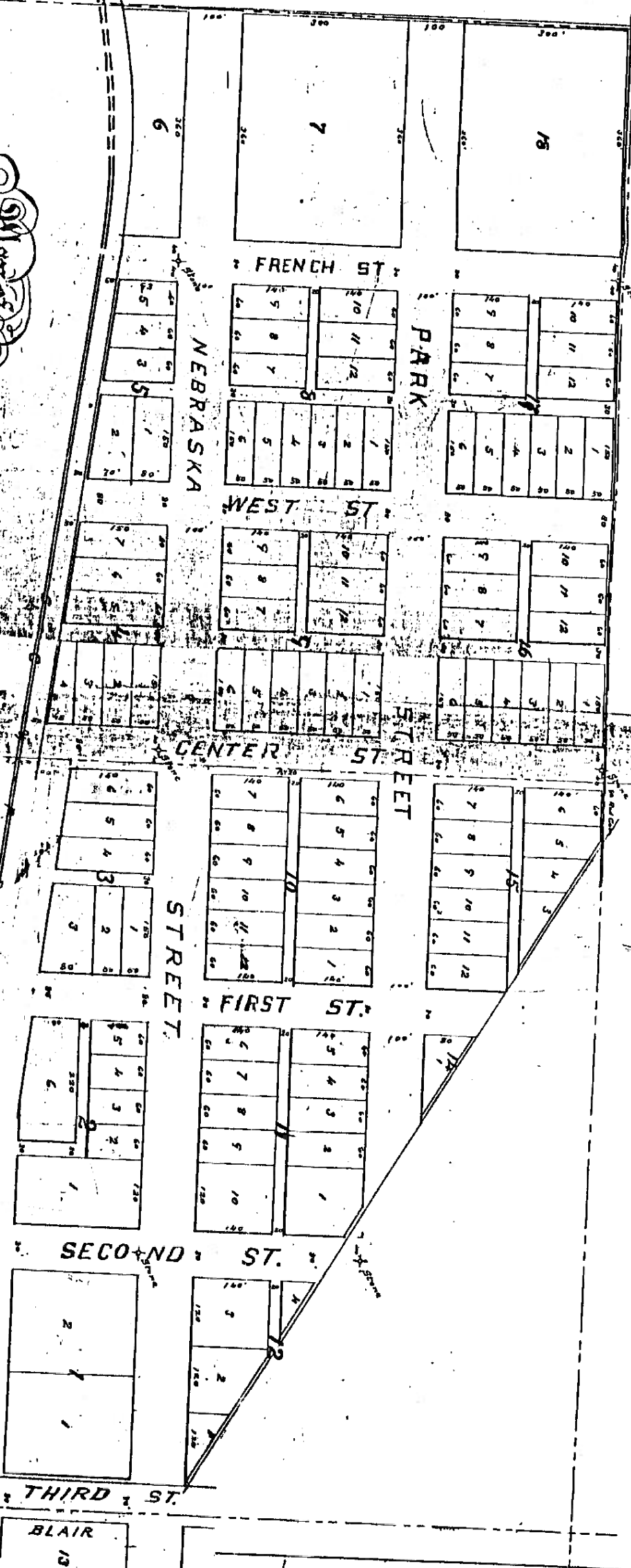

City of
BEVERLY ADDITION
 to

R. I. A. P. Co.
 WASHINGTON COUNTY

NEBRASKA

Township 18 N. Range 11 E. 6th P.M. Nebraska
 Scale 1/2 inch = 100 feet

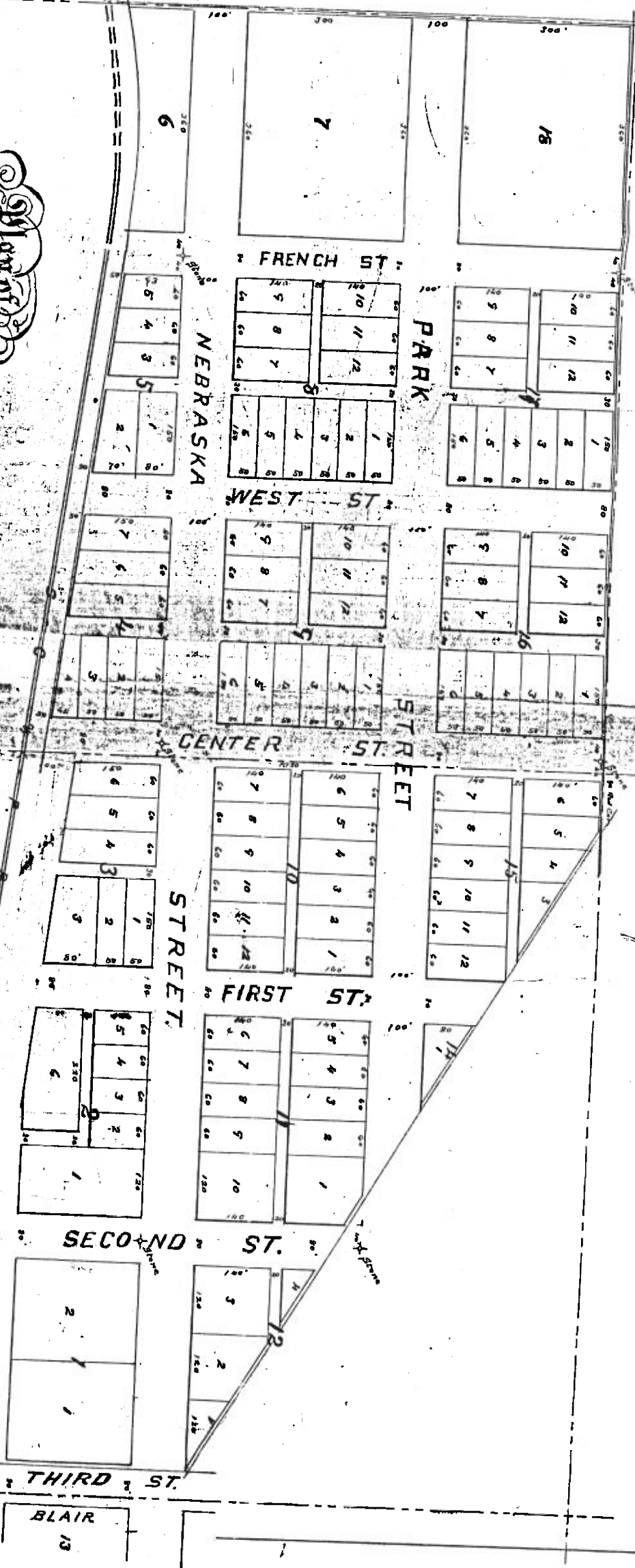

BLAIR