

MASTER DEED CREATING

CRYER CREST TOWNHOMES CONDOMINIUM PROPERTY REGIME

THIS MASTER DEED AND DECLARATION made this 19th day of October, 1972, by THE KOPECKY COMPANY, a Nebraska corporation, (herein called "Developer"), for itself, its successors, grantees and assigns,

W I T N E S S E T H :

1. The purpose of this Master Deed is to submit the lands herein described and the improvements to be built thereon to the condominium form of ownership and use in the manner provided by Sections 76-801 through 76-823, R.R.S. Nebraska (herein called "Condominium Act"), and the name by which this condominium is to be identified is Cryer Crest Townhomes Condominium Property Regime.

2. The lands owned by the Developer which are hereby submitted to the condominium regime are described as follows:

Lots 8, 9, 10 and 11, Block 6, Happy Hollow View Addition, an addition in Douglas County, Nebraska as surveyed, platted and recorded.

3. The definitions set forth in Section 76-802, R.R.S. Nebraska shall govern this Master Deed and the attached By-Laws.

4. The condominium will consist of 17 buildings which will vary in height from one to two stories. The buildings will contain a total of 27 units which may only be used for residential purposes. The condominium will also include automobile garages, parking areas, gardens and landscaping. The total ground floor area of all buildings (including garages) aggregates 32,236 square feet and the total land area aggregates 145,799 square feet. Said buildings and improvements together with their location on the land and the area and location of each unit are more particularly described in the plans which are attached hereto and recorded with this Master Deed.

5. The general common elements of the condominium are described as follows: the land on which the buildings stand including all of the surrounding lands embraced within the legal description specified above; the exterior surfaces of all buildings except for screening, window glass and exterior doors including garage doors, exterior water taps which may be used by the co-owners association for watering and maintenance of common areas; the foundations, common walls, roofs, yards and gardens, except that any yard areas that may be included within patios or decks delineated on the attached plans shall not be common elements; drives, walks, parking areas and all parts of the property and improvements which are not located within the units as shown on the attached plans. Air conditioning compressors or units are not common elements but are part of each apartment and shall be maintained and replaced as needed by each owner. Each unit owner shall be responsible for the repair, maintenance and replacement of all exterior doors including garage doors and the mechanical operators thereof; it being understood that the only common area maintenance of exterior doors shall be the painting or finishing of the exterior surfaces thereof. If any

owner fails to repair, maintain or replace the exterior of his unit as required in this Master Deed and the By-Laws described below, the Association may perform such work, invoice the owner therefor and secure and enforce a claim and lien therefor against the owner and his unit in like manner as a delinquent assessment for common element expense.

6. The total value of the entire condominium regime is \$822,000.00, and the basic value of each unit together with the percentage which each unit shall share in the expenses of and the rights in the common elements are as follows:

<u>UNIT NUMBER</u>	<u>BASIC VALUE</u>	<u>PERCEN- TAGE</u>
1	\$ 31,000	3.8
2	30,000	3.6
3	30,000	3.6
4	30,000	3.6
5	30,000	3.6
6	30,000	3.6
7	31,000	3.8
8	30,000	3.6
9	31,000	3.8
10	31,000	3.8
11	30,000	3.6
12	31,000	3.8
13	31,000	3.8
14	31,000	3.8
15	30,000	3.6
16	30,000	3.6
17	30,000	3.6
18	32,000	3.9
19	30,000	3.6
20	31,000	3.8
21	30,000	3.6
22	30,000	3.6
23	30,000	3.6
24	30,000	3.6
25	30,000	3.6
26	31,000	3.8
27	31,000	3.8

7. The following covenants, conditions and restrictions relating to this condominium regime shall run with the land and bind all co-owners, tenants of such owners, employees and any other persons who use the property, including the persons who acquire the interest of any co-owner through foreclosure, enforcement of any lien or otherwise:

a. Cryer Crest Townhomes Association, Inc., a Nebraska non-profit corporation, has been incorporated to provide a vehicle for the management of the condominium. Each co-owner shall automatically be deemed a member of said Association. The By-Laws of said Association are also the By-Laws of this condominium and are attached hereto.

b. The common elements are for the use and enjoyment of all co-owners. The ownership of the common elements shall remain undivided, and no person or co-owner shall bring any action for the partition or division of the common elements. The Association shall from time to time establish rules and regulations for the use of the common elements, and all co-owners and users shall be bound thereby. The Association shall have the sole jurisdiction over and responsibility for making alterations, improvements, repairs and maintenance of the common elements. The share of a co-owner in the common elements is

appurtenant to his unit and inseparable from unit ownership. Assessments against co-owners for insurance, common element expenses and reserves and for other expenses incurred by the Association shall be made pursuant to the By-Laws. Assessments paid within ten days after the date when due shall not bear interest, but all sums not paid within said ten-day period shall bear interest at the highest legal rate from due date until paid. If any co-owner shall fail or refuse to make any payment of such assessments when due, the amount thereof plus interest shall constitute a lien upon the co-owner's interest in his unit and in the property, and upon the recording of such lien by the Association in the Register of Deeds of Douglas County, Nebraska, such amount shall constitute a lien prior and preferred over all other liens and encumbrances except assessments, liens and charges for taxes past due and unpaid on the unit and except prior duly recorded mortgage and lien instruments.

c. Each co-owner shall be responsible:

(1) To maintain, repair and replace at his expense all portions of his unit which are not included in the definition of common elements.

(2) To refrain from painting, decorating or changing the appearance of any portion of the exterior of the unit building; unless approved by the Association in writing.

(3) To promptly report to the Association any defect or need for repairs which are the responsibility of the Association.

d. Each unit shall be used and occupied only by one family, its servants and guests as a residence and for no other purpose. No unit may be subdivided into a smaller unit nor any portion thereof sold or transferred without first amending this Master Deed to show the changes in the units to be subdivided and subject only to approval of the Association.

e. No practice or use shall be permitted on the condominium property or in any unit which shall be an annoyance to other owners or residents of the area or which shall interfere with their peaceful use and enjoyment of their property. All portions of the property and of the units shall be kept clean and sanitary and no use thereof shall be made which constitutes a violation of any laws, zoning ordinances, governmental regulations or regulations of the Association.

f. No unit owner may sell or lease his unit or any interest therein without the prior written approval of the Association. This provision shall not affect transfer by death but any person inheriting such unit shall be subject to those restrictions on subsequent transfer. An owner intending to make a sale or lease of his unit shall give the Association written notice thereof together with the name, and a current address and credit report of the purchaser or lessee and the terms and price of such sale or lease, together with a copy of the proposed purchase agreement or lease. Within thirty days after receipt of such notice, the Association shall by written notice to the owner either approve such purchase or lease or elect to either purchase the property for said price or terms or either lease the property or furnish a substitute tenant for the property on the terms and for the price contained in said lease. If the Association elects to purchase or lease, closing shall be within thirty days thereafter. Failure of the Association to act within the first 30-day period shall be deemed an approval of the sale or lease, but only to the party thus identified and

disclosed to the Association. The above provisions regarding approval of transfers shall not apply to acquisition of ownership through foreclosure of a mortgage upon a unit.

g. Co-owners representing three-fourths or more of the total basic value of the condominium may at any time in writing duly acknowledged and recorded effect an amendment to this Master Deed and to the By-Laws and plans attached hereto; provided that such modification shall not be binding upon any existing mortgage holders of record unless such mortgage holder likewise consents to such modification in writing.

h. This condominium regime may be terminated or waived by written agreement of unit owners representing three-fourths or more of the total basic value of the condominium and by all lien holders of record; which agreement shall be acknowledged and recorded in the Register of Deeds and termination shall be effective as of recording date. Following termination, the property may be judicially partitioned and sold upon the petition of any unit owner, but if co-owners representing three-fourths of the total basic value of the condominium agree in writing to sell or otherwise dispose of the condominium property, then all unit owners shall be bound to execute such deeds or other documents reasonably necessary to effect such sale or disposition when and as required by the Board of Directors of the Association. In such case, any pending partition action shall be dismissed in order to permit completion of such sale or disposition.

i. Special Provisions. Household pets within the condominium will be subject to regulation, restriction, exclusion and special assessment as may be determined by the Association from time to time. All garage doors must remain closed at all times except when cars are entering or exiting the garage space. No garbage cans or trash receptacles are to be permitted outside. Private barbecue grills may not be used in the common areas, and outside use or storage of barbecue grills will be subject to regulation, restriction or exclusion by the Association. Automobile parking will be subject to regulation and restriction by the Association.

j. All notices required hereby shall be in writing and sent by certified or registered mail -- return receipt requested.

(1) To an owner at his last-known address on the books of the Association.

(2) To the condominium or the Association at registered office of the Association.

EXECUTED the date first above written.

THE KOPECKY COMPANY

By [Handwritten Signature]
President

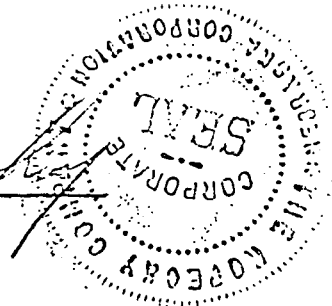

STATE OF NEBRASKA)
) SS.
COUNTY OF DOUGLAS)

On the day and year last above written, before me, the undersigned a Notary Public in and for said County, personally

came R. J. Kopecky, President of The Kopecky Company, to me personally known to be the President and the identical person whose name is affixed to the foregoing instrument and acknowledged the execution thereof to be his voluntary act and deed as such officer and the voluntary act and deed of the said corporation.

WITNESS my hand and Notarial Seal at Omaha, Nebraska, in said County, the day and year last above written.

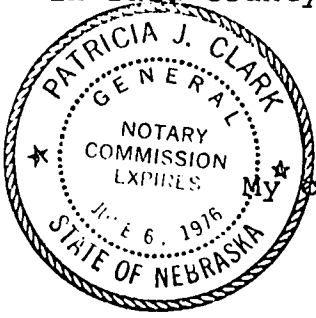

Patricia J. Clark
Notary Public

My commission expires: June 6, 1976

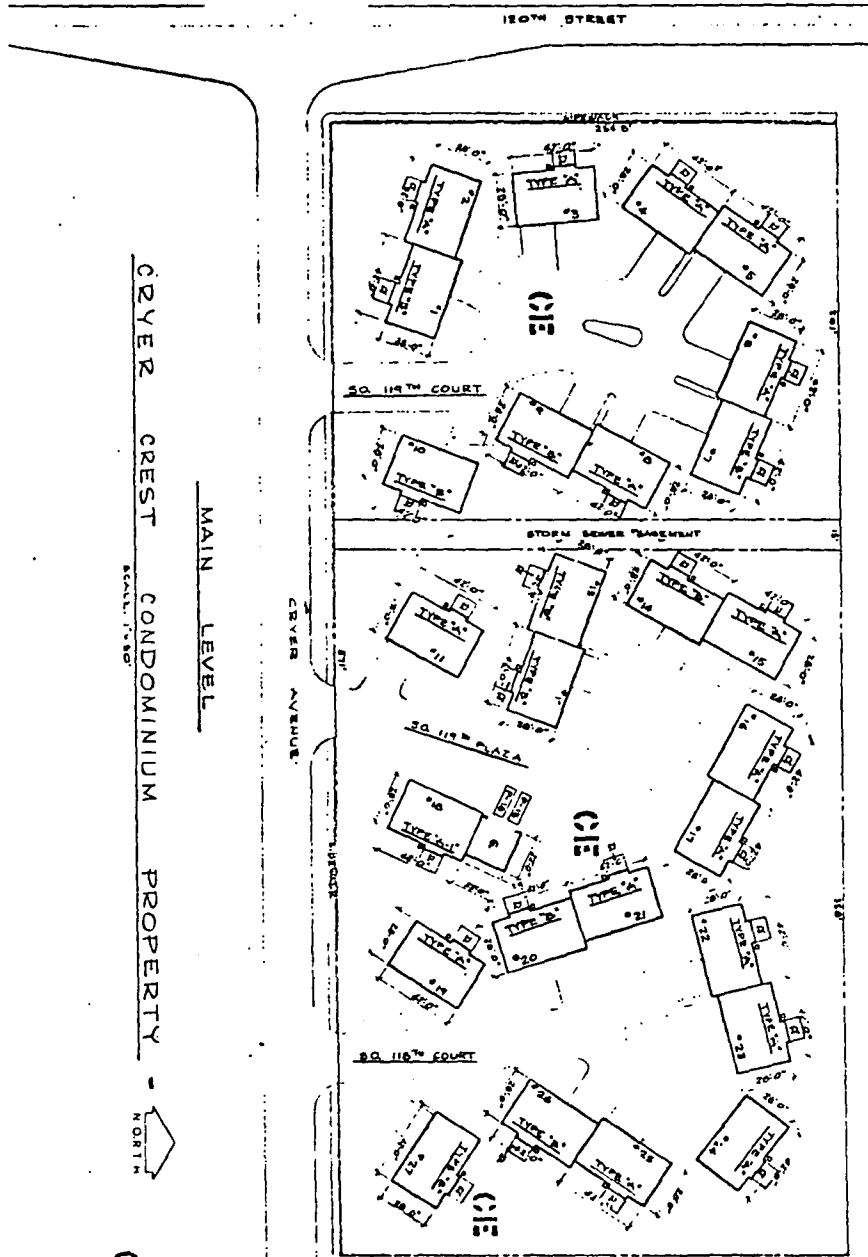

CRYER CREST CONDOMINIUM PROPERTY
 MAIN LEVEL
 SCALE: 1"=50'

KEY
 [Symbol] GARAGE
 [Symbol] RESERVED PARKING
 [Symbol] AIR CONDITIONING UNIT
 [Symbol] COMMON ELEMENTS: PRIVATE AND OTHER RESERVATION DESIGNATED IN PARAGRAPHS 5 OF MASTER DEED



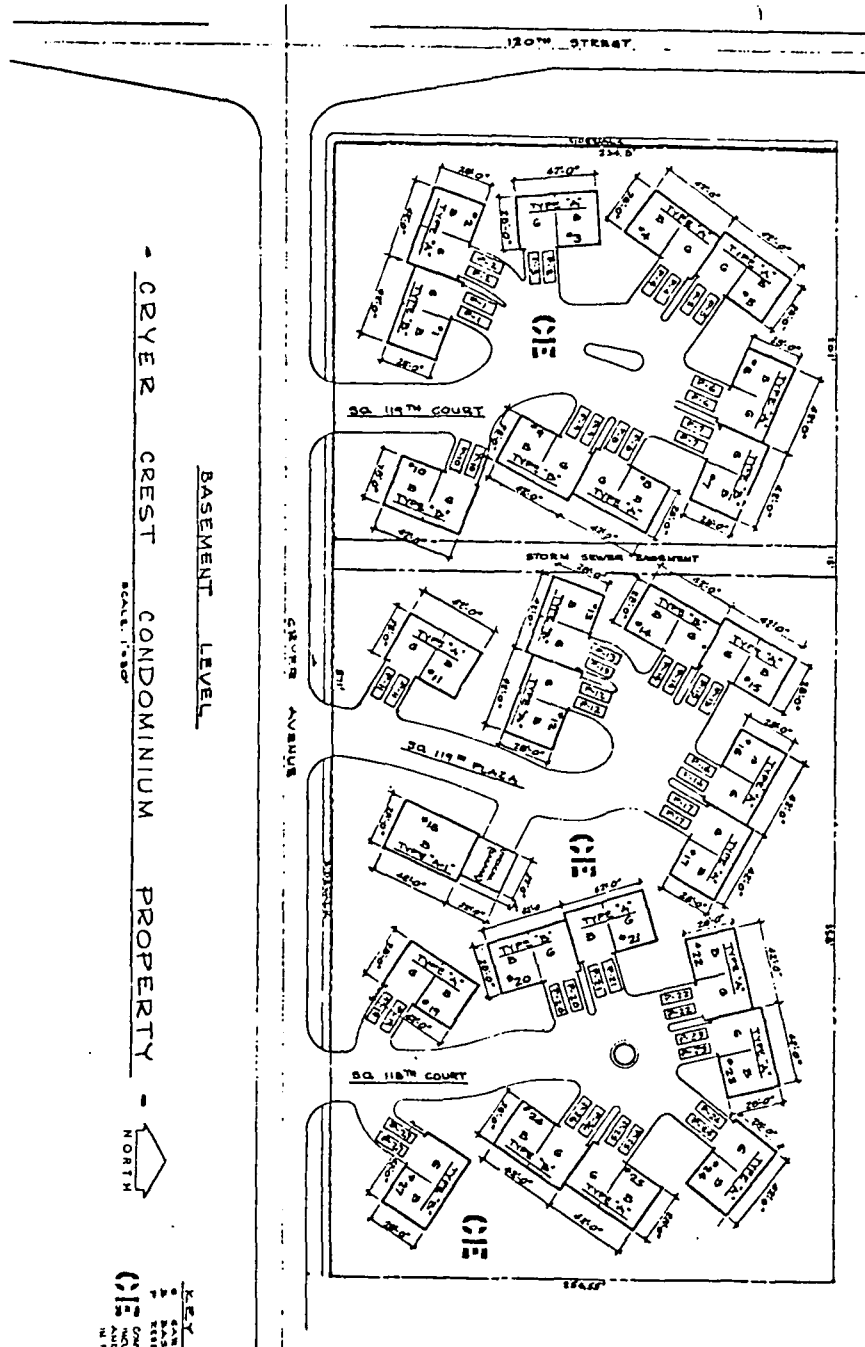

KEY
 1 STAIRS
 2 ELEVATOR
 3 COMMON ELEMENTS
 4 COMMON ELEMENTS DRIVE
 5 COMMON ELEMENTS DRIVE
 6 COMMON ELEMENTS DRIVE
 7 COMMON ELEMENTS DRIVE
 8 COMMON ELEMENTS DRIVE

THE UNDERSIGNED HAS REVIEWED THE PLANS AND SPECIFICATIONS FOR THE CONDOMINIUM PROJECT AND HAS FOUND THEM TO BE IN ACCORDANCE WITH THE REQUIREMENTS OF THE NEBRASKA CONDOMINIUM ACT AND THE NEBRASKA CONDOMINIUM REGULATIONS. I HEREBY CERTIFY THAT THE PLANS AND SPECIFICATIONS ARE COMPLETE AND CORRECT AS SUBMITTED.

Robert W. [Signature]

ENTERED IN NUMERICAL INDEX AND RECORDED IN THE REGISTER OF DEEDS OFFICE IN DOUGLAS COUNTY, NEBRASKA
 ... 1 DAY OF November 22 1972 AT 2:48 P.M. G. HEROLD GATLEY, REGISTER OF DEEDS

25

CRYER CREST TOWNHOMES

10000 GUYTON STREET
 OMAHA, NEBRASKA 68106
 (402) 394-7227

AMERICAN TITHE GROUP