

STORM SEWER NO. 1540  
Between 21st and M Streets and Dahlman Avenue and D Street

Easement for sewer through the Union Stock Yards Company's property North of the East and West center line of Section 4, T. 14, N.R. 13 E of the 6th P. M. and west of and along the west line of the Omaha Belt Railway (Missouri Pacific Railway) right-of-way to Dahlman Avenue; also for sewer in Vacated "G" Street between Dahlman Avenue and the Omaha Belt Railway.

Description of Easement:

a Beginning at a point on the westerly line of the Omaha Belt Railway (Missouri Pacific Railway <sup>road Corporation in Nebraska</sup>) seven hundred forty-eight and six-tenths (748.6) feet east of the center of Section 4, T. 14, N.R. 13 E of the 6th P. M. and twelve and five tenths (12.5) feet north of and at right angles to the said East and West center line of said Section 4; thence in a northwesterly direction along the westerly line of the Omaha Belt Railway right-of-way eighteen and three-tenths (18.3) feet to an angle point seven hundred thirty-five and nine-tenths (735.9) feet east of the center of said Section 4 and twenty-six (26) feet north of and right angles to the said East and West center line of said Section 4; thence in a northwesterly direction along the westerly line of the Omaha Belt Railway thirty-two and two-tenths (32.2) feet to a point seven hundred twenty (720) feet east of the center of said Section 4 and fifty four (54) feet north of and at right angles to the said East and West center line of said Section 4; thence southwesterly on a line which is a radial line of the curve of the sewer right-of-way, sixteen (16) feet to a point on the westerly line of the sewer easement, seven hundred eight and four-tenths (708.4) feet east of the center of said Section 4 and forty-two and eight tenths (42.8) feet north of and at right angles to the said East and West center line of said Section 4; thence in a southeasterly direction on a curve, the radius of which is one hundred forty-six and eighty-two one-hundredths (146.82) feet twenty-nine (29) feet to a point of curve, seven hundred thirty-one and two-tenths (731.2) feet east of the center of said Section 4 and twenty-four and four-tenths (24.4) feet north of and right angles to the East and West center line of Section 4; thence in a southeasterly direction twenty-one and two-tenths (21.2) feet to the place of beginning.

b Easement for a strip of land eight (8) feet each side of a center line described as follows:

Beginning at a point on the center line of the sewer easement on a curve the radius of which is one hundred-thirty-eight and eighty-two one-hundredths (138.82) feet and a central angle of twenty-four (24) degrees twenty-three (23) minutes and twenty (20) seconds (~~which point is also~~) which point is also seven hundred fourteen and two-tenths (714.2) feet east of the center of Section 4, T. 14, N, R13 E of the 6th P. M. and forty-eight and four-tenths (48.4) feet north of and at right angles to the east and west center line of said Section 4; thence in a northwesterly direction on the aforementioned curve, thirty-one and fifty-nine One-hundredths (31.59) feet to the end of the curve, twelve and eight-tenths (12.8) southwesterly and at right angles to the Omaha Belt Railway (Missouri Pacific Railway) right-of-way; (the said west right-of-way line of the Omaha Belt Railway (Missouri Pacific Railway) as noted in this description is also the east line of the Union Stock Yard Company's property in the N.E.  $\frac{1}{4}$  and N. W.  $\frac{1}{4}$  of Section 4, T/14, N.R.13 east of the 6th P. M. and in the South West  $\frac{1}{4}$  of Section 33, T.15 N., R.13 E. of the 6th P. M.); thence northwesterly five hundred thirty-one and sixty-nine one-hundredths (531.69) feet to a point of curve, thirty-four (34) feet west of and at right angles to the west right-of-way line of the Omaha Belt Railway; thence on a curve, the radius of which is three hundred eighty-nine and twenty-one one-hundredths (389.21) feet and a central angle of five degrees and fifty-three minutes (5 degrees 53 minutes) thirty-nine and ninety-six one-hundredths (39.96) feet to the end of the curve, thirty-three feet (33') west of and at right angles to the west right-of-way line of the Omaha Belt Railway; thence continuing in a northwesterly direction five hundred forty-one and sixty-seven One-hundredths (541.67) feet to a point of curve,

twenty-seven (27) feet west of and at right angles to the west right of way line of the Omaha Belt Railway; thence on a curve the radius of which is three hundred ninety-eight and twenty-five one-hundredths (398.25) feet and a central angle at five degrees and forty-five minutes (5 degrees, 45 minutes), thirty-nine and ninety-seven one-hundredths (39.97) feet to the end of the curve, twenty-seven<sup>(27)</sup>/feet west of and at right angles to the westerly line of the Omaha Belt Railway; thence continuing northwesterly, one thousand seventy-seven and sixteen one-hundredths (1077.6) feet to a point of curve twenty<sup>(20)</sup>/feet west of and at right angles to the westerly line of the Omaha Belt Railway; thence continuing in a northwesterly direction on a curve, the radius of which is five hundred sixteen and seven-tenths (516.7) feet and a central angle of four degrees, twenty-six minutes (4 degrees 26 minutes) to the end of the curve twenty-two (22) feet west of and at right angles to the westerly line of the Omaha Belt Railway; thence northwesterly three hundred sixty-one and three one-hundredths (361.03) feet to a point of curve, five hundred seventy-nine and sixteen one-hundredths (579.16) feet west of the northeast corner of the Northwest  $\frac{1}{4}$  of Section 4, T. 14, N., R. 13 E. of the 6th P. M. and seventy-six and seventy-six one-hundredths (76.76) feet south of and at right angles to the north line of said Section 4; thence on a curve to the right, the radius of which is one hundred twenty-nine and twenty-two one-hundredths (129.22) feet, forty-five and sixty-two one-hundredths (45.62) feet to the south line of "F" Street, five hundred ninety-one and two-tenths (591.2) feet west of the said northeast corner of the Northwest  $\frac{1}{4}$  of Section 4; and thirty-three<sup>(33)</sup>/feet south of and at right angles to the north line of said Section 4.

(Sewer alignment continues across "F" Street, is not included in easement) Easement description north of "F" Street: Beginning at a point on the north line of "F" Street on a

*Maps in back of book*

BOOK 223 PAGE 552

-4-

curve the radius of which is one hundred sixty-five and three one-hundredths (165.03) feet, five hundred ninety-two and forty-seven one-hundredths (592.47) feet west of the said northeast corner of the Northwest  $\frac{1}{4}$  of Section 4 and thirty-three feet <sup>west</sup> and at right angles to the north line of the said Section 4; thence northwesterly on the aforesaid curve thirty-eight and sixty-three one-hundredths (38.63) feet to the end of the curve six hundred one and thirty-one one-hundredths (601.31) feet west of the said northeast corner of the northwest  $\frac{1}{4}$  of Section 4 and seventy and forty-three one-hundredths (70.43) feet north of and at right angles to the north line of said Section 4; thence northwesterly six hundred twelve and thirty-three one-hundredths (612.33) feet to a point on the southerly line of Dahlman Avenue, six hundred nineteen and sixty-eight (619.68) feet northwesterly from the southwest corner of Block 258, South Omaha which is also the northeast corner of "F" Street and Dahlman Avenue.

*See maps on following pages*

*223-552 (A-B-C-D-E-F)*

*Ok J.E. [signature]*

PLAN
SCALE
DATE
BY
CHECKED
APPROVED

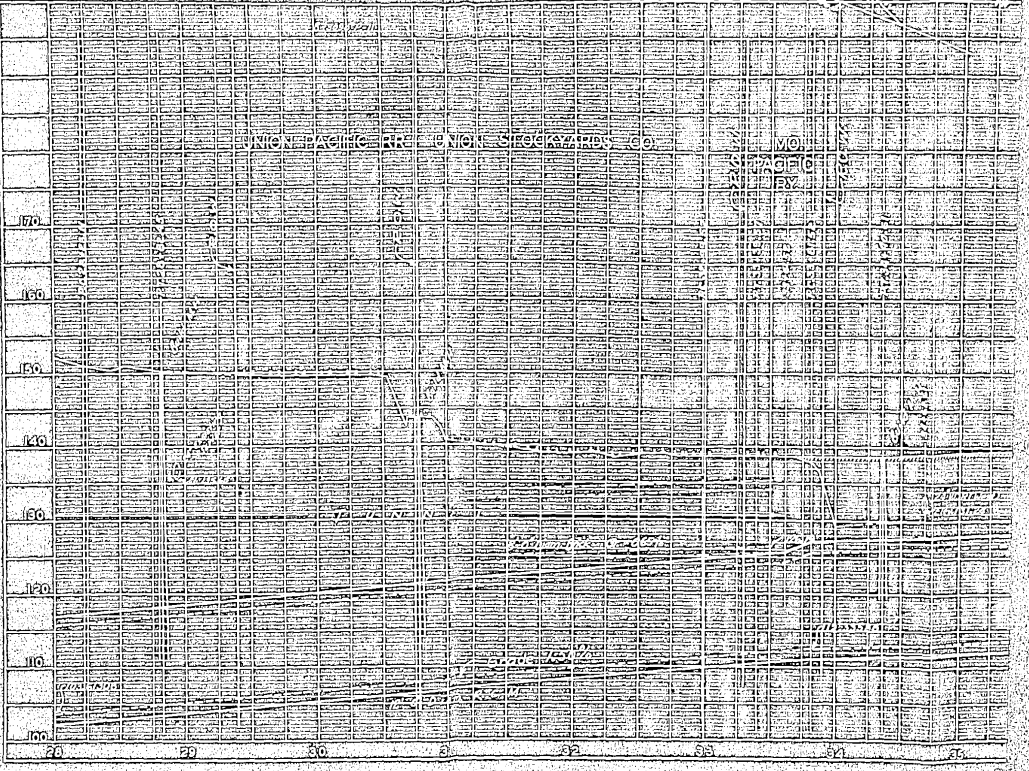
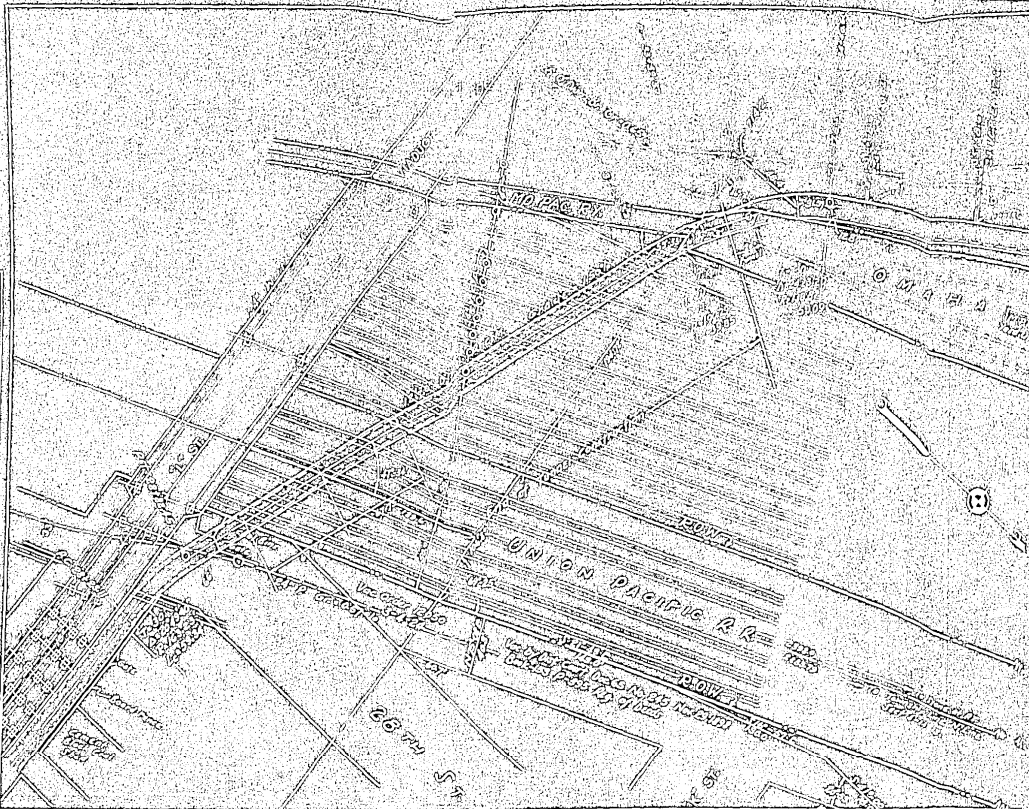

Plan No. 101-B

UNION STOCKYARDS CO.

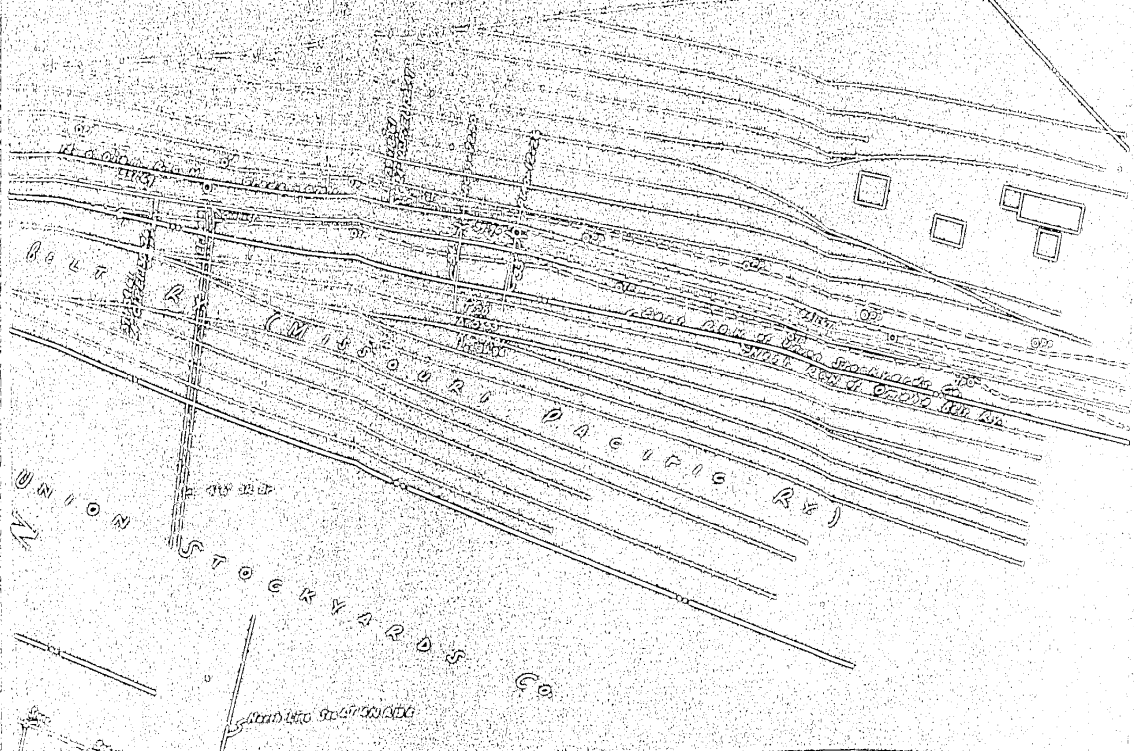

UNION STOCKYARDS CO.

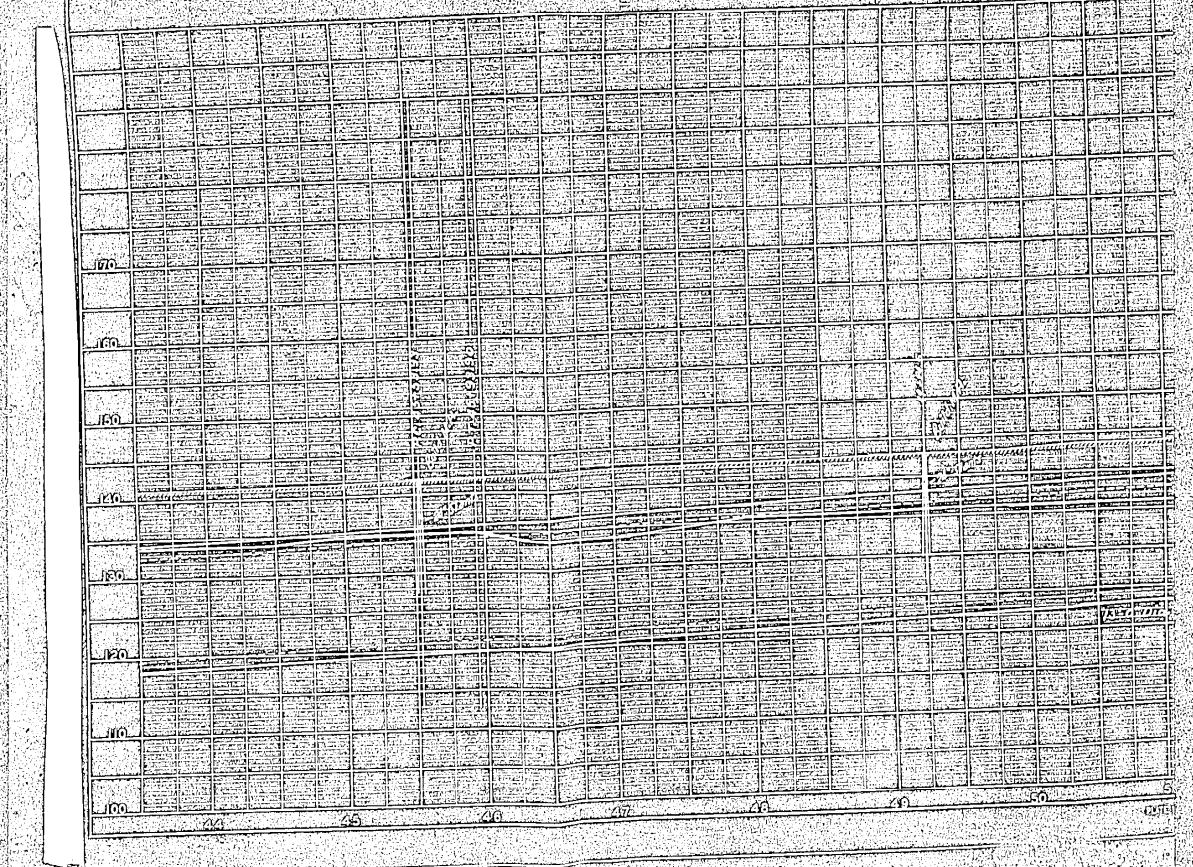
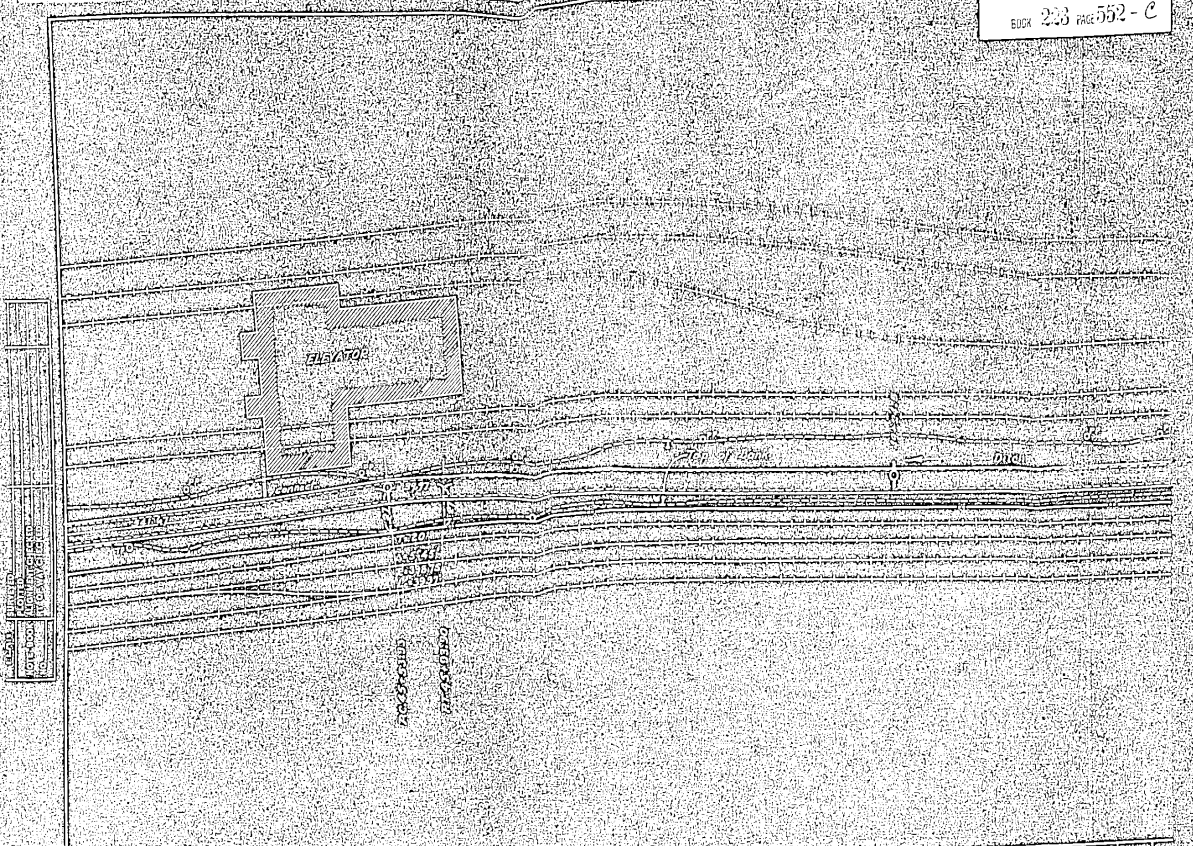

ENCL 23 and 552-D

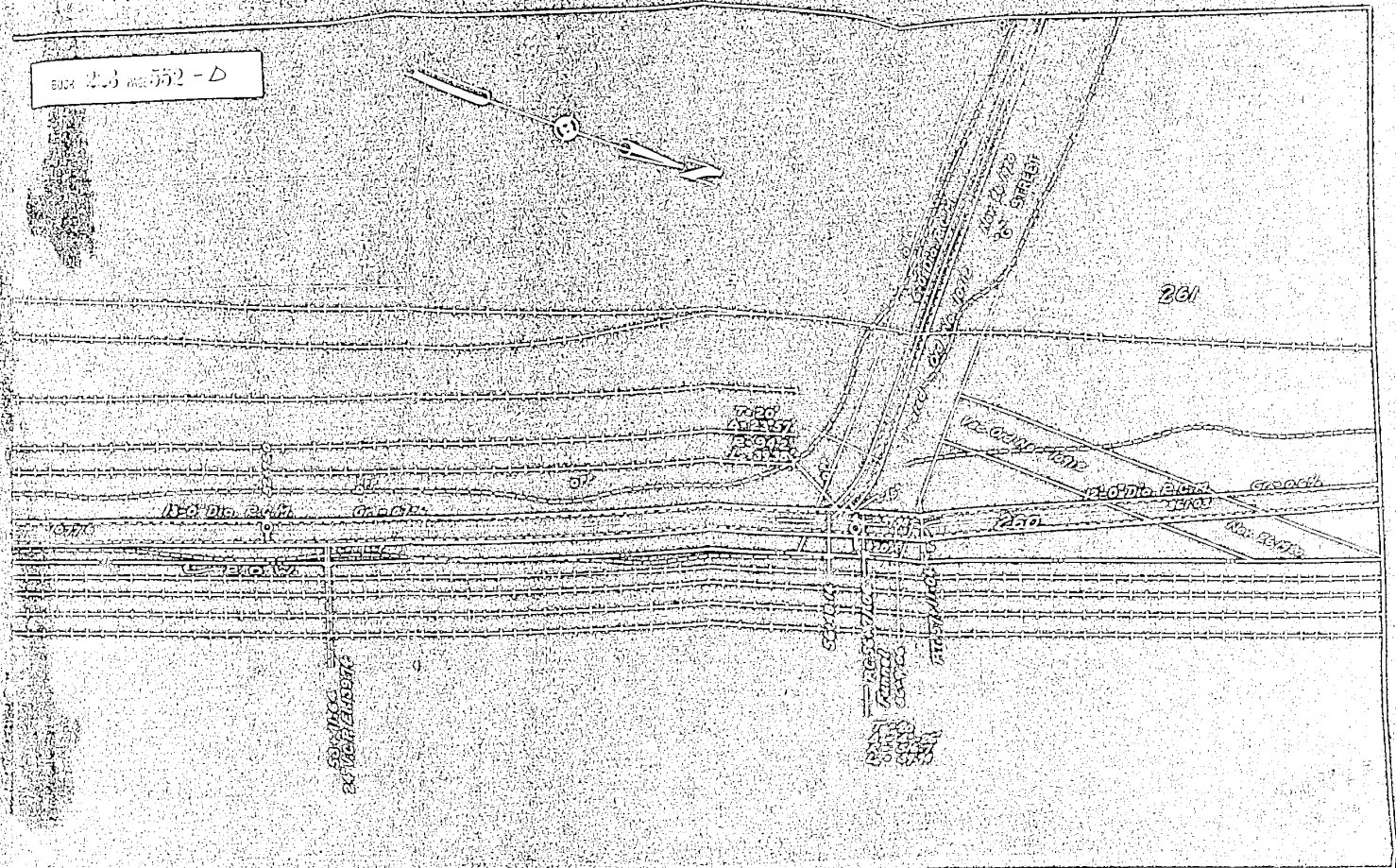
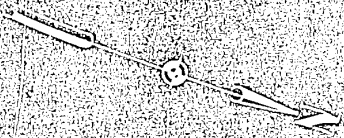





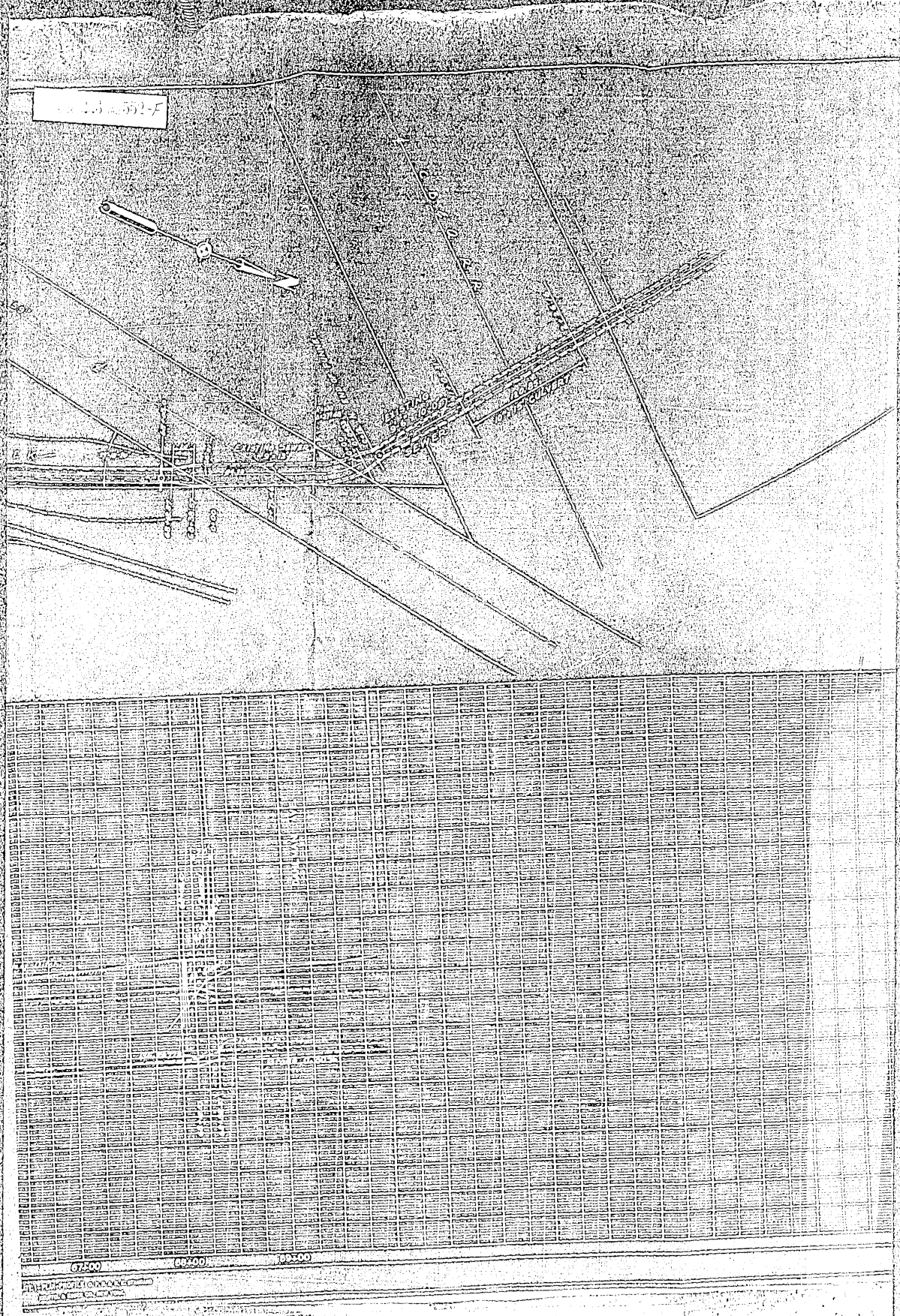

3. Control in Missouri Valley and Nevada in the Region of the  
 Alps and Douglas County, Nebraska 7 day June, 1947. at 10:30 AM  
 Thomas D. Cannon, Director of Work 210