

2275  
1

60

89-181

Introduce: 7-24-89

ORDINANCE NO. 15249

01 AN ORDINANCE creating Sidewalk Improvement District No. 84,  
02 defining the limits thereof, providing for the construction, reconstruction,  
03 replacement, or repair of public sidewalks therein, providing for the payment  
04 of the cost thereof, designating the property to be benefited, providing for  
05 the acquisition of easements and additional right-of-way, if necessary, and  
06 repealing all ordinances or parts of ordinances in conflict herewith.

07 BE IT ORDAINED by the City Council of the City of Lincoln, Nebraska:

08 Section 1. That Sidewalk Improvement District No. 84, of the  
09 City of Lincoln, Nebraska, be and the same is hereby created, that said  
10 Sidewalk Improvement District shall include that area bounded on the north by  
11 "O" Street; on the east by 48th Street; on the south by "A" Street; and on the  
12 west by 27th Street; with construction, reconstruction, replacement or repair  
13 of sidewalks as approved by the Director of Public Works for the following  
14 described real estate benefited to-wit: All those properties legally described  
15 in the attached "Exhibit A" which is hereby incorporated herein.

16 The cost of constructing, reconstructing, replacing or repairing the  
17 sidewalks in said District, including the cost of grading the sidewalk space  
18 and public street between the curb line and the property line and all  
19 expenses incidental to all of this improvement shall be assessed against the  
20 property benefited in said District in proportion to the benefits not

2

2

01 exceeding the cost thereof. In the event that easements or additional  
 02 right-of-way must be acquired for the completion of this district, such  
 03 property rights may be acquired by negotiation and purchase or by  
 04 condemnation, if necessary, as provided by law.

05 2. That all ordinances and parts of ordinances in conflict herewith be  
 06 and the same hereby are repealed.

07 3. This ordinance shall take effect and be in force from and after its  
 08 passage and publication according to law, but construction shall not be  
 09 commenced until ordered by resolution by the City Council.

Introduced by

Kenneth W. Haar

Approved as to Form:

William J. Hinder  
 City Attorney

AYES: Gutgsell, Haar, Hempel, Johanns,  
 Minnick, Seng, Wilson;  
 NAYS: None.

Approved as to Description:

Ruth Rousin  
 City Engineer

Staff Review Completed:

Pat  
 Administrative Assistant

KKH1077

**APPROVED**

AUG 10, 1989

Bill Harris  
 MAYOR

**PASSED**

AUG - 7 1989

**CITY COUNCIL**

3

3

C E R T I F I C A T E

I, Paul A. Malzer, City Clerk of the City of Lincoln, Nebraska, do certify that the above and foregoing is a true and correct copy of ORDINANCE NO. 15249 CREATING SIDEWALK IMPROVEMENT DISTRICT NO. 84

as passed and approved by the City Council of the City of Lincoln, Nebraska, at its meeting held AUGUST 7, 1989, as the original appears of record in my office, and is now in my charge remaining as City Clerk aforesaid.

IN WITNESS WHEREOF, I have hereunto set my hand officially and affixed the seal of the City of Lincoln, Nebraska, this 17TH day of JULY, 19 90.

*Paul A. Malzer*  
\_\_\_\_\_  
City Clerk  
SEAL  
CITY OF LINCOLN, NEBRASKA

*Return all to City Clerk*

4

ST.

ST. 4  
89-181

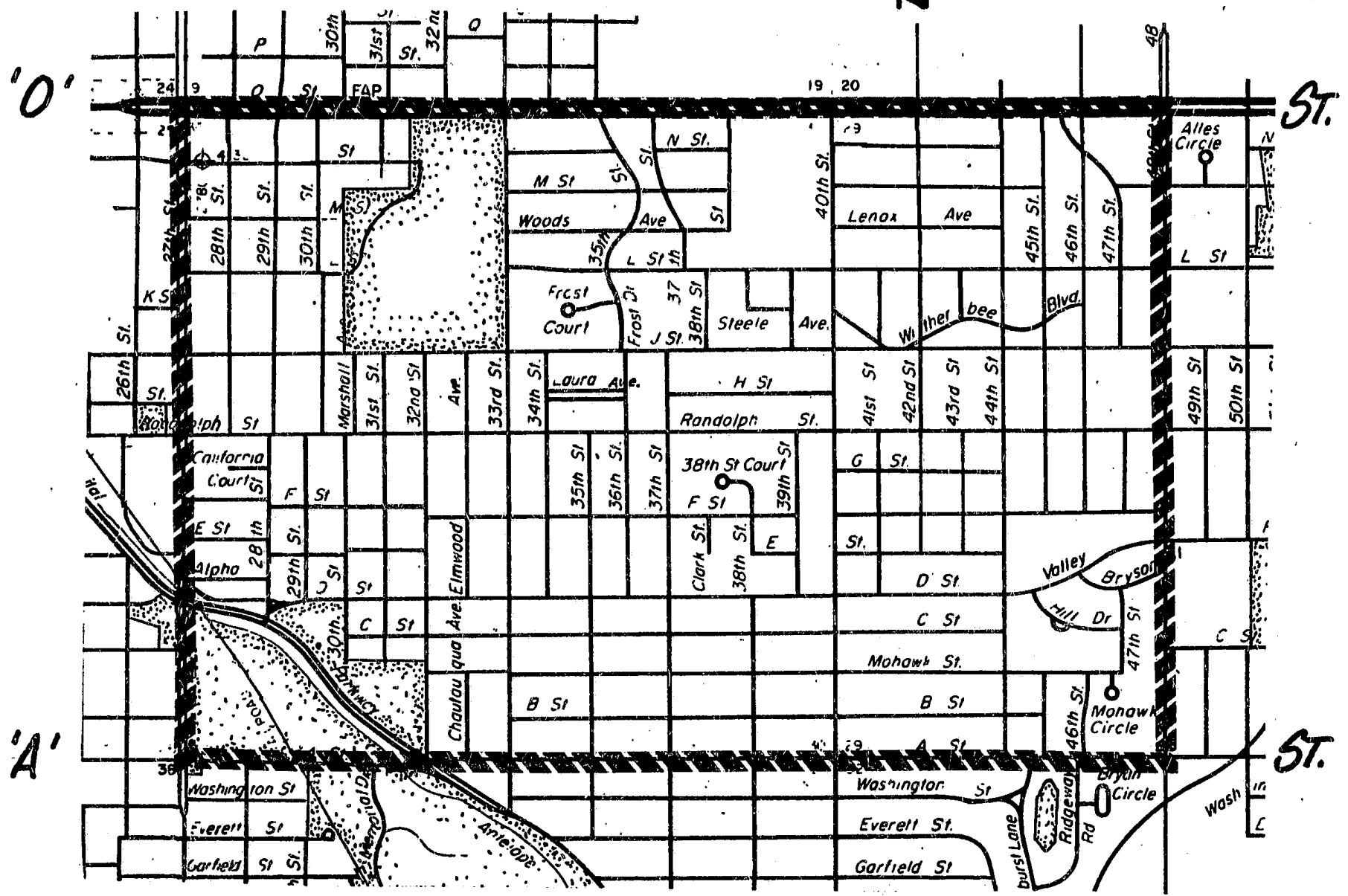

'A'

ST.

27TH

48TH

SIDEWALK DISTRICT

SA

7/21/89

5

SECTION 1-1  
FOR  
SIDEWALK DISTRICT NO. 84

"EXHIBIT A"

TAX # 6 NAME AND ADDRESS  
0883115 CITY OF LINCOLN / LLS SUBSTATION  
INSPTR % STEVE HANKS  
EC 1011 "D" STREET  
LINCOLN, NE 68506  
SECTION 1-1

LEGAL  
RILEY & WHITNEYS SUB  
L19:5131.17' EX S60'  
LOT 1 EXEMPT

6  
✓  
RI WA 30107  
No Block

SEQUENCE 3 LOCATION 815 S. 40TH

0883123 PETERS, JAMES E & DARA D  
INSPTR 7515 WHITESTONE  
EC LINCOLN, NE 68506

RILEY & WHITNEYS SUB OF LOT  
19: LOT 1 N 55  
OF SD 60 FT.

SECTION 1-1

SEQUENCE 4 LOCATION 825 S. 40TH

0883182 PETERS, JAMES E & DARA D  
INSPTR 7515 WHITESTONE  
EC LINCOLN, NE 68506

RILEY & WHITNEYS SUB OF LOT  
19: LOT 3, N 49 &  
4 TNTHS OF E 132 & 94 HNDRS  
& LOT 1 SD 5'

SECTION 1-1

SEQUENCE 5 LOCATION 835-37 S. 40TH

0731447 BENSON, HUBERT V & THELMA  
INSPTR 5321 WILSHIRE  
EC LINCOLN, NEBR. 68504

JOHNSON & SCHAFFER REPLAT  
LOT 8  
LOT 7 55' OF W70&86HND8'

JOSCRE  
✓

SECTION 1-1

SEQUENCE 9 LOCATION 3900 D ST & 1044 S. 39TH

0731421 HEALY, ALICE PEARL  
INSPTR % UNION BANK & TRUST CO - BOB  
EC FREY BOX 6155  
LINCOLN, NE 68506

JOHNSON & SCHAFFER REPLAT  
LOT 5 55' LT 6

SECTION 1-1

SEQUENCE 10 LOCATION 1020-22 S. 39TH

0883255 TAYLOR, JAMES H & PATRICIA F  
INSPTR 870 SD 39  
EC LINCOLN, NE 68510

RILEY & WHITNEYS SUB  
N55.085' W150' LOT 5 EX  
W30' THEREOF

✓  
RIWA 30107

SECTION 1-1

SEQUENCE 17 LOCATION 870 SD 39

6

7  
TAX # NAME AND ADDRESS  
0893171 HURNER, ERMA H. & RONALD  
INSPTR 840 SD 39TH ST.  
EC LINCOLN, NE 68503

7  
LEGAL  
RILEY & WHITNEYS SUB L19  
LOT 3 832 EX W 30  
AND EX E 171 AND N25 EX W30  
& EX E 171 LOT4

SECTION 1-1

RIWH 30107

SEQUENCE 20

LOCATION 840 SD 39TH ST.

0872458 CHRISTENSEN, DARRELL D &  
INSPTR ROSENE A  
EC 611 TEAKWOOD  
LINCOLN, NE 68510

RANDOLPH TERRACE SECOND  
BLOCK 1 LOT 3

RATE 2 ✓

SECTION 1-1

SEQUENCE 21

LOCATION 852-54 S 39TH

0872440 MARA, MARGUERITE A  
INSPTR 848 SD 39  
EC LINCOLN, NE 68510

RANDOLPH TERRACE SECOND  
BLOCK 1 LOT 2 EX N5' ✓

SECTION 1-1

SEQUENCE 22

LOCATION 848 SD 39

1550076 THOMANN, HENRY B & E JOYCE  
INSPTR 3835 RANDOLPH  
EC LINCOLN, NE 68510

\*  
IRREG TR L134 SE 30-10-7  
AND RANDOLPH TERRACE 2ND  
ADD LOT 1 EX E98' BLK 2 ✓

SECTION 1-1

SEQUENCE 24

LOCATION 3835 RANDOLPH

0872369 WORSTER, PETER J & KATHERYN E  
INSPTR 917 SD 39  
EC LINCOLN, NE 68510

RANDOLPH TERRACE BLOCK 2  
LOT 2

RATE ✓

SECTION 1-1

SEQUENCE 25

LOCATION 917 SD 39

0872377 DANAHY, VERNON E & ELSIE M  
INSPTR 929 SD 39  
EC LINCOLN, NE 68510

RANDOLPH TERRACE BLOCK 2  
LOT 3

RATE ✓

SECTION 1-1

SEQUENCE 26

LOCATION 929 SD 39

7

8  
TAX # 0872385  
INSPTR  
EC  
NAME AND ADDRESS  
OLSEN, GORDON D & BARBARA  
7914 SYCAMORE  
LINCOLN, NE 68510

LEGAL  
RANDOLPH TERRACE BLOCK 2  
LOT 4  
RATE ✓

SECTION 1-1

SEQUENCE 27

LOCATION 941 S. 39TH & 3040 E ST

0775398  
INSPTR  
EC  
CHERMOK, MARK  
910 SD 37  
LINCOLN, NE 68510

MAPLE GROVE BLOCK 3 LOT 11  
MAGR ✓

SECTION 1-1

SEQUENCE 31

LOCATION 910 SD 37

0872695  
INSPTR  
EC  
BELL, MICHAEL G & ROBIN L  
1025 SD 36  
LINCOLN, NE 68510

RANDOLPH TERRACE FIFTH LOT ✓  
4

SECTION 1-1

SEQUENCE 38

LOCATION 3715-17 S. 38TH ST CT

0872644  
INSPTR  
EC  
HUTCHISON, MANFORD E & LUCILLE  
ROUTE 6  
LINCOLN, NE 68502

RANDOLPH TERRACE FOURTH LOT ✓  
4  
RATE 4

SECTION 1-1

SEQUENCE 40

LOCATION 3743-45 S. 38TH ST CT

0726338  
INSPTR  
EC  
LUGINBILL, L.  
% FIRSTIER BANK TRUST DEPT  
BOX 8100E  
LINCOLN, NE 68501

IRREG TR L111 SE 30-10-7

SECTION 1-1

SEQUENCE 49

LOCATION 3787 RANDOLPH

0726371  
INSPTR  
EC  
WEST, FORREST R JR & MARTHA J  
3845 RANDOLPH  
LINCOLN, NE 68510

\*  
IRREG TR L133 SE 30-10-7

SECTION 1-1

SEQUENCE 52

LOCATION 3845 RANDOLPH



TAX # <sup>9</sup> NAME AND ADDRESS LEGAL  
0872563 K C PROPERTIES, LTD RANDOLPH TERRACE THIRD LOT  
INSPTR 6720 BERNESE 6  
EC LINCOLN, NE 68516 RATE 3 <sup>9</sup> ✓

SECTION 1-1

SEQUENCE 67 LOCATION 866 S. 38TH ST CT

0872521 SETTLES, KATHERINE M RANDOLPH TERRACE THIRD LOT ✓  
INSPTR 3610 SO 76 2  
EC LINCOLN, NE 68506

SECTION 1-1

SEQUENCE 70 LOCATION 3790-92 S. 38TH ST CT

0872512 SETTLE, TERRY L & TERRY RANDOLPH TERRACE THIRD LOT ✓  
INSPTR 3702 SO 38 ST CT 1  
EC LINCOLN, NE 68506

SECTION 1-1

SEQUENCE 72 LOCATION 3782 SO 38 ST CT

0771830 PARKER, PATRICK A & FRANCINE C LYMAN PARK SUB LOT 24 ✓  
INSPTR 600 SO 36 LYPA  
EC LINCOLN, NE 68510

SECTION 1-1

SEQUENCE 75 LOCATION 600 SO 36

0771805 STRAUB, WILLIAM P LYMAN PARK SUB LOT 16 ✓  
INSPTR 7200 OLD POST ROAD UNIT 12  
EC LINCOLN, NE 68506

SECTION 1-1

SEQUENCE 76 LOCATION 714 S. 36TH

0771767 DRAPER, JOHN J & JAYNE S LYMAN PARK SUB 54' LOT 11 & ✓  
INSPTR 745 SO 37 ALL LOT 12  
EC LINCOLN, NE 68510

SECTION 1-1

SEQUENCE 79 LOCATION 745 SO 37

TAX # 10 NAME AND ADDRESS  
0771759 BOYCE, ROBERT L III & BARBARA  
INSPTR 735 SD 37  
EC LINCOLN, NE 68510

LEGA  
LYMAN PARK SUB LOT 11 N46' ✓

SECTION 1-1

SEQUENCE 80 LOCATION 735 SD 37

0771724 LANG, GREGORY A & PATRICIA J  
INSPTR 711 SD 37  
EC LINCOLN, NE 68510

LYMAN PARK SUB LOT 8 ✓

SECTION 1-1

SEQUENCE 81 LOCATION 711 SD 37

0882968 FAUGHN, PAUL A & SHEILA J  
INSPTR 612 SD 37  
EC LILNOLN, NE 68510

RILEY & WHITNEY SUB L 21:L2  
S 1/3 N 1/2

RIWHFR ✓

SECTION 1-1

SEQUENCE 83 LOCATION 612 SD 37

0882950 SANDQUIST, KURT S & VIRGINIA A  
INSPTR 610 SD 37  
EC LINCOLN, NE 68510

RILEY & WHITNEY SUB LOT 21:  
545.8' N91.6' N1/2 LOT 2 ✓

SECTION 1-1

SEQUENCE 84 LOCATION 610 SD 37

0882941 NELSON, DAVID A. & BEVERLY A.  
INSPTR 600 SD 37 ST  
EC LINCOLN, NEBR. 68510

RILEY & WHITNEY SUB L21:L2  
N 1/3 N 1/2 ✓

SECTION 1-1

SEQUENCE 85 LOCATION 600 SD 37 ST

0882909 WATERS, JOANNE M  
INSPTR 3725 J ST  
EC LINCOLN, NE 68510

RILEY & WHITNEY SUB LOT 21  
SUTTONS SUB  
LOT 1:LOT 3 (EX W9') ✓

SECTION 1-1

SEQUENCE 86 LOCATION 3725 J ST

6

TAX # // NAME AND ADDRESS  
0882895 O'FLAHERTY, CLEMENT L & ALICE  
INSPTR 3737 J STREET  
EC LINCOLN, NEBR. 68510

LEGAL  
RILEY & WHITNEY SUB LOT 21  
SUTTONS SUB  
LOT 1: LOT 2

RIWHF

SECTION 1-1

SEQUENCE 87 LOCATION 3737 J STREET

1527325 CASEY, JOSEPH J  
INSPTR 3755 J  
EC LINCOLN, NE 68510

BANNISTER SUB LOT 1 TO 12  
INC OF W1/2 L22:  
FROST'S SUB LOTS 2 & 3

BANSU

SECTION 1-1

SEQUENCE 90 LOCATION 3755 J

0566276 HAMMEL, RICHARD D & CLARA  
INSPTR 3904 FAUROT DR  
EC COLUMBIA, MO 65201

DOAN ACRES LOT 6 E4&HALF  
OF S HALF

DOAC

SECTION 1-1

SEQUENCE 92 LOCATION 3816-18 RANDOLPH

0883018 GEISTLINGER, ALBERTA H &  
INSPTR KOWRACK, MIRIAM D  
EC 710 SO 37TH  
LINCOLN, NE 68510

RILEY & WHITNEY SUB L 21  
GEISTLINGERS  
REPLAT L 3:L 2

GE

18

SECTION 1-1

SEQUENCE 102 LOCATION 710 S. 37TH

0883000 COOK, JAMES R & CHERYL K  
INSPTR 700 S 37  
EC LINCOLN, NEBR. 68510

RILEY & WHITNEY SUB LOT 21  
GEISTLINGERS  
REPLAT LOT 3: LOT 1

GE

SECTION 1-1

SEQUENCE 103 LOCATION 700 S 37

0726303 WESSEL, ELMER A  
INSPTR 838 SO 37  
EC LINCOLN, NE 68510

IRREG TR L104 SE 30-10-7

SECTION 1-1

SEQUENCE 106 LOCATION 838 SO 37

U

TAX # 12 NAME AND ADDRESS  
0726311 MCKENZIE, DANIEL D & SHARRON M  
INSPTR 852 SO 37  
EC LINCOLN, NE 68510

LEGAL \*  
IRREG TR L108 SE 30-10-7

12

SECTION 1-1

SEQUENCE 108

LOCATION 852 SO 37

0566195 SECOND PRESBYTERIAN CHURCH  
INSPTR 2601 P  
EC LINCOLN, NE 68503

DOAN ACRES LOT 4 E HLF OF N  
HLF Doac ✓

SECTION 1-1

SEQUENCE 116

LOCATION 3835 J ST

0566144 KOBZA, SUSAN  
INSPTR 3845 J  
EC LINCOLN, NE 68510

DOAN ACRES LOT 3 W HALF  
OF N HALF ✓

SECTION 1-1

SEQUENCE 117

LOCATION 3845 J

0566128 JOHNSON, DANIEL LEE & SHERYL D  
INSPTR 3911 J  
EC LINCOLN, NE 68510

DOAN ACRES LOT 2 W1/2 OF  
N1/2 ✓

SECTION 1-1

SEQUENCE 118

LOCATION 3911 J

0566136 MOSER, M MONTE & JUDITH M  
INSPTR 3921 J STREET  
EC LINCOLN, NEBR. 68510

DOAN ACRES LOT 2 E HALF  
OF N HALF ✓

SECTION 1-1

SEQUENCE 119

LOCATION 3921 J STREET

1474621 CIDLIK, JOHN P & KELLY S  
INSPTR 601 SO 40  
EC LINCOLN, NE 68510

DOAN ACRES REX SUB OF LOT  
1: LOT 1 & N24' LOT 2 ✓

SECTION 1-1

SEQUENCE 120

LOCATION 601 SO 40

RET

6

TAX # 12  
0566080 BARTZATT, TAMARA  
INSPTR 3340 Y  
EC LINCOLN, NE 68503

LEGAL  
DOAN ACRES REX SUB OF 1: LOT  
4 N24& 7 TNS  
LOT 3 S26  
REF  
~~DOAC~~

13

SECTION 1-1

SEQUENCE 122

LOCATION 625 S. 40TH

0566098 NESTL, RANDOLPH G & ANNA F  
INSPTR 637 SD 40  
EC LINCOLN, NE 68510

DOAN ACRES REX SUB OF 1: LOT  
4 S 30' &  
LOT 5 ALL  
REF

SECTION 1-1

SEQUENCE 123

LOCATION 637 SD 40

0566420 STAUFFER, EDWARD J. & JANICE  
INSPTR 705 SD 40 ST  
EC LINCOLN, NE 68510

DOAN ACRES LOT 10 N65 ✓

SECTION 1-1

SEQUENCE 124

LOCATION 705 SD 40 ST

0566462 DREITH, MICHAEL H & LORI K  
INSPTR 3940 RANDOLPH  
EC LINCOLN, NE 68510

DOAN ACRES LOT 10 E66&08  
HNDS OF S100 ✓

SECTION 1-1

SEQUENCE 125

LOCATION 3940 RANDOLPH

0566454 ATKINSON, FREDERICK ARTHUR &  
INSPTR CAROLYN J  
EC 5109 A  
LINCOLN, NE 68510

DOAN ACRES W&O' OF S100'  
LOT 10 ✓

SECTION 1-1

SEQUENCE 126

LOCATION 3924 RANDOLPH

0771856 WILLIAMS, LINDA L  
INSPTR 615 SD 36  
EC LINCOLN, NE 68510

LYMAN PARK SUB LOT 25 S45'  
& L26  
LYPA ✓

SECTION 1-1

SEQUENCE 133

LOCATION 615 SD 36

6

TAX # 14 NAME AND ADDRESS  
0771996 MALY, GARY L. & TERRY  
INSPTR 3432 LAURA AVE  
EC LINCOLN, NEBR. 68510

LEBA  
LYMAN PARK SUB LOT 41  
LYPA

SECTION 1-1

SEQUENCE 139

LOCATION 3432 LAURA AVE

0771953 BOWER, JOAN E  
INSPTR 3400 LAURA AVE  
EC LINCOLN, NEBR. 68510

LYMAN PARK SUB LOT 37

SECTION 1-1

SEQUENCE 142

LOCATION 3400 LAURA AVE

0772071 SAINT TERESAS CHURCH  
INSPTR 735 SO 36  
EC LINCOLN, NE 68510

LYMAN PARK SUB L49-53 &  
LTS 67 TO 72

SECTION 1-1

SEQUENCE 144

LOCATION 735 SO 36

0772194 CMELIK, DOUGLAS F  
INSPTR 3434 RANDOLPH  
EC LINCOLN, NE 68510

LYMAN PARK SUB LOT 65

SECTION 1-1

SEQUENCE 145

LOCATION 3434 RANDOLPH

0772186 VERSTEEG, DEBRA S  
INSPTR 3424 RANDOLPH  
EC LINCOLN, NE 68510

LYMAN PARK SUB LOT 64

SECTION 1-1

SEQUENCE 146

LOCATION 3424 RANDOLPH

0771686 LYONS, ALLEN R. & LISA  
INSPTR 627 SO. 37TH ST  
EC LINCOLN, NEBR. 68510

LYMAN PARK SUB LOT 4

SECTION 1-1

SEQUENCE 147

LOCATION 627 SO. 37TH ST

TAX # 15 NAME AND ADDRESS  
0771643 GRANT, DONALD R  
INSPTR 1508 SKYLINE DR  
EC LINCOLN, NE 68506

LEGAL  
LYMAN PARK SUB LOT 1 E 1/2  
LYPA ✓

15

SECTION 1-1

SEQUENCE 152

LOCATION 3643 J ST

0771651 GRANT, DONALD R  
INSPTR 1508 SKYLINE DR  
EC LINCOLN, NE 68506

LYMAN PARK SUB L1 - W 1/2 ✓

✓

SECTION 1-1

SEQUENCE 153

LOCATION 3625-23 J ST

0772399 LIEN, V MAX & ELEANOR T  
INSPTR 618 SD 33  
EC LINCOLN, NEBR. 68510

LYMAN PARK SUB LOT 94 ✓

✓

SECTION 1-1

SEQUENCE 154

LOCATION 618 SD 33

0772364 HAMMACK, RALPH E JR & PAMELA K  
INSPTR 640 SD 33  
EC LINCOLN, NE 68510

LYMAN PARK SUB LOT 91 ✓

✓

SECTION 1-1

SEQUENCE 157

LOCATION 640 SD 33

0772356 PICCOLO, PETER & JONI  
INSPTR 702 SD 33  
EC LINCOLN, NE 68510

LYMAN PARK SUB LOT 90 ✓

✓

SECTION 1-1

SEQUENCE 158

LOCATION 702 SD 33

0772348 GUENTER, ROBERT F & BARBARA P  
INSPTR 714 SD 33RD  
EC LINCOLN, NEBR. 68510

LYMAN PARK SUB LOT 89 ✓

✓

SECTION 1-1

SEQUENCE 159

LOCATION 714 SD 33RD

6

TAX # <sup>16</sup> NAME AND ADDRESS  
0772330 BEKAS, BILL G & EDNA M  
INSPTR 720 SO 33  
EC LINCOLN, NE 68510

LEGAL  
LYMAN PARK SUB LOT 88  
LYPA ✓

SECTION 1-1

SEQUENCE 160

LOCATION 720 SO 33

0772305 HENNINGS, PAUL J &  
INSPTR KRUEGER, SHEILA M  
EC 743 SO 34  
LINCOLN, NE 68510

LYMAN PARK S16' LOT 93 &  
ALL LOT 84 ✓

SECTION 1-1

SEQUENCE 162

LOCATION 743 S. 34TH

0771864 REESE, MARY ANN  
INSPTR 3545 "J" STREET  
EC LINCOLN, NE 68510

LYMAN PARK SUB LOT 26 N87' ✓

SECTION 1-1

SEQUENCE 173

LOCATION 3545 J ST

0771848 MACH, JONELLA  
INSPTR 3551 J ST  
EC LINCOLN, NE 68510

LYMAN PARK SUB LOT 25 N87' ✓

SECTION 1-1

SEQUENCE 174

LOCATION 3551 J ST

0629511 FOSTER, EDWARD B & DELORES  
INSPTR 3500 FROST COURT  
EC LINCOLN, NEBR. 68510

FREEMON SUB LOT 2 W 40 &  
ALL LOT 3  
FREEMON ✓

SECTION 1-1

SEQUENCE 175

LOCATION 3500 FROST COURT

0629529 ADAMS, ARTHUR W & LOIS M  
INSPTR 3450 FROST COURT  
EC LINCOLN, NEBR. 68510

FREEMON SUB LOT 4 ✓

SECTION 1-1

SEQUENCE 176

LOCATION 3450 FROST COURT



TAX # 17  
0629537 IRWIN, JACK LA VERNE & MARY LO  
INSPTR 3440-42 FROST COURT  
EC LINCOLN, NEBR. 68510

LEGAL  
FREEMAN SUB LT 5 EX W 7' 17  
FREEMON

SECTION 1-1

SEQUENCE 177 LOCATION 3440-42 FROST COURT

0629545 FREEMON, LYMAN D & FRANCES M &  
INSPTR FREEMON, ORVILLE D  
EC 3064 PURITAN  
LINCOLN, NE 68502

FREEMON SUB LT 5 W7' & ALL  
LT 6 ✓

SECTION 1-1

SEQUENCE 178 LOCATION 3434-30 FROST CT.

0629553 FREEMON, LYMAN D & FRANCES M &  
INSPTR FREEMON, ORVILLE D  
EC 3064 PURITAN  
LINCOLN, NE 68502

FREEMON SUB LOT 7 ✓

SECTION 1-1

SEQUENCE 179 LOCATION 3424 FROST CT.

0629588 FREEMON, LYMAN D & FRANCES M &  
INSPTR FREEMON, ORVILLE D  
EC 3064 PURITAN  
LINCOLN, NE 68502

FREEMON SUB LOT 10 ✓

SECTION 1-1

SEQUENCE 180 LOCATION 3401 FROST CT.

0629600 FREEMON, LYMAN D & FRANCES M &  
INSPTR FREEMON, ORVILLE D  
EC 3064 PURITAN  
LINCOLN, NE 68502

FREEMON SUB LOT 12 ✓

SECTION 1-1

SEQUENCE 181 LOCATION 3421-25 FROST CT.

0670537 BEAU, JOHN L & ELSIE S  
INSPTR 3345 L ST  
EC LINCOLN, NEBR. 68510

HENKELMAN HEIGHTS PT LT 14  
FROSTB  
NE 30-10-7; E431.75' LT 5 ✓

SECTION 1-1

HEHE

SEQUENCE 187 LOCATION 3345 L ST

TAX # 18 NAME AND ADDRESS  
0670545 SIMMONS, CARL V  
INSPTR 316 N VICTORIA #Z  
EC VALENTINE, NE 69201

LEGAL  
HENKELMAN HEIGHTS PT LT 14  
FROSTS NE 30-10-  
7: E431.75' E12.21' LOT 7 &  
ALL LOTS 8 & 6

18

HEHE

SECTION 1-1

SEQUENCE 188

LOCATION 3333 L ST

0630101 HOFFMAN, NORMAN L  
INSPTR 4631 ANTELOPE CREEK RD  
EC LINCOLN, NEBR. 68506

FROSTS SUB LT 14 EX ST &  
690' E180' W213'

FROSTS -

SECTION 1-1

SEQUENCE 189

LOCATION 400 SD. 33

0990159 REDEEMER LUTHERAN CHURCH INC  
INSPTR 510 SD 33  
EC LINCOLN, NE 68510

VAN HORNS SUB LOT A EX W 7'  
LOT B EX W 7' & N 128.7' ✓  
LOT D

VANHORNS

SECTION 1-1

SEQUENCE 190

LOCATION 444 SD 33

0772411 BURES, WILLIAM J  
INSPTR 600 SD 33  
EC LINCOLN, NE 68510

LYMAN PARK LOT 96  
LYPA ✓

SECTION 1-1

SEQUENCE 192

LOCATION 600 SD 33

0772402 JONES, W. TILDEN & PATRICIA  
INSPTR 1319 P ST  
EC AURORA, NE 68818

LYMAN PARK SUB LOT 95 ✓

SECTION 1-1

SEQUENCE 193

LOCATION 610 SD. 33RD

0567655 LACY, LYLE A & LYNNE M  
INSPTR 400 SD 38  
EC LINCOLN, NE 68510

DUBRE  
DUFF BRUNING PRPLAT LOT 10 ✓  
ALL L 5 & 6 EX  
W 65 OF S 150 FROST SUB

SECTION 1-1

SEQUENCE 198

LOCATION 400 SD 38

6

19

19

TAX # 0938149  
INSPTR 702 GILLION DRIVE  
EC OMAHA, NE 68132

LEG  
W F STEELES SUB LOT 18  
STSU

SECTION 1-1

SEQUENCE 199

LOCATION 3835-37 L ST

0567663 GALOIS, RONALD G JR & SANDRA K  
INSPTR 401 SO 38 ST  
EC LINCOLN, NE 68510

DUFF BRUNING REPLAT ALL L 5  
& 6 EX W65' S150' FROST  
SUB: LOT 11 DUBRE

SECTION 1-1

SEQUENCE 200

LOCATION 401 SO 38 ST

0629766 SMITH, ELYRN D.  
INSPTR 400 S 37TH ST  
EC LINCOLN, NEBR. 68510

FROSTS SUB LOT 7 NORTH HALF  
OF NORTH HALF  
EXCEPT STREET FROSTS

SECTION 1-1

SEQUENCE 201

LOCATION 400 S 37TH ST

0629839 CHRISTENSEN, JOE I & MARIAN S  
INSPTR 3645 "L" STREET  
EC LINCOLN, NEBR. 68510

FROSTS SUB LOT 8 N 441 &  
.1' EX STREET

SECTION 1-1

SEQUENCE 202

LOCATION 3645 L ST

0629847 COLLEY, BERTHA L  
INSPTR 3625 L ST  
EC LINCOLN, NE 68510

FROSTS SUB LOT 9 E66 OF  
S150 OF N180

SECTION 1-1

SEQUENCE 203

LOCATION 3625 L ST

0629855 WEISHAHN, KENT D & IRENE S  
INSPTR 3615 L ST  
EC LINCOLN, NE 68510

FROSTS SUB W66' OF S150' OF  
N180' LOT 9 EX STREET

SECTION 1-1

SEQUENCE 204

LOCATION 3615 L ST

6

TAX # 20  
0629995 NAME AND ADDRESS  
INSPTR BARTUNEK, FRANCIS A & VERA V  
EC 3525 L ST  
LINCOLN, NEBR. 68510

LEGAL 20  
FROST SUB LOT 11 SD 140' N  
170' W 1/2 EX ST FROSTS ✓

SECTION 1-1

SEQUENCE 207

LOCATION 3525 L ST

0630039 ROUSE, PAM & SELLENRICK, GREG  
INSPTR 400 FROST DRIVE  
EC LINCOLN, NE 68510

FROSTS SUB LT 12 E56.26'  
N138.85'E OF 35 ST ✓

SECTION 1-1

SEQUENCE 208

LOCATION 400 FROST DRIVE

0629910 RENKER, LINDA M  
INSPTR 420 FROST DR  
EC LINCOLN, NE 68510

FROSTS SUB N50' S100' 4  
1/2" N1/2 L11 EX ST  
& N50' S100' 4 1/2" N1/2  
W1/2 EX ST L10 ✓

SECTION 1-1

SEQUENCE 209

LOCATION 420 FROST DR

0629987 BRESTEL, BRADLEY S & NANCY C  
INSPTR 430 FROST DR  
EC LINCOLN, NE 68510

FROSTS SUB S50' 4 1/2" N1/2  
LOT 11 &  
S50' 4 1/2" N1/2 W1/2 LOT  
10 ✓

SECTION 1-1

SEQUENCE 210

LOCATION 430 FROST DR

0629936 CASEY, LYNN R & DORENE M  
INSPTR 3600 J STREET  
EC LINCOLN, NEBR. 68510

FROSTS SUB LT 11 S125' S1/2  
E 1/2 ✓

SECTION 1-1

SEQUENCE 211

LOCATION 3600 J STREET

0630047 MORRIS, DAVID C & JERILYN G  
INSPTR 3540 J  
EC LINCOLN, NE 68510

FROSTS SUB LT 12 E53 OF  
S240 IN SE CORN 12  
LT 11 W6' OF S240' ✓

SECTION 1-1

SEQUENCE 212

LOCATION 3540 J

TAX # 21 NAME AND ADDRESS  
0629651 FREEMON, LYMAN D  
INSPTR 3064 PURITAN  
EC LINCOLN, NE 68502

LEGAL 21  
FREEMONS SUB FROSTS SUB-TRJ  
63.3' ON W SIDE  
L11 & D ON N & 6' ON S  
BEING 240' N OF SW  
COR 11 FREEMON SUB E30' L17  
& ALL LT 18

SECTION 1-1

SEQUENCE 213

LOCATION 3535 FROST CT FREEMON

0629502 ASHUSSEN, AGNES F  
INSPTR 1100 SD 47  
EC LINCOLN, NE 68510

FREEMON SUB LT 1 & LT 2 E L  
25'

SECTION 1-1

SEQUENCE 214

LOCATION 3532-30 FROST CT

0702986 MAJEWSKI, TERRY & TERRI PARSON  
INSPTR 2955 SOUTH  
EC LINCOLN, NE 68502

HYLAND PARK ANNEX BLOCK 11  
LOT 15 HYPAAN

SECTION 1-1

SEQUENCE 216

LOCATION 3620 L ST

0938025 FIENE, OSCAR W. & ARLENE  
INSPTR 4040 MOHAWK ST.  
EC LINCOLN, NEBR 68510

W F STEELES SUB LOT 8 W STSU  
55&41 HNDRS  
LOT 19 E 8 OF N 70&3 TMTS  
AND NO 50 OF  
E 43&53 HNDRS

SECTION 1-1

SEQUENCE 218

LOCATION 3853 L ST

0938041 BLAKE, LAURENCE A  
INSPTR 3843 L ST  
EC LINCOLN, NE 68510

W F STEELES SUB W85' LOT 9  
& N20' LOT 10

SECTION 1-1

SEQUENCE 226

LOCATION 3843 L ST

0937941 SANLEY, JAMES R & MARY C  
INSPTR 537 SD 39  
EC LINCOLN, NE 68510

W F STEELES SUB LOT 1

SECTION 1-1

SEQUENCE 229

LOCATION 537 SD 39

6

TAX # 22  
0702688 TRAUTWEIN, FLORENCE R  
INSPTR 3343 WOODS  
EC LINCOLN, NE 68510

LEGAL  
HYLAND PARK ANNEX BLOCK 10  
LOT 10  
HYPAAN

22

SECTION 1-1

SEQUENCE 233

LOCATION 3343 WOODS

0702714 NORTHROP, ROBERT B. & VICTORIA  
INSPTR 332 SO 33  
EC LINCOLN, NE 68510

HYLAND PARK ANNEX BLK 10 LT  
15 & 16 W 1/2

SECTION 1-1

SEQUENCE 237

LOCATION 332 SO 33

0702722 FELTON, ERLA  
INSPTR 3322 "L" STREET  
EC LINCOLN, NE 68510

HYLAND PARK ANNEX BLOCK 10  
LOT 17

SECTION 1-1

SEQUENCE 238

LOCATION 3320-22 L ST

0702773 WHITELEY, CURTIS B & C J KELLY  
INSPTR 3400 L  
EC LINCOLN, NE 68510

HYLAND PARK ANNEX BLOCK 10  
LOT 21

SECTION 1-1

SEQUENCE 241

LOCATION 3400-02 L

0702781 NEWSTROM, WM. G.  
INSPTR 3410 L  
EC LINCOLN, NEBR. 68510

HYLAND PARK ANNEX BLOCK 10  
LOT 22 SO 90

SECTION 1-1

SEQUENCE 242

LOCATION 3408 L

0702927 WILCOX, RAYMOND A. & NORMA E.  
INSPTR 3500 L  
EC LINCOLN, NEBR. 68510

HYLAND PARK ANNEX BLOCK 11  
LOT 9

SECTION 1-1

SEQUENCE 249

LOCATION 3500 L

6

TAX # 23 NAME AND ADDRESS  
0702935 KRULL, ROBER D & MARY LOU  
INSPTR 3510 L  
EC LINCOLN, NE 68510

LEGAL 23  
HYLAND PARK ANNEX BLOCK 11  
LOT 10  
HYPAAN ✓

SECTION 1-1

SEQUENCE 250

LOCATION 3510 L

0703052 BUCK, CARL & HERMANN, ELIZ  
INSPTR Z CAVE, RICHARD & PATRICIA  
EC (CONTRACT) 4410 SD 37  
LINCOLN, NE 68506

HYLAND PARK ANNEX BLOCK 12  
LOT 5

SECTION 1-1

SEQUENCE 258

LOCATION 3715 WOODS

0703079 DORF, VERA V  
INSPTR BARKS, VERETTA ANN  
EC 301 E DRICUTT  
LINCOLN, NE 68504

HYLAND PARK ANNEX BLOCK 12  
LOT 7

SECTION 1-1

SEQUENCE 259

LOCATION 3700 L STREET

0703109 WIELAND, MARGARET ELEANOR &  
INSPTR WIELAND, MICHAEL B  
EC 2573 MAYFAIR AVE  
WHITE BEAR LAKE, MN 55110

HYLAND PARK ANNEX BLOCK 12  
LOT 10

SECTION 1-1

SEQUENCE 262

LOCATION 3730 L ST

0703117 WOOD, DOUGLAS B.  
INSPTR 3740 L ST  
EC LINCOLN, NE 68510

HYLAND PARK ANNEX BLOCK 12  
LOT 11

SECTION 1-1

SEQUENCE 263

LOCATION 3740-42 L ST

0726460 CALVARY CEMETERY  
INSPTR 145 SD 40  
EC LINCOLN, NE 68510

IRREG TR EX STR L1 & ALL 34  
NE 30-10-7

SECTION 1-1

SEQUENCE 267

LOCATION CALVARY CEMETARY

TAX # 24 NAME AND ADDRESS  
0702625 STROPE, E JEAN  
INSPTR 3421 WOODS  
EC LINCOLN, NE 68510

LEGAL 24  
HYLAND PARK ANNEX BLOCK 10  
LOT 6 HYPAAN

SECTION 1-1

SEQUENCE 268

LOCATION 3421 WOODS

0702633 MAGDANZ, TERRANCE G & BELINDA  
INSPTR 3411 WOODS  
EC LINCOLN, NE 68510

HYLAND PARK ANNEX BLOCK 10  
LOT 7

SECTION 1-1

SEQUENCE 269

LOCATION 3411 WOODS

1058422 BREITFELDER, PATRICK J  
INSPTR 3701 N ST  
EC LINCOLN, NE 68510

YOUNGS HYLAND PARK BLOCK 5  
LOT 8 EX E45' YOHYPA

SECTION 1-1

SEQUENCE 272

LOCATION 3701 N ST

1058431 THOMSEN, THOMAS A & IRENE H  
INSPTR 3420 WOODS  
EC LINCOLN NEBR 68510

YOUNGS HYLAND PARK BLOCK 5  
LOT 8 E45'

SECTION 1-1

SEQUENCE 273

LOCATION 3711 N ST

1058465 ROBERTS, ROBERT D & BETTY J  
INSPTR 3716 M STREET  
EC LINCOLN, NE 68510

YOUNGS HYLAND PARK BLOCK 5  
LOT 11

SECTION 1-1

SEQUENCE 285

LOCATION 3716 M STREET

1058538 JOBES, JEFFERY L  
INSPTR 3751 M ST  
EC LINCOLN, NEBR. 68510

YOUNGS HYLAND PARK BLOCK 6  
LOT 2

SECTION 1-1

SEQUENCE 290

LOCATION 3751 M ST



TAX # 25 NAME AND ADDRESS  
1058520 ARON, NANCY B  
INSPTR % LINCOLN STATE BANK  
EC 5501 SD E6  
LINCOLN, NE 68516

LEGAL  
YOUNGS HYLAND PARK BLOCK 6  
LOT 1 YOHYP

25 ✓

SECTION 1-1

SEQUENCE 291

LOCATION 3761 M ST

1059224 JAMES, H VIRGINIA & DONALD  
INSPTR 3500 M ST.  
EC LINCOLN, NEBR. 68510

YOUNGS HYLAND PARK BLOCK 9  
LOT 13

SECTION 1-1

SEQUENCE 294

LOCATION 3500 M ST.

1059259 CHAMPOUX, STEVEN M  
INSPTR 840 W STOCKWELL  
EC LINCOLN, NE 68522

YOUNGS HYLAND PARK BLOCK 9  
LOT 16

SECTION 1-1

SEQUENCE 297

LOCATION 201 SD 37TH

1059283 AUSTIN REALTY INVESTMENTS  
INSPTR 3910 SOUTH ST  
EC LINCOLN, NE 68506

YOUNGS HYLAND PARK BLOCK 9  
LOT 19

SECTION 1-1

SEQUENCE 300

LOCATION 125 SD 37TH

1059046 AUSTIN REALTY INVESTMENTS  
INSPTR 3910 SOUTH  
EC LINCOLN, NE 68506

YOUNGS HYLAND PARK BLOCK 9  
LOT 1 EX STR

SECTION 1-1

SEQUENCE 301

LOCATION 3633 D ST

1059160 FRAZIER, GERALD E JR & MARLENE  
INSPTR 126 SD 35  
EC LINCOLN, NE 68510

YOUNGS HYLAND PARK BLOCK 9  
LOT 8

SECTION 1-1

SEQUENCE 302

LOCATION 126 SD 35

6

TAX # 26  
1059216 FRICK, JACOB JR & VERTREES  
INSPTR 222 SO 35  
EC LINCOLN, NE 68510

LEGAL  
YOUNGS HYLAND PARK TRI SE  
COR LT 11 37.4' &  
60.5' & 67.1' & EX TRI NW  
COR 16' X 24.1' X  
28.9' LOT 12 BLK 9  
YOHYPA

26

SECTION 1-1

SEQUENCE 304

LOCATION 222 SO 35

1057455 ART JOHNSON REALTY  
INSPTR 3701 D ST. SUITE 201  
EC LINCOLN, NE 68510

YOUNGS HYLAND PARK BLOCK 2  
LOTS 6, 7, & 8 EX ST &  
N36' E47' LOT 9 & N36' LOTS  
10 & 11

SECTION 1-1

SEQUENCE 305

LOCATION 3701 D ST.

1057480 JOHNSON, JAMES D  
INSPTR 6601 SUMNER  
EC LINCOLN, NE 68506

YOUNGS HYLAND PARK BLOCK 2  
S100' E57' LOT 10 &  
S100' W3' LOT 11

SECTION 1-1

SEQUENCE 309

LOCATION 3718 N ST

1057471 JOHNSON, JAMES D  
INSPTR 6601 SUMNER  
EC LINCOLN, NE 68506

YOUNGS HYLAND PARK BLOCK 2  
S100' E47' LOT 9 &  
S100' W3' LOT 10

SECTION 1-1

SEQUENCE 310

LOCATION 3710 N ST

1057663 WESTPHAL, KENNETH R & BEVERLY  
INSPTR 4137 BALDWIN  
EC LINCOLN, NE 68504

YOUNGS HYLAND PARK BLOCK 2  
LOT 9 W47'

SECTION 1-1

SEQUENCE 311

LOCATION 3700 N ST

1058856 HERSTEIN, ROBERT A & PATRICIA  
INSPTR 3325 M ST  
EC LINCOLN, NE 68510

YOUNGS HYLAND PARK BLOCK 8  
LOT 15

SECTION 1-1

SEQUENCE 312

LOCATION 3325 M ST

6

TAX # <sup>27</sup> NAME AND ADDRESS LEGAL <sup>27</sup>  
1058864 CARUSD, JAMES J. & SHARON YOUNGS HYLAND PARK BLOCK 8  
INSPTR 3315 M LOT 16  
EC LINCOLN, NEBR. 68510 YOHYPA ✓

SECTION 1-1

SEQUENCE 313 LOCATION 3315 M

1058953 STEPHENSON, RHETT JAMES & YOUNGS HYLAND PARK BLOCK 8  
INSPTR KATHRYN MCLEESE LOT 25  
EC 3412 WOODS AVE ✓  
LINCOLN, NE 68510

SECTION 1-1

SEQUENCE 319 LOCATION 3412 WOODS AVE

1058938 SALOMONS, DELMAR & BONNALYN YOUNGS HYLAND PARK BLOCK 8  
INSPTR 3448 WOODS AVE LOT 28  
EC LINCOLN, NE 68510 ✓

SECTION 1-1

SEQUENCE 322 LOCATION 3448 WOODS AVE

1058996 HEIZENRADER, JAKE & BREHA YOUNGS HYLAND PARK BLOCK 8  
INSPTR 3454 WOODS AVE LOT 29  
EC LINCOLN, NEBR 68510 ✓

SECTION 1-1

SEQUENCE 323 LOCATION 3454 WOODS AVE

1058171 PAPPAS, CONSTANCE M YOUNGS HYLAND PARK BLOCK 4  
INSPTR 3301 N ST LOT 15  
EC LINCOLN, NE 68510 ✓

SECTION 1-1

SEQUENCE 333 LOCATION 3301 N ST

1058163 MURRAY, CECIL W & VIOLA YOUNGS HYLAND PARK BLOCK 4  
INSPTR Z SIMMONS, LEE M (CONTRACT) LOT 14  
EC 2724 SO 14 ✓  
LINCOLN, NE 68502

SECTION 1-1

SEQUENCE 334 LOCATION 3311 N ST

TAX # 24 NAME AND ADDRESS  
1058155 WHITE, MICHAEL L & VIRGIE L  
INSPTR 3323 N ST  
EC LINCOLN, NE 68510

LEGAL  
YOUNGS HYLAND PARK BLOCK 4  
LOT 13

YOHYPA

25

SECTION 1-1

SEQUENCE 335

LOCATION 3323 N ST

1058139 MAY, STEPHEN W & CAROLYN  
INSPTR 3343 N  
EC LINCOLN, NEBR. 68510

YOUNGS HYLAND PARK BLOCK 4  
LOT 11

SECTION 1-1

SEQUENCE 336

LOCATION 3343 N

1058112 HALL, LARRY J & KAREN K  
INSPTR 3405 N ST  
EC LINCOLN, NEBR. 68510

YOUNGS HYLAND PARK BLOCK 4  
LOT 9

SECTION 1-1

SEQUENCE 337

LOCATION 3405 N ST

1058058 VOSS, LAR E  
INSPTR 3443-45 N ST  
EC LINCOLN, NEBR. 68510

YOUNGS HYLAND PARK BLOCK 4  
LOT 3

SECTION 1-1

SEQUENCE 342

LOCATION 3443-45 N ST

1058040 ARPS, JANET S  
INSPTR 3449 N ST  
EC LINCOLN, NE 68510

YOUNGS HYLAND PARK BLOCK 4  
LOT 2

SECTION 1-1

SEQUENCE 343

LOCATION 3449 N ST

1058716 KLEINSCHMIDT, ROBERT & KATHRYN  
INSPTR & TENNEY, DOUGLAS S  
EC 6631 BOXELDER DR  
LINCOLN, NE 68506

YOUNGS HYLAND PARK BLOCK 8  
LOT 1

SECTION 1-1

SEQUENCE 344

LOCATION 3495 N ST

6

TAX # 29 NAME AND ADDRESS  
1058759 WENDELIN, ERIC S & CONSTANCE J  
INSPTR 3455 M ST  
EC LINCOLN, NE 68503

LEGAL  
YOUNGS HYLAND PARK BLOCK 8  
LOT 5

29

YOHYPA

SECTION 1-1

SEQUENCE 346

LOCATION 3455 M ST

1058767 SCHNEIDER, CONSTANCE J  
INSPTR 3451 M ST  
EC LINCOLN, NE 68510

YOUNGS HYLAND PARK BLOCK 8  
LOT 6

SECTION 1-1

SEQUENCE 347

LOCATION 3451 M ST

1058791 MUNGER, MARK S. & MARSHA  
INSPTR 3423 M ST  
EC LINCOLN NEBR 68510

YOUNGS HYLAND PARK BLOCK 8  
LOT 9

SECTION 1-1

SEQUENCE 348

LOCATION 3423 M ST

1058848 BOESIGER, JAYNE E &  
INSPTR SUTTON, MARK III  
EC 3333 M ST  
LINCOLN, NE 68510

YOUNGS HYLAND PARK BLOCK 8  
LOT 14

SECTION 1-1

SEQUENCE 350

LOCATION 3333 M ST

1058023 HEWITT, JOHN J & TERESA L  
INSPTR 135 SO 35  
EC LINCOLN, NE 68510

YOUNGS HYLAND PARK BLOCK 3  
LOT 24

SECTION 1-1

SEQUENCE 351

LOCATION 135 SO 35

1057922 SANDHORST, BRUCE C & ROBERTA  
INSPTR 3320 N ST  
EC LINCOLN, NEBR. 68510

YOUNGS HYLAND PARK 5120' LT  
14 BLK 3

SECTION 1-1

SEQUENCE 360

LOCATION 3320 N ST

6

TAX # <sup>30</sup>  
1057914 NAME AND ADDRESS  
INSPTR KREINER, CHRISTINE  
EC 3310 N ST  
LINCOLN, NEBR. 68510

LEGAL  
YOUNGS HYLAND PARK BLOCK 3  
LOT 13

YOHYPN ✓

30

SECTION 1-1

SEQUENCE 361

LOCATION 3310 N ST

1057906 GEMAS, HELEN REVOCABLE TRUST  
INSPTR GEMAS, BILL TRUSTEE  
EC 720 SO ST  
LINCOLN, NE 68510

YOUNGS HYLAND PARK BLOCK 3  
LOT 12 ✓

SECTION 1-1

SEQUENCE 362

LOCATION 3306 N ST

1057868 B & J PARTNERSHIP LTD  
INSPTR ALL MAKES OFFICE EQUIP  
EC CO-CONT3333 D ST  
LINCOLN, NE 68510

YOUNGS HYLAND PARK BLOCK 3  
LOT 7 EX N 6 FT

SECTION 1-1

SEQUENCE 364

LOCATION 3333 D ST

1596793 ANDERSON, MARTIN & LACEY  
INSPTR PARTNERS  
EC 3445 D ST  
LINCOLN, NE 68510

YOUNGS HYLAND PARK BLOCK 3  
LOT 1 & 2 EX N6' ✓

SECTION 1-1

SEQUENCE 365

LOCATION 3445 D ST

1058333 BAKER, VERNON W & VIRGINIA  
INSPTR 3488 M  
EC LINCOLN, NE 68510

YOUNGS HYLAND PARK BLOCK 4  
LOT 31 ✓

SECTION 1-1

SEQUENCE 366

LOCATION 3488 M

1058309 GRENFELL, JOSEPH & KATHLEEN  
INSPTR 3460 M STREET  
EC LINCOLN, NEBR. 68510

YOUNGS HYLAND PARK BLOCK 4  
LOT 28

SECTION 1-1

SEQUENCE 368

LOCATION 3460 M STREET

6

TAX # 31  
1058295 VANEVERY, BARBARA  
INSPTR % MRS. R.L. GABEL  
EC 3448 "M" STREET  
LINCOLN, NE 68510

LEGAL 31  
YOUNGS HYLAND PARK BLOCK 4  
LOT 27  
YOHYPA ✓

SECTION 1-1

SEQUENCE 369

LOCATION 3448 M ST

1058210 NELSON, GARY W & JENIFER  
INSPTR 3330 M  
EC LINCOLN, NE 68510

YOUNGS HYLAND PARK BLOCK 4  
LOT 19 ✓

SECTION 1-1

SEQUENCE 370

LOCATION 3330 M

0598054 BATE & FRUEHLING PARTNERSHIP  
INSPTR 1926 B  
DB LINCOLN, NE 68510

ELM PARK BLOCK 04 LOT 12  
ELMPARK ✓

SECTION 1-1

SEQUENCE 371

LOCATION 745 S 28TH

0598046 MILLER, HARRY M & PEARL M  
INSPTR 735 S 28TH  
DB LINCOLN, NEBR. 68510

ELM PARK BLOCK 04 LOT 11 ✓

SECTION 1-1

SEQUENCE 372

LOCATION 735 S 28TH

0597996 MCVAY, JOHN E & JANE  
INSPTR 6331 FAIRFAX AVE  
DB LINCOLN, NE 68505

ELM PARK BLOCK 04 LOT 6 ✓

SECTION 1-1

SEQUENCE 374

LOCATION 641 S 28TH

0597961 HIXON, PAUL E & RUBY K  
INSPTR 617 S 28  
DB LINCOLN, NEBR. 68510

ELM PARK BLOCK 04 LOT 3 ✓

SECTION 1-1

SEQUENCE 377

LOCATION 617 S 28

TAX # 32 NAME AND ADDRESS  
0598186 PIERCE, FLORENCE  
INSFTR 600 SO 27 ST  
DB LINCOLN, NEBR. 68510

LEGA  
ELM PARK LOT 24 EX ST BLK  
4  
ELMPARK. /

SECTION 1-1

SEQUENCE 378 LOCATION 604 SO 27 ST

0598097 HARTWIG, HARVEY L & CAROL L &  
INSFTR POSKOCHIL, RODNEY D & LEIGH A  
DB 130 NORTH VERMONT  
CORTLAND, NE 68331

ELM PARK EX S 3' & EX W9' L  
16  
BLK 4

SECTION 1-1

SEQUENCE 380 LOCATION 722 SO 27TH

0598062 MARR, DANIEL L & CHERYLL A  
INSFTR BOX 125  
DB FUNK, NE 68940

ELM PARK BLOCK 4 LOT 13 EX  
W3.7' & S22' LOT 14 EX  
W5.5'

SECTION 1-1

SEQUENCE 381 LOCATION 2700 RANDOLPH

0598275 BUNDY, RALPH W & MARY T  
INSFTR 719 SO 29TH ST  
DB LINCOLN, NE 68510

ELM PARK BLOCK 5 LOT 9 /

SECTION 1-1

SEQUENCE 383 LOCATION 719 SO 29TH ST

0598241 STAMLER, MABEL C.  
INSFTR 643 SO 29  
DB LINCOLN, NEBR 68510

ELM PARK BLOCK 05 LOT 6 /

SECTION 1-1

SEQUENCE 386 LOCATION 643 SO 29

0598224 WADHAMS, VIRGIL C  
INSFTR 4840 ALLES CIRCLE  
DB LINCOLN, NEBR. 68510

ELM PARK BLOCK 05 LOT 4 /

SECTION 1-1

SEQUENCE 388 LOCATION 625 SO 29TH



TAX # 33 NAME AND ADDRESS  
0598194 FRUEHLING, GAIL N & VIVIAN  
INSPTR 601 SOUTH 29  
DB LINCOLN, NEBR. 68510

LEGAL  
ELM PARK BLOCK 05 LOT 1  
ELMPARK

33

SECTION 1-1

SEQUENCE 390

LOCATION 601 SOUTH 29

0598437 KESSELRING, JANICE L  
INSPTR 2815 J ST  
DB LINCOLN, NE 68510

ELM PARK BLOCK 05 LOT 24 E  
HLF

SECTION 1-1

SEQUENCE 391

LOCATION 2815 J ST

0598364 NELSON, WENDY L  
INSPTR 650 SO 28  
DB LINCOLN, NE 68510

ELM PARK BLOCK 05 LOT 18

SECTION 1-1

SEQUENCE 395

LOCATION 648 SO 28

0598321 GRAF, NANETTE H  
INSPTR 738 SO 28  
DB LINCOLN, NE 68510

ELM PARK BLOCK 05 LOT 14

SECTION 1-1

SEQUENCE 398

LOCATION 738 SO 28

0598305 MARTINEZ, HOMERO & MARIE BRADY  
INSPTR 745 SO 29  
DB LINCOLN, NE 68510

ELM PARK BLOCK 05 LOT 12

SECTION 1-1

SEQUENCE 399

LOCATION 745 SO 29

0598542 HARPER, MORGAN & AVIS M  
INSPTR 734 SO 29TH ST  
DB LINCOLN, NEBR. 68510

ELM PARK BLOCK 06 LOT 11

SECTION 1-1

SEQUENCE 400

LOCATION 734 SO 29TH ST

6

TAX # 34 NAME AND ADDRESS  
0598534 DELTJEN, JUNIOR F & HELEN J  
INSPTR 726 S 29  
DB LINCOLN, NE 68510

LEGAL 34  
ELM PARK BLOCK 06 LOT 10  
ELMPARK ✓

SECTION 1-1

SEQUENCE 401

LOCATION 726 S 29

0598526 TROUTMAN, JUDY K  
INSPTR 1950 JEFFERSON  
DB LINCOLN, NEBR. 68502

ELM PARK BLOCK 06 LOT 9 ✓

SECTION 1-1

SEQUENCE 402

LOCATION 716 SO 29TH

0598585 MOORE, LORI A & WITT, DONALD D  
INSPTR 2126 SANDSTONE  
DB LINCOLN, NE 68512

ELM PARK BLOCK 06 LOT 14  
N200

SECTION 1-1

SEQUENCE 406

LOCATION 2929 J ST

0992054 GLASS, LOIS J  
INSPTR 2935 J ST  
DB LINCOLN, NE 68510

VORES ELM PARK ANNEX BLOCK  
1 LOT 1 EX E61'  
LOT 2 N 13 EX E61' ✓

SECTION 1-1

SEQUENCE 407

LOCATION 2935 J ST

0578908 FERRIS, G STEVEN  
INSPTR 311 SO 28  
DB LINCOLN, NE 68510

EAST LINCOLN BLOCK 3 LOT 15  
EALI

SECTION 1-1

SEQUENCE 408

LOCATION 311 SO 28

0578860 HITE, WILLIAM A  
INSPTR 335 SO 28  
DB LINCOLN, NE 68510

EAST LINCOLN BLOCK 3 LOT 11 ✓

SECTION 1-1

SEQUENCE 410

LOCATION 335 SO 28

TAX # 35 NAME AND ADDRESS  
0597724 LEGRANDE, NORMAN H  
INSPTR 7601 SO 1  
DB LINCOLN, NE 68502

LEGAL  
ELM PARK BLOCK 03 LOT 3&4  
ELMPARK ✓

35

SECTION 1-1

SEQUENCE 411

LOCATION 421 SO 28TH

0597872 ELSBERG, MORRIS & ANNE L  
INSPTR 8046 LYONS ST  
DB NILES, IL 60648

ELM PARK LOT 19 EX ST BLK  
3

SECTION 1-1

SEQUENCE 417

LOCATION 444 SO 27TH

0597899 FEE SIMPLES, THE  
INSPTR 301 SO 70 SUITE 200  
DB LINCOLN, NE 68510

ELM PARK LOT 20 EX ST  
BLOCK 3

SECTION 1-1

SEQUENCE 418

LOCATION 438 SO 27TH

0597902 MCCORMICK, JOHN  
INSPTR 426 SOUTH 27TH  
DB LINCOLN, NEBR. 68510

ELM PARK LOT 21 EX ST BLK 3

SECTION 1-1

SEQUENCE 419

LOCATION 426 SOUTH 27TH

0597911 HILTON, EUGENE & MARCELLA  
INSPTR 418 S 27  
DB LINCOLN, NEBR 68510

ELM PARK L 22 EX WB' BLK 3

SECTION 1-1

SEQUENCE 420

LOCATION 418 S 27

0597651 CERNY, RONALD L & CYNTHIA L  
INSPTR 434 SO 28  
DB LINCOLN, NE 68510

ELM PARK BLOCK 02 LOT 20

SECTION 1-1

SEQUENCE 423

LOCATION 434 SO 28

6

TAX # **36** NAME AND ADDRESS LEGAL **36**  
0597643 ULLSTROM, CLEO LOUISE ELM PARK BLOCK 02 LOT 19  
INSPTR % ULLSTROM, LYLE  
DB 1500 SW 56  
LINCOLN, NE 68522  
ELMPARK  
SECTION 1-1

SEQUENCE 424 LOCATION 442 SO 28TH

0597571 MCCLOUD, KEITH D & MARY ELM PARK BLOCK 02 LOT 13  
INSPTR 544 SOUTH 28 W50'  
DB LINCOLN, NEBR. 68510

SECTION 1-1  
SEQUENCE 425 LOCATION 544 SOUTH 28

0597481 HENRICKSON, AGNES M ELM PARK BLOCK 2 LOT 1  
INSPTR 401 SO 29TH  
DB LINCOLN, NE 68510

SECTION 1-1  
SEQUENCE 427 LOCATION 401 SO 29TH

0597333 MARSH, PHILIP & SARAH ELM PARK BLOCK 01 LOT 10  
INSPTR 526 SO. 29TH ST.  
DB LINCOLN, NEBR. 68510

SECTION 1-1  
SEQUENCE 428 LOCATION 526 SO. 29TH ST.

0597287 BERKLAND, GARY L & CARDLYN ELM PARK BLOCK 01 LOT 5  
INSPTR 436 SO 29TH  
DB LINCOLN, NEBR. 68510

SECTION 1-1  
SEQUENCE 429 LOCATION 436 SO 29TH

0597244 HANEY, RICHARD J. & ROBIN S. DEFORDS SUB OF BLK 1 LOT 14  
INSPTR ROUTE 1, BOX 44A ELM PARK; LOTS 1  
DB DAVEY, NE 68336 & 2

SECTION 1-1 DEFORDS  
SEQUENCE 432 LOCATION 2925 L ST

37

TAX # 37 NAME AND ADDRESS  
0579025 DEVOSS, PAUL I & MARIA C  
INSPTR 1/2 PIAZZA, A  
DB 10411 ROSEDALE HWY  
BAKERSFIELD, CA 93312  
SECTION 1-1

LEGAL  
EAST LINCOLN BLOCK 4 LOT 10  
EALL

SEQUENCE 437 LOCATION 345 SD 29TH

0578827 RISENHOOVER, LINDAL G &  
INSPTR VALERIE  
DB 338 SD 27  
LINCOLN, NE 68510  
SECTION 1-1

EAST LINCOLN LOT 7 EX ST  
BLK 3

SEQUENCE 440 LOCATION 338 SD 27TH

0578797 BOYCE, JERRY E & LINDA L  
INSPTR 4710 SD 67  
DB LINCOLN, NE 68516  
SECTION 1-1

EAST LINCOLN L 4 EX WB' B 3

SEQUENCE 441 LOCATION 322 SD 27TH

0578916 LESLIE, CRAIG B ET AL  
INSPTR 2727 M  
DB LINCOLN, NE 68510  
SECTION 1-1

EAST LINCOLN BLOCK 3 LOT 16  
W54

SEQUENCE 442 LOCATION 2727 M

0579823 SCHOEN, L S & SUSAN  
INSPTR 332 SD 29  
DB LINCOLN, NE 68510  
SECTION 1-1

EASTLINCOLN BLOCK 9 LOT 5

SEQUENCE 445 LOCATION 332 SD 29

1321204 LIERZ, DOUGLAS J & DIANNA K  
INSPTR 425 SD 30  
DB LINCOLN, NE 68510  
SECTION 1-1

JANSENS  
JANSEN'S ADD LOT 26 AND  
DEFORD'S SUB OF BLOCK 1 LOT  
14 ELM PARK; LOT 3

SEQUENCE 450 LOCATION 425 SD 30

7

TAX # <sup>28</sup> NAME AND ADDRESS  
1598559 MARTIN, JON D & SARAH J  
INSPTR 437 SO 30  
DB LINCOLN, NE 68510

LEGAL <sup>28</sup>  
JANSENS ADD LOT 25 AND  
DEFORD'S SUB OF BLK 1 LOT  
14 ELM PARK: LOT 4

JANSENS  
Defords

SECTION 1-1

SEQUENCE 451

LOCATION 437 SO 30

1576784 DIENSTBIER, DANA P & CHRISTY L  
INSPTR 443 SO 30  
DB LINCOLN, NE 68510

JANSENS ADD LOT 23 AND  
DEFORD'S SUB OF BLK 1  
LOT 14 ELM PARK: LOT 6

SECTION 1-1

SEQUENCE 452

LOCATION 443 SO 30

1580331 BRANDT, WILLIAM & VALDRA  
INSPTR 6721 BERNESE BLVD  
DB LINCOLN, NE 68516

JANSENS ADD LOT 22 AND ELM  
PARK ADD BLK 1 N12.35'  
LOT 13, AND DEFORD'S SUB OF  
LOT 14 BLK 1 ELM PARK ADD  
LOT 7

SECTION 1-1

SEQUENCE 453

LOCATION 445 SO 30TH

1576776 CONNEALY, MARTIN J & LISA K  
INSPTR 449 SO 30  
DB LINCOLN, NE 68510

JANSENS ADD LOT 21 AND ELM  
PARK BLK 1 LOT 13 S45' OF  
N57.35'

SECTION 1-1

SEQUENCE 454

LOCATION 449 SO 30

1580340 ABRAMS, HERBERT L.  
INSPTR 519 SOUTH 30 STREET  
DB LINCOLN, NEBR. 68510

JANSENS ADD LOT 19; AND ELM  
PARK ADD BLK 1  
N45' S197.65' LOT 13

SECTION 1-1

SEQUENCE 455

LOCATION 519 SOUTH 30 STREET

0730513 DANIELS, SHERRILL  
INSPTR 2936 J ST  
DB LINCOLN, NE 68510

JANSENS ADD LOT 15 & 16 ✓  
W44' & HALF (EX S33'  
LOT 15)

SECTION 1-1

SEQUENCE 458

LOCATION 2936 J ST

TAX # <sup>39</sup> NAME AND ADDRESS  
0597376 WALKER, JOHN L & MAGDALEN E  
INSPTR 2924 J ST  
DB LINCOLN, NE 68510

LEGAL  
ELM PARK BLOCK 1 S152.65'  
LOT 13

ELMPARK ✓

39

SECTION 1-1

SEQUENCE 459

LOCATION 2924 J ST

0597350 BRITZ, QUINTIN  
INSPTR 2914 J  
DB LINCOLN, NE 68510

ELM PARK SB' E 1/2 LOT 11 &  
E 1/2 LOT 12  
BLOCK 1

SECTION 1-1

SEQUENCE 460

LOCATION 2914 J

0597368 BERKLAND, GARY & CAROLYN  
INSPTR 540 SD 29  
DB LINCOLN, NE 68510

ELM PARK BLOCK 01 LOT 12  
W1/2

SECTION 1-1

SEQUENCE 461

LOCATION 540 SD 29

0730491 DONIS, HAROLD & KATHLEEN  
INSPTR 538 SD 30  
DB LINCOLN, NE 68502

JANSENS ADD LOT 13 LOT 14  
N17&74 HNDS'

JANSENS ✓

SECTION 1-1

SEQUENCE 463

LOCATION 538 SD 30

0730467 HOAG, GEORGE R  
INSPTR 1325 SD 35  
DB LINCOLN, NE 68510

JANSENS ADD LOT 10

SECTION 1-1

SEQUENCE 464

LOCATION 458 SD 30TH

0730459 HABERLAN, LANE S  
INSPTR 452 SD 30  
DB LINCOLN, NE 68510

JANSENS ADD LOT 9

SECTION 1-1

SEQUENCE 465

LOCATION 452 SD 30

6

TAX # <sup>40</sup>  
0730432 GILBERT, KEVIN J  
INSFTR 444 SD 30  
DB LINCOLN, NE 68510

LEGAL  
JANSENS ADD LOT 7  
JANSENS ✓

SECTION 1-1

SEQUENCE 466 LOCATION 444 SD 30

0730424 PETERSON, JOHN P & DAVID E  
INSFTR 216 FAIRFIELD  
DB LINCOLN, NE 68521

JANSENS ADD LOT 6 ✓

SECTION 1-1

SEQUENCE 467 LOCATION 442 SD 30

0730408 BERKLAND, GARY LEE  
INSFTR 436 SD 30  
DB LINCOLN, NE 68510

JANSENS ADD LOT 4 ✓

SECTION 1-1

SEQUENCE 469 LOCATION 436 SD 30

0730394 MCSHANE, PETER M & LORETTA W  
INSFTR 418 SD 30  
DB LINCOLN, NE 68510

JANSENS ADD LOT 3 ✓

SECTION 1-1

SEQUENCE 470 LOCATION 418 SD 30

0730378 MARKWARDT, MELVIN D & GLADYS I  
INSFTR 400 SD 30  
DB LINCOLN, NEBR. 68510

JANSENS ADD LOT 1 ✓

SECTION 1-1

SEQUENCE 471 LOCATION 400 SD 30

0579971 LEADON, MARY & MILLER, ANN  
INSFTR 4225 EVERETT  
DB LINCOLN, NE 68506

EAST LINCOLN BLOCK 10 LOT  
6&7

EALI ✓

SECTION 1-1

SEQUENCE 473 LOCATION 336 SD 30TH

6



TAX # 41 NAME AND ADDRESS  
0579939 HERSHNER, IMOGENE  
INSPTR 310 S 30  
DB LINCOLN, NEBR. 68510

LEGAL  
EAST LINCOLN LOTS 1 & 2 BLK  
10  
2A11

SECTION 1-1

SEQUENCE 476 LOCATION 310 S 30

0579661 HELGET, MELVIN E  
INSPTR 236 SD 29  
DB LINCOLN, NE 68510

EAST LINCOLN BLOCK 8 LOT 6

SECTION 1-1

SEQUENCE 481 LOCATION 236 SD 29

0579726 NEUMAYER, RONALD N & BEVERLY C  
INSPTR 2510 SD 75  
DB LINCOLN, NE 68506

EASTLINCOLN BLOCK 8 LOT 11

SECTION 1-1

SEQUENCE 483 LOCATION 241 SD 30TH

0579998 BARTHALOMEW, ELSIE LEE  
INSPTR 349 SD 30  
DB LINCOLN, NEBR. 68510

EAST LINCOLN BLOCK 11 LOT 1  
W110  
LOT 2 W110 OF N7&HLF

SECTION 1-1

SEQUENCE 487 LOCATION 3001 N ST

0860280 BARTA, FELIX & ERMA  
INSPTR WESTERN, NEBR. 68464  
DB

PLAINVIEW ADD BLOCK 3 LOT 7

PLAINVIEW

SECTION 1-1

SEQUENCE 488 LOCATION 3015 N ST

0860051 GOBBER, ROBERT L. & JANE V  
INSPTR 214 BARRINGTON ST  
DB GRETNA, NE 68028

PLAINVIEW KOSMOS ADD SUB  
LOTS 6 & 7:  
LOT B EX 36.2 SQ FT FOR  
STREET BLOCK 1

KOSMOS

SECTION 1-1

SEQUENCE 496 LOCATION 3101 D ST

42  
TAX ID NAME AND ADDRESS  
0726214 CITY OF LINCOLN  
INSPTR PARKS & RECREATION DEPARTMENT  
DB 2740 "A" STREET  
LINCOLN, NE 68508  
SECTION 1-1

LEGAL  
IRREG TRACT LOTS 3 & 5  
30-10-7

42

NW 1/4

SEQUENCE 498 LOCATION WOODS PARK

0579703 NORTHRUP, MELVIN E. & NORMA J.  
INSPTR 5421 COVEY CT  
DB LINCOLN, NE 68516

EAST LINCOLN BLOCK 2 LOT 11

EALI

SECTION 1-1

SEQUENCE 499 LOCATION 241 SO 28TH

0579424 NATIONAL PROPERTIES CORP.  
INSPTR % CONTEMPORARY INDUSTRIES  
DB CORP711 NO 108 CT  
OMAHA, NE 68154

EAST LINCOLN BLOCK 7 LOTS  
1&2 EX 5.6 SQ FT  
& EX 534.4 SQ FT

SECTION 1-1

SEQUENCE 506 LOCATION 2911 D ST

0579441 WEST O DEV CO  
INSPTR % BUCKLEY'S OFFICE MACHINES  
DB 120 SO. 29  
LINCOLN, NE 68510

EAST LINCOLN BLOCK 7 LOT  
3&4

SECTION 1-1

SEQUENCE 507 LOCATION 122 SO 29TH

0579459 SHARIFI, HASSAN & CAROL J  
INSPTR P O BOX 3087  
DB FREMONT, CA 94539

EAST LINCOLN BLOCK 7 LOT 5

SECTION 1-1

SEQUENCE 508 LOCATION 126 SO 29TH

0579467 OVERBECK, KEITH G  
INSPTR 4831 SO 45  
DB LINCOLN, NE 68506

EAST LINCOLN BLOCK 7 LOT 6

SECTION 1-1

SEQUENCE 509 LOCATION 136 SO 29TH

6

TAX # <sup>43</sup>  
0579475 HIXON, PAUL E & RUBY K  
INSPTR % KONGS, JAMES & GAIL (CONT)  
DB 617 SO 28  
LINCOLN, NE 68510  
SECTION 1-1

LESA  
EAST LINCOLN BLOCK 7 LOT 7  
EALI

SEQUENCE 510

LOCATION 144 SO 29TH

0860191 HANSMEYER, WAYNE A & CONSTANCE  
INSPTR RR #2 BOX 84  
DB HALLAM, NE 68368

PLAINVIEW ADD BLK 2 W50' SO  
1/2

PLAINVIEW

SECTION 1-1

SEQUENCE 512

LOCATION 3026 N ST

0860182 GRADY, GIL  
INSPTR 3031 D  
DB LINCOLN, NE 68510

PLAINVIEW ADD BLOCK 2 E50  
OF W100 OF S.HLF

SECTION 1-1

SEQUENCE 513

LOCATION 3032 N ST

0860212 GRADY, GIL  
INSPTR 3031 D ST  
DB LINCOLN, NE 68510

PLAINVIEW ADD BLOCK 2 W47  
1/2 E48' SW 1/2

SECTION 1-1

SEQUENCE 514

LOCATION 3034 N ST

0580104 YOUROUKOS, GEORGE E &  
INSPTR ELIZABETH  
DB 128 SO 30  
LINCOLN, NE 68510

EAST LINCOLN BLOCK 12 LOT 4

EALI

SECTION 1-1

SEQUENCE 518

LOCATION 128 SO 30TH

0579611 TRIPP, RAYMOND L JR & NANCY  
INSPTR 3911 NO 13  
DB LINCOLN, NE 68521

EASTLINCOLN BLOCK 8 LOT 1

SECTION 1-1

SEQUENCE 519

LOCATION 200 SO 29TH

6

TAX # 44 NAME AND ADDRESS  
0579238 ROBERTS, RICHARD L & EMILIE  
INSPTR 1310 SCENIC LANE  
DB LINCOLN, NE 68505

LEGA  
EAST LINCOLN BLOCK 5 LOT 15

EALI

SECTION 1-1

SEQUENCE 529

LOCATION 211 SD 29TH

0578746 LAMPSHIRE, EARL L & CAROL  
INSPTR 1324 ALDRICH RD  
DB LINCOLN, NE 68510

EAST LINCOLN BLOCK 2 LOT 16

SECTION 1-1

SEQUENCE 532

LOCATION 201 SD 28TH

0578606 LAMPSHIRE, EARL L & CAROL L  
INSPTR 1324 ALDRICH RD.  
DB LINCOLN, NE 68510

EAST LINCOLN LTS 1 & 2 EX  
WB'  
BLK 2

SECTION 1-1

SEQUENCE 533

LOCATION 202 SD 27TH

0578541 LAMPSHIRE, EARL L & CAROL &  
INSPTR L L W REAL ESTATE PTNRS  
DB (CONT) 3201 PIONEERS BLV SUITE  
205 LINCOLN, NE 68502

EAST LINCOLN BLOCK 1 LOT  
9&10 E110

SECTION 1-1

SEQUENCE 538

LOCATION 145 SD 28TH

0578533 LAMPSHIRE INVESTMENTS INC &  
INSPTR L L W REAL ESTATE PTNRS  
DB (CONT) 3201 PIONEERS BLV SUITE  
205 LINCOLN, NE 68502

EAST LINCOLN BLOCK 1 LOT  
9&10 W32

SECTION 1-1

SEQUENCE 539

LOCATION 2726 N ST

0578550 LAMPSHIRE INVESTMENTS &  
INSPTR L L W REAL ESTATE PARTNERS  
DB 3201 PIONEERS BLV SUITE 205  
LINCOLN, NE 68502

EAST LINCOLN BLOCK 1 LOT 11

SECTION 1-1

SEQUENCE 540

LOCATION 139 SD 28TH

44

6

TAX # <sup>45</sup> NAME AND ADDRESS LEGAL <sup>45</sup>  
0578568 LAMPSHIRE, EARL L & CAROL & EAST LINCOLN BLOCK 1 LOT 12  
INSPTR L L W REAL ESTATE PTNRS  
DB (CONT) 3201 PIONEERS BLV SUITE EARL  
205 LINCOLN, NE 68502

SECTION 1-1

SEQUENCE 541 LOCATION 125 SO 28TH

0578576 LAMPSHIRE, EARL L & CAROL & EAST LINCOLN BLOCK 1 LOT 13  
INSPTR L L W REAL ESTATE PTNRS  
DB (CONT) 3201 PIONEERS BLV SUITE  
205 LINCOLN, NE 68502

SECTION 1-1

SEQUENCE 542 LOCATION 123 SO 28TH

0578584 LAMPSHIRE, EARL L & CAROL & EAST LINCOLN BLOCK 1 LOT 14  
INSPTR L L W REAL ESTATE PTNRS 538  
DB (CONT) 3201 PIONEERS BLV SUITE  
205 LINCOLN, NE 68502

SECTION 1-1

SEQUENCE 543 LOCATION 115 SO 28TH

0578452 A A INVESTMENTS EAST LINCOLN EX 360.2 SO FT  
INSPTR 1/2 L L W REAL ESTATE PARTNERS FOR RD LOT 1 &  
DB (CONT) 2327 SO CANTERBURY L 2 BLK 1  
LINCOLN, NE 68512

SECTION 1-1

SEQUENCE 544 LOCATION 2701 D ST

0578479 LAMPSHIRE INVESTMENTS & EAST LINCOLN EX 270 SO FT  
INSPTR L L W REAL ESTATE PARTNERS FOR RD LOT 3 & N  
DB 3201 PIONEERS BLV SUITE 205 1/2 LOT 4 BLK 1  
LINCOLN, NE 68502

SECTION 1-1

SEQUENCE 545 LOCATION 118 S 27TH

0578495 MCCAIN, RICHARD F & HELEN L EAST LINCOLN BLOCK 1 LOT 5  
INSPTR 122 SO 27 ALL & EX 270 SO  
DB LINCOLN, NE 68510 FT SO 1/2 LOT 4

SECTION 1-1

SEQUENCE 546 LOCATION 122 SO 27

6

TAX # *46* NAME AND ADDRESS  
0578517 LAMPSHIRE INVESTMENTS &  
INSPTR L L W REAL ESTATE PARTNERS  
DB 3201 PIONEERS BLV SUITE 205  
LINCOLN, NE 68502

LEGAL  
EAST LINCOLN BLOCK 1 LOTS 6  
TO 8 EX 542.7  
50 FT

*46*  
EARL

SECTION 1-1

SEQUENCE 547

LOCATION 140 SD 27TH

0579327 LAMPSHIRE, EARL L & CAROL L  
INSPTR 1324 ALDRICH RD  
DB LINCOLN, NE 68510

EAST LINCOLN BLOCK 6 LOT 6

SECTION 1-1

SEQUENCE 549

LOCATION 134 SD 28TH

0579319 SIMMONS, LEE M  
INSPTR 2724 SD 14 ST  
DB LINCOLN, NE 68502

EAST LINCOLN BLOCK 6 LOT 5

SECTION 1-1

SEQUENCE 550

LOCATION 130 SD 28TH

0579408 D M PROPERTIES  
INSPTR 2949 ND 27  
DB LINCOLN, NE 68503

EAST LINCOLN EX 661.1 50 FT  
LTS 14-15 &  
16 B6

SECTION 1-1

SEQUENCE 553

LOCATION 111 SD 29TH

0579092 ANDERSON, BEN L & BEVERLY  
INSPTR 7 LANG-ARRINGTON INV.-CONT  
DB 701 HAZELWOOD DR  
LINCOLN, NE 68510

EAST LINCOLN BLOCK 5 LOT 1  
W102 1/2'  
LOT 2 W102' N27 1/2'

SECTION 1-1

SEQUENCE 555

LOCATION 200 SD 28TH

0992071 WILLIAMS, JULIE ANNE  
INSPTR 611 SD 30  
DB LINCOLN, NE 68510

VORES ELM PARK ANNEX BLOCK  
1 LOT 2 532'

SECTION 1-1

SEQUENCE 557

LOCATION 611 SD 30

VOELPAAAN  
*DLN*

*6*

TAX # **47** NAME AND ADDRESS  
0992119 GIBSON, RUSSELL & EVELYN  
INSPTR 639 SO 30TH  
DB LINCOLN, NEBR. 68510

LEGAL **47**  
VORES ELM PARK ANNEX BLOCK  
1 LOT 6

VOELPAAN

SECTION 1-1

SEQUENCE 560 LOCATION 639 SO 30TH

0598551 PLAINS BAPTIST CHURCH  
INSPTR 2902 RANDOLPH  
DB LINCOLN, NE 68502

ELM PARK  
LOT 12 BLK 6

ELMPARK

SECTION 1-1

SEQUENCE 562 LOCATION 2916 RANDOLPH

0992569 ANDERSON, ABBIE J  
INSPTR 1530 BUCKINGHAM DR  
DB LINCOLN, NE 68506

WAITES SUB LOT 28

WAITES

NO BAK

SECTION 1-1

SEQUENCE 563 LOCATION 609 MARSHALL

0992607 WEEKLY, GEORGE H & BEVERLY A  
INSPTR 540 NO 58  
DB LINCOLN, NE 68505

WAITES SUB LOT 32

SECTION 1-1

SEQUENCE 566 LOCATION 645 MARSHALL

0992674 BELK, GEORGE  
INSPTR % ELAINE WAGGONER  
DB 315 SOUTH 9TH - SUITE 110  
LINCOLN, NE 68508

WAITES SUB LOT 39

SECTION 1-1

SEQUENCE 570 LOCATION 745 MARSHALL

0992291 ELSON, MERTIN A & LORENE E  
INSPTR 740 SO 30TH  
DB LINCOLN, NEBR 68510

VORES ELM PARK ANNEX BLOCK  
2 LOT 12

VOELPAAN

SECTION 1-1

SEQUENCE 571 LOCATION 740 SO 30TH

6

48  
TAX # 0992283  
NAME AND ADDRESS KALCIK, DONALD S. & SHARON  
INSPTR 734 SO 30 ST  
DB LINCOLN, NE 68510

35  
LEGAL VORES ELM PARK ANNEX BLOCK  
2 LOT 11

YOELPMAN

SECTION 1-1

SEQUENCE 572

LOCATION 734 SO 30 ST

0992524 VIDAL, OSCAR A & DIANA R  
INSPTR 618 MARSHALL  
DB LINCOLN, NEBR. 68510

WAITES SUB LOT 24

SECTION 1-1

SEQUENCE 577

LOCATION 618 MARSHALL

0992534 DUPONT, ALAN  
INSPTR 610 MARSHALL AVE  
DB LINCOLN, NE 68510

WAITES SUB LOT 25

WAITES

SECTION 1-1

SEQUENCE 578

LOCATION 610 MARSHALL AVE

0992542 JOHNSON, KRISTAL K &  
INSPTR MILLSTEAD, JAMES J  
DB 600 MARSHALL  
LINCOLN, NE 68510

WAITES SUB LOT 26 & W10'  
LOT 1

SECTION 1-1

SEQUENCE 579

LOCATION 600 MARSHALL

0872282 WEBB, JAMES A & DIANE K  
INSPTR 720 SO 31  
DB LINCOLN, NE 68510

RANDOLPH HEIGHTS RAHE  
N8' LOT 17 & S34' LOT 18

SECTION 1-1

SEQUENCE 587

LOCATION 720 SO 31

0872300 BECK, RICHARD H & NINA M  
INSPTR 6410 PONDEROSA  
DB LINCOLN, NE 68510

RANDOLPH HEIGHTS LOT 26  
N40&65HNDS

SECTION 1-1

SEQUENCE 594

LOCATION 602 SO 31ST ST

6



TAX # <sup>44</sup>  
0992216 ALBERS DEVELOPMENT CO  
INSPTR 1801 RIDGEHAVEN CT APT #7  
DB LINCOLN, NE 68505

LEGAL  
VORES ELM PARK BLOCK 2 S30'  
LOT 2 & N25' LOT 3

VOELPANN <sup>49</sup>

SECTION 1-1

SEQUENCE 596

LOCATION 610 SD 30TH

0992551 ZIMMERMAN, EDWARD & DOROTHY  
INSPTR 601 MARSHALL AVE  
DB LINCOLN, NE 68510

WAITES SUB LOT 27  
WAITES

SECTION 1-1

SEQUENCE 598

LOCATION 601 MARSHALL AVE

0992402 SZALAWIGA, GEORGE M & JULIE A  
INSPTR 741 SD 31  
DB LINCOLN, NE 68510

WAITES SUB LOT 11 S21' &  
ALL LOT 12

SECTION 1-1

SEQUENCE 606

LOCATION 741 SD 31

0992470 CUNNINGHAM, BEVERLY A  
INSPTR 706 MARSHALL AVE  
DB LINCOLN, NEBR. 68510

WAITES SUB LOT 19

SECTION 1-1

SEQUENCE 611

LOCATION 706 MARSHALL AVE

0992488 CARPER, STEVEN L & GAYLE E  
INSPTR 7411 WREN CIRCLE  
DB LINCOLN, NE 68510

WAITES SUB LOT 20

SECTION 1-1

SEQUENCE 612

LOCATION 644 MARSHALL

0992496 CARPER, STEVEN L & GAYLE E  
INSPTR 7411 WREN CIR  
DB LINCOLN, NE 68506

WAITES SUB LOT 21

SECTION 1-1

SEQUENCE 613

LOCATION 638 MARSHALL

TAX # 50 NAME AND ADDRESS  
0772721 ZAHN, IAN B & PATRICIA C  
INSPTR 865 SD 33  
DB LINCOLN, NEBR. 68510

50  
LEGA  
MCALISTER ADD LOT 17  
MCALLISTER

SECTION 1-1

SEQUENCE 614

LOCATION 865 SD 33

0772704 KIRBY, MICHAEL S & CARRIE L  
INSPTR 885 SD 33  
DB LINCOLN, NE 68510

MCALISTER ADD LOT 17

SECTION 1-1

SEQUENCE 615

LOCATION 885 SD 33

0772682 LORENZ, HENRY JR & NORMA  
INSPTR 888 ELMWOOD  
DB LINCOLN, NEBR. 68510

MCALISTER ADD LOT 15

SECTION 1-1

SEQUENCE 616

LOCATION 888 ELMWOOD

0772674 BERGE, MARTIN B & NANCY L  
INSPTR 886 ELMWOOD  
DB LINCOLN, NE 68510

MCALISTER ADD LOT 14

SECTION 1-1

SEQUENCE 617

LOCATION 886 ELMWOOD

0772623 SWARTZ, MICHAEL E & ROSALEE A  
INSPTR 840 ELMWOOD AVE  
DB LINCOLN, NE 68510

MCALISTER ADD LOT 9

SECTION 1-1

SEQUENCE 620

LOCATION 840 ELMWOOD AVE

0518760 MOLENAAR, OLIVE S  
INSPTR 3001 F ST  
DB LINCOLN, NE 68510

CAPITOL VIEWBLOCK 2 LOT 11  
& 12 W42' CAVI

SECTION 1-1

SEQUENCE 634

LOCATION 3001 F ST

TAX # 51 NAME AND ADDRESS  
0845078 DORENBACH, JOSEPH HENRY &  
INSPTR CATHERINE GILBERT  
DB 900 SD 31  
LINCOLN, NE 68502

57  
LEGAL  
PARK VIEW BLK 2 LT 11 W 73'  
OF N HLF &  
LT 12 W 73' PAVIAD

SECTION 1-1

SEQUENCE 636

LOCATION 900 SD 31ST ST

0845060 LEHR, WM D & KATHLEEN M  
INSPTR 912 SD 31  
DB LINCOLN, NEBR. 68510

PARK VIEW BLK 2 ALL LT 10 &  
LT 11 S HLF

SECTION 1-1

SEQUENCE 637

LOCATION 912 SD 31

0845051 BERNER, JOHN & ELSIE  
INSPTR 6340 ND 27  
DB LINCOLN, NE 68531

PARK VIEW BLOCK 2 LOT 9

SECTION 1-1

SEQUENCE 638

LOCATION 930 SD 31ST ST

0845043 STURTZ, EDWARD & ANNETTE ET AL  
INSPTR 934 SD 31  
DB LINCOLN, NE 68510

PARK VIEW BLOCK 2 LOT 8

SECTION 1-1

SEQUENCE 639

LOCATION 934 SD 31

0844977 BROWN, ZORT C & DEBRA C  
INSPTR 915 SD 32  
DB LINCOLN, NE 68510

PARK VIEW BLOCK 2 LOT 2

SECTION 1-1

SEQUENCE 640

LOCATION 915 SD 32

0844985 KOHTZ, MARSHALL L & GAIL D  
INSPTR 917 SD 32  
DB LINCOLN, NE 68510

PARK VIEW BLOCK 2 LOT 3

SECTION 1-1

SEQUENCE 641

LOCATION 917 SD 32

TAX # *52* NAME AND ADDRESS  
0844993 PAUSCHER, STEVEN E & KAREN  
INSPTR 925 SO 32  
DB LINCOLN, NE 68510

LEGAL  
PARK VIEW BLOCK 2 LOT 4

*PAVIAO*

SECTION 1-1

SEQUENCE 642

LOCATION 925 SO 32

0845001 LESSMAN, EUGENE H  
INSPTR 3126 E ST  
DB LINCOLN, NE 68510

PARK VIEW BLOCK 2 W40' LOTS  
5 & 6

SECTION 1-1

SEQUENCE 643

LOCATION 3126 E ST

0639842 PETTIT, MERLIN D & VERA M  
INSPTR 2950 F ST  
DB LINCOLN, NE 68510

GRANTS ADD BLOCK 1 LOT 14  
S100

*GRANT*

*BIKI*

SECTION 1-1

SEQUENCE 652

LOCATION 2950 F ST

0639826 BARLOW, DOUGLAS M & RHONDA  
INSPTR 2940 "F" STREET  
DB LINCOLN, NE 68510

GRANTS ADD BLOCK 1 S100'  
LOT 13

SECTION 1-1

SEQUENCE 653

LOCATION 2940 F

0639818 STACY, SCOTT D  
INSPTR 2920 F ST  
DB LINCOLN, NE 68510

GRANTS ADD BLOCK 1 LOT 12 &  
S1/2 E-W ALLEY ADJ

SECTION 1-1

SEQUENCE 654

LOCATION 2920 F ST

0639877 GOTTSLEBEN, DERALD E &  
INSPTR PATRICIA  
DB 6533 SUNDANCE  
LINCOLN, NE 68512

GRANT ADD AMERICAN SUB LT  
1&2 BLK 2;  
LT 3 BLK 2

SECTION 1-1

SEQUENCE 655

LOCATION 2836 F

*AMSU*

53

TAX # *53* NAME AND ADDRESS  
0639869 FERGUSEN, BRADLEY C & KAREN  
INSPTR % MCKENZIE, DANIEL & SHARRON  
DB (CONTRACT) 852 SO 37  
LINCOLN, NE 68510

LEGAL  
GRANT ADD AMERICAN SUB LOTS  
1 & 2 BLOCK 2  
LOT 2 BLOCK 2

*AMSU*

SECTION 1-1

SEQUENCE 656

LOCATION 865 SO 29TH

0639851 GEIBEL, JOHN L & MARY J  
INSPTR 857 SO 29  
DB LINCOLN, NE 68510

GRANT ADD AMERICAN SUB LOTS  
1 & 2 BLK 2  
LOTS 1 & 11 & 12 BLK 2

SECTION 1-1

SEQUENCE 657

LOCATION 857 SO 29

0477036 GROSSE, DWANE LEE & RUTH  
INSPTR 833 SO 29  
DB LINCOLN, NE 68510

BISHOPS ADD LOT 5 & S10  
LOT 6

*BISHOPS  
No Blk*

SECTION 1-1

SEQUENCE 658

LOCATION 833 SO 29

0477028 RISCHLING, RICHARD & DARLENE L  
INSPTR 821-23 SO 29TH  
DB LINCOLN, NEBR. 68510

BISHOPS ADD LOT 4 S 16 LOT  
5 N 30

SECTION 1-1

SEQUENCE 659

LOCATION 821-23 SO 29TH

0477001 HRUBY, CYRIL P & BERNITA R  
INSPTR : 2845 RANDOLPH  
DB LINCOLN, NEPH 68510

BISHOPS ADD LOT 1&2 E90 LT 3  
N18 OF E90

SECTION 1-1

SEQUENCE 660

LOCATION 2845 RANDOLPH

0476994 SEDLAK, JOHNNY R & BETTY J  
INSPTR 3730 NW 53  
DB LINCOLN, NE 68524

BISHOPS ADD LOT 1&2 W50 LT 3  
N18 OF W50

SECTION 1-1

SEQUENCE 661

LOCATION 2821 RANDOLPH

*6*

TAX # 54 NAME AND ADDRESS  
0871737 SWEENEY, THOMAS P  
INSPTR 734 SOUTH 45H  
DB LINCOLN, NE 68510

59  
LEGA  
RANDOLPH ADD LOT 1

RANDOLPH

NO 81/2

SECTION 1-1

SEQUENCE 662

LOCATION 2817 RANDOLPH

0871745 BODFIELD, MARJORIE & ROBERT W.  
INSPTR 2805 RANDOLPH  
DB LINCOLN, NEBR. 68510

RANDOLPH ADD LOT 2 N HALF

SECTION 1-1

SEQUENCE 663

LOCATION 2805 RANDOLPH

0871770 SCHMIEDING, EDWIN F & LILLIAN  
INSPTR 4041 ND 40  
DB LINCOLN, NE 68504

RANDOLPH ADD LOT 4

SECTION 1-1

SEQUENCE 666

LOCATION 830 SD 28TH

0871788 PETERSON, CALVIN & SHIRLEY  
INSPTR 4410 SD 49  
DB LINCOLN, NE 68516

RANDOLPH ADD LOT 5

SECTION 1-1

SEQUENCE 667

LOCATION 838 SD 28TH

0871796 WYCOFF, RICHARD A & ANGELA C  
INSPTR 844 SD 28  
DB LINCOLN, NE 68510

RANDOLPH ADD LOT 6

SECTION 1-1

SEQUENCE 668

LOCATION 844 SD 28

0639958 DANNER, MARK H & MARY  
INSPTR 862 SD 28  
DB LINCOLN, NE 68510

GRANTS ADD BLK 2 LT 5 N48'  
OF 596' OF E50'

GRANT

SECTION 1-1

SEQUENCE 669

LOCATION 862 SD 28

6

TAX # *55* NAME AND ADDRESS  
0639966 BALLA, EMMERICK & LIZELLA  
INSPTR 868 S 28  
DB LINCOLN, NEBR. 68510

55  
LEGAL  
GRANTS ADD BLK 2 LT 5 848'  
OF E50'

GRANT

SECTION 1-1

SEQUENCE 670

LOCATION 868 S 28

0640221 BULLAND, GERALD F. & PEGGY  
INSPTR % WAECHTER, ROBERT  
DB 2758 FRANKLIN  
LINCOLN, NE 68502

GRANT ADD LINCOLN AMERICAN  
SUB S1/2 BLK 4  
LOTS 8 & 15 & 16 BLK 4

*LIA<sup>m</sup>  
No BK*

SECTION 1-1

SEQUENCE 674

LOCATION 2900 E

1511232 BRITNELL, JESSE H.  
INSPTR 2040 ND 53  
DB LINCOLN, NE 68504

GRANT ADD LINCOLN AMERICAN  
SUB S1/2 BLK 4  
LOTS 6 & 17 & 18 BLK 4

SECTION 1-1

SEQUENCE 676

LOCATION 2918 E

0640174 BOUSEK, MARY JO & JOHN R  
INSPTR 2001 SD 24  
DB LINCOLN, NE 68502

GRANT ADD LINCOLN AMERICAN  
SUB S1/2 BLK 4  
LOT 4 BLK 4

SECTION 1-1

SEQUENCE 677

LOCATION 2932 E

0640158 BOUSEK, MARY JO & JOHN R  
INSPTR 2001 SD 24  
DB LINCOLN, NE 68502

GRANT ADD LINCOLN AMERICAN  
SUB S1/2 BLK 4  
SD 61' LOT 3 BLK 4

SECTION 1-1

SEQUENCE 678

LOCATION 933 SD 30TH

0640123 RANDALL, JAY H  
INSPTR 823 SD 31  
DB LINCOLN, NE 68510

GRANTS ADD BLOCK 4 LOT 4

SECTION 1-1

SEQUENCE 683

LOCATION 2911 F

*6*

TAX # <sup>56</sup> NAME AND ADDRESS  
0640051 THOMPSON, WM. R. & AMELIA  
INSPTR BOX 247  
DB FIRTH, NE 68358

LEGAL  
GRANT ADD AMERICAN SUB LT  
4&5 BLKS 3 OF 85'  
OF F ST ABUTTING LITS  
1&12&13 BLK 3

52

SECTION 1-1

SEQUENCE 687

LOCATION 2811 F

*Amsub  
No Blk*

0566870 PASCO, LOIS & RICHARD  
INSPTR 3220 D ST  
DB LINCOLN, NEBR 68510

DOLANS SUB IT 81 SW 1/4  
30-10-7  
BLOCK 2 LOT 13&14 E46

DOLANS

SECTION 1-1

SEQUENCE 695

LOCATION 3220 D ST

0566853 MOUNT ZION BAPTIST CHURCH INC  
INSPTR 1060 SD 32  
DB LINCOLN, NE 68510

DOLANS SUB IT 81 SW 1/4  
30-10-7  
BLOCK 2 LOT 13 W90

SECTION 1-1

SEQUENCE 696

LOCATION 1060 SD 32

0566918 KOPETZKY, DAVID R & KAREN A  
INSPTR 1008 SD 32  
DB LINCOLN, NE 68510

DOLANS SUB IT 81 SW 1/4  
30-10-7  
BLOCK 2 LOT 18

SECTION 1-1

SEQUENCE 700

LOCATION 1008 SD 32

0566926 MULGRUE, FERN L ET AL  
INSPTR : 3303 S 28  
DB LINCOLN, NE 68502

DOLANS SUB IT 81 SW 1/4  
30-10-7  
BLOCK 2 LOT 19

SECTION 1-1

SEQUENCE 701

LOCATION 940 SD 32ND

0566969 BECKER, ROBERT C  
INSPTR 910 SD 32  
DB LINCOLN, NE 68510

DOLANS SUB BLOCK 2 LOT 23

SECTION 1-1

SEQUENCE 705

LOCATION 910 SD 32

6



TAX # 57 NAME AND ADDRESS  
0844845 JOOSTEN, DAVID A & HEILA R  
INSPTR 3124 F ST  
DB LINCOLN, NE 68510

LEGAL  
PARK VIEW BLOCK 1 LOT 9 &  
10 W 40

57  
PAVING

SECTION 1-1

SEQUENCE 708

LOCATION 3124 F ST

0844837 HAUGHT, BRENDA  
INSPTR 871 SD 32  
DB LINCOLN, NE 68510

PARK VIEW ADD BLOCK 1 LOTS  
9 & 10 E 42

SECTION 1-1

SEQUENCE 709

LOCATION 871 SD 32

0844811 RITTENBURG, MARY ALICE  
INSPTR 855 SD. 32ND ST.  
DB LINCOLN, NEBR. 68510

PARK VIEW BLOCK 1 LOT 8

SECTION 1-1

SEQUENCE 710

LOCATION 855 SD. 32ND ST.

0844802 ROWEN, RAYMOND E & ELLEN M  
INSPTR 849 SD 32  
DB LINCOLN, NE 68510

PARK VIEW BLOCK 1 LOT 7

SECTION 1-1

SEQUENCE 711

LOCATION 849 SD 32

0844764 BEHRENS, GERTRUDE & RUTH  
INSPTR 819 SD 32  
DB LINCOLN, NEBR. 68510

PARK VIEW BLOCK 1 LOT 3

SECTION 1-1

SEQUENCE 713

LOCATION 819 SD 32

0844756 CRESS, ROBERT & GLADYS  
INSPTR 811 SD 32 ST  
DB LINCOLN, NEBR. 68510

PARKVIEW ADD LOT 2 BLK 1

SECTION 1-1

SEQUENCE 714

LOCATION 811 SD 32 ST

6

TAX # 58 NAME AND ADDRESS  
0844748 MARTIN, WILLIAM R & SHERRY L  
INSFTR 801 S 32  
DB LINCOLN, NE 68510

LEGAL 58  
PARK VIEW ADD BLK 1 LOT 1  
PAVIAD

SECTION 1-1

SEQUENCE 715

LOCATION 801 S 32

0844888 BOBBY, JACKLYN D &  
INSFTR KOENIG, MARK A  
DB 8707 MEADOWS PARKWAY  
OMAHA, NE 68138

PARK VIEW BLOCK 1 LOT 13

SECTION 1-1

SEQUENCE 719

LOCATION 860 SO 31ST ST

0518522 WHALEN, RICHARD & VERONICA  
INSFTR 874 SOUTH 30TH  
DB LINCOLN, NEBRASKA 68510

CAPITOL VIEWBLOCK 1 LOT 10  
CAVI

SECTION 1-1

SEQUENCE 722

LOCATION 874 SOUTH 30TH

0518514 SCHIEDLER, GLADYS E  
INSFTR 866 SO 30 ST  
DB LINCOLN, NEBR. 68510

CAPITOL VIEWBLOCK 1 LOT 9

SECTION 1-1

SEQUENCE 723

LOCATION 866 SO 30 ST

0518549 HESTER, PHILIP C  
INSFTR 865 SO 31  
DB LINCOLN, NE 68510

CAPITOL VIEWBLOCK 1 LOT 12

SECTION 1-1

SEQUENCE 728

LOCATION 865 SO 31

0518654 WAAK, HARLAN & VICKI  
INSFTR 907 SO 31  
DB LINCOLN, NE 68510

CAPITOL VIEWBLOCK 2 LOT 2

SECTION 1-1

SEQUENCE 730

LOCATION 907 SO 31

6

TAX # <sup>59</sup>  
0518697 MUTCHIE, JACOB L  
INSPTR 945 SO 31  
DB LINCOLN, NE 68510

LEGAL  
CAPITAL VIEWBLOCK 2 LOT 6  
CAVI

59

SECTION 1-1

SEQUENCE 732 LOCATION 945 SO 31

0599905 CONLEY, ROBERT D & MARY  
INSPTR 736 ELMWOOD  
DB LINCOLN, NEBR. 68510

ELMWOOD PARK SUB DIV 63&64  
30-10-7 LOT 15  
(EX S 14 1/2' OF E37')

SECTION 1-1

SEQUENCE 735 LOCATION 736 ELMWOOD

ELMPA  
NO 212

0599930 SOUTHWICK, DIANE K & TERRILL E  
INSPTR 714 ELMWOOD AVE  
DB LINCOLN, NE 68510

ELMWOOD PARK SUB DIV 63&64  
30-10-7 LOT 18

SECTION 1-1

SEQUENCE 736 LOCATION 714 ELMWOOD AVE

0599948 PITTMAN, FRED A B  
INSPTR 708 ELMWOOD  
DB LINCOLN, NE 68510

ELMWOOD PARK SUB DIV 63&64  
30-10-7 LOT 19

SECTION 1-1

SEQUENCE 737 LOCATION 708 ELMWOOD

0599956 GILBERT, DOYLE D & PEGGY L  
INSPTR 700 ELMWOOD AVE  
DB LINCOLN, NE 68510

ELMWOOD PARK SUB DIV 63&64  
30-10-7 LOT 20  
S2 1/2' LOT 21

SECTION 1-1

SEQUENCE 738 LOCATION 700 ELMWOOD AVE

0599964 DILLON, DENNIS L. & BAIL  
INSPTR 640 ELMWOOD AVE  
DB LINCOLN, NEBR. 68510

ELMWOOD PARK SUB DIV 63&64  
30-10-7  
LOT 21 N43 1/2'

SECTION 1-1

SEQUENCE 739 LOCATION 640 ELMWOOD AVE

6

TAX # 60 NAME AND ADDRESS  
0599781 BRANHILL, SUSAN PATRICIA  
INSPTR 624 ELMWOOD AVE  
DB LINCOLN, NE 68510

LEGAL  
ELMWOOD PARK SUB DIV 63&64  
30-10-7 LOT 23

ELMIPA

SECTION 1-1

SEQUENCE 740

LOCATION 624 ELMWOOD AVE

0599751 DORAN, JOHN L  
INSPTR 601 SO 33  
DB LINCOLN, NE 68510

ELMWOOD PARK SUB DIV 63&64  
30-10-7 LOT 1

SECTION 1-1

SEQUENCE 742

LOCATION 601 SO 33

0599778 FDRYCKI, RAYMOND & DIANE C  
INSPTR 615 SO 33  
DB LINCOLN, NE 68510

ELMWOOD PARK SUB DIV 63&64  
30-10-7 LOT 3

SECTION 1-1

SEQUENCE 743

LOCATION 615 SO 33

0599786 HORNBY, RODNEY S & CAMIE S  
INSPTR 623 SO 33 ST  
DB LINCOLN, NE 68510

ELMWOOD PARK SUB DIV 63&64  
30-10-7 LOT 4

SECTION 1-1

SEQUENCE 744

LOCATION 623 SO 33 ST

0599794 DIVIS, BERNARD J. & DEL ANN  
INSPTR 633 S 33  
DB LINCOLN, NEBR. 68510

ELMWOOD PARK SUB DIV 63&64  
30-10-7 LOT 5

SECTION 1-1

SEQUENCE 745

LOCATION 633 S 33

0599808 CLARK, CORY R  
INSPTR 641 SO 33  
DB LINCOLN, NE 68510

ELMWOOD PARK SUB DIV 63&64  
30-10-7 LOT 6

SECTION 1-1

SEQUENCE 746

LOCATION 641 SO 33

6

TAX # 61 NAME AND ADDRESS  
0599816 GILMORE, ORAN L & MATH E  
INSPTR 701 S 33  
DB LINCOLN, NEBR. 68510

LEGAL  
ELMWOOD PARK SUB DIV 63&64  
30-10-7 LOT 7

ELMPA

SECTION 1-1

SEQUENCE 747

LOCATION 701 S 33

0599824 NOWAKOWSKI, JANINA  
INSPTR 705 SO 33RD  
DB LINCOLN, NEBR 68510

ELMWOOD PARK SUB DIV 63&64  
30-10-7 LOT 8

SECTION 1-1

SEQUENCE 748

LOCATION 705 SO 33RD

0772755 SCHEFFERT, ERNEST R  
INSPTR 843 SO 33  
DB LINCOLN, NE 68510

MCALISTER ADD LOT 22

MCALLISTER

SECTION 1-1

SEQUENCE 753

LOCATION 843 SO 33

0772739 FUNK, DAN E & SARAH K  
INSPTR 855 SO 33  
DB LINCOLN, NE 68510

MCALISTER ADD LOT 20

SECTION 1-1

SEQUENCE 754

LOCATION 855 SO 33

0600156 YOUNG, MICHAEL D & NANCY  
INSPTR 745 ELMWOOD  
DB LINCOLN, NE 68510

ELMWOOD PARK SUB DIV 63&64  
30-10-7 LOT 39

ELMPA

SECTION 1-1

SEQUENCE 755

LOCATION 745 ELMWOOD

0600270 GILDE, HANS & SHIRLEY  
INSPTR 610 S 32  
DB LINCOLN, NEBR. 68510

ELMWOOD PARK SUB DIV 63&64  
30-10-7 LOT 51

SECTION 1-1

SEQUENCE 760

LOCATION 610 S 32

6

TAX # 62  
0600288 FORBES, VERNON J & JOANN B  
INSPTR 602 SD 32  
DB LINCOLN, NE 68510

62  
LEGAY  
ELMWOOD PARK SUB DIV 63&64  
30-10-7 LOT 52

SECTION 1-1

ELMPA

SEQUENCE 761

LOCATION 602 SD 32

0600059 BELL, ERIC J. & SUSAN  
INSPTR 615 ELMWOOD AVE  
DB LINCOLN, NEBR. 68510

ELMWOOD PARK SUB DIV 63&64  
30-10-7 LOT 29

SECTION 1-1

SEQUENCE 764

LOCATION 615 ELMWOOD AVE

0600067 PASCO, LOIS  
INSPTR 1635 SD 34TH ST  
DB LINCOLN, NE 68506

ELMWOOD PARK SUB DIV 63&64  
30-10-7 LOT 30

SECTION 1-1

SEQUENCE 765

LOCATION 625 ELMWOOD

0600083 LAWS, DONALD E SR  
INSPTR 637 ELMWOOD AVE  
DB LINCOLN, NEBR. 68510

ELMWOOD PARK SUB DIV 63&64  
30-10-7 LOT 32

SECTION 1-1

SEQUENCE 767

LOCATION 637 ELMWOOD AVE

0599883 WOLFE, DEL F. & SANDRA  
INSPTR 3260 RANDOLPH  
DB LINCOLN, NEBR. 68510

ELMWOOD PARK SUB DIV 63&64  
30-10-7 LOT 14 W  
80 5 TNTHS

SECTION 1-1

SEQUENCE 770

LOCATION 3260 RANDOLPH

0599891 ADAMS, FRANK J & CHERYL L  
INSPTR 3268 RANDOLPH  
DB LINCOLN, NE 68510

ELMWOOD PARK SUB DIV 63&64  
30-10-7: LOT 14  
E54 LOT 15 S 14&HLF OF E37

SECTION 1-1

SEQUENCE 771

LOCATION 3268 RANDOLPH

6

TAX # <sup>63</sup>  
0599875 WOLFE, DOUGLAS  
INSPTR 745 SO 33 ST  
DB LINCOLN, NE 68510

LEGAL  
ELMWOOD PARK SUB LOT 13  
ELMPA

63

SECTION 1-1

SEQUENCE 772 LOCATION 745 SO 33 ST

0566659 TEATER, THOMAS C & MELISA K  
INSPTR 1000 ELMWOOD  
DB LINCOLN, NE 68510

DOLANS SUB IT 81 SW 1/4  
30-10-7  
BLOCK 1 LOT 18

SECTION 1-1

SEQUENCE 773 LOCATION 1000 ELMWOOD

0566713 DAVIS, DANIEL T  
INSPTR 900 ELMWOOD  
DB LINCOLN, NE 68510

DOLANS SUB IT 81 SW 1/4  
30-10-7  
BLOCK 1 LOT 24 DOLANS

SECTION 1-1

SEQUENCE 780 LOCATION 900 ELMWOOD

0566721 MERTENS, EDWIN H & MARGARET A  
INSPTR RR1  
DB LINCOLN, NE 68502

DOLANS SUB IT 81 SW 1/4  
30-10-7  
BLOCK 2 LOT 1

SECTION 1-1

SEQUENCE 782 LOCATION 901 ELMWOOD

0566781 CRIST, ROY E & GLADYS D  
INSPTR 1003 ELMWOOD  
DB LINCOLN, NE 68510

DOLANS SUB IT 81 SW 1/4  
30-10-7  
BLOCK 2 LOT 7

SECTION 1-1

SEQUENCE 787 LOCATION 1005 ELMWOOD

0566829 MCCOWN, ROSEMARY A  
INSPTR 1035 ELMWOOD  
DB LINCOLN, NE 68510

DOLANS SUB IT 81 SW 1/4  
30-10-7  
BLOCK 2 LOT 11 E90

SECTION 1-1

SEQUENCE 790 LOCATION 1035 ELMWOOD

6

TAX # *64* NAME AND ADDRESS  
0566845 OLSON, WILMER R & JOANN C  
INSPTR 5601 DEERHAVEN  
DB LINCOLN, NE 68516

LEGAL  
DOLANS SUB IT 81 SW 1/4  
30-10-7  
BLOCK 2 LOT 12 E90

*69*

SECTION 1-1

DOLANS

SEQUENCE 791

LOCATION 1045 ELMWOOD

0566471 REDFIELD, LARRY E  
INSPTR 903 SOUTH 33  
DB LINCOLN, NE 68510

DOLANS SUB IT 81 SW 1/4  
30-10-7  
BLOCK 1 LOT 1

SECTION 1-1

SEQUENCE 805

LOCATION 903 SO 33RD

0566616 GRANDBERRY, SYLVESTER & CYNTHI  
INSPTR 3268 "D" ST.  
DB LINCOLN, NEBR. 68510

DOLANS SUB IT 81 SW 1/4  
30-10-7  
BLOCK 1 LOT 13&14 E45

SECTION 1-1

SEQUENCE 807

LOCATION 3268 "D" ST.

0566624 HORNBY, DARRELL V & ANITA J  
INSPTR 1024 ELMWOOD  
DB LINCOLN, NE 68510

DOLANS SUB IT 81 SW 1/4  
30-10-7  
BLOCK 1 LOT 15

SECTION 1-1

SEQUENCE 808

LOCATION 1024 ELMWOOD

1511798 SITTNER, JACK J & WILHELMINA  
INSPTR 4045 RANDOLPH  
DB LINCOLN, NEBR. 68510

ELM PLACE LOTS 6&7 EX W-PT  
OF LOTS 6 & 7 FOR STREET

ELMPIACE

*No D/R*

SECTION 1-1

SEQUENCE 812

LOCATION 2705 RANDOLPH

0871893 VRTISKA, JOSEPH F & LINDA  
INSPTR 5621 DAVE CIRCLE  
DB LINCOLN, NE 68516

RANDOLPH ADD LOT 13 N102

RANDOLPH

SECTION 1-1

SEQUENCE 816

LOCATION 2747 RANDOLPH

*6*



TAX # <sup>65</sup> NAME AND ADDRESS  
0871915 HARTMAN, GEO H & LILLA H  
INSPTR 2776 CALIF CRT  
DB LINCOLN, NE 68510

LEGAL  
RANDOLPH ADD GEHRKES SUB OF  
14 TO 19 LOT B

63

SECTION 1-1

GEHRKE107

SEQUENCE 821

LOCATION 2776 CALIF CRT

1519802 FLETCHER, MARK  
INSPTR 1529 SO 24  
DB LINCOLN, NE 68502

RANDOLPH ADD GEHRKES SUB OF  
14 TO 19 LOT D  
RANDOLPH ADD LOT 11 S25'

SECTION 1-1

RANDOLPH  
+ GEHRKE107

SEQUENCE 823

LOCATION 2760 CALIFORNIA CT

NO B&K

0871940 SISLER, WARREN L & LILA M  
INSPTR % SCHRINER, RITA (CONTRACT\*)  
DB 320 JEFFERY DR  
LINCOLN, NE 68505

RANDOLPH ADD GEHRKES SUB OF  
14 TO 19 LOT E

SECTION 1-1

SEQUENCE 824

LOCATION 2754 CALIF CT

0871982 JISKRA, MICHAEL J & DEBRA S  
INSPTR 644 WEST B  
DB LINCOLN, NE 68522

RANDOLPH ADD GEHRKES SUB OF  
14 TO 19 LOT I

SECTION 1-1

SEQUENCE 825

LOCATION 2757 CALIF CT

0871991 LYBERIS, GEORGE W & EILENE L  
INSPTR 4515 NEWTON  
DB LINCOLN, NE 68506

RANDOLPH ADD GEHRKES SUB OF  
14 TO 19 LOT J

SECTION 1-1

SEQUENCE 826

LOCATION 2767 CALIF CT

0633593 LIGHTNER, NANETTE L  
INSPTR 2760 F ST  
DB LINCOLN, NE 68510

GILLIANS ORCHARD HOME ADD  
LOT 5

GIORHO

SECTION 1-1

SEQUENCE 829

LOCATION 2760 F ST

NO  
B&K

6

TAX # <sup>66</sup> NAME AND ADDRESS  
0633615 BROWN, DANIEL F & SANDRA D  
INSPTR 2750 F  
DB LINCOLN, NE 68510

LEGAL  
GILLIANS ORCHARD HOME ADD  
LOT 7

66

GIORHO

SECTION 1-1

SEQUENCE 830

LOCATION 2750 F

0633658 DITTMER, LAWRENCE B & BILLIE S  
INSPTR RFD #1  
DB LINCOLN, NE 68502

GILLIANS ORCHARD HOME ADD  
E32' LOT 10

SECTION 1-1

SEQUENCE 831

LOCATION 2726 F

0633640 HUNDEMER, VALERA R  
INSPTR 2722 F ST  
DB LINCOLN, NEBR. 68510

GILLIANS ORCHARD HOME ADD  
LOT 10 W16  
LOT 11 E16

SECTION 1-1

SEQUENCE 832

LOCATION 2722 F ST

0633739 LINCOLN, CITY OF  
INSPTR TRAFFIC ENGINEERING  
DB 233 SOUTH 10TH  
LINCOLN, NE 68508

GILLIANS ORCHARD HOME ADD  
LT 14 W42'

SECTION 1-1

SEQUENCE 835

LOCATION S E CORNER SO 27TH & F

0942235 WHITEHEAD, MILTON E JR  
INSPTR 2433 WOODSCREST  
DB LINCOLN, NE 68502

SUMMERDALE ADD S62' LTS 12  
& 13 EX ST  
BLK 1

SUMMERDALE

BLK 1

SECTION 1-1

SEQUENCE 836

LOCATION 946 SO 27TH

0633836 WEHRLI, ROBERT R & DORIS A  
INSPTR 46 FENCHURCH DR TRUSTEES  
DB BELLA VISTA, AR 72714

GILLIAN ORCHARD HOME ADD  
N55.4' LOTS 23 & 24 &  
N55.4' W24' LOT 25

GIORHO

SECTION 1-1

SEQUENCE 842

LOCATION 901 SO 28TH

6

TAX # 67 NAME AND ADDRESS  
0633828 VOSTA, ELMER J & LORRAINE L  
INSPTR 915 SO 28  
DB LINCOLN, NE 68510

LEGAL  
GILLIAN ORCHARD HOME ADD  
LOT 22  
GIORHO

67

SECTION 1-1

SEQUENCE 843

LOCATION 2769 F

0633810 MCMICHAEL, FORREST R & JULIA  
INSPTR 2767 F ST  
DB LINCOLN, NE 68502

GILLIAN ORCHARD HOME ADD  
LOT 21

SECTION 1-1

SEQUENCE 844

LOCATION 2767 F ST

0942456 BROOKS, SHIRLEY ANN  
INSPTR 2780 ALPHA  
DB LINCOLN, NEBR 68510

SUMMERDALE ADD BLOCK 2 LOT  
25

SUMMERDALE

SECTION 1-1

SEQUENCE 848

LOCATION 2780 ALPHA

0942430 DILLEY, BRYAN E & KIMBERLY N &  
INSPTR BARBARA J  
DB 602 SO 40  
LINCOLN, NE 68510

SUMMERDALE ADD BLOCK 2 LOT  
23

SECTION 1-1

SEQUENCE 849

LOCATION 2766 ALPHA

0942391 HOSEK, RICHARD J & SANDRA  
INSPTR 3901 NORTH 42  
DB LINCOLN NEBR 68504

SUMMERDALE ADD BLOCK 2 LOT  
19

SECTION 1-1

SEQUENCE 851

LOCATION 2742 ALPHA

0942375 AIR MANAGEMENT SUPPLY, INC  
INSPTR 10525 I  
DB OMAHA, NE 68127

SUMMERDALE ADD BLOCK 2 LOT  
17

SECTION 1-1

SEQUENCE 853

LOCATION 2730 ALPHA

6

TAX # <sup>68</sup> NAME AND ADDRESS  
0942316 DOERING, GEORGE H & YOLANDA  
INSPTR 5230 ENGLISH DR  
DB LINCOLN, NE 68516

LEGAL  
SUMMERDALE ADD BLOCK 2 LOT  
7  
SUMMERDALE

68

SECTION 1-1

SEQUENCE 856 LOCATION 2755 E

0942260 VESKINA, ALFRED J & CAROLINE B  
INSPTR 2305 SD 58 ST  
DB LINCOLN, NE 68506

SUMMERDALE ADD BLOCK 2 LOT  
2

SECTION 1-1

SEQUENCE 859 LOCATION 2785 E

0942251 SHERDON, HERBERT  
INSPTR 2793 E ST  
DB LINCOLN, NEBR. 68510

SUMMERDALE ADD BLOCK 2 LOT  
1

SECTION 1-1

SEQUENCE 860 LOCATION 2793 E ST

0640328 POWELL, RANDOLPH J & GEORGIA B  
INSPTR 1034 SD 28TH  
DB LINCOLN, NEBR. 68510

GRANTS ADD BLOCK 6 LOT 7  
GRANT

SECTION 1-1

SEQUENCE 861 LOCATION 1034 SD 28TH

0640336 STEYER, ANDREW J & RUTH C  
INSPTR 3710 J  
DB LINCOLN, NE 68510

GRANTS ADD BLOCK 6 LOT 8

SECTION 1-1

SEQUENCE 862 LOCATION 1040 SD 28TH

0782416 HOPPES, DON R  
INSPTR RT 1  
DB ROCA, NE 68430

MAYS SUB LOT 24 BLOCK 5  
MAYS

SECTION 1-1

SEQUENCE 869 LOCATION 1041 SD 30TH

6

TAX # 69 NAME AND ADDRESS  
0782408 CARCAMO, RAFAEL A & ROSALINA  
INSPTR 1025 SO 30  
DB LINCOLN, NE 68510

LEGAL 69  
MAYS SUB LOT 23 BLOCK 5  
MAYS

SECTION 1-1

SEQUENCE 870 LOCATION 1025 SO 30

0942481 BUETHE, KENNETH & MILDRED  
INSPTR X MCGINNIS, ROGER, DORIS &  
DB CLIFFORD (CONT) 1530 SO 70  
LINCOLN, NE 68506

SUMMERDALE ADD BLOCK 3 LOT  
2  
SUMMERDALE

SECTION 1-1

SEQUENCE 875 LOCATION 2781 ALPHA

0942502 ROKEYBY, ROBERT & VICTORIA (1/2)  
INSPTR & SCHMIEDING, LARRY D (1/2)  
DB 6140 HAVELOCK AVE  
LINCOLN, NE 68507

SUMMERDALE ADD BLOCK 3 ALL  
LOT 5 & W35.5' LOT 4

SECTION 1-1

SEQUENCE 877 LOCATION 2757 ALPHA

0942511 SHANNON, GERALD K  
INSPTR 2749 ALPHA  
DB LINCOLN, NEBR. 68510

SUMMERDALE ADD BLOCK 3 LOT  
6

SECTION 1-1

SEQUENCE 878 LOCATION 2749 ALPHA

0942529 CRADICK, LARRY L & JANICE  
INSPTR 4100 S 39TH  
DB LINCOLN, NEBR. 68506

SUMMERDALE ADD BLOCK 3 LOT  
7

SECTION 1-1

SEQUENCE 879 LOCATION 2745 ALPHA

0518786 TOMASEK, GERALD J & JAMES C  
INSPTR 5724 CULWELLS RD  
DB LINCOLN, NE 68516

CAPITOL VIEW BLOCK 3 LOT  
2  
CAVI

SECTION 1-1

SEQUENCE 884 LOCATION 1009 SO 31ST ST

70  
TAX # NAME AND ADDRESS  
0518891 JESIFERS, HERBERT & RASMA  
INSPTR 3272 MOHAWK  
DB LINCOLN, NEBR 68516

90  
LEGAL  
CAPITOL VIEWBLOCK 3 LOT 12  
LOT 13 S2'

CAVI

SECTION 1-1

SEQUENCE 888

LOCATION 1020 SD 30TH

0561401 MAHER, KATHLEEN A  
INSPTR 1101 SD 31  
DB LINCOLN, NEBR. 68510

DAVIS SECOND ADD BLOCK 2  
LOT 1 E85  
DAVZ

SECTION 1-1

SEQUENCE 894

LOCATION 1101 SD 31

0528242 BOYUM, FOREST E & HONEY LOU  
INSPTR 1940 PACIFIC  
DB LINCOLN, NE. 68506

CITY PARK BLOCK 4 LOT 3  
CIPA

SECTION 1-1

SEQUENCE 898

LOCATION 1225 SD 31ST ST

0561479 VANBRONINGEN, JOHN DONOVAN &  
INSPTR HELEN K  
DB 1138 SD 30  
LINCOLN, NE 68510

DAVIS SECOND ADD BLOCK 2  
LOT 7  
DAVZ

SECTION 1-1

SEQUENCE 899

LOCATION 1138 SD 30TH

0561487 HOLLINGSWORTH, JOHN J. & SALLY  
INSPTR 1130 SD 30  
DB LINCOLN, NE 68510

DAVIS SECOND ADD BLOCK 2  
LOT 8

SECTION 1-1

SEQUENCE 900

LOCATION 1130 SD 30

0561517 BECK, JOHN  
INSPTR 1100 SD 30  
DB LINCOLN, NE 68510

DAVIS SECOND ADD BLOCK 2  
LOT 12

SECTION 1-1

SEQUENCE 903

LOCATION 1100 SD 30

6

TAX # 71 NAME AND ADDRESS  
0528277 NEUMAN, MARION  
INSFTR 1200 SD 30  
DB LINCOLN, NEBR. 68510

LEGAL  
CITY PARKBLOCK 4 LOT 6  
CIPA

SECTION 1-1

SEQUENCE 904

LOCATION 1200 SD 30

0561380 RHOADS, KENNETH D  
INSFTR 1102 SD 31  
DB LINCOLN, NE 68510

DAVIS SECOND ADD BLOCK 1  
LOT 12  
DAV2

SECTION 1-1

SEQUENCE 905

LOCATION 1102 SD 31

0561339 WOLFE, RONALD W & TRACIE  
INSFTR 1146 SD 31  
DB LINCOLN, NE 68510

DAVIS SECOND ADD BLOCK 1  
LOT 7

SECTION 1-1

SEQUENCE 906

LOCATION 1146 SD 31

0845213 ROUTON, DAVID F  
INSFTR 1016 SOUTH 31ST  
DB LINCOLN, NEBR. 68510

PARK VIEW BLOCK 3 LOT 12  
PAVIAD

SECTION 1-1

SEQUENCE 910

LOCATION 1016 SOUTH 31ST

0845116 FORSBERG, ELLEN  
INSFTR 1/2 GRANATA REATLY  
DB 1836 HIGH ST  
LINCOLN, NE 68502

PARK VIEW BLK 3 LT 1&2 W42  
& 76 HNDRD FT

SECTION 1-1

SEQUENCE 912

LOCATION 3125 E

0561304 FRICKEL, AMELIA, JAKE G &  
INSFTR ROBERT DEAN  
DB 4300 C ST  
LINCOLN, NE 68510

DAVIS SECOND ADD BLOCK 1  
LOT 4  
DAV2

SECTION 1-1

SEQUENCE 918

LOCATION 1125 SD 32ND

6

TAX # 72 NAME AND ADDRESS  
0561312 WAGNER, ROBERT J.  
INSPTR 1135 SO 32  
DB LINCOLN, NEBR. 68510

72  
LEGA  
DAVIS SECOND ADD BLOCK 1  
LOT 5  
DAV2

SECTION 1-1

SEQUENCE 919

LOCATION 1135 SO 32

0561321 CROUGH, RUTH L.  
INSPTR 1145 SO 32  
DB LINCOLN, NEBR. 68510

DAVIS SECOND ADD BLOCK 1  
LOT 6

SECTION 1-1

SEQUENCE 920

LOCATION 1145 SO 32

0528188 RICHTER, GREG & CHERYL R  
INSPTR 3135 C ST  
DB LINCOLN NEBR 68510

CITY PARK ADD SUB B3 L1 EX  
W5' E1/2  
CIPA

SECTION 1-1

SEQUENCE 923

LOCATION 3135 C ST

0476877 SMITH, GREGORY T & ROBIN C  
INSPTR 1228 SO 32  
DB LINCOLN, NE 68510

BICKERTS SUB BLK 2 CITY  
PARK ADD S 50'  
LOT 12 & LOT 13

SECTION 1-1

SEQUENCE 924

LOCATION 1228 SO 32

0476986 LATVIAN EVANGELICAL LUTHERAN  
INSPTR CHURCH OF LINCOLN  
DB 3300 C  
LINCOLN, NE 68510

BICKERTS SUB BLK 2 CITY  
PARK ADD LOT 20

SECTION 1-1

SEQUENCE 925

LOCATION 3272 MOHAWK

0476790 IHRIE, LEROY C & LEILABETH H  
INSPTR 4100 VAN DORN  
DB LINCOLN, NE 68506

BICKERTS SUB BLKS 2 CITY  
PARK ADD N 1/2  
VAC ALLEY ADJ & LOT 3

SECTION 1-1

SEQUENCE 928

LOCATION 3269 C

SUBCIPA No BLK

6



TAX # <sup>73</sup> NAME AND ADDRESS  
0476811 RAFFETY, CALVIN R & MARIAN F  
INSPTR 3253 C  
DB LINCOLN, NEBR. 68510

LEGAL  
BICKERTS SUB BLK 2 CITY  
PARK ADD 1/2 VAC  
ALLEY ADJ & LOT 5

73

*sub 2 C1PA*

SECTION 1-1

SEQUENCE 930 LOCATION 3253 C

0528145 PETERSEN, GLYNDA W FINLEY  
INSPTR 7815 SYCAMORE  
DB LINCOLN, NE 68506

CITY PARKBLOCK 1 LOT 24

*C1PA*

SECTION 1-1

SEQUENCE 932 LOCATION 3274 C

0528137 THOMAS, FLOYD G & MARILYN A  
INSPTR 3266 C STREET  
DB LINCOLN, NEBR. 68510

CITY PARKBLOCK 1 LOT 23

SECTION 1-1

SEQUENCE 933 LOCATION 3266 C STREET

0528064 REEVES, JAMES A & MARJORIE  
INSPTR 6001 SUMNER ST  
DB LINCOLN, NE 68506

CITY PARK BLK 1 LOT 15 E8'  
LOT 16 EX E2'

SECTION 1-1

SEQUENCE 937 LOCATION 3212-10 C

0528056 JENSEN, JOYCE L  
INSPTR 1138 SD 32  
DB LINCOLN, NE 68510

CITY PARK BLOCK 1 LOT 14 S  
71' LOT 15 S 71'  
OF W 36'

SECTION 1-1

SEQUENCE 938 LOCATION 3200 C

0527947 HOAG, GEORGE R  
INSPTR 1325 SD 35  
DB LINCOLN, NE 68510

CITY PARKBLOCK 1 LOT 4

SECTION 1-1

SEQUENCE 946 LOCATION 3267 D

*4*

TAX # 74 NAME AND ADDRESS  
0527912 RESINSER, GEORGE R & MARLENE  
INSPTR 1101 SO 33  
DB LINCOLN, NEBR. 68510

LEGAL 74  
CITY PARKBLOCK 1 LOT 1  
CIPA

SECTION 1-1

SEQUENCE 948

LOCATION 1101 SO 33

0528153 BROWN, DARRELL & NOREEN  
INSPTR 2003 LAKE  
DB LINCOLN, NE 68502

CITY PARKBLOCK 1 LOT 25 &  
26 N50'

SECTION 1-1

SEQUENCE 949

LOCATION 1125-27 SO 33RD

0596833 PARTSCH, JAMES P & LEONA M  
INSPTR 1333 CHAUTAUGUA  
DB LINCOLN, NE 68510

ELLENDALE BLOCK 02 LOT 6  
ELLENDALE

SECTION 1-1

SEQUENCE 952

LOCATION 1333 CHAUTAUGUA

0596957 DIAL-A-BOW INC  
INSPTR 3208 A  
DB LINCOLN, NE 68510

ELLENDALE BLOCK 02 LOT 18

SECTION 1-1

SEQUENCE 956

LOCATION 3208 A

0596663 DEPRIEST, RICHARD A  
INSPTR 1376 CHAUTAUGUA  
DB LINCOLN, NEBR. 68510

ELLENDALE BLOCK 01 LOT 20

SECTION 1-1

SEQUENCE 958

LOCATION 1376 CHAUTAUGUA

0596701 WINGATE, WAYNE A & LINDA  
INSPTR 720 C  
DB LINCOLN, NE 68502

ELLENDALE BLOCK 01 LOT 24

SECTION 1-1

SEQUENCE 960

LOCATION 1350 CHAUTAUGUA

TAX # <sup>75</sup> NAME AND ADDRESS  
0596744 HEINBIGNER, REINHOLD B &  
INSPTR BETTY J  
DB 1328 CHAUTAUGUA  
LINCOLN, NEBR. 68510  
SECTION 1-1

LEGAL <sup>75</sup>  
ELLENDALE BLOCK 01 LOT 28  
ELLENDALE

SEQUENCE 963

LOCATION 1328 CHAUTAUGUA

0596507 BAUER, STEVEN M ET AL  
INSPTR 1309 SD 33  
DB LINCOLN, NE 68510

ELLENDALE L2 & S2FT L1 B1

SECTION 1-1

SEQUENCE 965

LOCATION 1309 SD 33

0596523 RIZIJS, VILIS & LINDA  
INSPTR 6801 ALMIRA LN  
DB LINCOLN, NE 68516

ELLENDALE BLOCK 01 LOT 4

SECTION 1-1

SEQUENCE 966

LOCATION 1321 SD 33RD

0596540 CORNELIUS, LAVERN C & DARLENE R  
INSPTR 3819 EMILINE  
DB OMAHA NEBR 68147

ELLENDALE BLOCK 01 LOT 8

SECTION 1-1

SEQUENCE 967

LOCATION 1345 SD 33RD

0596574 CULLIGAN WATER CONDITIONING  
INSPTR INC  
DB 1371 SD 33  
LINCOLN, NEBR. 68510

ELLENDALE BLOCK 01 LOT 11

SECTION 1-1

SEQUENCE 968

LOCATION 1359 SD 33RD

0596582 CULLIGAN WATERCOND. INC.  
INSPTR 1371 SD 33  
DB LINCOLN, NE 68510

ELLENDALE BLOCK 01 LOT 12  
(EX 510' W12')

SECTION 1-1

SEQUENCE 969

LOCATION 1371 SD 33

9

TAX # <sup>76</sup>  
0596621 WHITEHEAD OIL CO  
INSPTR % WHITEHEAD OIL  
DB 2537 RANDOLPH  
LINCOLN, NE 68510

LEGAL  
ELLENDALE BLOCK 01 LOT  
14&15 N88 & ALL 16

76

SECTION 1-1

ELLENDALE

SEQUENCE 970

LOCATION 1379 SO 33RD

0485098 SWENSON, WM. L. & PAMELA S.  
INSPTR 1301 SO 35  
DB LINCOLN, NEBR. 68510

BLVD HTS SUB L50 IN 30-10-7  
& PALMER PLACE:  
LOT 136&137 N88 2/3'

SECTION 1-1

BOUHE

NO  
BIK

SEQUENCE 971

LOCATION 1301 SO 35

0485144 KADLICK, ARWILLA  
INSPTR 3411 MOHAWK  
DB LINCOLN, NE 68510

BLVD HTS SUB L50 IN 30-10-7  
& PALMER PLACE:  
LOT 141

SECTION 1-1

SEQUENCE 973

LOCATION 3411 MOHAWK

0485209 HAMPTON, ROBERT D & PAMELA S  
INSPTR 7501 NO HAMPTON RD  
DB LINCOLN, NE 68506

BLVD HTS SUB L50 IN 30-10-7  
& PALMER PLACE:  
LOT 148 W30' LOT 149 E 1/2

SECTION 1-1

SEQUENCE 975

LOCATION 3315-17 MOHAWK

0485217 BEIL, LORRAINE H  
INSPTR 3301 MOHAWK  
DB LINCOLN, NEBR. 68510

BLVD HTS SUB L50 IN 30-10-7  
& PALMER PLACE:  
LOT 149 W HALF LOT 150

SECTION 1-1

SEQUENCE 976

LOCATION 3301 MOHAWK

0485683 HOBELMAN, BRUCE & DEBORAH  
INSPTR 1351 SO 35  
DB LINCOLN, NE 68510

BLVD HTS SUB L50 IN 30-10-7  
& PALMER PLACE:  
LOT 196 & 197 N HALF

SECTION 1-1

SEQUENCE 985

LOCATION 1351 SO 35

60

TAX # 77 NAME AND ADDRESS  
0485691 KUNDZINS, PAUL M  
INSPTR 1365 SD 35  
DB LINCOLN, NEBR. 68510

LEGAL 77  
BLVD HTS SUB L50 IN 30-10-7  
& PALMER PLACE:  
LOT 196 & 197 S HALF

SECTION 1-1

BOUHE

SEQUENCE 986

LOCATION 1365 SD 35

0484679 MORELAND, DENNIS R & LINDA L  
INSPTR 3300 MOHAWK  
DB LINCOLN, NE 68510

BLVD HTS SUB L50 IN 30-10-7  
& PALMER PLACE:  
LOT 91

SECTION 1-1

SEQUENCE 987

LOCATION 3300 MOHAWK

0484695 BEDELL, DOUGLAS E & VICKY K  
INSPTR 3316 MOHAWK  
DB LINCOLN, NE 68510

BLVD HTS SUB L50 IN 30-10-7  
& PALMER PLACE:  
E1/2 LOT 92 & ALL LOT 93

SECTION 1-1

SEQUENCE 988

LOCATION 3316 MOHAWK

0484709 BENNETT, JORIE C & DELORES  
INSPTR BOX 30097  
DB LINCOLN, NE 68503

BLVD HTS SUB L50 IN 30-10-7  
& PALMER PLACE:  
LOT 94

SECTION 1-1

SEQUENCE 989

LOCATION 3324 MOHAWK

0484717 TREFFER, CYNTHIA A  
INSPTR 3330 MOHAWK  
DB LINCOLN, NE 68510

BLVD HTS SUB L50 IN 30-10-7  
& PALMER PLACE:  
LOT 95

SECTION 1-1

SEQUENCE 990

LOCATION 3330 MOHAWK

0484768 TUPE, JANIS J & JEANETTE M  
INSPTR 3414 MOHAWK  
DB LINCOLN, NEBR. 68510

BLVD HTS SUB L50 IN 30-10-7  
& PALMER PLACE:  
LOT 100

SECTION 1-1

SEQUENCE 991

LOCATION 3414 MOHAWK

TAX # 74 NAME AND ADDRESS  
0484776 WDMONTREE, MICHELE  
INSPTR ROUTE 1 BOX 139  
DB NEBO, IL 62355

LEGAL  
BLVD HTS SUB L50 IN 30-10-7  
& PALMER PLACE:  
LOT 101

75

BOUHE

SECTION 1-1

SEQUENCE 992

LOCATION 3420 MOHAWK

0484792 DAYTON, THOMAS L & VALERIE J  
INSPTR 2424 "T" STREET  
DB LINCOLN, NE 68508

BLVD HTS SUB L50 IN 30-10-7  
& PALMER PLACE:  
LOT 103

SECTION 1-1

SEQUENCE 993

LOCATION 3432 MOHAWK

0484814 BELDIN, HELEN ET AL  
INSPTR 1235 SOUTH 35TH ST  
DB LINCOLN, NE. 68510

BLVD HTS SUB L50 IN 30-10-7  
& PALMER PLACE:  
LOT 104 & 105 S HALF

SECTION 1-1

SEQUENCE 994

LOCATION 1235 SOUTH 35TH ST

0484539 HEALEY, ALICE PEARL  
INSPTR % UNION BANK - TRUST DEPT  
DB PO BOX 6155  
LINCOLN, NE 68506

BLVD HTS SUB L50 IN 30-10-7  
& PALMER PLACE:  
LOT 76 & 77 S HALF

SECTION 1-1

SEQUENCE 996

LOCATION 1217 SO 35TH

0484644 IHRIE, LEILABETH & TAYS, MARILYN  
INSPTR % IHRIE, DAVID & RHONDA-CONT  
DB 3315-17 C ST  
LINCOLN, NE 68510

BLVD HTS SUB L50 IN 30-10-7  
& PALMER PLACE:  
LOT 88

SECTION 1-1

SEQUENCE 998

LOCATION 3315-17 C

0484636 IHRIE, STEVEN A  
INSPTR 3321 C STREET  
DB LINCOLN, NEBR. 68510

BLVD HTS SUB L50 IN 30-10-7  
& PALMER PLACE:  
LOT 87

SECTION 1-1

SEQUENCE 999

LOCATION 3321 C STREET

6

TAX # 79 NAME AND ADDRESS  
0484555 BUSH, KARIN R  
INSPTR 3427 C  
DB LINCOLN, NE 68510

LEGA 79  
BLVD HTS SUB L50 IN 30-10-7  
& PALMER PLACE:  
LOT 79

SECTION 1-1

BOUHE

SEQUENCE 1004

LOCATION 3427 C

0485934 MURPHY, MARY ET AL  
INSPTR 900 S 50  
DB LINCOLN, NEBR. 68510

BLVD HTS SUB L50 IN 30-10-7  
& PALMER PLACE:  
LOT 224 E10' OF S 80' L 225  
S 80'

SECTION 1-1

SEQUENCE 1006

LOCATION 1385 SO 35TH

0485535 HANK, LARRY A & CARRIE L  
INSPTR 1365 SO 37  
DB LINCOLN, NEBR. 68510

BLVD HTS SUB L50 IN 30-10-7  
& PALMER PLACE:  
LOT 181 & 182 S 68 1/2'

SECTION 1-1

SEQUENCE 1012

LOCATION 1365 SO 37

0485527 LAUDOMER, RODNEY & KATHY  
INSPTR 1351 SO 37  
DB LINCOLN, NE 68510

BLVD HTS SUB L50 IN 30-10-7  
& PALMER PLACE:  
LOT 181 & 182 N64 1/2'

SECTION 1-1

SEQUENCE 1013

LOCATION 1351 SO 37

0485543 LUEDTKE, RICKI R & CONNIE L  
INSPTR 3621 B STREET  
DB LINCOLN, NEBR. 68510

BLVD HTS SUB L50 IN 30-10-7  
& PALMER PLACE:  
LOT 183

SECTION 1-1

SEQUENCE 1014

LOCATION 3621 B STREET

0485608 WHITE, ELEANOR E  
INSPTR % GABER, TERRY & JANET (CONT)  
DB 7500 SOUTH #13  
LINCOLN, NE 68506

BLVD HTS SUB L50 IN 30-10-7  
& PALMER PLACE:  
L189 EX TRI ALONG E SIDE

SECTION 1-1

SEQUENCE 1020

LOCATION 3541 B

6

TAX # 80  
0485624 NAME AND ADDRESS  
WHITNEY, FRANCIS E. EDNA M  
INSPTR 3529 B  
DB LINCOLN, NE 68510

LEGA 50  
BLVD HTS SUB L50 IN 30-10-7  
& PALMER PLACE:  
LOT 191

SECTION 1-1

BOUHE

SEQUENCE 1022 LOCATION 3529 B

0485632 SCHWARTZ, HARRY C  
INSPTR 3525 B  
DB LINCOLN, NE. 68510

BLVD HTS SUB L50 IN 30-10-7  
& PALMER PLACE:  
LOT 192

SECTION 1-1

SEQUENCE 1023 LOCATION 3525 B

0485641 SCHUTZ, WILFRED M & JUDITH  
INSPTR 3515 B ST  
DB LINCOLN, NEBR. 68510

BLVD HTS SUB L50 IN 30-10-7  
& PALMER PLACE:  
LOT 193

SECTION 1-1

SEQUENCE 1024 LOCATION 3515 B ST

0485667 GOLDBERG, MARILYN A  
INSPTR 3175 WOODSDALE BLV  
DB LINCOLN, NE 68502

BLVD HTS SUB L50 IN 30-10-7  
& PALMER PLACE:  
LOT 195 N71

SECTION 1-1

SEQUENCE 1025 LOCATION 1350 80 35TH

0485969 VISSER, EARL W  
INSPTR RR 1 BOX 136  
DB EAGLE, NE 68347

BLVD HTS SUB L50 IN 30-10-7  
& PALMER PLACE:  
LOT 227

SECTION 1-1

SEQUENCE 1027 LOCATION 3510 A

0485977 LINGLE, RONALD L. TRUSTEE  
INSPTR 3858 STEELE AVE  
DB LINCOLN, NE 68510

BLVD HTS SUB L50 IN 30-10-7  
& PALMER PLACE:  
LOT 228

SECTION 1-1

SEQUENCE 1028 LOCATION 3514 A

BLOCK  
CODE  
CHECKED  
ENTERED  
EDITED

CASTLE COUNTY, NEBR.  
Dan Gallo  
REGISTER OF DEEDS

90 JUL 26 AM 8:53

ENTERED ON  
NUMERICAL INDEX  
FILED FOR RECORDS

INST. NO. 90- 22751

\$625<sup>00</sup>

Hold  
City Clerk  
ATG  
gou