

# ADAMS COUNTY ASSESSOR

Assessor Hub provided by Vanguard Appraisals, Inc 

**Parcel Number:** 010006693  
**Computer ID:** 3765-18-4-1325.20-000-0009  
**Deed Holder:** COX LINDA K  
**Property Address:** 111 E H ST  
**Mailing Address:** 111 EAST H STREET  
 HASTINGS, NE 68901-0000 USA  
**Status:** IMPROVED  
**Use:** SINGLE FAMILY  
**Zoning:** SINGLE FAMILY  
**Location:** URBAN  
**City Size:** 12,001 - 100,000  
**Lot Size:** 1 SF - 10,000 SF  
**Map Area:** 1001 SOUTH HASTINGS  
**Plat Map:** 6-42  
**Subdivision:** 1325.20-SOUTHWOOD 2ND ADD REPLAT PT BLK 2 MISSOURI PACIFIC ADD  
**Sec-Twp-Rng:** -07-09  
**Lot-Block:** 9-2  
**Assessor Location:** HASTINGS  
**Legal Description:** 1325.20-LOT 9 BLOCK 2 SOUTHWOOD 2ND ADDITION (1210) 0.22 AC  
 (NOT TO BE USED ON LEGAL DOCUMENTS)  
**Property Report:** [PROPERTY REPORT \(PDF FILE\)](#)



Pin 010006693 Photo

1 / 1



### Taxing Districts

District	Description	Levy
Ag Society	AG SOCIETY	0.017840
CRA	HASTINGS CRA	0.025998
City or Village	HASTINGS	0.449687
Community College	CCC GENERAL	0.095956
County	COUNTY GENERAL	0.264723
ESU	ESU 9	0.015000
Fire	NONE	0.000000
Library	NONE	0.000000
NRD	NRD 2 LITTLE BLUE	0.019815
SID	NONE	0.000000
School Bonds	HASTINGS 18 BOND	0.240000
School Districts	HASTINGS 18 (01-0018)	1.102000
TIF	NONE	0.000000

Townships	NONE	0.000000
Master	ES9 NR2 SD18 CRA HASTINGS 01-018	2.231019

**Current Value Information**

<b>Land Value</b>	<b>Dwelling Value</b>	<b>Improvement Value</b>	<b>Total Value</b>
\$14,192	\$89,915	\$0	\$104,107

**Tax Information**

<b>Taxable Value</b>	<b>Exempt Value</b>	<b>Net Taxable Value</b>	<b>Levy</b>	<b>Gross Tax</b>	<b>Homestead Loss</b>	<b>Ag Land Tax Credit</b>	<b>Used Tax Credit</b>	<b>Net Tax</b>
\$104,107	\$0	\$104,107	2.231019	\$2,322.66	\$0.00	\$0.00	\$90.06	\$2,232.60

NOTE: Tax amounts do not necessarily reflect official values and are subject to change based on exemption and levy rate changes.  
 Please click link below for accurate Tax Information  
[Get Official Taxes](#)

**Prior Year Value Information**

Year	Land	Dwelling Value	Improvement Value	Total Value
2019	\$14,192	\$89,915	\$0	\$104,107
2018	\$8,295	\$89,915	\$0	\$98,210
▼ More Years...				

**Land Information**

<b>Lot Type</b>	<b>Square Feet</b>	<b>Acres</b>
Sq. Ft x Rate	9,590	0.220

**Residential Building Information**

<b>Occupancy</b>	<b>Style</b>	<b>Year Built</b>	<b>Total Living Area</b>
▼ Single-Family / Owner Occupied	1 Story Frame	2002	1,056

**Yard Extra Information**

<b>Description</b>	<b>Item Count</b>	<b>Year Built</b>
▼ A Misc. Extra	1	2002
▼ Paving - Concrete	1	1900

**Sale Information**

<b>Sale Date</b>	<b>Amount</b>	<b>Non-Useable Transaction Code</b>	<b>Recording</b>
▼ 02/26/2002	\$81,593	00 - GOOD SALE	2002 ~1125

Sketch

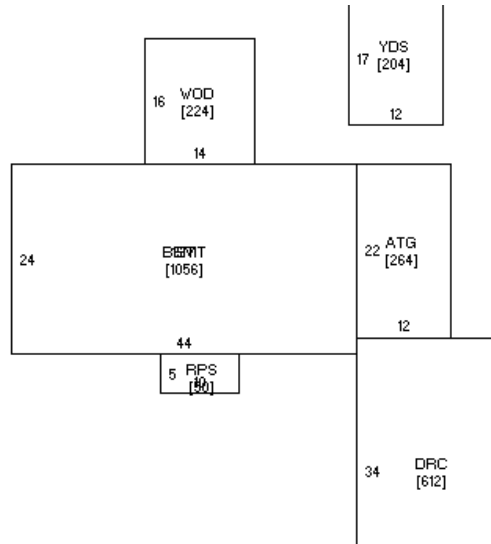

Sketch of Pin 010006693

1 / 1

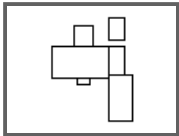

GIS Map Information

**Land Use GIS Website**

By Shape By Value By Spatial Results

Features selected: 1

**Parcel ID: 010006693**  
 Owner Name: COX LINDA K  
 Property Address: 111 E H ST  
[Assessor Information](#)  
[Tax Information](#)  
[Deed Information](#)

The map displays several land parcels with the following details:

- Parcel 1 (Selected):** Parcel ID 010006693, Owner: COX LINDA K, Address: 111 E H ST. Dimensions: 70' x 111'.
- Parcel 2:** Dimensions: 70' x 111'.
- Parcel 3:** Dimensions: 70' x 111'.
- Parcel 4:** Dimensions: 70' x 111'.
- Parcel 5:** Dimensions: 70' x 111'.
- Parcel 6:** Dimensions: 70' x 111'.
- Parcel 7:** Dimensions: 70' x 111'.
- Parcel 8:** Dimensions: 70' x 111'.
- Parcel 9:** Dimensions: 70' x 111'.
- Parcel 10:** Dimensions: 70' x 111'.
- Parcel 11:** Dimensions: 70' x 111'.
- Parcel 12:** Dimensions: 70' x 111'.
- Parcel 13:** Dimensions: 70' x 111'.
- Parcel 14:** Dimensions: 70' x 111'.
- Parcel 15:** Dimensions: 70' x 111'.
- Parcel 16:** Dimensions: 70' x 111'.
- Parcel 17:** Dimensions: 70' x 111'.
- Parcel 18:** Dimensions: 70' x 111'.
- Parcel 19:** Dimensions: 70' x 111'.
- Parcel 20:** Dimensions: 70' x 111'.
- Parcel 21:** Dimensions: 70' x 111'.
- Parcel 22:** Dimensions: 70' x 111'.
- Parcel 23:** Dimensions: 70' x 111'.
- Parcel 24:** Dimensions: 70' x 111'.
- Parcel 25:** Dimensions: 70' x 111'.
- Parcel 26:** Dimensions: 70' x 111'.
- Parcel 27:** Dimensions: 70' x 111'.
- Parcel 28:** Dimensions: 70' x 111'.
- Parcel 29:** Dimensions: 70' x 111'.
- Parcel 30:** Dimensions: 70' x 111'.
- Parcel 31:** Dimensions: 70' x 111'.
- Parcel 32:** Dimensions: 70' x 111'.
- Parcel 33:** Dimensions: 70' x 111'.
- Parcel 34:** Dimensions: 70' x 111'.
- Parcel 35:** Dimensions: 70' x 111'.
- Parcel 36:** Dimensions: 70' x 111'.
- Parcel 37:** Dimensions: 70' x 111'.
- Parcel 38:** Dimensions: 70' x 111'.
- Parcel 39:** Dimensions: 70' x 111'.
- Parcel 40:** Dimensions: 70' x 111'.
- Parcel 41:** Dimensions: 70' x 111'.
- Parcel 42:** Dimensions: 70' x 111'.
- Parcel 43:** Dimensions: 70' x 111'.
- Parcel 44:** Dimensions: 70' x 111'.
- Parcel 45:** Dimensions: 70' x 111'.
- Parcel 46:** Dimensions: 70' x 111'.
- Parcel 47:** Dimensions: 70' x 111'.
- Parcel 48:** Dimensions: 70' x 111'.
- Parcel 49:** Dimensions: 70' x 111'.
- Parcel 50:** Dimensions: 70' x 111'.
- Parcel 51:** Dimensions: 70' x 111'.
- Parcel 52:** Dimensions: 70' x 111'.
- Parcel 53:** Dimensions: 70' x 111'.
- Parcel 54:** Dimensions: 70' x 111'.
- Parcel 55:** Dimensions: 70' x 111'.
- Parcel 56:** Dimensions: 70' x 111'.
- Parcel 57:** Dimensions: 70' x 111'.
- Parcel 58:** Dimensions: 70' x 111'.
- Parcel 59:** Dimensions: 70' x 111'.
- Parcel 60:** Dimensions: 70' x 111'.
- Parcel 61:** Dimensions: 70' x 111'.
- Parcel 62:** Dimensions: 70' x 111'.
- Parcel 63:** Dimensions: 70' x 111'.
- Parcel 64:** Dimensions: 70' x 111'.
- Parcel 65:** Dimensions: 70' x 111'.
- Parcel 66:** Dimensions: 70' x 111'.
- Parcel 67:** Dimensions: 70' x 111'.
- Parcel 68:** Dimensions: 70' x 111'.
- Parcel 69:** Dimensions: 70' x 111'.
- Parcel 70:** Dimensions: 70' x 111'.
- Parcel 71:** Dimensions: 70' x 111'.
- Parcel 72:** Dimensions: 70' x 111'.
- Parcel 73:** Dimensions: 70' x 111'.
- Parcel 74:** Dimensions: 70' x 111'.
- Parcel 75:** Dimensions: 70' x 111'.
- Parcel 76:** Dimensions: 70' x 111'.
- Parcel 77:** Dimensions: 70' x 111'.
- Parcel 78:** Dimensions: 70' x 111'.
- Parcel 79:** Dimensions: 70' x 111'.
- Parcel 80:** Dimensions: 70' x 111'.
- Parcel 81:** Dimensions: 70' x 111'.
- Parcel 82:** Dimensions: 70' x 111'.
- Parcel 83:** Dimensions: 70' x 111'.
- Parcel 84:** Dimensions: 70' x 111'.
- Parcel 85:** Dimensions: 70' x 111'.
- Parcel 86:** Dimensions: 70' x 111'.
- Parcel 87:** Dimensions: 70' x 111'.
- Parcel 88:** Dimensions: 70' x 111'.
- Parcel 89:** Dimensions: 70' x 111'.
- Parcel 90:** Dimensions: 70' x 111'.
- Parcel 91:** Dimensions: 70' x 111'.
- Parcel 92:** Dimensions: 70' x 111'.
- Parcel 93:** Dimensions: 70' x 111'.
- Parcel 94:** Dimensions: 70' x 111'.
- Parcel 95:** Dimensions: 70' x 111'.
- Parcel 96:** Dimensions: 70' x 111'.
- Parcel 97:** Dimensions: 70' x 111'.
- Parcel 98:** Dimensions: 70' x 111'.
- Parcel 99:** Dimensions: 70' x 111'.
- Parcel 100:** Dimensions: 70' x 111'.

**Tax Statement**

Served by WEBSERVER-2

**Adams County**

0 Step 4 of 8

<b>Perm ID</b> 010006693	<b>Name</b> COX LINDA K 111 EAST H STREET HASTINGS NE 68901-0000	<b>Legal</b> 1325.20-LOT 9 BLOCK 2 SOUTHWOOD 2ND ADDITION (1210) 0.22 AC 111 E H ST
-----------------------------	---	---

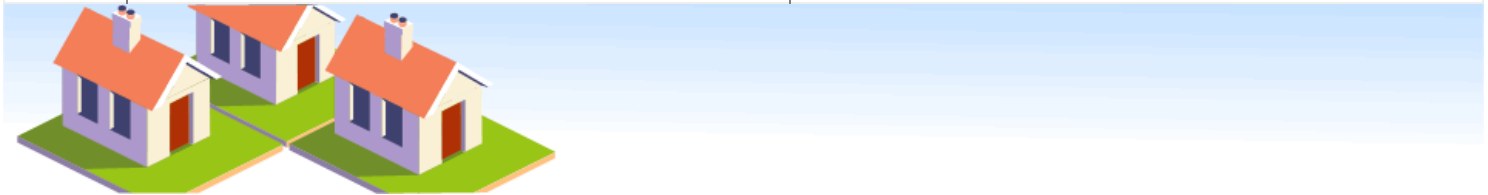

[Levy Graph](#)
[Value Graph](#)
[Tax Graph](#)

Year	Statement	Value	Tax	Exemption	Net Tax	Balance Due
2018	<a href="#">000046</a>	\$ 98,210	\$ 2,191.08	- \$ 84.96	\$ 2,106.12	\$ 0.00
2017	<a href="#">006361</a>	\$ 98,210	\$ 2,190.80	- \$ 86.38	\$ 2,104.42	\$ 0.00
2016	<a href="#">007240</a>	\$ 87,885	\$ 1,963.62	- \$ 78.72	\$ 1,884.90	\$ 0.00
2015	<a href="#">006383</a>	\$ 87,885	\$ 1,964.98	- \$ 82.70	\$ 1,882.28	\$ 0.00
2014	<a href="#">006415</a>	\$ 87,885	\$ 2,017.18	- \$ 62.88	\$ 1,954.30	\$ 0.00
2013	<a href="#">007200</a>	\$ 84,825	\$ 1,957.06	- \$ 55.96	\$ 1,901.10	\$ 0.00
2012	<a href="#">007142</a>	\$ 84,825	\$ 1,986.20	- \$ 60.66	\$ 1,925.54	\$ 0.00
2011	<a href="#">002716</a>	\$ 84,825	\$ 2,000.06	- \$ 63.88	\$ 1,936.18	\$ 0.00
2010	<a href="#">002769</a>	\$ 84,825	\$ 1,970.00	- \$ 66.94	\$ 1,903.06	\$ 0.00
2009	<a href="#">002732</a>	\$ 84,825	\$ 1,942.05	- \$ 69.74	\$ 1,872.31	\$ 0.00
2008	<a href="#">002769</a>	\$ 4,025	\$ 91.37	- \$ 3.47	\$ 87.90	\$ 0.00
2007	<a href="#">002756</a>	\$ 4,025	\$ 92.81	- \$ 3.35	\$ 89.46	\$ 0.00
2006	<a href="#">002657</a>	\$ 4,025	\$ 94.74	\$ 0.00	\$ 94.74	\$ 0.00
2005	<a href="#">002620</a>	\$ 4,025	\$ 95.39	\$ 0.00	\$ 95.39	\$ 0.00

The information provided in this site is the most recent and most accurate data available. All information contained herein is for informational purposes only. MIPS Inc does not warrant that such information is accurate and error free. This information is provided on an "as is" basis without warranties of any kind, either expressed or implied, including, but not limited to, the implied warranties of merchantability or fitness for a particular purpose. MIPS Inc shall not be liable for any direct, indirect, incidental, special or consequential damages arising out of the use of such information or the inability to use such information. MIPS also is not, nor shall be party to or subject to any warranty or any breach of any kind. The User acknowledges and agrees that the use of such information is at the sole risk of the User.

Copyright © 2004 Nebraska Association of County Officials. All rights reserved.