

WOODS BROS. LAKEVIEW ACRES

S. 1/2 S.E. 1/4 SEC. 21-10-6 LANCASTER CO. NEBRASKA.

SCALE 1"=200'

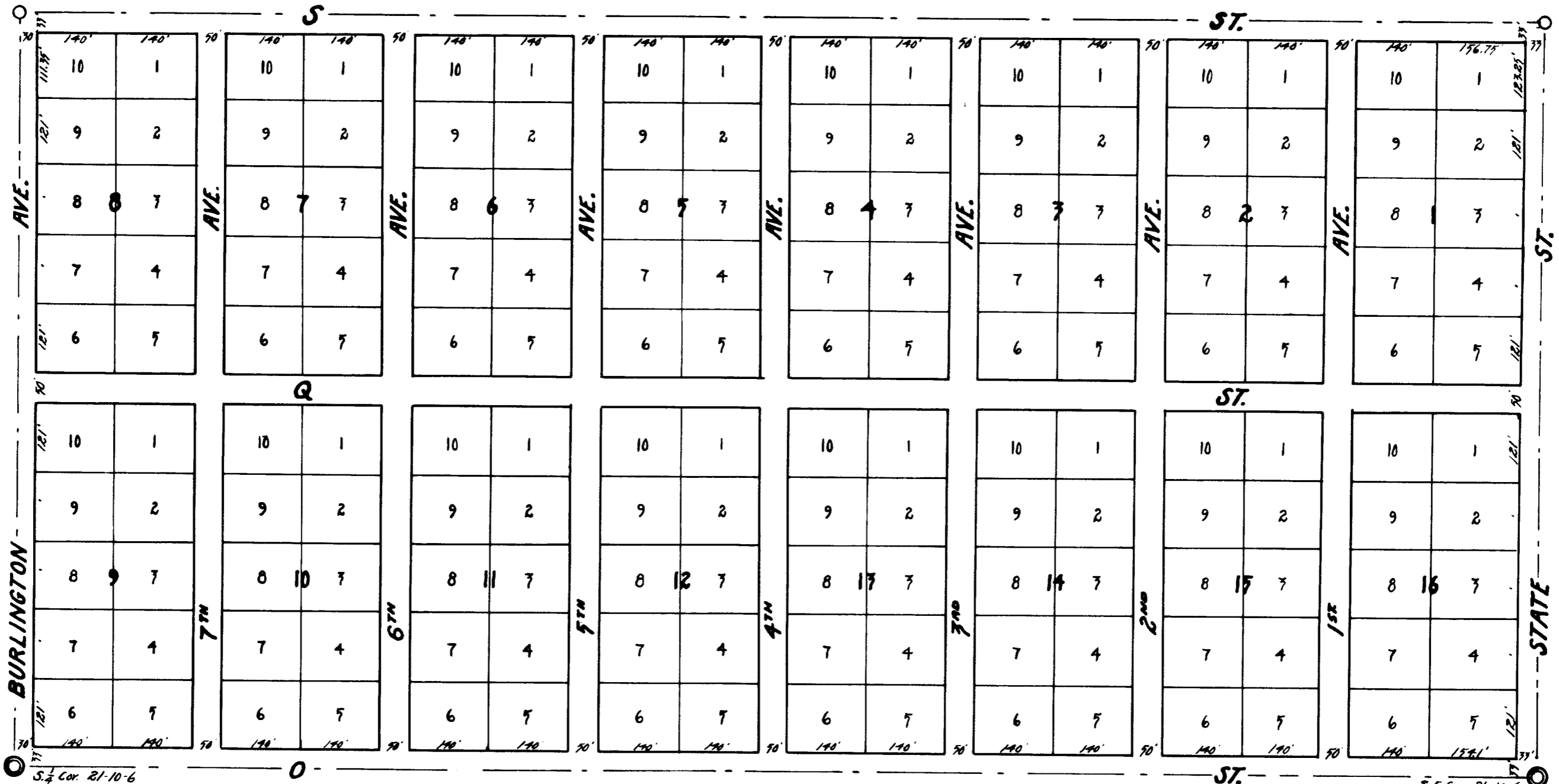

DEDICATION

The above subdivision of the South half of the Southeast Quarter of Section 21-10-6 E. of the 6th P.M. in Lancaster County, Nebraska, and the platting of the same as "WOODS BROS. LAKEVIEW ACRES", is with the free consent and in accordance with the desires of the undersigned owners and proprietors thereof, and the streets shown thereon are hereby dedicated to the public.

Witness our hands this 25th day of April, 1925.

L. F. Schroeder
WITNESS

Paul H. Holm
Maudie H. Holm
TRUSTEES FOR John W. McDonald Estate.

Paul H. Holm
William M. Leonard
Frederick W. Houtz
TRUSTEES

ACKNOWLEDGEMENT

State of Nebraska } ss.
Lancaster County }

On this 25th day of April, 1925, before me a NOTARY PUBLIC, duly commissioned and qualified for and residing in said County, personally came Paul H. Holm and Maudie H. Holm, his wife, as individuals, and Paul H. Holm, William M. Leonard and Frederick W. Houtz, as trustees, for and in behalf of the estate of John W. McDonald, deceased, to me known to be the identical persons whose names are affixed to the annexed instrument and acknowledged the same to be their voluntary act and deed.

Witness my hand and Notarial Seal on the day and year last above written.

My commission expires
May 20-1930.

L. F. Schroeder
NOTARY PUBLIC

25th April 25
3 P 35

SURVEYOR'S CERTIFICATE

I hereby certify that I have carefully and accurately staked off into lots and streets the above plat of "WOODS BROS. LAKEVIEW ACRES". Iron stakes are set at all lot corners.

April 20, 1925.

W. M. Aert
SURVEYOR

J. B. Wheeler
By J. B. Wheeler
Fee \$ 3.00