

Ind. Rec. Camp FILED NO. 2754
BOOK 10 PAGE 353-5
Miscellaneous
1967 DEC 15 PM 1:43
Mertie H. Huber
MERTIE H. HUBER
RECORDER
KOSSUTH COUNTY, IOWA 3.50

File: 13-8-2
Permit Number 2-342
Kossuth County
Project P-6

IOWA STATE HIGHWAY COMMISSION

Application for Permit to Construct Entrance from Private Property
to Primary Road or Primary Road Extension

Applicant Algona Industrial Development Corporation
(Owner or Owners of Record)
Address Algona, Iowa Date December 7
Iowa State Highway Commission
Des Moines, Iowa (Date)
Attorneys:

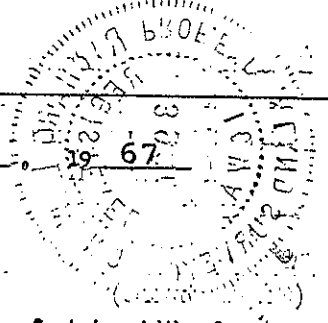

A permit is hereby requested to construct a Type "B" entrance 45 feet in width, from
right of way line to primary road traveled way, including necessary drainage structure thereunder.
(Residential, etc.)

PLAT OF ENTRANCE AS PROPOSED TO BE CONSTRUCTED IS ATTACHED
TO AND IS A PART OF THIS APPLICATION. (Marked Exhibit "A")

Proposed entrance is located on Primary Road No. 18, Sec. 36, T. 96N, R. 29W, Kossuth
County, 1.0 Miles east from U.S. 169 more specifically described as follows:
(Direction) (Place, Town, or object)
at Sta. 658+50, north side. Entrance is 2298 ft. east of the S. W. corner
of Sec. 36-T96N-R29W.

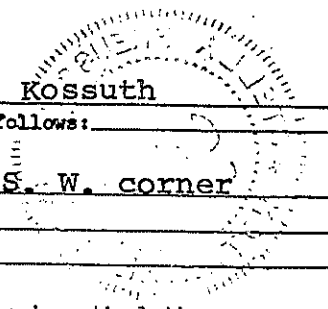

The applicant agrees that if granted a permit to construct the above described entrance the following stipulations shall govern.

1. Written approval of the Highway Commission shall be obtained before any change is made in the entrance or its location.
2. That the entrance, including drainage structure, grading and surfacing, shall be constructed by the applicant at the applicant's expense, in accordance with the plat attached hereto, and in conformity with the standard specifications of the Iowa State Highway Commission, and shall thereafter be kept in repair and maintained by the applicant at his own expense. Nothing in this stipulation, however, shall preclude the Iowa State Highway Commission from entering upon said entrance on highway right of way and performing necessary maintenance for the protection of the highway.
3. That the construction, of the entrance shall be completed by the 1st day of October, 19 67.
(The permit is null and void if drive is not completed by the above date unless extension of time is granted in writing by the Iowa State Highway Commission.)
4. That the construction, future repair or maintenance of said entrance shall be carried on in such a way as not to interfere with, or interrupt traffic on said highway, and the applicant shall take all reasonable precautions to protect and safeguard the lives and property of any person or persons, and shall save the State and State Highway Commission harmless of any damage or losses that may be sustained by any person or persons, on account of such construction, repair or maintenance operations.
5. That no filling will be permitted in the right of way of primary road No. U. S. 18 other than that necessary to construct the entrance at Station 658+50, Project P-6.
6. That the culvert pipe under the entrance shall be zinc coated corrugated metal or 1500D concrete pipe. It shall be 24 inches in diameter and 58 feet in length as shown on attached sketch, and of quality complying with Sec. 41 and Sec. 4145 of the Iowa State Highway Commission Standard Specifications, Series of 1964. The pipe shall be installed at the elevation specified by the engineer.
7. The finished surface elevation of the driveway over the pipe or place where the pipe would normally be, shall be 5 inches lower than shoulder elevation at Station 658+50 to prevent water draining onto the pavement or travel way.
7. That the applicant agrees to give the State Highway Commission forty-eight hours notice of his intention to start construction on the highway right of way. Said notice shall be made in writing to the person whose name is shown below.

STRA

8. That all provisions herein relating to future repair or maintenance shall be binding on all successors or assigns the applicant.

9. This permit renders Permit No. 2-132 Null and void. Existing field entrance at Sta. 661+45, north side (near east property line) is to be eliminated.

APPLICANTS ATTENTION is directed to the fact that property may not be used so as to obstruct or encumber the public highway right way.

Certificate -

I hereby certify that this sketch was prepared by me or under my direct personal supervision and that I am a fully registered professional engineer under the laws of the State of Iowa.

Algona Industrial
Signed Development Corporation
(Applicant)
By [Signature]
(Title)
Algona, Iowa
(Address)

(Signature) [Signature] Iowa Reg.
Date 12-12 1967 No. 3980

ACKNOWLEDGEMENT

STELLA PREUSCH
Notary Public in and for Iowa
Koch County

On this 11 day of Dec A.D. 1967 before me Stella Preusch, a Notary Public in and for said County, State of Iowa, personally appeared [Signature] and [Signature] to be known to be the person(s), named in and who executed the foregoing instrument, and acknowledged that Mr. Cook executed the same as a voluntary act and deed.

[Signature]
Notary Public in and for Said County

Recommended for Approval:
[Signature]
Assistant Maintenance Engineer
Richard L. Wing

Recommended for Approval:
City Clerk

Permit Granted
December 14 19 67
Iowa State Highway Commission

Outside Corporate Limits
Mayor or Other _____ Title _____
Authorized Official

by Archie P. Christensen
District Engineer
Maint. Archie P. Christensen
Notice of date construction is to start shall be sent by applicant to
Donald Christensen
Address

None in effect
County Zoning Officer _____ Date _____
Algona, Iowa
Address

(Four copies of the application and plat must be filed with the State Highway Commission at Ames, Iowa. If entrance requested is within a city or town five copies of application and plat are required.)

NOTATION OF RECORD

Filed for Record on the _____ day of _____, A.D. 19____, at _____ o'clock _____ M., and Recorded in Book _____ of _____, on Page _____.

Form 534

IOWA STATE HIGHWAY COMMISSION

No. 2-342

ACCESS PLAT

County Kossuth

Project No. P-6

SPECIAL PUBLIC ROAD CONNECTION
(Access Rights Acquired).

CHECK

PRIVATE PROPERTY ENTRANCE
(Access Rights NOT Acquired)
EXHIBIT "A"

Attach to Form 536

Attach to Form 559

Location Description: Primary Road No. 18, Sec. 36, T. 96N, R. 29W,

Kossuth County, 1.0 Miles east from U.S. 169

more specifically described as follows: at Sta. 658+50, north side.

Entrance is 2298 ft. east of the S.W. corner of Sec. 36-T96N-R29W

SKETCH MAP (Show intersection, entrance and property line details and dimensions)

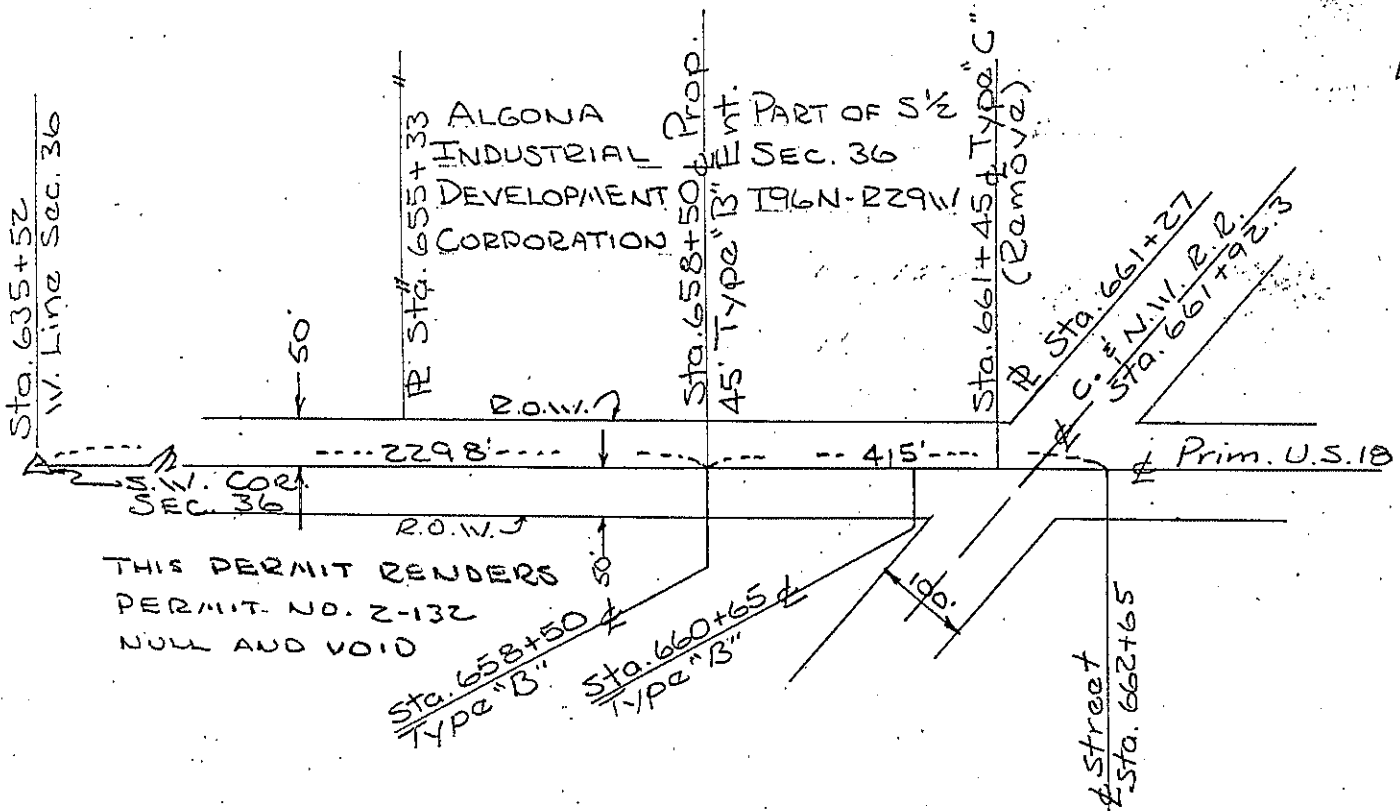

THIS PERMIT RENDERS
PERMIT NO. 2-132
NULL AND VOID

CLASS III - FRINGE
SPEED LIMIT:
EAST BOUND - 45 M.P.H.
WEST BOUND - 70 M.P.H.
SIGHT DISTANCE:
WEST - 800 FT.
EAST - 950 FT.

PROPOSED 45 FT. TYPE "B"
ENTRANCE BY:
ALGONA INDUSTRIAL
DEVELOPMENT CORPORATION
STA. 658+50 PROJ. P-6
U.S. 18 KOSSUTH CO.

SCALE 1"=200'

NOTE: The sketch shall include section of road of sufficient length to show the existing public roads on both sides and location of all accesses within the area which have previously been approved, including all special road connections.

CERTIFICATION

I hereby certify that this sketch was prepared by me or under my direct personal supervision and that I am a

APPLICANT

Name Algona Industrial Development Corp.

By [Signature]

