

2001-30163

EA CONSULTING GROUP, INC.  
PLANNERS SURVEYORS ENGINEERS

Country: USA  
Verify: [Signature]  
P: [Signature]  
D: [Signature]  
Fee \$ 1650  
OK X Cash [ ] [ ]

# NORTHBRIDGE ESTATES

LOTS 17 THROUGH 201 INCLUSIVE & OUTLOT "A"  
SECTION 31, TOWNSHIP 30N, RANGE 12E, COUNTY OF CHANDLER, MINNESOTA

9-16-2001 11:35 AM  
30163  
Northridge Estates  
30163

APPROVAL OF CHANDLER CITY COUNCIL  
The subdivision of NORTHBRIDGE ESTATES was approved by the Chandler City Council, City of Chandler, Minnesota, on the 16th day of September, 2001.

APPROVAL OF CHANDLER PLANNING COMMISSION  
The subdivision of NORTHBRIDGE ESTATES was approved by the Chandler Planning Commission, City of Chandler, Minnesota, on the 16th day of September, 2001.

REVIEW BY SANDY COUNTY SURVEYOR  
The plat of NORTHBRIDGE ESTATES was reviewed by the Sandy County Surveyor, Sandy County, Minnesota, on the 16th day of September, 2001.

APPROVAL OF NEBRASKA REGISTERED PROFESSIONAL SURVEYOR  
The subdivision of NORTHBRIDGE ESTATES was approved by the Nebraska Registered Professional Surveyor, Sandy County, Minnesota, on the 16th day of September, 2001.

ACKNOWLEDGMENT OF NOTARY  
I, Notary Public, do hereby certify that the above described plat of NORTHBRIDGE ESTATES was approved by the Chandler City Council, City of Chandler, Minnesota, on the 16th day of September, 2001.

ACKNOWLEDGMENT OF NEBRASKA REGISTERED PROFESSIONAL SURVEYOR  
I, Notary Public, do hereby certify that the above described plat of NORTHBRIDGE ESTATES was approved by the Nebraska Registered Professional Surveyor, Sandy County, Minnesota, on the 16th day of September, 2001.

WITNESS MY HAND AND SEAL OF OFFICE  
I, Notary Public, do hereby certify that the above described plat of NORTHBRIDGE ESTATES was approved by the Chandler City Council, City of Chandler, Minnesota, on the 16th day of September, 2001.

WITNESS MY HAND AND SEAL OF OFFICE  
I, Notary Public, do hereby certify that the above described plat of NORTHBRIDGE ESTATES was approved by the Nebraska Registered Professional Surveyor, Sandy County, Minnesota, on the 16th day of September, 2001.

### LOT AREAS

LOT NO.	AREA (SQ. FT.)
17	12,000
18	12,000
19	12,000
20	12,000
21	12,000
22	12,000
23	12,000
24	12,000
25	12,000
26	12,000
27	12,000
28	12,000
29	12,000
30	12,000
31	12,000
32	12,000
33	12,000
34	12,000
35	12,000
36	12,000
37	12,000
38	12,000
39	12,000
40	12,000
41	12,000
42	12,000
43	12,000
44	12,000
45	12,000
46	12,000
47	12,000
48	12,000
49	12,000
50	12,000
51	12,000
52	12,000
53	12,000
54	12,000
55	12,000
56	12,000
57	12,000
58	12,000
59	12,000
60	12,000
61	12,000
62	12,000
63	12,000
64	12,000
65	12,000
66	12,000
67	12,000
68	12,000
69	12,000
70	12,000
71	12,000
72	12,000
73	12,000
74	12,000
75	12,000
76	12,000
77	12,000
78	12,000
79	12,000
80	12,000
81	12,000
82	12,000
83	12,000
84	12,000
85	12,000
86	12,000
87	12,000
88	12,000
89	12,000
90	12,000
91	12,000
92	12,000
93	12,000
94	12,000
95	12,000
96	12,000
97	12,000
98	12,000
99	12,000
100	12,000
101	12,000
102	12,000
103	12,000
104	12,000
105	12,000
106	12,000
107	12,000
108	12,000
109	12,000
110	12,000
111	12,000
112	12,000
113	12,000
114	12,000
115	12,000
116	12,000
117	12,000
118	12,000
119	12,000
120	12,000
121	12,000
122	12,000
123	12,000
124	12,000
125	12,000
126	12,000
127	12,000
128	12,000
129	12,000
130	12,000
131	12,000
132	12,000
133	12,000
134	12,000
135	12,000
136	12,000
137	12,000
138	12,000
139	12,000
140	12,000
141	12,000
142	12,000
143	12,000
144	12,000
145	12,000
146	12,000
147	12,000
148	12,000
149	12,000
150	12,000
151	12,000
152	12,000
153	12,000
154	12,000
155	12,000
156	12,000
157	12,000
158	12,000
159	12,000
160	12,000
161	12,000
162	12,000
163	12,000
164	12,000
165	12,000
166	12,000
167	12,000
168	12,000
169	12,000
170	12,000
171	12,000
172	12,000
173	12,000
174	12,000
175	12,000
176	12,000
177	12,000
178	12,000
179	12,000
180	12,000
181	12,000
182	12,000
183	12,000
184	12,000
185	12,000
186	12,000
187	12,000
188	12,000
189	12,000
190	12,000
191	12,000
192	12,000
193	12,000
194	12,000
195	12,000
196	12,000
197	12,000
198	12,000
199	12,000
200	12,000
201	12,000

NOTES:  
1. ALL AREAS ARE BY VALUE CHANGING ZONING.  
2. ALL AREAS ARE SUBJECT TO THE MINNESOTA CONSTITUTION.  
3. ALL AREAS ARE SUBJECT TO THE MINNESOTA STATUTES.  
4. ALL AREAS ARE SUBJECT TO THE MINNESOTA LOCAL ORDINANCES.

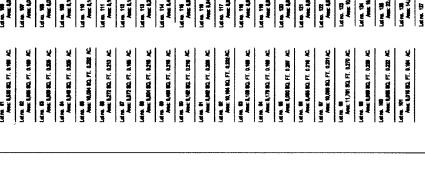
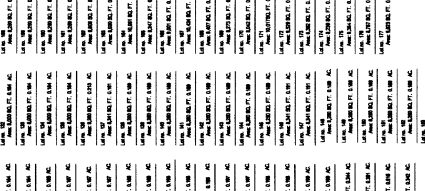
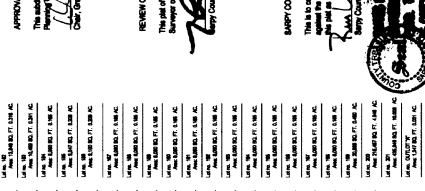
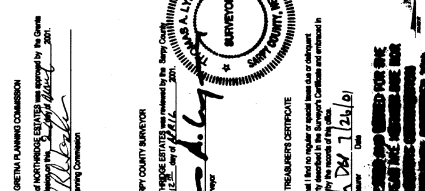
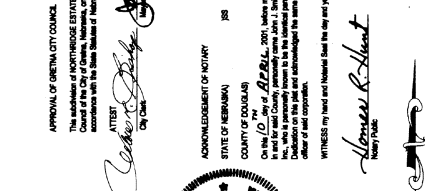

DEDICATION  
I, the undersigned, do hereby dedicate to the public for the use and enjoyment of the people of the State of Minnesota, the land described in the plat of NORTHBRIDGE ESTATES, Section 31, Township 30N, Range 12E, County of Chandler, Minnesota, as shown on the plat, and the same shall be subject to the provisions of the Minnesota Statutes relating to the dedication of land to the public for the use and enjoyment of the people of the State of Minnesota.

SEAL OF SANDY COUNTY, MINNESOTA  
NOTARY PUBLIC  
ROBERT ROBERT

SEAL OF NEBRASKA REGISTERED PROFESSIONAL SURVEYOR  
NOTARY PUBLIC  
ROBERT ROBERT

SEAL OF CHANDLER CITY, MINNESOTA  
NOTARY PUBLIC  
ROBERT ROBERT

SEAL OF SANDY COUNTY, MINNESOTA  
NOTARY PUBLIC  
ROBERT ROBERT

SEAL OF NEBRASKA REGISTERED PROFESSIONAL SURVEYOR  
NOTARY PUBLIC  
ROBERT ROBERT

SEAL OF CHANDLER CITY, MINNESOTA  
NOTARY PUBLIC  
ROBERT ROBERT

SEAL OF SANDY COUNTY, MINNESOTA  
NOTARY PUBLIC  
ROBERT ROBERT

SEAL OF NEBRASKA REGISTERED PROFESSIONAL SURVEYOR  
NOTARY PUBLIC  
ROBERT ROBERT

SEAL OF CHANDLER CITY, MINNESOTA  
NOTARY PUBLIC  
ROBERT ROBERT

EA CONSULTING GROUP, INC.  
PLANNERS SURVEYORS ENGINEERS

Country: USA  
Verify: [Signature]  
P: [Signature]  
D: [Signature]  
Fee \$ 1650  
OK X Cash [ ] [ ]