

91-20193A

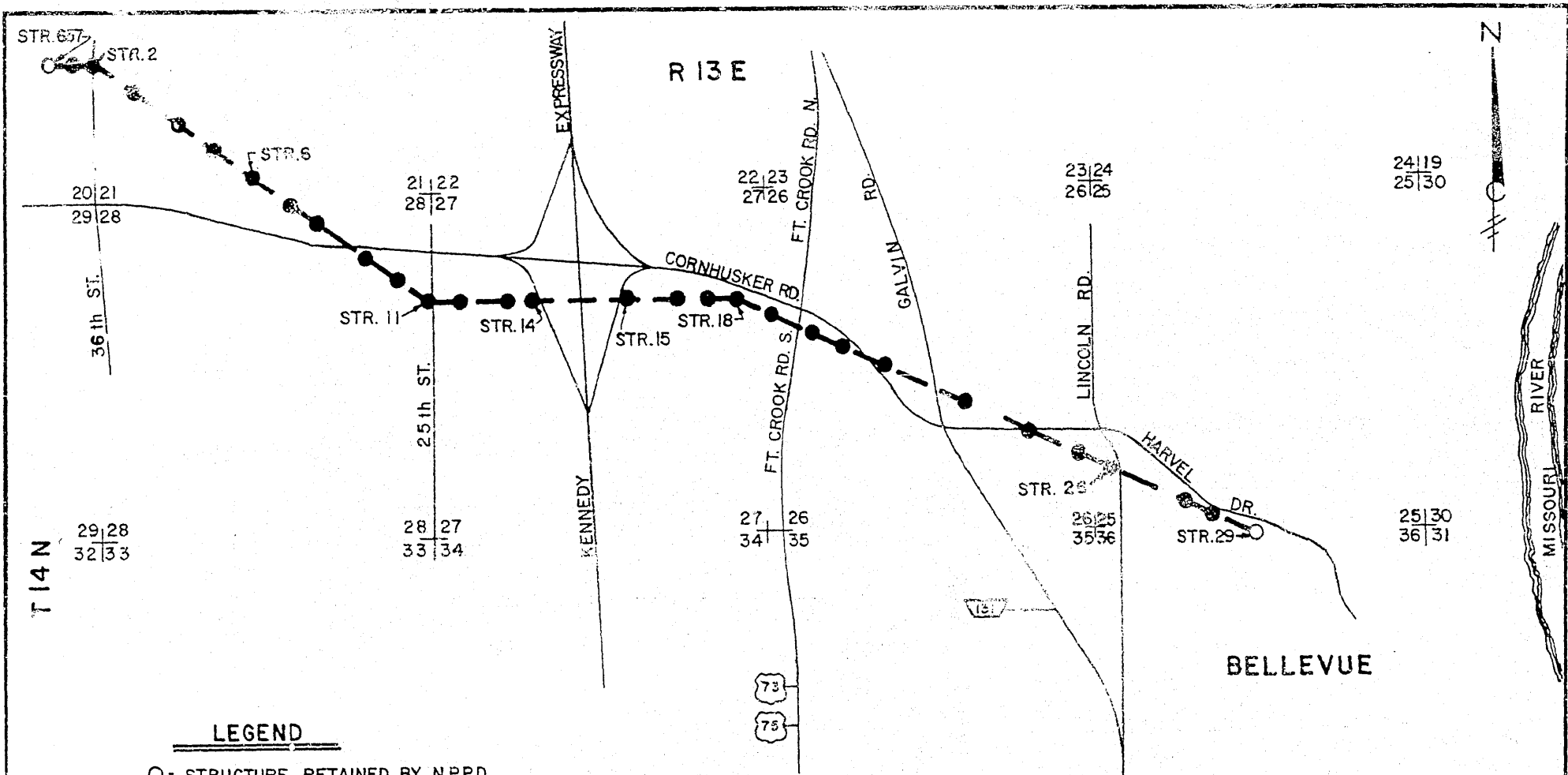

LEGEND

- = STRUCTURE RETAINED BY N.P.P.D.
- = STRUCTURE SOLD TO O.P.P.D.

SARPY COUNTY

EXHIBIT "A"
SALE OF FACILITIES

NO.	1
REVISION	ADDED STR. 14 B IS B MODIFIED LEGEND D.J.Y. 5-9-90 C.K.D. 10/5 APPROVED 4-11-90 FILM

SIGNIFICANT NUMBER	011580					7410
GROUP	1	2	3	4	5	6
FREMONT - KRAMER TL 1158 LINE SALE BETWEEN STR. 657 AND 29						

DRAWN	DATE	 Nebraska Public Power District
D.J.Y.	4-3-90	
CHECKED	DATE	
Lvs 8/1	4-11-90	
APPROVED	DATE	
ZHO	4-11-90	
FILMED	DATE	REVISION
4-20-90	NA66480	1

5.13663

TRANSFER TO
OMAHA PUBLIC POWER DISTRICT
1991 RETIREMENT
FREMONT-KRAMER 115kV
FACILITY #011580
W.O. 48348
SARPY COUNTY

Search Number	Owners Name	Location	Sec.	Twp.	Rng.	Acq. Pmt.	Acq. Type	Record Info.	Date Signed	Grantee
21038-1132	O'Keefe, Elizabeth	SW $\frac{1}{4}$ SW $\frac{1}{4}$ NW $\frac{1}{4}$ SW $\frac{1}{4}$	21 21	14N 14N	13E 13E	\$300.00	Easement	470827, Misc. Book 13, Page 346	470418	LRPPD
21038-1136	Blue Ridge Land Company	SW $\frac{1}{4}$ SW $\frac{1}{4}$ NW $\frac{1}{4}$ SW $\frac{1}{4}$	21 21	14N 14N	13E 13E	\$1.00	Partial Release of Easement	620813, Misc. Book 30, Page 259	620725	LRPPD
21038-1142	Laduke, Laura	NE $\frac{1}{4}$ SW $\frac{1}{4}$ SE $\frac{1}{4}$ SW $\frac{1}{4}$	21 21	14N 14N	13E 13E	\$100.00	Easement	470827, Misc. Book 13, Page 345	470718	LRPPD
21038-1144	Rock Island Railroad	SE $\frac{1}{4}$ SW $\frac{1}{4}$ SW $\frac{1}{4}$ SW $\frac{1}{4}$	21 21	14N 14N	13E 13E		Permit			
21038-1145	Murphy Joseph F. Etc.	NE $\frac{1}{4}$ SW $\frac{1}{4}$ SE $\frac{1}{4}$ SW $\frac{1}{4}$ SW $\frac{1}{4}$ SE $\frac{1}{4}$ NW $\frac{1}{4}$ SE $\frac{1}{4}$	21 21 21 21	14N 14N 14N 14N	13E 13E 13E 13E	\$500.00	Condemnation	510915, Misc. Book 15, Page 63	510915	LRPPD
21038-1166	Meisinger, Earle W.	NW $\frac{1}{4}$ NE $\frac{1}{4}$	28	14N	13E	\$800.00	Condemnation	510915, Misc. Book 15, Page 63	510915	LRPPD
21038-1174	Strike, Charles O. Etc.	NW $\frac{1}{4}$ NE $\frac{1}{4}$	28	14N	13E	\$75.00	Easement	510911, Misc. Book 15, Page 56	510807	LRPPD
21038-1178	Meisinger, Raymond	NE $\frac{1}{4}$ NE $\frac{1}{4}$	28	14N	13E	\$350.00	Condemnation	510915, Misc. Book 15, Page 63	510915	LRPPD
21038-1184	Vandusen, Dana B.	SE $\frac{1}{4}$ NE $\frac{1}{4}$	28	14N	13E	\$1,050.00	Condemnation	510915, Misc. Book 15, Page 63	510915	LRPPD

EXHIBIT B

91-20193 B

Transfer to CPPD - 1991 Retirement
 From - Former 115kV - Facility #011580
 W.O. 48348 - Sarpy County

Page 2

Search Number	Owners Name	Location	Sec.	Twp.	Eng.	Acq. Pmt.	Acq. Type	Record Info.	Date Signed	Grantee
21038-1189	Pratt, Willard Etc.	SW $\frac{1}{4}$	27	14N	13E	\$1,050.00	Condemnation	510915, Misc. Book 15, Page 63	510925	LRPPD
21038-1192	Meadow Green Co.	NW $\frac{1}{4}$	27	14N	13E		Quit-Claim	740509, Book of Deeds 149, Page 1008	740208	LRPPD
21038-1200	Hall Investment Co.	NE $\frac{1}{4}$	27	14N	13E	\$1,650.00	Condemnation	510915, Misc. Book 15, Page 63	510915	LRPPD
21038-1206	Union Pacific Railroad	SE $\frac{1}{4}$ NE $\frac{1}{4}$	27	14N	13E	\$5.00	Permit		530529	
21038-1211	Petersen, Michael P. Etc.	SE $\frac{1}{4}$ NE $\frac{1}{4}$	27	14N	13E	\$1,850.00	Condemnation	511013, Misc. Book 15, Page 81	510927	LRPPD
21038-1233	Petersen, Michael P. Etc.	SW $\frac{1}{4}$ NW $\frac{1}{4}$	26 26	14N 14N	13E 13E	\$1,850.00	Condemnation	511003, Misc. Book 15, Page 81	510927	LRPPD
21038-1250	Real Construction Co. Inc.	SW $\frac{1}{4}$ NW $\frac{1}{4}$	25 26	14N 14N	13E 13E		Partial Release of Easement	730522, Misc. Book 46, Page 275	730430	LRPPD
21038-1253	Grobeck, Arthur P. Etc.	SW $\frac{1}{4}$	26	14N	13E	\$30.00	Easement	471024, Misc. Book 13, Page 409	470925	
21038-1258	Petersen, Arther P. Etc.	SE $\frac{1}{4}$	26	14N	13E	\$800.00	Condemnation	511003 Misc. Book 15, Page 81	510927	
21038-1281	Hansen, Chris Etc.	SW $\frac{1}{4}$ SE $\frac{1}{4}$ NW $\frac{1}{4}$ SE $\frac{1}{4}$	26	14N	13E	\$800.00	Condemnation	511003 Misc. Book 15, Page 81	510927	
21038-1294	Hansen, Chris Etc.	SW $\frac{1}{4}$ SW $\frac{1}{4}$	25	14N	13E	\$75.00	Condemnation	511003 Misc. Book 15, Page 81	510927	
21038-1307	Petersen, Michael P.	SE $\frac{1}{4}$ SW $\frac{1}{4}$ SW $\frac{1}{4}$ SW $\frac{1}{4}$ SE $\frac{1}{4}$ SW $\frac{1}{4}$ SW $\frac{1}{4}$ SW $\frac{1}{4}$ NE $\frac{1}{4}$ NW $\frac{1}{4}$ NW $\frac{1}{4}$ NE $\frac{1}{4}$	26 26 25 25 36 36	14N 14N 14N 14N 14N 14N	13E 13E 13E 13E 13E 13E	\$410.00	Condemnation	511003 Misc. Book 15, Page 81	510927	

EXHIBIT B

91-20193C

Transfer to OPPD - 1991 Easement
Fremont-Kramer 115kV - Facility #01158
W.O. 48348 - Sarpy County

Page 3

Search Number	Owners Name	Location	Sec.	Twp.	Eng.	Acq. Pmt.	Acq. Type	Record Info.	Date Signed	Grantee
21038-1325	St. Columban's Foreign Mission Society	SW $\frac{1}{4}$	25	14N	13E	\$50.00	Easement	480716, Misc. Book 13, Page 648	471107	

Proof	_____
D.E.	_____
Verify	_____
Filmed	_____
Checked	_____
Fee \$	28.00

Carole A. Glavin
REGISTER OF DEEDS

91 DEC 18 AM 11:17

FILED SARPY CO. NE.
INSTRUMENT NUMBER
91
20193

EXHIBIT B

91-20193 D