

38

33016

FILED
2001 PAGE 6718
2001 OCT -9 PH 3:35

Carol Adams
DODGE COUNTY
REGISTER OF DEEDS
RESOLUTION NO. 25-50
9861-169

A resolution of the City Council of the City of Fremont, Nebraska, approving the request of ANT, LLC to subdivide Tax Lot 10 as described in the attached Exhibit "A" being Part of the West Half of the Northeast Quarter of Section 11, Township 17 North, Range 8 East of the 6th P.M., Dodge County, Nebraska into two (2) lots as described in the attached Exhibit "B"

RESOLVED: That ANT, LLC to subdivide Tax Lot 10 as described in the attached Exhibit "A" being Part of the West Half of the Northeast Quarter of Section 11, Township 17 North, Range 8 East of the 6th P.M., Dodge County, Nebraska into two (2) lots as described in the attached Exhibit "B"

The subdivision of the property is hereby approved subject to receipt of proper easements, the capping of any necessary utility services, and the Mayor and City Clerk are hereby directed to sign this resolution on behalf of the City Council.

Council member *Neil Schumig - Neely* offers this resolution and moves its adoption, seconded by Council member *Jay Botters*.

PASSED AND APPROVED THIS 25th DAY OF September, 2004.

Donald B. Edwards
DONALD B. EDWARDS, MAYOR

ATTEST:
Kimberly Voll
Kimberly Voll
City Clerk



33017

VICINITY SKETCH

DODGE COUNTY
NEBRASKA

R8E

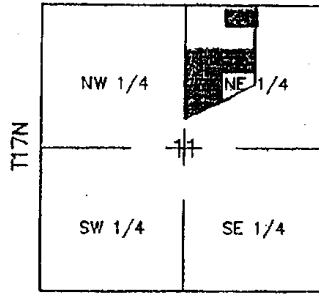
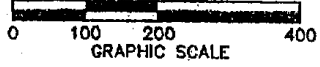

EXHIBIT "A"

**ANT, LLC LOT SUBDIVISION
PT. NE 1/4 -11-T17N-R8E
DODGE COUNTY, NE
PAGE 1 OF 1**



LEGAL DESCRIPTIONS:

PARCEL NO. 3:

(LEGAL DESCRIPTION AS INSTRUCTED BY CLIENT)

THAT PORTION OF THE WEST HALF NORTHEAST QUARTER OF SECTION 11, TOWNSHIP 17 NORTH, RANGE 8 EAST, SIXTH P.M., DODGE COUNTY, NEBRASKA, LYING NORTHERLY OF THE NORTH OF THE CHICAGO AND NORTHWESTERN RAILWAY COMPANY'S (NOW UNION PACIFIC RAILROAD COMPANY) 100.0 FOOT WIDE RIGHT OF WAY, AND LYING SOUTH OF A LINE DRAWN PARALLEL WITH AND DISTANT 809.22 FEET SOUTH, AS MEASURED AT RIGHT ANGLES FROM THE NORTH LINE OF SAID WEST HALF NORTHEAST QUARTER, AND ALSO THAT PART OF THE WEST 33.00 FEET OF SAID WEST HALF NORTHEAST QUARTER, BEING DESCRIBED AS FOLLOWS: COMMENCING AT THE NORTHEAST CORNER OF SAID WEST HALF NORTHEAST QUARTER; THENCE S00°01'15"W ON THE EAST LINE OF SAID WEST HALF NORTHEAST QUARTER, A DISTANCE OF 388.00 FEET; THENCE S00°02'16"E CONTINUING ON SAID EAST LINE, A DISTANCE OF 85.00 FEET TO THE TRUE POINT OF BEGINNING; THENCE S00°00'59"W CONTINUING ON SAID EAST LINE, A DISTANCE OF 336.22 FEET; THENCE S89°59'39"W, A DISTANCE OF 33.00 FEET TO THE SOUTHEAST CORNER OF A PARCEL OF LAND DESCRIBED IN DEED BOOK 2000, PAGE 6413; THENCE N00°01'51"E ON THE EAST LINE OF SAID DESCRIBED PARCEL, A DISTANCE OF 336.28 FEET TO THE NORTHEAST CORNER OF SAID DESCRIBED PARCEL; THENCE N89°59'31"E, A DISTANCE OF 32.92 FEET TO THE TRUE POINT OF BEGINNING.

PARCEL NO. 4:

(LEGAL DESCRIPTION PROVIDED BY CLIENT AND RECORDED IN DEED BOOK 1999, PAGE 1264)

THAT PORTION OF THE NORTHWEST QUARTER NORTHEAST QUARTER OF SECTION 11, TOWNSHIP 17 NORTH, RANGE 8 EAST, SIXTH P.M., DODGE COUNTY, NEBRASKA, LYING BETWEEN TWO LINES DRAWN PARALLEL WITH AND DISTANT, RESPECTIVELY, 70.0 FEET AND 388.0 FEET SOUTH, AS MEASURED AT RIGHT ANGLES FROM THE NORTH LINE OF SAID NORTHWEST QUARTER NORTHEAST QUARTER, BOUNDED ON THE EAST BY THE EAST LINE OF SAID NORTHWEST QUARTER NORTHEAST QUARTER, AND BOUNDED ON THE WEST BY A LINE DRAWN PARALLEL WITH AND DISTANT 736.0 FEET EAST, AS MEASURED AT RIGHT ANGLES FROM THE WEST LINE OF SAID NORTHWEST QUARTER NORTHEAST QUARTER.

<p align="center">SURVEY RECORD PART OF THE WEST HALF OF THE NORTHEAST QUARTER SECTION 11, TOWNSHIP 17 NORTH, RANGE 8 EAST DODGE COUNTY, NEBRASKA</p>	<p align="center">JEO Consulting Group, Inc. <small>402-443-4861 P.O. BOX 207 WYHOG, NEBRASKA 68078</small></p>
--	--

33019

LEGEND

- ⊙ MONUMENT FOUND
- MONUMENT SET
- TEMPORARY POINT
- D DEEDED DISTANCE
- G GOVERNMENT DISTANCE
- M MEASURED DISTANCE
- P PLATTED DISTANCE
- R RECORDED DISTANCE (ERICKSON 1977)

NOTE: ALL BEARINGS ARE ASSUMED.

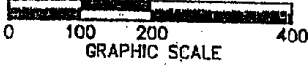

VICINITY SKETCH

DODGE COUNTY
NEBRASKA

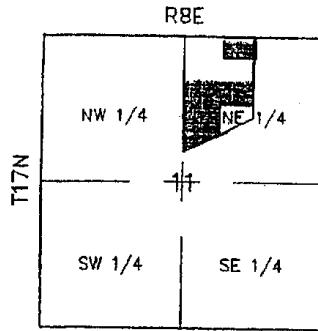

LEGAL DESCRIPTIONS:

PARCEL NO. 3:

(LEGAL DESCRIPTION AS INSTRUCTED BY CLIENT)
 THAT PORTION OF THE WEST HALF NORTHEAST QUARTER OF SECTION 11, TOWNSHIP 17 NORTH, RANGE 8 EAST, SIXTH P.M., DODGE COUNTY, NEBRASKA, LYING NORTHERLY OF THE NORTH OF THE CHICAGO AND NORTHWESTERN RAILWAY COMPANY'S (NOW UNION PACIFIC RAILROAD COMPANY) 100.0 FOOT WIDE RIGHT OF WAY, AND LYING SOUTH OF A LINE DRAWN PARALLEL WITH AND DISTANT 809.22 FEET SOUTH, AS MEASURED AT RIGHT ANGLES FROM THE NORTH LINE OF SAID WEST HALF NORTHEAST QUARTER, AND ALSO THAT PART OF THE WEST 33.00 FEET OF SAID WEST HALF NORTHEAST QUARTER, BEING DESCRIBED AS FOLLOWS: COMMENCING AT THE NORTHEAST CORNER OF SAID WEST HALF NORTHEAST QUARTER; THENCE S00°01'15"W ON THE EAST LINE OF SAID WEST HALF NORTHEAST QUARTER, A DISTANCE OF 388.00 FEET; THENCE S00°02'16"E CONTINUING ON SAID EAST LINE, A DISTANCE OF 85.00 FEET TO THE TRUE POINT OF BEGINNING; THENCE S00°00'59"W CONTINUING ON SAID EAST LINE, A DISTANCE OF 336.22 FEET; THENCE S89°59'39"W, A DISTANCE OF 33.00 FEET TO THE SOUTHEAST CORNER OF A PARCEL OF LAND DESCRIBED IN DEED BOOK 2000, PAGE 6413; THENCE N00°01'51"E ON THE EAST LINE OF SAID DESCRIBED PARCEL, A DISTANCE OF 336.28 FEET TO THE NORTHEAST CORNER OF SAID DESCRIBED PARCEL; THENCE N89°59'31"E, A DISTANCE OF 32.92 FEET TO THE TRUE POINT OF BEGINNING.

PARCEL NO. 4:

(LEGAL DESCRIPTION PROVIDED BY CLIENT AND RECORDED IN DEED BOOK 1998, PAGE 1264)
 THAT PORTION OF THE NORTHWEST QUARTER NORTHEAST QUARTER OF SECTION 11, TOWNSHIP 17 NORTH, RANGE 8 EAST, SIXTH P.M., DODGE COUNTY, NEBRASKA, LYING BETWEEN TWO LINES DRAWN PARALLEL WITH AND DISTANT, RESPECTIVELY, 70.0 FEET AND 388.0 FEET SOUTH, AS MEASURED AT RIGHT ANGLES FROM THE NORTH LINE OF SAID NORTHWEST QUARTER NORTHEAST QUARTER, BOUNDED ON THE EAST BY THE EAST LINE OF SAID NORTHWEST QUARTER NORTHEAST QUARTER, AND BOUNDED ON THE WEST BY A LINE DRAWN PARALLEL WITH AND DISTANT 738.0 FEET EAST, AS MEASURED AT RIGHT ANGLES FROM THE WEST LINE OF SAID NORTHWEST QUARTER NORTHEAST QUARTER.

EXHIBIT "B"
ANT, LLC
PAGE 2 OF 3

<p>SURVEY RECORD PART OF THE WEST HALF OF THE NORTHEAST QUARTER SECTION 11, TOWNSHIP 17 NORTH, RANGE 8 EAST DODGE COUNTY, NEBRASKA</p>	<p>JEO Consulting Group, Inc. <small>40945-4851 P.O. BOX 207 YUKON, NEBRASKA 68398</small></p>
--	--

