

RIGHT OF WAY PERMIT

I, ~~Phillips Petroleum Company~~ REPROCO, INC. Owner (s) of  
(agent for) the real estate described as the east 250 feet of the south 250  
feet of the S E 1/4 of the S W 1/4 of sec. 34 - T16 - R12 of the 6th PM of  
Douglas County, Nebraska, excepting public roads FWM

in consideration of the sum of \$ 1.00, receipt of which is hereby acknowledged,  
do hereby grant to the Omaha Public Power District, its successors and assigns the  
perpetual right to construct, operate and maintain, its electric transmission and  
distribution line (s), consisting of poles, wires, cables, fixtures, guys and anchors,  
together with the right to trim any trees, along said line (s) where necessary to  
secure a clearance of at least 12 1/2 feet for the wires. The electric line (s)  
to be located as follows:

The north 12 1/2 feet of the property described above and shown on the attached sketch.

The grantor also grants the Omaha Public Power District power to extend to  
the Telephone Company the right to use jointly with the Omaha Public Power District  
any pole placed pursuant to the provisions hereof.

The foregoing right is granted upon the express condition that the Omaha  
Public Power District will assume liability for all damages to the above described  
property caused by said District's failure to use due care in its exercise of the  
granted right.

Witness my hand and seal this 17<sup>th</sup> day of October, 1966.  
ATTEST: \_\_\_\_\_ REPROCO INC. SWE  
By: E. G. McElroy By: [Signature]  
\_\_\_\_\_  
Owners

STATE OF Oklahoma }  
COUNTY OF Washington } ss

On this 17<sup>th</sup> day of October, 1966, before me the  
undersigned a Notary Public in and for said County and State, personally appeared

H. V. Allison  
personally to me known to be the identical person who signed the foregoing instru-  
ment as grantor and who acknowledged the execution thereof to be his voluntary  
act and deed for the purpose therein expressed.

Witness my hand and Notarial Seal the date above written.

M. J. [Signature]  
Notary Public

My Commission Expires February 3, 1970



PROPERTY PLAT SKETCH SHOWING THE LOCATION & SIZE OF EASEMENT REQUESTED BY O.P.R.D. BEING IN THE SOUTHEAST CORNER OF THE SOUTHEAST QUARTER OF THE SOUTHWEST QUARTER OF SECTION 34, TOWNSHIP 16, RANGE 12, DOUGLAS COUNTY, NEBRASKA.

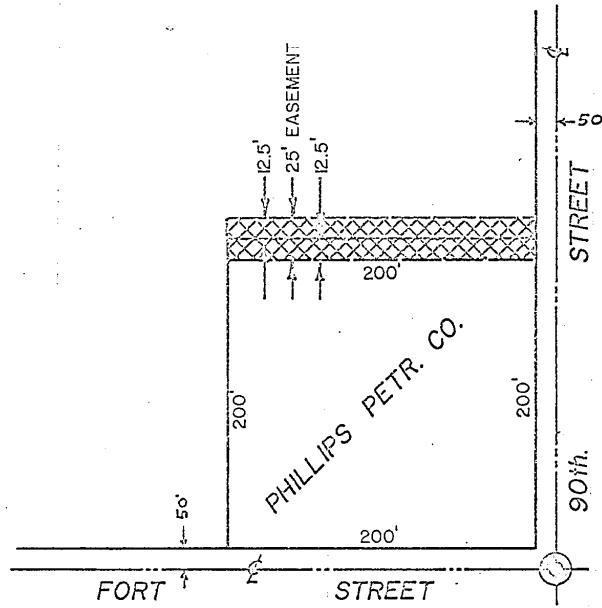
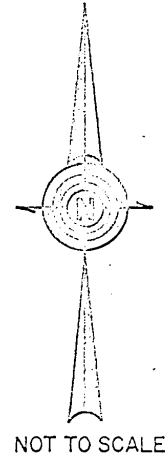

SE. COR. OF THE SE 1/4 OF THE SW 1/4 SEC. 34-16-12

*9*  
*Michael*  
RECEIVED

1966 NOV 10 AM 10 14

THOMAS J. O'CONNOR  
REGISTER OF DEEDS  
DOUGLAS COUNTY, NEBR.

for Records  
Book *243*  
Page *419*

*Edward J. [unclear]*

By *Orville Public Power Dist*  
*L. J. & Harney*

Compared *34-16-12* *325*

*34-16-12*