

No consideration passes - this instrument given to correct a scrivener's error in that easement recorded in Book 60 of Page 2140 and Pages 2140-A through 2140-S, which in turn, corrected and more specifically located that easement recorded in Book 58 at Page 711, all in records of Sarpy County, Nebraska.

60-3131

AMENDED CORRECTION EASEMENT GRANT

KNOW ALL MEN BY THESE PRESENTS:

That CHICAGO PACIFIC CORPORATION, a Delaware corporation, (hereinafter referred to as "Grantor"), in consideration of the sum of TEN AND 00/100 (\$10.00) DOLLARS and other good and valuable consideration in hand paid, does hereby grant unto US SPRINT COMMUNICATIONS COMPANY (hereinafter referred to as "Grantee"), 2330 Johnson Drive, Shawnee Mission, Kansas 66205, a nonexclusive perpetual easement for a fiber optic communication system, in the County of Sarpy, State of Nebraska, described as follows and more specifically delineated on Exhibits "A-1" through "A-17", attached hereto and made a part of this document.

\$ 115.00

FILED FOR RECORD 10-19-87 11:23 AM IN BOOK 60 OF PAGE 351  
Dorothy Dowling  
REGISTER OF DEEDS, SARPY COUNTY, NE

A ten foot wide non-exclusive easement for a fiber optics transmission cable along the former right-of-way of the Chicago, Rock Island and Pacific Railroad Company, the centerline of said easement generally described in a Southwesterly to Northeasterly fashion in Sarpy County, Nebraska as follows:

Beginning at the intersection of said easement centerline, also being a line 35 feet Southeasterly of and parallel to the centerline of the former right-of-way with the centerline of the Platte River, said river centerline also being the Southerly line of Sarpy County, Nebraska, said point of intersection being in the Northwest Quarter of Section 19, Township 12 North, Range 11 East of the Sixth Principal Meridian; thence in a general Northeasterly direction along said easement centerline through said Section 19 and Sections 18, 17, 16, 15, 10, 11, 2 and 1 all Township 12 North, Range 11 East; thence continuing in a general Northeasterly direction through Section 36 Township 13 North, Range 11 East; thence continuing in a general Northeasterly direction through Sections 31, 30, 29, 20, 17, 8, 9, 10, 3 and 2 all Township 13 North, Range 12 East; thence continuing in a general Northeasterly direction through Sections 35, 36 and 25 all Township 14 North, Range 12 East; thence continuing in a general Northeasterly direction through Sections 30, 31, 32, 29, 28, 21 and 16 all Township 14 North, Range 13 East to a point on the North line of said Section 16, said line also being the North line of Sarpy County, said point being on a line 5 feet Westerly of and parallel to the centerline of said former right-of-way.

Grantee's use of the property (herein described "premises") is made subject to the following terms and conditions which are deemed covenants and shall run with the land:

1. The fiber optic communication system shall include fiber optic cables, conduit, carrier pipe, poles, cables, fibers, repeaters, junctions, terminals, power sources, power supply access and attendant buildings, equipment, fixtures and appurtenances incidental to such use.

2. Grantee shall have access to the premises for the installation of the fiber optic cable and support devices, access to aerial or marine rights for fiber optic cable installation, and land for Grantee at locations approved by Grantor to construct equipment shelters, support structures and other facilities, as needed. Where applicable, the fiber optic cable shall be placed at a depth of not less than 5'6" below the base of the rails of the track or tracks where it passes under same and not less than 3' below the surface of the ground at any point on the premises except where rock makes placement at a depth of 3' impractical. At Grantee's option, the fiber optic cable may be attached to bridges or structures subject to Grantor's prior written consent which shall not be unreasonably withheld. The Easement is for the installation, inspection, maintenance, repair, reinstallation, replacement and use of fiber optic cables, support devices and buildings, and for reasonable access thereto. Any subsequent fiber optic communication system or cables which Grantee may install pursuant to its Easement Agreement with Grantor dated October 1, 1984, shall require the filing of additional Easement Grant(s), except for replacement cables or facilities required due to the failure or defect of a prior installed cable or facilities.

✓

Rec'd 17339 ✓

3. Should the construction, maintenance, operation or presence of said fiber optic communication system necessitate any change or alteration in the location or arrangement of any railroad facilities or appurtenances owned or possessed by Grantor, Grantor shall do or cause to be done any necessary changes or alterations necessary for railroad operating purposes only and Grantee agrees to pay to Grantor the cost of said changes or alterations, said cost to be mutually agreed to by the parties. Should it, for reasons of railroad safety or as a result of railroad operations, become necessary to repair or change the locations, elevation or method of construction of said fiber optic communication system or any part thereof, the Grantee shall do such work upon receipt of a written request to do so made upon it by the Grantor.

4. Grantor shall permit Grantee reasonable right of entry for the purpose of constructing, installing, replacing, repairing, inspecting, maintaining, reinstalling, and operating said fiber optic communication system, it being understood that Grantor may restrict the location of entry point or access on or over the premises.

5. Grantee shall have the right to mark the location of the fiber optic communication system by suitable markers set in the ground which shall not interfere with any reasonable use Grantor shall make of the premises.

6. Grantee shall pay the entire cost of constructing, installing, replacing, repairing, maintaining, reinstalling, and operating said fiber optic communication system. All of said work shall be done in a good and workmanlike manner and in accordance with the plans, specifications and profiles, specifically including date of commencement of work, to be prepared by Grantee and submitted for approval to Grantor; and, except in emergencies, until such approval is first had, and such approval shall not be unreasonably withheld, said work upon Grantor's premises shall not be commenced by Grantee. Grantor reserves the right to have a representative present, but in no way waives any rights under this Easement Grant by failing to have said representative present.

7. Grantor shall have the right to retain existing tracks and other improvements at the location of the premises and also shall have the right at any and all times in the future to construct, maintain and operate over said premises such additional track, tracks and other railroad related improvements as it may from time to time elect. Nothing shall be done or suffered to be done by Grantee that will in any manner impair the usefulness or safety of the existing tracks and other railroad related improvements of the Grantor, or of such track, tracks and other railroad related improvements as Grantor may construct in the future upon the premises. Grantor reserves the right to fully enjoy and use said premises, including the exclusive right to grant future easements within the above described premises, except as may be inconsistent with or interfere with the rights and privileges herein granted to Grantee.

8. Grantee agrees that before and during the construction, installation, replacement, repair, maintenance, reinstallation, or operation of said fiber optic communication system, or at any other time, Grantor shall have the right to provide such safe and temporary structures as it may deem necessary for safely caring for and preserving its tracks, buildings or other railroad related improvements, and Grantee agrees to pay to Grantor the cost, to be mutually agreed to by the parties, of putting in and removing such temporary structures and of restoring the property of Grantor substantially to the same condition in which it was before the commencement of the work.

9. Grantee agrees that if, at any time, Grantor shall change for railroad operating purposes only the location or grade of Grantor's tracks at any point of crossing or at any point along a parallel course with said fiber optic communication system or shall desire to use the premises at said point or parallel course for any railroad operating purpose, Grantee, at its own expense, shall make all changes in the fiber optic communication system required by Grantor. If Grantee within a period of 30 days after receiving written notice from Grantor shall fail, neglect or refuse to respond and agree to make said changes, then Grantor may forthwith make such changes at Grantee's expense.

10. Grantee shall at all times construct, install, replace, repair, maintain, reinstall, and operate said fiber optic communication system in a secure and safe condition and in accordance with all applicable laws, ordinances, rules and regulations. If the manner of constructing, installing, replacing, repairing, maintaining, reinstalling, or operating said fiber optic communication system shall at any time be in violation of any applicable law, rule, regulation or ordinance, then Grantee shall at no cost or expense to Grantor, upon receipt of appropriate notice from a governmental agency having enforcement jurisdiction in the premises, make such changes or repairs as shall be necessary.

11. Grantee shall indemnify and save harmless Grantor, and its officers, employees, and agents, from and against all claims, losses, demands and causes of action, including attorneys' fees, court costs and/or judgments arising in favor of any person or other legal entity (including Grantee or its employees, agents, invitees, contractors, tenants or licensees) which are caused by, or arise directly or indirectly from the construction, use and operation of said fiber optic communication system or the grant of this easement, unless caused by the negligence or willful acts of Grantor, its officers, employees or agents.

12. Notwithstanding anything to the contrary herein, the Grantor shall in no event incur liability to Grantee for the failure of or defect in Grantor's title or estate in the premises.

13. The grants, covenants and stipulations hereof shall extend to and be binding upon the respective successors and permitted assignees of the parties hereto as allowed in the October 1, 1984, Easement Agreement between the parties.

IN WITNESS WHEREOF, this instrument is executed by Grantor this 29<sup>th</sup> day of September, 1987.

ATTEST:

CHICAGO PACIFIC CORPORATION

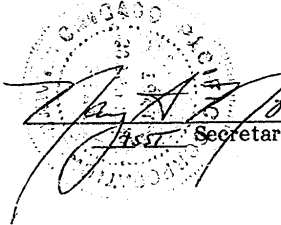
  
[Signature]  
Secretary

By: E. Harrison  
Executive Vice President

STATE OF ILLINOIS        )  
  ) SS  
COUNTY OF COOK        )

I, the undersigned, a Notary Public, in and for the County and State aforesaid, do hereby certify that E. J. Harrison personally known to me to be the Exec. Vice President of CHICAGO PACIFIC CORPORATION, a Delaware corporation, and Nancy A. Norman personally known to me to be the Asst. Secretary of said corporation, and personally known to me to be the same persons whose names are subscribed to the foregoing instrument, appeared before me this day in person and acknowledged that as such Exec. Vice President and Asst. Secretary they signed and delivered the said instrument as Exec. Vice President and Asst. Secretary of said corporation, and caused the corporate seal of said corporation to be affixed thereto, pursuant to authority given by the Board of Directors of said corporation as their free and voluntary act, and as the free and voluntary act and deed of said corporation for the uses and purposes therein set forth.

Given under my hand and seal this 29<sup>th</sup> day of September, 1987.

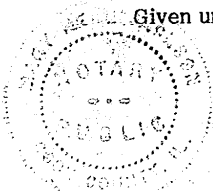

Mary Nell Jackson  
Notary Public

My commission expires: November 1, 1987

mj



POOR COPY FILED

3131 D

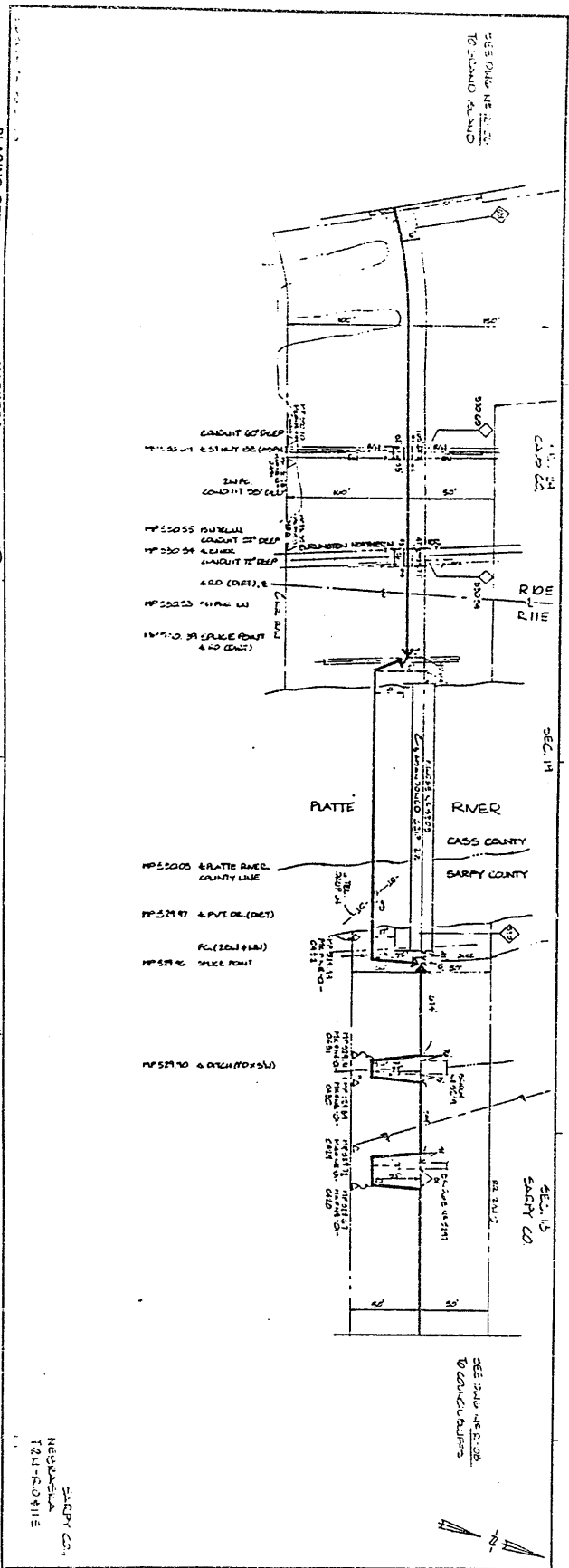

PLACING DETAIL  
CABLE

CONDUIT

MARKERS

MISCELLANEOUS

US Telecom

GRAND ISLAND TO CONDUIT DEEP

DATE	12/18/84
BY	...
FOR	...
PROJECT	...
NO.	...
REV.	...
DATE	...
BY	...
FOR	...

EXHIBIT "A-2"

12/18/84

Chicago Pacific

SARPY CO,  
NEBRASKA  
12N-RD 411E

POOR COPY FILED

64-3131

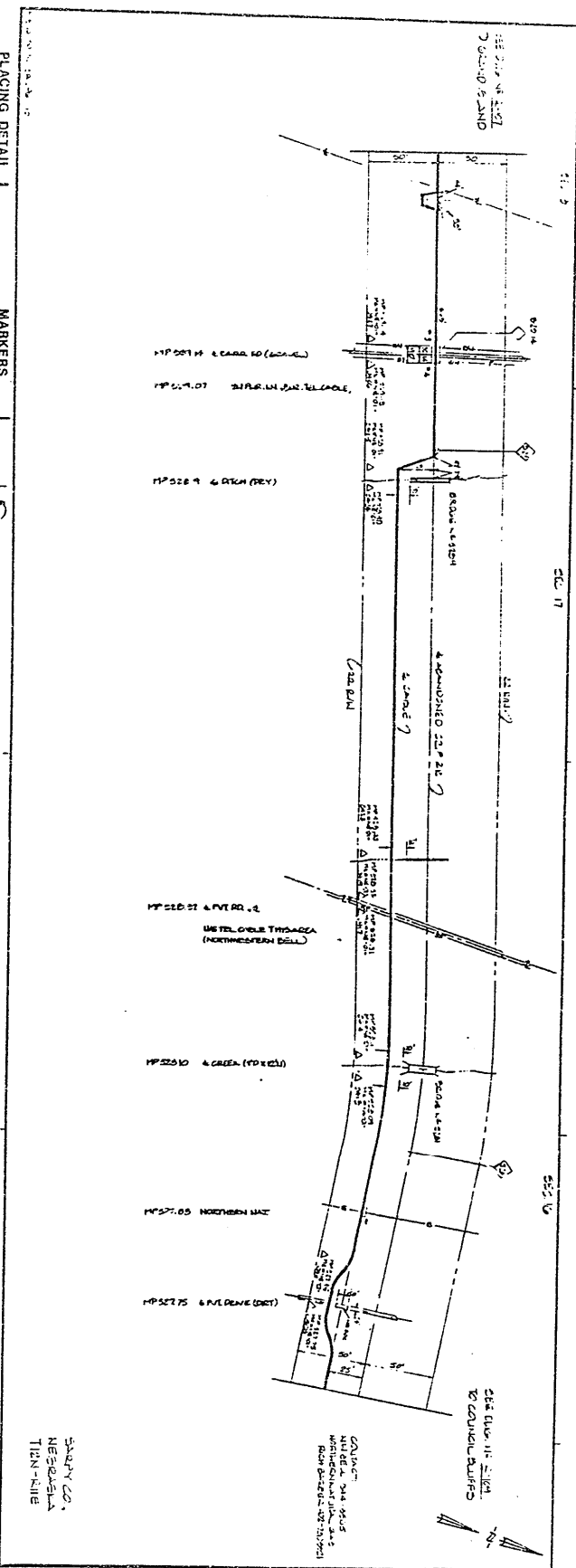

PLACING DETAIL

CABLE
CONDUIT
DATE 3-14-80
BY BJA

MARKERS

MISCELLANEOUS
---------------

US Telephone

ROAD BELONG TO COMPANY
DATE 5-12-87
BY BJA
DATE 5-12-87
BY BJA
DATE 5-12-87
BY BJA
DATE 5-12-87
BY BJA
DATE 5-12-87
BY BJA

EXHIBIT "A-3"

5/12/87

Chicago Pacific

SHAWY CO.  
NEBASKA  
TINN-KITE

**POOR COPY FILED**

60-31319

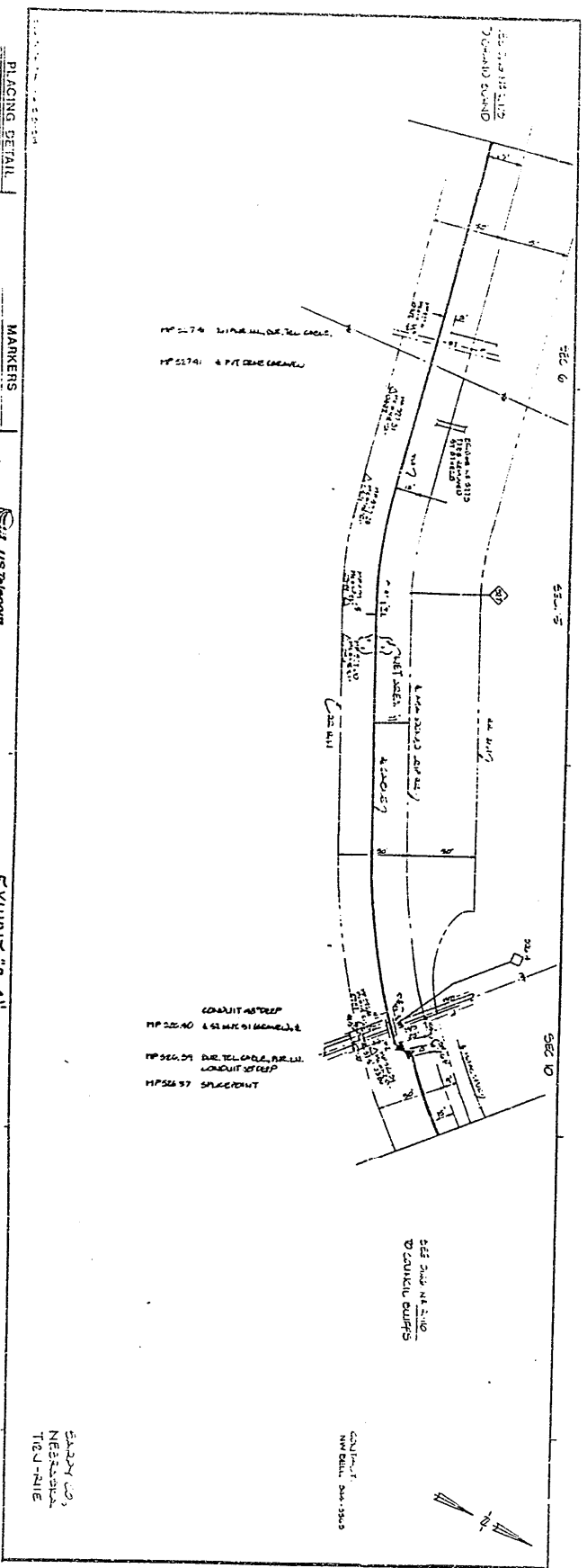

**PLACING DETAIL**  
CABLE  
CONDUIT

**MARKERS**  
MISCELLANEOUS

**US Telephone**  
HANDING TO CONDUIT RUTS

DATE	5/12/87
TIME	1:30 PM
BY	...
FOR	...
PROJECT	...
LOCATION	...
REVISION	...
APPROVED BY	...
DATE	...
PROJECT NO.	...
DATE	...

**EXHIBIT "A-4"**  
5/12/87

*Chicago Pacific*

5/12/87  
NEE:SSB  
T.C.J.-MIE

100-31316

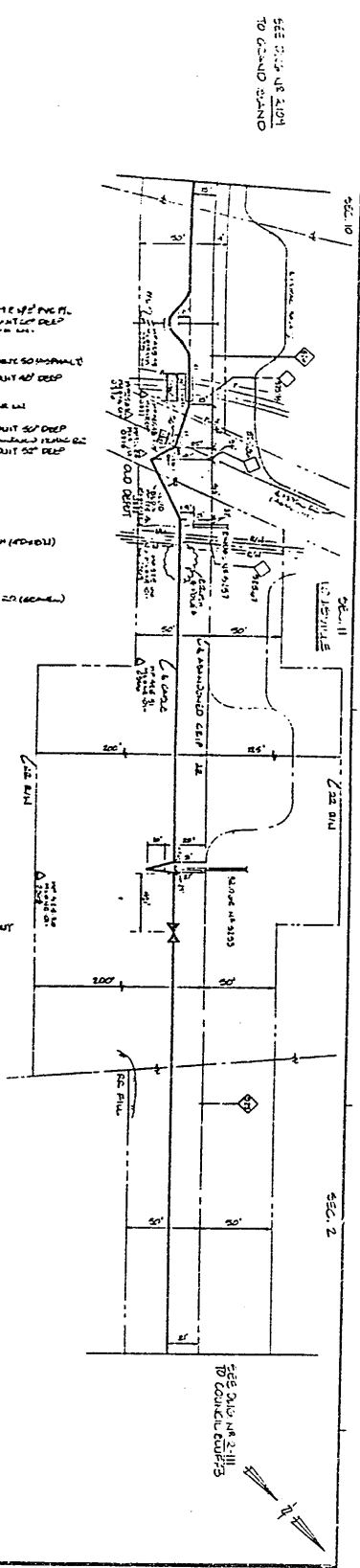

SEE PLAN US 1101  
TO GRAND ISLAND

SEE PLAN US 1111  
TO CONDUIT HEADS

- MP 51.01 2" LINE 40' DEEP  
CONDUIT 40' DEEP
- MP 51.95 2" LINE 40' DEEP  
CONDUIT 40' DEEP
- MP 51.94 2" LINE 40' DEEP  
CONDUIT 40' DEEP
- MP 51.92 2" LINE 40' DEEP  
CONDUIT 40' DEEP
- MP 51.91 2" LINE 40' DEEP  
CONDUIT 40' DEEP
- MP 51.90 2" LINE 40' DEEP  
CONDUIT 40' DEEP
- MP 51.89 2" LINE 40' DEEP  
CONDUIT 40' DEEP
- MP 51.88 2" LINE 40' DEEP  
CONDUIT 40' DEEP
- MP 51.87 2" LINE 40' DEEP  
CONDUIT 40' DEEP
- MP 51.86 2" LINE 40' DEEP  
CONDUIT 40' DEEP
- MP 51.85 2" LINE 40' DEEP  
CONDUIT 40' DEEP
- MP 51.84 2" LINE 40' DEEP  
CONDUIT 40' DEEP
- MP 51.83 2" LINE 40' DEEP  
CONDUIT 40' DEEP
- MP 51.82 2" LINE 40' DEEP  
CONDUIT 40' DEEP
- MP 51.81 2" LINE 40' DEEP  
CONDUIT 40' DEEP
- MP 51.80 2" LINE 40' DEEP  
CONDUIT 40' DEEP
- MP 51.79 2" LINE 40' DEEP  
CONDUIT 40' DEEP
- MP 51.78 2" LINE 40' DEEP  
CONDUIT 40' DEEP
- MP 51.77 2" LINE 40' DEEP  
CONDUIT 40' DEEP
- MP 51.76 2" LINE 40' DEEP  
CONDUIT 40' DEEP
- MP 51.75 2" LINE 40' DEEP  
CONDUIT 40' DEEP
- MP 51.74 2" LINE 40' DEEP  
CONDUIT 40' DEEP
- MP 51.73 2" LINE 40' DEEP  
CONDUIT 40' DEEP
- MP 51.72 2" LINE 40' DEEP  
CONDUIT 40' DEEP
- MP 51.71 2" LINE 40' DEEP  
CONDUIT 40' DEEP
- MP 51.70 2" LINE 40' DEEP  
CONDUIT 40' DEEP
- MP 51.69 2" LINE 40' DEEP  
CONDUIT 40' DEEP
- MP 51.68 2" LINE 40' DEEP  
CONDUIT 40' DEEP
- MP 51.67 2" LINE 40' DEEP  
CONDUIT 40' DEEP
- MP 51.66 2" LINE 40' DEEP  
CONDUIT 40' DEEP
- MP 51.65 2" LINE 40' DEEP  
CONDUIT 40' DEEP
- MP 51.64 2" LINE 40' DEEP  
CONDUIT 40' DEEP
- MP 51.63 2" LINE 40' DEEP  
CONDUIT 40' DEEP
- MP 51.62 2" LINE 40' DEEP  
CONDUIT 40' DEEP
- MP 51.61 2" LINE 40' DEEP  
CONDUIT 40' DEEP
- MP 51.60 2" LINE 40' DEEP  
CONDUIT 40' DEEP
- MP 51.59 2" LINE 40' DEEP  
CONDUIT 40' DEEP
- MP 51.58 2" LINE 40' DEEP  
CONDUIT 40' DEEP
- MP 51.57 2" LINE 40' DEEP  
CONDUIT 40' DEEP
- MP 51.56 2" LINE 40' DEEP  
CONDUIT 40' DEEP
- MP 51.55 2" LINE 40' DEEP  
CONDUIT 40' DEEP
- MP 51.54 2" LINE 40' DEEP  
CONDUIT 40' DEEP
- MP 51.53 2" LINE 40' DEEP  
CONDUIT 40' DEEP
- MP 51.52 2" LINE 40' DEEP  
CONDUIT 40' DEEP
- MP 51.51 2" LINE 40' DEEP  
CONDUIT 40' DEEP
- MP 51.50 2" LINE 40' DEEP  
CONDUIT 40' DEEP
- MP 51.49 2" LINE 40' DEEP  
CONDUIT 40' DEEP
- MP 51.48 2" LINE 40' DEEP  
CONDUIT 40' DEEP
- MP 51.47 2" LINE 40' DEEP  
CONDUIT 40' DEEP
- MP 51.46 2" LINE 40' DEEP  
CONDUIT 40' DEEP
- MP 51.45 2" LINE 40' DEEP  
CONDUIT 40' DEEP
- MP 51.44 2" LINE 40' DEEP  
CONDUIT 40' DEEP
- MP 51.43 2" LINE 40' DEEP  
CONDUIT 40' DEEP
- MP 51.42 2" LINE 40' DEEP  
CONDUIT 40' DEEP
- MP 51.41 2" LINE 40' DEEP  
CONDUIT 40' DEEP
- MP 51.40 2" LINE 40' DEEP  
CONDUIT 40' DEEP
- MP 51.39 2" LINE 40' DEEP  
CONDUIT 40' DEEP
- MP 51.38 2" LINE 40' DEEP  
CONDUIT 40' DEEP
- MP 51.37 2" LINE 40' DEEP  
CONDUIT 40' DEEP
- MP 51.36 2" LINE 40' DEEP  
CONDUIT 40' DEEP
- MP 51.35 2" LINE 40' DEEP  
CONDUIT 40' DEEP
- MP 51.34 2" LINE 40' DEEP  
CONDUIT 40' DEEP
- MP 51.33 2" LINE 40' DEEP  
CONDUIT 40' DEEP
- MP 51.32 2" LINE 40' DEEP  
CONDUIT 40' DEEP
- MP 51.31 2" LINE 40' DEEP  
CONDUIT 40' DEEP
- MP 51.30 2" LINE 40' DEEP  
CONDUIT 40' DEEP
- MP 51.29 2" LINE 40' DEEP  
CONDUIT 40' DEEP
- MP 51.28 2" LINE 40' DEEP  
CONDUIT 40' DEEP
- MP 51.27 2" LINE 40' DEEP  
CONDUIT 40' DEEP
- MP 51.26 2" LINE 40' DEEP  
CONDUIT 40' DEEP
- MP 51.25 2" LINE 40' DEEP  
CONDUIT 40' DEEP
- MP 51.24 2" LINE 40' DEEP  
CONDUIT 40' DEEP
- MP 51.23 2" LINE 40' DEEP  
CONDUIT 40' DEEP
- MP 51.22 2" LINE 40' DEEP  
CONDUIT 40' DEEP
- MP 51.21 2" LINE 40' DEEP  
CONDUIT 40' DEEP
- MP 51.20 2" LINE 40' DEEP  
CONDUIT 40' DEEP
- MP 51.19 2" LINE 40' DEEP  
CONDUIT 40' DEEP
- MP 51.18 2" LINE 40' DEEP  
CONDUIT 40' DEEP
- MP 51.17 2" LINE 40' DEEP  
CONDUIT 40' DEEP
- MP 51.16 2" LINE 40' DEEP  
CONDUIT 40' DEEP
- MP 51.15 2" LINE 40' DEEP  
CONDUIT 40' DEEP
- MP 51.14 2" LINE 40' DEEP  
CONDUIT 40' DEEP
- MP 51.13 2" LINE 40' DEEP  
CONDUIT 40' DEEP
- MP 51.12 2" LINE 40' DEEP  
CONDUIT 40' DEEP
- MP 51.11 2" LINE 40' DEEP  
CONDUIT 40' DEEP
- MP 51.10 2" LINE 40' DEEP  
CONDUIT 40' DEEP
- MP 51.09 2" LINE 40' DEEP  
CONDUIT 40' DEEP
- MP 51.08 2" LINE 40' DEEP  
CONDUIT 40' DEEP
- MP 51.07 2" LINE 40' DEEP  
CONDUIT 40' DEEP
- MP 51.06 2" LINE 40' DEEP  
CONDUIT 40' DEEP
- MP 51.05 2" LINE 40' DEEP  
CONDUIT 40' DEEP
- MP 51.04 2" LINE 40' DEEP  
CONDUIT 40' DEEP
- MP 51.03 2" LINE 40' DEEP  
CONDUIT 40' DEEP
- MP 51.02 2" LINE 40' DEEP  
CONDUIT 40' DEEP
- MP 51.01 2" LINE 40' DEEP  
CONDUIT 40' DEEP

SADPT CO.  
NEBRASKA  
TOWN - RAIL

PLACING DETAIL

CABLE	
CONDUIT	

MARKERS

--	--

MISCELLANEOUS

US TELECOM	
GRAND ISLAND TO CONDUIT HEADS	
DATE	5/12/87
BY	
FOR	
APPROVED BY	
DATE	
BY	
DATE	

EXHIBIT "H-5"  
5/12/87

*Chicago Pacific*





PL	FIG. DETAIL
CABLE	
CONDUIT	

US TELEPHONE	
GRAND ISLAND TO COUNCIL BLUFFS	
NO.	3112
ITEM NO.	3112
DATE	5/12/87
BY	...
FOR	...
APPROVED BY	...
DATE	...
BY	...
DATE	...

EXHIBIT "H-7"  
5/12/87

*Chicago Pacific*

SARPT CO.,  
NEBRASKA  
TDN-R11412B

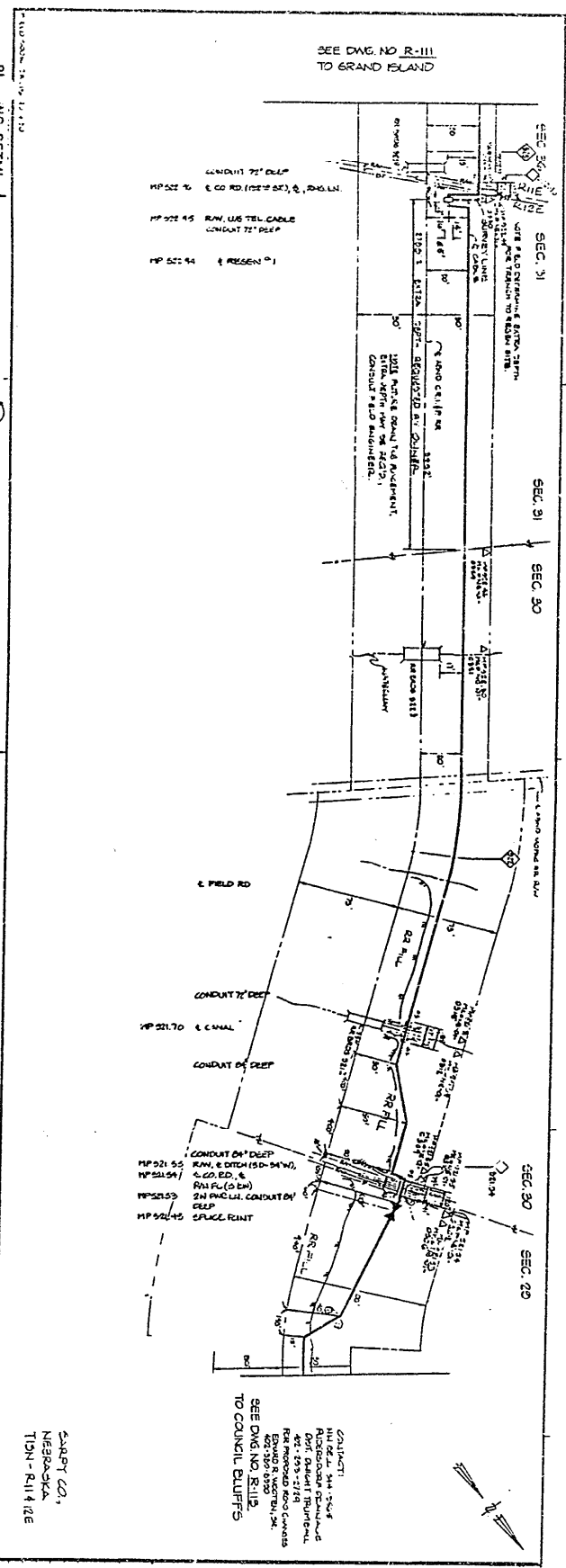

SEE DWG. NO. R-III  
TO GRAND ISLAND

- MP 522 75 CONDUIT 72" DEEP
- MP 522 45 RAW, US TEL. CABLE CONDUIT 72" DEEP
- MP 522 44 RESEN. 0'

CONTACT:  
RICHARDSON & COOK  
PORT GARDNER BUILDING  
427 293-2784  
PORT GARDNER, NEBRASKA  
68130-0000

**POOR COPY FILED**

60-3131

60-31315

**POOR COPY FILED**

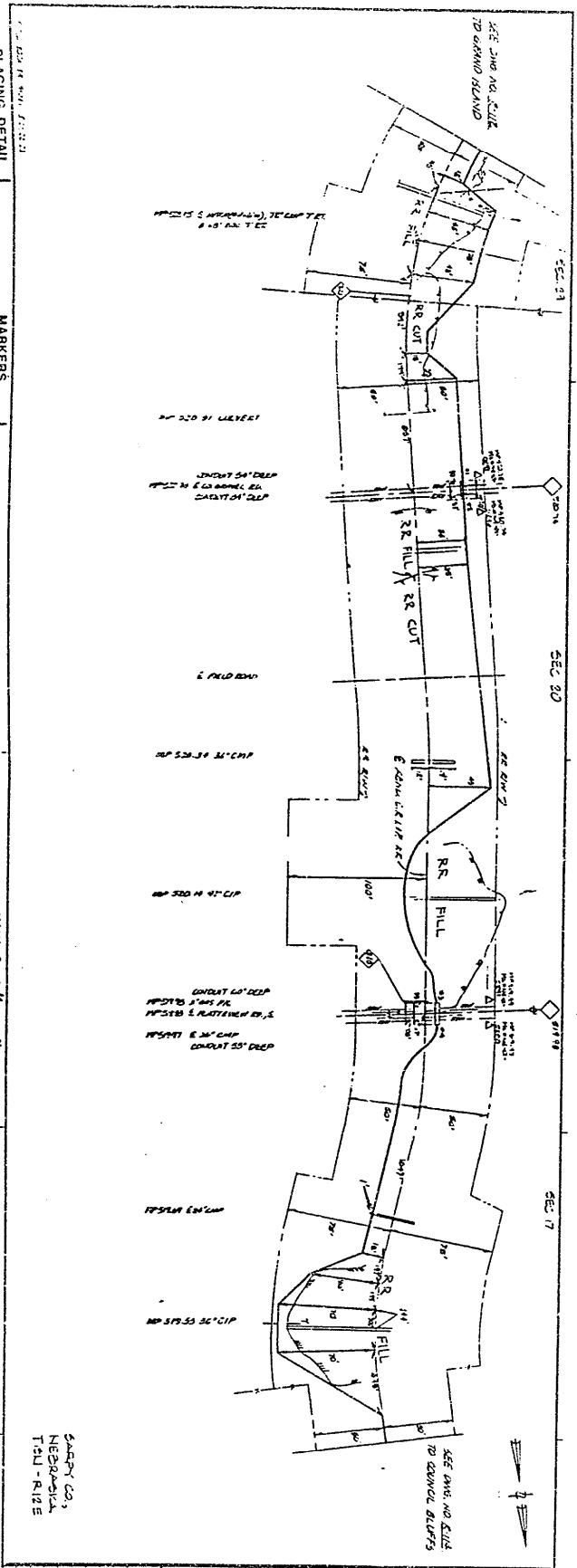

PLACING DETAIL

CABLE
CONDUIT
1" - 20' x 4" 0"
3" - 100' x 4" 0"

MARKERS

MISCELLANEOUS
---------------

US Railroad

DATE PLANNED TO CONDUIT
NO. 1
NO. 2
NO. 3
NO. 4
NO. 5
NO. 6
NO. 7
NO. 8
NO. 9
NO. 10
NO. 11
NO. 12
NO. 13
NO. 14
NO. 15
NO. 16
NO. 17
NO. 18
NO. 19
NO. 20
NO. 21
NO. 22
NO. 23
NO. 24
NO. 25
NO. 26
NO. 27
NO. 28
NO. 29
NO. 30
NO. 31
NO. 32
NO. 33
NO. 34
NO. 35
NO. 36
NO. 37
NO. 38
NO. 39
NO. 40
NO. 41
NO. 42
NO. 43
NO. 44
NO. 45
NO. 46
NO. 47
NO. 48
NO. 49
NO. 50
NO. 51
NO. 52
NO. 53
NO. 54
NO. 55
NO. 56
NO. 57
NO. 58
NO. 59
NO. 60
NO. 61
NO. 62
NO. 63
NO. 64
NO. 65
NO. 66
NO. 67
NO. 68
NO. 69
NO. 70
NO. 71
NO. 72
NO. 73
NO. 74
NO. 75
NO. 76
NO. 77
NO. 78
NO. 79
NO. 80
NO. 81
NO. 82
NO. 83
NO. 84
NO. 85
NO. 86
NO. 87
NO. 88
NO. 89
NO. 90
NO. 91
NO. 92
NO. 93
NO. 94
NO. 95
NO. 96
NO. 97
NO. 98
NO. 99
NO. 100

EXHIBIT "A-8"  
5/12/87

*Chicago Pacific*

SAGOPY CO.,  
MEMPHIS,  
TENN - R12E

POOR COPY FILED

60-3131K

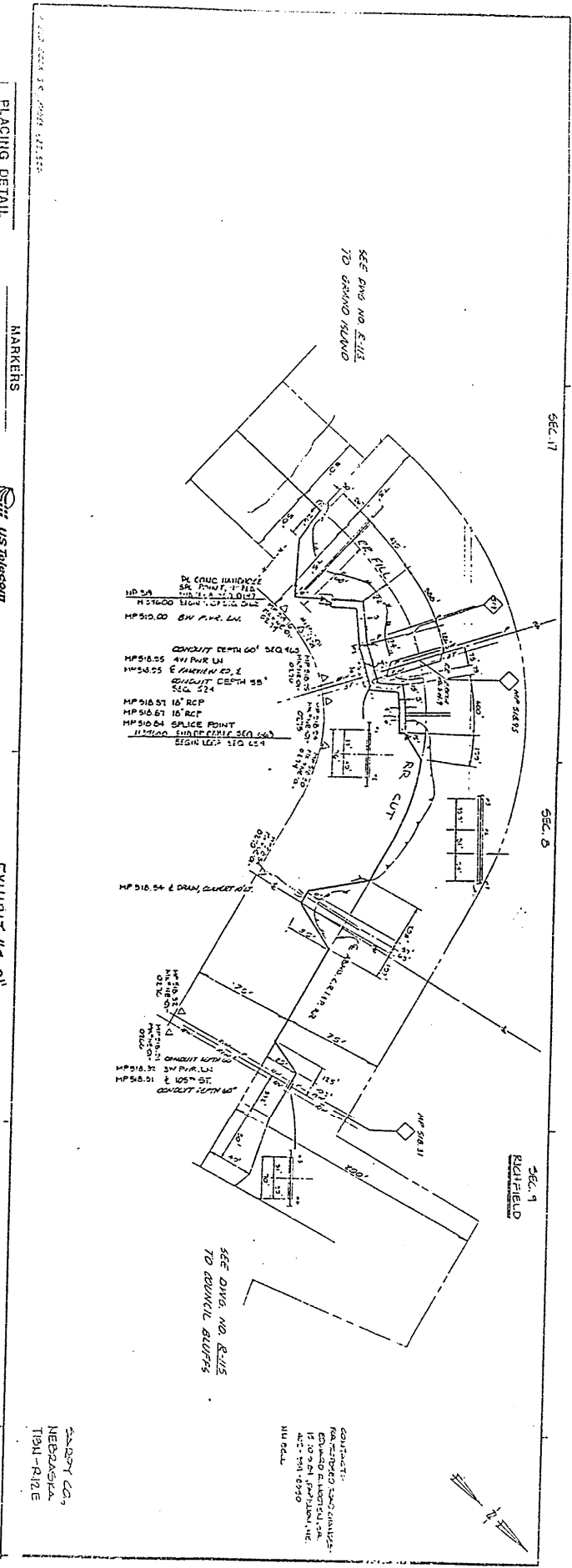

**POOR COPY FILED**

60-3131b

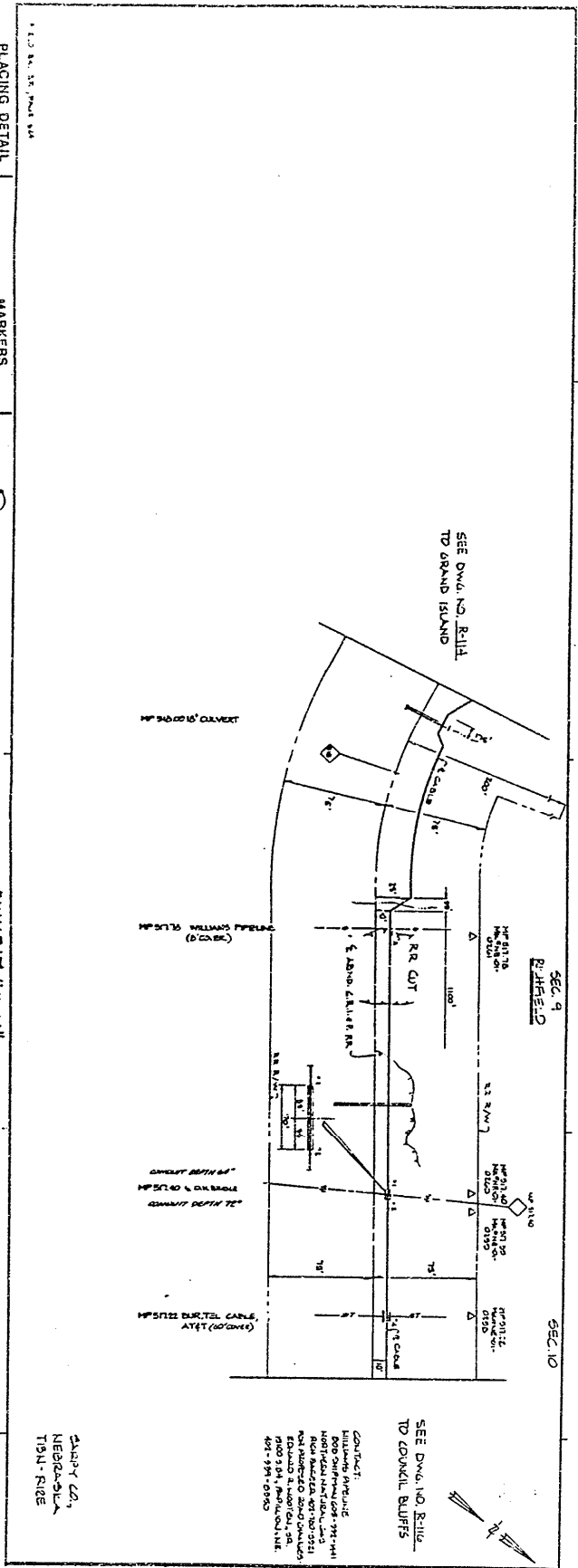

PLACING DETAIL

CABLE	
CONDUIT	
MARKER	
NO. OF MARKERS	

MARKERS

MISCELLANEOUS	
MARKER	
NO. OF MARKERS	

US Telecom

DATE	5/12/87
TIME	10:30 AM
BY	...
FOR	...
PROJECT	...
NO.	...
REV.	...
DATE	...
BY	...
FOR	...

EXHIBIT "H-10"  
5/12/87

*Chicago Pacific*

SEE DWG. NO. R-114  
TO COUNCIL BUFFS

CONTRACT:  
BUILDING PERMITTING  
1001 N. LAKE ST. CHICAGO, ILL.  
1001 N. LAKE ST. CHICAGO, ILL.  
1001 N. LAKE ST. CHICAGO, ILL.  
1001 N. LAKE ST. CHICAGO, ILL.  
1001 N. LAKE ST. CHICAGO, ILL.  
1001 N. LAKE ST. CHICAGO, ILL.  
1001 N. LAKE ST. CHICAGO, ILL.  
1001 N. LAKE ST. CHICAGO, ILL.

THAYER CO.,  
NEARBY  
TISH - RICE

**POOR COPY FILED**

60-2131 M

SEE DWG. NO. E-115  
TO GRAND ISLAND

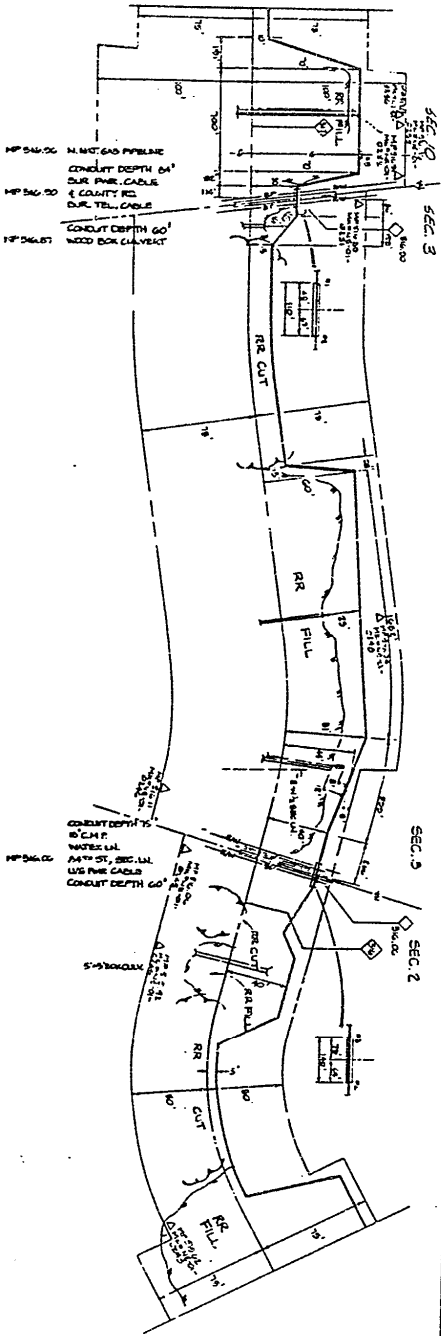

SEE DWG. NO. E-117  
TO COUNCIL BLUFFS

CONTRACTS  
 FOR THE  
 LAYING OF  
 CABLES  
 BETWEEN  
 COUNCIL BLUFFS  
 AND GRAND ISLAND  
 IOWA  
 RICH BARBER, INC. 1931

SARPY CO  
 WEBERISA  
 T 331-N-818E

PLACING DETAIL

CABLE
CONDUIT
1-2 1/2" 4" D.P.
3-4 1/2" 4" D.P.

MARKERS

--

MISCELLANEOUS

--

US Telephone

ORDER BLANK TO COUNCIL BLUFFS
NO. 1
NO. 2
NO. 3
NO. 4
NO. 5
NO. 6
NO. 7
NO. 8
NO. 9
NO. 10
NO. 11
NO. 12
NO. 13
NO. 14
NO. 15
NO. 16
NO. 17
NO. 18
NO. 19
NO. 20
NO. 21
NO. 22
NO. 23
NO. 24
NO. 25
NO. 26
NO. 27
NO. 28
NO. 29
NO. 30
NO. 31
NO. 32
NO. 33
NO. 34
NO. 35
NO. 36
NO. 37
NO. 38
NO. 39
NO. 40
NO. 41
NO. 42
NO. 43
NO. 44
NO. 45
NO. 46
NO. 47
NO. 48
NO. 49
NO. 50
NO. 51
NO. 52
NO. 53
NO. 54
NO. 55
NO. 56
NO. 57
NO. 58
NO. 59
NO. 60
NO. 61
NO. 62
NO. 63
NO. 64
NO. 65
NO. 66
NO. 67
NO. 68
NO. 69
NO. 70
NO. 71
NO. 72
NO. 73
NO. 74
NO. 75
NO. 76
NO. 77
NO. 78
NO. 79
NO. 80
NO. 81
NO. 82
NO. 83
NO. 84
NO. 85
NO. 86
NO. 87
NO. 88
NO. 89
NO. 90
NO. 91
NO. 92
NO. 93
NO. 94
NO. 95
NO. 96
NO. 97
NO. 98
NO. 99
NO. 100

EXHIBIT "A-11"  
 5/12/87

*Chicago Pacific*

**POOR COPY FILED**

60-3131W

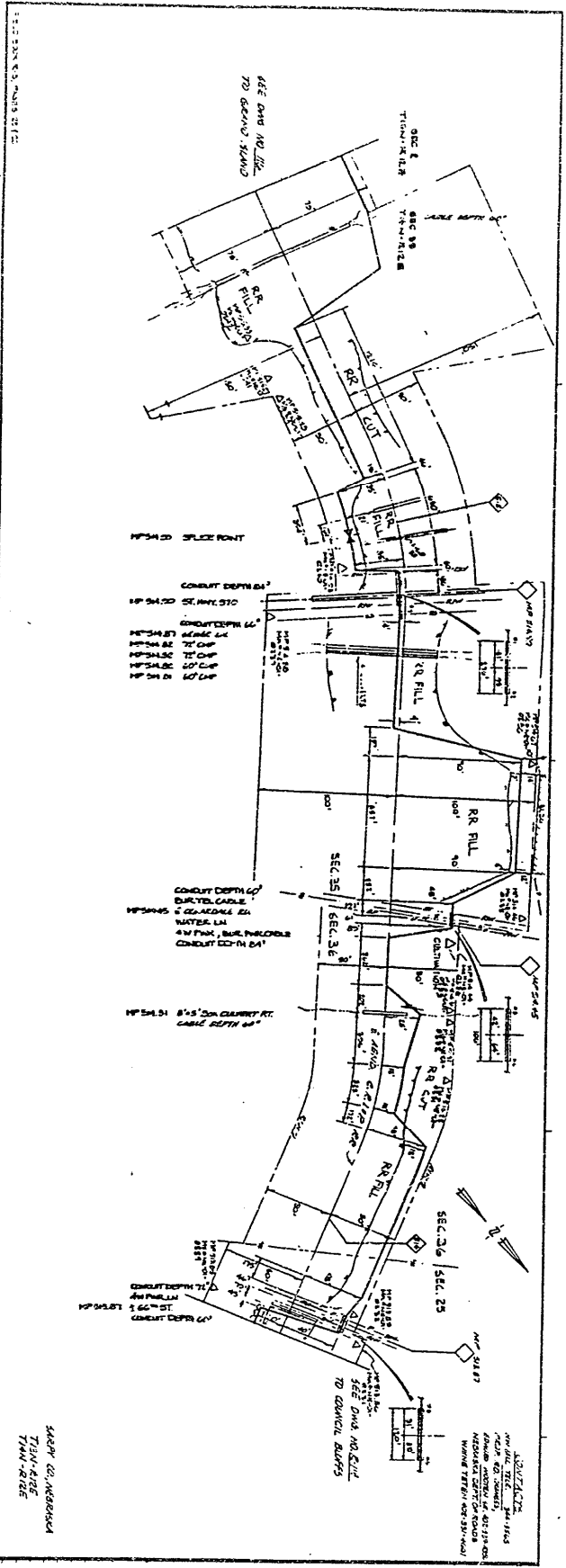

**PLACING DETAIL**

**CABLE**

1	100' 4' 0"
2	100' 4' 0"
3	100' 4' 0"
4	100' 4' 0"
5	100' 4' 0"
6	100' 4' 0"
7	100' 4' 0"
8	100' 4' 0"
9	100' 4' 0"
10	100' 4' 0"
11	100' 4' 0"
12	100' 4' 0"
13	100' 4' 0"
14	100' 4' 0"
15	100' 4' 0"
16	100' 4' 0"
17	100' 4' 0"
18	100' 4' 0"
19	100' 4' 0"
20	100' 4' 0"
21	100' 4' 0"
22	100' 4' 0"
23	100' 4' 0"
24	100' 4' 0"
25	100' 4' 0"
26	100' 4' 0"
27	100' 4' 0"
28	100' 4' 0"
29	100' 4' 0"
30	100' 4' 0"
31	100' 4' 0"
32	100' 4' 0"
33	100' 4' 0"
34	100' 4' 0"
35	100' 4' 0"
36	100' 4' 0"
37	100' 4' 0"
38	100' 4' 0"
39	100' 4' 0"
40	100' 4' 0"
41	100' 4' 0"
42	100' 4' 0"
43	100' 4' 0"
44	100' 4' 0"
45	100' 4' 0"
46	100' 4' 0"
47	100' 4' 0"
48	100' 4' 0"
49	100' 4' 0"
50	100' 4' 0"
51	100' 4' 0"
52	100' 4' 0"
53	100' 4' 0"
54	100' 4' 0"
55	100' 4' 0"
56	100' 4' 0"
57	100' 4' 0"
58	100' 4' 0"
59	100' 4' 0"
60	100' 4' 0"
61	100' 4' 0"
62	100' 4' 0"
63	100' 4' 0"
64	100' 4' 0"
65	100' 4' 0"
66	100' 4' 0"
67	100' 4' 0"
68	100' 4' 0"
69	100' 4' 0"
70	100' 4' 0"
71	100' 4' 0"
72	100' 4' 0"
73	100' 4' 0"
74	100' 4' 0"
75	100' 4' 0"
76	100' 4' 0"
77	100' 4' 0"
78	100' 4' 0"
79	100' 4' 0"
80	100' 4' 0"
81	100' 4' 0"
82	100' 4' 0"
83	100' 4' 0"
84	100' 4' 0"
85	100' 4' 0"
86	100' 4' 0"
87	100' 4' 0"
88	100' 4' 0"
89	100' 4' 0"
90	100' 4' 0"
91	100' 4' 0"
92	100' 4' 0"
93	100' 4' 0"
94	100' 4' 0"
95	100' 4' 0"
96	100' 4' 0"
97	100' 4' 0"
98	100' 4' 0"
99	100' 4' 0"
100	100' 4' 0"

**CONDUIT**

1	100' 4' 0"
2	100' 4' 0"
3	100' 4' 0"
4	100' 4' 0"
5	100' 4' 0"
6	100' 4' 0"
7	100' 4' 0"
8	100' 4' 0"
9	100' 4' 0"
10	100' 4' 0"
11	100' 4' 0"
12	100' 4' 0"
13	100' 4' 0"
14	100' 4' 0"
15	100' 4' 0"
16	100' 4' 0"
17	100' 4' 0"
18	100' 4' 0"
19	100' 4' 0"
20	100' 4' 0"
21	100' 4' 0"
22	100' 4' 0"
23	100' 4' 0"
24	100' 4' 0"
25	100' 4' 0"
26	100' 4' 0"
27	100' 4' 0"
28	100' 4' 0"
29	100' 4' 0"
30	100' 4' 0"
31	100' 4' 0"
32	100' 4' 0"
33	100' 4' 0"
34	100' 4' 0"
35	100' 4' 0"
36	100' 4' 0"
37	100' 4' 0"
38	100' 4' 0"
39	100' 4' 0"
40	100' 4' 0"
41	100' 4' 0"
42	100' 4' 0"
43	100' 4' 0"
44	100' 4' 0"
45	100' 4' 0"
46	100' 4' 0"
47	100' 4' 0"
48	100' 4' 0"
49	100' 4' 0"
50	100' 4' 0"
51	100' 4' 0"
52	100' 4' 0"
53	100' 4' 0"
54	100' 4' 0"
55	100' 4' 0"
56	100' 4' 0"
57	100' 4' 0"
58	100' 4' 0"
59	100' 4' 0"
60	100' 4' 0"
61	100' 4' 0"
62	100' 4' 0"
63	100' 4' 0"
64	100' 4' 0"
65	100' 4' 0"
66	100' 4' 0"
67	100' 4' 0"
68	100' 4' 0"
69	100' 4' 0"
70	100' 4' 0"
71	100' 4' 0"
72	100' 4' 0"
73	100' 4' 0"
74	100' 4' 0"
75	100' 4' 0"
76	100' 4' 0"
77	100' 4' 0"
78	100' 4' 0"
79	100' 4' 0"
80	100' 4' 0"
81	100' 4' 0"
82	100' 4' 0"
83	100' 4' 0"
84	100' 4' 0"
85	100' 4' 0"
86	100' 4' 0"
87	100' 4' 0"
88	100' 4' 0"
89	100' 4' 0"
90	100' 4' 0"
91	100' 4' 0"
92	100' 4' 0"
93	100' 4' 0"
94	100' 4' 0"
95	100' 4' 0"
96	100' 4' 0"
97	100' 4' 0"
98	100' 4' 0"
99	100' 4' 0"
100	100' 4' 0"

**MARKERS**

**MISCELLANEOUS**

1	100' 4' 0"
2	100' 4' 0"
3	100' 4' 0"
4	100' 4' 0"
5	100' 4' 0"
6	100' 4' 0"
7	100' 4' 0"
8	100' 4' 0"
9	100' 4' 0"
10	100' 4' 0"
11	100' 4' 0"
12	100' 4' 0"
13	100' 4' 0"
14	100' 4' 0"
15	100' 4' 0"
16	100' 4' 0"
17	100' 4' 0"
18	100' 4' 0"
19	100' 4' 0"
20	100' 4' 0"
21	100' 4' 0"
22	100' 4' 0"
23	100' 4' 0"
24	100' 4' 0"
25	100' 4' 0"
26	100' 4' 0"
27	100' 4' 0"
28	100' 4' 0"
29	100' 4' 0"
30	100' 4' 0"
31	100' 4' 0"
32	100' 4' 0"
33	100' 4' 0"
34	100' 4' 0"
35	100' 4' 0"
36	100' 4' 0"
37	100' 4' 0"
38	100' 4' 0"
39	100' 4' 0"
40	100' 4' 0"
41	100' 4' 0"
42	100' 4' 0"
43	100' 4' 0"
44	100' 4' 0"
45	100' 4' 0"
46	100' 4' 0"
47	100' 4' 0"
48	100' 4' 0"
49	100' 4' 0"
50	100' 4' 0"
51	100' 4' 0"
52	100' 4' 0"
53	100' 4' 0"
54	100' 4' 0"
55	100' 4' 0"
56	100' 4' 0"
57	100' 4' 0"
58	100' 4' 0"
59	100' 4' 0"
60	100' 4' 0"
61	100' 4' 0"
62	100' 4' 0"
63	100' 4' 0"
64	100' 4' 0"
65	100' 4' 0"
66	100' 4' 0"
67	100' 4' 0"
68	100' 4' 0"
69	100' 4' 0"
70	100' 4' 0"
71	100' 4' 0"
72	100' 4' 0"
73	100' 4' 0"
74	100' 4' 0"
75	100' 4' 0"
76	100' 4' 0"
77	100' 4' 0"
78	100' 4' 0"
79	100' 4' 0"
80	100' 4' 0"
81	100' 4' 0"
82	100' 4' 0"
83	100' 4' 0"
84	100' 4' 0"
85	100' 4' 0"
86	100' 4' 0"
87	100' 4' 0"
88	100' 4' 0"
89	100' 4' 0"
90	100' 4' 0"
91	100' 4' 0"
92	100' 4' 0"
93	100' 4' 0"
94	100' 4' 0"
95	100' 4' 0"
96	100' 4' 0"
97	100' 4' 0"
98	100' 4' 0"
99	100' 4' 0"
100	100' 4' 0"

EXHIBIT "A-12"  
5/12/87

*Chicago Pacific*

3449 W. WASHINGTON  
CHICAGO, ILL. 60644  
773-472-2100

NOT TO SCALE  
ALL DIMENSIONS IN FEET AND INCHES  
UNLESS OTHERWISE SPECIFIED  
CONDUIT SHALL BE 1/2" WALL THICKNESS  
UNLESS OTHERWISE SPECIFIED

POOR COPY FILED

60-3131 0.

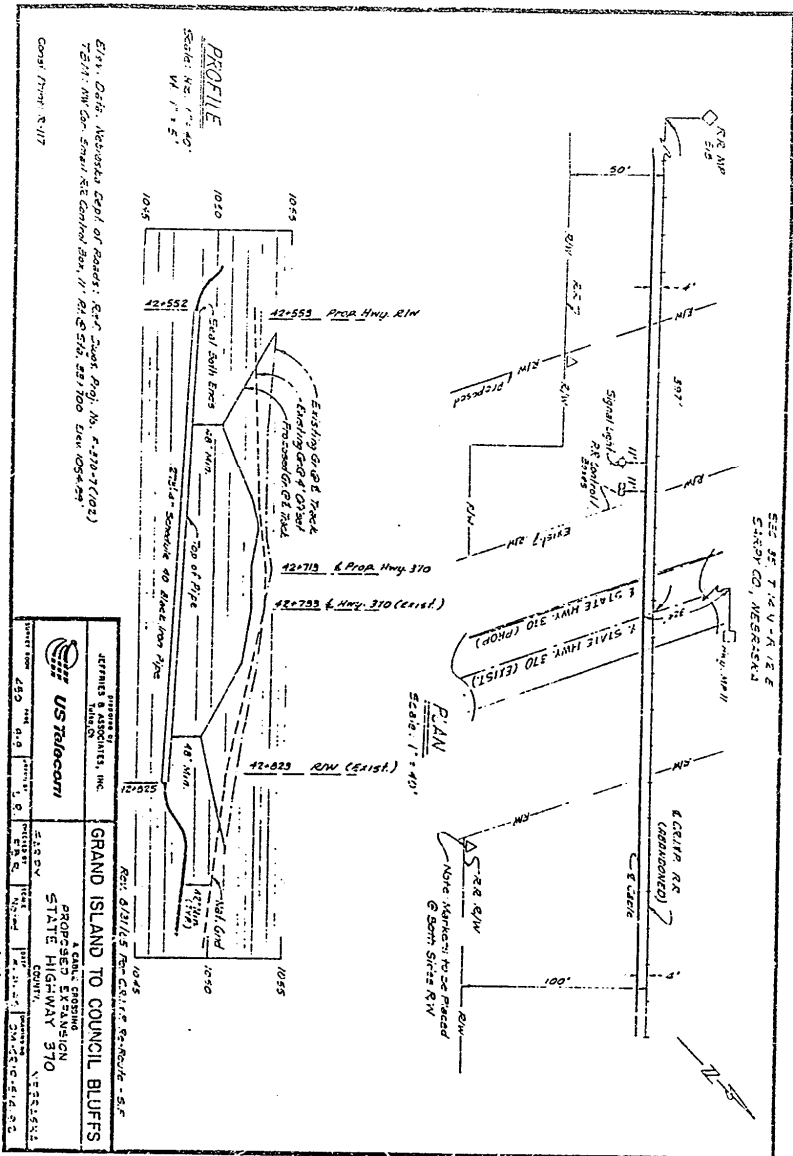

		PROJECT OF <b>DEFENS &amp; ASSOCIATES, INC.</b> 1000 N. 10th St. Lincoln, NE 68502	
GRAND ISLAND TO COUNCIL BLUFFS A GALE CROSSING PROPOSED EXTENSION STATE HIGHWAY 370 NEBRASKA COUNTY		Rev. 01/11/05 Rev. 01/11/05 Rev. 01/11/05 Rev. 01/11/05	
SHEET NO. 450 OF 450	DATE 5/12/07	DRAWN BY [Name]	CHECKED BY [Name]

GRAND ISLAND TO COUNCIL BLUFFS A GALE CROSSING PROPOSED EXTENSION STATE HIGHWAY 370 NEBRASKA COUNTY	SHEET NO. 450 OF 450 DATE 5/12/07 DRAWN BY [Name] CHECKED BY [Name]

*Chicago Pacific*

EXHIBIT "A-13"  
5/12/07

**PROFILE**  
Scale: HZ. 1" = 40'  
V. 1" = 5'  
Elev. Data: Nebraska Dept. of Roads: Ref. Supp. Proj. No. 6-419-1(02)  
7811 NW Cor. Small Rectangular Box, 1/4" R/S 51/2, 231700 Elev. 1054.49'  
Comp. From 5/17

SEE SET T-14 V-A 1 & 2  
SARBY CO., NEBRASKA

**PLAN**  
Scale: 1" = 40'

Note: Markers to be placed @ both State R/W





**POOR COPY FILED**

5-31312

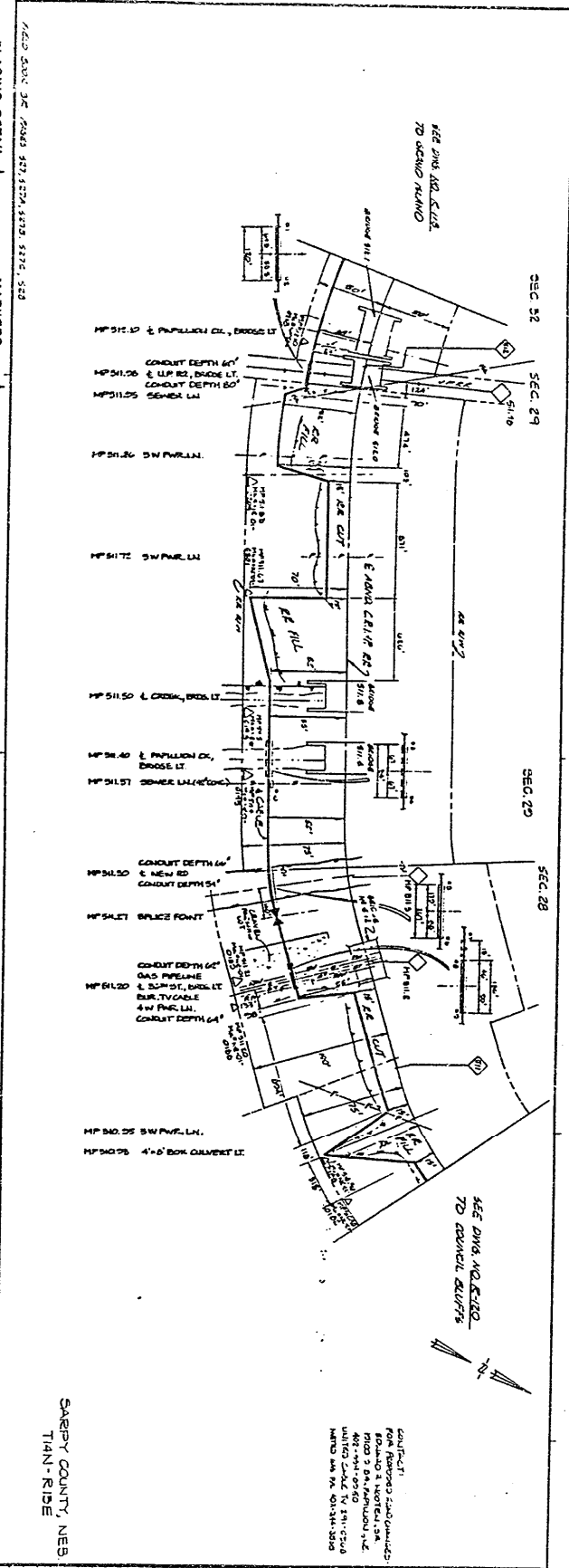

PLACING DETAIL

CABLE
CONDUIT

MARKERS

MISCELLANEOUS
ONE "D" PLANK

US Telecom

STANDARD DRAWING TO CONDUIT SYSTEMS
DATE: 11/87
REVISED BY: [Signature]
DESIGNED BY: [Signature]
CHECKED BY: [Signature]
DATE: 5/12/87

EXHIBIT "A-15"  
5/12/87

*Chicago Pacific*

SARPY COUNTY, NEB  
TIAN-RIDE

CONDUIT  
FOR FIBER OPTIC CABLES  
ELECTRICITY  
AND TELEPHONE  
CABLES  
UNITS: 1/2" - 1/4"  
MATERIAL: PVC  
MATERIAL: 1/2" - 1/4"



POOR COPY FILED

60-31315

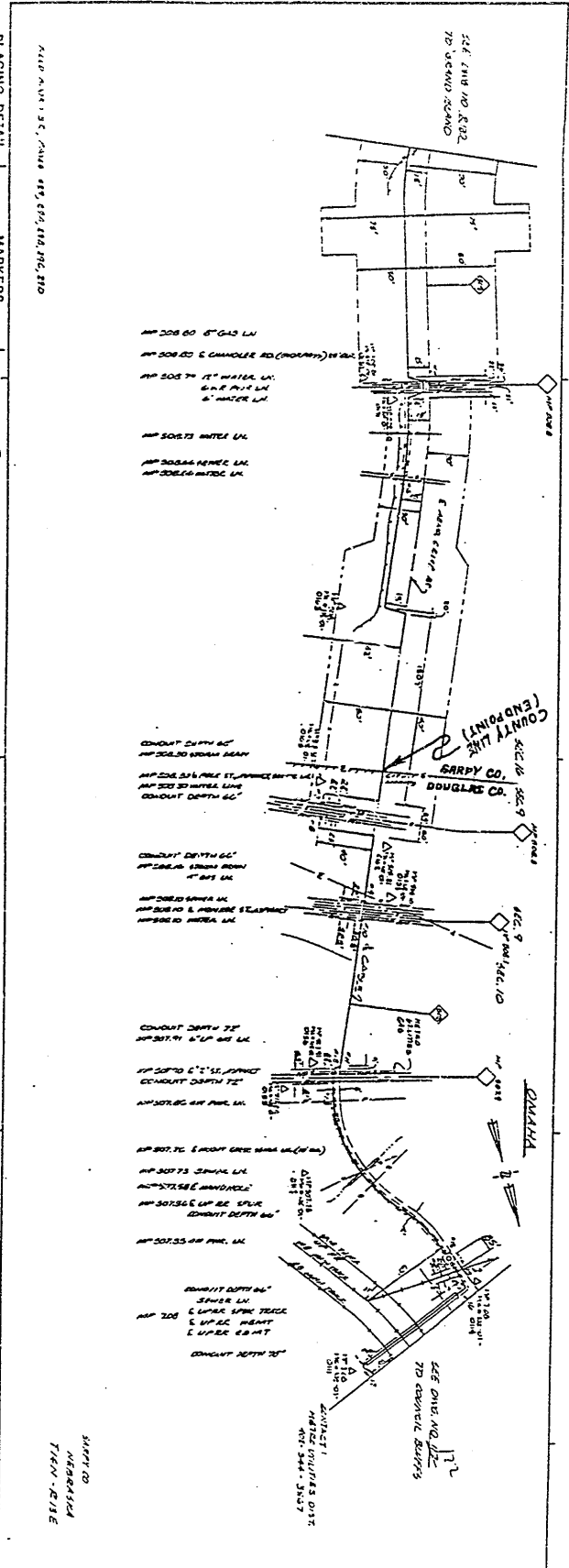

PLACING DETAIL

CABLE
CONDUIT

MARKERS

MISCELLANEOUS

US District

DATE	5/12/87
BY	[Signature]
FOR	CHICAGO PACIFIC

EXHIBIT "A-17"  
5/12/87

Chicago Pacific

SHIPPED  
MARRIETTA  
TYEN - 213E