

201101931

Page 1 of 4

FILED  
OTOE COUNTY, NE  
FEE \$ 25.50

2011 AUG 3 PM 1 41

*Janet R. Reed*

REGISTER OF DEEDS

ENTERED ☒  
VERIFIED ☒  
SCANNED ☒

ORDINANCE NO. 2853-11

AN ORDINANCE TO VACATE PORTIONS OF 7<sup>th</sup> CORSO, 5<sup>th</sup> STREET, 8<sup>th</sup> CORSO, AND 7<sup>th</sup> STREET, AND PORTIONS OF ALLEYS IN BLOCKS 46, 51, AND 68, ALL IN SOUTH NEBRASKA CITY ADDITION TO NEBRASKA CITY, OTOE COUNTY, NEBRASKA, MORE SPECIFICALLY DESCRIBED IN SECTIONS 1 THROUGH 7 HEREOF, AND RESERVING TITLE TO THE SAME IN THE NAME OF THE CITY OF NEBRASKA CITY, OTOE COUNTY, NEBRASKA; AND TO DECLARE AN EFFECTIVE DATE.

WHEREAS, the Southeast Nebraska Grain Company, LLC, has requested that portions of 7<sup>th</sup> Corso, 5<sup>th</sup> Street, 8<sup>th</sup> Corso, and 7<sup>th</sup> Street, all in South Nebraska City Addition to Nebraska City, Otoe County, Nebraska, as more particularly described in Sections 1 through 4 hereof, and portions of the alleys in Blocks 46, 51, and 68, all in South Nebraska City Addition to Nebraska City, Otoe County, Nebraska, as more particularly described in Section 5 through 7 hereof, be vacated for the purpose of selling the same to the Southeast Nebraska Grain Company, LLC, and

WHEREAS, because of the location of said parcels, the Mayor and City Commissioners of the City of Nebraska City, Nebraska, find and determine the City no longer has a need for said parcels as described in Sections 1 through 7 hereof, and hereby approve the application to vacate said parcels.

NOW THEREFORE, BE IT ORDAINED BY THE MAYOR AND CITY COMMISSIONERS OF THE CITY OF NEBRASKA CITY, NEBRASKA as follows:

SECTION 1. That parcel of land located in South Nebraska City Addition, Nebraska City, Nebraska, more particularly described as follows: Beginning at the Southeast corner of Lot 10, Block 46 of said South Nebraska City Addition; thence S89°12'46"E (assumed bearing), a distance of 97.7 feet to the North Right of way line of the Union Pacific Railroad on the South line of Lot 6, Block 47 of said Addition; thence S54°38'15"W on said North railroad Right of way line, a distance of 120.23 feet to the Southeasterly extension of the East line of said Block 46; thence N00°17'20"E on the extension of said East line, a distance of 70.93 feet to the Point of Beginning, containing 3,464 square feet, more or less, by and the same is hereby vacated and title to the same is hereby reserved unto the City of Nebraska City, Otoe County, Nebraska.

201101931

SECTION 2. That parcel of land located in South Nebraska City Addition, Nebraska City, Nebraska, more particularly described as follows: Beginning at the Southeast corner of Lot 1, Block 52, of said South Nebraska City Addition; thence S89°07'30"E (Assumed bearing) a distance of 80.00 feet to the Southwest Corner of Lot 5, Block 51 of said Addition; thence S00°23'19"W on the West line of said Block 51, a distance of 26.78 feet to the North Right of way line of the Union Pacific Railroad; thence S55°32'22"W on said North railroad Right of way line, a distance of 97.48 feet to the East line of Block 52 of said Addition; thence N00°23'19"E on the East line of said Block 52, a distance of 83.16 feet to the Point of Beginning, containing 4,397 square feet more or less, by and the same is hereby vacated and title to the same is hereby reserved unto the City of Nebraska City, Otoe County, Nebraska.

SECTION 3. That parcel of land located in South Nebraska City Addition, Nebraska City, Nebraska, more particularly described as follows: Beginning at the Southwest corner of Lot 6, Block 52, of said South Nebraska City Addition; thence S89°02'13"E (Assumed bearing) on the South line of Lots 6 through 8 inclusive, of said Block 52, a distance of 140.39 feet to the North Right of way line of the Union Pacific Railroad; thence S54°40'35"W on said North railroad Right of way line, a distance of 135.18 feet to the North line of Lot 5, Block 69 of said Addition; thence N89°02'13"W on the North line of said Lot 5, a distance of 30.69 feet to the Northwest corner of said Lot 5; thence N00°26'19"E, a distance of 80.00 feet to the Point of Beginning, containing 6,843 square feet more or less, by and the same is hereby vacated and title to the same is hereby reserved unto the City of Nebraska City, Otoe County, Nebraska.

SECTION 4. That parcel of land located in South Nebraska City Addition, Nebraska City, Nebraska, more particularly described as follows: Beginning at the Southwest corner of Lot 5, Block 68, of said South Nebraska City Addition; thence S00°29'20"W (Assumed bearing) on the West line of said Block 68, a distance of 37.74 feet to the North Right of way line of the OPPD Railroad Switch Track; thence Southwesterly on said North Railroad Right of way line, on a 736.50 foot radius curve to the right, an arc distance of 83.95 feet to the East line of Block 67 of said Addition, the Chord of said curve bears S72°56'34"W, 83.90 feet; thence N00°29'20"E on the East line of said Block 67, a distance of 63.70 feet to the Southeast Corner of Lot 1 of Block 67; thence S89°02'14"E, a distance of 80.00 feet to the Point of Beginning, containing 4,124 square feet more or less, by and the same is hereby vacated and title to the same is hereby reserved unto the City of Nebraska City, Otoe County, Nebraska.

SECTION 5. That parcel of land located in Block 46, South Nebraska City Addition to Nebraska City, Nebraska, more particularly described as follows: Beginning at the Northeast corner of Lot 10, Block 46 of said South Nebraska City Addition; thence N89°11'41"W (Assumed bearing) on the North line of said Lot 10, a distance of 49.59 feet to the South Right of way line of the OPPD Railroad side track; thence S58°16'24"E on said South right of way line, a distance of 37.19 feet to the South line of Lot 1 in said Block 46; thence S89°11'41"E on said

South line, a distance of 18.04 feet to the West right of line of 4<sup>th</sup> Street; thence S00°14'24"W on said West right of way line, 20.00 feet to the Point of Beginning, containing 676 square feet more or less, by and the same is hereby vacated and title to the same is hereby reserved unto the City of Nebraska City, Otoe County, Nebraska.

SECTION 6. That parcel of land located in Block 51, South Nebraska City Addition, Nebraska City, Nebraska, more particularly described as follows: Beginning at the Southwest corner of Lot 5, Block 51 of said South Nebraska City Addition; thence S89°07'30" (Assumed bearing) on the South line of said Lot 5, a distance of 38.00 feet to the North right of way line of the Union Pacific Railroad Mainline Track; thence S55°43'20"W on said North right of way line, a distance of 34.74 feet to the North line of Lot 6 in said Block 51; thence N89°07'30"W on said North line, a distance of 9.36 feet to the East right of way line of 5<sup>th</sup> Street; thence N00°11'39"E on said East line, a distance of 20.00 feet to the Point of Beginning, containing 473 square feet more or less, by and the same is hereby vacated and title to the same is hereby reserved unto the City of Nebraska City, Otoe County, Nebraska.

SECTION 7. That parcel of land located in Block 68, South Nebraska City Addition, Nebraska City, Nebraska, more particularly described as follows: Beginning at the Southwest corner of Lot 5, Block 68 of said South Nebraska City Addition; thence S00°29'20"W (Assumed bearing) on the West line of said Block 68, a distance of 20.00 feet to the Northwest corner of Lot 6 in said Block 68; thence S89°02'14"E on the North line of said Lot 6, a distance of 41.75 feet to the North right of way line of the OPPD Switch track; thence Northeasterly on said North railroad right of way line, on a 745.00 foot radius curve to the left, an arc distance of 8.78 feet to a point of tangency, the chord of said curve beard N65°48'48"E, 8.78 feet; thence N65°32'20"E continuing on said North railroad right of way line, a distance of 37.90 feet to the South line of Lot 4 in said Block 68; thence N89°02'14"W on the South line of Lots 4 and 5 of said Block 68, a distance of 84.09 feet to the Point of Beginning, containing 0.02 acres, more or less, by and the same is hereby vacated and title to the same is hereby reserved unto the City of Nebraska City, Otoe County, Nebraska.

SECTION 8. This ordinance shall be in full force and effect from and after its passage, approval and publication as provided by law.

Passed and Approved this 1<sup>st</sup> day of August, 2011.



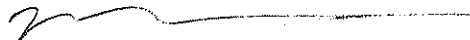

Mark Mercer, Acting Mayor

Attest:



Arnold M. Ehlers, City Clerk-Treasurer

201101931

# PART OF SOUTH NEBRASKA CITY ADDITION, NEBRASKA CITY, NEBRASKA PROPOSED VACATIONS

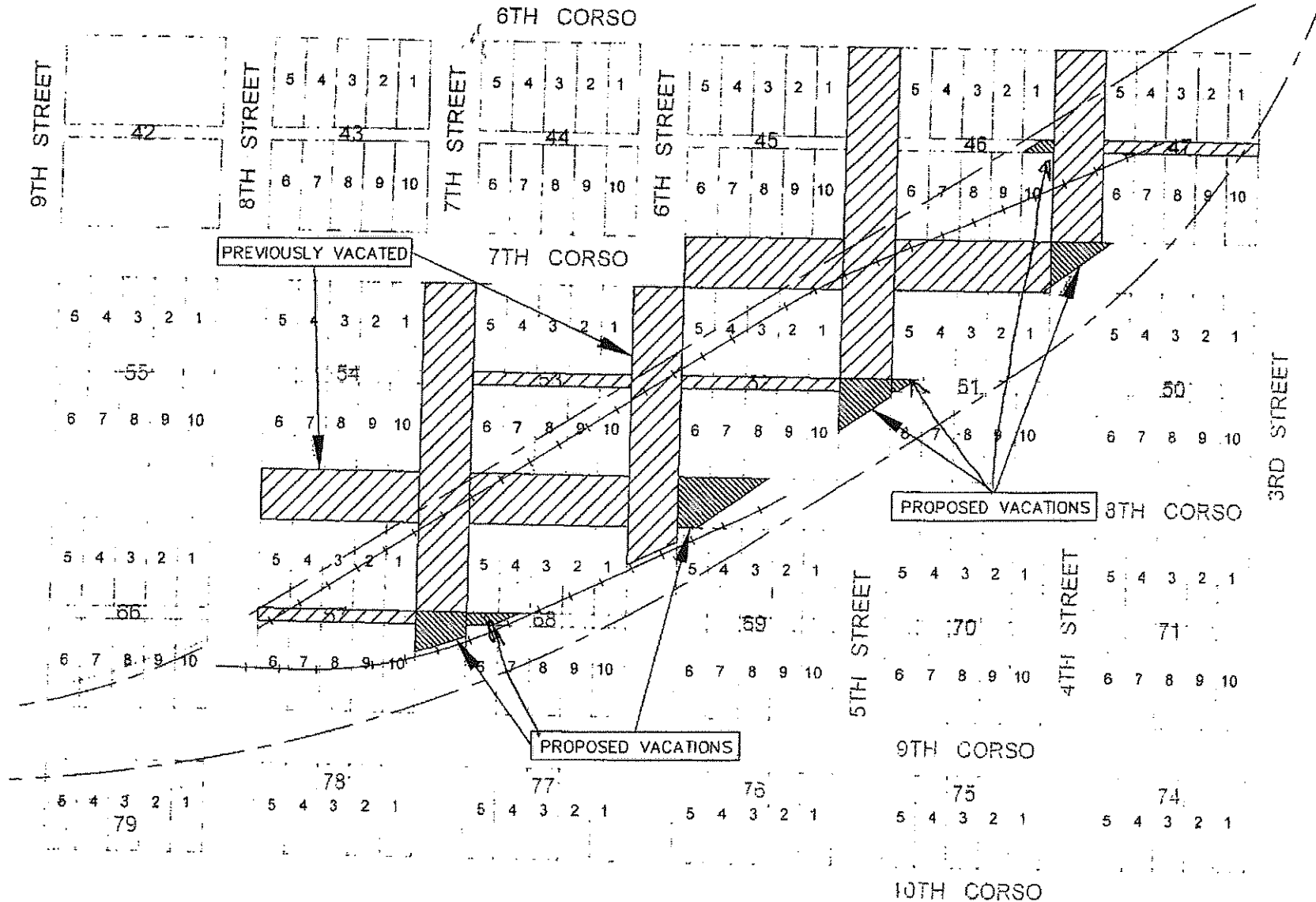

201101931