

97-11998

FILED SARPY CO. NE.
ASSIGNMENT NUMBER
97-011998

SEP 13 PM 3:33

Lloyd J. Dowding
REGISTER OF DEEDS

DEED
Proc.
Fee: *alc*
Ck
Cash
Charge

THIS PAGE ADDED FOR
RECORDING
INFORMATION.

LLOYD J. DOWDING
SARPY COUNTY REGISTER OF DEEDS
1210 GOLDEN GATE DRIVE #1109
PAPILLION, NEBRASKA 68046-2895

97-11998 B

Dated this 11th day of June, 1997
On the above date, before me a General Notary Public duly commissioned and qualified, personally came
Margaret L. Graham
to me known to be the identical person whose name affixed to the foregoing instrument as grantor and acknowledged the same to be a voluntary act and deed.

WITNESS my hand and Notarial Seal the day and year above written.
Notary Kristen A. May
My commission expires the 16th day of July 2000

STATE OF Nebraska
Douglas County ss.

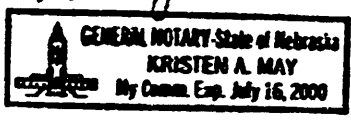

Dated this _____ day of _____, 19____
On the above date, before me a General Notary Public duly commissioned and qualified, personally came _____
to me known to be the identical person whose name affixed to the foregoing instrument as grantor and acknowledged the same to be a voluntary act and deed.

WITNESS my hand and Notarial Seal the day and year above written.
Notary _____
My commission expires the _____ day of _____, 19____

STATE OF _____
_____ County ss.

MEMORANDA

PLEASE PRINT ALL NAMES

Exact and full name of OWNER, as same appears of record _____
If married, full name of spouse _____
If unmarried, show "single," "widower," "widow" _____
If mortgage or other liens, show names of holders, amounts, dates and book page of record _____
If an estate, give the names of all the heirs, with the share of each. Show names of spouses of those married _____
Name of executor or administrator _____
If any of the owners or heirs are minors, give their names and ages _____
Name of guardian _____
TENANT - Exact and full names. Rent Agreement _____

REMARKS

07-11998C

RIGHT OF -WAY ACQUISITION

TRACT 2

LEGAL DESCRIPTION

That part of the Northeast Quarter of Section 16, Township 14 North, Range 11 East of the 6th P.M., Sarpy County, Nebraska, described as follows:

Commencing at the northeast corner of the said Northeast Quarter of Section 16;

Thence South 02°38'44" East (bearings referenced to the Final Plat of MILLARD PARK, a subdivision, as surveyed, platted and recorded in Sarpy County, Nebraska) for 1329.39 feet

along the east line of the said Northeast Quarter of Section 16;

Thence South 87°21'16" West for 33.00 feet to the west right of way line of 168th Street

and the TRUE POINT OF BEGINNING;

Thence South 02°38'44" East for 550.18 feet parallel with and 33.00 feet west of the east

line of the said Northeast Quarter of Section 16;

Thence South 06°13'53" West for 304.58 feet along said west right of way line;

Thence North 02°38'44" East for 421.31 feet parallel with and 80.00 feet west of the east

line of the said Northeast Quarter of Section 16;

Thence North 14°12'51" East for 105.52 feet;

Thence North 00°12'33" East for 329.20 feet to the Point of Beginning.

Contains 0.43 acre.

97-11998 D

NE Cor., NE 1/4
Sec. 18, T14N, R11E
Point of Commencement

TRACT 2

PAPIO VALLEY LAND CO.

Donal Graham

Point of Beginning

UNPLATTED

UNPLATTED

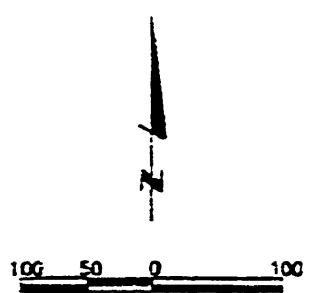
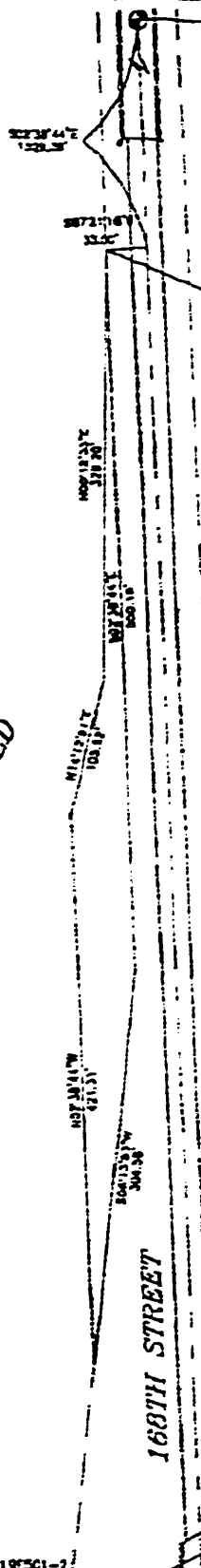

220-5\DW\92192501-2

Book _____ Page _____ Date 05/13/97 Drawn By C.N Job Number 93909-4157/4160

lamp, rynearson & associates, inc.
 engineers surveyors planners

14710 west dodge road, suite 100 ph 402-498-2408
 omaha, nebraska 68154-2029 fax 402-498-2730