

RECEIVED

AUG 5 4 18 PM '96

GEORGE J. PUGH
REGISTERED
DOUGLAS CO.



Brent M. Kuhn
10050 Regency Cir. #101
Omaha, NE 68114

CITY OF OMAHA, NEBRASKA
ADMINISTRATIVE SUBDIVISION

ALAMO PLAZA REPLAT 1

LOTS 1 and 2

Being a replat of Lots 9, 10 and 11, Block 3, Alamo Plaza, an addition to the City of Omaha, as surveyed, platted and recorded in Douglas County, Nebraska.

SURVEYOR'S CERTIFICATE

I hereby certify that I have surveyed the property described hereon and that permanent markers have been found or set at all corners of the lots being platted.

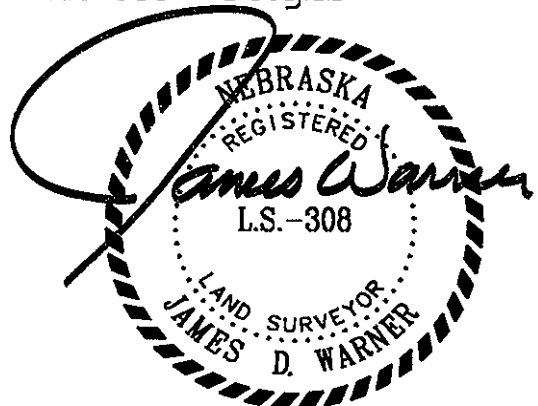

May 28, 1996

Date:

James D. Warner,
Nebraska R.L.S. 308

OWNER'S AND MORTGAGE HOLDERS CERTIFICATION

KNOW ALL PERSONS BY THESE PRESENTS: That we, Fiftieth & Grover Shopping Center, a Nebraska Partnership, the undersigned owners of the property described hereon and embraced within this plat, have caused said land to be subdivided into lots as shown on this plat.

Fiftieth & Grover Shopping Center,
a Nebraska Partnership

By M. H. Feldman - Partner
M. H. Feldman, Partner

08748 15-
FEE 11.50 R FB 00300 (old)
DEL. C/O COMP ST
LEGAL PG SCAL PV

ACKNOWLEDGEMENT OF NOTARY

State of Nebraska)
County of Douglas) ss

The foregoing owners certification was acknowledged before me this 27th day of June, 1996 by M. H. Feldman, Partner of Fiftieth & Grover Shopping Center, a Nebraska Partnership on behalf of said Partnership.

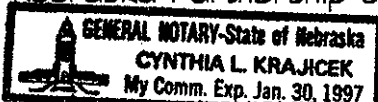

Cynthia L. Krajicek
Notary Public

COUNTY TREASURER'S CERTIFICATION

This is to certify that I find no regular or special taxes due or delinquent against the property described in the legal description and as shown by the records of this office.

6-25-96
Date:

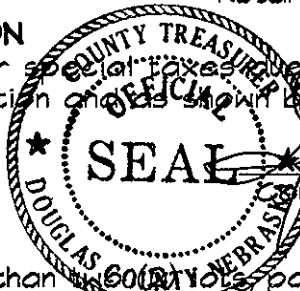

Julie M. Haney
County Treasurer
JULIE M. HANEY

PLANNING DIRECTOR'S APPROVAL

Approved as a subdivision of not more than 60 lots, parcels or tracts, with plat requirements waived per Section 7.08 Home Rule Charter of the City of Omaha, 1956. This subdivision approval is void unless this plat is filed and recorded with the County Register of Deeds within thirty (30) days of this date.

7/8/96
Date:

[Signature]
City Planning Director

3065

SHEET 1 of 2

MIKE FELDMAN

TD2 JOB NO. 149-113-2

MAY 28, 1996

THOMPSON, DREESSEN AND DORNER, INC., 10836 OLD MILL ROAD, OMAHA, NEBRASKA 68154, 402-330-8860

LEGEND

- corners found
- corners set (3/4" otp unless noted)
- Δ set temporary point
- R recorded distance
- M measured distance
- otp open top pipe
- ctp crimped top pipe

ADDRESS, LOT 1 3702 DODGE STREET

ADDRESS, LOT 2 3708 DODGE STREET

