

# HAVELOCK

LANCASTER CO.

NEB.

Scale: 1 inch = 300 feet.

I hereby certify that I have accurately surveyed Havelock, Lancaster Co., Neb., and that the same out into lots, blocks, streets, & alleys as shown on the annexed plat.  
The street lines except Jackson St., Pennsylvania Ave., Adams St., Warren Ave. are parallel with or at right angles to Foster Avenue. The divisions of all lots, streets, & alleys are indicated in feet on the plat.  
The stakes are set at the front corners of all lots.  
Plats are set at points marked thus: *(Symbol)*  
June 25<sup>th</sup> 1890  
John D. Wright  
Surveyor

THE STATE OF NEBRASKA, s.s.  
LANCASTER COUNTY,  
Entered on Numerical Index  
and filed for record in the Reg-  
ister of Deeds, Office of said  
County, the 24<sup>th</sup> day of  
June 1890 at 3  
o'clock and 15 Minutes  
P.M., and recorded in Book  
of \_\_\_\_\_ at  
page \_\_\_\_\_  
John D. Wright  
Surveyor  
J. H. Howell, Dep.  
43.35  
S. N.

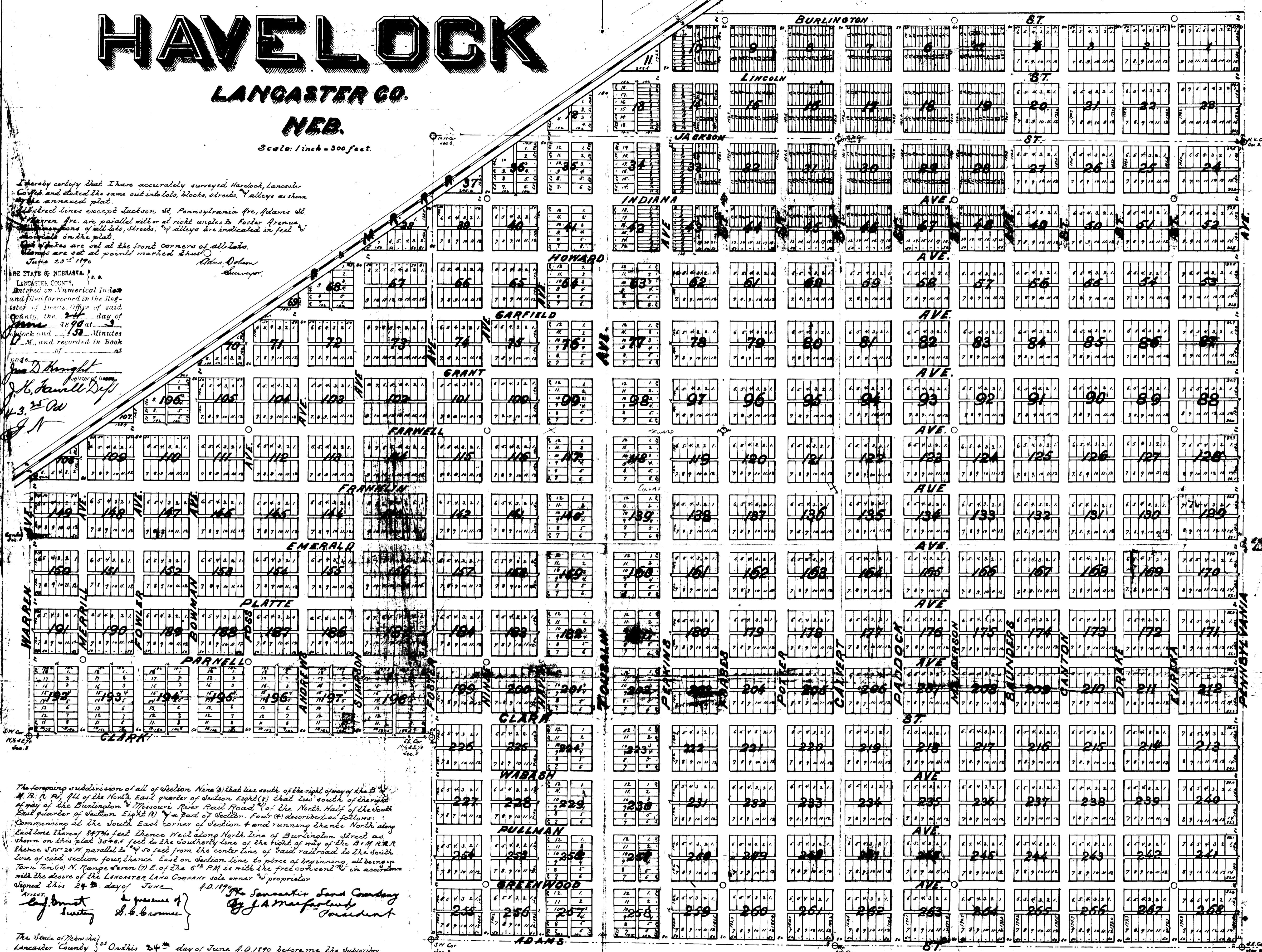

The foregoing subdivision of all of Section Nine (9) that lies south of the right of way of the B. & M. R. R., 1/2 of the North East quarter of Section Eight (8) that lies south of the right of way of the Burlington & Missouri River Railroad & the North Half of the South East quarter of Section Eight (8) & a part of Section Four (4) described as follows:  
Commencing at the South East corner of Section 4 and running thence North along East line thereof 847 1/2 feet thence West along North line of Burlington Street as shown on this plat 354 1/2 feet to the Southern line of the right of way of the B. & M. R. R. thence S 88° 20' W parallel to 1/4 section line 1/4 section line to the South line of said section four, thence East on section line to place of beginning, all being in Town 20 N. Range 20 W. E. of the 6<sup>th</sup> P.M. is with the free consent of in accordance with the desire of the LANCASTER LAND COMPANY sole owner & proprietor  
Signed this 24<sup>th</sup> day of June 1890  
Witness my hand & official seal the day & year first above written.  
Notary Public

The State of Nebraska)  
Lancaster County ss On this 24<sup>th</sup> day of June A.D. 1890 before me the subscriber a Notary Public duly commissioned & qualified for residing in said County personally came J. D. MACFARLAND President of the Lancaster Land Company to me personally known to be the identical person who executed the foregoing instrument and acknowledged the same to be his voluntary act & deed and the voluntary act & deed of the Lancaster Land Company.  
Witness my hand and official seal the day & year first above written.  
Notary Public