

37-261

BEFORE THE COUNTY JUDGE OF SARPY COUNTY, NEBRASKA

THE STATE OF NEBRASKA
DEPARTMENT OF ROADS

Docket 112

Page 103

Condemner

vs.

RETURN OF APPRAISERS

WILL HANSEN, Owner; MARIE E. HANSEN,
wife of Will Hansen;

WILL HANSEN and MARIE E. HANSEN,
husband and wife, Owners; JOHN P.
FORD, Trustee, Holder of interest;

FREDERICK W. HANSEN and MARIE N.
HANSEN, husband and wife, Joint Ten-
ants; WILL HANSEN, Mortgagee;

WALLACE C. SUMP and GERALD F. SUMP,
a single person, Joint Tenants;
ELAINE F. SUMP, wife of Wallace C.
Sump;

Condemnees

TO HONORABLE ORVILLE ENTENMAN, COUNTY JUDGE, SARPY COUNTY, NEBR.

We, the undersigned appraisers, do hereby certify that under and
by virtue of an "Appointment of Appraisers" duly served upon us by
P. A. Skittles, Jr. Sheriff or Deputy Sheriff of Sarpy
County, Nebraska, on the 24 day of Sept, 1964, and after
having taken and filed the "Oath of Appraisers" that we did carefully
inspect and view the property described herein, sought to be appropri-
ated by the State of Nebraska, Department of Roads, and also other
property of the condemnees alleged damaged thereby and did hear all
parties interested therein in reference to the amount of damages sus-
tained while we were so inspecting and viewing the property herein
described and thereafter did assess the damages that the condemnees
have sustained or will sustain by such appropriation of the property
herein described for State highway purposes and also damage to such
other property of the condemnees as in our opinion was damaged by the
appropriation of the property herein described.

RLW-GJG

FILED FOR RECORD IN SARPY COUNTY NEBR. Oct 26 1964 AT 10:00 CLOCK A.M. 2200

AND RECORDED IN BOOK 34 OF 100 PAGES 100 REGISTER OF DEEDS

C O N D E M N A T I O N

Land Owners: Will Hansen and Marie Hansen, husband and wife,
Joint Tenants.

Project: I-80-9 (94) AFE: R-172b Sarpy County, Nebraska

Permanent easement to a tract of land for the control of outdoor advertising as illustrated on the attached plat and being more particularly described as all that part of Tax Lot 1 in the Southwest Quarter of Section 24, Township 14 North, Range 11 East of the 6th P.M., Sarpy County, Nebraska, lying within 660 feet of the Interstate Highway Right of Way Controlled Access Line as measured at right angles to the centerline of said Interstate Highway, and being in accordance with the Rules and Regulations Relating to the Control of Advertising in Areas Adjacent to the National System of Interstate and Defense Highways in Nebraska, which were adopted pursuant to Section 39-1320.03, R. S. Supp., 1961 and in accordance with Section 84-907, R. R. S. 1943; approved and filed on June 15, 1961.

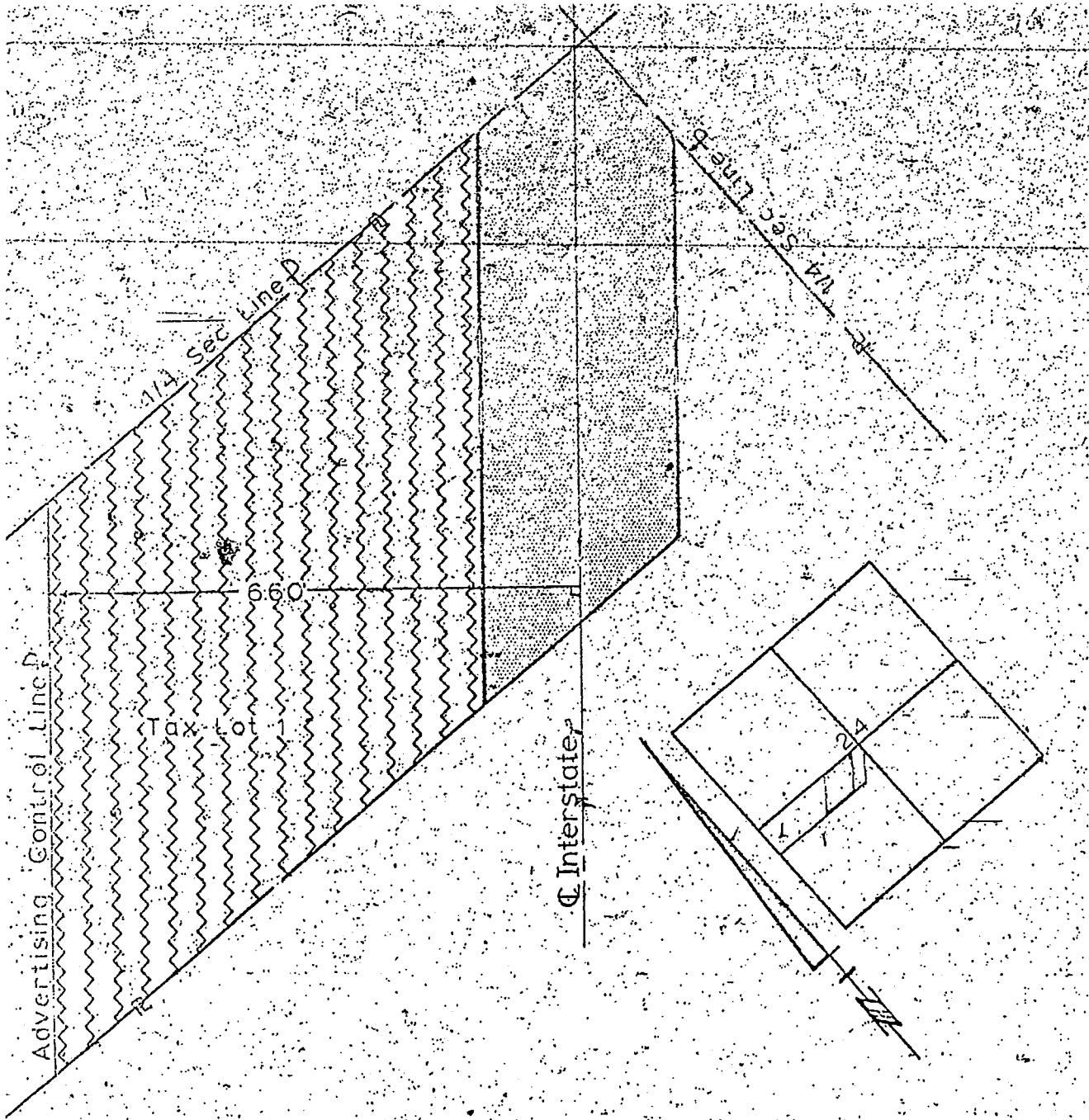

Scale: 1" = 200'

Advertising Easement
 to be acquired for Interstate Highway purposes
 Project: I-80-9(94) Sarpy County AFER-172b
 Tract: 203
 Holder of Record: Will & Marie Hansen
 Location: Tax Lot 1 in SW Sec. 24-
 T14N-R11E

drawn: S.T.
 checked: W.E.
 written: W.E.
 checked: C.S.

- Total ROW =
- Old ROW =
- New ROW =
- Controlled Access =
- Channel Easement =
- Advertising Easement =

34-264

C O N D E M N A T I O N

Land Owners: Will Hansen and Marie E. Hansen, Husband and Wife.

Purchaser on Contract: John P. Ford, Trustee.

Project: 1-80-9(94) AFE: R-1725 Sarpy County, Nebraska.

Permanent easement to a tract of land for the control of outdoor advertising as illustrated on the attached plat and being more particularly described as all that part of Tax Lot 3 in the Southwest Quarter of Section 24, Township 14 North, Range 11 East of the 6th P.M., Sarpy County, Nebraska, lying within 660 feet of the Interstate Highway Right of Way Controlled Access Line as measured at right angles to the centerline of said Interstate Highway and being in accordance with the Rules and Regulations Relating to the Control of Advertising in Areas Adjacent to the National System of Interstate and Defense Highways in Nebraska, which were adopted pursuant to Section 39-1320.03, R. S. Supp., 1961 and in accordance with Section 64-907, R. R. S.: 1943; approved and filed on June 15, 1961.

>

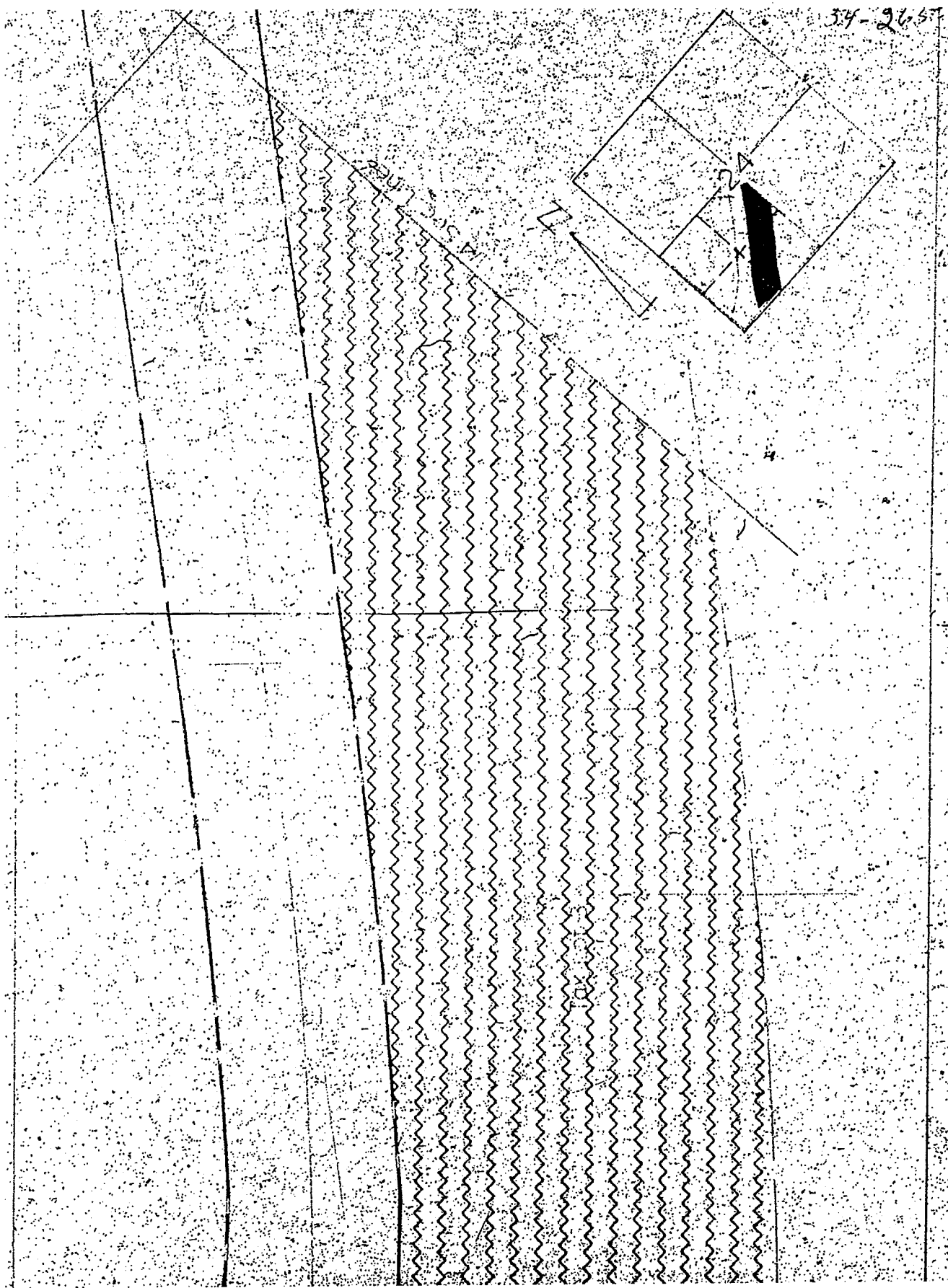

57-266

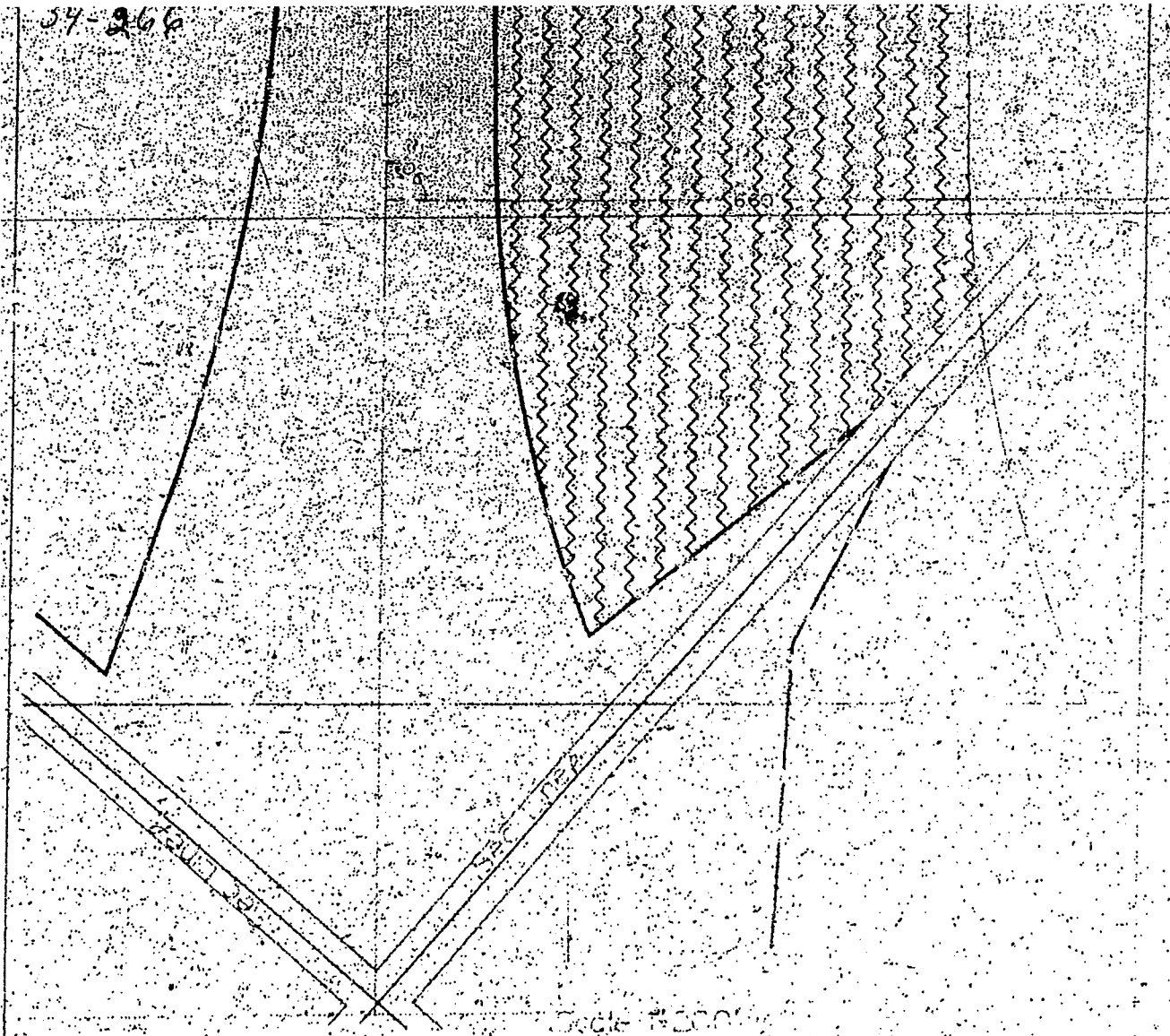

Scale 1" = 200'

Advertising Control
 to be acquired for Interstate Highway purposes
 Project I-80-9(94) Sarpy County A.E.R. Co.
 Tract 276

Holder of Record Will & Marie E. Hansen H & W

Buyer under Contract John P. Ford Trustee

Location Tax Lot 3 in Sec 24-T14N-R1E

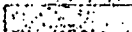
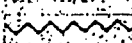
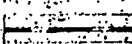
-  Old ROW
-  Advertising Control Easement
-  Controlled Access Line

STATE OF NEBRASKA DEPARTMENT OF ROAD & TRANSPORTATION

C O N D E M N A T I O N

Land Owners: Frederick W. Hansen and Marie N. Hansen, Husband and Wife, Joint Tenants.

Project: 1-80-9(94) AFE: R-E725 Sarpy County, Nebraska.

Permanent easement to a tract of land for the control of outdoor advertising as illustrated on the attached plat and being more particularly described as all that part of Tax Lot 2 in the Southwest Quarter of Section 24, Township 14 North, Range 11 East of the 6th P.M., Sarpy County, Nebraska, lying within 660 feet of the Interstate Highway Right of Way Controlled Access Line as measured at right angles to the centerline of said Interstate Highway and being in accordance with the Rules and Regulations Relating to the Control of Advertising in Areas Adjacent to the National System of Interstate and Defense Highways in Nebraska, which were adopted pursuant to Section 39-1320.03, R. S. Supp., 1961 and in accordance with Section 34-907, R. R. S. 1943; approved and filed on June 15, 1961.

24-368

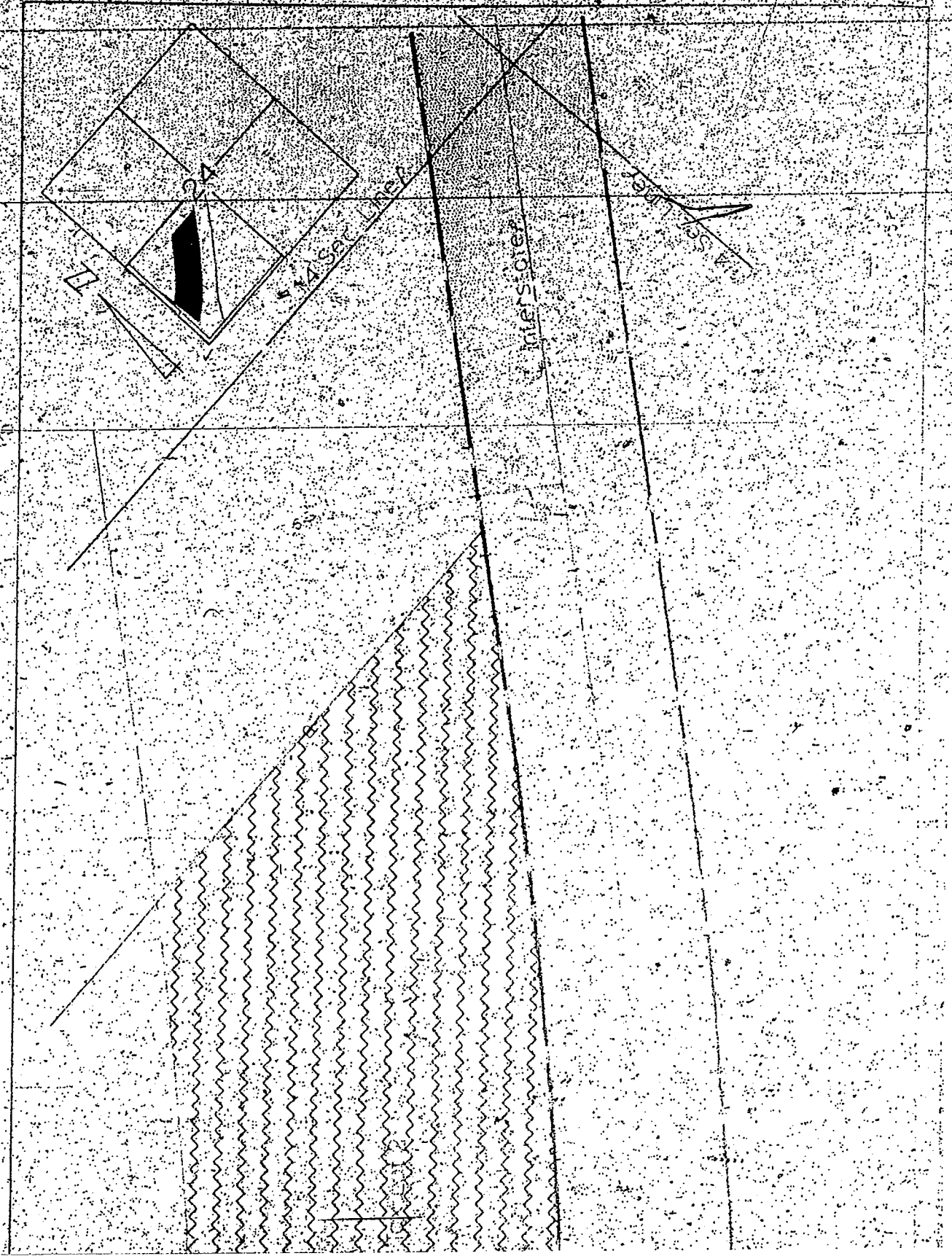

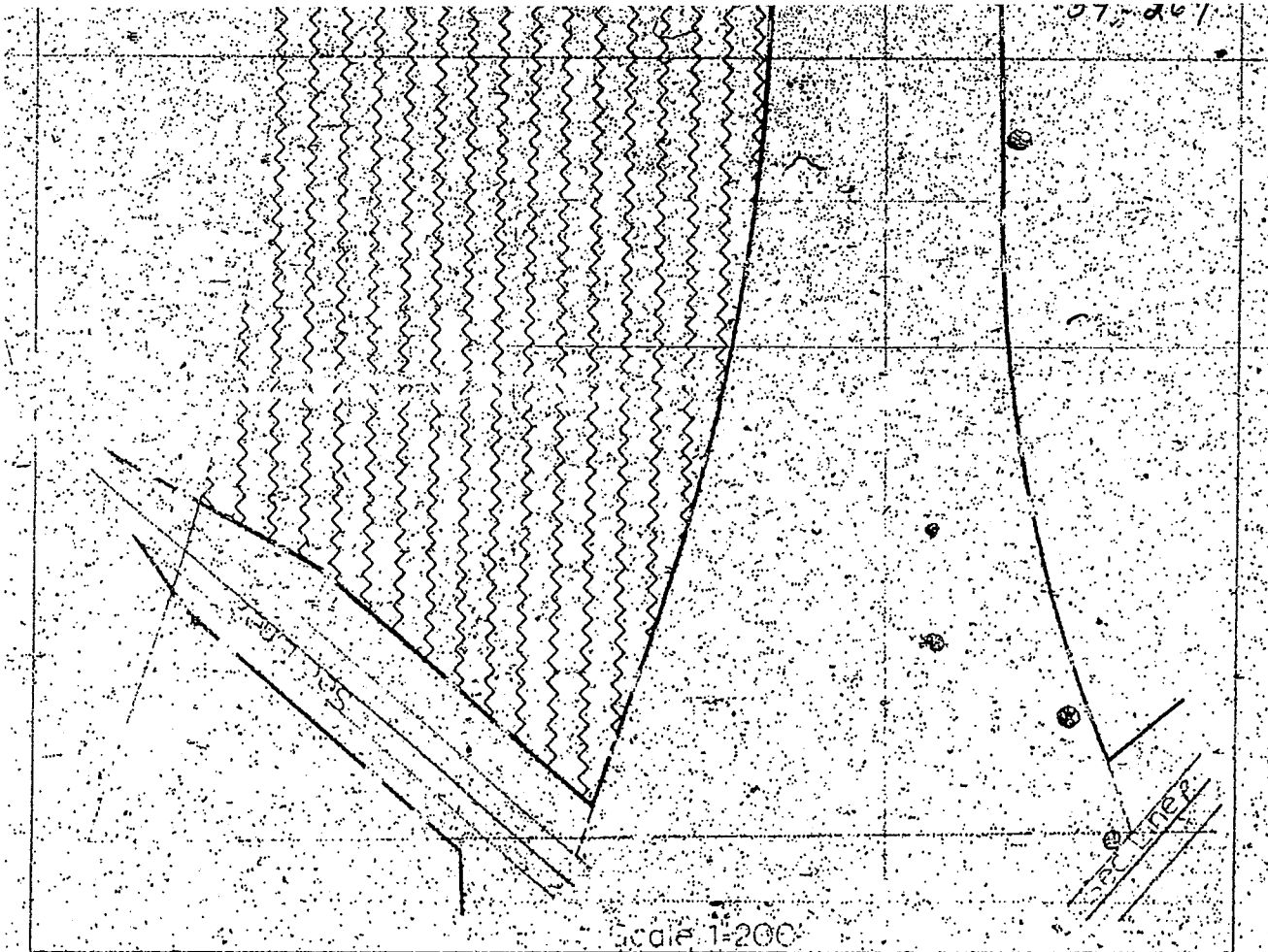

Scale 1:200

Advertising Control

to be acquired for Interstate Highway purposes
 Project I-80-9(94) Sarpy County A.F.E. R-172b

Tract 277

Holder of Record Frederick & Marie N. Hansen, H&W, J

Location, Tax Lot 2 in Sec. 24-T14N-R11E

- — — — — Right of Way
- ~~~~~ Advertising Control Easement
- == Controlled Access Line

DRAWN BY R. B. B.
DATE 10/25/94
WRITTEN BY
CHECKED BY

STATE OF NEBRASKA

DEPARTMENT OF ROADS

34-220

C O N D E M N A T I O N

Land Owners: Wallace C. Sump and Gerald F. Sump, an unmarried man,
Joint Tenants; Elaine F. Sump, Wife of Wallace C. Sump.

Project: I-80-9(94) AFE: R-172b Sarpy County, Nebraska.

Permanent easement to a tract of land for the control of outdoor advertising as illustrated on the attached plat and being more particularly described as all that part of Tax Lots 1-B and 2-B in Section 26, Township 14 North, Range 11 East of the 6th P.M., Sarpy County, Nebraska, lying within 660 feet of the Interstate Highway

Right of Way Controlled Access Line as measured at right angles to the centerline of said Interstate Highway and being in accordance with the Rules and Regulations Relating to the Control of Advertising in Areas Adjacent to the National System of Interstate and Defense Highways in Nebraska, which were adopted pursuant to Section 39-1320.03, R. S. Supp., 1961 and in accordance with Section 84-907, R. R. S. 1943; approved and filed on June 15, 1961.

34-271

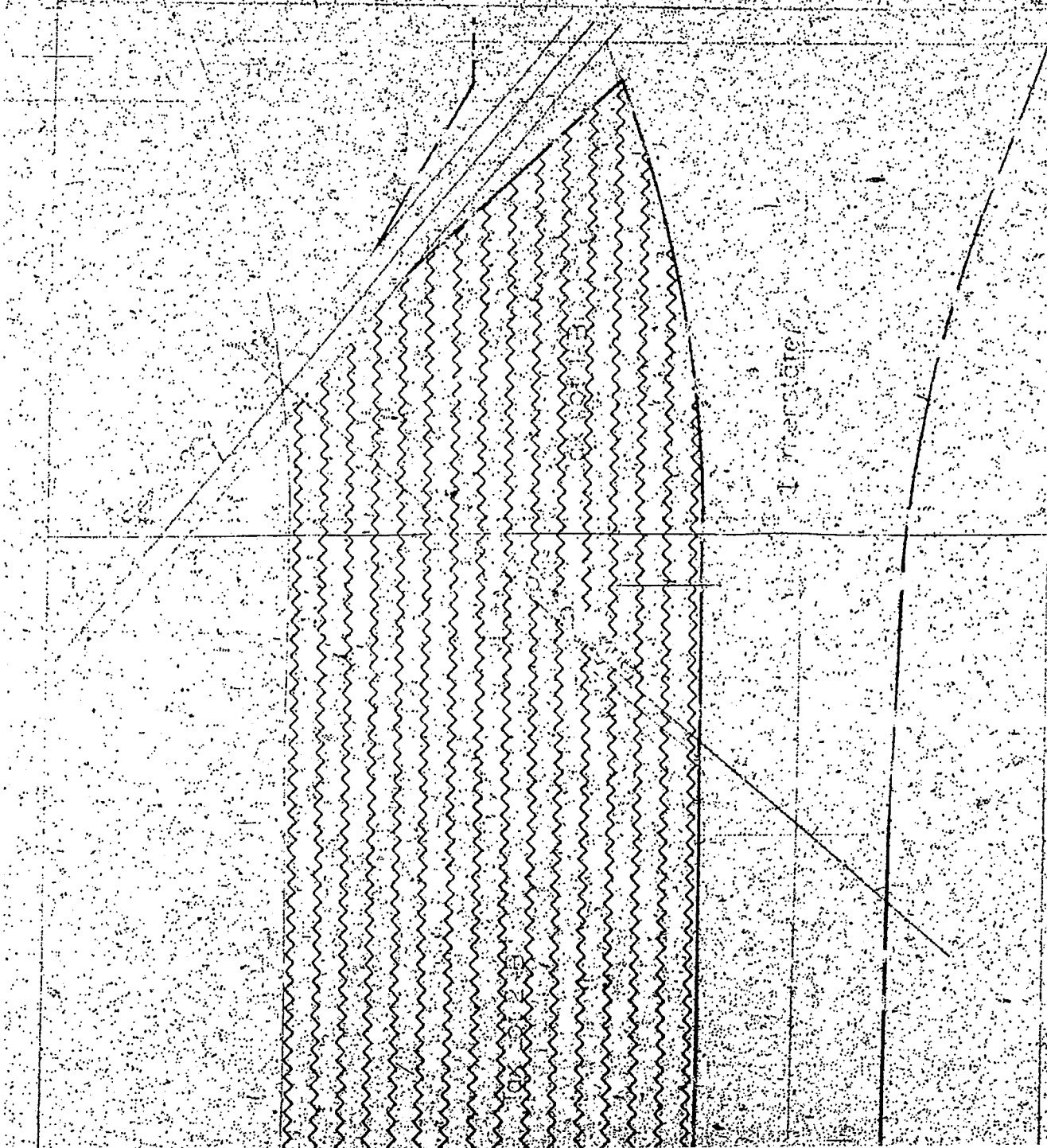

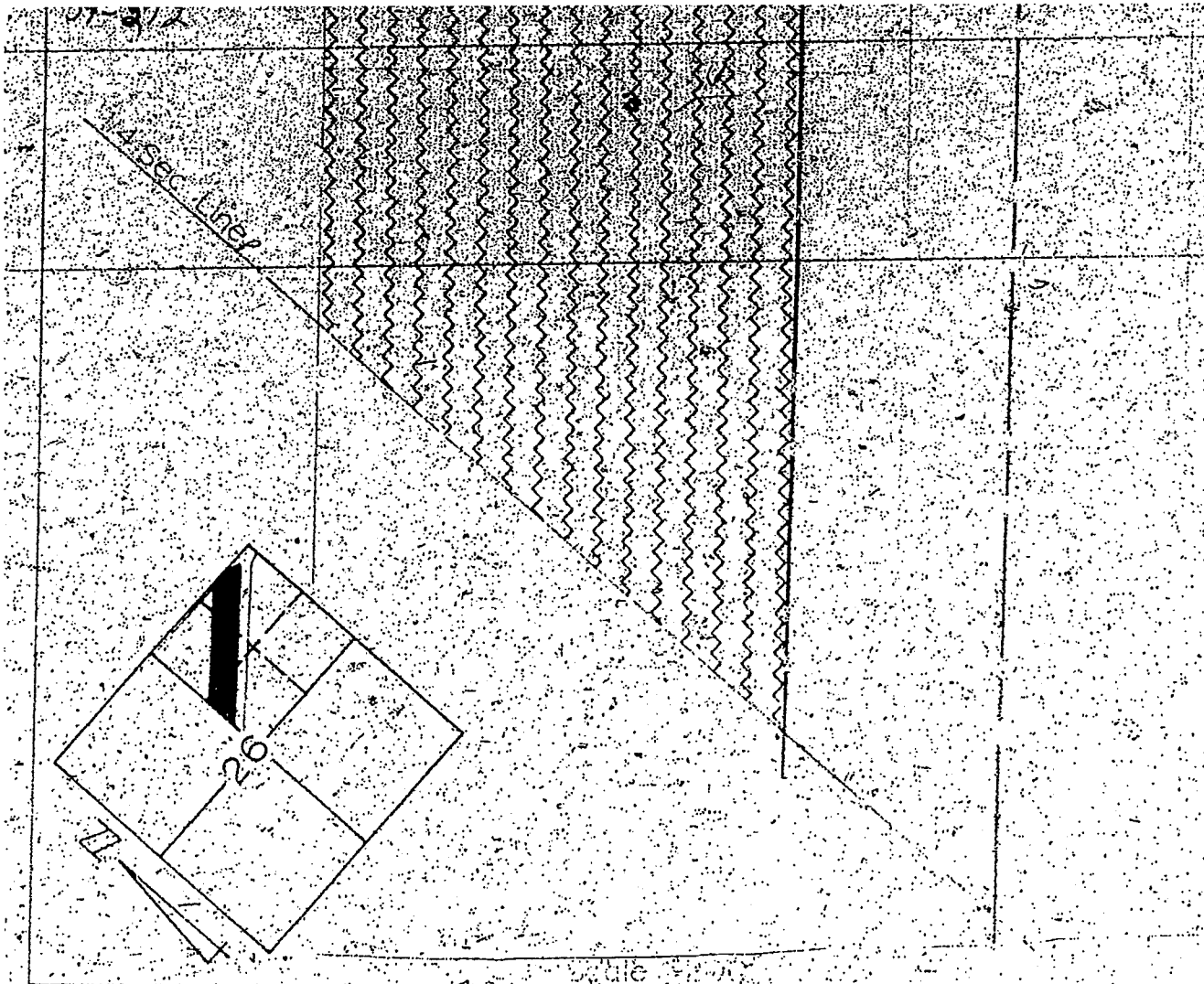



Advertising Control

to be acquired for Interstate Highway
 Project (80-994) in Sarpy County

Tract 283

Holder of Record: Wallace C. & Gerald

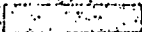
Location: Tax Lots 1-B & 2-B in Section 28

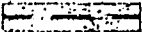
-  Old ROW
-  Advertising Control Area
-  Controlled Access Line

STATE OF NEBRASKA

DEPARTMENT OF TRANSPORTATION

Now, therefore, we, as appraisers aforesaid, do hereby find and approve the damages that will be suffered by reason of the appropriation of title to the said property or any interest therein described for State highway purposes by the State of Nebraska, Department of Roads, in the amount of:

To: Will Hansen, Owner; Marie T. Hansen, wife of Will Hansen;

To: Will Hansen and Marie T. Hansen, husband and wife, Owners; John W. Reed, Trustee, Holder of Interest;

To: Frederick W. Hansen and Marie M. Hansen, husband and wife, Joint Tenants; Will Hansen, Mortgagee;

To: Wallace C. Sump and Gerald F. Sump, a single person, Joint Tenants; Blanche F. Sump, wife of Wallace C. Sump;

All of which is hereby respectfully submitted.

Dated this 21st day of October, A. D., 1924.

Will Warren
Wm. Strawn
Ronald E. Bell
Appraisers

Subscribed and sworn to before me this 21 day of Oct

A. D., 1924.

(SEAL)

Paul W. Eastman
County Judge

IN THE COUNTY COURT OF THE COUNTY OF SARPY, STATE OF NEBRASKA
(Certified Copy of Record)

STATE OF NEBRASKA
County of Sarpy

Orville Entenman, Judge of the County Court of the County of Sarpy, State of Nebraska, do hereby certify that I have compared the foregoing copies of

RETURN OF APPRAISERS

THE STATE OF NEBRASKA)	Doc. M2
DEPARTMENT OF ROADS)	Page 102
VS)	No. 280
WILL HANSEN, et al)	

with the original records thereof, now remaining in said Court; that the same are correct transcripts thereof, and of the whole of said original records.

In Witness Whereof I have hereunto set my hand and affixed the seal of said County Court in Papillion, County of Sarpy, State of Nebraska, on this 26 day of October A.D. 1914

Orville Entenman
Judge of the County Court



By *W. L. ...*