

BOOK 565 PAGE 84

LAND SURVEYOR'S CERTIFICATE

(24-80)

I hereby certify that this plat, map, survey or report was made by me or under my direct personal supervision and that I am a duly Registered Land Surveyor under the laws of the State of Nebraska.

Legal Description

THE SOUTH 19.50 FEET OF LOT 4, BLOCK 33, FLORENCE, AN ADDITION TO THE CITY OF OMAHA, DOUGLAS COUNTY, NEBRASKA.

Plat to scale showing tract surveyed with all pertinent points.

10 ENTERED IN NUMERICAL INDEX AND RECORDED IN THE REGISTER OF DEEDS OFFICE IN DOUGLAS COUNTY, NEB. 325  
19 DAY OF May 19 1967 1097 A.M. C. HAROLD OSTLER, REGISTER OF DEEDS

TUCKER ST.

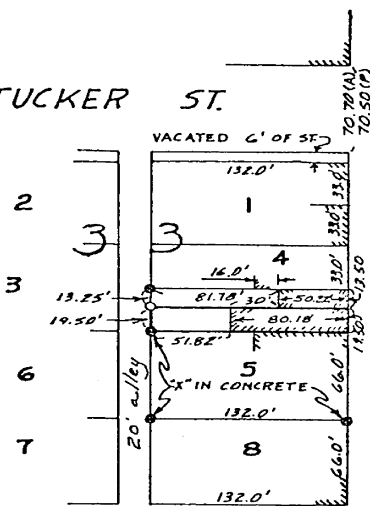

30TH ST.



SCALE 1" = 100'

- Corners Set
- ⊙ Corners Found
- [A] Actual Dimensions
- [P] Plat Dimensions

WILLIT ST.

Approved as a subdivision of only two (2) lots with plat requirement waived per Section 7.08 Home Rule Charter of the City of Omaha, 1956."

5/17/76 Date Planning Director

Gerald B. Rager, Jr. Signature of Land Surveyor

DATE RECEIVED: \_\_\_\_\_ Date: 3-15-76

OFFICIAL ADDRESS: \_\_\_\_\_

BLDG. PERMIT NO.: \_\_\_\_\_

Book 76-4 Page 43

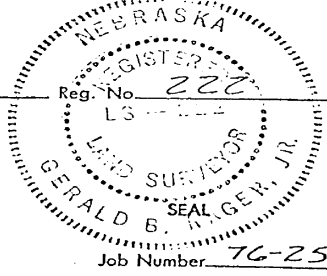

Job Number 76-258

LAMP RYNEARSON & ASSOCIATES, INC. engineers surveyors

FORTY-SIX TEN DODGE STREET OMAHA, NEBRASKA 68132 TELEPHONE 402-538-6030