

MISC 2003112506

RICHARD M. JARLICH  
REGISTER OF DEEDS  
DOUGLAS COUNTY, NE.

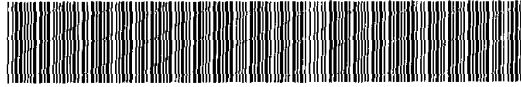

JUN 12 2003 14:54 P 2

RECEIVED

**THIS PAGE INCLUDED FOR INDEXING  
PAGE DOWN FOR BALANCE OF INSTRUMENT**

mix FEE 151.<sup>00</sup> FB 05-02879  
2 BKP \_\_\_\_\_ C/O \_\_\_\_\_ COMP *th*  
282 DEL \_\_\_\_\_ SCAN *R* FV \_\_\_\_\_

Temp. 12.4.01

::

*V22492*

# AFFIDAVIT OF CORRECTION

This Affidavit is made to correct the drafting errors in the TYPICAL SETBACK DETAIL in the Final Plat of BENNINGTON LAKE, a subdivision, as recorded in Douglas County Register of Deeds Office in Deed Book 2128 at page 001. The setback along the lake (Lot 1) should have been sixty foot (60') not eighty foot (80') as shown and the front setback should have been thirty foot (30') not thirty-five foot (35') as shown. This Affidavit affects Lots 2 through 283, inclusive.

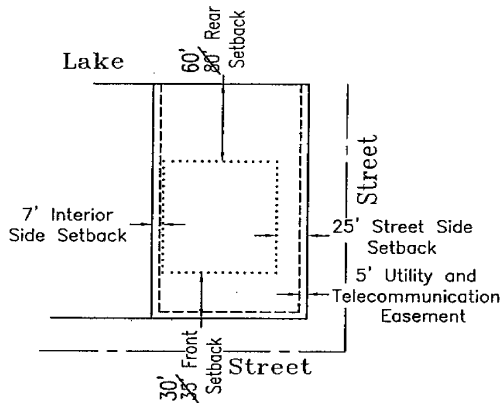

## "R" ZONING TYPICAL SETBACKS

### LAND SURVEYOR'S CERTIFICATE

I, Robert D. Proett, do hereby submit this affidavit to correct the drafting error in the TYPICAL SETBACK DETAIL in the Final Plat of BENNINGTON LAKE as filed in the Douglas County Register of Deeds Office and that I am the identical person whose name appears on the Land Surveyor's Certificate of said plat.

Robert D. Proett, L.S.

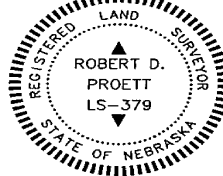

### ACKNOWLEDGEMENT OF NOTARY

State of Nebraska) )SS  
County of Douglas)

On this the 2nd day of June 2003, A.D., before me, a Notary Public, duly commissioned and qualified for said County, appeared Robert D. Proett, who is personally known to me to be the identical person whose name is affixed as a Registered Land Surveyor under the laws of the State of Nebraska, and he did acknowledge his execution of the foregoing Affidavit of Correction to be his voluntary act and deed as such and the voluntary act and deed of said Corporation.

Witness my hand and seal the date aforesaid.

  
Notary Public

96009\9609AFID.Dwg  
Book 96009 Page Date June 2, 2003 Dwn.By JHVD Job Number 96009.01 / 002

**lamp, rynearson & associates, inc.**  
engineers surveyors planners

14710 west dodge road, suite 100  
omaha, nebraska 68154-2029

ph 402-496-2498  
fax 402-496-2730