

Parcel Information	
Parcel ID	130094722
Links	Sketch #1
Map Number	3473-27-0-00000-000-0027
Cadastral #	
Current Owner	LOVEGROVE, DANIEL DEAN
Mailing Address	22855 HWY 34, EAGLE NE 68347-
Situs Address	
Tax District	465
Tax ID	
School District	SD 145 WAVERLY
Neighborhood	3
Property Class	Agricultural
Lot Width x Depth	
Legal Description	27-10-09 W1/2 NW1/4 EXC TL6 & HWY (73.08)

Assessed Values				
Year	Total	Land	Improvements	Outbuildings
2016	\$331,447	\$331,447	\$0	\$0

2016 Tax Information	
Taxes	\$5,445.00
Tax Levy	1.732366

2016 Tax Levy	
Description	Rate
AG SOCIETY	0.010479
AG SOCIETY BOND	0.001843
CO JAIL BD	0.000000
COUNTY GENERAL	0.371015
ESU NO 6 LANCASTER	0.015689
FD 9 EAGLE/ALVO	0.009961
FD 9 EAGLE/ALVO BOND	0.007248
NEMAHA NRD 2	0.030631
SD 145 BOND 2015	0.037480
SD 145 BOND 2016	0.025227
SD 145 BOND 9-12	0.014722
SD 145 BOND 9-12 '11	0.010016
SD 145 BOND K-8	0.000000
SD 145 BOND K-8 '11	0.043144
SD 145 CAP PURPOSE 12	0.009899
SD 145 QCPF 2013	0.022845
SD 145 WAVERLY	1.046967
SE COMM COLLEGE	0.075200

5 Year Sales History

No previous sales information is available.

Property Classification			
Status:	Unimproved	Location:	Rural
Property Class:	Agricultural	City Size:	No Population
Assessor's Use:	Agricultural	Lot Size:	40.01-160.00 ac.

Historical Valuation Information							
Year	Billed Owner	Land	Impr	Outbldg	Total	Taxable	Taxes
2016	LOVEGROVE/DANIEL DEAN	\$331,447	\$0	\$0	\$331,447	\$331,447	\$5,445.00
2015	LOVEGROVE/DANIEL DEAN	\$323,778	\$0	\$0	\$323,778	\$323,778	\$5,239.06
2014	LOVEGROVE/DANIEL DEAN	\$259,745	\$0	\$0	\$259,745	\$259,745	\$4,365.44
2013	LOVEGROVE/DANIEL DEAN	\$225,874	\$0	\$0	\$225,874	\$225,874	\$3,890.76
2012	LOVEGROVE/DANIEL DEAN	\$167,000	\$0	\$0	\$167,000	\$167,000	\$2,891.12

Farm Residence Datasheet			
Type		Heat Type	
Quality / Condition		Foundation	
Arch. Type		Slab Area	
Year Built		Crawl Area	
Actual Age	N/A	Basement Area	sq. ft.
Ext. Wall 1		Min Finish	
Ext. Wall 2		Rec Finish	
Base Area		Part Finish	
Total Area		Bedrooms	
Style 1		Bathrooms	
Style 2		Garage Type	
Roof Type		Garage Area	

Agland Inventory							
Soil Symbol	Soil Name	Land Use	LVG Code	Spot LVG	Value/Acre	Acres	Total Value
7464	OTOE,6 TO 11,ERODED	DRY	4D1		4,530	36.18	163,895
7684	WYMORE,3 TO 6,ERODED	DRY	2D		4,760	33.37	158,841
7773	COLO-NODAWAY	DRY	2D		4,760	1.83	8,711
1500	ROAD	ROAD	1500			1.7	0
Totals						73.08	331,447

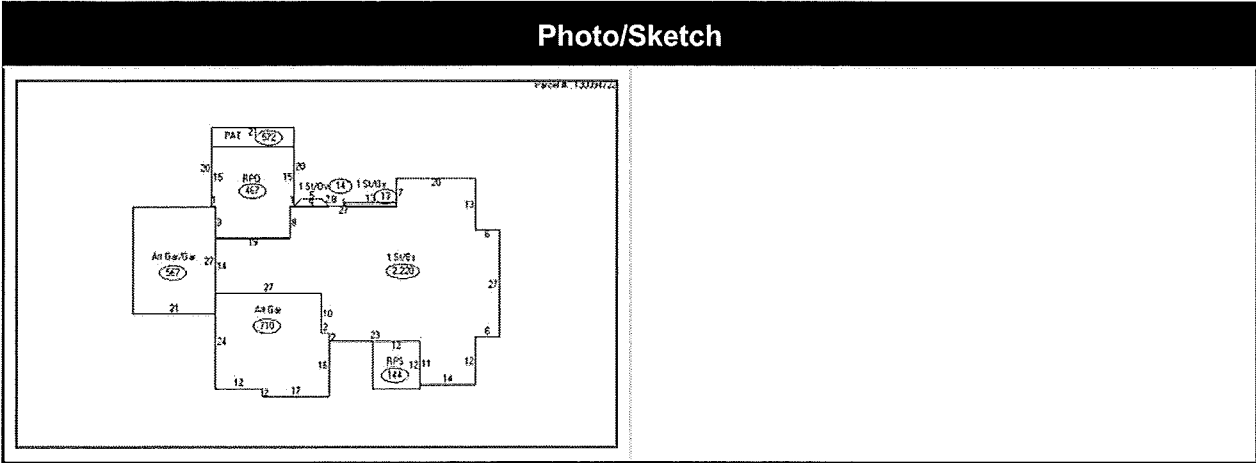

Tax Statement

Served by WEBSERVER-TWO

Submit Query

Cass County

Step 4 of 8

Perm ID
130094722

Name
LOVEGROVE,DANIEL DEAN
22855 HWY 34
EAGLE NE 68347

Legal
27-10-09 W1/2 NW1/4 EXC TL6 & HWY
(73.08)

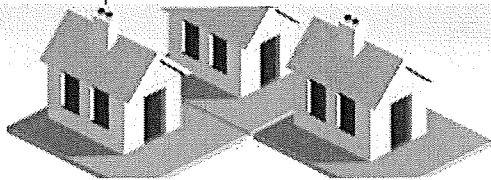

Tax Statement Information Found for this Property

[Levy Graph](#) [Value Graph](#) [Tax Graph](#)

Year	Statement	Value	Tax	Exemption	Net Tax	Balance Due
2016	009642	\$ 331,447	\$ 5,741.88	- \$ 296.88	\$ 5,445.00	\$ 5,445.00
2015	009714	\$ 323,778	\$ 5,543.70	- \$ 304.64	\$ 5,239.06	\$ 0.00
2014	007316	\$ 259,745	\$ 4,551.26	- \$ 185.82	\$ 4,365.44	\$ 0.00
2013	007327	\$ 225,874	\$ 4,039.76	- \$ 149.00	\$ 3,890.76	\$ 0.00
2012	007340	\$ 167,000	\$ 3,010.52	- \$ 119.40	\$ 2,891.12	\$ 0.00
2011	007547	\$ 148,803	\$ 2,693.24	- \$ 112.06	\$ 2,581.18	\$ 0.00
2010	007499	\$ 116,682	\$ 2,148.26	- \$ 92.08	\$ 2,056.18	\$ 0.00
2009	007454	\$ 115,136	\$ 2,097.98	- \$ 94.66	\$ 2,003.32	\$ 0.00
2008	007472	\$ 221,775	\$ 4,067.00	- \$ 191.02	\$ 3,875.98	\$ 0.00
2007	007484	\$ 89,389	\$ 1,646.30	- \$ 74.38	\$ 1,571.92	\$ 0.00
2006	007490	\$ 88,249	\$ 1,645.24	\$ 0.00	\$ 1,645.24	\$ 0.00
2005	007503	\$ 79,122	\$ 1,499.24	\$ 0.00	\$ 1,499.24	\$ 0.00
2004	007514	\$ 65,418	\$ 1,140.68	\$ 0.00	\$ 1,140.68	\$ 0.00
2003	007528	\$ 65,418	\$ 1,126.08	\$ 0.00	\$ 1,126.08	\$ 0.00
2002	007524	\$ 59,142	\$ 1,025.98	\$ 0.00	\$ 1,025.98	\$ 0.00
2001	007524	\$ 59,142	\$ 995.68	\$ 0.00	\$ 995.68	\$ 0.00
2000	007508	\$ 58,571	\$ 804.42	\$ 0.00	\$ 804.42	\$ 0.00
1999	007533	\$ 58,571	\$ 994.48	\$ 0.00	\$ 994.48	\$ 0.00

The information provided in this site is the most recent and most accurate data available. All information contained herein is for informational purposes only. MIPS Inc does not warrant that such information is accurate and error free. This information is provided on an "as is" basis without warranties of any kind, either expressed or implied, including, but not limited to, the implied warranties of merchantability or fitness for a particular purpose. MIPS Inc shall not be liable for any direct, indirect, incidental, special or consequential damages arising out of the use of such information or the inability to use such information. MIPS also is not, nor shall be party to or subject to any warranty or any breach of any kind. The User acknowledges and agrees that the use of such information is at the sole risk of the User.

Copyright © 2004 Nebraska Association of County Officials. All rights reserved.