

I, Samuel W. Mercer, proprietor of the land included in the accompanying plat and in whom the fee simple title of the streets and alleys shown on said plat is now vested, do hereby state and admit that said plat is in accordance with my desire and wishes and do hereby dedicate to public use the said streets and alleys ~~now~~ <sup>now</sup> ~~and~~ <sup>except</sup> Dale Street and do hereby ratify and approve said plat.

In witness whereof I have hereunto set my hand this 11th day of December, A.D. 1883.

In presence of  
 Geo W. Mills

Samuel W. Mercer

1883  
 Dec 11

State of Nebraska  
 County of Douglas

# Map of Walnut Hill

On this 11th day of December, A.D. 1883, before me a Notary Public in and for said County personally came the above named Samuel W. Mercer to me known to be the identical person whose name is affixed to the foregoing instrument as grantor and acknowledged said instrument to be his voluntary act and deed.

Witness my hand and Notarial Seal the day and year last above written

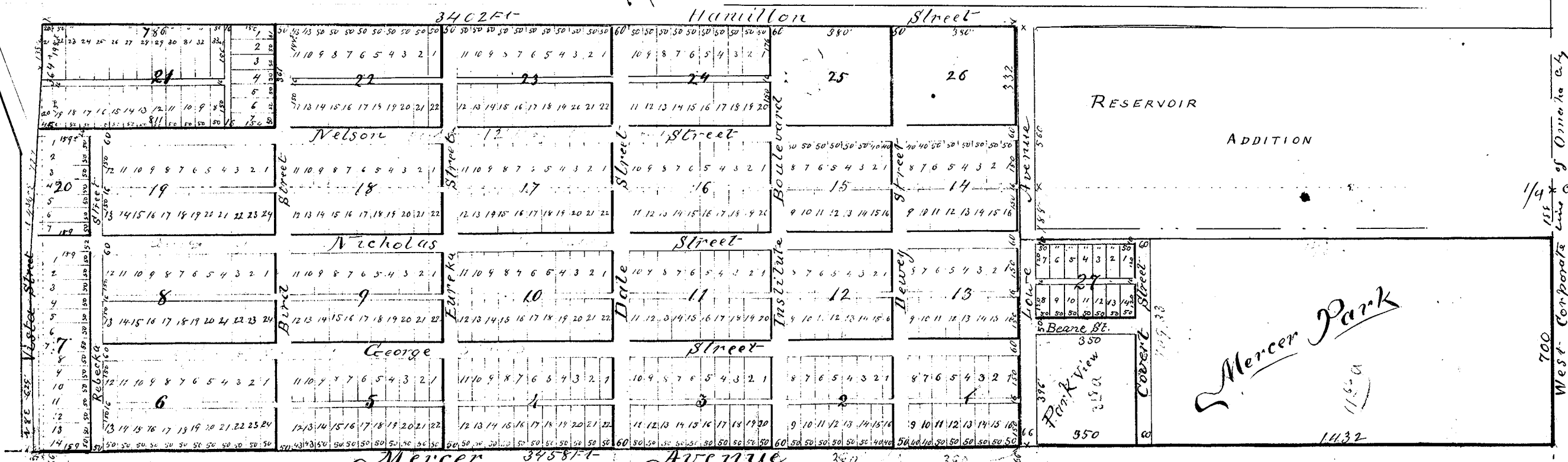

Geo W. Mills -  
 Notary Public.

I certify that I have staked off and marked the streets and alleys of Walnut Hill as shown on the above map, situated on the following described land - Beginning 587 ft W of the 1/4 cor between Sec 17 and 18 T15 N R13 of 6" P.M. then E 340 1/2 ft to Iowa Ave then S 1460 ft then West line N line Mercer Av 3458 ft to pt 62 ft W of N line Sec 17 then N 8 1/2 E 629 ft then N 4 3/4 E 727 ft to N line Sec 17 then N 138 1/2 ft to beginning - Also Beginning 188 ft S of the 1/4 cor between Sec 16 & 17 T15 N R13, then S 700 ft to N line Mercer Av, then W. along N line Mercer Av 1842 ft then North 712 ft to pt 188 ft S of E & W 1/2 Sec line through said Sec 17 then E 1836 ft to beginning.

Dec 4 1883. G. Griffith Surveyor

THE STATE OF NEBRASKA,  
 DOUGLAS COUNTY,  
 Entered on Numerical Index and filed for record in the Clerk's Office of said County, the 11th day of Dec at ... o'clock and ... Minutes and recorded in Book ... page ...