

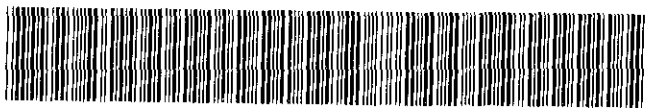

MISC 2006117597



OCT 12 2006 13:33 P 5

PERMANENT AND
TEMPORARY CONTRUCTION
EASEMENTS

Received - DIANE L. BATTIATO
Register of Deeds, Douglas County, NE
10/12/2006 13:33:25.22



2006117597

THIS AGREEMENT, made this 30th day of August, 2006 between LARRY E. BARTELS and GLORIA JEAN BARTELS, BRADLEY BARTELS and REBECCA SUDBECK, ("Grantors"), and METROPOLITAN UTILITIES DISTRICT OF OMAHA, a Municipal Corporation and Political Subdivision, ("Grantee"),

WITNESS:

Grantors, in consideration of the sum of Two Dollars (\$2.00) and other valuable consideration, receipt of which is acknowledged, hereby grants to Metropolitan Utilities District of Omaha, its successors and assigns, a permanent easement to lay, maintain, operate, repair, relay and remove, at any time, pipelines for the transportation of water and all appurtenances thereto, including, but not limited to, round iron covers, roadway boxes, hydrants, and pipeline markers and a temporary easement for construction purposes, together with the right of ingress and egress on, over, under and through ands described as follows:

TRACT ONE

PERMANENT EASEMENT

The easterly seventeen feet (17.00') of the westerly fifty feet (50.00') of the SE ¼ of Section 2-14-10 excluding the southerly two hundred eight and seventy-one one hundredths feet (208.71') of the northerly one thousand seven hundred ninety-one and ninety-seven one hundredths feet (1,791.97') and the southerly fifty feet (50.00').

This permanent easement contains 0.929 of an acre, more or less, and is shown on the attached drawing hereto and made a part hereof by reference.

TEMPORARY EASEMENT

The easterly thirty feet (30.00') of the westerly eighty feet (80.00') of the SE ¼ of Section 2-14-10 excluding the southerly two hundred eight and seventy-one one hundredths feet (208.71') of the northerly one thousand seven hundred ninety-one and ninety-seven one hundredths feet (1,791.97') and the southerly fifty feet (50.00').

This temporary easement contains 1.640 of an acre, more or less, and is shown on the attached drawing hereto and made a part hereof by reference.

TRACT TWO

PERMANENT EASEMENT

The easterly seventeen feet (17.00') of the westerly fifty feet (50.00') of the southerly two hundred eight and seventy-one one hundredths feet (208.71') of the northerly one thousand seven hundred ninety-one and ninety-seven one hundredths feet (1,791.97') of the SE ¼ of Section 2-14-10.

Please file & return to:

Patrick L. Tripp, Attorney
Metropolitan Utilities District
1723 Harney Street
Omaha, NE 68102-1960

Handwritten: b Mix 5 1

FEE	25.2	FB	0160000
BKP	2-14-10	COMP	
DEL		SCAN	FV

v26212

This permanent easement contains 0.081 of an acre, more or less, and is shown on the attached drawing hereto and made a part hereof by this reference.

TEMPORARY EASEMENT

The easterly thirty feet (30.00') of the westerly eighty feet (80.00') of the southerly two hundred eight and seventy-one one hundredths feet (208.71') of the northerly one thousand seven hundred ninety-one and ninety-seven one hundredths feet (1,791.97') of the SE ¼ of Section 2-14-10.

This temporary easement contains 0.144 of an acre, more or less, and is shown on the attached drawing hereto and made a part hereof by reference.

1. The Grantors and their successors and assigns shall not at any time erect, construct or place on or below the surface of the permanent easement any building or structure, except pavement or a similar covering, and shall not permit anyone else to do so. The same prohibitions shall apply to temporary easements. The effective period of the temporary easement shall commence upon the execution date hereof and end after completion of the project for which these easements are obtained.

2. The Grantee shall restore the soil excavated for any purpose hereunder, as nearly as is reasonably possible to its original contour within a reasonable time after the work is performed.

3. The Grantors are the lawful possessors of this real estate; have good, right and lawful authority to make such conveyance; and Grantors and their successors and assigns shall warrant and defend this conveyance and shall indemnify and hold harmless Grantee forever against claims of all persons asserting any right, title or interest prior to or contrary to this conveyance.

IN WITNESS WHEREOF, Grantors execute this Permanent and Temporary Easements on the above date.

LARRY E. BARTELS and GLORIA JEAN
BARTELS,
Grantors

By: Larry E. Bartels
Larry E. Bartels

By: Gloria Jean Bartels
Gloria Jean Bartels

BRADLEY BARTELS,
Grantor

By: Bradley E. Bartels
Bradley Bartels

REBECCA SUDBECK,
Grantor

By: Rebecca Sudbeck
Rebecca Sudbeck

ACKNOWLEDGMENT

STATE OF NEBRASKA)
) ss
COUNTY OF DOUGLAS)

This instrument was acknowledged before me on October 3rd, 2006,
by LARRY E. BARTELS.



Ann L. Kennedy
Notary Public

ACKNOWLEDGMENT

STATE OF NEBRASKA)
) ss
COUNTY OF DOUGLAS)

This instrument was acknowledged before me on October 3rd, 2006,
by GLORIA JEAN BARTELS.

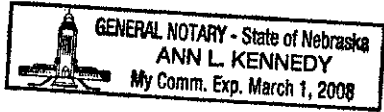

Ann L. Kennedy
Notary Public

ACKNOWLEDGMENT

STATE OF ^{Kansas} NEBRASKA)
) ss
COUNTY OF ^{Johnson} DOUGLAS)

This instrument was acknowledged before me on 30 August, ~~2004~~ ²⁰⁰⁶,
by BRADLEY BARTELS.

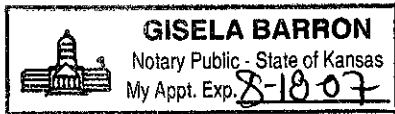

Gisela Barron
Notary Public

ACKNOWLEDGMENT

STATE OF NEBRASKA)
) ss
COUNTY OF DOUGLAS)

This instrument was acknowledged before me on October 3rd, 2006,
by REBECCA SUDBECK.

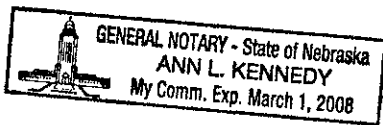

Ann L. Kennedy
Notary Public

**METROPOLITAN
UTILITIES
DISTRICT**
OMAHA, NEBRASKA

**EASEMENT
ACQUISITION**

FOR **WCP 10150**

LAND OWNER

Gloria J. Bartels
5151 S. 222nd Street
Elkhorn, NE 68022

TOTAL ACRE PERMANENT 0.929 ±
TOTAL ACRE TEMPORARY 1.640 ±

LEGEND



PERMANENT EASEMENT



TEMPORARY EASEMENT

PAGE 1 OF 1

DRAWN BY J.J.G.
DATE 3-15-06
CHECKED BY
DATE
APPROVED BY
DATE
REVISED BY
DATE
REV. CHK'D. BY
DATE
REV. APPROV. BY
DATE

Tract One

NO SCALE
222nd ST.; 1900' S. OF W. CENTER RD.
TO 1350' N. OF Q. ST.

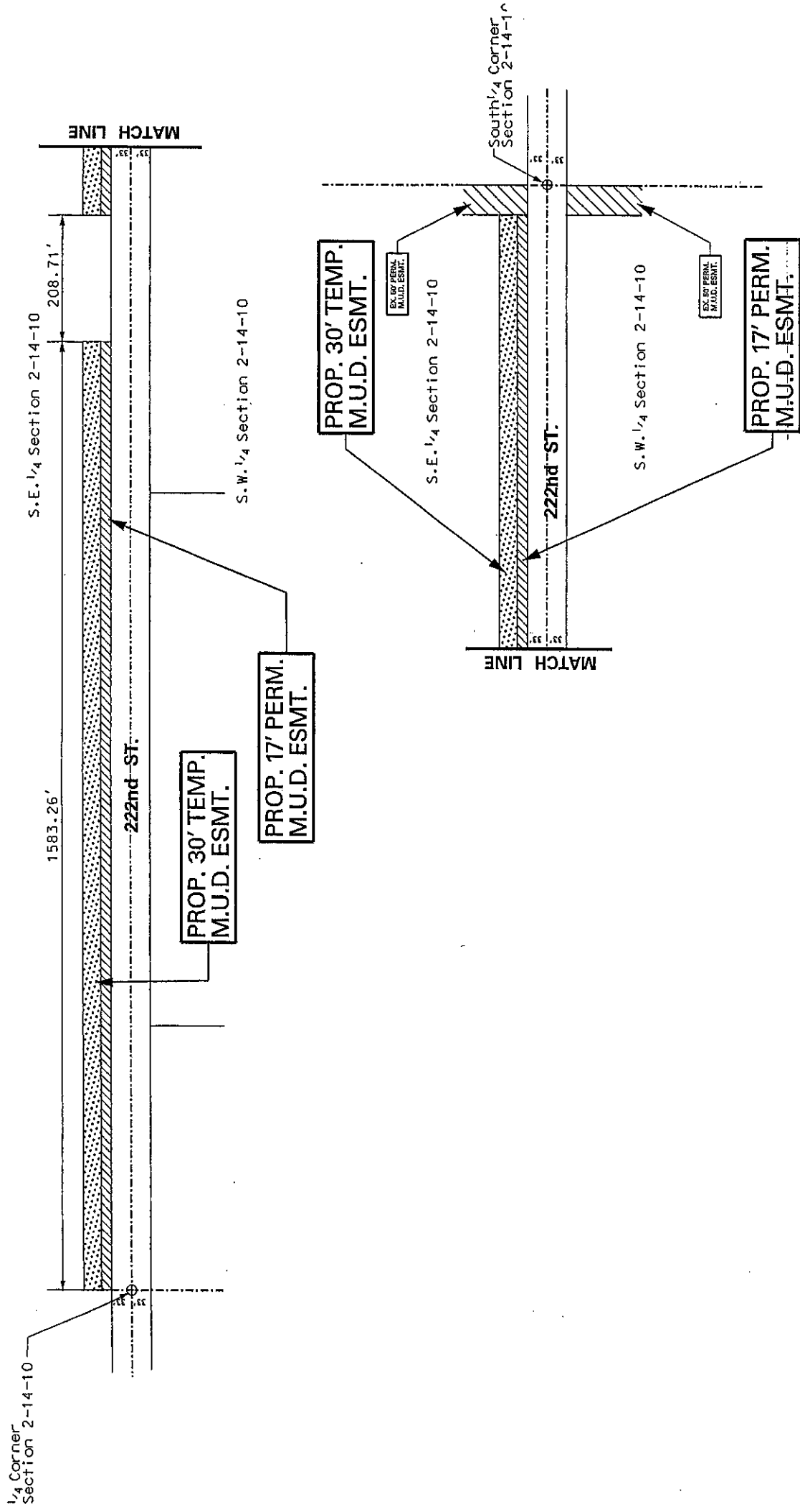

METROPOLITAN UTILITIES DISTRICT
 OMAHA, NEBRASKA

EASEMENT ACQUISITION

FOR **WCP 10150**

LAND OWNER _____

TOTAL ACRE PERMANENT 0.081 ±
 TOTAL ACRE TEMPORARY 0.144 ±

LEGEND

PERMANENT EASEMENT 

TEMPORARY EASEMENT 

PAGE 1 OF 1

DRAWN BY JJG
 DATE 3-15-06
 CHECKED BY _____
 DATE _____
 APPROVED BY _____
 DATE _____
 REVISED BY _____
 DATE _____
 REV. CHK'D. BY _____
 DATE _____
 REV. APPROV. BY _____
 DATE _____

NO. SCALE
 222nd ST.; 1900' S. OF W. CENTER RD.
 TO 1350' N. OF Q. ST.

S.E. 1/4 Section 2-14-10

1/4 Corner Section 2-14-10

1583.26'

208.71'

222nd ST.

S.W. 1/4 Section 2-14-10

PROP. 17' PERM. M.U.D. ESMT.

PROP. 30' TEMP. M.U.D. ESMT.

Tract Two