

MISCELLANEOUS RECORD, No. 79

15. VACATING ALLEY BET. FARNAM & HARNEY STS.
FROM SADDLE CREEK ROAD TO OMAHA BELT RY.

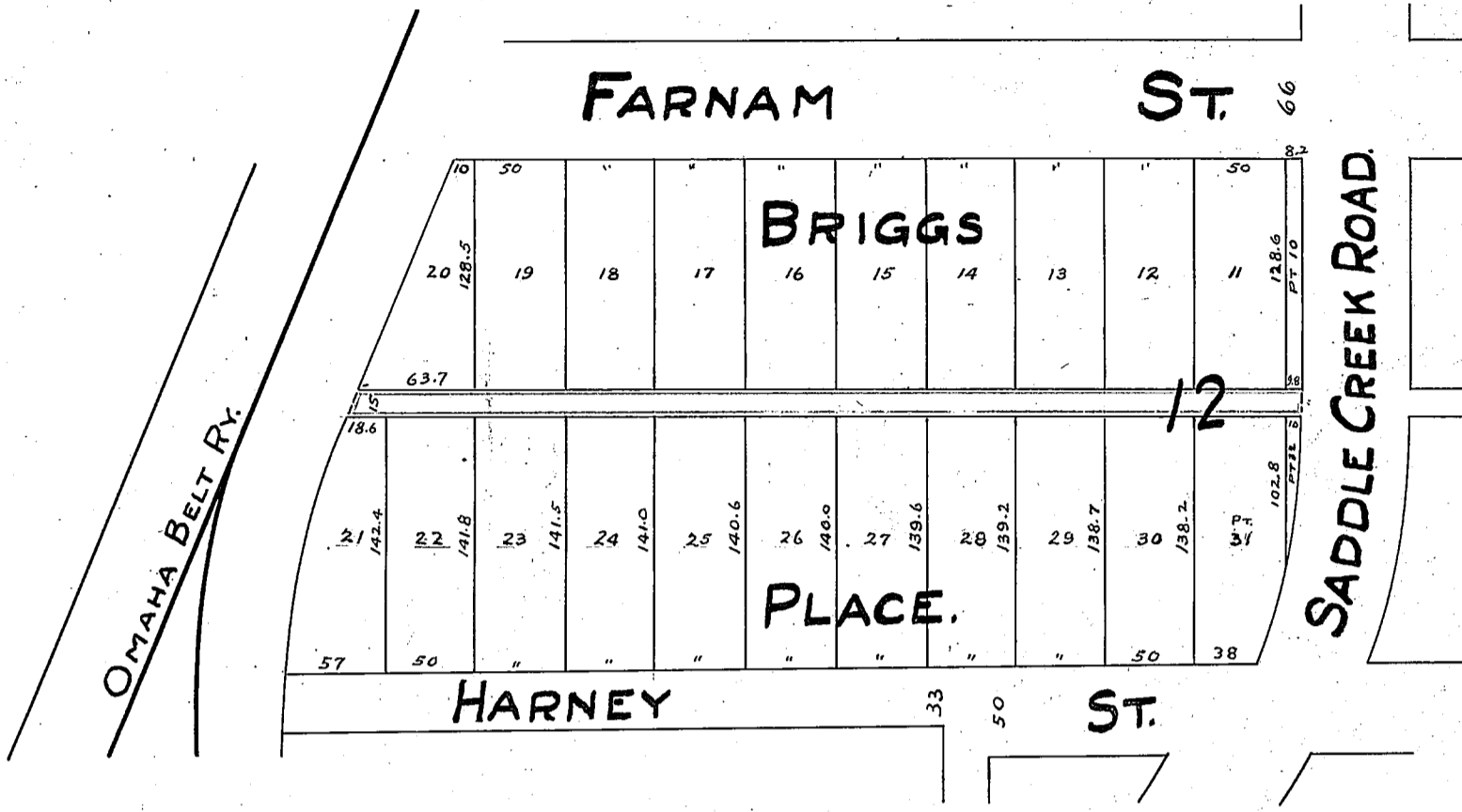

I hereby certify that this Plat is a true copy of Records on file in this Office.

Herman Beal,
City Engineer.

ORDINANCE No. 13133 Aug. 3, 1926.

DEPARTMENT OF PUBLIC IMPROVEMENTS, OMAHA, OFFICE OF CITY ENGINEER.		
VACATING ALLEY BET. FARNAM & HARNEY STS. FROM SADDLE CREEK ROAD TO OMAHA BELT RY.		
Made By Ed. S. Checked by	Scale 1 in- 100 ft.	Aug. 24, 1926. Drawing No. 148141

State of Nebraska,)
Douglas County,)

ss. Entered on Numerical Index and filed for Record in
the Register of Deeds' Office of said County, the 28th
day of August, A.D., 1926, at 11:35 o'clock A.M.

Harry Pearce,

Register of Deeds.

Compared by M.H.