

HOUSING COMMUNITY & DEVELOPMENT DEPARTMENT  
PERMITS & INSPECTIONS DIVISION

PUBLISH

BOOK 661 PAGE 271

WORK SHEET

ADDRESS So 2515 So 20 St STRUCTURE Office Bldg  
 TYPE C/B SIZE 10 x 20 x 12  
 BASEMENT no STORIES 1  
 OCCUPANT vacant  
 CONDITION OF BUILDING: Deteriorated

LOCATION: SHOW LOCATION OF STRUCTURE ON THE PLATTED BLOCK AS MEASURED FROM CENTER LINES OF STREETS TO CENTER LINE OF STRUCTURE.

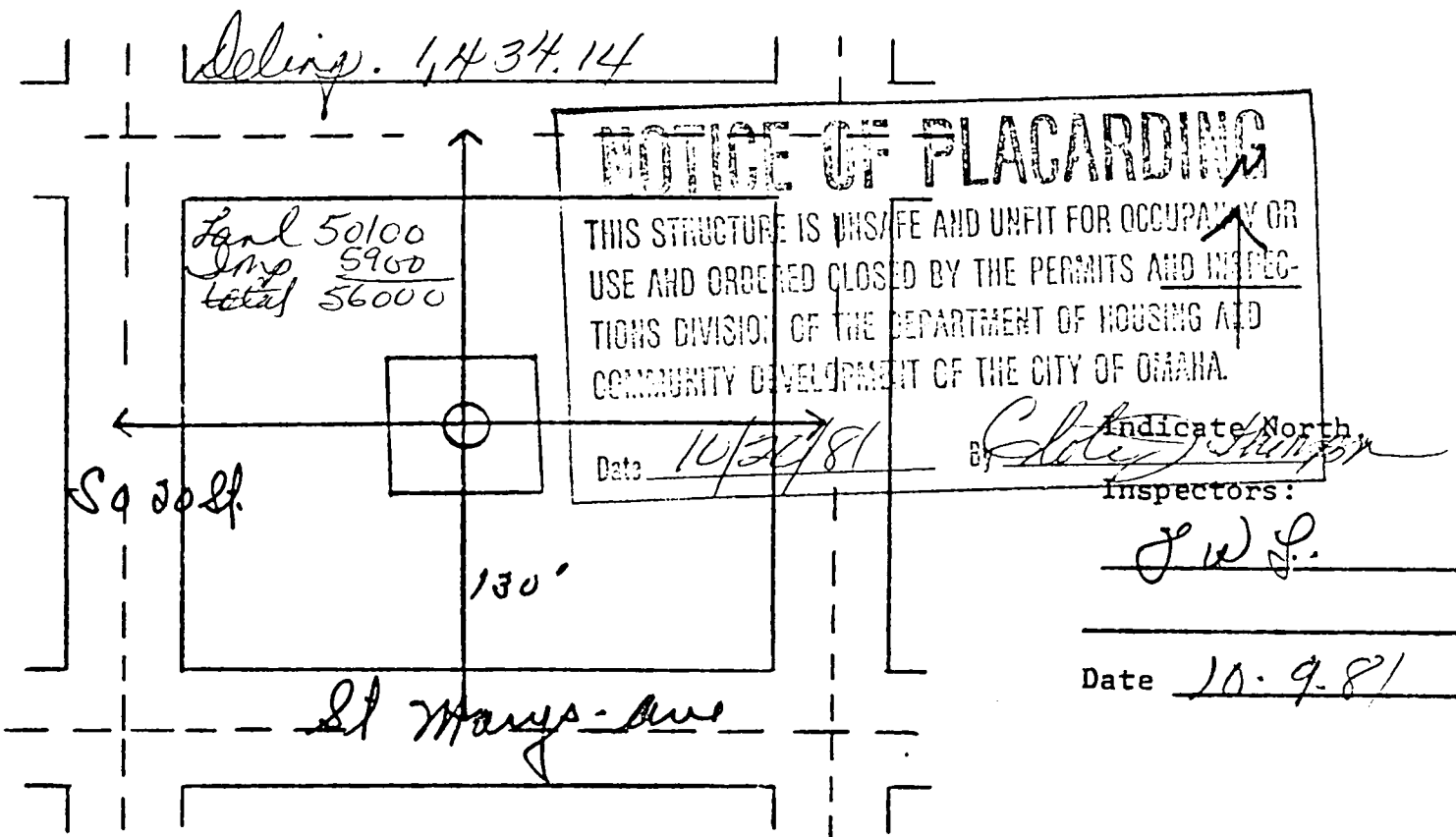

LEGAL DESCRIPTION LOTS 36 THRU 41 - KUNTZE - E - RESERVE REPLAT

OWNER: RECORD ENTERPRISES LTD

ADDRESS: 508 S. 19 STREET, OMAHA, NE 68102

MTG: NATIONAL ACCEPTANCE COMPANY C.C. RON HENNINGSEN  
 105 W. ADAMS STREET REG. AGENT  
 508 S. 19 STREET  
 CHICAGO, ILL  
 C. SHERIFF DELING. TAX DEPT. OMAHA, NE 68102

33 Miss

RECEIVED  
1981 OCT 20 PM 1:57

C. HAROLD OSTLER  
REGISTER OF DEEDS  
DOUGLAS COUNTY, NEBR.

Book 661  
Page 271  
of 271  
To: [Signature]  
In: [Signature]  
Copied [Signature]  
# 31A-109  
31A