



BK 0923 PG 323



MISC 1990 08295

THIS PAGE INCLUDED FOR  
INDEXING  
PAGE DOWN FOR BALANCE OF INSTRUMENT

March 19, 1990

BOOK 923 PAGE 323

Doc. \_\_\_\_\_

RIGHT-OF-WAY EASEMENT

I, Omaha School District # 1 Owner(s)  
We, \_\_\_\_\_  
of the real estate described as follows, and hereafter referred to as "Grantor",

The irregular South 1119.75 Feet of the North 1204.74 Feet of the Northeast Quarter (NE1/4) of Section Nineteen (19), Township Fifteen (15) North, Range Twelve (12) East of the 6th P.M., Douglas County, Nebraska, except roads, the intent being to describe a parcel of property bounded by West Dodge Street on the North, 120th Street on the East and Burke Street on the South and West, containing 69.38 acres more or less.

in consideration of the sum of One Dollar (\$1.00) and other valuable consideration, receipt of which is hereby acknowledged, do hereby grant to the OMAHA PUBLIC POWER DISTRICT, a public corporation, its successors and assigns referred to as "Grantee", a permanent right of way easement with rights of ingress and egress thereto, to construct, operate, maintain, replace and remove its underground electric facilities, consisting of cables, wires, conduits, manholes, drains, splicing boxes and other appurtenances, upon, over, along and under the following described real estate, to wit:

RECEIVED

See the reverse side hereof for sketch of easement area. MAY 14 9 58 AM '90

GEORGE J. BUGLEWICZ  
REGISTER OF DEEDS  
DOUGLAS COUNTY, NE

CONDITIONS: The Grantor hereby grants to the District, its successors and assigns, the right, privilege and authority to clear all trees, roots, brush, and other obstructions from the surface and subsurface of said strip and to temporarily open any fences crossing said strip. Grantor agrees that grade shall not be reduced more than One foot (1') in elevation without the prior approval of the District. The Grantor understands that a single pole and appurtenances may be used to provide service to this property.

In granting this easement, it is understood that said cables shall be buried below plow depth in order to not interfere with the ordinary cultivation of the strip. Damages to fences and growing crops arising from the construction and maintenance of the aforesaid system shall be paid for by the District.

The Grantor covenants that he/they has/have lawful possession of said real estate, good, right and lawful authority to make such conveyance and that his/her/their heirs, executors, administrators, successors and assigns shall warrant and defend the same and will indemnify and hold harmless the District forever against the claims of all persons whomsoever in any way asserting any right, title or interest prior to or contrary to this conveyance.

IN WITNESS WHEREOF, the parties hereto have signed their names and caused the execution of this instrument this 30th day of April, 19 90.

Stephen Kegan

Jos E. Hane

OK 923 N \_\_\_\_\_ C/O \_\_\_\_\_ FEE 10.50  
PG 323-24 N \_\_\_\_\_ DEL MC We  
OF Free COMP Q F/B 01-60000

Distribution Engineer \_\_\_\_\_ Date \_\_\_\_\_ Property Management MC Date 5-9-90

Section NE1/4 19 Township 15 North, Range 12 East

Salesman Zuehlke Engineer Korte Est. # 76013 D01 W.O. # 6026

COMPLETE APPROPRIATE ACKNOWLEDGEMENT ON REVERSE SIDE

STATE OF

Nebraska

COUNTY OF

Douglas

On this 30th day of April, 1990,  
before me the undersigned, a Notary Public in and  
for said County, personally came

Stephen J. Regan  
President of Board of Education

personally to me known to be the identical person(s)  
who signed the foregoing instrument as grantor(s)  
and who acknowledged the execution thereof to be  
his voluntary act and deed for  
the purpose therein expressed.

Witness my hand and Notarial Seal at Omaha  
Nebraska in said County the day and year  
last above written.

Joanne Malloy  
NOTARY PUBLIC



WEST

DODGE

STATE OF

COUNTY OF

On this \_\_\_\_\_ day of \_\_\_\_\_, 19\_\_\_\_,  
before me the undersigned, a Notary Public in and  
for said County and State, personally appeared

personally to me known to be the identical person(s)  
and who acknowledged the execution thereof to be  
\_\_\_\_\_ voluntary act and deed for  
the purpose therein expressed.

Witness my hand and Notarial Seal the date above  
written.

NOTARY PUBLIC

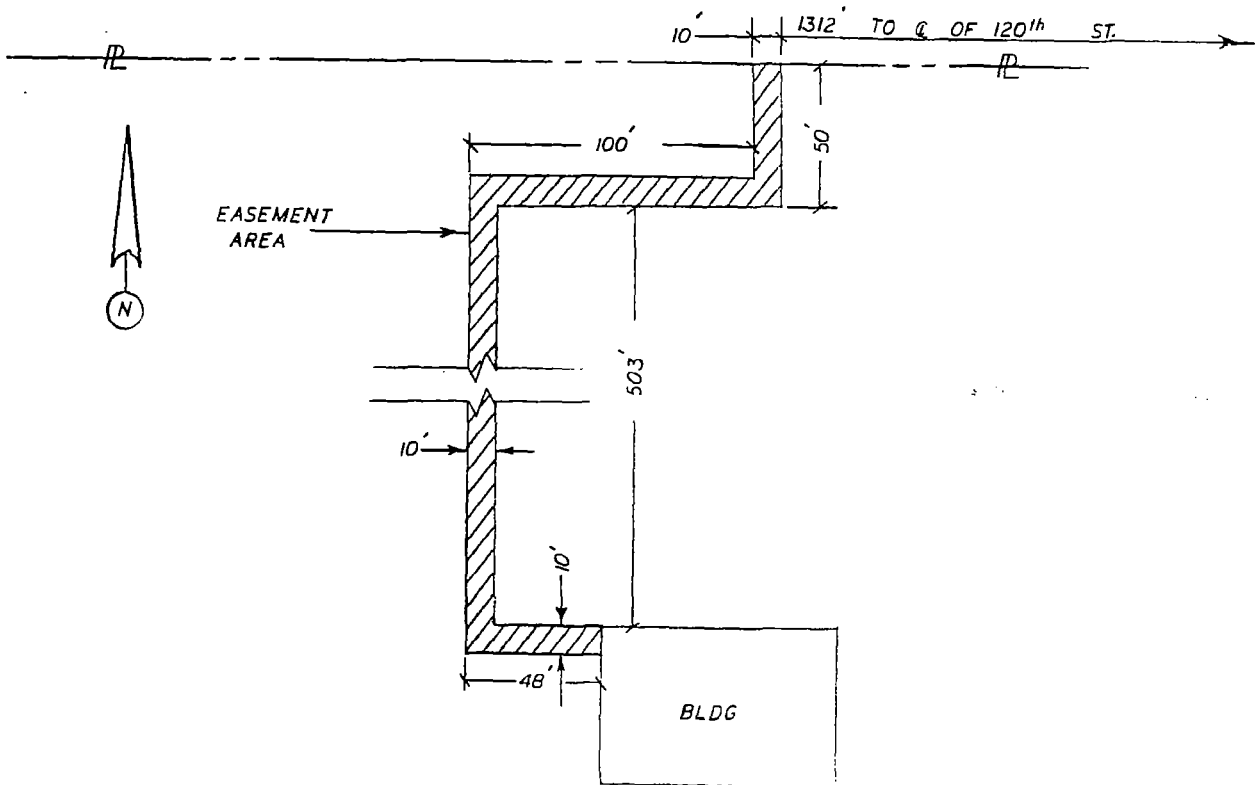

RETURN TO:  
MAHA PUBLIC POWER DISTRICT  
Real Estate Division  
1111 15th Street Mall  
Lincoln, NE 68102-2247