

B

LEGAL DESCRIPTION - EXHIBIT "A"

A parcel of land located in the Northeast Quarter and the East Half of the Northwest Quarter of Section 18, Township 14 North, Range 11 East of the 6th P.M., Sarpy County, Nebraska, more particularly described as follows:

BEGINNING at the Northeast Quarter Corner of said Section 18;

thence along the easterly line of said Northeast Quarter and along the centerline of 192nd Street, South 02 degrees 21 minutes 54 seconds East, a distance of 1750.97 feet to the Northeast Corner of Lot 1, Bellbrook, an addition to Sarpy County, Nebraska;

thence along the Northerly line of said Lot 1, South 87 degrees 38 minutes 06 seconds West, a distance of 670.00 feet to the Northwest Corner of said Lot 1;

thence along the Westerly line of said Lot 1, South 02 degrees 21 minutes 54 seconds East, a distance of 186.46 feet to the Northeast Corner of Outlot D, Bellbrook, Lots 2 through 184, an addition in Sarpy County, Nebraska;

thence along the Northerly line of said Outlot D, South 89 degrees 08 minutes 06 seconds West, a distance of 154.87 feet to Northwest Corner of said Outlot D;

thence along the Westerly line of said Outlot D, and along a curve, concave Westerly, having a radius of 1033.25 feet, an arc length of 30.63 feet to the Southwest Corner of said Outlot D;

thence along the Southerly line of said Outlot D, North 89 degrees 08 minutes 06 seconds East, a distance of 161.83 feet to the Southeast Corner of said Outlot D;

thence along the Westerly line of said Lot 1, Bellbrook, South 02 degrees 21 minutes 54 seconds East, a distance of 300.10 feet to the Northeast Corner of Outlot E, said Bellbrook, Lots 2 through 184;

thence along the Northerly line of said Outlot E, South 89 degrees 08 minutes 06 seconds West, a distance of 122.23 feet to the Northwest corner of said Outlot E;

thence southerly along the westerly line of said Outlot E, and along a curve, concave westerly; having a radius of 225.00 feet, an arc length of 94.35 feet to a point of reverse curve, said curve concave Northeasterly, having a radius of 30.00 feet;

thence southeasterly along said curve, an arc length of 37.14 feet to the end of said curve;

thence South 57 degrees 13 minutes 19 seconds East, a distance of 95.59 feet to the beginning of a curve, concave northerly, having a radius of 75.00 feet;

thence easterly, along said curve, an arc length of 40.67 feet to end of said curve;

thence along the Southerly line of said Lot 1, Bellbrook, North 86 degrees 55 minutes 48 seconds East, a distance of 670.95 feet to a point on said East line of the Northeast Quarter of Section 18;

C

thence along said East line and along the centerline of said 192nd Street, South 02 degrees 21 minutes 54 seconds East, a distance of 194.75 feet to East Quarter Corner of said Section 18;

thence along the Southerly line of said Northeast Quarter, South 86 degrees 54 minutes 58 seconds West, a distance of 2638.38 feet to the Center of said Section 18;

thence along the Southerly line of said East Half of the Northwest Quarter of said Section 18, South 86 degrees 54 minutes 58 seconds West, a distance of 1310.60 feet;

thence North 02 degrees 22 minutes 07 seconds West, a distance of 2587.69 feet to a point on the Southerly right-of-way line of Harrison Street;

thence along said Southerly right-of-way line, South 86 degrees 52 minutes 30 seconds West, a distance of 5.88 feet to a point on the Westerly line of said East Half of the Northwest Quarter;

thence along said Westerly line, North 02 degrees 18 minutes 32 seconds West, a distance of 50.01 feet to the Northwest Corner of said East Half of the Northwest Quarter;

thence along the Northerly line of said East Half of the Northwest Quarter, and along the centerline of Harrison Street, North 86 degrees 52 minutes 30 seconds East, a distance of 1318.18 feet to the North Quarter Corner of said Section 18;

thence along the Northerly line of said Northeast Quarter and along the centerline of said Harrison Street, North 86 degrees 52 minutes 33 seconds East, a distance of 2636.91 feet to the POINT OF BEGINNING.

Said parcel contains 228.27 acres, more or less.

2005/134802

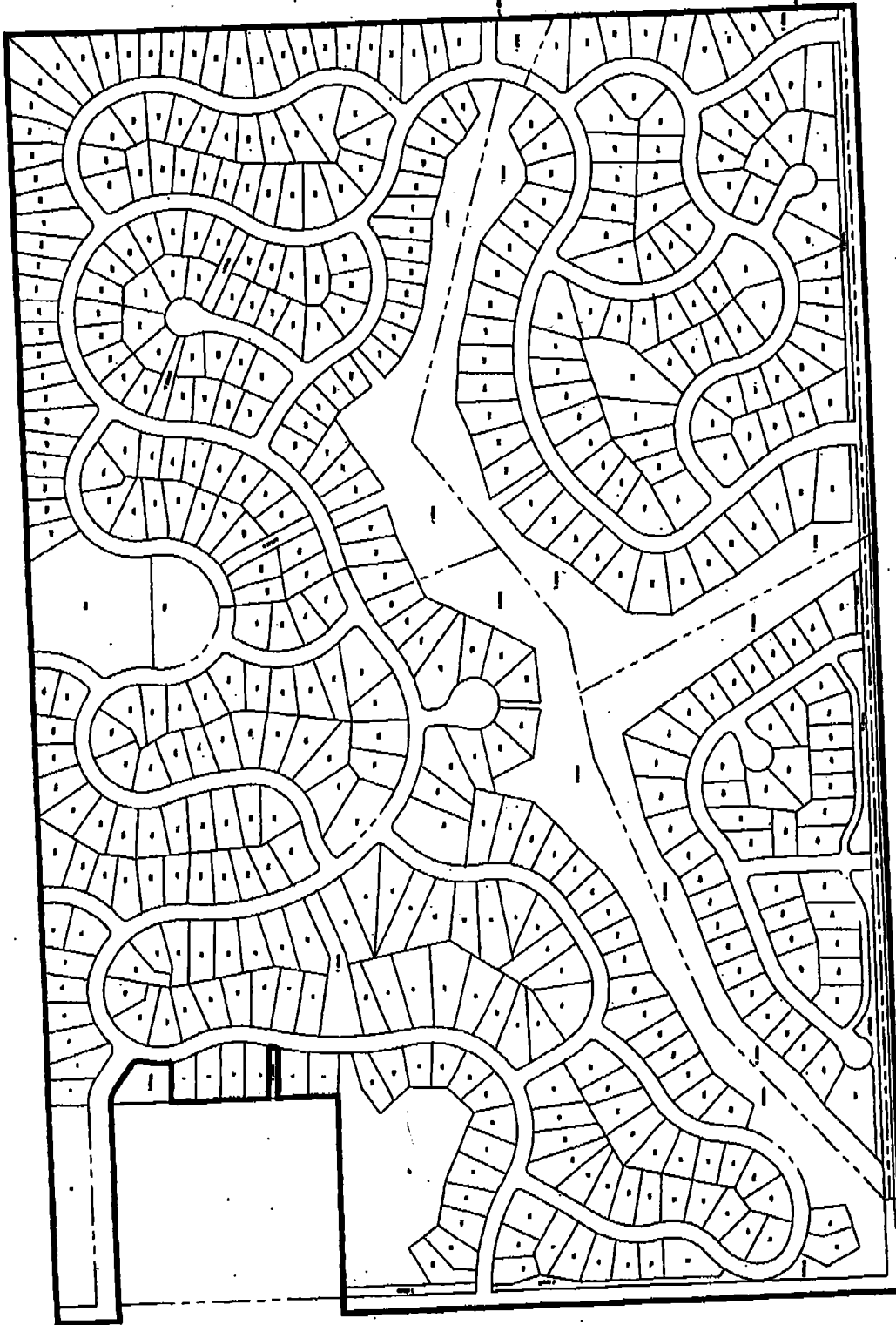

PROJECT NO.: 001-044-04
 DATE: APRIL, 2005
 DESIGNED: RLD
 DRAWN: MOB
 CHECKED: RLD
 SHEET NO.: 1 OF 1

EXHIBIT "A"

S.D. BOUNDARY
LOTS 2-403

BELLBROOK

SANITARY IMPROVEMENT DISTRICT NO. 261
SARPY COUNTY, NEBRASKA

THIS DOCUMENT AND THE INFORMATION
 HEREON ARE THE PROPERTY OF
 RD ENGINEERING, INC.
 NO PART OF THIS DOCUMENT
 MAY BE REPRODUCED OR
 TRANSMITTED IN ANY FORM
 OR BY ANY MEANS, ELECTRONIC
 OR MECHANICAL, INCLUDING
 PHOTOCOPYING, RECORDING,
 OR BY ANY INFORMATION
 STORAGE AND RETRIEVAL
 SYSTEM, WITHOUT THE
 WRITTEN PERMISSION OF
 RD ENGINEERING, INC.

rd
ENGINEERING, INC.
 11000 BURT STREET, SUITE 400
 OMAHA, NEBRASKA 68134
 402.886.4400 (P) • 402.886.4400 (FAX)