

NOTICE OF FILING OF CORRIDOR DESIGNATION PROTECTION

Notice is hereby given pursuant to the provision of RRS Nebraska Chapter 39, Articles 1311 thru 1311.05 that corridor protection has been filed on the following properties abutting HIGHWAY INTERSTATE 80 & INTERSTATE 680 AND ADJOINING COUNTY ROADS IN DOUGLAS County. The ownerships listed below were of record as of 12-11-85 For additional information refer to Corridor Protection Plan NO. IR-80-9(559) & IR-680-9(569) filed in douglas COUNTY ON 2-14-86 or call (402) 479-4761.

No	Owner	Description
1	GERALD L. & ISABEL E. KINSEL, H&W, JT	✓ LOT 9, BLK. 14, THOMASON & GOOS' ADD., OMAHA
2	JAMES K. & CHERYLE L. TAYLOR, H&W, JT	✓ LOT 10, BLK. 14, THOMASON & GOOS' ADD., OMAHA
3	RUTH M. REHWINKLE	✓ N. 76' LOT 11, BLK. 14, THOMASON & GOOS' ADD., OMAHA
4	JOANN O. RITCHEY	✓ S. 47.4' LOT 11, BLK. 14, THOMASON & GOOS' ADD., OMAHA
5	CONAGRA, INC., A DELEWARE CORP.	LOTS 1-4, BLK. 214, PT. LOT 1 & ALL LOTS 2-5, BLK. 206, LOTS 3, 5-8, BLK. 205, LOTS 12-14, BLK. 215, PT. VACATED "A" ST. & PT. VACATED GROVER ST., SOUTH OMAHA, OMAHA
6	WILLIAM A & HELEN B. PARR, H&W, JT	✓ LOT 10, BLK. 205, SOUTH OMAHA & Pt. So. Side Reserve, in Block 15, Thomason & Goos' Add. Omaha.
7	HELEN C. MANNING	✓ LOT 1, BLK. 205, SOUTH OMAHA, OMAHA
8	JOYLENE RUSSELL, ET AL.	✓ LOT 2, BLK. 205, SOUTH OMAHA, OMAHA
9	JERRY J. KOUBSKY & DUANE F. LARCHICK, TC	✓ LOT 4, BLK. 205, SOUTH OMAHA, OMAHA
10	LUCILLE WINEBRENNER	✓ LOT 9, BLK. 205, SOUTH OMAHA, OMAHA
11	THERESA M. WEIDNER	✓ LOT 7, BLK. 204, SOUTH OMAHA, OMAHA
12	DONNELL A. & ANN L. MORAN, H&W, JT	✓ LOT 8, BLK. 204, SOUTH OMAHA, OMAHA

48-317

SOFA

- 13 TERRY & JOLINE JOHNSON ✓ LOT 9, BLK. 204, SOUTH OMAHA, OMAHA
- 14 JAMES L. BUCHHOLZ ✓ LOTS 5 & 6, BLK. 204, SOUTH OMAHA, OMAHA
- 15 HELEN M. DUNBAR ✓ LOT 4, BLK. 204, SOUTH OMAHA, OMAHA
- 16 SOPHIA WIETZKI ✓ PT. LOT 1, BLK. 204, SOUTH OMAHA, OMAHA
- 17 HERMAN & BERTHA MUND, H&W, JT ✓ PT. LOTS 1 & 2, BLK. 204, SOUTH OMAHA, OMAHA
- 18 VIRGINIA REGINA LENCZOWSKI ✓ PT. LOTS 2 & 3, BLK. 204, SOUTH OMAHA, OMAHA
- 19 VEINNA KAY VEST & HILDA C. PIPPITT, JT ✓ PT. LOT 3, BLK. 204, SOUTH OMAHA, OMAHA
- 20 RAYMOND R. & LOIS E. VOYCHESKE, H&W, JT ✓ PT. LOTS 10 & 11, BLK. 204, SOUTH OMAHA, OMAHA
- 21 JUNIOR D. & ALICE A. FARLIN, H&W; JOHN D. FARLIN, JT ✓ PT. LOTS 10 & 11, BLK. 204, & 1/2 VACATED ALLEY, SOUTH OMAHA, OMAHA
- 22 LEONARD J. & ELEANOR L. BRICHACEK, H&W, JT ✓ PT. LOTS 12 & 13, BLK. 204, & 1/2 VACATED ALLEY, SOUTH OMAHA, OMAHA
- 23 KENNETH G. & KAREN M. SCHUELER, H&W, JT ✓ PT. LOTS 12 & 13, BLK. 204, SOUTH OMAHA, OMAHA
- 24 LESLIE H. & LINNEA K. SHOUP, H&W; DANIEL MERCER, JT ✓ PT. LOTS 12 & 13, BLK. 204, SOUTH OMAHA, OMAHA
- 25 U. S. NATIONAL BANK OF OMAHA ✓ PT. LOT 1, BLK. 216 & EAST 1/2 VACATED WEST BOULEVARD, SOUTH OMAHA, OMAHA
- 26 JERONA, INC., A NEBR. CORP. ✓ PT. LOT 1, BLK. 216 & LOT 14 & PT. LOT 1, BLK. 217, SOUTH OMAHA, OMAHA
- 27 LORRAINE O'NEILL ✓ NORTH 1/2 LOT 1, BLK. 203, SOUTH OMAHA, OMAHA
- 28 CARL E. BLANFORD ✓ SOUTH 1/2 LOT 1, BLK. 203, SOUTH OMAHA, OMAHA
- 29 CLINT W. CULBERTSON & RALPH E. CULBERTSON, JT ✓ LOT 2, BLK. 203, SOUTH OMAHA, OMAHA

- 30 DANIEL D. & KATHLEEN M. KOPERSKI, H&W, JT ✓ LOT 3, BLK. 203, SOUTH OMAHA, OMAHA
- 31 RONALD L. & CLARA C. SLYTER, H&W, TC ✓ LOT 4, BLK. 203, SOUTH OMAHA, OMAHA
- 32 JEROMA HIBBERD ✓ LOT 5, BLK. 203, SOUTH OMAHA, OMAHA
- 33 FRANK E. & MARY ANN MCCONNELL, H&W, JT ✓ LOT 6, BLK. 203, SOUTH OMAHA, OMAHA
- 34 FRANK J., JR. & LILLIAN STUTZ, H&W, JT ✓ LOT 7, BLK. 203, SOUTH OMAHA, OMAHA
- 35 VERNARD W. & BEVERLY J. KOPERSKI, H&W, JT ✓ LOT 8, BLK. 203, SOUTH OMAHA, OMAHA
- 36 GARLAND W. & JUANITA B. LAMB, H&W, JT ✓ LOT 9, BLK. 203, SOUTH OMAHA, OMAHA
- 37 VERNARD W. & BEVERLY J. KOPERSKI, H&W, JT ✓ LOT 10, BLK. 203, SOUTH OMAHA, OMAHA
- 38 STEPHEN RAY & DOREEN M. M. MCCONNELL, H&W, JT ✓ LOTS 6 & 7, BLK. 202, SOUTH OMAHA, OMAHA
- 39 HERBERT L. & HEDWIG T. MILLER, H&W, JT ✓ LOT 8, BLK. 202, SOUTH OMAHA, OMAHA
- 40 BEN H. & ELLA PINKES, H&W, JT ✓ LOT 9, BLK. 202, SOUTH OMAHA, OMAHA
- 41 ANN MARIE NOONAN ✓ LOT 10, BLK. 202, SOUTH OMAHA, OMAHA
- 42 BUYER: GENERAL COMMUNICATIONS COMPANY, INC. SELLER: ROBERT H. & BETTY J. WETHERBEE, H&W; ROBERT L. & ELOISE ROSS, H&W PT. LOTS 1[✓] & 2[✓], BLK. 201 & ALL LOTS 1[✓] & 2[✓], BLK. 202 & VACATED 30TH STREET, SOUTH OMAHA, OMAHA
- 43 SILVERWOOD ASSOC., INC. ✓ PT. LOTS 7, 8, 9, 11, 12, 24, 25 & ALL LOTS 29[✓] & 31[✓], SILVERWOOD ADD., OMAHA
- 44 BARBARA GORELICK ✓ PT. LOT 7, SILVERWOOD ADD., OMAHA ✓
- 45 JULE M. & CAROLYN R. NEWMAN, H&W, JT ✓ PT. LOT 8, SILVERWOOD ADD., OMAHA ✓

86-401

- 87-20-2 ✓
- 46 BROOK HOLLOW, INC. PT. S2SE4 SEC. 20-T15N-R12E & Lots 1, 14, 15, 17, 20, 24, 25, 28, 29, 30, 31, 32, 33 and Part Lot 26, Spyglass Hill. Omaha, ✓
- 47 PACIFIC HOLLOW, INC. ✓ PT. LOT 16, SPYGLASS HILL, OMAHA ✓
- 48 HAL GROVE, INC. ✓ PT. LOTS 16 & 18, SPYGLASS HILL, OMAHA ✓✓
- 49 RAYMOND L. & MARGARET L. JOHNSON, H&W, JT ✓ PT. LOT 18, SPYGLASS HILL, OMAHA ✓
- 50 HAL GROVE, INC. ✓✓ PT. LOTS 26 & 27, SPYGLASS HILL, OMAHA ✓✓
- 51 DENNIS E. & SHARON T. POTTER, H&W, JT ✓ PT. LOTS 26 & 27, BLK. 14, WEAR'S WEST PACIFIC ADD., OMAHA ✓
- 52 REBECCA LIEBSACK ✓ PT. LOTS 27 & 28, BLK. 14, WEAR'S WEST PACIFIC ADD., OMAHA ✓
- 53 JEANETTE F. MANGIARUCA ✓ PT. LOT 28, BLK. 14, WEAR'S WEST PACIFIC ADD., OMAHA ✓
- 54 SANITARY & IMPROVEMENT DISTRICT NO. 111 OF DOUGLAS COUNTY ✓ LOTS 1 THRU 21, BLK. 13, WEAR'S WEST PACIFIC ADD., OMAHA, & PT. N2SE4 SEC. 20-T15N-R12E ✓
- 55 DONALD T. & SHERRY L. LEGROS, H&W, JT ✓ LOT 139 & 1/2 VACATED STREET, BEL AIR ADD., OMAHA ✓
- 56 THOMAS W. & MARY ANNE HAUSER, H&W, JT ✓ LOT 140, BEL AIR ADD., OMAHA ✓
- 57 BROOK HOLLOW, INC. ✓ PT. LOT 146, BEL AIR ADD., OMAHA ✓
- 58 FIRST OF OMAHA SAVINGS CO. ✓ LOT 158 EXCEPT EASTERLY 15.0', BEL AIR ADD., OMAHA ✓
- 59 ELIZABETH C. TOMLINSON & MARGARET TOMLINSON DAVIS, TC ✓ PT. WEST 18 ACRES OF NE4NE4 SEC. 29-T15N-R12E ✓
- 60 LEROY G. & JEAN M. BOWER, H&W, JT ✓ LOT 1, BLK. 4, BEL AIR 2ND ADD. EXTENSION, OMAHA ✓
- 61 RICHARD J., JR. & ANN M. EVANS, H&W, JT ✓ LOT 2, BLK. 4, BEL AIR 2ND ADD. EXTENSION, OMAHA ✓
- 62 NELSON J. & ARLOA D. HYMANS, H&W, JT ✓ LOT 3, BLK. 4, BEL AIR 2ND ADD. EXTENSION, OMAHA ✓
- 71-379
20-15-12
69-1

BOOK

765 PAGE **189**

63 BUYER: RICHARD C. & DOROTHY
A. GILGUT, H&W
SELLER: ROBERT C. & ROSEMARY E.
WILLIAMS, H&W, JT

LOT 4, BLK. 4, BEL AIR 2ND ADD.
EXTENSION, OMAHA

64 CELLA QUINN & E. L. (MAC)
MCCALLUM, H&W, JT

✓ LOTS 10 THRU 13, BLK. 3 & 1/2
VACATED STREET, BEL AIR 2ND ADD.
EXTENSION, OMAHA

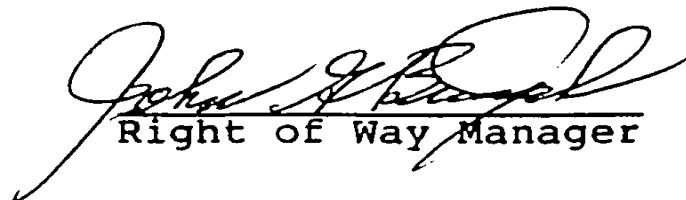
Right of Way Manager

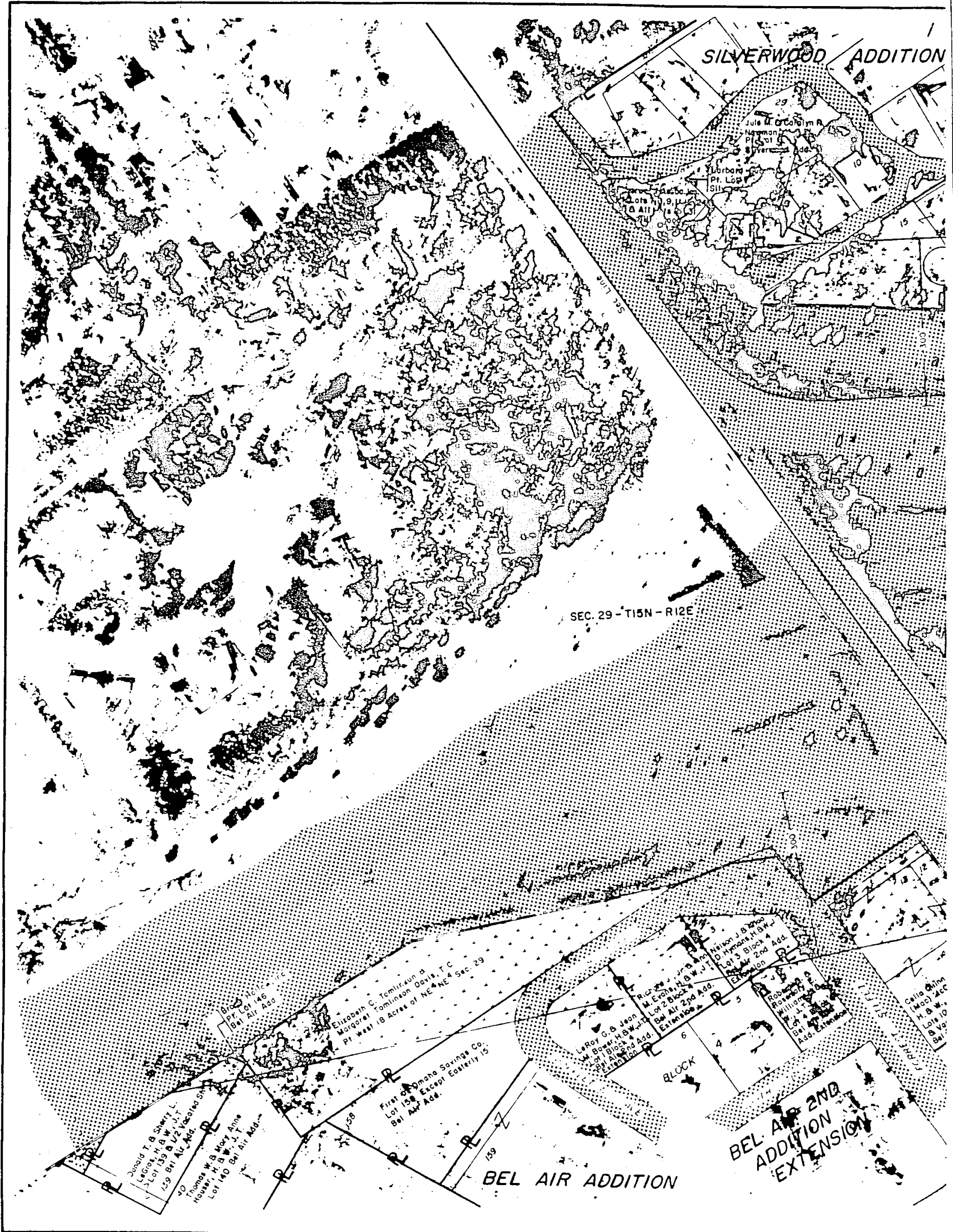

SILVERWOOD ADDITION

SEC. 29 - T15N - R12E

BEL AIR ADDITION

BEL AIR 2ND ADDITION EXTENSION

Douglas T. & Sherry L. LeGros, H.B.W.J.
Lot 159 & 172 Vacated on 12-9 Bel Air Add.

Thomas W. & Mary Anne Haver, H.B.W.J.
Lot 140 Bel Air Add.

Elizabeth C. Tomlinson & Margaret Tomlinson Davis, T.C.
Pr. West 18 Acres of NE 1/4 Sec. 29

First of Omaha Savings Co.
Lot 158 Except Easterly 15' Bel Air Add.

Loroy G. & Jean W. Boser, H.B.W.J.
Lot 1 Block 4 Bel Air 2nd Add. Extension

BLOCK

Richard J. & Jean M. Evans, H.B.W.J.
Lot 2 Block 4 Bel Air 2nd Add. Extension

Nelson J. & Doreen D. Henson, H.B.W.J.
Lot 3 Block 4 Bel Air 2nd Add. Extension

Robert & Rosemary Williams, H.B.W.J.
Lot 4 Block 4 Bel Air 2nd Add. Extension

Celia & John (Magg) McC...
Lot 10 & 11 Bel Air 2nd Add. Extension

SEC. 28 - T15N - R12E

SEC. 21 - T15N - R12E

20 - T15N - R12E

1-680 & PACIFIC	DOUGLAS COUNTY	IR-680 - 9 (569)	C.N. 21214
Approximate Corridor Location			

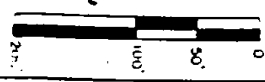

**WEAR'S WEST
PACIFIC ADDITION**

BLOCK 13
Lots 1 thru 21 Block 13
& Pt. A-25C Sec. 20

JOHN D. WEAR BLVD.

LEVENWORTH STREET

SPYGLASS HILL

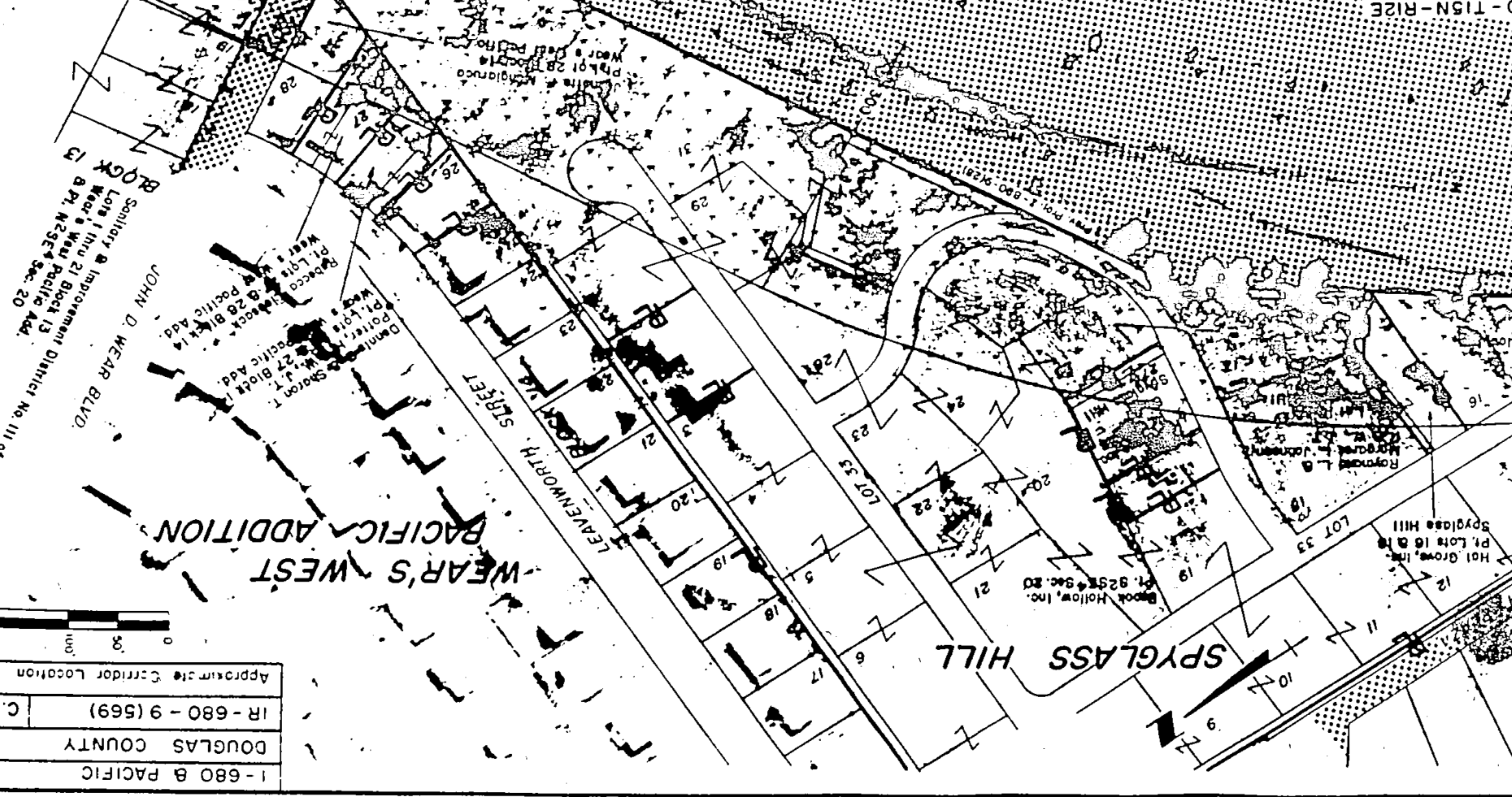



ORIGINAL TOWN OF SOUTH OMAHA

SEC 33-T15N-R13E

THOMASON & GOOS



3 ST S 34th E



Map annotations including:
PI VEGGED GROWL ST
Lot 10 B
Lot 11 B
Lot 12 B
Lot 13 B
Lot 14 B
Lot 15 B
Lot 16 B
Lot 17 B
Lot 18 B
Lot 19 B
Lot 20 B
Lot 21 B
Lot 22 B
Lot 23 B
Lot 24 B
Lot 25 B
Lot 26 B
Lot 27 B
Lot 28 B
Lot 29 B
Lot 30 B
Lot 31 B
Lot 32 B
Lot 33 B
Lot 34 B
Lot 35 B
Lot 36 B
Lot 37 B
Lot 38 B
Lot 39 B
Lot 40 B
Lot 41 B
Lot 42 B
Lot 43 B
Lot 44 B
Lot 45 B
Lot 46 B
Lot 47 B
Lot 48 B
Lot 49 B
Lot 50 B
Lot 51 B
Lot 52 B
Lot 53 B
Lot 54 B
Lot 55 B
Lot 56 B
Lot 57 B
Lot 58 B
Lot 59 B
Lot 60 B
Lot 61 B
Lot 62 B
Lot 63 B
Lot 64 B
Lot 65 B
Lot 66 B
Lot 67 B
Lot 68 B
Lot 69 B
Lot 70 B
Lot 71 B
Lot 72 B
Lot 73 B
Lot 74 B
Lot 75 B
Lot 76 B
Lot 77 B
Lot 78 B
Lot 79 B
Lot 80 B
Lot 81 B
Lot 82 B
Lot 83 B
Lot 84 B
Lot 85 B
Lot 86 B
Lot 87 B
Lot 88 B
Lot 89 B
Lot 90 B
Lot 91 B
Lot 92 B
Lot 93 B
Lot 94 B
Lot 95 B
Lot 96 B
Lot 97 B
Lot 98 B
Lot 99 B
Lot 100 B

Map annotations including:
Joann C Ritchey
5 47 4 Lot 11 Biv. 1A
Thompson B Good Add.
N 76 Lot 1 Biv. 1A
Thompson B Good Add.
Ruth M Remwale
N 76 Lot 1 Biv. 1A
Thompson B Good Add.
34th STREET

2360 MISC
B

RECEIVED
1985 FEB 14 AM 11:34
GEORGE J. SENCZ
REGISTER OF DEEDS
DOUGLAS COUNTY, NEBR.

Book 765
Page 193
of Misc
Fee 109.50
Del 129
Index 3 13
Comped 2
N _____
Comped 1
MC 1