

Numerical Index, Lancaster County

Block No. 5, BUCKINGHAM SOUTH 2ND ADD., City of Lincoln

| GRANTEE | GRANTOR | KIND OF INSTRUMENT | LOTS | | | | | | | | | | | | | | | | INSTR. NO. | REMARKS |
|---|-----------------------------|--------------------|------|---|---|---|---|---|----|----|----|----|----|----|----|----|----------|----------------------|----------------------------|-------------|
| | | | 1 | 2 | 3 | 4 | 5 | 6 | 7 | 8 | 9 | 10 | 11 | 12 | 13 | 14 | 15 | 16 | | |
| To The Public | Buckingham Development Co. | Plat | 12 | 3 | 4 | 5 | 6 | 7 | 8 | 9 | 10 | 11 | 12 | 13 | 14 | 15 | 16 | 76-24399 | 7-70 | OCT 19 1976 |
| Commercial Fed. S. & L. | Buckingham Development Co. | Plat | 1 | 2 | 3 | 4 | 5 | 6 | 7 | 8 | 9 | 10 | 11 | 12 | 13 | 14 | 15 | 77-21306 | # 2,052, 200 Nov. 9, 1976 | |
| Buckingham Development Co. | Commonwealth Co. | Release | 4 | 5 | 6 | 7 | 8 | 9 | 10 | 11 | 12 | 13 | 14 | 15 | 16 | | | 76-24362 | 74-214 wop Nov 9-1976 | |
| Lincoln Electric System | Buckingham Dev. Co. | Comm | | | | | | | | | | | | | | | | 77-532 | wop Nov 9, 1977 | |
| Buckingham Dev. Co. to City of Lincoln | City of Lincoln | Plat | 1 | 2 | 3 | 4 | 5 | 6 | 7 | 8 | 9 | 10 | 11 | 12 | 13 | 14 | 15 | 77-2777 | # 62765 Feb. 2, 1977 | |
| To the Public | Buckingham Development Co. | Plat | 3 | 4 | 5 | 6 | 7 | 8 | 9 | 10 | 11 | 12 | 13 | 14 | 15 | 16 | | 77-1188 | wop May 11, 1977 | |
| To the Public | Buckingham Development Co. | Plat | 3 | 4 | 5 | 6 | 7 | 8 | 9 | 10 | 11 | 12 | 13 | 14 | 15 | 16 | | 77-1188 | wop May 11, 1977 | |
| Lincoln Electric System | Buckingham Dev. Co. | Comm | | | | | | | | | | | | | | | | 77-4932 | wop July 28, 1977 | |
| Map Hall Realty Co. | Commercial Federal | Release | | | | | | | | | | | | | | | | 77-20007 | 76-26366 Aug 3, 1977 | |
| Debera A. Zich | Buckingham Dev. Co. | Release | | | | | | | | | | | | | | | | 77-20068 | Rev 7.15 Aug 3, 1977 | |
| As to Homestead | Debera Ann Zich | Att. | | | | | | | | | | | | | | | | 77-21013 | Aug 22, 1977 | |
| Commercial Federal | Debera Ann Zich | Att. | | | | | | | | | | | | | | | | 77-20114 | \$32,000 Aug 22, 1977 | |
| Stephens & Smith Const. Co. | Buckingham Dev. Co. | Release | | | | | | | | | | | | | | | | 77-23413 | Rev. 4.6.78 Sept 20, 1977 | |
| Buckingham Dev. Co. | Commercial Fed. | Att. | | | | | | | | | | | | | | | | 77-23882 | 76-26366 Sept 4, 1977 | |
| Lincoln Federal | Stephens & Smith Const. Co. | Att. | | | | | | | | | | | | | | | | 78-6075 | Rev. 11.31.78 | |
| State Security Svc. | Buckingham Dev. Co. | Att. | 1 | 2 | 3 | 4 | 5 | 6 | 7 | 8 | 9 | 10 | 12 | 13 | 15 | 16 | 78-10582 | \$75,000 May 1, 1978 | | |
| Commercial Federal | State Security Svc. | Att. | 1 | 2 | 3 | 4 | 5 | 6 | 7 | 8 | 9 | 10 | 12 | 13 | 15 | 16 | 78-10582 | 76-26366 May 1, 1978 | | |
| Tom Charles Atkinson | Buckingham Dev. Co. | W. Deed | | | | | | | | | | | | | | | | 78-20375 | Rev. 12.29 Aug 3, 1978 | |
| Buckingham Dev. Co. | State Security Svc. | Att. | | | | | | | | | | | | | | | | 78-21213 | 78-10582 Aug 11, 1978 | |
| Buckingham Dev. Co. | Commercial Fed. | Att. | | | | | | | | | | | | | | | | 78-21212 | 76-26366 Aug 11, 1978 | |
| State Federal | Stephens & Smith Const. Co. | Att. | | | | | | | | | | | | | | | | 78-21519 | Rev. 11.15.78 | |
| State Federal | Stephens & Smith Const. Co. | Att. | | | | | | | | | | | | | | | | 78-21550 | \$44,000 Aug 15, 1978 | |
| Stephens & Smith Const. Co. | Lincoln Federal | Release | | | | | | | | | | | | | | | | 78-22065 | 78-6075 Aug 21, 1978 | |
| Stephens & Smith Const. Co. | Buckingham Dev. Co. | Att. | | | | | | | | | | | | | | | | 78-23276 | Rev. 12.05 Sept 1, 1978 | |
| Buckingham Dev. Co. | State Security Svc. | Att. | | | | | | | | | | | | | | | | 78-23494 | 78-10582 Sept 5, 1978 | |
| Buckingham Dev. Co. | Commercial Fed. | Att. | | | | | | | | | | | | | | | | 78-23760 | 76-26366 Sept 7, 1978 | |
| Commercial Federal | Stephens & Smith Const. Co. | Att. | | | | | | | | | | | | | | | | 78-25432 | \$39,000 Sept 25, 1978 | |
| State Federal | Jan C. Atkinson | Att. | | | | | | | | | | | | | | | | 78-26272 | \$3,300 Oct 4, 1978 | |
| Jan C. Atkinson | Michael W. Jittle | Att. | | | | | | | | | | | | | | | | 78-30500 | \$1,765.52 Nov. 16-1978 | |
| As to Notice | Michael W. Jittle | Att. | | | | | | | | | | | | | | | | 78-30501 | Nov. 16-1978 | |
| Sears Enterprises, Inc. | Buckingham Dev. Co. | W. Deed | 3 | | | | | | | | | | | | | | | 78-32336 | Rev. 12.65 Dec. 6, 1978 | |
| Sears Enterprises, Inc. | Buckingham Dev. Co. | W. Deed | 4 | | | | | | | | | | | | | | | 78-32337 | Rev. 12.65 Dec. 6, 1978 | |
| Sears Enterprises, Inc. | Buckingham Dev. Co. | W. Deed | 5 | | | | | | | | | | | | | | | 78-32338 | Rev. 12.65 Dec. 6, 1978 | |
| Buckingham Dev. Co. | State Security Svc. | Att. | 3 | 4 | 5 | | | | | | | | | | | | | 78-33189 | 78-10582 Dec. 14, 1978 | |
| Buckingham Dev. Co., Inc. | Commercial Fed. | Att. | 3 | 4 | 5 | | | | | | | | | | | | | 78-33189 | 76-26366 Dec 14, 1978 | |
| As to Identity | Debera Ann Zich | Att. | | | | | | | | | | | | | | | | 78-8450 | 77-22013 Apr 12, 1979 | |
| Paul D. Phipps & Betty | Debera A. Zich | W. Deed | | | | | | | | | | | | | | | | 78-9167 | Rev. 12.70 Oct 17, 1979 | |
| Lincoln Federal | Paul D. Phipps | Att. | | | | | | | | | | | | | | | | 78-9168 | \$59,000 Oct 19, 1979 | |
| Debera A. Zich | Buckingham Dev. Co. | W. Deed | | | | | | | | | | | | | | | | 78-9229 | Rev. 12.70 Oct 23, 1979 | |
| Buckingham Development Co. | Commercial Federal | Att. | | | | | | | | | | | | | | | | 78-9606 | 78-10582 Nov 25, 1979 | |
| Buckingham Dev. Co., Inc. | Commercial Federal | Att. | | | | | | | | | | | | | | | | 78-9610 | 76-26366 Nov 25, 1979 | |
| Debera Ann Zich | Commercial Federal | Att. | | | | | | | | | | | | | | | | 78-9612 | 77-22014 Nov 25, 1979 | |
| Paul Jensen & Kelly E. | Buckingham Dev. Co. | W. Deed | | | | | | | | | | | | | | | | 16-12925 | \$20,110.00 Nov 30, 1979 | |
| Buckingham Dev. Co. | State Security Svc. | Att. | | | | | | | | | | | | | | | | 16-13692 | 78-10582 June 5, 1979 | |
| Buckingham Dev. Co., Inc. | Commercial Federal | Att. | | | | | | | | | | | | | | | | 16-13693 | 76-26366 June 5, 1979 | |
| Commercial Federal | Nels Jensen & Wj. | Att. | | | | | | | | | | | | | | | | 16-15376 | \$59,000 June 22, 1979 | |
| Michael W. Jittle | Buckingham Dev. Co. | W. Deed | 6 | 7 | | | | | | | | | | | | | | 78-15228 | Rev. 12.70 June 28, 1979 | |
| Michael W. Jittle | Buckingham Dev. Co. | W. Deed | 6 | 7 | | | | | | | | | | | | | | 78-15227 | Rev. 12.70 June 28, 1979 | |
| Buckingham Development | State Security Svc. | Att. | 6 | 7 | | | | | | | | | | | | | | 78-16357 | 78-10582 July 3, 1979 | |
| Buckingham Dev. Co., Inc. | Commercial Federal | Att. | 6 | 7 | | | | | | | | | | | | | | 78-16358 | 76-26366 July 3, 1979 | |
| Stephens & Smith Construction Co., Inc. | Buckingham Development | W. Deed | | | | | | | | | | | | | | | | Error | Rev. 11.02 July 20, 1979 | |
| Stephens & Smith Construction Co., Inc. | Buckingham Development | W. Deed | | | | | | | | | | | | | | | | Error | Rev. 11.02 July 20, 1979 | |
| Jan C. Atkinson | William F. Jackson | Att. | | | | | | | | | | | | | | | | 78-20803 | \$8,609.00 Aug 14, 1979 | |
| As to Mailing | William F. Jackson | Att. | | | | | | | | | | | | | | | | 78-20804 | Aug 14, 1979 | |
| Commercial Federal | Buckingham Dev. Co. | Att. | | | | | | | | | | | | | | | | 78-20845 | \$509,000 wop Aug 15, 1979 | |
| Buckingham Dev. Co., Inc. | Commercial Federal | Att. | | | | | | | | | | | | | | | | 78-21723 | 76-26366 Aug 23, 1979 | |
| Buckingham Development Co. | State Security Svc. | Release | 1 | 2 | 3 | 4 | 5 | 6 | 7 | 8 | 9 | 10 | 12 | 13 | 15 | 16 | | 78-21800 | 78-10582 wop Aug 24, 1979 | |
| Thomas Michael Kory Diane | Stephens & Smith Const. Co. | W. Deed | | | | | | | | | | | | | | | | 78-24174 | Rev. 12.70 Sept 14, 1979 | |
| State Federal | Thomas Michael Kory & Wj. | Att. | | | | | | | | | | | | | | | | 78-24175 | \$49,900 Sept 14, 1979 | |
| Stephens & Smith Const. Co. | Commercial Federal | Att. | | | | | | | | | | | | | | | | 78-24657 | 78-25432 Sept 24, 1979 | |
| Richard D. Rekart & Nancy A. | Nels Jensen & Wj. | W. Deed | | | | | | | | | | | | | | | | 78-25158 | Rev. 12.70 Sept 25, 1979 | |
| Lincoln Bank South | Harold E. Seary | Att. | 3 | 4 | 5 | | | | | | | | | | | | | 80-1435 | \$232,975 wop Jan 25, 1980 | |
| Harold E. Seary & Wj. | Lincoln Bank South | Release | 3 | 4 | 5 | | | | | | | | | | | | | 80-7370 | 80-1435 Jan 30, 1980 | |
| John W. French | Sears Enterprises, Inc. | W. Deed | 3 | 4 | | | | | | | | | | | | | | 80-7341 | Rev. 12.70 Jan 30, 1980 | |
| Harold E. Seary & Wj. | Lincoln Bank South | Att. | 4 | | | | | | | | | | | | | | | 80-18044 | 80-1435 Sept 10, 1980 | |
| May E. Amis & Wj. | Sears Enterprises, Inc. | W. Deed | 4 | | | | | | | | | | | | | | | 80-33746 | Rev. 12.70 Oct 14, 1980 | |
| Lincoln Federal | Stephens & Smith Const. Co. | Att. | 4 | | | | | | | | | | | | | | | 80-23747 | \$48,000.00 Oct 14, 1980 | |
| C. I. Financial Service | Marjorie Smith & Wj. | Att. | 4 | | | | | | | | | | | | | | | 80-26510 | \$698.07 Dec 29, 1980 | |
| Catherine Louise Gerdes | Stephens & Smith Const. Co. | Att. | | | | | | | | | | | | | | | | 81-682 | Rev. 12.15 Jan 18, 1981 | |

Numerical Index, Lancaster County

Block No. 5, BUCKINGHAM SOUTH 2ND ADD. City of Lincoln

| GRANTEE | GRANTOR | KIND OF INSTRUMENT | LOTS | | | | | | | | | | | | | | | | INSTRUMENT NO. | REMARKS |
|-------------------------------------|---------------------------|--------------------|------|---|---|---|---|---|---|---|---|----|----|----|----|----|----|--------|----------------------|--------------------|
| | | | 1 | 2 | 3 | 4 | 5 | 6 | 7 | 8 | 9 | 10 | 11 | 12 | 13 | 14 | 15 | 16 | | |
| To the Owner | Mirwyn F. Jackson | Quitclaim | | | | | | | | | | | | | | | | 12 | 81-2966 79-20803 | Feb 23, 1981 |
| Commercial Federal S & W | Walter Dean Bassel & wife | Mortgage | | | | | | | | | | | | | | | | | 81-2165 #27,000 | May 4, 1981 |
| Harold E. Spore & Phyllis G. Spore | Lincoln Bank South | Mortgage | | | | | | | | | | | | | | | | | 81-2355 70-1435 | May 6, 1981 |
| Walter D. Bassel & Phyllis G. Spore | Sears Enterprises, Inc. | W.D. Deed | | | | | | | | | | | | | | | | | 81-2356 70-1435 | May 6, 1981 |
| Hubert H. Hall et al | Commercial Federal S & W | Mortgage | | | | | | | | | | | | | | | | 8 9 10 | 81-2336 70-1435 | May 21, 1981 |
| Hubert H. Hall et al | Commercial Federal S & W | Mortgage | | | | | | | | | | | | | | | | | 82-1860 81-2336 | Feb 1, 1982 |
| First National Bank | May C. Atkinson | Release | | | | | | | | | | | | | | | | | 83-5961 #13,000 | Apr 14, 1983 |
| Paul D. Phipps & wife | C.F.I. Finance Co. | Release | | | | | | | | | | | | | | | | | 83-1182 80-26510 | June 29, 1983 |
| James T. MacCallister & wife | Paul D. Phipps & wife | W.D. Deed | | | | | | | | | | | | | | | | | 83-17606 Rev'd 86 70 | Subj Aug 30, 1983 |
| Paul D. Phipps & wife | Lincoln Federal S & W | Release | | | | | | | | | | | | | | | | | 83-1174 79-9168 | July 13, 1983 |
| Commercial Federal | Sheriff of Lancaster Co. | Release | | | | | | | | | | | | | | | | 8 9 10 | 84-766 0 | Apr 21, 1984 |
| Hubert H. Hall et al | Clack of District Court | Release | | | | | | | | | | | | | | | | 8 9 10 | 84-1125 76-2666 | May 14, 1984 |
| First Bank of Commerce | Jim C. Atkinson | Release | | | | | | | | | | | | | | | | | 84-14630 #7,500 | June 20, 1984 |
| Don C. Atkinson of Landlord | Don C. Atkinson | W.D. Deed | | | | | | | | | | | | | | | | | 84-25749 | joint Dec 22, 1984 |
| Frank C. Steinmann | M. John W. Frey | W.D. Deed | | | | | | | | | | | | | | | | | 84-30689 | joint Dec 14, 1984 |
| First National Bank | Frank C. Steinmann | Mortg. | | | | | | | | | | | | | | | | | 84-30670 | Dec 14, 1984 |
| First National Bank | Frank C. Steinmann | Mortg. | | | | | | | | | | | | | | | | | 84-30671 | Dec 14, 1984 |
| First National Bank | Frank C. Steinmann | Mortg. | | | | | | | | | | | | | | | | | 84-30685 | Dec 18, 1984 |
| Mark T. Headrick & wife | Mirwyn F. Jackson | W.D. Deed | | | | | | | | | | | | | | | | | 84-31257 #6,195 | Dec 20, 1984 |
| Mirwyn F. Jackson & wife | Mark T. Headrick & wife | W.D. Deed | | | | | | | | | | | | | | | | | 84-31258 #5,000 | Dec 20, 1984 |
| First National Bank | Frank C. Steinmann | Mortg. | | | | | | | | | | | | | | | | | 84-31773 63,466 | Dec 28, 1984 |
| Warner Construction Co. | Commercial Federal | W.D. Deed | | | | | | | | | | | | | | | | | 85-19217 | July 29, 1985 |
| Donald N. Northcutt | Warner Construction Co. | W.D. Deed | | | | | | | | | | | | | | | | 10 | 85-26225 | Oct 1, 1985 |
| Knutton Mortgage & Fin. Corp. | Donald N. Northcutt | W.D. Deed | | | | | | | | | | | | | | | | 10 | 85-26226 | Oct 1, 1985 |
| Knutton Mortgage & Fin. Corp. | Donald N. Northcutt | W.D. Deed | | | | | | | | | | | | | | | | 10 | 85-26227 | Oct 1, 1985 |
| Knutton Mortgage & Fin. Corp. | Donald N. Northcutt | W.D. Deed | | | | | | | | | | | | | | | | 10 | 85-26228 | Oct 1, 1985 |
| Knutton Mortgage & Fin. Corp. | Donald N. Northcutt | W.D. Deed | | | | | | | | | | | | | | | | 10 | 85-26229 | Oct 1, 1985 |
| Knutton Mortgage & Fin. Corp. | Donald N. Northcutt | W.D. Deed | | | | | | | | | | | | | | | | 10 | 85-26230 | Oct 1, 1985 |
| Knutton Mortgage & Fin. Corp. | Donald N. Northcutt | W.D. Deed | | | | | | | | | | | | | | | | 10 | 85-26231 | Oct 1, 1985 |
| Knutton Mortgage & Fin. Corp. | Donald N. Northcutt | W.D. Deed | | | | | | | | | | | | | | | | 10 | 85-26232 | Oct 1, 1985 |
| Knutton Mortgage & Fin. Corp. | Donald N. Northcutt | W.D. Deed | | | | | | | | | | | | | | | | 10 | 85-26233 | Oct 1, 1985 |
| Knutton Mortgage & Fin. Corp. | Donald N. Northcutt | W.D. Deed | | | | | | | | | | | | | | | | 10 | 85-26234 | Oct 1, 1985 |
| Knutton Mortgage & Fin. Corp. | Donald N. Northcutt | W.D. Deed | | | | | | | | | | | | | | | | 10 | 85-26235 | Oct 1, 1985 |
| Knutton Mortgage & Fin. Corp. | Donald N. Northcutt | W.D. Deed | | | | | | | | | | | | | | | | 10 | 85-26236 | Oct 1, 1985 |
| Knutton Mortgage & Fin. Corp. | Donald N. Northcutt | W.D. Deed | | | | | | | | | | | | | | | | 10 | 85-26237 | Oct 1, 1985 |
| Knutton Mortgage & Fin. Corp. | Donald N. Northcutt | W.D. Deed | | | | | | | | | | | | | | | | 10 | 85-26238 | Oct 1, 1985 |
| Knutton Mortgage & Fin. Corp. | Donald N. Northcutt | W.D. Deed | | | | | | | | | | | | | | | | 10 | 85-26239 | Oct 1, 1985 |
| Knutton Mortgage & Fin. Corp. | Donald N. Northcutt | W.D. Deed | | | | | | | | | | | | | | | | 10 | 85-26240 | Oct 1, 1985 |
| Knutton Mortgage & Fin. Corp. | Donald N. Northcutt | W.D. Deed | | | | | | | | | | | | | | | | 10 | 85-26241 | Oct 1, 1985 |
| Knutton Mortgage & Fin. Corp. | Donald N. Northcutt | W.D. Deed | | | | | | | | | | | | | | | | 10 | 85-26242 | Oct 1, 1985 |
| Knutton Mortgage & Fin. Corp. | Donald N. Northcutt | W.D. Deed | | | | | | | | | | | | | | | | 10 | 85-26243 | Oct 1, 1985 |
| Knutton Mortgage & Fin. Corp. | Donald N. Northcutt | W.D. Deed | | | | | | | | | | | | | | | | 10 | 85-26244 | Oct 1, 1985 |
| Knutton Mortgage & Fin. Corp. | Donald N. Northcutt | W.D. Deed | | | | | | | | | | | | | | | | 10 | 85-26245 | Oct 1, 1985 |
| Knutton Mortgage & Fin. Corp. | Donald N. Northcutt | W.D. Deed | | | | | | | | | | | | | | | | 10 | 85-26246 | Oct 1, 1985 |
| Knutton Mortgage & Fin. Corp. | Donald N. Northcutt | W.D. Deed | | | | | | | | | | | | | | | | 10 | 85-26247 | Oct 1, 1985 |
| Knutton Mortgage & Fin. Corp. | Donald N. Northcutt | W.D. Deed | | | | | | | | | | | | | | | | 10 | 85-26248 | Oct 1, 1985 |
| Knutton Mortgage & Fin. Corp. | Donald N. Northcutt | W.D. Deed | | | | | | | | | | | | | | | | 10 | 85-26249 | Oct 1, 1985 |
| Knutton Mortgage & Fin. Corp. | Donald N. Northcutt | W.D. Deed | | | | | | | | | | | | | | | | 10 | 85-26250 | Oct 1, 1985 |
| Knutton Mortgage & Fin. Corp. | Donald N. Northcutt | W.D. Deed | | | | | | | | | | | | | | | | 10 | 85-26251 | Oct 1, 1985 |
| Knutton Mortgage & Fin. Corp. | Donald N. Northcutt | W.D. Deed | | | | | | | | | | | | | | | | 10 | 85-26252 | Oct 1, 1985 |
| Knutton Mortgage & Fin. Corp. | Donald N. Northcutt | W.D. Deed | | | | | | | | | | | | | | | | 10 | 85-26253 | Oct 1, 1985 |
| Knutton Mortgage & Fin. Corp. | Donald N. Northcutt | W.D. Deed | | | | | | | | | | | | | | | | 10 | 85-26254 | Oct 1, 1985 |
| Knutton Mortgage & Fin. Corp. | Donald N. Northcutt | W.D. Deed | | | | | | | | | | | | | | | | 10 | 85-26255 | Oct 1, 1985 |
| Knutton Mortgage & Fin. Corp. | Donald N. Northcutt | W.D. Deed | | | | | | | | | | | | | | | | 10 | 85-26256 | Oct 1, 1985 |
| Knutton Mortgage & Fin. Corp. | Donald N. Northcutt | W.D. Deed | | | | | | | | | | | | | | | | 10 | 85-26257 | Oct 1, 1985 |
| Knutton Mortgage & Fin. Corp. | Donald N. Northcutt | W.D. Deed | | | | | | | | | | | | | | | | 10 | 85-26258 | Oct 1, 1985 |
| Knutton Mortgage & Fin. Corp. | Donald N. Northcutt | W.D. Deed | | | | | | | | | | | | | | | | 10 | 85-26259 | Oct 1, 1985 |
| Knutton Mortgage & Fin. Corp. | Donald N. Northcutt | W.D. Deed | | | | | | | | | | | | | | | | 10 | 85-26260 | Oct 1, 1985 |
| Knutton Mortgage & Fin. Corp. | Donald N. Northcutt | W.D. Deed | | | | | | | | | | | | | | | | 10 | 85-26261 | Oct 1, 1985 |
| Knutton Mortgage & Fin. Corp. | Donald N. Northcutt | W.D. Deed | | | | | | | | | | | | | | | | 10 | 85-26262 | Oct 1, 1985 |
| Knutton Mortgage & Fin. Corp. | Donald N. Northcutt | W.D. Deed | | | | | | | | | | | | | | | | 10 | 85-26263 | Oct 1, 1985 |
| Knutton Mortgage & Fin. Corp. | Donald N. Northcutt | W.D. Deed | | | | | | | | | | | | | | | | 10 | 85-26264 | Oct 1, 1985 |
| Knutton Mortgage & Fin. Corp. | Donald N. Northcutt | W.D. Deed | | | | | | | | | | | | | | | | 10 | 85-26265 | Oct 1, 1985 |
| Knutton Mortgage & Fin. Corp. | Donald N. Northcutt | W.D. Deed | | | | | | | | | | | | | | | | 10 | 85-26266 | Oct 1, 1985 |
| Knutton Mortgage & Fin. Corp. | Donald N. Northcutt | W.D. Deed | | | | | | | | | | | | | | | | 10 | 85-26267 | Oct 1, 1985 |
| Knutton Mortgage & Fin. Corp. | Donald N. Northcutt | W.D. Deed | | | | | | | | | | | | | | | | 10 | 85-26268 | Oct 1, 1985 |
| Knutton Mortgage & Fin. Corp. | Donald N. Northcutt | W.D. Deed | | | | | | | | | | | | | | | | 10 | 85-26269 | Oct 1, 1985 |
| Knutton Mortgage & Fin. Corp. | Donald N. Northcutt | W.D. Deed | | | | | | | | | | | | | | | | 10 | 85-26270 | Oct 1, 1985 |
| Knutton Mortgage & Fin. Corp. | Donald N. Northcutt | W.D. Deed | | | | | | | | | | | | | | | | 10 | 85-26271 | Oct 1, 1985 |
| Knutton Mortgage & Fin. Corp. | Donald N. Northcutt | W.D. Deed | | | | | | | | | | | | | | | | 10 | 85-26272 | Oct 1, 1985 |
| Knutton Mortgage & Fin. Corp. | Donald N. Northcutt | W.D. Deed | | | | | | | | | | | | | | | | 10 | 85-26273 | Oct 1, 1985 |
| Knutton Mortgage & Fin. Corp. | Donald N. Northcutt | W.D. Deed | | | | | | | | | | | | | | | | 10 | 85-26274 | Oct 1, 1985 |
| Knutton Mortgage & Fin. Corp. | Donald N. Northcutt | W.D. Deed | | | | | | | | | | | | | | | | 10 | 85-26275 | Oct 1, 1985 |
| Knutton Mortgage & Fin. Corp. | Donald N. Northcutt | W.D. Deed | | | | | | | | | | | | | | | | 10 | 85-26276 | Oct 1, 1985 |
| Knutton Mortgage & Fin. Corp. | Donald N. Northcutt | W.D. Deed | | | | | | | | | | | | | | | | 10 | 85-26277 | Oct 1, 1985 |
| Knutton Mortgage & Fin. Corp. | Donald N. Northcutt | W.D. Deed | | | | | | | | | | | | | | | | 10 | 85-26278 | Oct 1, 1985 |
| Knutton Mortgage & Fin. Corp. | Donald N. Northcutt | W.D. Deed | | | | | | | | | | | | | | | | 10 | 85-26279 | Oct 1, 1985 |
| Knutton Mortgage & Fin. Corp. | Donald N. Northcutt | W.D. Deed | | | | | | | | | | | | | | | | 10 | 85-26280 | Oct 1, 1985 |
| Knutton Mortgage & Fin. Corp. | Donald N. Northcutt | W.D. Deed | | | | | | | | | | | | | | | | 10 | 85-26281 | Oct 1, 1985 |
| Knutton Mortgage & Fin. Corp. | Donald N. Northcutt | W.D. Deed | | | | | | | | | | | | | | | | 10 | 85-26282 | Oct 1, 1985 |
| Knutton Mortgage & Fin. Corp. | Donald N. Northcutt | W.D. Deed | | | | | | | | | | | | | | | | 10 | 85-26283 | Oct 1, 1985 |
| Knutton Mortgage & Fin. Corp. | Donald N. Northcutt | W.D. Deed | | | | | | | | | | | | | | | | 10 | 85-26284 | Oct 1, 1985 |
| Knutton Mortgage & Fin. Corp. | Donald N. Northcutt | W.D. Deed | | | | | | | | | | | | | | | | 10 | 85-26285 | Oct 1, 1985 |
| Knutton Mortgage & Fin. Corp. | Donald N. Northcutt | W.D. Deed | | | | | | | | | | | | | | | | 10 | 85-26286 | Oct 1, 1985 |
| Knutton Mortgage & Fin. Corp. | Donald N. Northcutt</ | | | | | | | | | | | | | | | | | | | |

Return to Search Results

You searched for: FilingDate >= Tue Jan 01 00:00:00 CST 1901 and <= Fri Jun 19 00:00:00 CDT 2015 and Subdivision=AMB15BS2 and Block=5 and Lot=2

27 items found, displaying all items.1

| Description | Summary | <u>Add All to My Images</u> |
|---------------------------------|---|--------------------------------|
| ✓ Amend Plat 1987025651 | Thu Jul 30 08:45:00 CDT 1987 Grantor: BUCKINGHAM SOUTH INC Grantee: AMENDED PLAT OF L2,PT L1 B1,L1-10,12,13,OLB B5 BUCKINGHAM... Subdivision BUCKINGHAM SOUTH 2ND ADD Block 1 Lot 1 Partial Lot P, ... | View Image Add to My Images |
| ✗ Quit Claim Deed 1987025722 | Thu Jul 30 11:54:00 CDT 1987 Grantor: BUCKINGHAM SOUTH INC Grantee: KASSEBAUM CHARLES K ETAL, TOOHEY SHARON L ETAL Subdivision AMENDED PLAT OF PT B1,5 BUCKINGHAM SOUTH SECOND ADDITION Block 5 Lot 2 | View Image Add to My Images |
| ✗ Quit Claim Deed 1987032495 | Tue Sep 29 15:54:00 CDT 1987 Grantor: BUCKINGHAM SOUTH INC Grantee: KASSEBAUM CHARLES K ETAL, TOOHEY SHARON L ETAL Subdivision AMENDED PLAT OF PT B1,5 BUCKINGHAM SOUTH SECOND ADDITION Block 5 Lot 2 | View Image Add to My Images |
| ✗ Assignment 1988031150 | Fri Oct 07 10:50:00 CDT 1988 Grantor: FIRSTIER MORTGAGE CO Grantee: LEADER FEDERAL SAVINGS & LOAN ASSN Subdivision AMENDED PLAT OF PT B1,5 BUCKINGHAM SOUTH SECOND ADDITION Block 5 Lot 2 | View Image Add to My Images |
| ✗ Deed of Trust 1989012432 | Mon May 15 08:40:00 CDT 1989 | View Image Add to My Images |

86-37551 L2P5 B5 2nd

| Description | Summary | Add All to My Images |
|--|---|--|
| | <p>Grantor: KASSEBAUM CHARLES K ETAL, TOOHEY SHARON ETAL</p> <p>Grantee: LEADER FEDERAL BANK FOR SAVINGS</p> <p>Subdivision AMENDED PLAT OF PT B1,5 BUCKINGHAM SOUTH SECOND ADDITION Block 5 Lot 2</p> <p>86-37551</p> | |
| <p>Sheriff's Deed 1990013191</p> | <p>Mon May 14 13:09:00 CDT 1990</p> <p>Grantor: SHERIFF OF LANCASTER COUNTY NEBRASKA</p> <p>Grantee: LEYPOLDT GARY W</p> <p>Subdivision AMENDED PLAT OF L1-8,OLB B2 BUCKINGHAM SOUTH FIRST ADDITION Block 2 Lot 1 Partial Lot P, ...</p> | <p>View Image Add to My Images</p> |
| <p>Quit Claim Deed 1991000041</p> | <p>NO REV WOP</p> <p>Wed Jan 02 11:29:00 CST 1991</p> <p>Grantor: LEYPOLDT GARY W</p> <p>Grantee: KASSEBAUM CHARLES K ETAL, TOOHEY SHARON L ETAL</p> <p>Subdivision AMENDED PLAT OF PT B1,5 BUCKINGHAM SOUTH SECOND ADDITION Block 5 Lot 2</p> <p>REV \$1.50 COMMON</p> | <p>View Image Add to My Images</p> |
| <p>Ratify Plat 1991004177</p> | <p>Wed Feb 13 15:59:00 CST 1991</p> <p>Grantor: LUFT GREGORY & WF MARY J ETAL, LUFT MARY J & HSB GREGORY ETAL, MALER LEE & WF NORMA J ETAL, MALER NORMA J & HSB LEE ETAL, KASSEBAUM CHARLES K ETAL, ...</p> <p>Subdivision AMENDED PLAT OF PT B1,5 BUCKINGHAM SOUTH SECOND ADDITION Block 1, ...</p> <p>WOP</p> | <p>View Image Add to My Images</p> |
| <p>Partial Release 1991011572</p> | <p>Mon Apr 22 11:48:00 CDT 1991</p> <p>Grantor: COMMERCIAL FEDERAL SAVINGS AND LOAN ASN</p> <p>Grantee: BUCKINGHAM DEVELOPMENT COMPANY</p> <p>Subdivision AMENDED PLAT OF PT B1,5 BUCKINGHAM SOUTH SECOND ADDITION Block 5 Lot 1, ...</p> <p>(79-20843) LTS 1-10, 12&13</p> | <p>View Image Add to My Images</p> |
| <p>Acknowledgement 1993021347</p> | <p>Wed May 26 11:53:00 CDT 1993</p> | <p>View Image Add to My Images</p> |

| Description | Summary | Add All to My Images |
|--|---|--------------------------------|
| Deed of Trust 1993021348 | Grantor: KASSEBAUM CHARLES K & WF, TOOHEY SHARON L & HSB Grantee: COMMERCIAL FEDERAL MORTGAGE CORPORATION Subdivision AMENDED PLAT OF PT B1,5 BUCKINGHAM SOUTH SECOND ADDITION Block 5 Lot 2 | View Image Add to My Images |
| Deed of Trust 1993021348 | Wed May 26 11:53:00 CDT 1993 Grantor: KASSEBAUM CHARLES K & WF, TOOHEY SHARON L & HSB Grantee: COMMERCIAL FEDERAL MORTGAGE CORPORATION Subdivision AMENDED PLAT OF PT B1,5 BUCKINGHAM SOUTH SECOND ADDITION Block 5 Lot 2 \$71,000.00 | View Image Add to My Images |
| Deed of Reconveyance 1993025718 | Fri Jun 18 10:22:00 CDT 1993 Grantor: LEADER FEDERAL BANK FOR SAVINGS Grantee: KASSEBAUM CHARLES K & WF, TOOHEY SHARON & HSB Subdivision AMENDED PLAT OF PT B1,5 BUCKINGHAM SOUTH SECOND ADDITION Block 5 Lot 2 89-12432 | View Image Add to My Images |
| Deed of Reconveyance 1993060131 | Wed Dec 29 11:46:00 CST 1993 Grantor: LEADER FEDERAL BANK FOR SAVINGS Grantee: KASSEBAUM CHARLES K & WF, TOOHEY SHARON L & HSB Subdivision AMENDED PLAT OF PT B1,5 BUCKINGHAM SOUTH SECOND ADDITION Block 5 Lot 2 86-37551 | View Image Add to My Images |
| Deed of Trust 1998004540 | Tue Feb 03 14:18:00 CST 1998 Grantor: KASSEBAUM CHARLES K & WF, TOOHEY SHARON L & HSB Grantee: UNION BANK & TRUST COMPANY Subdivision AMENDED PLAT OF PT B1,5 BUCKINGHAM SOUTH SECOND ADDITION Block 5 Lot 2 \$10,000.00 | View Image Add to My Images |
| Deed of Trust 1999041457 | Tue Jul 27 16:36:00 CDT 1999 Grantor: KASSEBAUM CHARLES K & WF, TOOHEY SHARON L & HSB Grantee: UNION BANK & TRUST COMPANY Subdivision AMENDED PLAT OF PT B1,5 BUCKINGHAM SOUTH SECOND ADDITION Block 5 Lot 2 \$24,561.15 FUTURE ADVANCES | View Image Add to My Images |

View Image

no release filed

maturity date 1/27/00

| <u>Description</u> | <u>Summary</u> | <u>Add All to My Images</u> |
|--|--|--------------------------------|
| Deed of Trust 2001062590 | Thu Oct 25 15:32:00 CDT 2001 Grantor: KASSEBAUM CHARLES K Grantee: COMMERCIAL FEDERAL BANK Subdivision AMENDED PLAT OF PT B1,5 BUCKINGHAM SOUTH SECOND ADDITION Block 5 Lot 2 \$36,557.00 | Add to My Images |
| Deed of Reconveyance 2001077593 | Mon Dec 24 14:07:00 CST 2001 Grantor: UNION BANK & TRUST COMPANY Grantee: KASSEBAUM CHARLES & WF, TOOHEY SHARON & HSB Subdivision AMENDED PLAT OF PT B1,5 BUCKINGHAM SOUTH SECOND ADDITION Block 5 Lot 2 99-41457 L2,PT L1 RR | View Image Add to My Images |
| Deed of Reconveyance 2002064278 | Tue Sep 24 16:02:00 CDT 2002 Grantor: COMMERCIAL FEDERAL BANK Grantee: KASSEBAUM CHARLES K Subdivision AMENDED PLAT OF PT B1,5 BUCKINGHAM SOUTH SECOND ADDITION Block 5 Lot 2 01-62590 | View Image Add to My Images |
| Deed of Trust 2002070964 | Wed Oct 16 15:30:00 CDT 2002 Grantor: KASSEBAUM CHARLES K & WF, TOOHEY SHARON L & HSB Grantee: STATE FARM BANK Subdivision AMENDED PLAT OF PT B1,5 BUCKINGHAM SOUTH SECOND ADDITION Block 5 Lot 2 \$25,000.00 | View Image Add to My Images |
| Deed of Reconveyance 2003053803 | Fri Jun 06 14:59:00 CDT 2003 Grantor: COMMERCIAL FEDERAL MORTGAGE CORPORATION Grantee: KASSEBAUM CHARLES K & WF, TOOHEY SHARON L & HSB Subdivision AMENDED PLAT OF PT B1,5 BUCKINGHAM SOUTH SECOND ADDITION Block 5 Lot 2 93-21347 <i>RS</i> | View Image Add to My Images |
| Modify Deed of Trust 2005057344 | Mon Sep 26 15:03:00 CDT 2005 Grantor: KASSEBAUM CHARLES K & WF, TOOHEY SHARON L & HSB Grantee: STATE FARM BANK Subdivision AMENDED PLAT OF PT B1,5 BUCKINGHAM SOUTH SECOND ADDITION Block 5 Lot 2 02-70964 | View Image Add to My Images |

| Description | Summary | Add All to My Images |
|--|---|--------------------------------|
| Deed of Reconveyance 2005070948 | Thu Dec 01 16:05:32 CST 2005 Grantor: STATE FARM BANK Grantee: KASSEBAUM CHARLES K & WF, TOOHEY SHARON L & HSB Subdivision AMENDED PLAT OF PT B1,5 BUCKINGHAM SOUTH SECOND ADDITION Block 5 Lot 2 2002-070964, 2005-057344 | View Image Add to My Images |
| Deed of Trust 2005073302 | Wed Dec 14 11:37:27 CST 2005 Grantor: KASSEBAUM CHARLES K ETAL, TOOHEY SHARON L ETAL Grantee: ING BANK Subdivision AMENDED PLAT OF PT B1,5 BUCKINGHAM SOUTH SECOND ADDITION Block 5 Lot 2 \$34,000.00 | View Image Add to My Images |
| Substitute Trustee 2009048986 | Tue Apr 14 15:35:55 CDT 2009 Grantor: ING BANK Grantee: LANGDON WILLIAM Subdivision AMENDED PLAT OF PT B1,5 BUCKINGHAM SOUTH SECOND ADDITION Block 5 Lot 2 2005-073302 | View Image Add to My Images |
| Deed of Reconveyance 2009048987 | Tue Apr 14 15:35:55 CDT 2009 Grantor: ING BANK Grantee: KASSEBAUM CHARLES K ETAL, TOOHEY SHARON L ETAL Subdivision AMENDED PLAT OF PT B1,5 BUCKINGHAM SOUTH SECOND ADDITION Block 5 Lot 2 2005-073302 | View Image Add to My Images |
| Warranty Deed 2014038268 | Fri Oct 03 15:04:11 CDT 2014 Grantor: KASSEBAUM CHARLES K Grantee: KASSEBAUM CHARLES K TRUSTEE, CHARLES K KASSEBAUM REVOCABLE TRUST Subdivision AMENDED PLAT OF PT B1,5 BUCKINGHAM SOUTH SECOND ADDITION Block 5 Lot 2 \$0.00 | View Image Add to My Images |
| Affidavit - Death Cert 2014038269 | Fri Oct 03 15:04:11 CDT 2014 Grantor: NEBRASKA DEPARTMENT OF HEALTH Grantee: TOOHEY SHARON L Subdivision AMENDED PLAT OF PT B1,5 BUCKINGHAM SOUTH SECOND ADDITION Block 5 Lot 2 | View Image Add to My Images |

Description

Summary

Add All to My Images

27 items found, displaying all items.1

[Return to Search Results](#)

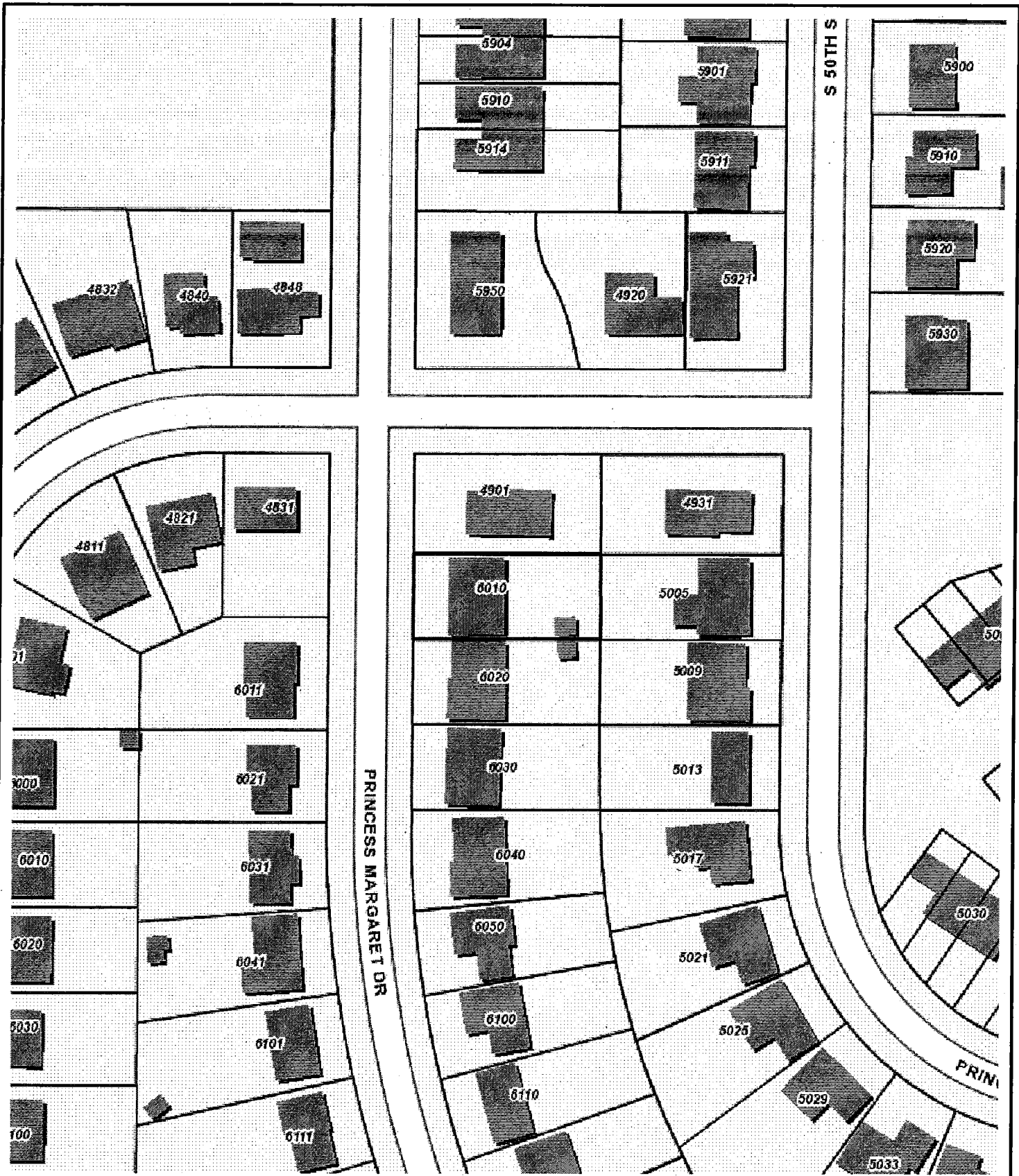

Lancaster County/City of Lincoln GIS Map

6010



Printed: Jun 23, 2015

DISCLAIMER: The information is presented on a best-efforts basis, and should not be relied upon for making financial, survey, legal or other commitments. If you have questions or comments regarding the data displayed on this map, please email ags@lincoln.ne.gov and you will be directed to the appropriate department.