

# ORDINANCE RECORD

No. 72 B-REARFIELD & COMPANY INC., OMAHA

94-17054

ORDINANCE NO. 2237

AN ORDINANCE TO ANNEX TO THE CITY OF BELLEVUE, SARPY COUNTY, NEBRASKA, CERTAIN LANDS, LOTS, AND REAL ESTATE LYING WITHIN THE BELOW DESCRIBED BOUNDARIES, TO THE CITY OF BELLEVUE, SARPY COUNTY, NEBRASKA, AND DESIGNATING AN EFFECTIVE DATE.

WHEREAS, ALL OF THE LOTS, LANDS, AND REAL ESTATE LYING WITHIN THE BOUNDARIES DESCRIBED AS FOLLOWS, TO WIT:

## AVERY COMMERCIAL INDUSTRIAL PLAZA

A parcel of ground located in the southwest quarter of Section 23, Township 14 North, Range 13 East; Southeast Quarter of Section 22, Township 14 North, Range 13 East; Northwest Quarter of Section 26, Township 14 North, Range 13 East; and the Northeast Quarter Section of 27, Township 14 North, Range 13 East of the 6th Principal Meridan, Sarpy County, Nebraska.

Beginning at the southeast corner of lot 8-LALA and running west along the north right-of-way line of Smith Road approximately six hundred eighty seven and twenty-two hundreds (687.22) feet to a point on the west right-of-way line of Nineth Avenue. Then south along the west right-of-way line of Nineth Avenue approximately seven hundred (700) feet to the point of intersection with the north right-of-way line of Thurston Avenue. Then west approximately one thousand nine hundred thirty three and eighty-nine hundreds (1933.89) feet to the point intersecting the east right-of-way line of Fifteenth Street. Then south along the east right-of-way line of Fifteenth Street approximately sixty six (66) feet to a point intersecting the south right-of-way of Thurston Avenue. Then easterly approximately one thousand one hundred sixty (1160) feet along the south right-of-way line of Thurston Avenue to the northwest corner of lot 21 of Avery Commercial Industrial Plaza. Then southerly approximately six hundred thirty five and ninety-seven hundreds (635.97) feet to the southwest corner of lot 19 of Avery Commercial Industrial Plaza. Then easterly along the south lines of lots 19, 18 & 17 approximately five hundred forty six and thirty-one hundreds (546.31) feet to the southeast corner of lot 17 of Avery Commercial Industrial Plaza. Then southerly along the east lines of lots 15, 14 and 13 approximately four hundred forty two and fifteen hundreds (442.15) feet to the southeast corner of lot 13 of Avery Commercial Industrial Plaza. Then easterly approximately two hundred twenty six and eighty-two hundreds (226.83) feet to the southeast corner of lot 12 of Avery Commercial Industrial Plaza. Then northerly along the west right-of-way of the Union Pacific Railroad track approximately one thousand six hundred ten and thirty-three hundreds (1610.33) feet to the northeast corner of lot 1 of Avery Commercial Industrial Plaza. Then westerly along the north line of lot 1 of Avery Commercial Industrial Plaza approximately five hundred thirty one and fifty-eight hundreds (531.58) feet to the northwest line of said lot. Then north along the east right-of-way line of Nineth Avenue approximately three hundred (300) feet to the south right-of-way line of Smith Road. Then east along the south right-of-way of Smith Road approximately four hundred (400) feet to a point intersecting the east line of lot 8-LALA extended. Then north approximately sixty six (66) feet to the point of beginning.

17054

# ORDINANCE RECORD

No. 728 - Revised & Copyright Inc., Omaha

ARE CONTIGUOUS AND ADJACENT TO THE CITY OF BELLEVUE, NEBRASKA, AND ARE URBAN OR SUBURBAN IN CHARACTER, AND

WHEREAS, SAID REAL ESTATE WILL RECEIVE MATERIAL BENEFITS AND ADVANTAGES FROM ANNEXATION TO THE SAID CITY.

NOW, THEREFORE, BE IT ORDAINED BY THE MAYOR AND CITY COUNCIL OF THE CITY OF BELLEVUE, NEBRASKA:

Section 1. All of the real estate lying within the area heretofore described be and the same hereby is included within the boundaries and territory of the City of Bellevue, Nebraska, and said lands and the persons residing thereon shall hereafter be subject to all of the rules, regulations, ordinances, taxes, and all other burdens and benefits of other persons and territory included within the City of Bellevue, Nebraska.

Section 2. This Ordinance shall take effect and be in full force and effect on and after January 10, 1983 and after its passage, approval and publication according to law.

Passed and approved this 10<sup>th</sup> day of January, 1983.

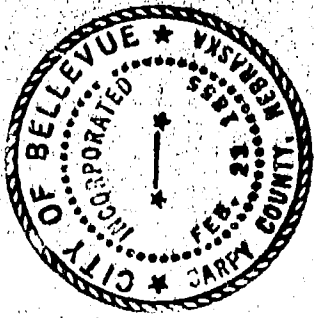

*[Signature]*  
Mayor

Attest.

*[Signature]*  
City Clerk

First reading: \_\_\_\_\_  
Second reading: *[Signature]*  
Third reading: \_\_\_\_\_

MS 94-17054

94 JAN 23 PM 1:24



*[Signature]*  
Clerk

Verify	_____
Filed	_____
Checked	_____
Fee \$	110.00

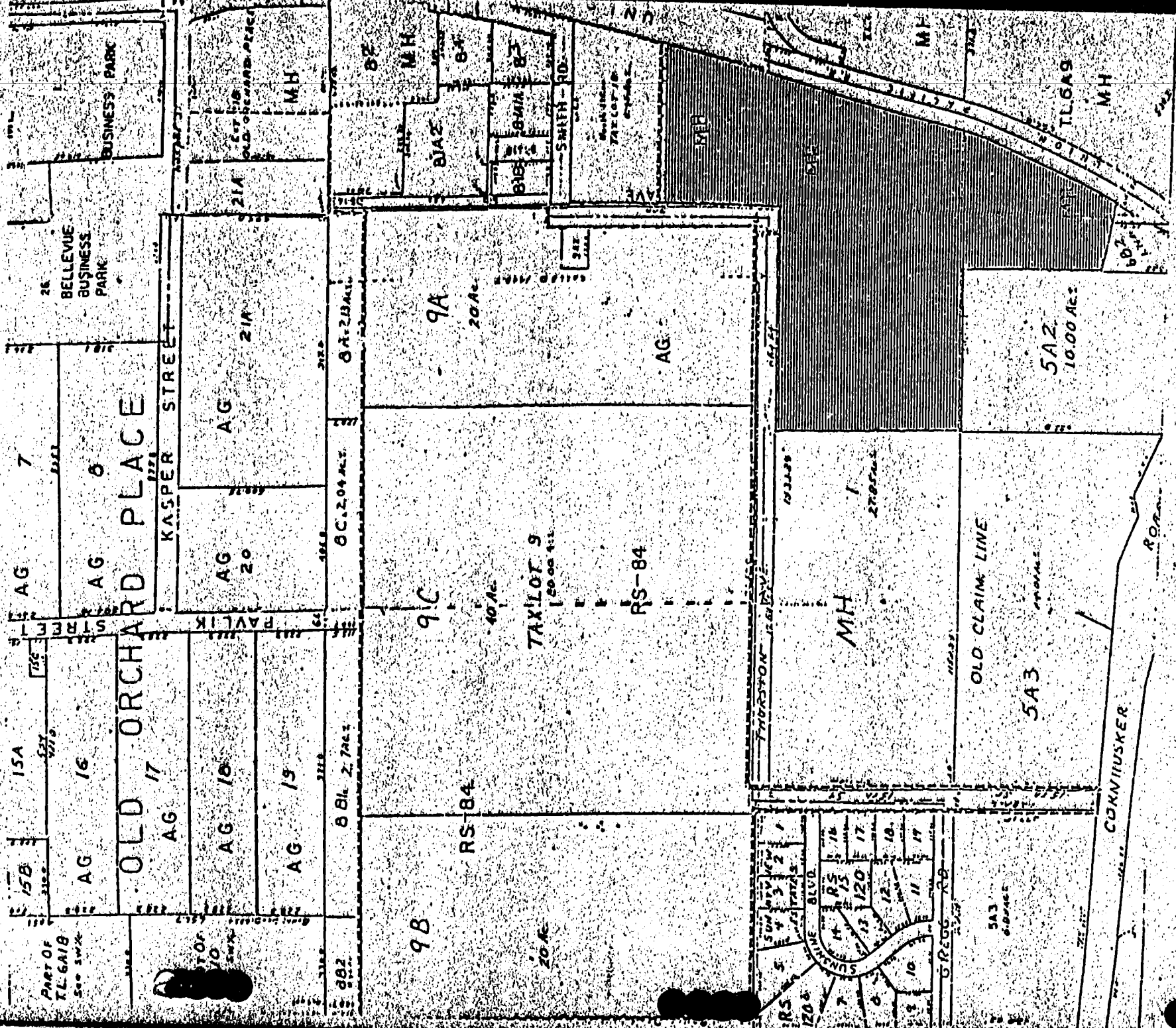
94-17054B



Legend:

 Present Bellevue City Limits  
 Possible Area of Annexation

AVERY COMMERICAL INDUSTRIAL PLAZA