

US 136 Apple Grove

NE 1/4 NW 1/4 15-14-12.

DT 9517726.

DOT 9517726.

Inst	Date	Type	Grantor	Grantee	c
45-14	3/4/12	WD	Bertha Ellet George Henry W.	Henry Fricke Mary NW	
10-112	6/22/39	decree	Henry Fricke	dec'd.	
12-276	9/1/44	decree	Mary M Fricke	dec'd	
62-586	11/6/44	WD	Milton and Verna Fricke m. Grace Ward Johnson, Ruth Fricke, sup.	Marc Grube.	
15-47	8/21/51	Ease.	all NE 1/4 NW		✓
23-172	3/7/58	Ease.	rel by 96-10726		✓
93-26121	10/18/93	Ease.			✓
9514225	8/25/95	WD	Marc D Grube	Apple Grove Inc.	✓
9519366	11/2/95	assign	15-49 sb 15-47		✓
9519367	11/2/95	plat	Apple Grove.		✓

96-10726 6/14/96 rel. 23-172 and 95-17522 - shows an plat rel after plat filed

Vertical

Trussford

DATE	GRANTOR	GRANTEE	KIND OF INSTRUMENT	RECORD				ACRES	REMARKS
				BOOK	PAGE	N.E. QUARTER	N.W. QUARTER		
				N.	N.W.	S.W.	S.E.		
	Bertha E. Eitelgerge & H. Henry Friske & wife	Henry Friske & wife	W.D.	45	14			40	
	Louis W. Sautter & wife	President of Sautter & Co.	Mtg.	30	433			1.234	Pt. Con. 34-24
	United States	Andrew J. Hanson	Relat.	47	23			1.234	Con. 34-525
	Mo. Pacific Railway Co. et al	Mo. Pac. R.R. Corporation et al	Deed	47	496				Pt. of way
	Louis X. Sautter & wife	Myrtle L. Sautter et al	W.D.	48	543			1.2	80
	Louis W. Sautter	Louis X. Sautter	W.D.	48	545			3.4	80
	Myrtle L. Sautter et al	Ernest Hess	Mtg.	31	256			1.2	80
	The Provident Loan and S. Co. of Philadelphia	Louis W. Sautter & wife	Ch. Rel.	34	296			1.2	Set. 37-699
	Louis X. Sautter & wife	John L. Sautter	W.D.	50	225			3.4	of 30-432
	President of Sautter & Co.	Louis W. Sautter & wife	Rel.	34	525			1.234	
	Myrtle L. Sautter & H. Francis Friske & wife	Ernest Hess	Mtg.	35	167			1.2	Cloud 22 Set. 37-700
	Francis Friske & wife	E. C. Goerke	Mtg.	37	335	1.234			Con. 37-485
	E. C. Goerke	Francis Friske, et al	Ch. Rel.	37	485	1.234			
	H. A. Oldenop, Sheriff	Charles E. Marshall	Deed	53	9			1.2	
	Charles E. Marshall & wife	Jorgan Investment Co.	Mtg.	37	644			1.2	Con. 42-204
	Clerk District Court	County Clerk	Ch. Rel.	37	699			1.2	Deed 38-14
	Clerk District Court	County Clerk	Ch. Rel.	37	700			1.2	
	Jorgan Investment Co.	Equit. Life Assur. Society	Deed	38	14			1.2	
	Chas E. Marshall & wife	The State Bank of Papillion	W.D.	53	128			1.2	
	St. Bank of Papillion	Malinda H. Margaret Morgan	W.D.	53	174			1.2	
	Bertha E. Eitelgerge & H. Henry Friske	The Federal Land Bk of Mo.	Mtg.	33	751		234		Con. 42-292
	Bertha E. Eitelgerge	Whom it may concern	Ch. Rel.	36	447		234		
	United States	Francis Lussignom	Ch. Rel.	53	543		1.234		
	James H. Latta	Albert A. Patzman, et al	Ch. Rel.	41	112	1.234			
	H. S. Lower & wife	H. M. Bletz et al	W.D.	53	562	1.234			2nd Sub. } 1st Sub. }
	Francis H. Friske et al	H. S. Lower	W.D.	53	561	1.234			Rel. 79-22
	Missouri Pacific R.R. Corp.	Guaranty Trust Co. of N.Y.	Mtg.	41	485				of H. 351/369
	New England Trust Co. et al	C. B. v. Q. R. R. Co.	Rel.	41	559				of H. 383/391
	Charles E. Perkins & Harry H.	Omaha & North Platte R.R.	Rel.	41	562				

Proof read

DATE	GRANTOR	GRANTEE	KIND OF INSTRUMENT	RECORD				ACRES	REMARKS
				BOOK	PAGE	N.E. QUARTER	N.W. QUARTER		
	Margaret Face et al	Nebraska Lumber Co.	Contract	7	204			1.2	Right of way
	Elizabeth E. Entelgeorge	Nebraska Lumber Co.	Contract	7	211		3/4		
	Elizabeth F. Fricke	Nebraska Lumber Co.	Contract	7	205			1.2	
	F.M. Blyskal & w/f.	Nebraska Lumber Co.	Contract	7	206	2/4			
	Malinda A. Magaret et al	Walter Wittmuss	Mtg.	26	346			1.2	Canon margin
	Walter Wittmuss	Charles E. Marshall et al	Rel.	42	204			1.2	of 37, 644
	Betha E. Entelgeorge	Federal Land Bank	Mtg.	42	267		2, 3, 4		Canon 13-660
	Federal Land Bank	Betha E. Entelgeorge	Rel.	42	292		2, 3, 4		of 33-757
	John S. Sautter & w/f.	Victor J. Jepp.	Contract	7	357			3.4	Can. 22-13-204
	Malinda A. Magaret et al	Victor J. Jepp	Contract	7	359			1.2	
	Betha E. Entelgeorge & w/f.	Victor J. Jepp	W.D.	57	19		2, 3, 4		
	Victor J. Jepp & w/f.	Vera A. Drumble	Mtg.	36	492		2, 3, 4		Can. and margin
	Betha E. Entelgeorge & w/f.	Nebraska Lumber Co.	Contract	8	767		3, 4		
	Betha E. Entelgeorge & w/f.	Nebraska Lumber Co.	Contract	8	783		3, 4		
	Vera A. Drumble	Victor J. Jepp & w/f.	Rel.	36	492		2, 3, 4		of 36-492
	Federal Land Bank	Betha E. Entelgeorge	Rel.	43	660		2, 3, 4		of 42-267
	Malinda A. Magaret & w/f.	Margaret Face	W.D.	57	188			1.2	Land 1/2 int.
	Walter Wittmuss	Malinda A. Magaret & w/f.	Mtg.	36	346			1.2	of 36-346
	Margaret Face & w/f.	Walter Wittmuss	Mtg.	36	545			1.2	of 36-545
	Walter Wittmuss	David J. Cameron & w/f.	W.D.	58	208			1.2	of 36-545
	In Matter of Estate of F.M. Blyskal & w/f.	State of Nebraska	W.D.	57	81		3, 4		Land 1/2 int.
	Walter Wittmuss	Margaret Face & w/f.	W.D.	47	136				
	Malinda A. Face & w/f.	State of Nebraska	W.D.	57	83				
	Elizabeth F. Fricke	Sophie Wittmuss	Mtg.	48	31		1, 2, 3, 4		Canon margin
	John S. Sautter & w/f.	State of Nebraska	W.D.	61	79				
	John S. Sautter & w/f.	George C. Sautter	W.D.	62	463			3.4	
	F.M. Blyskal & w/f.	Carl J. Cameron & w/f.	W.D.	62	242		1, 2, 3, 4		
	Carl J. Cameron & w/f.	F.M. Blyskal & w/f.	Mtg.	50	618		1, 2, 3, 4		Can 61-259
	Sophy M. Face	Northern Natural Gas Co.	W.D.	52	128			1.2	Rel. 85-125
	Walter Wittmuss	David J. Cameron & w/f.	W.D.	58	208			1.2	
	Raymond J. Face & w/f.	Barclay M. Face	W.D.	62	560			1.2	Land 1/2 int.
	Walter Wittmuss	Margaret Face, et al	Rel.	52	141			1.2	of 36-545
	In Matter of Estate of Margaret Face, Dec'd.	Margaret Face, Dec'd.	Decree	12	272			1.2	Land 1/2 int.
	Malinda A. Magaret	Abbie May Concern	Off.	12	273			1.2	Land int.
	In Matter of Estate of Mary M. Fricke Dec'd.	Mary M. Fricke Dec'd.	Decree	12	276				Land 1/2 int.
	Victor J. Jepp et al	Marie S. Strube	W.D.	62	586				
	Sophie A. Wittmuss	Abbie May Concern	Off.	12	273		1, 2, 3, 4		Rel. 31-354
	Carl J. Cameron & w/f.	Victor J. Jepp et al	W.D.	62	578		1, 2, 3, 4		Rel. 120-354
	Elizabeth F. Fricke	Sophie Wittmuss	Mtg.	53	239		1, 2, 3, 4		Can 56-286
	Sophie Wittmuss	Elizabeth Fricke	Rel.	48	31		1, 2, 3, 4		of 48-31
	Victor J. Jepp	John S. Sautter & w/f.	Rel.	13	204			3.4	of Dec 7-357
	Mary A. Sautter	George C. Sautter	Dec'd	64	447			3.4	
	Sophie Wittmuss	Elizabeth Fricke	Rel.	56	286		1, 2, 3, 4		of 53-239
	F.M. Blyskal & w/f.	Carl J. Cameron & w/f.	Rel.	61	259		1, 2, 3, 4		of 50-618
	Elizabeth Fricke	Northern Natural Gas Co.	W.D.	15	44		1, 2, 3, 4		
	Victor J. Jepp & w/f.	Northern Natural Gas Co.	W.D.	15	45		3, 4		
	Marie S. Strube et al	Northern Natural Gas Co.	W.D.	15	47				
	U.S. of America	Marie Luigraan	Patent	71	430		1, 2, 3, 4		

Times-Tenillas, Nebraska

GRANTOR	GRANTEE	KIND OF INSTRUMENT	RECORD		N.E. QUARTER	N.W. QUARTER	S.W. QUARTER	S.E. QUARTER	ACRES	REMARKS	DATE
			BOOK	PAGE							
Ernest A. G. p. King & wife	Frank Stepanek	Cont.	71	475			1 2 3 4				
Carol E. Thompson	Edw. E. Thompson	Gen. D.	73	469		2 3 4					
John M. Hottel & wife	Edw. E. Thompson	Gen. D.	73	481		2 3 4					
Edw. E. Thompson	Anthony Stepanek et al	Gen. D.	77	113		2 3 4					
Carl Camengind	Edw. E. Thompson	Gen. D.	77	209	1 2 3 4						
Frank C. Stepanek & wife	Anthony Stepanek	Gen. D.	77	364		2 3 4					
In Matter of Estate of	Edw. E. Thompson	Gen. D.	78	383		2 3 4				Cont. the Act.	
No. Pacific Railroad Corp.	Matter of Reorganization	Gen. D.	79	11							
Guaranty Trust Co. of N. Y.	No. Pacific Railroad	Gen. D.	79	22							of 41-485
Edw. E. Thompson, Trustee	No. Pacific Railroad Co.	Gen. D.	79	25							
No. Pacific Railroad Co.	Fortune Hill Land	Gen. D.	79	32							
No. Pacific Railroad Co.	Mfg. Trust Co. et al	Gen. D.	79	90							
In Matter of Petition	Omaha P. P. Dist.	Gen. D.	80	411				1			
Carl Camengind	Richard Berg	Gen. D.	80	467	1 2 3 4						
Central Inv. Co.	Dorothy M. Jase	Gen. D.	85	185				1 2			of 52-128
Carl J. Camengind & wife	Omaha Public Power Dist.	Gen. D.	83	166	2 3 4						
Marie D. S. Rabe & husband	Omaha Public Power Dist.	Gen. D.	83	173							
Edward E. Stepanek & wife	Omaha Public Power Dist.	Gen. D.	83	170							
Edw. E. Thompson	Anthony Stepanek, et al	Gen. D.	83	70		2 3 4					
Anthony Stepanek et al	Edw. E. Stepanek & wife	Gen. D.	83	91		2 3 4					
Carl J. Camengind & wife	Northwestern Bell Telephone Co.	Gen. D.	101	665							
Carl J. Camengind & wife	Northwestern Bell Telephone Co.	Gen. D.	128	254							Min of 14-578
Carl J. Camengind & wife	Northwestern Bell Telephone Co.	Gen. D.	104	234							
Carl J. Camengind & wife	Northwestern Bell Telephone Co.	Gen. D.	120	207	1 2 3 4						of 19-608
Kelly M. Mahon & wife	Carl J. Camengind & wife	Gen. D.	108	223	1 2 3 4						
Carl J. Camengind & wife	Kelly M. Mahon Const. Inc.	Gen. D.	94	509	1 2 3 4						
Kelly M. Mahon Const. Co.	Whom it may concern	Gen. D.	94	509	1 2 3 4						of 11-578
Kelly M. Mahon Const. Co.	Whom it may concern	Gen. D.	94	509	1 2 3 4						of 19-608
George C. Jantzen & wife	State of Nebraska	Gen. D.	30	257							
State of Neb. Dept. of Roads	Dorothy M. Jase	Gen. D.	31	34							
Northwestern Bell Telephone	State of Nebraska	Gen. D.	112	24							
Great Lakes Pipe Line Co.	Carl J. Camengind & wife	Gen. D.	31	354	1 2 3 4						of 12-578
Kelly M. Mahon Const. Co.	Whom it may concern	Gen. D.	33	200							
Great Lakes Pipe Line Company	Kelly M. Mahon Const. Inc.	Gen. D.	44	74	1 2 3						of 12-578
Kelly M. Mahon Const. Co.	Whom it may concern	Gen. D.	36	13							of 12-578
Great Lakes Pipe Line Co.	Williams Bros. Pipe Line Co.	Gen. D.	44	106							of 12-578
Great Lakes Pipe Line Co.	Williams Bros. Pipe Line Co.	Gen. D.	126	277	1 2 3 4						of 12-578
Jase, Dorothy	Omaha Public Power Dist.	Gen. D.	37	194							
Jantzen, George C. & wife	Nebraska, State of	Gen. D.	37	475							
Jantzen, George C. & wife	Nebraska, State of	Gen. D.	129	210							
Jase, Dorothy M.	Nebraska, State of	Gen. D.	37	477							
Nebraska, State of	Jase, Dorothy M. et al	Gen. D.	37	481							
Park View Addition, Inc.	Neb., State of	Gen. D.	37	477							
Park View Addition, Inc.	D. P. Associates, Inc.	Gen. D.	38	221							
D. P. Associates, Inc.	School District Popillion	Gen. D.	134	23							
Jase, Dorothy	School District Popillion	Gen. D.	134	22							
La Vista, City of	Whom it may concern	Gen. D.	39	199							
In Matter of Estate	Camengind, Carl Joseph	Gen. D.	39	272	1 2 3 4						
Stepanek, Edward E. & wife	Stockyards & Mill Bank	Gen. D.	177	187		2 3 4					of 12-578
Stepanek, Edward E. & wife	Stockyards & Mill Bank	Gen. D.	177	191		2 3 4					of 12-578

LOT NOS. LOT NOS. LOT NOS. LOT NOS.
 NE 1/4 NE 1/4 NE 1/4 NW 1/4 NW 1/4 NW 1/4 SW 1/4 SW 1/4
 NW 1/4 NE 1/4 NW 1/4 NW 1/4 SW 1/4 SW 1/4 SE 1/4 SE 1/4
 SW 1/4 NE 1/4 SW 1/4 NW 1/4 SW 1/4 SW 1/4 SE 1/4 SE 1/4

SEC. 15 TWP. 14 RING 12
 SARPY COUNTY,
 NEBRASKA 243

DATE	GRANTOR	GRANTEE	KIND OF INSTRUMENT	RECORD		N.E. QUARTER		N.W. QUARTER		S.W. QUARTER		S.E. QUARTER		ACRES	REMARKS
				BOOK	PAGE	N.E. N.W. S.W. S.E.	N.E. N.W. S.W. S.E.	N.E. N.W. S.W. S.E.	N.E. N.W. S.W. S.E.						
1-6-69	Fare, Dorothy M.	whom it may concern	title	140	676							1 2			(... 124-22) R.C.
1-6-69	Fare, Dorothy M.	D. J. P. Associates, Inc.	W.D.	137	629							1 2			Block 6.77
1-4-69	D. J. - P. Associates, Inc.	Fare, Dorothy M.	W.D.	192	615							1 2			Rel. 122-15
6-19-69	School District of Papillion	D. J. P. Associates, Inc.	W.D.	191	578							1 2			2.8
6-19-69	D. J. P. Associates, Inc.	Ludwig, Larry B. et al	W.D.	141	580							1 2			5 80 Log. W. 50' B.B.
4-1-70	Burlington Northern Inc.	Morgan Guar. Tr. Co. of N.Y. et al	W.D.	189	482							1 2			
4-1-70	Burlington Northern Inc.	First Natl City Bank, Trustee	W.D.	189	483							1 2			
4-1-70	Burlington Northern Inc.	Morgan Guar. Tr. Co. of N.Y. et al	W.D.	189	485							1 2			
7-22-70	Burlington Northern Inc.	Morgan Guar. Tr. Co. of N.Y. et al	W.D.	189	484							1 2			
7-27-70	Burlington Northern Inc.	First Natl City Bank, Trustee	W.D.	189	486							1 2			
10-14-70	Sautter, George C. & w/f	Ther, state of	W.D.	145	1828							1 2			0.165
3-24-71	Freije, Frank R.	Sautter, George C.	W.D.	190	576							3 4			
3-25-71	Sautter, George C. & w/f	Freije, Frank R.	W.D.	146	464							3 4			
4-26-71	Burlington Northern Inc.	Morgan Guar. Tr. Co. of N.Y. et al	W.D.	190	958							1 2			
4-26-71	Burlington Northern Inc.	First Natl City Bank, Trustee	W.D.	190	959							1 2			
5-6-71	Edward Dist. of Papillion	whom it may concern	W.D.	147	720							1 2			1.77 T.L. 28
5-10-71	Ludwig, Larry B. et al	D. J. - P. Associates, Inc.	W.D.	146	789							1 2			T.L. 38
5-10-71	D. J. - P. Associates, Inc.	McCahon, Betty S. et al	W.D.	146	788							1 2			
5-10-71	McCahon, Betty S. et al	Smith, Charles D. et al	W.D.	146	790							1 2			
5-13-71	D. J. - P. Associates, Inc.	Smith, C. B. Const. Co.	W.D.	146	813							1 2			
5-14-71	Smith, C. B. Const. Co.	D. J. - P. Associates, Inc.	W.D.	190	1228							1 2			
5-14-71	D. J. - P. Associates, Inc.	whom it may concern	W.D.	5	45							1 2			Rel. 193-2186
5-21-71	Smith, C. B. Const. Co.	Construction Services, Inc.	W.D.	146	823							1 2			Block 15-616 "Alpine Valley Serv." 117961

NOV 4 1971

Please, See Next Page

Numerical Land Index, Sarpy County, Nebraska

LOT NOS. _____ LOT NOS. _____ LOT NOS. _____ LOT NOS. _____
 NE 1/4 NE 1/4 _____ NE 1/4 NW 1/4 _____ NE 1/4 SW 1/4 _____ NE 1/4 SE 1/4 _____
 NW 1/4 NE 1/4 _____ NW 1/4 NW 1/4 _____ NW 1/4 SW 1/4 _____ NW 1/4 SE 1/4 _____
 SW 1/4 NE 1/4 _____ SW 1/4 NW 1/4 _____ SW 1/4 SW 1/4 _____ SW 1/4 SE 1/4 _____
 SE 1/4 NE 1/4 _____ SE 1/4 NW 1/4 _____ SE 1/4 SW 1/4 _____ SE 1/4 SE 1/4 _____

SEC. 15 TWP. 14 RING. 12

SARPY COUNTY
NEBRASKA 247

DATE	GRANTOR	GRANTEE	KIND OF INSTRUMENT	RECORD INSTRUMENT NUMBER	N.E. QUARTER				N.W. QUARTER				S.W. QUARTER				S.E. QUARTER				ACRES	REMARKS
					N.	E.	S.	W.	N.	E.	S.	W.	N.	E.	S.	W.	N.	E.	S.	W.		
7-27-88	Missouri Pac. R.R. Co.	Center Develop. Co.	D.C.R.	88-1163																		
9-15-88	Center Develop. Co.	Sarpy R.R. Co.	P.C.D.	88-12626																		
10-25-88	Dept. of Treasury, U.S.A.	Stepanek, Donald Jr.	W.D.	88-15719																		
12-15-88	Stepanek, Inc.	Stepanek, Anthony et al.	D.C.R.	88-19994																		
3-1-89	Montenisi Nat. Bank of St. Paul	Trust Co. of N. D.	W.D.	89-02275																		
4-12-89	Stepanek, Anthony, Personal Rep.	Vanderwater, Gene	W.D.	89-01610																		
11-12-89	Stepanek, Anthony, Personal Rep.	Stepanek, Victor	W.D.	89-04311																		
1-12-89	Stepanek, Anthony, Personal Rep.	Stepanek, Anthony	W.D.	89-04212																		
10-18-89	Stepanek, Anthony, Personal Rep.	Stepanek, Anthony et al.	W.D.	89-14425																		
1-17-90	Vanderwater, Gene - CEO	Stepanek, Victor	W.D.	90-00956																		
1-17-90	Stepanek, Anthony A. + wife	Stepanek, Victor	W.D.	90-00857																		
2-15-90	Vogel, Dennis P. III	LaVita Church of Christ	W.D.	90-02109																		
8-31-90	Sarpy R.R. Co.	Stepanek, Victor	W.D.	90-72510																		

Computer Index as of 11-1-90

(8-45)
 p. 77-158, 175, 180, 181, 182, 183, 184, 185, 186, 187, 188, 189, 190
 57.90 Under 1/3 int.
 57.90 Under 1/3 int.
 57.90 Under 1/3 int.
 Under 1/3 int. (8-4)
 Under 1/3 int. (8-7)
 Under 1/3 int. (8-1)
 of 201-344
 (600)

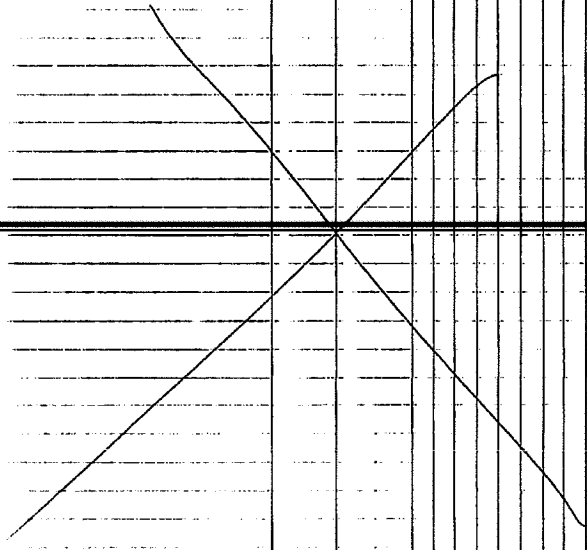



SARPY COUNTY NEBRASKA

Todays Date: 9/11/2014 Indexed Thru: 9/9/2014 Imaged Thru: 9/9/2014

Sarpy County Register of Deeds

Lands Book Available

Format

Search Type = Lands (# Records Found 113)
 Search Criteria = Section 15 Township 14 Range 12 Quarter - Quarter of the Quarter
 Double Click Row to View Instrument Information

	LandsParts	Instr #	Type	Filed Date	Grantor	Remarks	Grantee	SEC	TWP	RNG	Lots
	**** **** p**	199002109	DOR	2/15/1990	HOGAN DENNIS P 111	201-344	LAVISTA CHURCH OF CHRIST	15	14	12	
	**** pp** **** *	199012510	QCD	8/31/1990	SARPY R & R CO		STEPANEK VICTOR	15	14	12	
	XXX XXXX	199100283	CABOS	1/7/1991	ENRON CORP	CORR SUB 7/17/97 PW	NORTHERN NATURAL GAS CO	15	14	12	
	**** **pp ****	199217273	WD	8/21/1992	STEPANEK VICTOR C	CORR GRANTEE MR 9/2/92	LAVISTA CITY OF	15	14	12	
	**** **pp ****	199217274	EASE	8/21/1992	STEPANEK ANTHONY A & HELEN A ETAL	CORR TO SHOW SECTION TOWNSHIP RANGE MR 9/1/92	LAVISTA CITY OF	15	14	12	
	**** **pp ****	199217275	EASE	8/21/1992	STEPANEK ANTHONY A & HELEN A ETAL	CORR GRANTEE MR 9/2/92	LAVISTA CITY OF	15	14	12	
	XXXX	199300875	UCC	1/14/1993	STEPANEK VICTOR C		AMERICAN NATIONAL BANK OF SARPY CTY	15	14	12	
	**** p** **** *	199326151	WD	10/18/1993	FIRST SOUTHERN BAPTIST CHURCH		SARPY COUNTY OF	15	14	12	
	**** p** **** *	199326152	EASE	10/18/1993	FIRST LUTHERAN BAPTIST CHURCH		SARPY COUNTY OF	15	14	12	
	**** p** **** *	199326153	WD	10/18/1993	GRUBE MARIE		SARPY COUNTY OF	15	14	12	
	**** p** **** *	199326154	EASE	10/18/1993	GRUBE MARIE		SARPY COUNTY OF	15	14	12	
	**** p** **** *	199403665	RAOR	2/15/1994	BANK OF PAPILLION	OF 205- 7366	FIRST SOUTHERN BAPTIST CHURCH RALSTON	15	14	12	
							FIRST				

**** *p** *****	199403666	DOR	2/15/1994	BANK OF PAPILLION TR	OF 205- 7365	SOUTHERN BAPTIST CHURCH RALSTON	15	14	12	
**** *p** *****	199405218	TD	3/7/1994	FIRST SOUTHERN BAPTIST CHURCH ETAL		SPRINGFIELD STATE BANK ETAL	15	14	12	TL 6B
p*** **** *****	199406087	QCD	3/16/1994	U S WEST COMMUNICA INC	PT TX LOT 1	LAVISTA CITY OF	15	14	12	
p*** **** *****	199406089	EASE	3/16/1994	U S WEST COMMUNICA INC		LAVISTA CITY OF	15	14	12	TL 1
**** *p** *****	199406316	REL	4/13/1994	AMERICAN CHURCH TRUST CO TR	OF 206- 4126	FIRST SO BAPTIST CHURCH OF RALSTON INC	15	14	12	
**** *p** *****	199412473	PDOR	6/2/1994	SPRINGFIELD STATE BANK TR	OF 94- 05218	FIRST SOUTHERN BAPTIST CHURCH	15	14	12	
**** *p** *****	199412557	EASE	6/3/1994	FIRST SOUTHERN BAPTIST CHURCH	A STRIP 23' IN WIDTH & 36' IN LENGTH	OMAHA PUBLIC POWER DISTRICT	15	14	12	TL 6B
AMERICAN										
**** **** XXXX ****	199413346	UCCT	6/14/1994	NATIONAL BANK SARPY CTY	OF 93- 000875	STEPANEK VICTOR C	15	14	12	
**** *pp* *****	199420440	WD	9/16/1994	STEPANEK VICTOR	(3)	SARPY COUNTY OF	15	14	12	
**** *p** *****	199420441	EASE	9/16/1994	FIRST SOUTHERN BAPTIST CHURCH	(3)	SARPY COUNTY OF	15	14	12	
**** *p** *****	199420442	WD	9/16/1994	FIRST SOUTHERN BAPTIST CHURCH	(3)	SARPY COUNTY OF	15	14	12	
**** *p** *****	199502386	AOE	2/28/1995	SARPY COUNTY OF	OF 94- 20441	METROPOLIT UTILITIES DIST	15	14	12	
**** *pp* *****	199510738	FLT	7/12/1995	IRS	OF 88- 15419	STEPANEK FRANK JR	15	14	12	
**** *p** *****	199517711	EASE	8/21/1995	BURLINGTON NORTHERN RAILROAD CO		NE DEPT OF ROADS	15	14	12	
**** p*** *****	199514225	WD	8/25/1995	GRUBE MARIE D	CORR TO SHOW PT NW1/4 R	APPLE GROVE INC	15	14	12	

9/14/95

**** p*** **** ****	199514501 QCD	8/30/1995	APPLE GROVE INC	SUDBECK HENRY J ETAL	15	14	12
**** p*** **** ****	199515774 SID	9/14/1995	SID #174	WHOM IT MAY CONCERN	15	14	12
**** p*** **** ****	199517522 EASE	10/10/1995	APPLE GROVE INC	OMAHA PUBLIC POWER DISTRICT	15	14	12
**** p*** **** ****	<u>199517726</u> DOT	10/11/1995	APPLEGROVE INC	NORWEST BANK ETAL	15	14	12
**** p*** **** ****	199517727 NOC	10/11/1995	APPLEGROVE INC	WHOM IT MAY CONCERN	15	14	12
**** p*** **** ****	<u>199519366</u> AMEASE	11/2/1995	NORTHERN NATURAL GAS CO	REPL PT OF NE1/4 OF NW 1/4 15-14-12 NKA LOTS 1-136 APPLE GROVE	15	14	12
**** p*** **** ****	<u>199519367</u> PLAT	11/2/1995	APPLE GROVE INC ETAL	WHOM IT MAY CONCERN ADDN ADD SECTION, TOWNSHIP, AND RANGE	15	14	12

REMARKS
LAL 9-25-2002

**** **** ***p ****	199604826 WD	3/15/1996	STEPANEK ANTHONY A ETAL	LAVISTA CITY OF	15	14	12	
**** **** ***p ****	199605946 PREASE	4/2/1996	NORTHERN NATURAL GAS CO	CORR TO SHOW OF 15-44 NOT 44-15 7/30/99 R	15	14	12	
**** p*** **** ****	199610726 REL	6/4/1996	OMAHA PUBLIC POWER DISTRICT	WHOM IT MAY CONCERN OF 23-172 & 95-17522	15	14	12	
**** **p* **** ****	199705478 ROW	3/25/1997	STEPANEK VICTOR C	SARPY COUNTY OF	15	14	12	PT TL6A
**** **p* **** ****	199705479 WD	3/25/1997	STEPANDK VICTOR C	SARPY COUNTY OF	15	14	12	PT TL 6A
**** **** *pp* ****	199705480 ROW	3/25/1997	AJV	SARPY COUNTY OF	15	14	12	
**** **** *pp* ****	199705481 WD	3/25/1997	AJV	SARPY COUNTY OF	15	14	12	

NW1/4 SEC 15 T14N R12E

1 inch = 200 feet

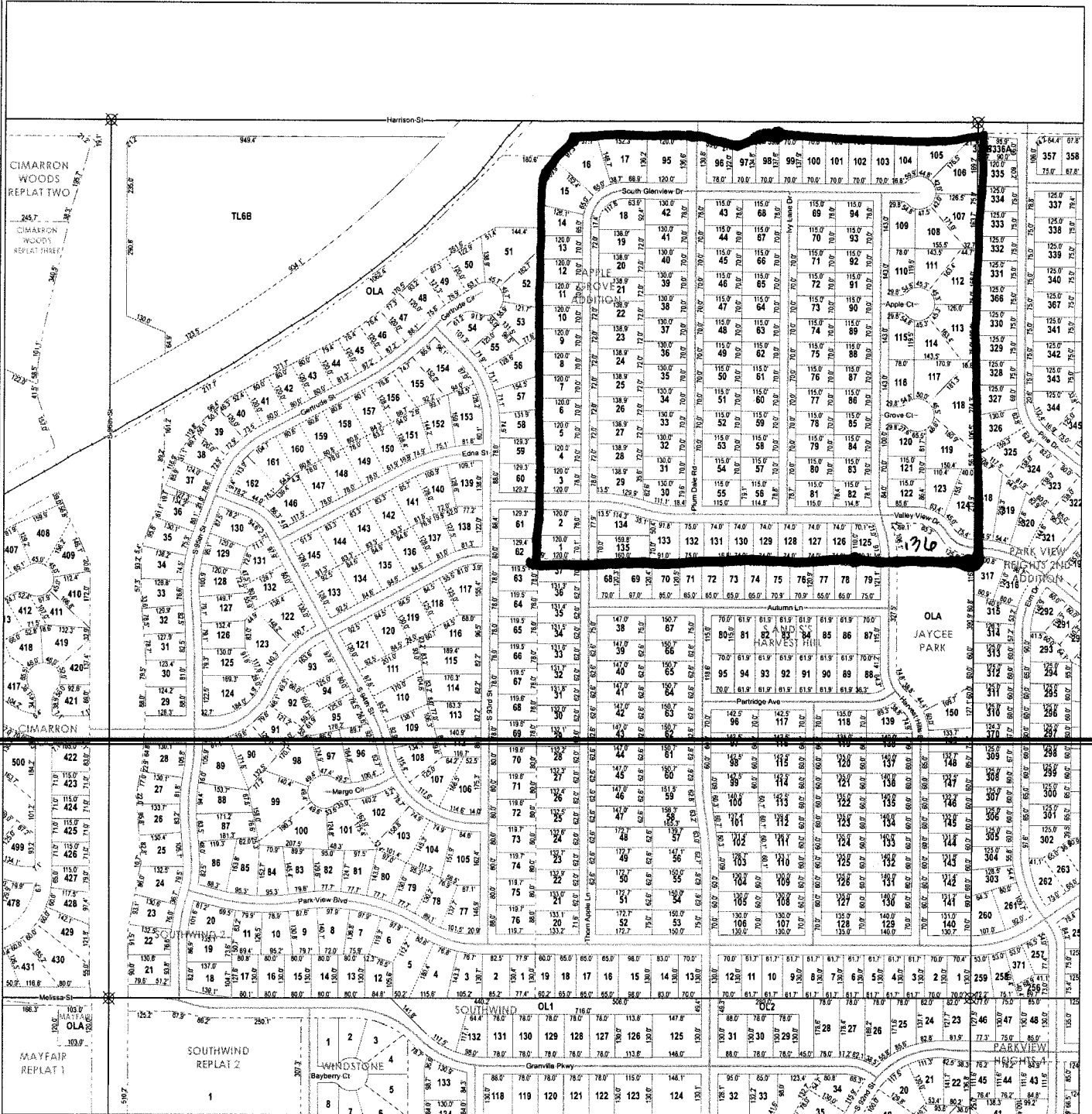

Legend

- CornerType**
- ☒ Corners
- ▭ QuarterSections
- Subdivisions
- Rights of Way
- ▭ Lots
- ▭ Blocks
- Railroads
- Street Centerline

NOTICE

This map constitutes a representation based on information provided to the Sarpy County Surveyors Office by other individuals and organizations. Therefore no representations regarding the accuracy of the size, dimensions, measurements, condition, platting, or location of the within described area are made. Should such information be required for construction, zoning, or other purposes, the services of a private surveyor and/or title search should be secured.

SARPY COUNTY
SURVEYOR'S OFFICE

sarpy county
GIS

Quarter Section Location

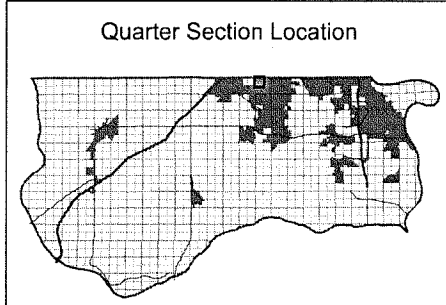

This Map Was Printed On:
8/1/2014