



1346 306 MISC



10147 00 306-308

Nebr Doc Stamp Tax
Date
\$
By

RICHARD N. TAKECHI
REGISTER OF DEEDS
DOUGLAS COUNTY, NE

00 AUG -1 PM 3: 21

RECEIVED

**THIS PAGE INCLUDED FOR INDEXING
PAGE DOWN FOR BALANCE OF INSTRUMENT**

M *Miss* *3* *26*⁰⁰

- 61448

2

AFFIDAVIT OF CORRECTION

To correct the Dedication on the Plat of BROOKHAVEN WEST REPLAT ONE, a subdivision located in the West 1/2 of Section 8, and also part of the SE 1/4 of Section 8, Township 14 North, Range 12 East of the 6th P.M., Douglas County, Nebraska.

The Dedication on the Plat of BROOKHAVEN WEST REPLAT ONE to read
DEDICATION

Know all men by these presents that we, VILLAGE HOMES, L.L.C., owners of the property described in the Certification of Survey and embraced within the plat, have caused said land to be subdivided into lots to be numbered and named as shown, said subdivision to be hereafter known as BROOKHAVEN WEST REPLAT ONE, and we do hereby ratify and approve of the disposition of our property as shown on this plat, and we do hereby grant easements as shown on this plat. We do further grant a perpetual easement to the Omaha Public Power District, U.S. West Communications and any company which has been granted a franchise to provide a cable television system in the area to be subdivided, their successors and assigns, to erect, operate, maintain, repair and renew poles, wires, cables, conduits and other related facilities, and to extend thereon wires or cables for the carrying and transmission of electric current for light, heat and power and for the transmission of signals and sounds of all kinds including signals provided by a cable television system, and the reception on, over, through, under and across a five-foot (5') wide strip of land abutting all front and side boundary Lot lines; except those side Lot lines which are occupied by the common wall between the duplex units; an eight-foot (8') wide strip of land abutting the rear boundary lines of all interior lots; and a sixteen-foot (16') wide strip of land abutting the rear boundary lines of all exterior lots. The term exterior lots is herein defined as those lots forming the outer perimeter of the above-described addition. Said sixteen-foot (16') wide easement will be reduced to an eight-foot (8') wide strip when the adjacent land is surveyed, platted and recorded and we do further grant a perpetual easement to Metropolitan Utilities District, their successors and assigns, to erect, install, operate, maintain, repair and renew pipelines, hydrants and other related facilities, and to extend thereon pipes for the transmission of gas and water on, through, under and across a five-foot (5') wide strip of land abutting all cul-de-sac streets. No permanent buildings or retaining walls shall be placed in the said easement ways, but the same may be used for gardens, shrubs, landscaping and other purposes that do not then or later interfere with the aforesaid uses or rights herein granted.

In witness whereof, we do set our hands.

VILLAGE HOMES, L.L.C.

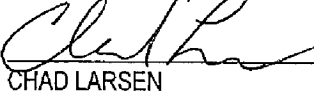

CHAD LARSEN

MANAGER

STATE OF NEBRASKA

COUNTY OF DOUGLAS

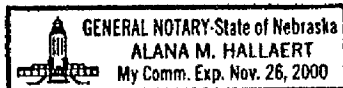

On the 31 day of July, 2000, before me a Notary Public, qualified and commissioned in and for said County, personally appeared Chad Larsen who is personally known to me to be the same and identical person whose name is affixed to the above Affidavit, and he acknowledged the signing thereof to be his voluntary act and deed.

Witness my hand and official seal at Omaha, Nebraska, on the date last aforesaid.

Commission Expires: 11-26-2000

NOTARY PUBLIC

AFFIDAVIT

Correction to the Dedication on the Plat of BROOKHAVEN WEST REPLAT ONE, a subdivision located in the West 1/2 of Section 8, and also part of the SE 1/4 of Section 8, Township 14 North, Range 12 East of the 6th P.M., Douglas County, Nebraska.

I, Robert Clark, do hereby submit the above drawing in order to correct the error in the Dedication on the Plat of BROOKHAVEN WEST REPLAT ONE, a subdivision located in Douglas County Nebraska, as Recorded in Book 2144, Page 389 thru 395.

I certify that I am the same identical person whose name appears in the Surveyor's Certificate of said BROOKHAVEN WEST REPLAT ONE, Douglas County, Nebraska.

Robert Clark

Robert Clark, L.S. 419

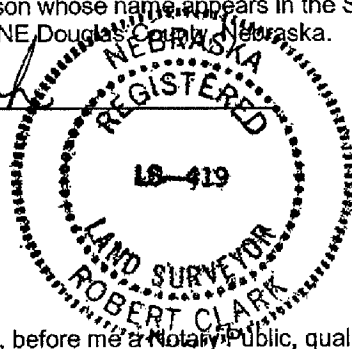

STATE OF NEBRASKA

COUNTY OF DOUGLAS

On the 1ST day of AUG., 2000, before me a Notary Public, qualified and commissioned in and for said County, personally appeared Robert Clark, who is personally known to me to be the same and identical person whose name is affixed to the above Affidavit, and he acknowledged the signing thereof to be his voluntary act and deed.

Witness my hand and official seal at Omaha, Nebraska, on the date last aforesaid.

Commission Expires:

4-30-03 *Homer R. Hunt*

NOTARY PUBLIC

E & A Consulting Group, Inc.
12001 "Q" Street
Omaha, Nebraska 68137

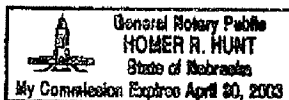

#98043

NOTARIAL SEAL AFFIXED
REGISTER OF DEEDS