

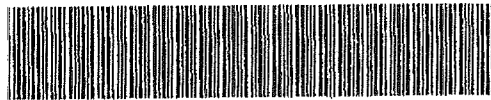

BK 1350 PG 590-590



MISC 2000 11985

Nebr Doc
Stamp Tax

Date

\$

By

RICHARD N. TARELL
REGISTER OF DEEDS
DOUGLAS COUNTY, NE

00 SEP -8 AM 8:12

RECEIVED

AFFIDAVIT OF CORRECTION

To correct the error in wording on the location of Lots 1 through 12, Wood Creek Replat Thirteen, a subdivision located in the NW 1/4 of Section 4, Township 14 North, Range 11 East of the 6th P.M., Douglas County, Nebraska.

The Surveyor's Certificate should read "the NW 1/4 of Section 4, Township 14 North, Range 11 East" instead of "Section 8, Township 14 North, Range 12 East".

The text below the title should also read "the NW 1/4 of Section 4, Township 14 North, Range 11 East" instead of "Section 8, Township 14 North, Range 12 East".

AFFIDAVIT

Correction to Lots 1 through 12, Wood Creek Replat Thirteen, a subdivision located in the NW 1/4 of Section 4, Township 14, North, Range 11 East of the 6th P.M., Douglas County, Nebraska.

I, Robert Clark, do hereby submit the above drawing in order to correct the error in the Surveyor's Certificate and the text below the title for Lots 1 through 12, Wood Creek Replat Thirteen, a subdivision located in the NW 1/4 of Section 4, Township 14 North, Range 11 East of the 6th P.M., Douglas County, Nebraska, as recorded in Book No. 2157, Page No. 481 thru 487, Douglas County, Nebraska.

I certify that I am the same identical person whose name appears in the Surveyor's Certificate of said Lots 1 through 12, Wood Creek Replat Thirteen, Douglas County, Nebraska.

Robert Clark

8-18-00

Robert Clark, L.S. 419

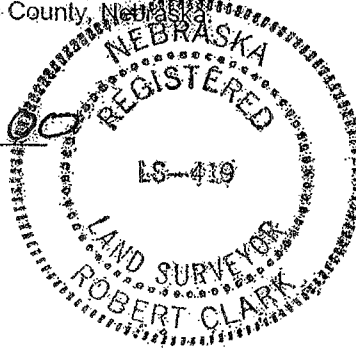

STATE OF NEBRASKA

COUNTY OF DOUGLAS

On the 18 day of Aug, 2000, before me a Notary Public, qualified and commissioned in and for said County, personally appeared Robert Clark, who is personally known to me to be the same and identical person whose name is affixed to the above Affidavit, and he acknowledged the signing thereof to be his voluntary act and deed.

Witness my hand and official seal at Omaha, Nebraska, on the date last aforesaid.

Commission Expires:

4-30-03

Homer R. Hunt
NOTARY PUBLIC

E & A Consulting Group, Inc.
12001 "Q" Street
Omaha, Nebraska 68137

#92053.5

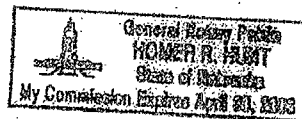

8/17/2000

✓ 61445
61541

*misc
1/2*

F
11.00
FEE 11.00 FBC# 60000
BKP 4-14-11 C/O _____ COMP _____
DEL _____ SCAN Y FV _____