



MISC 2004079040



JUN 17 2004 10:24 P 1

Received - RICHARD TAKECHI
Register of Deeds, Douglas County, NE
6/17/2004 10:24:37.66



2004079040

9-11
FEE 251.50 FB 06-43941
493 BKP 6-14-11 C/O 06-43942 COMP 493
DEL _____ SCAN _____ FV M

AFFIDAVIT OF CORRECTION

To correct Note 5 of lots 234 through 725 Inclusive and Outlot "D" Inclusive, Whitehawk, a subdivision located in the East 1/2 of Section 6, Township 14 North, Range 11 East of the 6th P.M., Douglas County, Nebraska.

Note 5 to read: 5. MINIMUM BASEMENT FLOOR ELEVATION FOR ALL LOTS WITHIN THE WHITEHAWK SUBDIVISION IS 1161.3 (USGS DATUM). FURTHERMORE, LAND AND STRUCTURES LOWER THAN ELEVATION 1168.0 (USGS DATUM) ARE SUBJECT TO A PERMANENT FLOWAGE EASEMENT GRANTED TO THE PAPIO-MISSOURI RIVER NATURAL RESOURCES DISTRICT.

instead of

5. MINIMUM BASEMENT FLOOR ELEVATION FOR ALL LOTS WITHIN THE WHITEHAWK SUBDIVISION IS 1172.0 (USGS DATUM).

AFFIDAVIT

Correction to Whitehawk, a subdivision located in the East 1/2 of Section 6, Township 14 North, Range 11 East of the 6th P.M., Douglas County, Nebraska.

I Robert Clark, do hereby submit the above drawing in order to correct the error in language of Note 5, Whitehawk, a subdivision located in Douglas County, Nebraska as recorded in Instrument No. 2003-206213, in the Register of Deeds office, Douglas County, Nebraska.

I certify that I am the same identical person whose name appears in the Surveyor's Certificate of said Whitehawk, Douglas County, Nebraska.

Robert Clark
Robert Clark L.S. 419

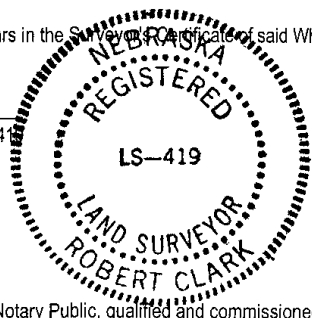

STATE OF NEBRASKA

COUNTY OF DOUGLAS

On the 14TH day of JUNE, 2004, before me a Notary Public, qualified and commissioned in and for said County, personally appeared Robert Clark, who is personally known to me to be the same identical person whose name is affixed to the above Affidavit, and he acknowledged the signing thereof to be his voluntary act and deed.

Witness my hand and official seal at Omaha, Nebraska, on this date last aforesaid.

Commission Expires:

4-30-07 *Homer R. Hunt*
NOTARY PUBLIC

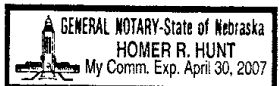

E&A CONSULTING GROUP, INC.
ENGINEERS • PLANNERS • SURVEYORS
12001 Q STREET OMAHA, NE 68137 PHONE: (402) 895-4700

Drawn by: MH Chkd by: wac Date: 6-14-04 Chkd by: _____ Date: _____

Job No.: 2001102.01 DATE: 6-14-2004

AFFIDAVIT OF CORRECTION

WHITEHAWK