



MISC 2004094212



JUL 16 2004 09:18 P 1

FEE \_\_\_\_\_ FB \_\_\_\_\_  
 BKP \_\_\_\_\_ C/O \_\_\_\_\_ COMP \_\_\_\_\_  
 DEL *JK* SCAN \_\_\_\_\_ FV *JK*

*MM 25100 OC-439411*

Received - RICHARD TAKECHI  
 Register of Deeds, Douglas County, NE  
 7/16/2004 09:18:07.18



2004094212

**Filed: AS RECEIVED**

AFFIDAVIT OF CORRECTION

To correct Note 5 of lots 234 through 725 Inclusive and Outlot "D" Inclusive, Whitehawk, a subdivision located in the East 1/2 of Section 6, Township 14 North, Range 11 East of the 6th P.M., Douglas County, Nebraska; and also Affidavit of Correction, dated June 14, 2004 and recorded June 17, 2004.

Note 5 to read: 5. MINIMUM BASEMENT FLOOR ELEVATION FOR ALL LOTS WITHIN THE WHITEHAWK SUBDIVISION IS 1161.6 (USGS DATUM). FURTHERMORE, LAND AND STRUCTURES LOWER THAN ELEVATION 1168.0 (USGS DATUM) ARE SUBJECT TO A PERMANENT FLOWAGE EASEMENT GRANTED TO THE PAPIO-MISSOURI RIVER NATURAL RESOURCES DISTRICT.

instead of

5. MINIMUM BASEMENT FLOOR ELEVATION FOR ALL LOTS WITHIN THE WHITEHAWK SUBDIVISION IS 1161.3 (USGS DATUM). FURTHERMORE, LAND AND STRUCTURES LOWER THAN ELEVATION 1168.0 (USGS DATUM) ARE SUBJECT TO A PERMANENT FLOWAGE EASEMENT GRANTED TO THE PAPIO-MISSOURI RIVER NATURAL RESOURCES DISTRICT.

AFFIDAVIT

Correction to Whitehawk, a subdivision located in the East 1/2 of Section 6, Township 14 North, Range 11 East of the 6th P.M., Douglas County, Nebraska; and also Affidavit of Correction, dated June 14, 2004 and recorded June 17, 2004.

**\*\* FILED: AS IS**

I Robert Clark, do hereby submit the above drawing in order to correct the error in language of Note 5, Whitehawk, a subdivision located in Douglas County, Nebraska as recorded in Instrument No. 2003-206213, in the Register of Deeds office, Douglas County, Nebraska; and also Affidavit of Correction, recorded June 17, 2004 as Instrument No. 2004-079040, in the Register of Deeds office, Douglas County, Nebraska.

I certify that I am the same identical person whose name appears in the Surveyor's Certificate of said Whitehawk, Douglas County, Nebraska.

*Robert Clark*  
 \_\_\_\_\_  
 Robert Clark

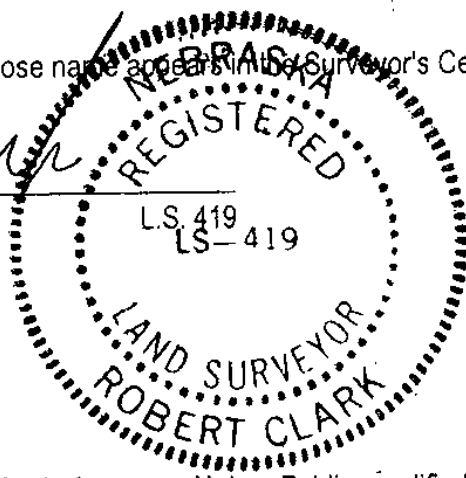

STATE OF NEBRASKA

COUNTY OF DOUGLAS

On the 14<sup>TH</sup> day of JULY, 2004, before me a Notary Public, qualified and commissioned in and for said County, personally appeared Robert Clark, who is personally known to me to be the same identical person whose name is affixed to the above Affidavit, and he acknowledged the signing thereof to be his voluntary act and deed.

Witness my hand and official seal at Omaha, Nebraska, on this date last aforesaid.

Commission Expires:

4-30-07

*Homer R. Hunt*  
 \_\_\_\_\_  
 NOTARY PUBLIC

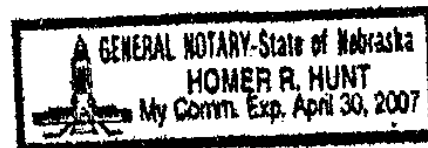

**E&A CONSULTING GROUP, INC.**  
 ENGINEERS • PLANNERS • SURVEYORS  
 12001 Q STREET OMAHA, NE 68137 PHONE: (402) 895-4700

Drawn by: MH Chkd by: WAC Date: 7-14-04 Chkd by: \_\_\_\_\_ Date: \_\_\_\_\_

Job No.: 2001102.01 Date: 7-13-2004

**AFFIDAVIT OF CORRECTION**  
**WHITEHAWK**